

SHEET INDEX		
SHEET NO.	STATION to STATION	DESCRIPTION
1	N/A	COVER
2	N/A	LEGEND/NOTES
3	1141+25.00 to 1146+25.00	PLAT OF HIGHWAYS
4	N/A	TOTAL HOLDING SKETCH
5	N/A	TOTAL HOLDING SKETCH

STATE OF ILLINOIS
DEPARTMENT OF TRANSPORTATION
DIVISION OF HIGHWAYS

PLAT OF HIGHWAYS

FAP ROUTE 785 (IL 140)
SECTION 136-BR
MADISON COUNTY
JOB NO.
R-98-018-11

SPACE RESERVED FOR RECORDING OFFICER

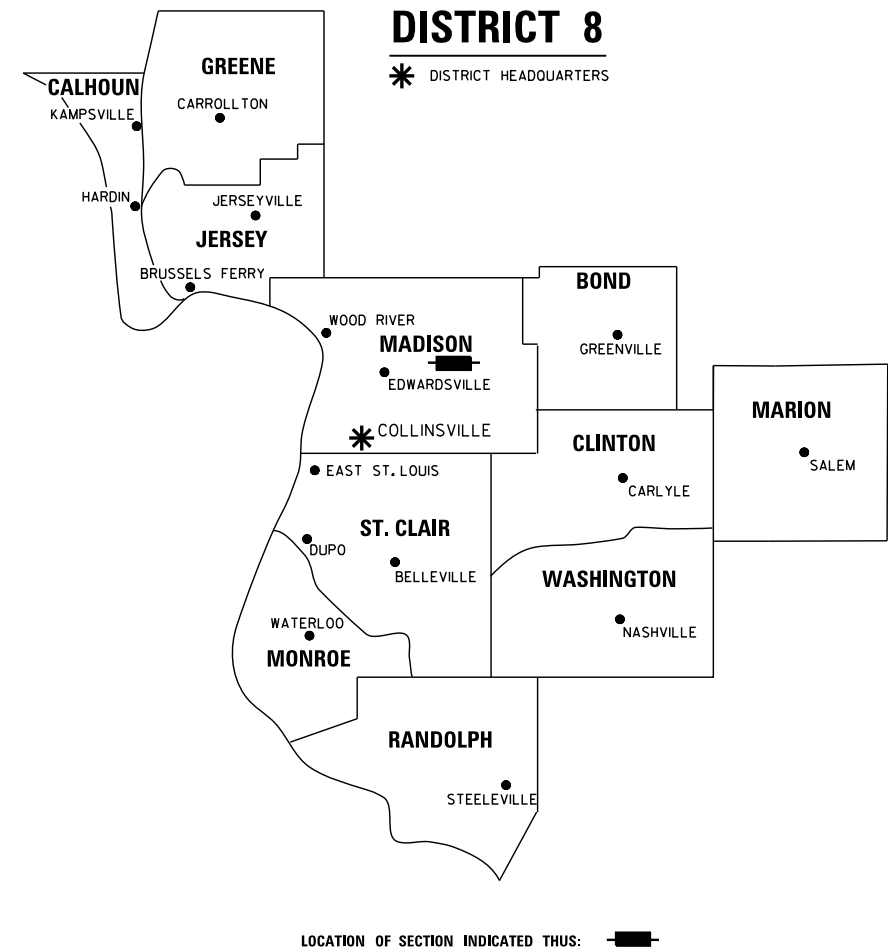
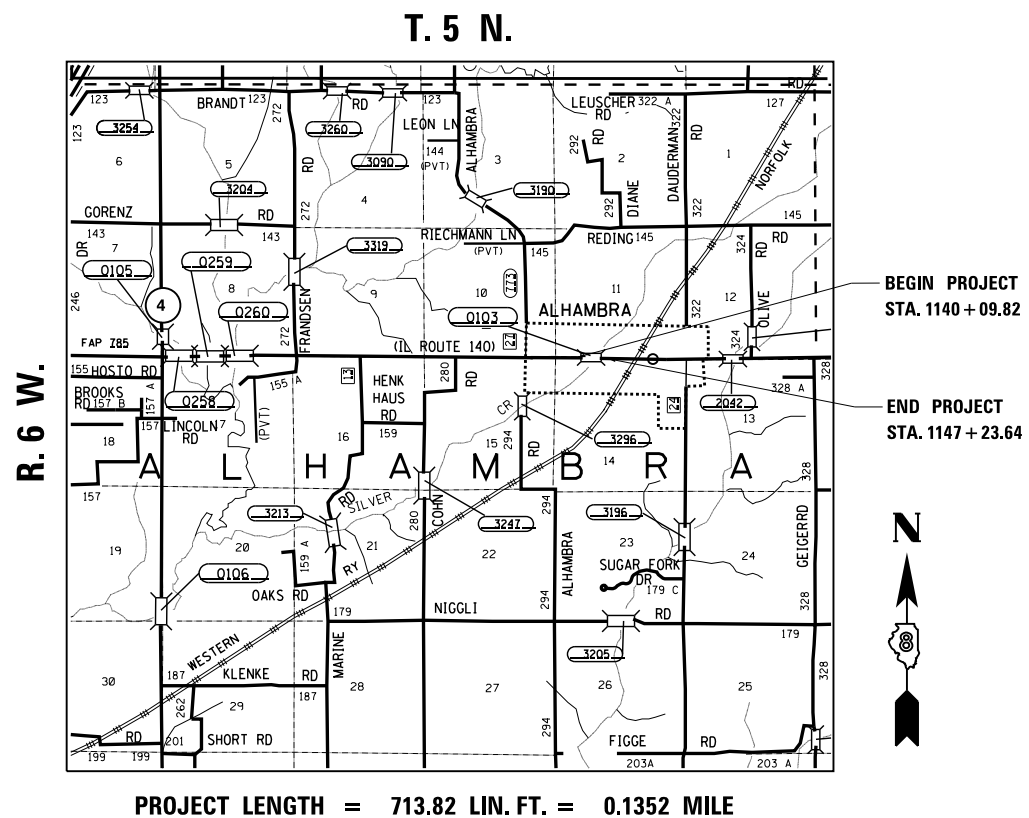

PREPARED BY:



SHERRILL ASSOCIATES, INC.
Engineers - Surveyors - Planners

Professional Design Firm Number 184-001238
316 North Main Street
Edwardsville, IL 62025

2727 Telegraph Road
St. Louis, MO 63125



GREGORY S. McVICAR, PLS NO. 3512
LICENSE EXPIRATION DATE: 11/30/2012

SHEET 1 OF 5

ILLINOIS DEPARTMENT OF TRANSPORTATION DIVISION OF HIGHWAYS/REGION 5/DISTRICT 8 1102 EASTPORT PLAZA DRIVE COLLINSVILLE, ILLINOIS 62234-6198				
F.A. RTE.	SECTION	COUNTY	TOTAL SHEETS	SHEET NO.
785	136-BR	MADISON	58	29
			CONTRACT NO. 76049	
FED. ROAD DIST. NO. - ILLINOIS FED. AID PROJECT				