

SECTION C-C
(Near ends)

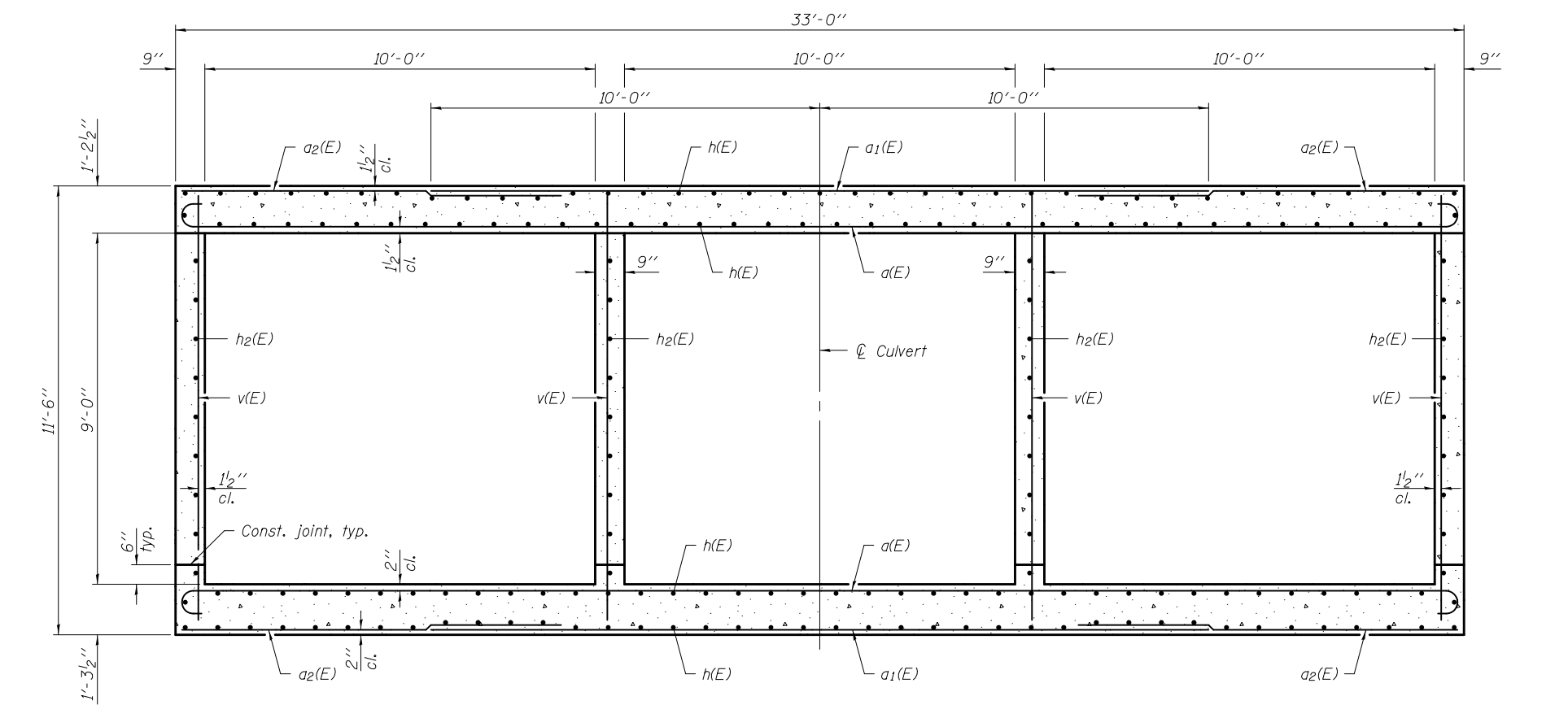

SECTION D-D

DESIGNED - SEAN CHAU	EXAMINED	DATE - FEBRUARY 1, 2013
CHECKED - PAUL GURKLYS	<i>James F. Joffe</i> ACTING ENGINEER OF BRIDGE DESIGN	
DRAWN - MICHAEL B. MOSSMAN	PASSED	REVISED
CHECKED - S.C. / P.G.	<i>Carl Berger</i> ACTING ENGINEER OF BRIDGES AND STRUCTURES	REVISED

STATE OF ILLINOIS
DEPARTMENT OF TRANSPORTATION

CULVERT DETAILS - SECTIONS THRU BARRELS
STRUCTURE NO. 060 - 2051

F.A.P. RTE.	SECTION	COUNTY	TOTAL SHEETS	SHEET NO.
785	136-BR	MADISON	58	39
CONTRACT NO. 76D49				

SHEET NO. 6 OF 12 SHEETS

ILLINOIS FED. AID PROJECT