

MATCH TO PAGE 34

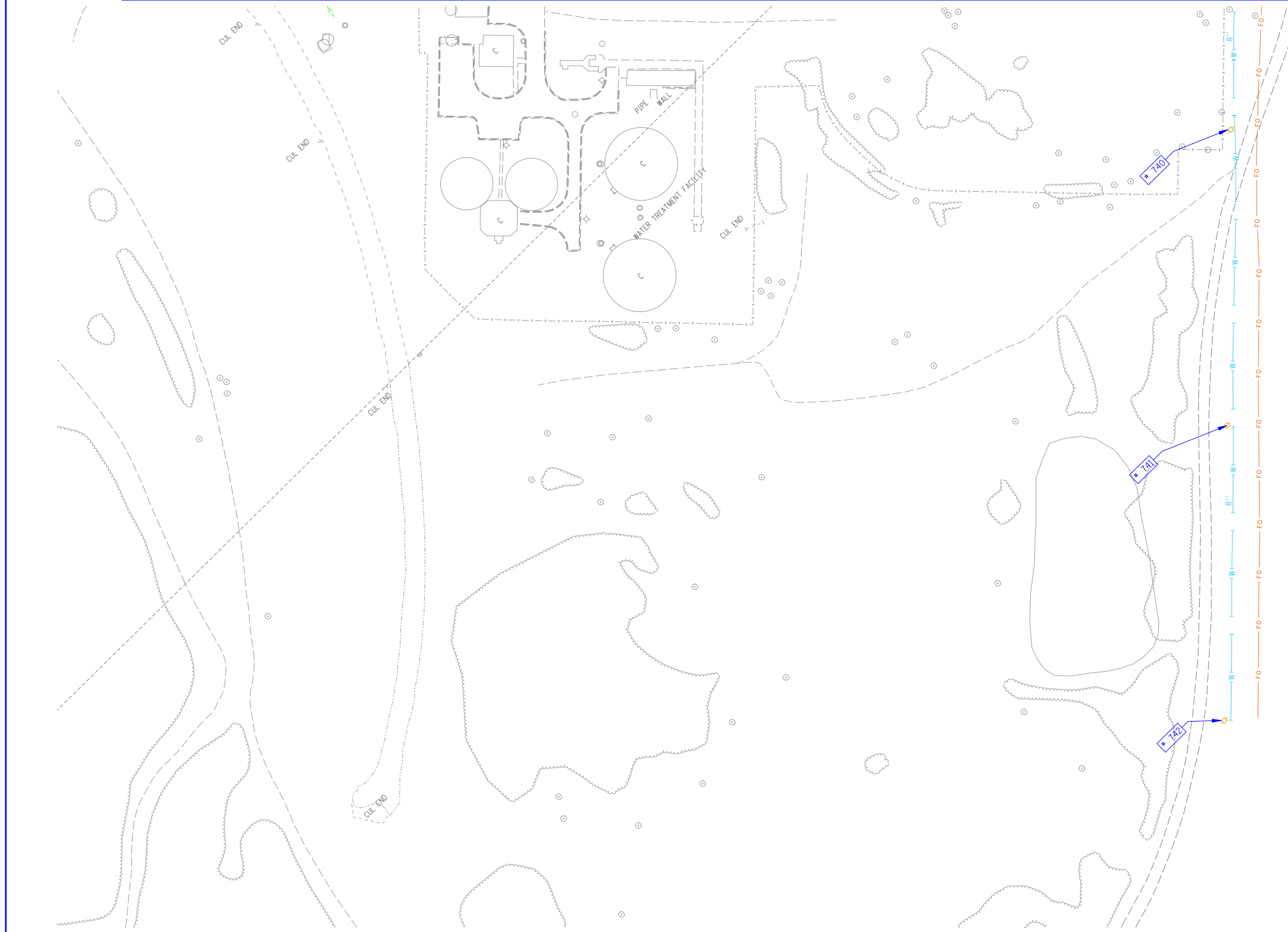

TBE Pole Number	Approximate Location	Identification on Pole	Utilities Attached to Poles	Utility Owners	Notes: Additional Items Attached to Poles
740	1112' SW OF RT 3 & N OF RR	726224	TELEPHONE, ELECTRIC	AT&T, AMEREN ELECTRIC	
741	1376' SW OF RT 3 & N OF RR	726223	TELEPHONE, ELECTRIC	AT&T, AMEREN ELECTRIC	
742	1638' SW OF RT 3 & N OF RR	726222	TELEPHONE, ELECTRIC	AT&T, AMEREN ELECTRIC	

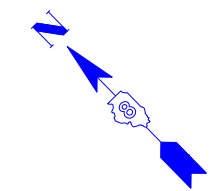

UNKNOWN	UNKNOWN
ABANDONED SANITARY	ABANDONED SANITARY
FORCE MAIN	FORCE MAIN (OL "D")
FORCE MAIN (OL "D")	FORCE MAIN (OL "D")
CABLE TV	CABLE TV
TELEPHONE	TELEPHONE
GAS (OL "D")	GAS (OL "D")
ELECTRIC	ELECTRIC
WATER	WATER (OL "D")
WATER (OL "D")	WATER (OL "D")
FIBER OPTIC	FIBER OPTIC (OL "D")
FIBER OPTIC (OL "D")	FIBER OPTIC (OL "D")
WELL DRAINAGE	WELL DRAINAGE
UTILITY POLE	UTILITY POLE
TBE TEST HOLE	TBE TEST HOLE

Utilities shown in color on these plans as depicted in the legend have been investigated by TBE Group, Inc in accordance with SUE Industry Standards. All other information shown has been provided to TBE Group, Inc by others. TBE's SUE field investigation was finished on 5/22/09. Changes to utilities after this date may have been made and therefore may result in variances from this plan. Consideration should be given to updating this plan if deemed advisable prior to final design and construction.  
**All sheets are printed in black and white. Color copies are available upon request.**

ALL UTILITIES SHOWN QUALITY LEVEL "B" UNLESS NOTED OTHERWISE.

- Utility Quality Level "A" : Test Hole
- Utility Quality Level "B" : Designating
- Utility Quality Level "C" : Research with Survey
- Utility Quality Level "D" : Records Research

**TBE GROUP, INC.**  
 CIVIL ENGINEERING • TRANSPORTATION • ENVIRONMENTAL  
 PLANNING • UTILITY ENGINEERING/LOCATING

Checked By: \_\_\_\_\_  
 Date: \_\_\_\_\_

TBE Job No. 1109500601-602,603,604,607,608,609
SUE Plan Page: 35 of 35

FILE NAME =	USER NAME =	DESIGNED <i>EG, IP, LP</i>	REVISED
*FILE#		DRAWN <i>KLC</i>	7/28/09 - 8/26/09 ADDED TEST HOLES #60-108
	PLOT SCALE = 1" = 50'	CHECKED <i>JB</i>	REVISED
	PLOT DATE = *DATE*	DATE <i>9/15/09</i>	REVISED

**STATE OF ILLINOIS  
DEPARTMENT OF TRANSPORTATION**

**Mississippi River Bridge Project**

SCALE:      SHEET NO.      STA.      TO STA.

F.A.P. RTE.	SECTION	COUNTY	TOTAL SHEETS	SHEET NO.
	82-2-1LS	St. Clair	71	53
PTB NO. 147-038				
FED. ROAD DIST. NO. ILLINOIS Job No. D-98-061-08				