

DATE	
BY	
PLAN	
NO.	
DATE	
BY	
PLAN	
NO.	
DATE	
BY	
PLAN	
NO.	

DATE	
BY	
PROFILE	
NO.	
DATE	
BY	
PROFILE	
NO.	
DATE	
BY	
PROFILE	
NO.	

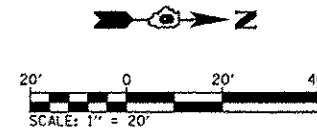

SECTION 09-00018-00-SW
BEGINS STA. 10+00.00

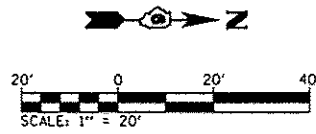
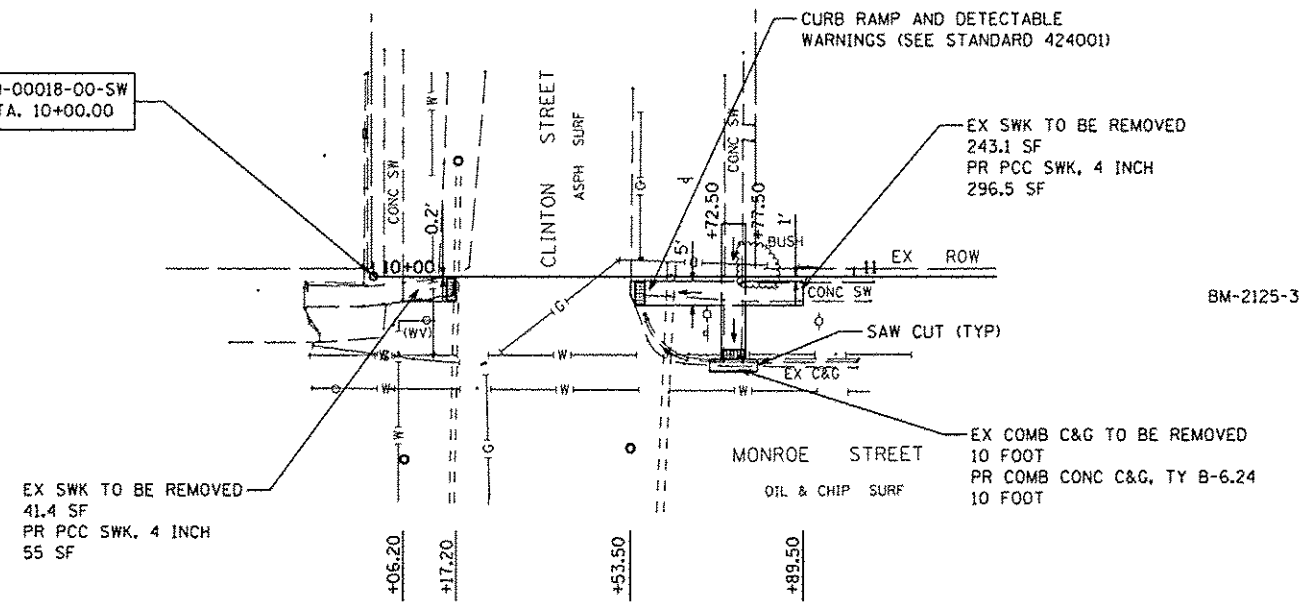

BM-2125-3 - CHISELD "4" BOTTOM W. FLANGE
BOLT OF FH, W. SIDE MONROE STREET, 250'±
N. OF CLINTON STREET. ELEV - 666.34

EX COMB C&G TO BE REMOVED
(THIS CORNER) 17 FOOT
PR COMB CONC C&G, TY B-6.24
(THIS CORNER) 17 FOOT

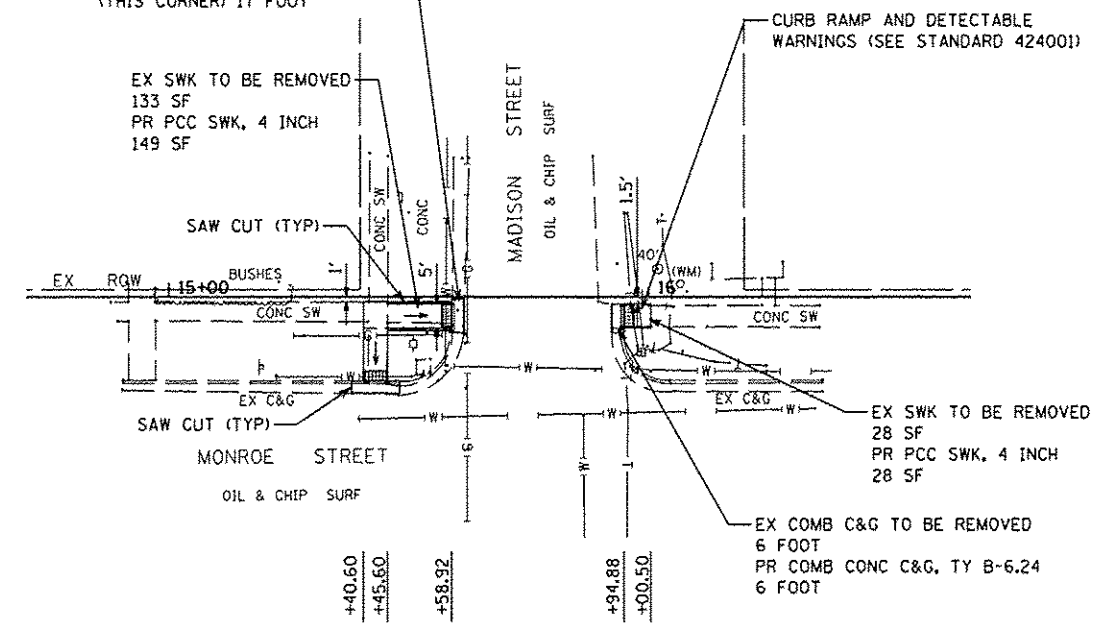

BM-2125-3 - CHISELD "4" BOTTOM W. FLANGE
BOLT OF FH, W. SIDE MONROE STREET, 250'±
N. OF CLINTON STREET. ELEV - 666.34

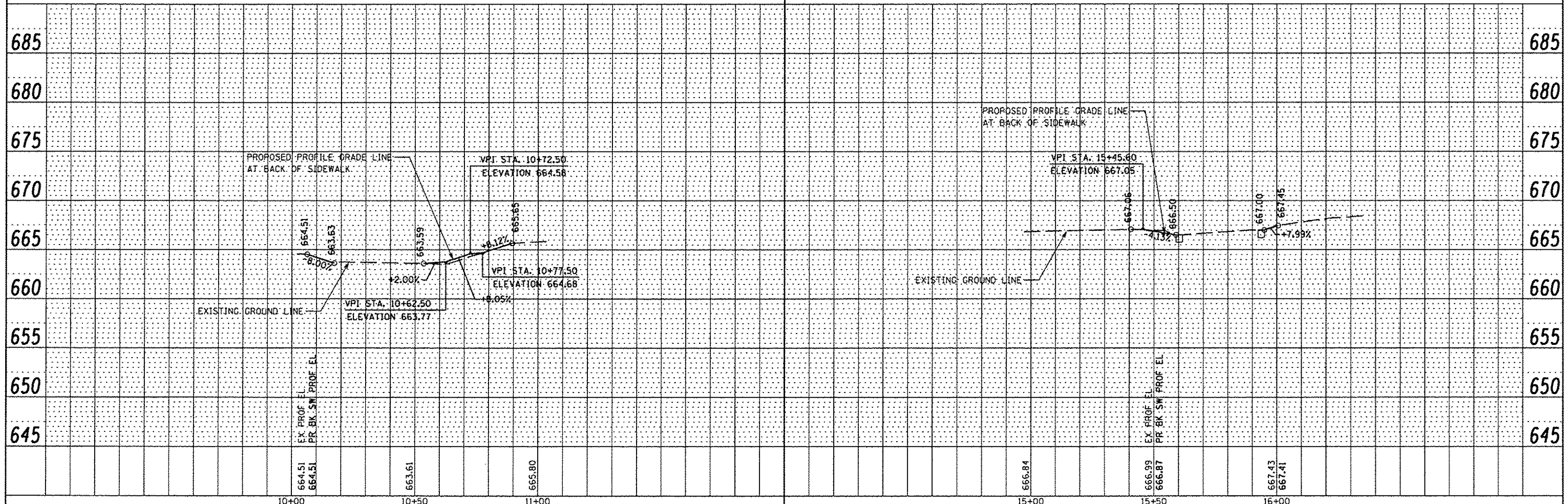

FILE NAME	USER NAME	DESIGNED	REVISED	<p align="center">CITY OF RUSHVILLE SAFE ROUTES TO SCHOOLS PROGRAM</p>	<p align="center">PLAN AND PROFILE MONROE STREET</p>	F.A. RTE.	SECTION	COUNTY	TOTAL SHEETS	SHEET NO.
P:\92125\Design\Design\CADD Sheets\06000-8-shr-plan.rfd		DRAWN - MGM	REVISED -			09-00018-00-SW	SCHUYLER	11	6	
PLOT SCALE = 1/8" = 1' IN.		CHECKED - WJS	REVISED -			CONTRACT NO.				
PLOT DATE = 10/24/2012		DATE - 09/2012	REVISED -			FED. ROAD DIST. NO.		ILLINOIS FED. AID PROJECT		