

STATE OF ILLINOIS
DEPARTMENT OF TRANSPORTATION
DIVISION OF HIGHWAYS
SAFE ROUTES TO SCHOOLS PROGRAM
SIDEWALK IMPROVEMENTS
CITY OF RUSHVILLE
SECTION 09-00018-00-SW
PROJECT - SRTS-4009(060)
SCHUYLER COUNTY

F.A. RITE.	SECTION	COUNTY	TOTAL SHEETS	SHEET NO.
	09-00018-00-SW	SCHUYLER	11	1
FED. ROAD DIST. NO.	ILLINOIS	CONTRACT NO.		

93587

INDEX OF SHEETS

SHEET NO.	ITEM
1	COVER SHEET
2	GENERAL NOTES
3	SUMMARY OF QUANTITIES
4	SCHEDULE OF QUANTITIES
5	ALIGNMENT, TIES & BENCHMARKS
6-8	PLAN AND PROFILE
9	CONSTRUCTION DETAILS
10-11	CROSS SECTIONS

HIGHWAY STANDARDS

- 000001-06 - STANDARD SYMBOLS, ABBREVIATIONS AND PATTERNS
- 424001-07 - PERPENDICULAR CURB RAMPS FOR SIDEWALKS
- 606001-05 - CONCRETE CURB TYPE B AND COMBINATION CONCRETE CURB AND GUTTER
- 701501-06 - URBAN LANE CLOSURE, 2L, 2W, UNDIVIDED
- 701801-05 - SIDEWALK, CORNER OR CROSSWALK CLOSURE
- 701901-02 - TRAFFIC CONTROL DEVICES

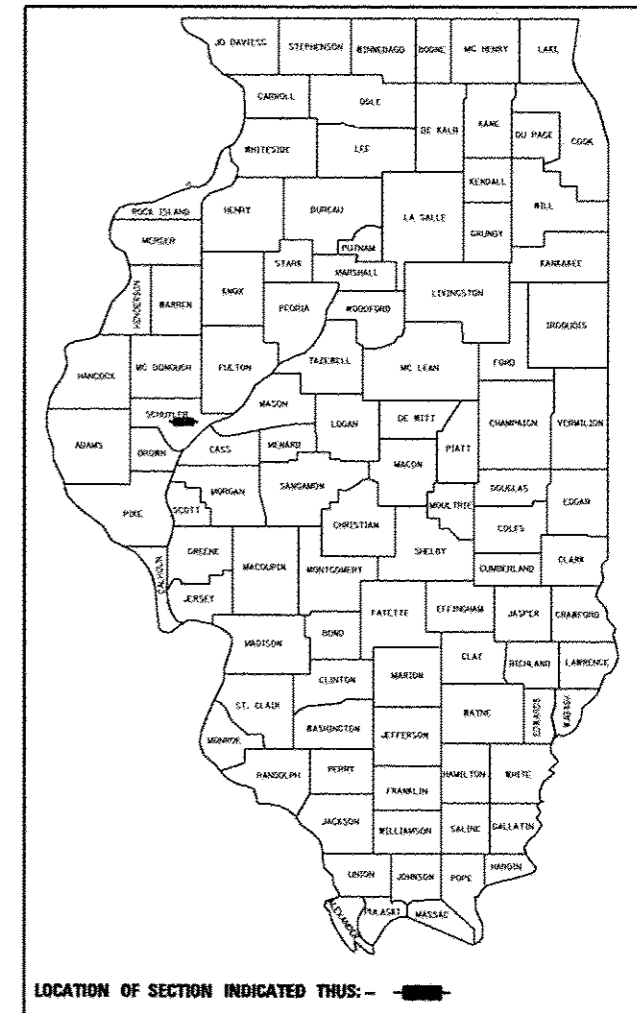

LOCATION OF SECTION INDICATED THUS: - [Symbol] -

C-96-295-10

R 2 W, 4th P.M.

END SECTION 09-00018-00-SW
 MAPLE AVENUE
 STA. 40+58.00

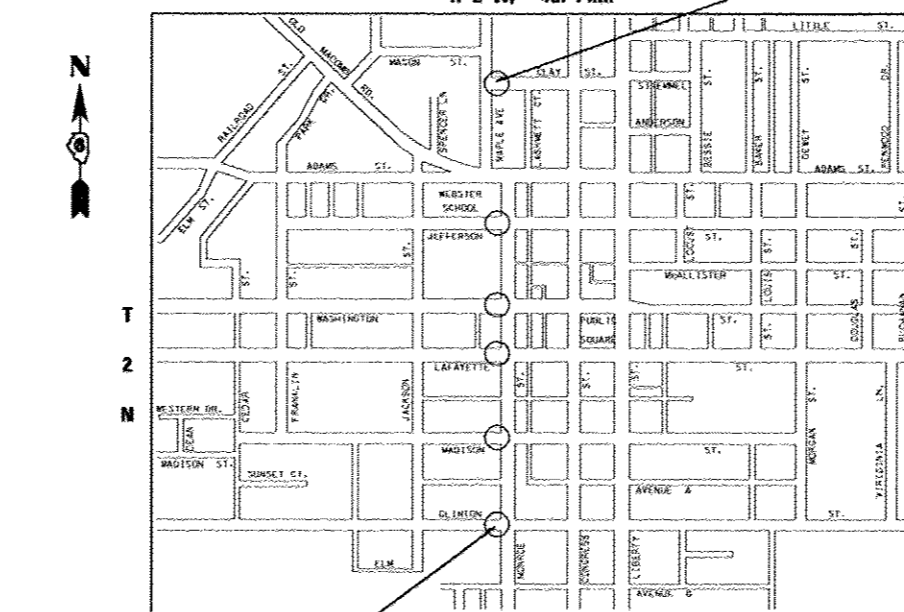

BEGIN SECTION 09-00018-00-SW
 CLINTON STREET
 STA. 10+00.00

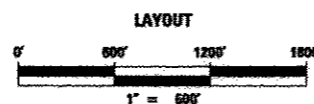

LENGTH OF IMPROVEMENT = 3058.00 FEET = 0.578 MILES
 NET LENGTH OF IMPROVEMENT = 222.34 FEET = 0.042 MILES

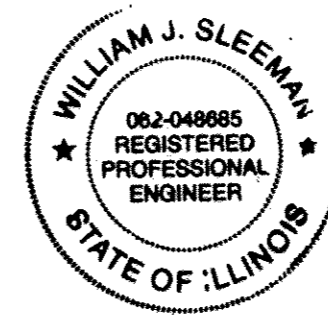

EXPIRES: 11-30-2013

BY: *William J. Sleeman*
 DATE: Oct. 24, 2012

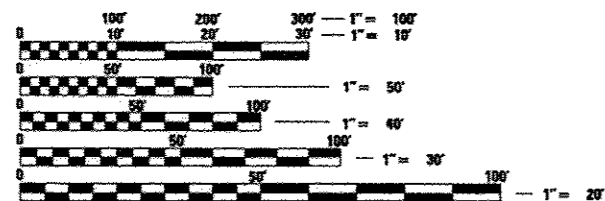

FULL SIZE PLANS HAVE BEEN PREPARED USING STANDARD ENGINEERING SCALES. REDUCED SIZED PLANS WILL NOT CONFORM TO STANDARD SCALES. IN MAKING MEASUREMENTS ON REDUCED PLANS, THE ABOVE SCALES MAY BE USED.

J.U.L.I.E.
 JOINT UTILITY LOCATION INFORMATION FOR EXCAVATION
 1-800-892-0123
 OR 811

STATE OF ILLINOIS
 DEPARTMENT OF TRANSPORTATION
 DIVISION OF HIGHWAYS

APPROVED: *[Signature]* 2012
 MAYOR - CITY OF RUSHVILLE

PASSED: November 9 2012
Terence J. [Signature]
 DISTRICT 6 ENGINEER OF LOCAL ROADS & STREETS

PASSED: November 9 2012
Ron [Signature]
 DISTRICT 6 CONSTRUCTION ENGINEER

Releasing For Bid Based on Limited Review: November 9 2012
[Signature]
 DEPUTY DIRECTOR OF HIGHWAYS, REGION 4 ENGINEER

CONTRACT NO. 93587

BENTON & ASSOCIATES, INC.
 1970 W. Lafayette Ave., Jacksonville IL 62650
 (217) 245-4146 (217) 245-4149 Fax

Kirksville Missouri
 Macomb Illinois

PRINTED BY THE AUTHORITY OF THE STATE OF ILLINOIS

GENERAL NOTES

1. THE LOCATION OF UNDERGROUND UTILITIES SHOWN ON THE PLANS REPRESENTS THE BEST KNOWLEDGE OF THE OWNER AND THE INDICATED ADJUSTMENTS ARE CONSIDERED TO BE REASONABLY ACCURATE. IT SHALL BE THE CONTRACTORS RESPONSIBILITY TO VERIFY LOCATIONS OF UNDERGROUND INSTALLATIONS BEFORE STARTING CONSTRUCTION OPERATIONS. THE CONTRACTOR SHALL INDEMNIFY THE OWNER, ITS OFFICERS AND EMPLOYEES AGAINST ALL CLAIMS DUE TO DAMAGE TO CORPORATE OR PRIVATE PROPERTY RESULTING FROM HIS/HER CONSTRUCTION OPERATIONS AS DESCRIBED IN ARTICLE 107.20 AND 107.26 OF THE STANDARD SPECIFICATIONS FOR ROAD AND BRIDGE CONSTRUCTION.
2. THIS SECTION SHALL BE CONSTRUCTED IN ACCORDANCE WITH THE PLANS, THE "STANDARD SPECIFICATIONS FOR ROAD AND BRIDGE CONSTRUCTION" ADOPTED JANUARY 1, 2012, THE "MANUAL ON UNIFORM TRAFFIC CONTROL DEVICES", THE "SUPPLEMENTAL SPECIFICATIONS AND RECURRING SPECIAL PROVISIONS", AND THE SPECIAL PROVISIONS INCLUDED IN THE PROPOSAL. THE IDOT HIGHWAY STANDARDS LATEST REVISION NUMBERS SHALL APPLY TO THIS PROJECT.
3. THE CONTRACTOR MAY BE REQUIRED TO CONDUCT SOME OF HIS/HER GRADING OPERATIONS AROUND TRANSMISSION POLES AND UNDER TRANSMISSION LINES. THE ADDED COST OF SO DOING SHALL BE INCLUDED WITH THE COST OF THE CONSTRUCTION ITEM FOR WHICH THE GRADING IS BEING ACCOMPLISHED.
4. WHERE SECTION OR SUBSECTION MONUMENTS ARE ENCOUNTERED, THE ENGINEER SHALL BE NOTIFIED BEFORE SUCH MONUMENTS ARE REMOVED. THE CONTRACTOR SHALL PROTECT AND CAREFULLY PRESERVE ALL MONUMENTS UNTIL AN AUTHORIZED SURVEYOR OR AGENT HAS WITNESSED OR OTHERWISE REFERENCED THEIR LOCATION. THE CONTRACTOR WILL BE RESPONSIBLE FOR HAVING AN AUTHORIZED SURVEYOR RE-ESTABLISH ANY SECTION OR SUBSECTION MONUMENTS DESTROYED BY HIS OPERATIONS.
5. ALL ELEVATIONS SHOWN REFER TO THE U.S.G.S. DATUM - NORTH AMERICAN VERTICAL DATUM OF 1988 (NAVD88).
6. ALL EXISTING ROADWAY FEATURES SUCH AS PAVEMENT, CURB, SIDEWALK, DRIVEWAY PAVEMENT, CULVERTS, HEADWALLS, FENCING, RETAINING WALLS, ETC. WHICH INTERFERE WITH THE PROPOSED CONSTRUCTION SHALL BE REMOVED BY THE CONTRACTOR UNLESS NOTED OTHERWISE ON THE PLANS. ALL MISCELLANEOUS FEATURES WHICH ARE TO BE REMOVED AND FOR WHICH THERE IS NO SPECIFIC PAY ITEM, WILL NOT BE MEASURED SEPARATELY FOR PAYMENT. THE COST OF THIS REMOVAL WORK SHALL BE INCLUDED IN THE CONTRACT UNIT PRICES BID FOR SIDEWALK REMOVAL.
7. ALL EXISTING PUBLIC AND MUNICIPAL OWNED UTILITIES REQUIRING ADJUSTMENT WILL BE MADE BY THE UTILITY OWNED INVOLVED UNLESS OTHERWISE NOTED. WHERE NO PROVISIONS HAVE BEEN MADE FOR ADJUSTMENT ON THE PLANS, NO ADDITIONAL COMPENSATION WILL BE ALLOWED DUE TO DELAYS OR INCONVENIENCES CAUSED BY THE SAID UTILITY ADJUSTMENTS.
8. BEFORE STARTING ANY EXCAVATION, THE CONTRACTOR MUST CALL J.U.L.I.E. AT 1-800-892-0123 OR 811 FOR FIELD LOCATIONS OF BURIED ELECTRICAL, TELEPHONE, GAS FACILITIES AND ALL PUBLIC UTILITIES. A 48 HOUR NOTIFICATION IS REQUIRED.
9. IT IS THE CONTRACTORS RESPONSIBILITY TO ASCERTAIN EXISTING FIELD CONDITIONS BEFORE BIDDING ON THIS PROJECT, SPECIFICALLY AS THEY RELATE TO THE LUMP SUM PAY ITEMS.
10. ALL DISTURBED EARTH SURFACES WITHIN THE LIMITS OF THE RIGHT-OF-WAY SHALL BE SEED. THE ESTIMATED AREA OF SEEDING ALONG THE NEW SIDEWALKS AND CURBS IS 0.03 ACRES. THE SEEDING AND FERTILIZER SHALL BE IN ACCORDANCE WITH SECTION 250 OF THE STANDARD SPECIFICATIONS. THE COST OF THIS WORK SHALL BE INCLUDED IN THE COST OF PORTLAND CEMENT CONCRETE SIDEWALK AND NO ADDITIONAL COMPENSATION WILL BE ALLOWED.

11. THE CONTRACTOR SHALL VERIFY ALL DIMENSIONS AND CONDITIONS IN THE FIELD PRIOR TO CONSTRUCTION AND ORDERING OF MATERIALS.
12. REMOVAL OF EXISTING BITUMINOUS SURFACE (OIL AND CHIP), AGGREGATE BASE COURSE AND CONCRETE SURFACE SHALL BE CONSIDERED INCIDENTAL TO COMBINATION CURB AND GUTTER REMOVAL.
13. EXISTING PAVEMENT, SIDEWALK AND CURB AND GUTTER DAMAGED DUE TO THE CONTRACTORS NEGLIGENCE SHALL BE REPLACED AT THE EXPENSE OF THE CONTRACTOR TO THE SATISFACTION OF THE ENGINEER.
14. DURING CONSTRUCTION OPERATIONS, THE CONTRACTOR SHALL COMPLY WITH THE LEGAL LOADING LIMITS ESTABLISHED BY THE CITY. THE CONTRACTOR SHALL BE RESPONSIBLE FOR REPAIRING AND DAMAGE CAUSED BY THE LUGS OR CLEATS ON TREADS OR WHEELS, OR EQUIPMENT, OR BY EXCESSIVE WEIGHTS AND LOADS.
15. THE CONTRACTOR SHALL CONFINE HIS/HER OPERATIONS TO THE AREA LOCATED WITHIN THE CONSTRUCTION LIMITS SHOWN ON THE PLANS. ANY AREA DISTURBED BEYOND THESE LIMITS SHALL BE RESTORED TO ITS ORIGINAL CONDITION AT THE CONTRACTOR'S EXPENSE.
16. DURING CONSTRUCTION OPERATIONS, IF ANY LOOSE MATERIAL IS DEPOSITED IN THE FLOW LINE OF DITCHES, GUTTERS OR DRAINAGE STRUCTURES SO THAT THE NATURAL FLOW OF WATER IS OBSTRUCTED, IT SHALL BE REMOVED AT THE CLOSE OF EACH WORKING DAY. AT THE CONCLUSION OF CONSTRUCTION OPERATIONS, ALL DRAINAGE STRUCTURES SO AFFECTED SHALL BE FREE FROM ALL DEBRIS. THIS WORK SHALL BE INCLUDED IN THE COST OF EARTH EXCAVATION.
17. ALL SAW CUTS THAT ARE INDICATED IN THE PLANS OR REQUIRED TO CONSTRUCT THE IMPROVEMENTS SHALL BE CONSIDERED INCIDENTAL TO THE PROJECT AND NO ADDITIONAL COST WILL BE ALLOWED.

TRAFFIC CONTROL

1. NO OVERNIGHT LANE CLOSURES WILL BE ALLOWED.
2. "ROAD CONSTRUCTION AHEAD" SIGNS SHALL BE PLACED AT THE BEGINNING AND END OF THE PROJECT AND ON THE INTERSECTING SIDE ROADS, AND SHALL BE INCLUDED IN THE TRAFFIC CONTROL PAY ITEMS.
3. FLAGMEN SHALL BE PRESENT DURING CLOSURE OF ANY ADJACENT TRAFFIC LANES AND NO ADDITIONAL COMPENSATION SHALL BE ALLOWED.
4. FOR STABILIZATION, ALL TYPE III BARRICADES SHALL REQUIRE A MINIMUM OF FOUR SANDBAGS PER BARRICADE.

UTILITY COMPANIES IN AREA:

AMEREN CIPS - ELECTRIC
(800) 892-0123

AMEREN CIPS - GAS
(800) 892-0123

FRONTIER COMMUNICATIONS - TELEPHONE
(800) 892-0123

CASS CABLE - CABLE TV
(800) 892-0123

CITY OF RUSHVILLE - SEWER
220 WEST WASHINGTON
RUSHVILLE, IL 62681
(800) 892-0123

CITY OF RUSHVILLE - WATER
220 WEST WASHINGTON
RUSHVILLE, IL 62681
(800) 892-0123

FILE NAME *	USER NAME * #USER#	DESIGNED -	REVISED -	CITY OF RUSHVILLE SAFE ROUTES TO SCHOOLS PROGRAM	GENERAL NOTES	F.A. RTE.	SECTION	COUNTY	TOTAL SHEETS	SHEET NO.
P:\09E2125\Design\Design\CADD Sheets\09E2125-shr-general notes.dgn	DRAWN - MCM	REVISED -				09-00018-00-SW	SCHUYLER	11	2	
PLOT SCALE * 48.0000" / IN.	CHECKED - WJS	REVISED -				CONTRACT NO.				
PLOT DATE * 10/24/2012	DATE - 09/20/12	REVISED -				SCALE:	SHEET NO. OF SHEETS STA. TO STA.	FED. ROAD DIST. NO.	ILLINOIS FED. AID PROJECT	SRTS-400910601

SUMMARY OF QUANTITIES

SUMMARY OF QUANTITIES						
CODE NO.	ITEM	UNITS	TOTAL QUANTITIES	CONSTRUCTION TYPE CODE		
				0021		
42400100	PORTLAND GEMENT CONCRETE SIDEWALK 4 INCH	SQ FT	1,629	1,629		
42400800	DETECTABLE WARNINGS	SQ FT	200	200		
* 44000500	COMBINATION CURB AND GUTTER REMOVAL	FOOT	157	157		
* 44000600	SIDEWALK REMOVAL	SQ FT	1,426	1,426		
* 60603800	COMBINATION CONCRETE CURB AND GUTTER, TYPE B-6.12	FOOT	20	20		
* 60604400	COMBINATION CONCRETE CURB AND GUTTER, TYPE B-6.18	FOOT	21	21		
* 60605000	COMBINATION CONCRETE CURB AND GUTTER, TYPE B-6.24	FOOT	116	116		
67100100	MOBILIZATION	L SUM	1	1		
* Z0013798	CONSTRUCTION LAYOUT	L SUM	1	1		
* X7010216	TRAFFIC CONTROL AND PROTECTION, (SPECIAL)	L SUM	1	1		

* SPECIAL PROVISION

FILE NAME =	USER NAME = USER1	DESIGNED -	REVISED -	CITY OF RUSHVILLE SAFE ROUTES TO SCHOOLS PROGRAM	SUMMARY OF QUANTITIES			F.A. RTE.	SECTION	COUNTY	TOTAL SHEETS	SHEET NO.
P:\179\2125\Design\Design\CADD Sheets\05	803-rht-SDG.dgn	DRAWN - MGM	REVISED -					09-00018-00-SW	SCHUYLER	11	3	
	PLOT SCALE = 40.00000' / IN.	CHECKED - WJS	REVISED -		CONTRACT NO.							
	PLOT DATE = 10/24/2012	DATE = 09/20/12	REVISED -		SCALE:	SHEET NO. OF SHEETS	STA. TO STA.	FED. ROAD DIST. NO.	ILLINOIS FED. AID PROJECT	SRTS-40090601		

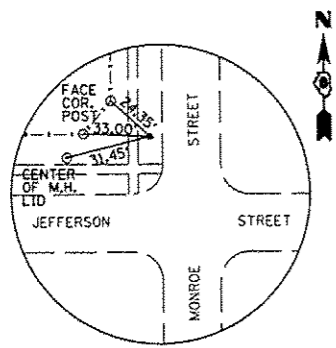

CONTROL POINT #1
IRON ROD

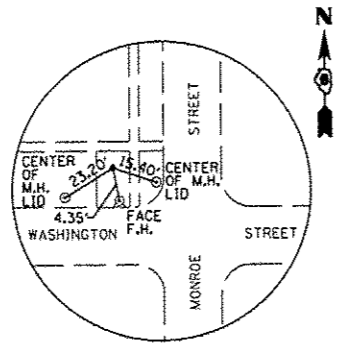

CONTROL POINT #2
IRON ROD

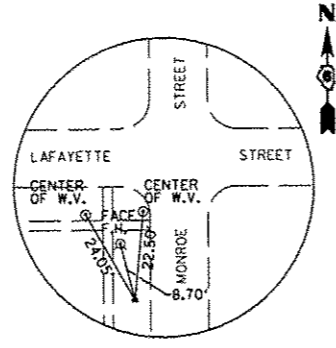

CONTROL POINT #3
IRON ROD

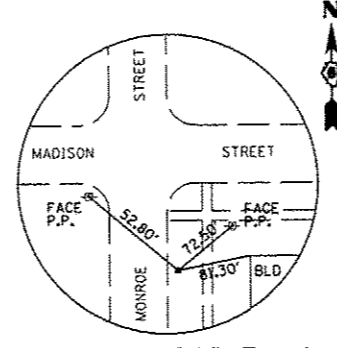

CONTROL POINT #4
IRON ROD

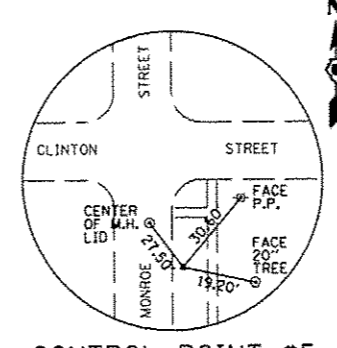

CONTROL POINT #5
IRON ROD

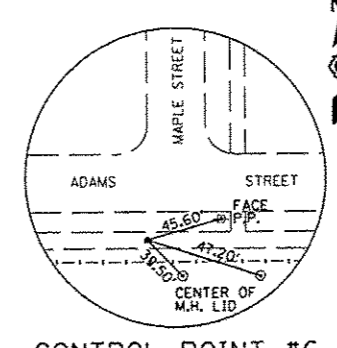

CONTROL POINT #6
MAG NAIL

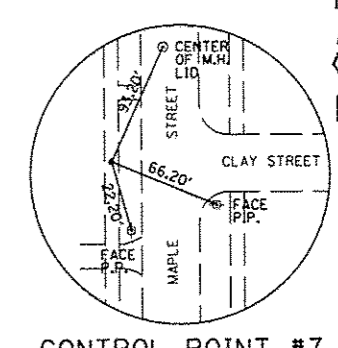

CONTROL POINT #7
MAG NAIL

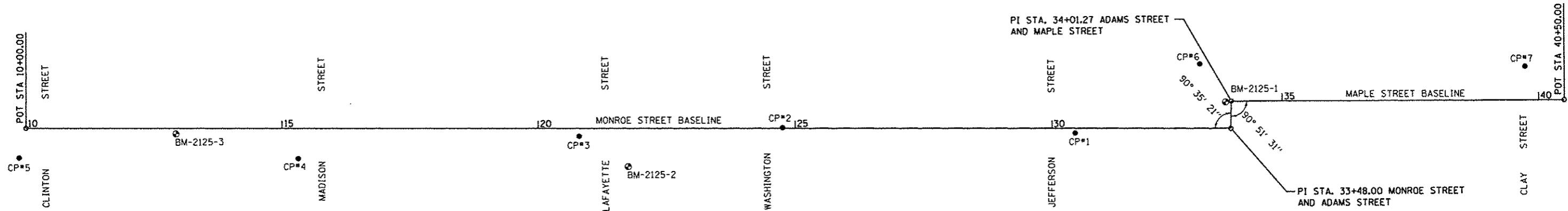

GROUND COORDINATES

DESCRIPTION	POINT NO.	NORTHING	EASTING
CONTROL POINT			
	1	1259065.623	2185293.550
	2	1258496.481	2185278.168
	3	1258100.333	2185291.908
	4	1257552.149	2185331.174
	5	1257007.377	2185325.876
	6	1259309.488	2185160.175
	7	1259942.226	2185169.038
MONROE STREET			
POT STA. 10+00		1257020.840	2185268.235
POT STA. 11+00		1257120.837	2185269.007
POT STA. 15+00		1257520.825	2185272.094
POT STA. 16+00		1257620.822	2185272.866
POT STA. 20+50		1258070.809	2185276.340
POT STA. 22+00		1258220.804	2185277.497
POT STA. 24+00		1258420.798	2185279.041
POT STA. 25+00		1258520.795	2185279.813
POT STA. 29+00		1258920.783	2185282.900
POT STA. 31+00		1259120.777	2185284.444
PI STA. 33+48		1259368.770	2185286.358
MAPLE STREET			
PI STA. 34+01.27		1034431.447	2408903.362
POT STA. 39+00		1259868.454	2185234.600
POT STA. 40+50		1260018.454	2185235.053

BM-2125-1
"M" IN MUELLER, TOP FLANGE OF F. HYDRANT,
N.E. COR. OF ADAMS STREET AND MAPLE STREET
ELEVATION 675.62

BM-2125-2
CHISELED "□" S. CORNER 2x2 CONC. LIGHT
POLE BASE FOR "FAMILY DOLLAR", N.E. CORNER
MONROE STREET AND LAFAYETTE STREET
ELEVATION 672.79

BM-2125-3
CHISELED "4" BOTTOM W. FLANGE BOLT OF F. HYDRANT,
W. SIDE OF MONROE STREET, 250'± N. OF CLINTON STREET
ELEVATION 666.34

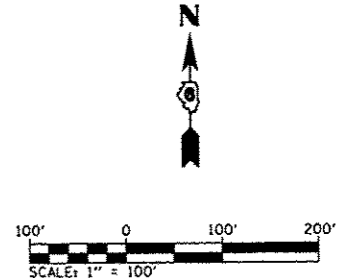

FILE NAME *	USER NAME * #USER*	DESIGNED -	REVISED -
P:\09\2125\Design\Design\CADD Sheets\09-sh1-ATB.dgn		DRAWN - MGM	REVISED -
		CHECKED - WJS	REVISED -
		DATE - 09/2012	REVISED -

**CITY OF RUSHVILLE
SAFE ROUTES TO SCHOOLS PROGRAM**

ALIGNMENT, TIES & BENCHMARKS			
SCALE:	SHEET NO.	OF SHEETS	STA. TO STA.

F.A. RTE.	SECTION	COUNTY	TOTAL SHEETS	SHEET NO.
	09-00018-00-SW	SCHUYLER	11	5
CONTRACT NO.			SRTS-40090601	

DATE	
BY	
PLAN	
REVISION	
NO.	
DATE	
BY	
PLAN	
REVISION	
NO.	
DATE	
BY	
PLAN	
REVISION	
NO.	

DATE	
BY	
PROFILE	
REVISION	
NO.	
DATE	
BY	
PROFILE	
REVISION	
NO.	

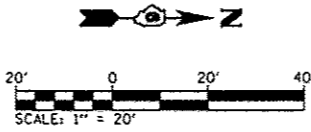

SECTION 09-00018-00-SW
BEGINS STA. 10+00.00

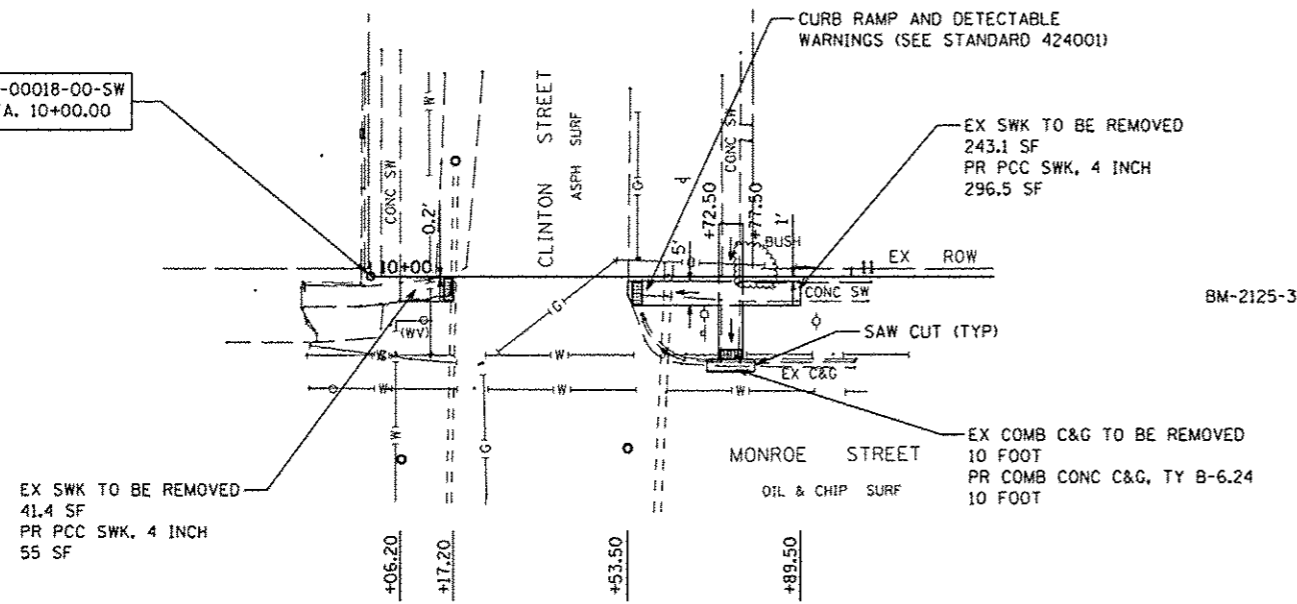

BM-2125-3 - CHISELD "4" BOTTOM W. FLANGE
BOLT OF FH, W. SIDE MONROE STREET, 250'±
N. OF CLINTON STREET. ELEV - 666.34

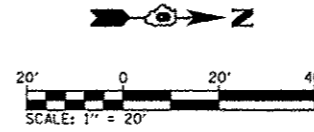

EX COMB C&G TO BE REMOVED
(THIS CORNER) 17 FOOT
PR COMB CONC C&G, TY B-6.24
(THIS CORNER) 17 FOOT

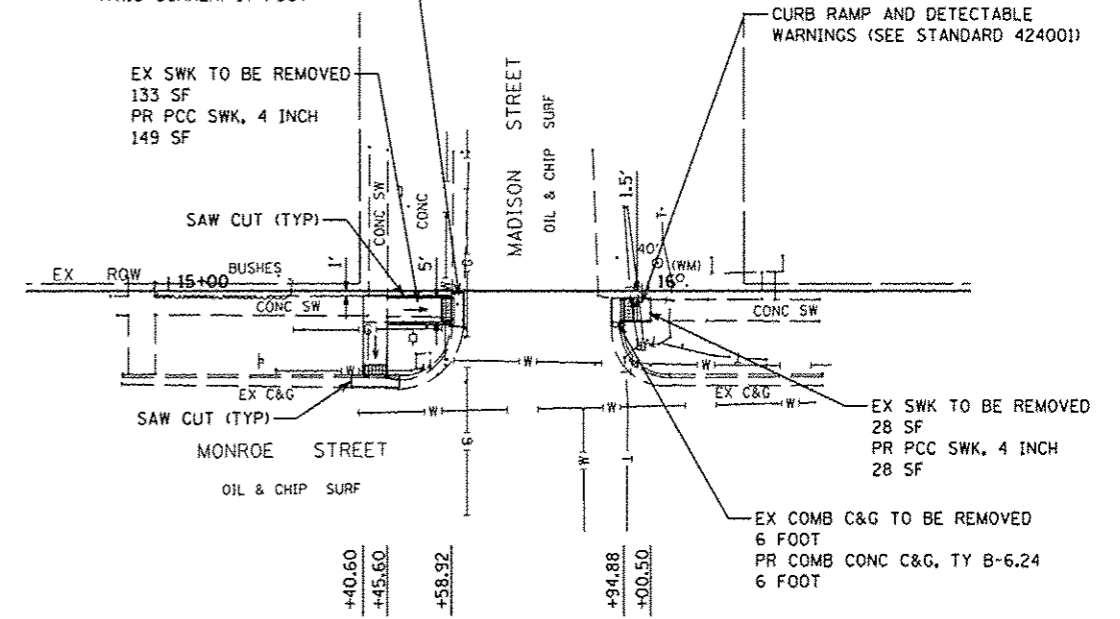

BM-2125-3 - CHISELD "4" BOTTOM W. FLANGE
BOLT OF FH, W. SIDE MONROE STREET, 250'±
N. OF CLINTON STREET. ELEV - 666.34

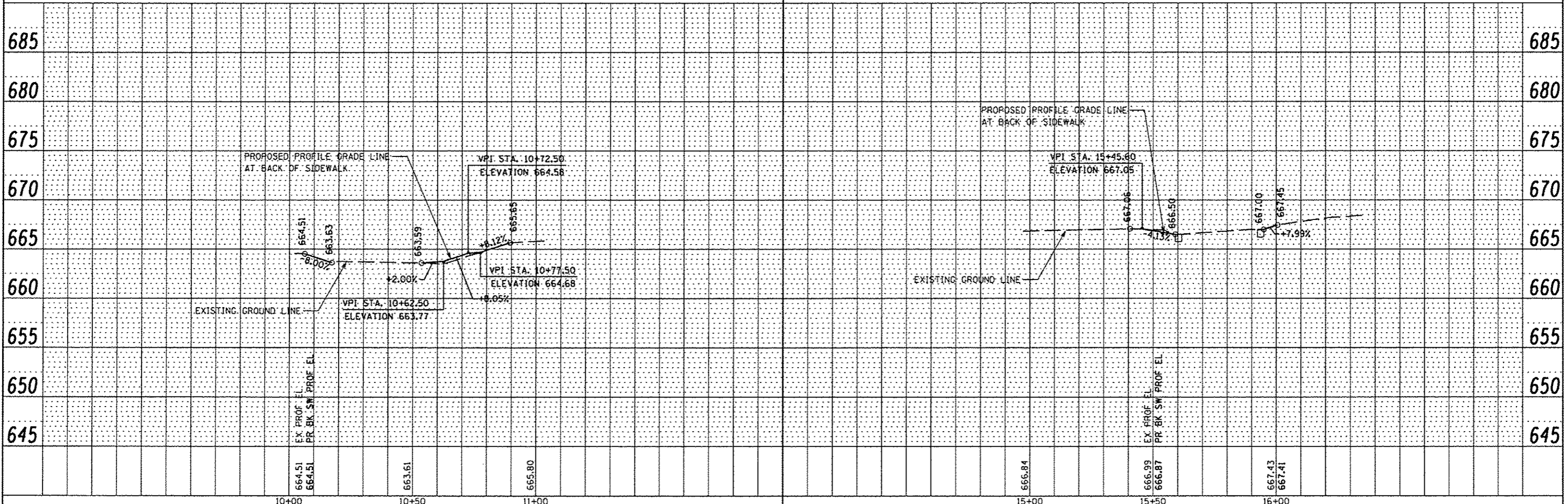

FILE NAME	USER NAME	DESIGNED	REVISED	<p align="center">CITY OF RUSHVILLE SAFE ROUTES TO SCHOOLS PROGRAM</p>	<p align="center">PLAN AND PROFILE MONROE STREET</p>	F.A. RTE.	SECTION	COUNTY	TOTAL SHEETS	SHEET NO.
P:\92125\Design\Design\CADD Sheets\06000-8-shr-plan.rfd		DRAWN - MGM	REVISED -			09-00018-00-SW	SCHUYLER	11	6	
PLOT SCALE = 1/8" = 1' IN.		CHECKED - WJS	REVISED -			CONTRACT NO.				
PLOT DATE = 10/24/2012		DATE - 09/2012	REVISED -			FED. ROAD DIST. NO.		ILLINOIS FED. AID PROJECT		

DATE	
BY	
REVISIONS	
PROPOSED	
PLOTTED	
GRADES CHECKED	
ALIGNMENT CHECKED	
NO. OF SHEETS	
NOTE BOOK	
NO.	
FILE NAME	
PLAN	

DATE	
BY	
REVISIONS	
PROPOSED	
PLOTTED	
GRADES CHECKED	
STRUCTURE NOTATIONS	
NO. OF SHEETS	
NOTE BOOK	
NO.	
PROFILE	

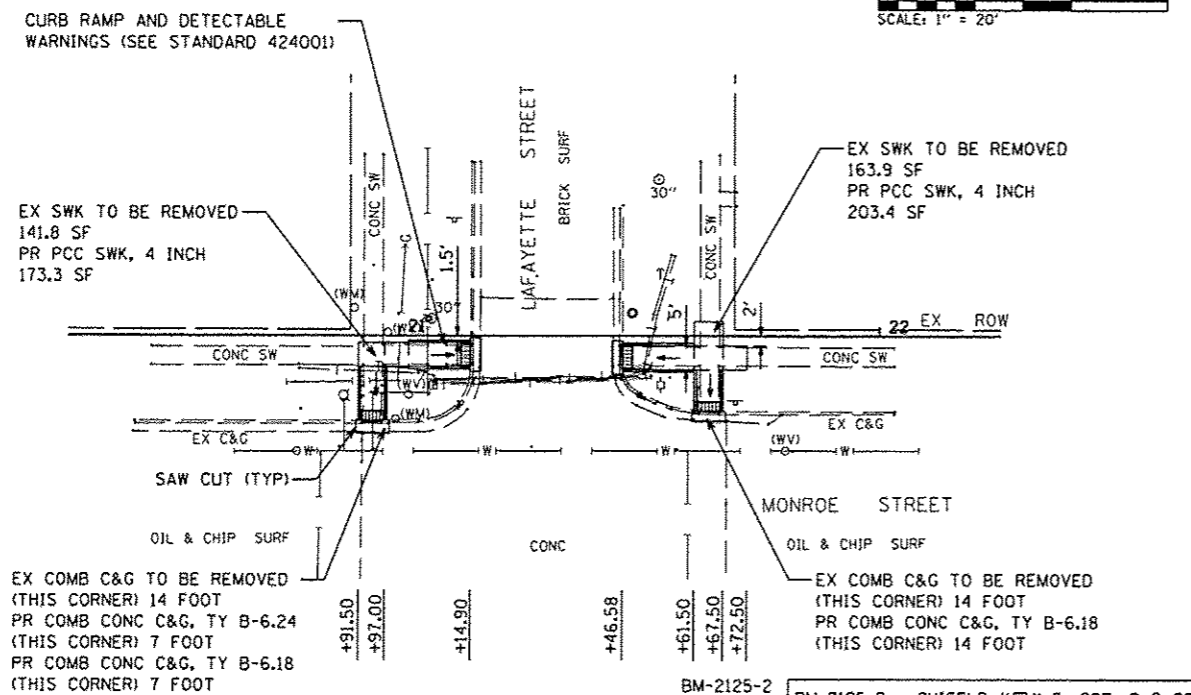

BM-2125-2
 BM-2125-2 - CHISELD "□" S. COR. 2x2 CONC.
 L.P. BASE FOR "FAMILY DOLLAR", N.E. COR.
 MONROE STREET AND LAFAYETTE STREET.
 ELEV - 672.79

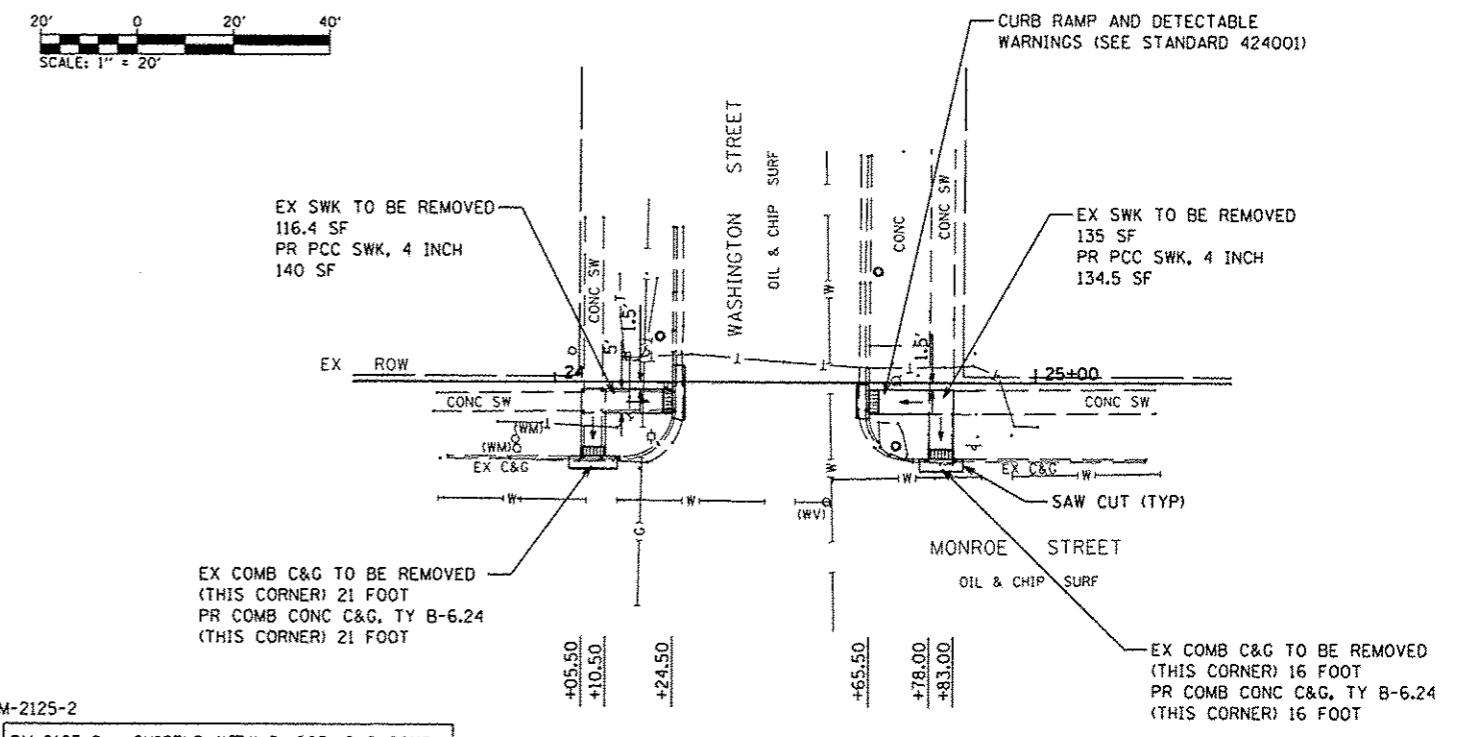

BM-2125-2
 BM-2125-2 - CHISELD "□" S. COR. 2x2 CONC.
 L.P. BASE FOR "FAMILY DOLLAR", N.E. COR.
 MONROE STREET AND LAFAYETTE STREET.
 ELEV - 672.79

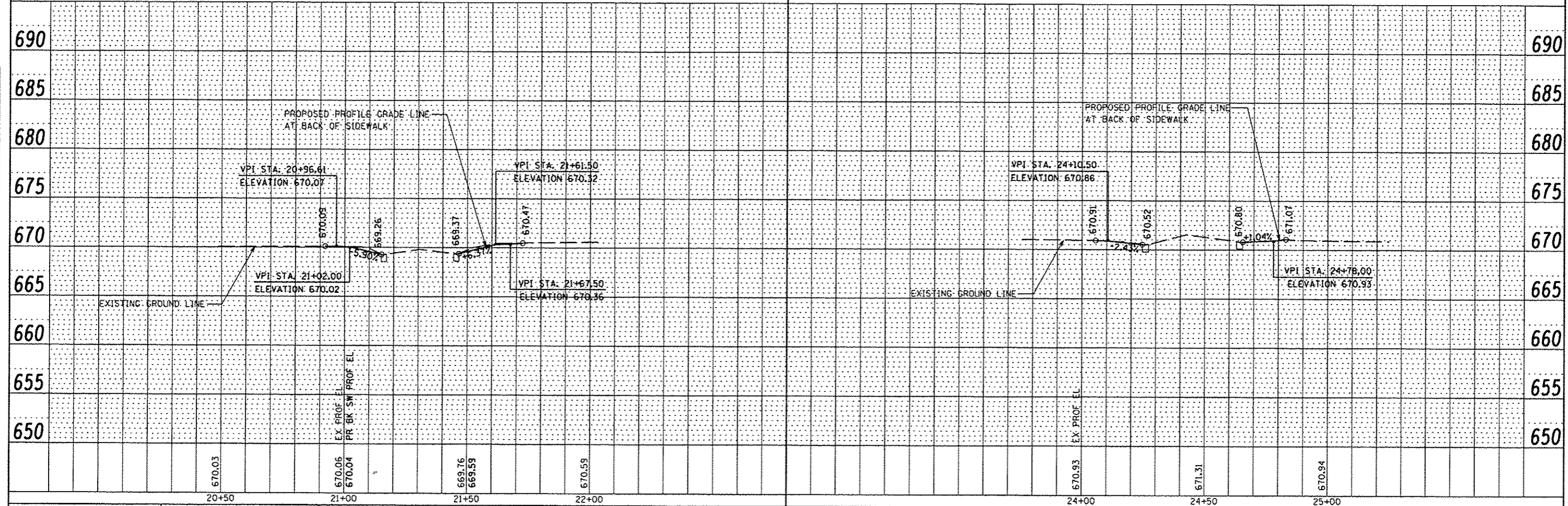

FILE NAME * P:\09E2125\Design\Design\CADD Sheets\06800-B-shs-plotpr.f.dgn	USER NAME * USER*	DESIGNED -	REVISED -	CITY OF RUSHVILLE SAFE ROUTES TO SCHOOLS PROGRAM	PLAN AND PROFILE MONROE STREET		F.A. RTE.	SECTION	COUNTY	TOTAL SHEETS	SHEET NO.
PLOT SCALE * 40.0000 "/> IN.	DRAWN - MCM	CHECKED - WJS	REVISED -		SCALE: 1" = 20'	SHEET NO. OF SHEETS	STA. TO STA.	09-00018-00-SW	SCHUYLER	11	7
PLOT DATE * 10/24/2012	DATE - 09/2012	REVISED -	REVISED -				CONTRACT NO.		SRTS-400910601		
							FED. ROAD DIST. NO.		ILLINOIS FED. AID PROJECT		

DATE	
BY	
REVISIONS	
NO.	
DESCRIPTION	
DATE	
BY	
DATE	

CURB RAMP AND DETECTABLE WARNINGS (SEE STANDARD 424001)

EX SWK TO BE REMOVED
154 SF
PR PCC SWK, 4 INCH
154.1 SF

EX COMB C&G TO BE REMOVED
(THIS CORNER) 19 FOOT
PR COMB CONC C&G, TY B-6.24
(THIS CORNER) 19 FOOT

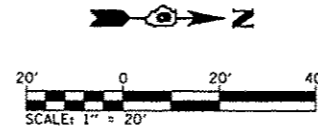
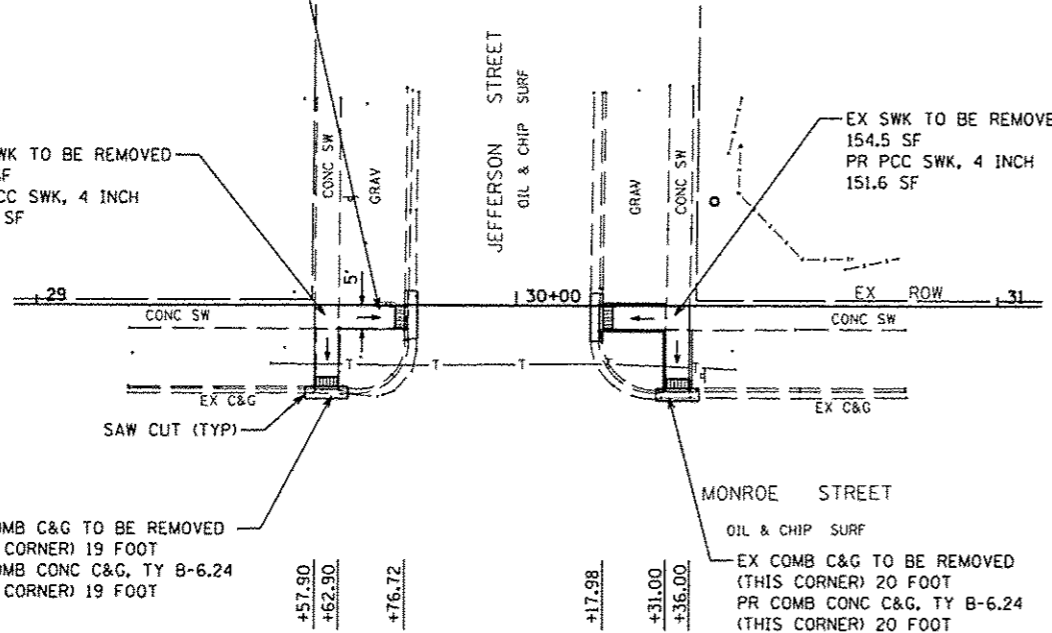

BM-2125-1

BM-2125-1 - "M" IN "MUELLER" TOP FLANGE OF
FH, N.E. COR. ADAMS STREET AND MAPLE STREET.
ELEV - 675.62

DATE	
BY	
REVISIONS	
NO.	
DESCRIPTION	
DATE	
BY	
DATE	

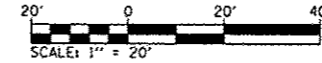

BM-2125-1

BM-2125-1 - "M" IN "MUELLER" TOP FLANGE OF
FH, N.E. COR. ADAMS STREET AND MAPLE STREET.
ELEV - 675.62

EX SWK TO BE REMOVED
50 SF
PR PCC SWK, 4 INCH
62.5 SF

EX COMB C&G TO BE REMOVED
(THIS CORNER) 10 FOOT
PR COMB CONC C&G, TY B-6.12
(THIS CORNER) 10 FOOT

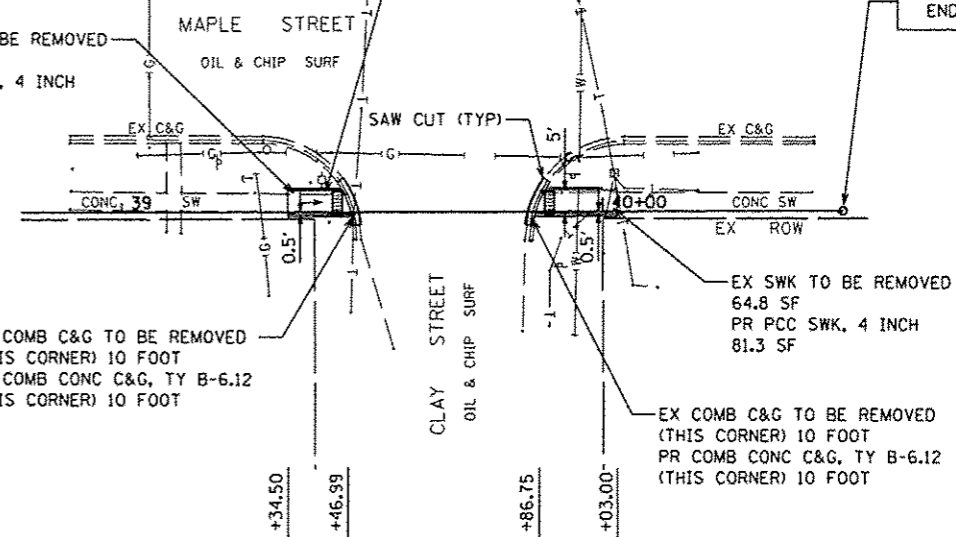

SECTION 09-00018-00-SW
ENDS STA. 40+50.00

CURB RAMP AND DETECTABLE WARNINGS (SEE STANDARD 424001)

DATE	
BY	
REVISIONS	
NO.	
DESCRIPTION	
DATE	
BY	
DATE	

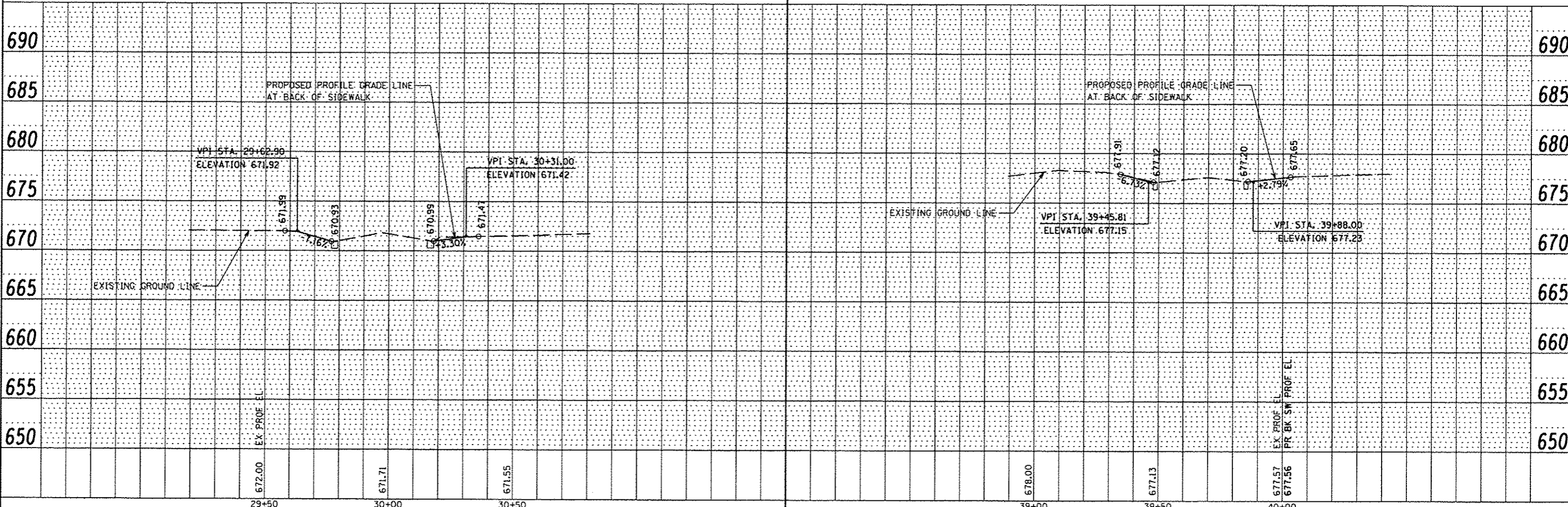

FILE NAME * P:\09E2125\Design\Design\CADD Sheets\06008-8-shr-planprf.dgn	USER NAME * #USER*	DESIGNED - MCM	REVISED -	<p align="center">CITY OF RUSHVILLE SAFE ROUTES TO SCHOOLS PROGRAM</p>	<p align="center">PLAN AND PROFILE MONROE STREET AND MAPLE STREET</p>			<table border="1"> <tr><td>F.A. RTE.</td><td>SECTION</td><td>COUNTY</td><td>TOTAL SHEETS</td><td>SHEET NO.</td></tr> <tr><td></td><td>09-00018-00-SW</td><td>SCHUYLER</td><td>11</td><td>8</td></tr> </table>		F.A. RTE.	SECTION	COUNTY	TOTAL SHEETS	SHEET NO.		09-00018-00-SW	SCHUYLER	11	8
F.A. RTE.	SECTION	COUNTY	TOTAL SHEETS		SHEET NO.														
	09-00018-00-SW	SCHUYLER	11		8														
PLOT SCALE = 40.0000 / IN.	CHECKED - WJS	REVISOR -	REVISIONS -		SCALE: 1" = 20'	SHEET NO.	OF SHEETS	STA.	TO STA.	FED. ROAD DIST. NO.	ILLINOIS FED. AID PROJECT	SRTS-4009060							
PLOT DATE = 10/24/2012	DATE - 09/2012	REVISOR -	REVISIONS -																

- ① EXISTING CONCRETE SIDEWALK (TO BE REMOVED UNLESS NOTED OTHERWISE)
- ② PROPOSED PORTLAND CEMENT CONCRETE SIDEWALK, 4 INCH
- ③ PROPOSED FINE AGGREGATE SUBBASE, 2" (COST TO BE INCLUDED IN PCC SIDEWALK)
- ④ CROSS SLOPE SHALL BE 1.5% NOMINAL (2% MAX) UNLESS OTHERWISE SHOWN

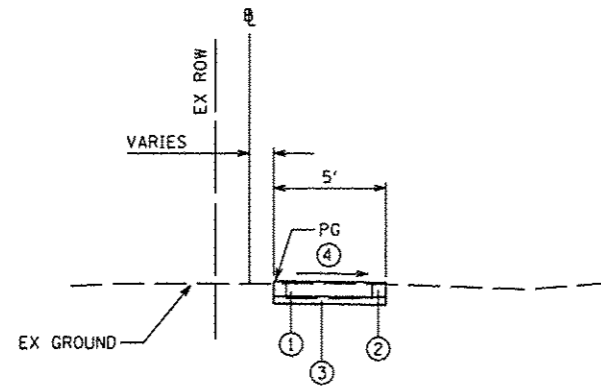

TYPICAL SIDEWALK SECTION
(EXCEPT TRANSITIONS)

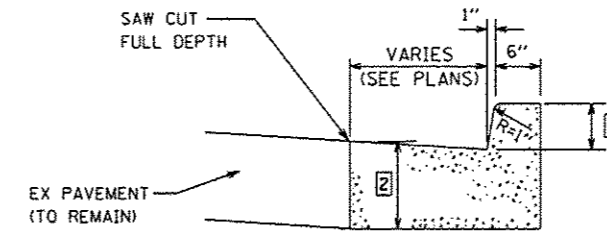

NOTE:

- 1 MATCH HEIGHT OF EX CURB AND GUTTER.
- 2 THICKNESS VARIES. MATCH EX. PAVEMENT (TO REMAIN). MINIMUM THICKNESS OF 9".

TYPICAL COMBINATION CURB AND GUTTER SECTION

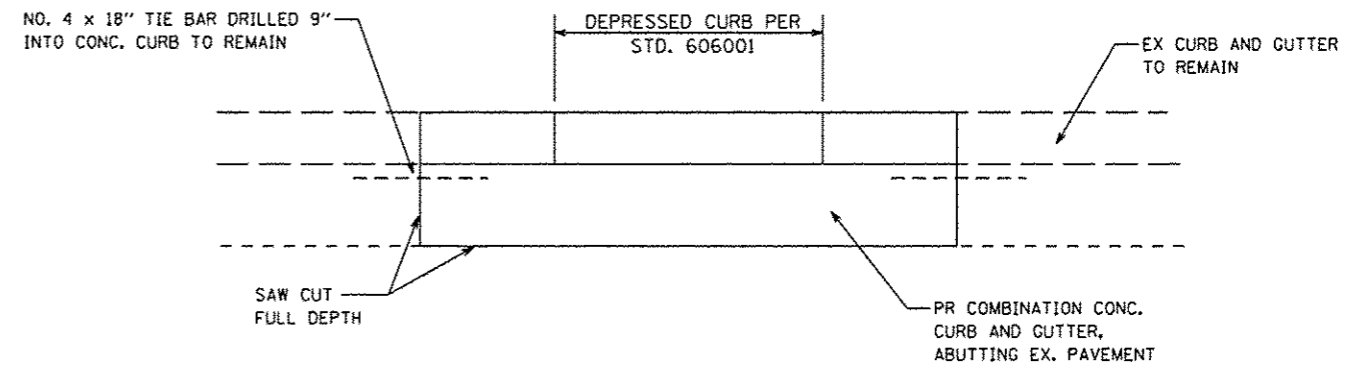

PLAN COMBINATION CURB AND GUTTER

FILE NAME *	USER NAME * #USER*	DESIGNED -	REVISED -	CITY OF RUSHVILLE SAFE ROUTES TO SCHOOLS PROGRAM	CONSTRUCTION DETAILS			F.A. RTE.	SECTION	COUNTY	TOTAL SHEETS	SHEET NO.
P:\0902120\Design\Design\CADD Sheets\0609-shit-const details.dgn		DRAWN - MCM	REVISED -					09-00018-00-SW	SCHUYLER	11	9	
	PLOT SCALE > 40.0000 * / IN.	CHECKED - WJS	REVISED -		CONTRACT NO.							
	PLOT DATE = 10/24/2012	DATE - 09/2012	REVISED -		SCALE: NTS	SHEET NO.	OF SHEETS	STA.	TO STA.	FED. ROAD DIST. NO.	ILLINOIS FED. AID PROJECT	SRTS-40090601

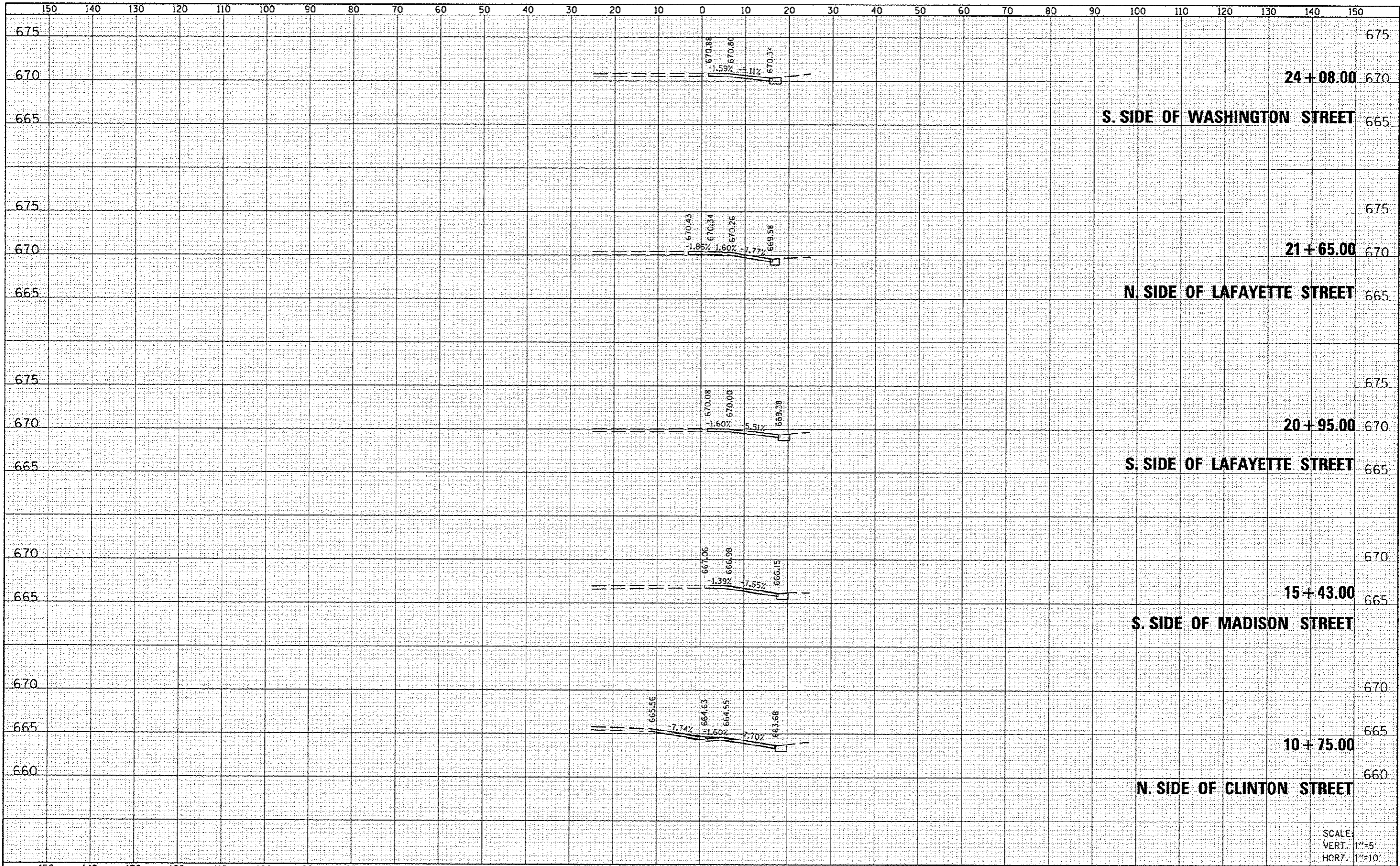

DATE	
BY	
DESIGNED	
PLOTTED	
TEMPLATE	
AREAS	
AREAS CHECKED	
NO.	

DATE	
BY	
DESIGNED	
PLOTTED	
TEMPLATE	
AREAS	
AREAS CHECKED	
NO.	

FILE NAME = P:\09E2125\Design\Design\CADD Sheets\06018-11	USER NAME = USER	DESIGNED -	REVISED -	CITY OF RUSHVILLE SAFE ROUTES TO SCHOOLS PROGRAM	MONROE STREET CROSS SECTIONS				F.A. RTE.	SECTION	COUNTY	TOTAL SHEETS	SHEET NO.
		DRAWN - MCM	REVISED -		SCALE: 1"=5'	SHEET NO. OF SHEETS	STA. 10+75.00 TO STA. 24+08.00	09-00018-00-SW	SCHUYLER	11	10		
		CHECKED - WJS	REVISED -										
		DATE - 09/20/12	REVISED -										

SCALE:
VERT. 1"=5'
HORZ. 1"=10'

93587

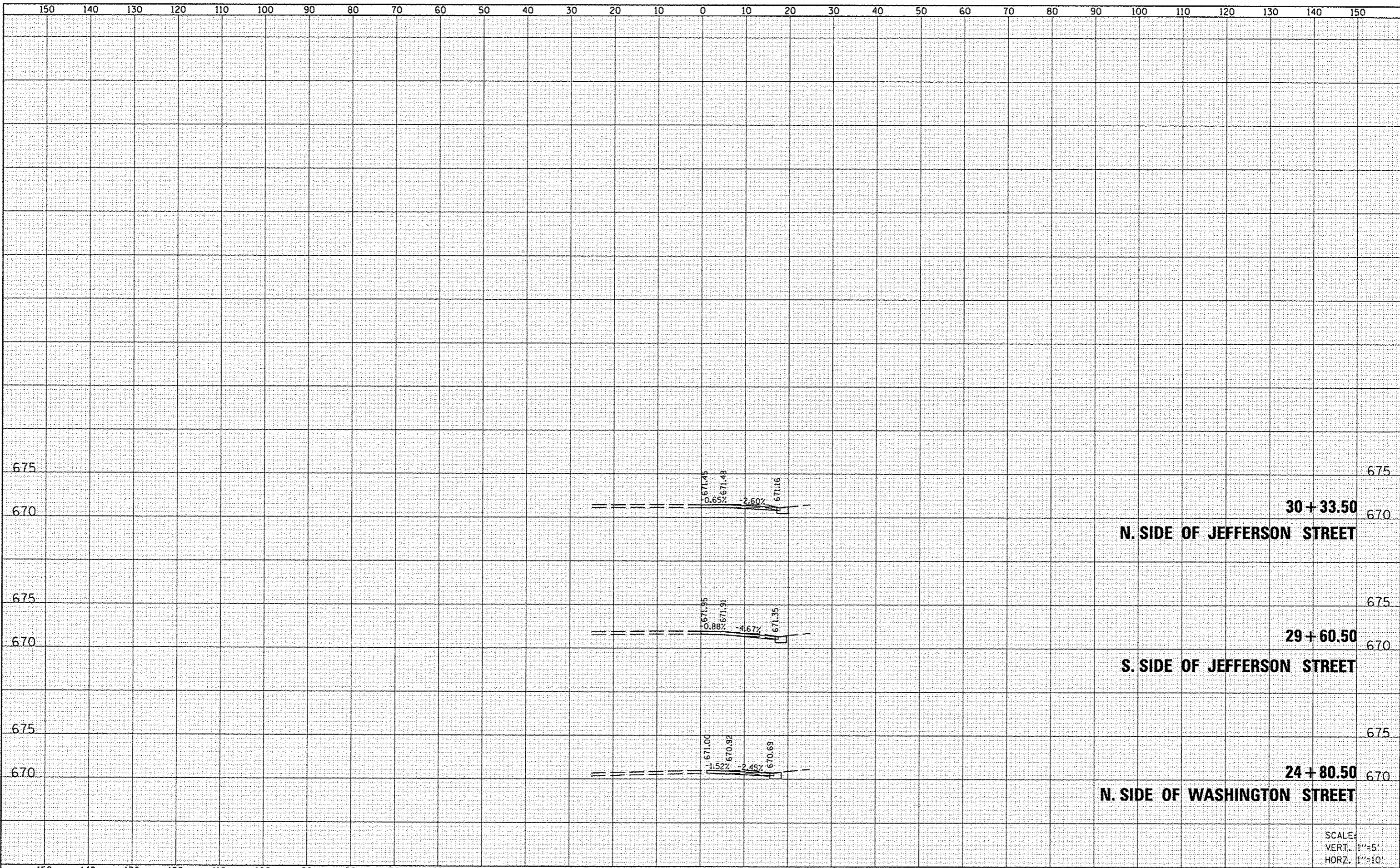

DATE	
BY	
NO.	
FINAL SURVEY	SURVEYED
NOTE BOOK	PLOTTED
	TEMPLATE
	AREAS
	AREAS CHECKED

DATE	
BY	
NO.	
ORIGINAL SURVEY	SURVEYED
NOTE BOOK	PLOTTED
	TEMPLATE
	AREAS
	AREAS CHECKED

SCALE:
VERT. 1"=5'
HORZ. 1"=10'

FILE NAME * P:\09E2125\Design\Design\CADD Sheets\06010-11-11\06010-11-11.dgn	USER NAME * USER	DESIGNED -	REVISED -	CITY OF RUSHVILLE SAFE ROUTES TO SCHOOLS PROGRAM	MONROE STREET CROSS SECTIONS			F.A. RTE.	SECTION	COUNTY	TOTAL SHEETS	SHEET NO.
		DRAWN - MCM	REVISED -		SCALE:	SHEET NO. OF	SHEETS	STA. 24+80.50 TO STA. 30+33.50	09-00018-00-SW	SCHUYLER	11	11
		CHECKED - WJS	REVISED -							CONTRACT NO.		
		DATE - 09/2012	REVISED -						FED. ROAD DIST. NO.	ILLINOIS FED. AID PROJECT	SRTS-40090601	