

029

03-08-2019 LETTING ITEM 029

STATE OF ILLINOIS
DEPARTMENT OF TRANSPORTATION

F.A.P. RTE.	SECTION	COUNTY	TOTAL SHEETS	SHEET NO.
365	2018-092-RS	DUPAGE	21	1
		ILLINOIS	CONTRACT NO. 62H24	

D-91-018-19



FOR INDEX OF SHEETS, SEE SHEET NO. 2

THE PROJECT IS LOCATED IN THE CITY OF AURORA

TRAFFIC DATA:

IL 56 (BUTTERFIELD ROAD):
KANE COUNTY LINE TO EOLA ROAD:
ADT (2016) = 18,800
POSTED SPEED LIMIT = 55 MPH

IL 56 (BUTTERFIELD ROAD):
EOLA ROAD TO CN RR OVERPASS:
ADT (2016) = 22,700
POSTED SPEED LIMIT = 50 MPH

**PROPOSED
HIGHWAY PLANS**
FAP ROUTE 365: IL RTE. 56
KANE COUNTY LINE TO CN RR OVERPASS
SECTION: 2018-092-RS
PROJECT: NHPP-ETYM (738)
RESURFACING (3P), MILLED RUMBLE STRIP;
DUPAGE COUNTY

C-91-217-19



LOCATION MAP
(NOT TO SCALE)

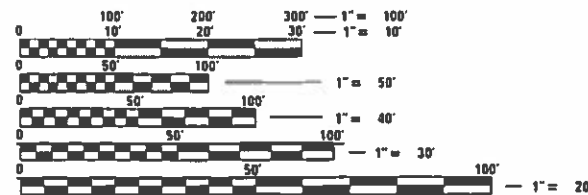

FULL SIZE PLANS HAVE BEEN PREPARED USING STANDARD ENGINEERING SCALES. REDUCED SIZED PLANS WILL NOT CONFORM TO STANDARD SCALES. IN MAKING MEASUREMENTS ON REDUCED PLANS, THE ABOVE SCALES MAY BE USED.

J.U.I.E.
JOINT UTILITY LOCATION INFORMATION FOR EXCAVATION
1-800-892-0123
OR 811

PROJECT BEGINS
STA 20 + 96.7

PROJECT ENDS
STA 152 + 23.6

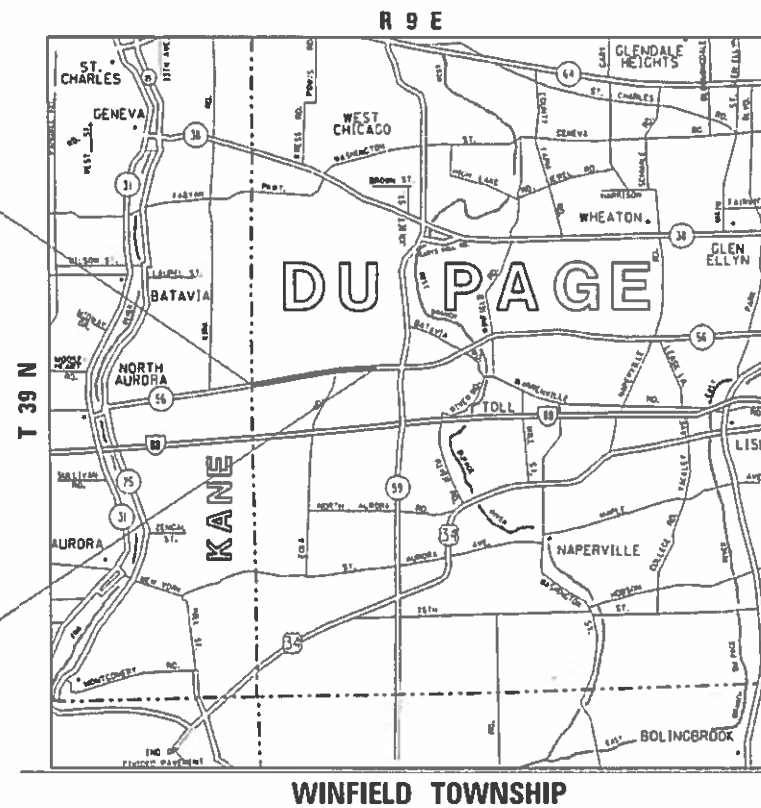

PROJECT ENGINEER KARI SMITH (847) 705-4437
PROJECT MANAGER FAWAD AQUEEL (847) 705-4247

GROSS LENGTH = 13,126.9 FEET = 2.486 MILE
NET LENGTH = 13,126.9 FEET = 2.486 MILE

CONTRACT NO. 62H24

STATE OF ILLINOIS
DEPARTMENT OF TRANSPORTATION

SUBMITTED December 5, 2018

Anthony A. Pringle / OAS
REGIONAL ENGINEER

Feb 1, 2019

Paul P. [Signature]
ENGINEER OF DESIGN AND ENVIRONMENT

Feb 1, 2019

Paul P. [Signature]
DIRECTOR OF HIGHWAYS PROJECT IMPLEMENTATION

PRINTED BY THE AUTHORITY
OF THE STATE OF ILLINOIS

INDEX OF SHEETS

STATE STANDARDS

GENERAL NOTES

SHEET NO.	DESCRIPTION	STANDARD NO.	DESCRIPTION
1	COVER SHEET	000001-07	STANDARD SYMBOLS, ABBREVIATIONS AND PATTERNS
2	INDEX OF SHEETS, STATE STANDARDS & GENERAL NOTES	442201-03	CLASS C AND D PATCHES
3-5	SUMMARY OF QUANTITIES	630001-12	STEEL PLATE BEAM GUARDRAIL
6-7	TYPICAL SECTIONS	635001-02	DELINEATORS
8-12	ROADWAY AND PAVEMENT MARKING PLAN	701001-02	OFF-ROAD OPERATIONS, 2L, 2W, 15' MINIMUM FROM PAVEMENT EDGE
13	DETECTOR LOOP REPLACEMENT PLAN	701006-05	OFF-ROAD OPERATIONS, 2L, 2W, 15' TO 24" FROM PAVEMENT EDGE
14	BD-22: PAVEMENT PATCHING FOR HMA SURFACED PAVEMENT	701011-04	OFF-ROAD MOVING OPERATIONS 2L2W - DAY ONLY
15	BD-24: CURB OR CURB AND GUTTER REMOVAL AND REPLACEMENT	701336-07	LANE CLOSURE 2L2W - WORK AREAS IN SERIES 45 MPH OR MORE
16	BD-32: BUTT JOINT AND HMA TAPER DETAILS	701301-04	LANE CLOSURE, 2L, 2W, SHORT TIME OPERATIONS
17	BD-55: RUMBLE STRIPS FOR CENTERLINE, NON-FREEWAY	701306-04	LANE CLOSURE 2L2W - SLOW MOVING OPERATIONS DAY ONLY 45MPH OR MORE
18	TC-10: TRAFFIC CONTROL AND PROTECTION FOR SIDE ROADS, INTERSECTIONS AND DRIVEWAYS	701311-03	LANE CLOSURE 2L2W - MOVING OPERATIONS DAY ONLY
19	TC-11: TYPICAL APPLICATIONS: RAISED REFLECTIVE PAVEMENT MARKERS (SNOW-PLOW RESISTANT)	701502-09	URBAN LANE CLOSURE 2L2W WITH BIDIRECT LEFT TURN LANE
20	TC-13: DISTRICT ONE TYPICAL PAVEMENT MARKINGS	701701-10	URBAN LANE CLOSURE MULTY LANE INTERSECTION
21	TC-22: ARTERIAL ROAD INFORMATION SIGN	701901-08	TRAFFIC CONTROL DEVICES
		725001-01	OBJECTAND TERMINAL MARKERS
		782006	GUARDRAIL AND BARRIER WALL REFLECTOR MOUNTING DETAILS

- BEFORE STARTING ANY EXCAVATION, THE CONTRACTOR SHALL CALL "JULIE" AT (800) 892-0123 OR 811 FOR FIELD LOCATIONS OF BURIED ELECTRIC, TELEPHONE, AND GAS FACILITIES. (48 HOUR NOTIFICATION REQUIRED)
- THE CONTRACTOR SHALL COORDINATE CONSTRUCTION ACTIVITIES WITH UTILITY COMPANIES AND THE VILLAGE OF AURORA.
- FRAMES AND GRATES ADJUSTMENT OF PRIVATE UTILITIES WITHIN THE LIMITS OF THE IMPROVEMENTS SHALL BE DONE BY THEIR RESPECTIVE OWNERS AND ARE NOT PART OF THIS CONTRACT.
- THE CONTRACTOR SHALL CONTACT DISTRICT ONE ARTERIAL TRAFFIC CONTROL SUPERVISOR AT (847) 705-4470 A MINIMUM OF 72 HOURS IN ADVANCE OF BEGINNING WORK.
- THE CONTRACTOR WILL NOT BE ALLOWED TO SET UP A YARD OR FIELD OFFICE ON STATE PROPERTY WITHOUT THE WRITTEN PERMISSION OF THE DEPARTMENT.
- UNLESS OTHER CONDITIONS WARRANT EXTENDED LANE CLOSURE AS DETERMINED AND APPROVED IN WRITING BY THE RESIDENT ENGINEER OR AS PROVIDED FOR IN THE CONTRACT SPECIFICATIONS, OVERNIGHT CLOSURES SHALL NOT BE ALLOWED FOR REHABILITATION PROJECTS INVOLVING DAYTIME MILLING AND RESURFACING OPERATIONS AND CLASS D PATCHING.
- IT SHALL BE THE CONTRACTOR'S RESPONSIBILITY TO VERIFY ALL DIMENSIONS AND CONDITIONS EXISTING IN THE FIELD PRIOR TO CONSTRUCTION AND ORDERING OF MATERIALS.
- DO NOT SCALE PLANS FOR CONSTRUCTION DIMENSIONS.
- THE CONTRACTOR SHALL BE REQUIRED TO PROVIDE ACCESS TO ABUTTING PROPERTY AT ALL TIMES DURING THE CONSTRUCTION OF THIS PROJECT.
- ALL PAVEMENT PATCHING LOCATIONS WILL BE DETERMINED IN THE FIELD BY THE RESIDENT ENGINEER/TECHNICIAN.
- BUTT JOINTS WILL BE INSTALLED AT THE ENDS OF RESURFACING (WHERE RESURFACING MEETS EXISTING PAVEMENT) IN ACCORDANCE WITH THE "BUTT JOINT AND HMA TAPER DETAILS" SHEET INCLUDED IN THE PLANS, UNLESS OTHERWISE SPECIFIED.
- THE ENGINEER SHALL CONTACT DON CHIARUGI, IDOT'S AREA TRAFFIC FIELD ENGINEER FOR THE WILL COUNTY AREA, VIA E-MAIL AT DON.CHIARUGI@ILLINOIS.GOV A MINIMUM OF TWO (2) WEEKS PRIOR TO THE PLACEMENT OF PERMANENT PAVEMENT MARKINGS.
- BEFORE BEGINNING ANY WORK, THE CONTRACTOR SHALL RETAIN AND RECORD FOR FUTURE REFERENCE, ALL EXISTING PAVEMENT MARKING LINES (AND RAISED REFLECTIVE PAVEMENT MARKERS) IN ORDER THAT THESE LOCATIONS CAN BE RE-ESTABLISHED FOR STRIPING. EXACT LOCATIONS OF ALL PAVEMENT MARKINGS SHALL BE AS DIRECTED BY THE RESIDENT ENGINEER.
- ALL DAMAGE TO EXISTING PAVEMENT MARKINGS OR RAISED REFLECTIVE PAVEMENT MARKERS OUTSIDE THE REMOVAL LINE SHOWN ON THE PLANS SHALL BE REPLACED AT NO ADDITIONAL COST TO THE DEPARTMENT.
- ANY PAVEMENT MARKINGS AND RAISED REFLECTIVE PAVEMENT MARKERS OBLITERATED BY MILLING AND RESURFACING OPERATIONS ON SIDE STREETS AND ENTRANCES SHALL BE REPLACED AND PAID FOR IN KIND.
- PAVEMENT MARKING TAPE, TYPE III SHALL BE USED FOR SHORT TERM PAVEMENT MARKINGS ON ALL FINAL SURFACES.
- ANY LOOSE MATERIAL DEPOSITED IN THE FLOW LINE OF CURB OR DRAINAGE STRUCTURES, WHICH OBSTRUCTS THE NATURAL FLOW OF WATER, SHALL BE REMOVED AT THE CLOSE OF EACH WORKING DAY. PRIOR TO ACCEPTANCE OF THE IMPROVEMENT, ALL DRAINAGE STRUCTURES SHALL BE FREE OF DIRT AND DEBRIS. THIS WORK WILL NOT BE PAID FOR SEPARATELY BUT SHALL BE CONSIDERED AS INCIDENTAL.
- THE CONTRACTOR SHALL CONTACT THE ROADSIDE DEVELOPMENT UNIT AT (847) 705-4171 AT LEAST 2 WEEKS PRIOR TO BEGINNING ANY FORESTRY WORK FOR LAYOUT.
- CONTACT THE ROADSIDE DEVELOPMENT UNIT 72 HOURS PRIOR TO TREE REMOVAL AT (847) 705-4171.

MODEL: Default
 FILE NAME: P:\11108\B&E\BID\NTEC\Illinois.gov\PWD\DOT\Documents\DOT Offices\District 1\Projects\ID1018\1819\CADD\Drawings\ID101819-shr-gemore.dgn

USER NAME = JOHNSTONKD	DESIGNED -	REVISED -	STATE OF ILLINOIS DEPARTMENT OF TRANSPORTATION	INDEX OF SHEETS, STATE STANDARDS & GENERAL NOTES			F.A.P. RTE.	SECTION	COUNTY	TOTAL SHEETS	SHEET NO.
DRAWN -	REVISIED -			IL ROUTE 56 (BUTTERFIELD ROAD)			365	2018-092-R5	DUPAGE	21	2
PLOT SCALE = 100.0000' / in.	CHECKED -	REVISED -		KANE COUNTY LINE TO CN RAILROAD OVERPASS					CONTRACT NO. 62H24		
PLOT DATE = 12/12/2018	DATE -	REVISED -		SCALE:	SHEET	OF	SHEETS	STA.	TO	STA.	ILLINOIS FED. AID PROJECT

URBAN

SUMMARY OF QUANTITIES			TOTAL QUANTITIES	CONSTRUCTION TYPE CODE				
CODE NO	ITEM	UNIT		0005 80% FED 20% STATE				
20101350	TREE PRUNING (OVER 10 INCH DIAMETER)	EACH	16	16				
21101615	TOPSOIL FURNISH AND PLACE, 4"	SO YD	190	190				
25003210	INTERSEEDING, CLASS 2A	ACRE	3.43	3.43				
25200110	SODDING, SALT TOLERANT	SO YD	190	190				
40600290	BITUMINOUS MATERIALS (TACK COAT)	POUND	34640	34640				
40600400	MIXTURE FOR CRACKS, JOINTS, AND FLANGEWAYS	TON	77	77				
40600827	POLYMERIZED LEVELING BINDER (MACHINE METHOD), IL-4.75, N50	TON	2117	2117				
40600982	HOT-MIX ASPHALT SURFACE REMOVAL - BUTT JOINT	SO YD	301	301				
40601005	HOT-MIX ASPHALT REPLACEMENT OVER PATCHES	TON	406	406				
40603565	POLYMERIZED HOT-MIX ASPHALT SURFACE COURSE, MIX "E", N70	TON	5029	5029				
42001300	PROTECTIVE COAT	SO YD	455	455				
44000159	HOT-MIX ASPHALT SURFACE REMOVAL, 2 1/2"	SO YD	51319	51319				

URBAN

SUMMARY OF QUANTITIES			TOTAL QUANTITIES	CONSTRUCTION TYPE CODE				
CODE NO	ITEM	UNIT		0005 80% FED 20% STATE				
44002218	HOT-MIX ASPHALT REMOVAL OVER PATCHES, 4 1/2"	SO YD	1611	1611				
44201785	CLASS D PATCHES, TYPE I, 12 INCH	SO YD	8	8				
44201789	CLASS D PATCHES, TYPE II, 12 INCH	SO YD	218	218				
44201794	CLASS D PATCHES, TYPE III, 12 INCH	SO YD	118	118				
44201796	CLASS D PATCHES, TYPE IV, 12 INCH	SO YD	1267	1267				
48102100	AGGREGATE WEDGE SHOULDER, TYPE B	TON	197	197				
60252800	CATCH BASINS TO BE RECONSTRUCTED	EACH	1	1				
60300105	FRAMES AND GRATES TO BE ADJUSTED	EACH	7	7				
60406100	FRAMES AND LIDS, TYPE 1, CLOSED LID	EACH	1	1				
67000400	ENGINEER'S FIELD OFFICE, TYPE A	CAL MO	6	6				
67100100	MOBILIZATION	L SUM	1	1				
70100460	TRAFFIC CONTROL AND PROTECTION, STANDARD 701306	L SUM	1	1				
70100600	TRAFFIC CONTROL AND PROTECTION, STANDARD 701336	L SUM	1	1				

* = SPECIALTY ITEMS
 △ = NON-PARTICIPATING WORK (100% STATE)

FILE NAME =	USER NAME = JOHNSTONKD	DESIGNED -	REVISED -
pw:\N\LOB\EBID\INT\EG\Illinois.gov\FW\DOT\Documents\DOT	Offices\District\Projects\DI0819\CADD\Design\DI0819	BY	REVISION
	PLOT SCALE = 100,0000' / 1in	CHECKED -	REVISED -
	PLOT DATE = 12/12/2018	DATE -	REVISED -

**STATE OF ILLINOIS
 DEPARTMENT OF TRANSPORTATION**

SUMMARY OF QUANTITIES			
IL ROUTE 56 (BUTTERFIELD ROAD)			
KANE COUNTY LINE TO CN RAILROAD OVERPASS			
SCALE:	SHEET NO.	OF SHEETS	STA. TO STA.

F.A.P. RTE.	SECTION	COUNTY	TOTAL SHEETS	SHEET NO.
365	2018-092-RS	DUPAGE	21	3
FED. ROAD DIST. NO. 1 ILLINOIS FED. AID PROJECT			CONTRACT NO. 62H24	

URBAN

URBAN

SUMMARY OF QUANTITIES			TOTAL QUANTITIES	CONSTRUCTION TYPE CODE				
CODE NO	ITEM	UNIT		0005 80% FED 20% STATE				
70102622	TRAFFIC CONTROL AND PROTECTION, STANDARD 701502	L SUM	1	1				
70102635	TRAFFIC CONTROL AND PROTECTION, STANDARD 701701	L SUM	1	1				
70300100	SHORT TERM PAVEMENT MARKING	FOOT	5692	5692				
70300150	SHORT TERM PAVEMENT MARKING REMOVAL	SO FT	1897	1897				
70300210	TEMPORARY PAVEMENT MARKING LETTERS AND SYMBOLS	SO FT	692	692				
70300220	TEMPORARY PAVEMENT MARKING - LINE 4"	FOOT	49517	49517				
70300240	TEMPORARY PAVEMENT MARKING - LINE 6"	FOOT	3021	3021				
70300250	TEMPORARY PAVEMENT MARKING - LINE 8"	FOOT	150	150				
70300260	TEMPORARY PAVEMENT MARKING - LINE 12"	FOOT	683	683				
70300280	TEMPORARY PAVEMENT MARKING - LINE 24"	FOOT	147	147				
70300520	PAVEMENT MARKING TAPE, TYPE III 4"	FOOT	1423	1423				
* 78000100	THERMOPLASTIC PAVEMENT MARKING - LETTERS AND SYMBOLS	SO FT	692	692				
* 78000200	THERMOPLASTIC PAVEMENT MARKING - LINE 4"	FOOT	54197	54197				

SUMMARY OF QUANTITIES			TOTAL QUANTITIES	CONSTRUCTION TYPE CODE				
CODE NO	ITEM	UNIT		0005 80% FED 20% STATE				
* 78000400	THERMOPLASTIC PAVEMENT MARKING - LINE 6"	FOOT	3021	3021				
* 78000500	THERMOPLASTIC PAVEMENT MARKING - LINE 8"	FOOT	150	150				
* 78000600	THERMOPLASTIC PAVEMENT MARKING - LINE 12"	FOOT	683	683				
* 78000650	THERMOPLASTIC PAVEMENT MARKING - LINE 24"	FOOT	147	147				
* 78100100	RAISED REFLECTIVE PAVEMENT MARKER	EACH	648	648				
78300200	RAISED REFLECTIVE PAVEMENT MARKER REMOVAL	EACH	550	550				
* 88600600	DETECTOR LOOP REPLACEMENT	FOOT	556	556				
K0029614	WEED CONTROL, AQUATIC	GALLON	0.5	0.5				
K0029624	WEED CONTROL, TEASEL	GALLON	0.62	0.62				
X0325222	WEED CONTROL, BASAL TREATMENT	GALLON	3	3				
X0326898	CENTER LINE - RUMBLE STRIP - 16"	FOOT	5510	5510				
X2010350	TREE REMOVAL, ACRES (SPECIAL)	ACRE	1.53	1.53				
X2020110	GRADING AND SHAPING SHOULDERS	UNIT	205	205				

REV. - MS

* = SPECIALTY ITEMS
△ = NON-PARTICIPATING WORK (100% STATE)

FILE NAME =	USER NAME = JOHNSTOWN	DESIGNED -	REVISED -
OFFICES\District\Projects\DI018\B\CAD\Drawings\Design\DI018\		REVISED -	REVISED -
PLOT SCALE = 100,000' / 1" =	CHECKED -	REVISED -	REVISED -
PLOT DATE = 12/12/2018	DATE -	REVISED -	REVISED -

**STATE OF ILLINOIS
DEPARTMENT OF TRANSPORTATION**

**SUMMARY OF QUANTITIES
IL. ROUTE 56 (BUTTERFIELD ROAD)
KANE COUNTY LINE TO CN RAILROAD OVERPASS**

SCALE: SHEET NO. OF SHEETS STA. TO STA.

F.A.P. RTE.	SECTION	COUNTY	TOTAL SHEETS	SHEET NO.
365	2018-092-R5		21	4
FED. ROAD DIST. NO. 1 (ILLINOIS) FED. AID PROJECT			CONTRACT NO. 62H24	

F.A.P. 365 / IL-56 (BUTTERFIELD ROAD)

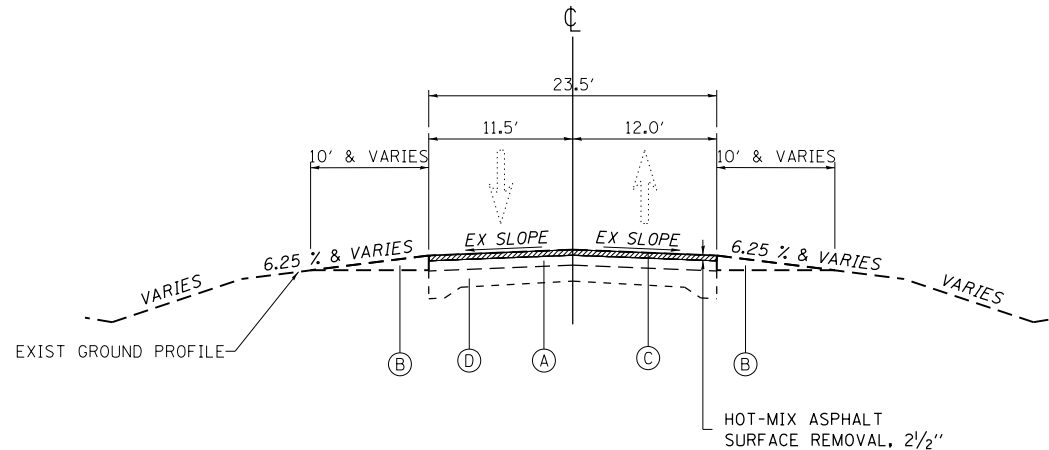

EXISTING TYPICAL SECTION

STA 20+96.7 TO STA 30+35
 STA 43+95 TO STA 56+90
 STA 69+25 TO STA 102+00
 STA 145+00 TO STA 152+23.6

LEGEND - EXISTING:

- (A) HOT MIX ASPHALT SURFACE 4 1/2" ±
- (B) AGGREGATE WEDGE SHOULDER, TYPE B
- (C) HOT MIX ASPHALT SURFACE REMOVAL 2 1/2"
- (D) PORTLAND CONCRETE CEMENT PAVEMENT SUB-BASE, 9"

LEGEND - PROPOSED

- (1) POLYMERIZED HOT-MIX ASPHALT SURFACE COURSE, MIX "E", N70, 1 3/4"
- (2) POLYMERIZED LEVELING BINDER (MACHINE METHOD), IL-4.75, N50, 3/4"
- (3) AGGREGATE WEDGE SHOULDERS, TYPE B
- (4) GRADING AND SHAPING SHOULDERS
- (5) MILLED RUMBLE STRIPES

[1] EXACT LOCATIONS OF GRADING AND SHAPING SHOULDERS AND AGGREGATE WEDGE SHOULDER TYPE B, WILL BE DETERMINED IN THE FIELD BY THE ENGINEER.

F.A.P. 365 / IL-56 (BUTTERFIELD ROAD)

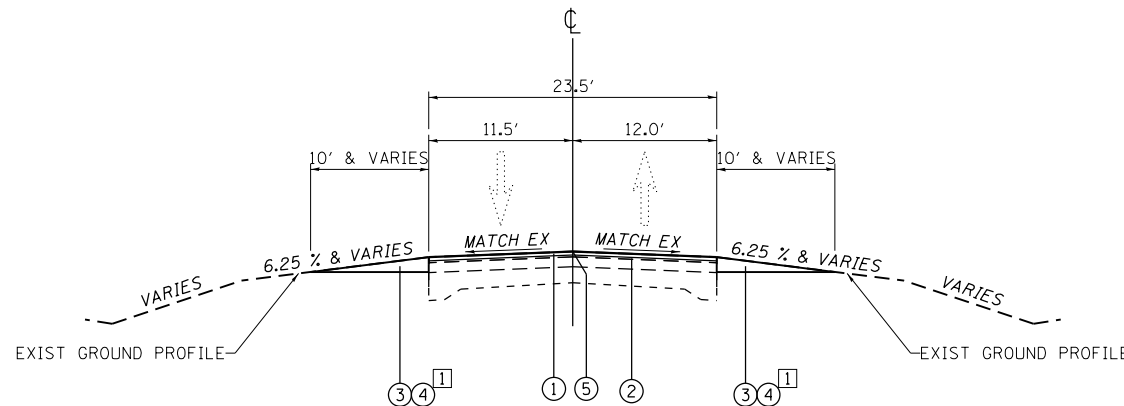

PROPOSED TYPICAL SECTION

STA 20+96.7 TO STA 30+35
 STA 43+95 TO STA 56+90
 STA 69+25 TO STA 102+00
 STA 145+00 TO STA 152+23.6

- NOTE 1: THE UNIT WEIGHT USED TO CALCULATE ALL HMA SURFACE MIXTURE QUANTITIES IS 112 LBS/SQ YD/IN.
- NOTE 2: THE "AC TYPE" FOR POLYMERIZED HMA MIXES SHALL BE "SBS/SBR PG 76-22" AND FOR NON-POLYMERIZED HMA THE "AC TYPE" SHALL BE "PG 64-22" UNLESS MODIFIED BY DISTRICT ONE SPECIAL PROVISIONS. FOR USE OF RECYCLED MATERIALS SEE SPECIAL PROVISIONS.
- NOTE 3: QUALITY MANAGEMENT PROGRAM (QMP) IDENTIFIES THE PARTICULAR QUALITY CONTROL SPECIFICATION THAT APPLIES TO THE HMA MIXTURE.
- NOTE 4: PATCH BEFORE MILLING
- NOTE 5: THE LONGITUDINAL JOINT SEALANT SHALL BE PLACED OVER THE POLYMERIZED LEVELING BINDER WHERE THE SURFACE JOINT WILL BE LOCATED.

HOT-MIX ASPHALT MIXTURE REQUIREMENTS		QUALITY MANAGEMENT PROGRAM (QMP)
MIXTURE TYPE	AIR VOIDS • Ndes	
PAVEMENT RESURFACING		
POLYMERIZED HOT-MIX ASPHALT SURFACE COURSE, MIX "E", N70 (IL-9.5 mm)	4% AT 70 GYR.	QCP
POLYMERIZED LEVELING BINDER (MACHINE METHOD), IL-4.75, N50	3.5% AT 50 GYR.	QCP
PATCHING		
CLASS D PATCHES (HMA BINDER IL-19 mm)	4% AT 70 GYR.	QC/OA
HOT-MIX ASPHALT REPLACEMENT OVER PATCHES (HMA BINDER IL-19 mm)	4% AT 70 GYR.	QC/OA
QMP DESIGNATION: QUALITY CONTROL/QUALITY ASSURANCE (QC/QA); QUALITY CONTROL FOR PERFORMANCE (QCP)		

MODEL: Default
 FILE: \\s:\cadd\p101819\cadd\data\des\p101819\sh-typlcal.dgn

USER NAME = JOHNSTONKD	DESIGNED -	REVISED -
	DRAWN -	REVISED -
PLOT SCALE = 100.0000' / in.	CHECKED -	REVISED -
PLOT DATE = 12/12/2018	DATE -	REVISED -

STATE OF ILLINOIS
 DEPARTMENT OF TRANSPORTATION

TYPICAL SECTIONS		F.A.P. RTE.	SECTION	COUNTY	TOTAL SHEETS	SHEET NO.
IL ROUTE 56 (BUTTERFIELD ROAD)		365	2018-092-R5	DUPAGE	21	6
KANE COUNTY LINE TO CN RAILROAD OVERPASS		CONTRACT NO. 62H24				
SCALE:	SHEET OF SHEETS	STA. TO STA.	ILLINOIS FED. AID PROJECT			

F.A.P. 365 / IL-56 (BUTTERFIELD ROAD)

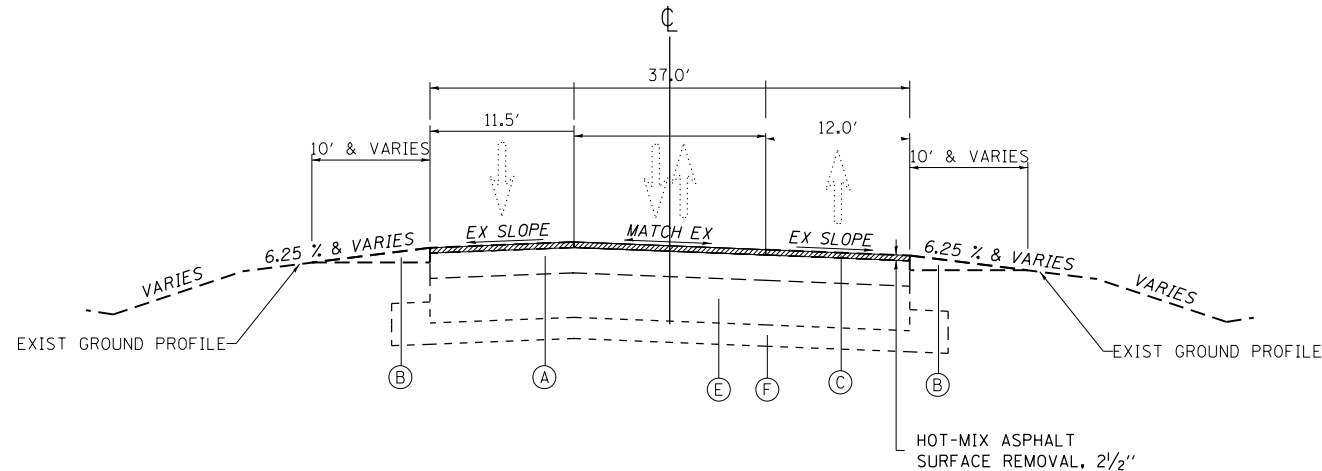

EXISTING TYPICAL SECTION

STA 30+35 TO STA 43+95
 STA 56+90 TO STA 69+25
 STA 102+00 TO STA 145+00

LEGEND - EXISTING:

- (A) HOT MIX ASPHALT SURFACE COURSE ± 4 1/2"
- (B) AGGREGATE SHOULDER, TYPE B
- (C) HOT MIX ASPHALT SURFACE REMOVAL 2 1/2"
- (E) BITUMINOUS BASE COURSE ± 10"
- (F) SUB-BASE GRANULAR MATERIAL, TYPE A, 4"

LEGEND - PROPOSED

- (1) POLYMERIZED HOT-MIX ASPHALT SURFACE COURSE, MIX "E", N70, 1 3/4"
- (2) POLYMERIZED LEVELING BINDER (MACHINE METHOD), IL-4.75, N50, 3/4"
- (3) AGGREGATE WEDGE SHOULDERS, TYPE B
- (4) GRADING AND SHAPING SHOULDERS
- (5) MILLED RUMBLE STRIP

[1] EXACT LOCATIONS OF GRADING AND SHAPING SHOULDERS AND AGGREGATE WEDGE SHOULDER TYPE B, WILL BE DETERMINED IN THE FIELD BY THE ENGINEER.

F.A.P. 365 / IL-56 (BUTTERFIELD ROAD)

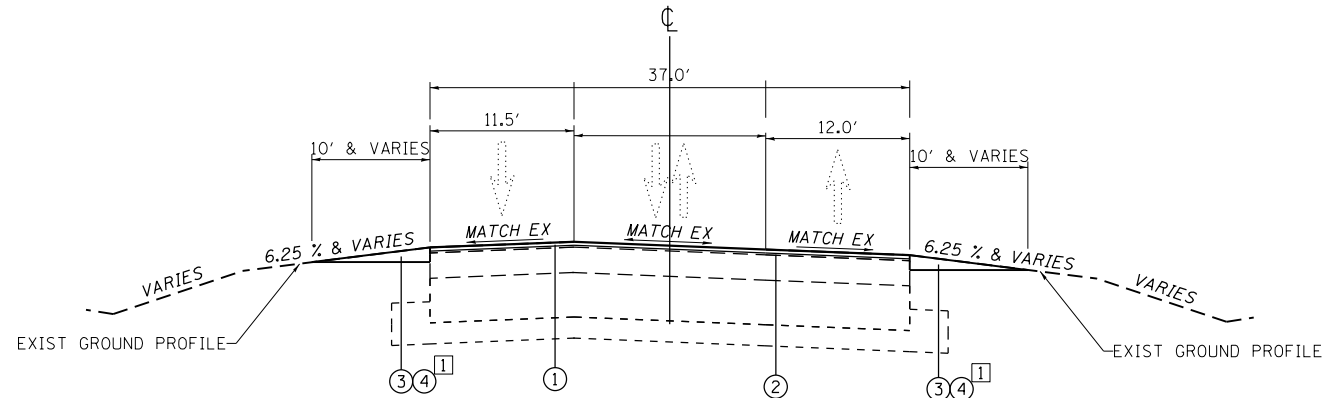

PROPOSED TYPICAL SECTION

STA 30+35 TO STA 43+95
 STA 56+90 TO STA 69+25
 STA 102+00 TO STA 145+00

MODEL: Default
 FILE: \\nas01c.psu.edu\B&E\BID\NTEC\Illinois\gov\PI\DOT\Documents\1\DOT\Office\1\1819\1819-ah-typlcal.dgn

USER NAME = JOHNSTONKD	DESIGNED -	REVISED -
	DRAWN -	REVISED -
PLOT SCALE = 100.0000' / in.	CHECKED -	REVISED -
PLOT DATE = 12/12/2018	DATE -	REVISED -

STATE OF ILLINOIS
 DEPARTMENT OF TRANSPORTATION

TYPICAL SECTIONS
 IL ROUTE 56 (BUTTERFIELD ROAD)
 KANE COUNTY LINE TO CN RAILROAD OVERPASS

SCALE: SHEET OF SHEETS STA. TO STA.

F.A.P. RTE.	SECTION	COUNTY	TOTAL SHEETS	SHEET NO.
365	2018-092-R5	DUPAGE	21	7
			CONTRACT NO. 62H24	
			ILLINOIS FED. AID PROJECT	

IL. ROUTE 56
(BUTTERFIELD ROAD)

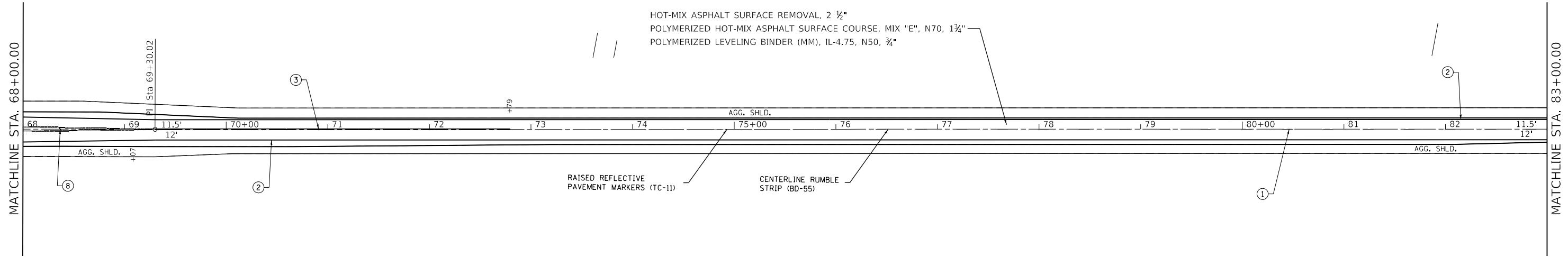

PROPOSED PAVEMENT MARKINGS LEGEND

- | | |
|---|--|
| <ul style="list-style-type: none"> ① THERMOPLASTIC PVMT. MARKING LINE 4", SKIP-DASH, YELLOW, 10' LINE WITH 30' SPACE - LANE LINES (TYP.) ② THERMOPLASTIC PVMT. MARKING LINE 4", SOLID, WHITE, EDGE LINES (TYP.) ③ THERMOPLASTIC PVMT. MARKING LINE 4", SOLID, YELLOW, 2 @ 4", 11" C-C - CENTERLINE (TYP.) ④ THERMOPLASTIC PVMT. MARKING LINE 6", SOLID, WHITE - TURN LANE MARKINGS (TYP.) ⑤ THERMOPLASTIC PVMT. MARKING LINE 24", SOLID, WHITE - STOP LINES (TYP.) | <ul style="list-style-type: none"> ⑥ THERMOPLASTIC PVMT. MARKING LETTERS & SYMBOLS, 8", SOLID, WHITE - TURN LANE MARKINGS (TYP.) ⑦ THERMOPLASTIC PVMT. MARKING LINE 12", SOLID, WHITE - SHOULDER DIAGONALS (TYP.) (SEE DISTRICT DETAIL TC-13 FOR SPACING) ⑧ THERMOPLASTIC PVMT. MARKING LINE 12", SOLID, YELLOW -PAINTED MEDIAN DIAGONALS (TYP.) - SEE DISTRICT DETAIL TC-13 FOR SPACING ⑨ THERMOPLASTIC PVMT. MARKING LINE 8", SOLID, WHITE - GORE MARKING AND CHANNELIZING LINES (TYP.) ⑩ THERMOPLASTIC PVMT. MARKING LINE 12", SOLID, WHITE - GORE DIAGONALS (TYP.) - SEE DISTRICT DETAIL TC-13 FOR SPACING ⑪ THERMOPLASTIC PVMT. MARKING LINE 6", SKIP-DASH, WHITE, 2' LINE WITH 6' SPACE - TURN LANE MARKING (TYP.) |
|---|--|

NOTES:

- 1) ALL FINAL PAVEMENT MARKINGS SHALL BE THERMOPLASTIC PAVEMENT MARKINGS (OF THE EXTRUDED TYPE).
- 2) ALL FINAL PAVEMENT MARKINGS SHALL BE PLACED IN ACCORDANCE WITH TC-13 "DISTRICT ONE TYPICAL PAVEMENT MARKINGS" STANDARD DETAIL.
- 3) ALL RAISED REFLECTIVE PAVEMENT MARKERS SHALL BE PLACED IN ACCORDANCE WITH TC-11 "TYPICAL APPLICATIONS RAISED REFLECTIVE PAVEMENT MARKERS (SNOW-PLow RESISTANT)" STANDARD DETAIL.
- 4) ALL CENTERLINE RUMBLE STRIPS SHALL BE PLACED IN ACCORDANCE WITH BD-55 "RUMBLE STRIPS FOR CENTERLINE, NON-FREEWAY" STANDARD DETAIL.
- 5) FOR RAISED REFLECTIVE PAVEMENT MARKERS AND CENTERLINE RUMBLE STRIP LOCATIONS, REFER TO TABLES ALONG THE ROADWAY.

IL. ROUTE 56
(BUTTERFIELD ROAD)

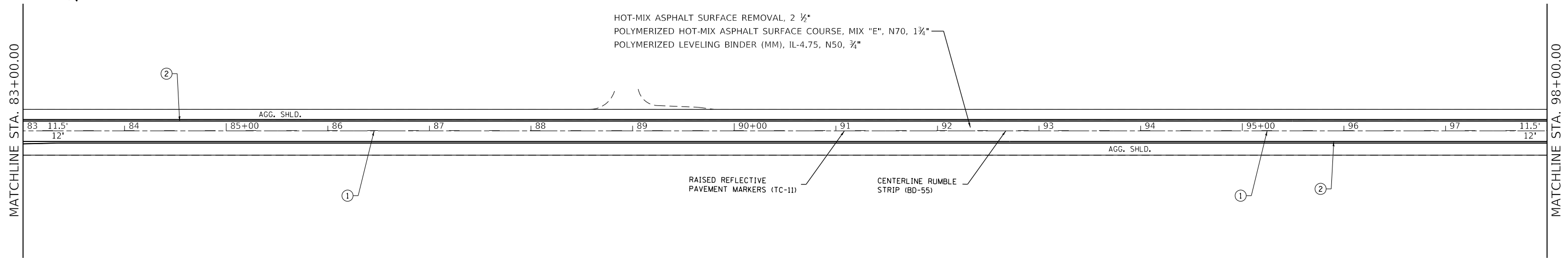

MODEL: Default
 FILE: \\bls01\B&E\BID\NTEC\Illinois\gov\p\W\DOT\Documents\1\DOT\Office\BID\Tct\1\proj\cscs\101819\CADD\B&E\BID\NTEC\Illinois\gov\p\W\DOT\Documents\1\DOT\Office\BID\Tct\1\proj\cscs\101819\sh-rl-plan.dgn

USER NAME = JOHNSTONKD	DESIGNED -	REVISED -
PLOT SCALE = 100,0000' / in.	DRAWN -	REVISED -
PLOT DATE = 12/12/2018	CHECKED -	REVISED -
	DATE -	REVISED -

**STATE OF ILLINOIS
DEPARTMENT OF TRANSPORTATION**

**ROADWAY PLAN
IL. ROUTE 56 (BUTTERFIELD ROAD)
KANE COUNTY LINE TO CN RAILROAD OVERPASS**

SCALE: 1" = 50' SHEET OF SHEETS STA. TO STA.

F.A.P. RTE.	SECTION	COUNTY	TOTAL SHEETS	SHEET NO.
365	2018-092-RS	DUPAGE	21	10
CONTRACT NO. 62H24			ILLINOIS FED. AID PROJECT	

NOTES:

1. WORK SHALL MEET THE REQUIREMENTS OF THE SPECIAL PROVISION, "DETECTOR LOOP REPLACEMENT AND/OR INSTALLATION (ROADWAY GRINDING, RESURFACING & PATCHING OPERATIONS).
2. THIS PLAN IS FOR THE SOLE PURPOSE OF DETECTOR LOOP REPLACEMENT.

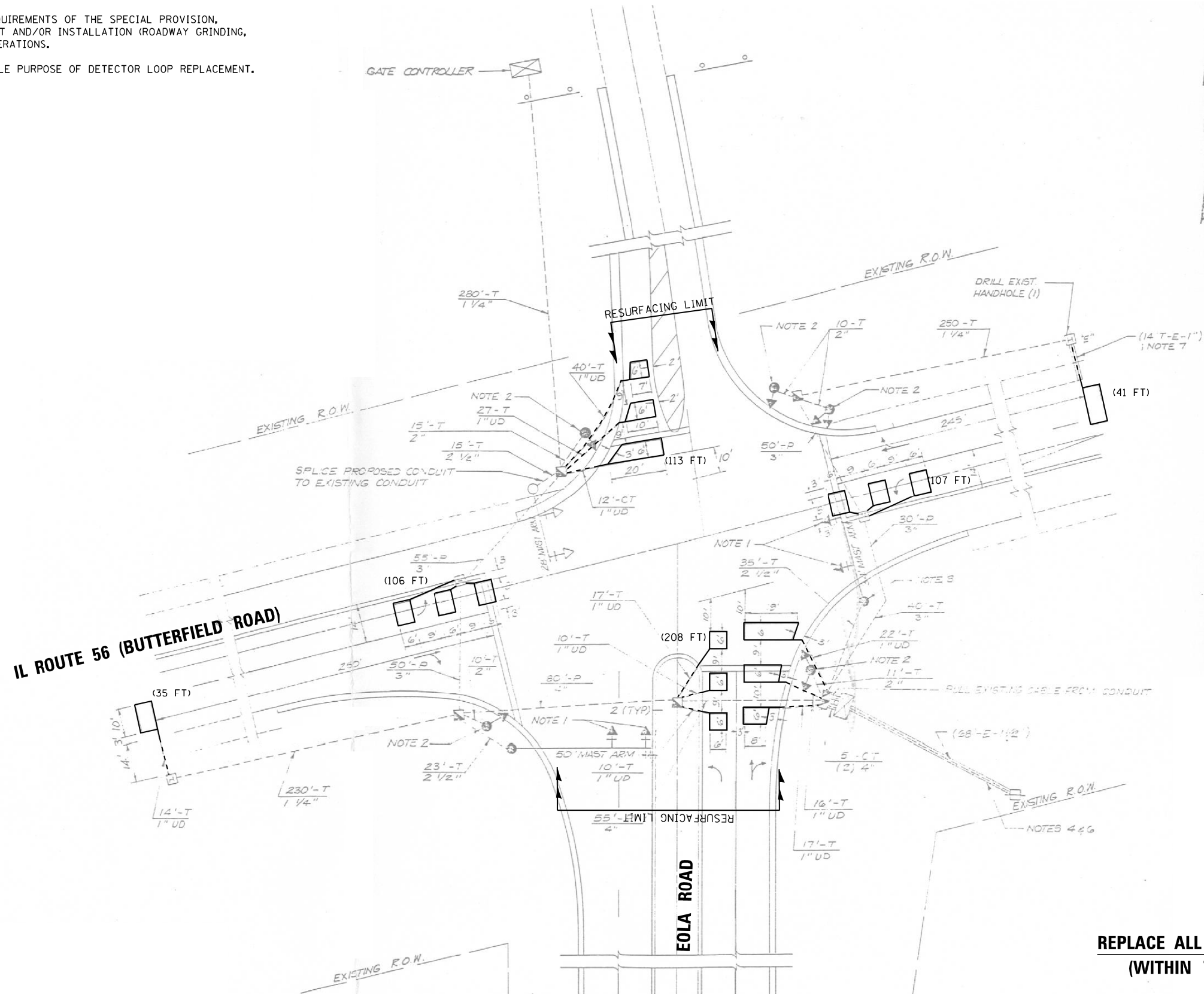

**REPLACE ALL DETECTOR LOOPS AS SHOWN
(WITHIN THE RESURFACING LIMITS)**

CODE	ITEM	QUANTITY	UNIT
88600600	DETECTOR LOOP REPLACEMENT	610	FOOT

MODEL: Default
 FILE: \\nas01.cpe.illinois.gov\pww\DOT\Documents\DOT_Offices\Director_1\Projects\101819\101819-CAD\Drawings\101819-19-ehp-plan.dwg

USER NAME = JOHNSTONKD	DESIGNED -	REVISED -
	DRAWN -	REVISED -
PLOT SCALE = 100.0000' / in.	CHECKED -	REVISED -
PLOT DATE = 12/12/2018	DATE -	REVISED -

**STATE OF ILLINOIS
DEPARTMENT OF TRANSPORTATION**

**DETECTOR LOOP REPLACEMENT PLAN
IL ROUTE 56 (BUTTERFIELD ROAD)
KANE COUNTY LINE TO CN RAILROAD OVERPASS**

SCALE: 1" = 50' SHEET OF SHEETS STA. TO STA.

F.A.P. RTE.	SECTION	COUNTY	TOTAL SHEETS	SHEET NO.
365	2018-092-RS	DUPAGE	21	13
CONTRACT NO. 62H24			ILLINOIS FED. AID PROJECT	

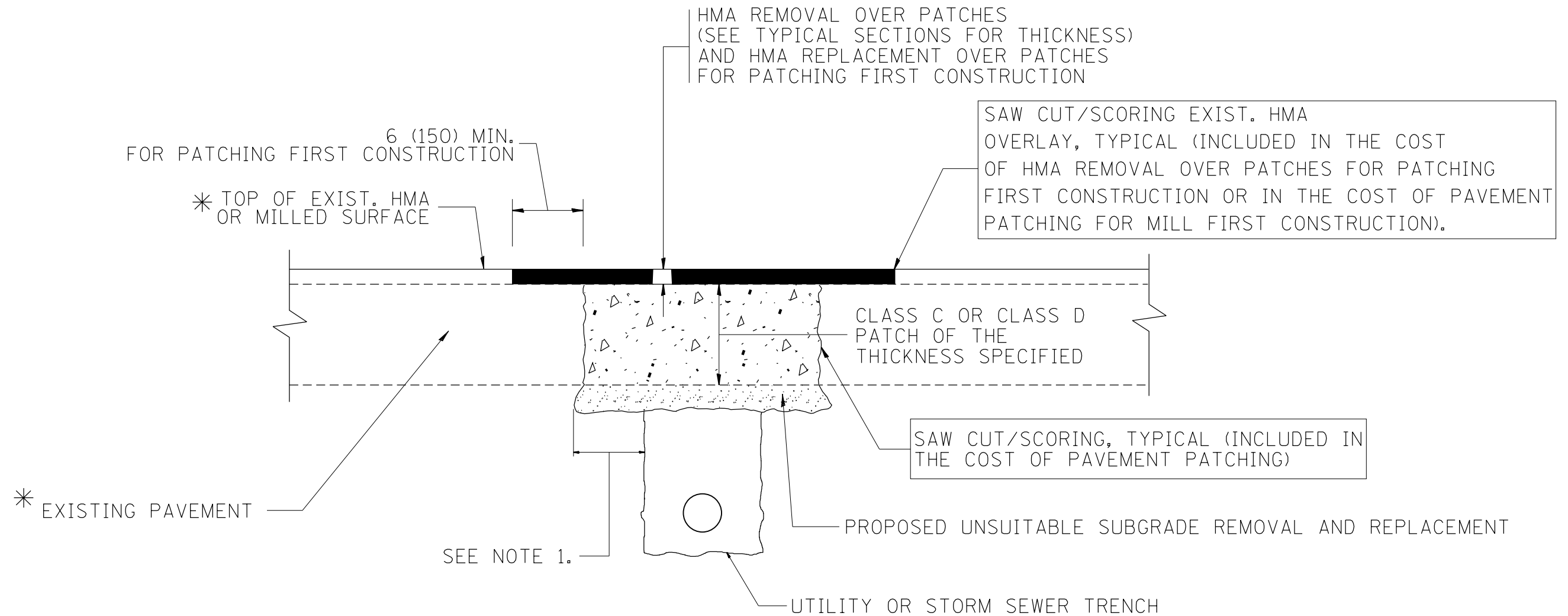

* SEE TYPICAL SECTIONS FOR THICKNESS AND MATERIALS

NOTES:

1. THE WIDTH OF THE FULL DEPTH PATCH OVER A TRENCH SHALL BE 12 (300) WIDER ON EACH SIDE OF THE TRENCH.
2. FOR METHOD OF MEASUREMENT AND BASIS OF PAYMENT, SEE RECURRING SPECIAL PROVISION "PATCHING WITH HOT-MIX ASPHALT OVERLAY REMOVAL".

SEQUENCE OF CONSTRUCTION (PATCHING FIRST)

1. REMOVE THE EXISTING HMA MATERIAL OVER THE AREA TO BE PATCHED.
2. REMOVE AND REPLACE WITH CLASS C OR D PATCH.
3. REPLACE HMA MATERIAL OVER THE AREA TO BE PATCHED.

SEQUENCE OF CONSTRUCTION (MILLING FIRST)

1. MILL HMA FIRST IF THERE IS AT LEAST 4 1/2 INCHES OR MORE OF HMA MATERIAL ON TOP OF THE EXISTING PAVEMENT OR IF THE PAVEMENT IS FULL DEPTH HMA. A MINIMUM OF 2 INCHES OF HMA MATERIAL SHALL BE IN PLACE AFTER MILLING.
2. REMOVE AND REPLACE WITH FULL DEPTH CLASS D PATCHES TO TOP OF MILLED SURFACE.

ALL DIMENSIONS ARE IN INCHES (MILLIMETERS) UNLESS OTHERWISE SHOWN.

FILE NAME =	USER NAME = JOHNSTONKD	DESIGNED - R. SHAH	REVISED - A. ABBAS 04-27-98	STATE OF ILLINOIS DEPARTMENT OF TRANSPORTATION	PAVEMENT PATCHING FOR HMA SURFACED PAVEMENT			F.A.P. RTE.	SECTION	COUNTY	TOTAL SHEETS	SHEET NO.
pw\11084EBIDINTEG.illinois.gov\PIWIDOT\Documents\DOT Offices\District 1\Projects\DI084EBIDINTEG\Design\DistStd.dgn	PLOT SCALE = 100.0000' / 1in.	CHECKED -	REVISED - R. BORO 01-01-07					365	2018-092-RS	DUPAGE	21	14
	PLOT DATE = 12/12/2018	DATE - 10-25-94	REVISED - R. BORO 09-04-07		BD400-04 (BD-22)			CONTRACT NO. 62H24				
			REVISED - K. ENG 10-27-08		SCALE: NONE	SHEET NO. 1 OF 1 SHEETS	STA. TO STA.	FED. ROAD DIST. NO. 1 ILLINOIS FED. AID PROJECT				

VARIABLE - TO MEET EXISTING DIMENSIONS AND FIELD CONDITIONS (SEE NOTE ②)

PROP. CONC. CURB OR CURB AND GUTTER REPLACEMENT IN ACCORDANCE WITH STATE STANDARD 606001. (SEE NOTE ②)

SAW CUT FULL DEPTH - INCLUDED IN THE COST OF SIDEWALK, DRIVEWAY OR MEDIAN SURFACE REMOVAL PAY ITEM.

EXISTING SIDEWALK, DRIVEWAY, MEDIAN SURFACE, SOD OR GROUND.

PROPOSED SIDEWALK, DRIVEWAY PAVEMENT, MEDIAN SURFACE OR SODDING SALT TOLERANT WITH TOP SOIL, 4" (100) SOD RESTORATION (SEE NOTE ①).

SUITABLE BACKFILL MATERIAL (INCLUDED IN THE COST OF CURB OR CURB AND GUTTER REMOVAL AND REPLACEMENT)

PROPOSED 3/4" (20) PREFORMED EXPANSION JOINT AT CONCRETE SIDEWALKS, DRIVEWAYS, AND MEDIANS. (INCLUDED IN THE COST OF CURB OR CURB AND GUTTER REMOVAL AND REPLACEMENT.)

UNSUITABLE SUB-BASE MATERIAL TO BE REMOVED, IF DIRECTED BY THE ENGINEER, SHALL BE REPLACED WITH EITHER SUB-BASE GRANULAR MATERIAL, TYPE B OR ADDITIONAL THICKNESS OF CONCRETE.

REMOVAL AND REPLACEMENT 4" (100) OR LESS IS INCLUDED IN THE COST OF CURB OR CURB AND GUTTER REMOVAL AND REPLACEMENT.

REMOVAL AND REPLACEMENT IN EXCESS OF 4" (100) WILL BE PAID FOR IN ACCORDANCE WITH ARTICLE 109.04 OF THE STANDARD SPECIFICATIONS.

PROPOSED #6 (20) EPOXY COATED TIE BARS 24" (600) LONG AT 24" (600) CENTERS WILL NOT BE PAID FOR SEPARATELY. DELETE EPOXY COATED TIE BARS IF EXISTING TIE BARS ARE USUABLE AS DETERMINED BY THE ENGINEER. (SEE NOTE ③).

BASIS OF PAYMENT:
THIS WORK WILL BE PAID FOR AT THE CONTRACT UNIT PRICE PER FOOT (METER) FOR "CURB REMOVAL AND REPLACEMENT" OR "COMBINATION CONCRETE CURB AND GUTTER REMOVAL AND REPLACEMENT".

SEE STATE STANDARD 606001
EXISTING OR PROPOSED HMA SURFACE (IF APPLICABLE)

1/4" (5) **

18" (450) MAX.

T/2 *

3" (75) MIN.

EXISTING CONCRETE PAVEMENT, CONCRETE BASE COURSE OR FLEXIBLE PAVEMENT

* 3" (75) MINIMUM FROM TOP AND BOTTOM OF THE CONCRETE PAVEMENT OR BASE COURSE.

** IF THE FINAL SURFACE OF THE PAVEMENT IS CONCRETE, THE GUTTER IS TO BE FLUSH WITH THE PAVEMENT.

NOTE: ① SIDEWALK, DRIVEWAY PAVEMENT OR MEDIAN SURFACE SHALL BE SIMILAR TO THE MATERIAL BEING REMOVED AND WILL BE PAID FOR SEPARATELY.

SODDING, SALT TOLERANT AND TOP SOIL, FURNISH AND PLACE 4" WILL BE PAID FOR SEPARATELY.

② FERTILIZER FOR THE PLACEMENT OF THE SOD IS NOT REQUIRED

③ CURB OR CURB AND GUTTER REPLACEMENT SHALL MATCH THE SHAPE OF THE EXISTING CURB OR CURB AND GUTTER UNLESS OTHERWISE SPECIFIED.

④ FOR CURB OR CURB AND GUTTER REMOVAL AND REPLACEMENT ADJACENT TO FLEXIBLE PAVEMENT DELETE EPOXY COATED TIE BARS.

⑤ LONGITUDINAL BARS, IF ENCOUNTERED IN THE EXISTING CURB OR CURB AND GUTTER, ARE NOT TO BE REPLACED. CUTTING AND REMOVING LONGITUDINAL BARS SHALL BE INCLUDED IN THE COST OF CURB OR CURB AND GUTTER REMOVAL AND REPLACEMENT.

⑥ THE COST OF HMA SURFACE REMOVAL IN THE EXISTING GUTTER FLAG SHALL BE INCLUDED IN THE COST OF THE CURB AND GUTTER REMOVAL AND REPLACEMENT.

⑦ THE REMOVAL AND REPLACEMENT OF THE EXISTING CURB OR CURB AND GUTTER SHALL BE DONE IN ACCORDANCE WITH THE APPLICABLE PORTIONS OF SECTION 440 AND 606 OF THE STANDARD SPECIFICATIONS.

⑧ THE LOCATIONS OF REMOVAL AND REPLACEMENT OF EXISTING CURB OR CURB AND GUTTER SHALL BE DETERMINED BY THE RESIDENT ENGINEER AT THE TIME OF CONSTRUCTION.

CURB OR CURB AND GUTTER REMOVAL AND REPLACEMENT

ALL DIMENSIONS ARE IN INCHES (MILLIMETERS) UNLESS OTHERWISE SHOWN.

FILE NAME =	USER NAME = JOHNSTONKD	DESIGNED - A. HOUSEH	REVISED - R. SHAH 10-03-96	STATE OF ILLINOIS DEPARTMENT OF TRANSPORTATION	CURB OR CURB AND GUTTER REMOVAL AND REPLACEMENT	F.A.P. R.E.	SECTION	COUNTY	TOTAL SHEETS	SHEET NO.
pw\11084EBIDINTEG.illinois.gov\PIWIDOT\Documents\DOT Offices\District 1\Projects\DI084EBIDINTEG\Design\DistStd.dgn	PLotted SCALE = 100.0000' / 1in.	CHECKED -	REVISED - A. ABBAS 03-21-97			365	2018-092-RS	DUPAGE	21	15
PLOT DATE = 12/12/2018	DATE - 03-11-94	REVISED - M. GOMEZ 01-22-01	REVISED - R. BORO 12-15-09			BD600-06 (BD-24)		CONTRACT NO. 62H24		
						FED. ROAD DIST. NO. 1 ILLINOIS FED. AID PROJECT				

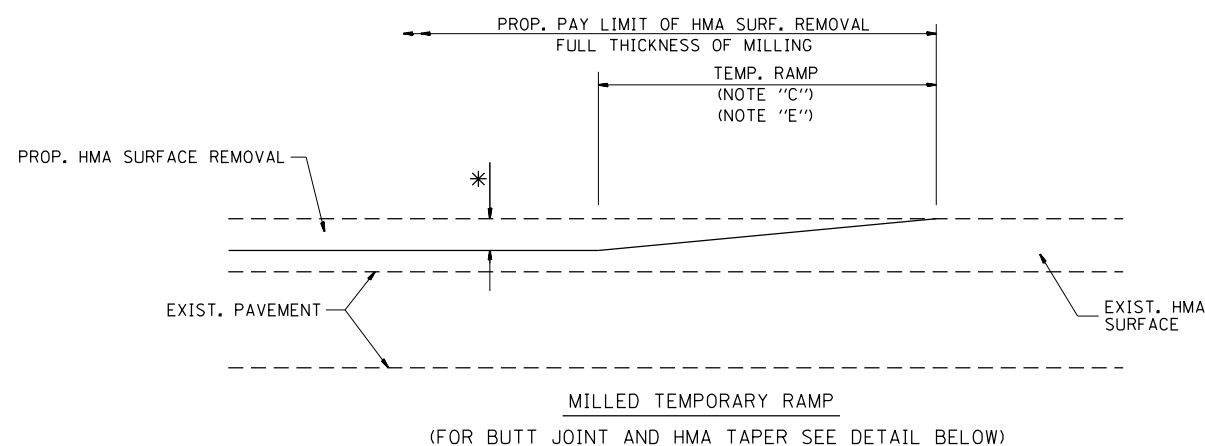

OPTION 1

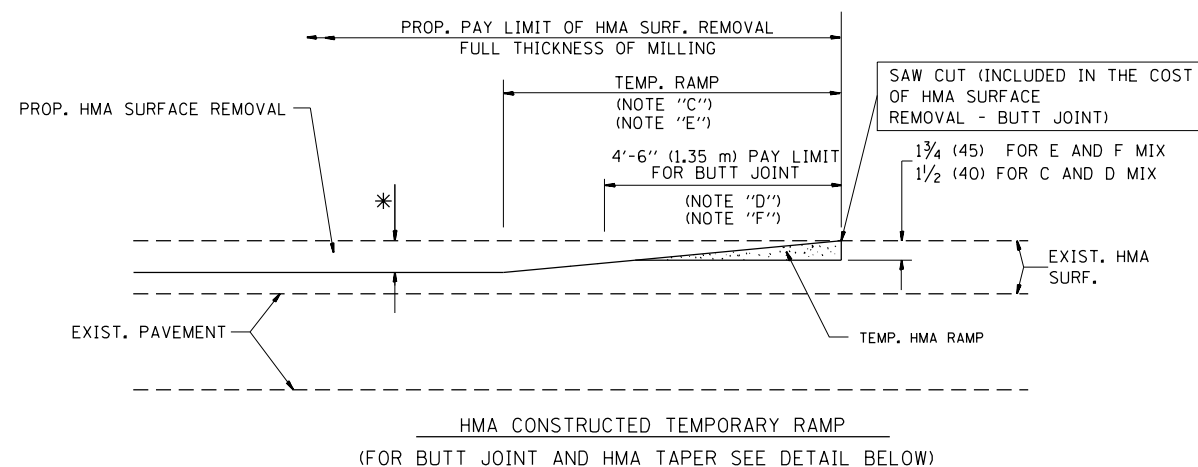

OPTION 2

TYPICAL TEMPORARY RAMP

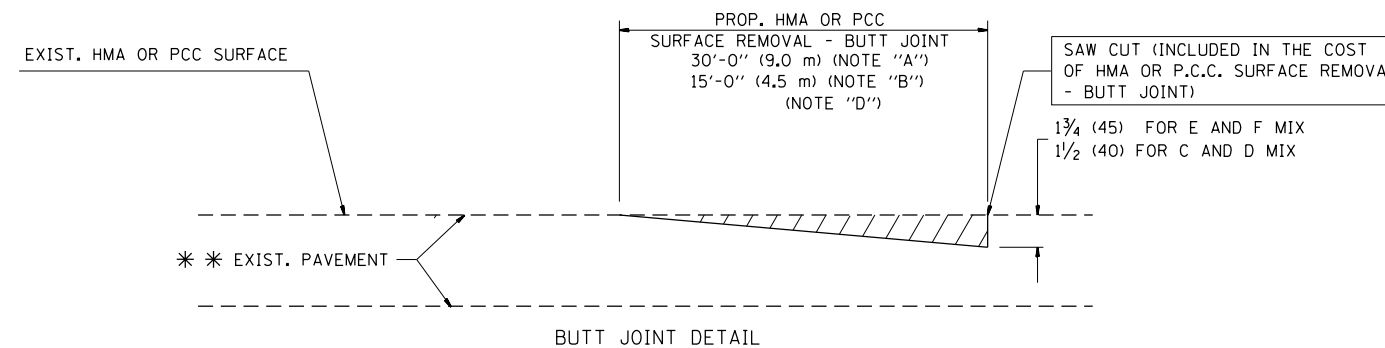

BUTT JOINT DETAIL

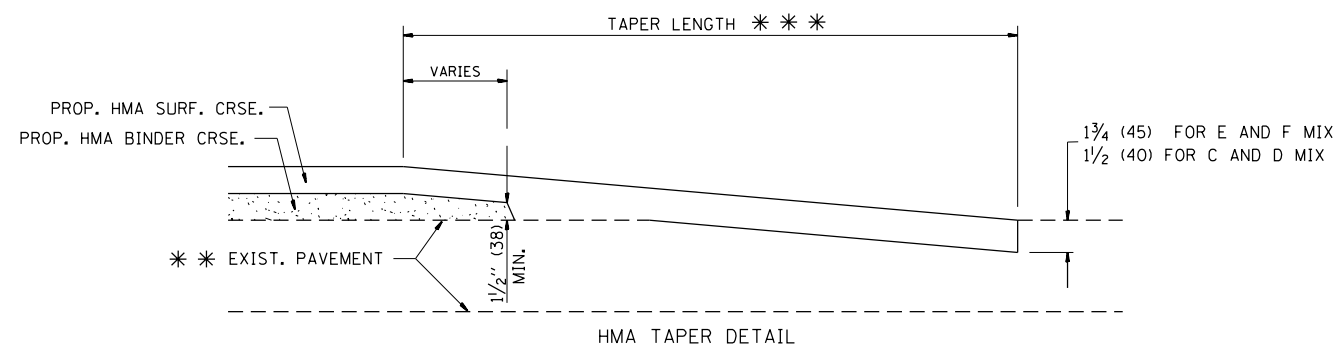

HMA TAPER DETAIL

TYPICAL BUTT JOINT AND HMA TAPER FOR RESURFACING ONLY

* * PC CONCRETE, HMA OR HMA RESURFACED PAVEMENT.

NOTES

- A: MAINLINE ROADWAYS AND MAJOR SIDE ROADS.
 - B: MINOR SIDE ROADS.
 - C: THE TEMP. RAMP SHALL BE CONSTRUCTED IMMEDIATELY UPON REMOVAL OF THE EXISTING HMA SURFACE.
 - D: THE BUTT JOINT SHALL BE CONSTRUCTED IMMEDIATELY PRIOR TO PLACING THE PROPOSED HMA COURSES.
 - E: TAPER THE TEMP. RAMP AT A RATE OF 3'-0" (900 mm) PER 1 INCH (25 mm) OF MILLING THICKNESS.
 - F: INSTALLATION AND REMOVAL OF THE 4'-6" (1.35 m) TEMP. RAMP IS INCLUDED IN COST OF HMA SURFACE REMOVAL - BUTT JOINT
 - G: SEE ARTICLE 406.08 AND 406.14 OF THE STANDARD SPECIFICATIONS FOR "HMA AND/OR PCC SURFACE REMOVAL, BUTT JOINT".
- * SEE TYPICAL SECTIONS FOR MILLING THICKNESS.
- * * * 20'-0" (6.1 m) PER 1 (25) RESURFACING (NOTE "A")
10'-0" (3.0 m) PER 1 (25) RESURFACING (NOTE "B")

BASIS OF PAYMENT:

THE BUTT JOINT WILL BE PAID FOR AT THE CONTRACT UNIT PRICE PER SQUARE YARD (SQUARE METER) FOR "HOT-MIX ASPHALT SURFACE REMOVAL - BUTT JOINT" OR FOR "PORTLAND CEMENT CONCRETE SURFACE REMOVAL - BUTT JOINT".

ALL DIMENSIONS ARE IN INCHES (MILLIMETERS) UNLESS OTHERWISE SHOWN.

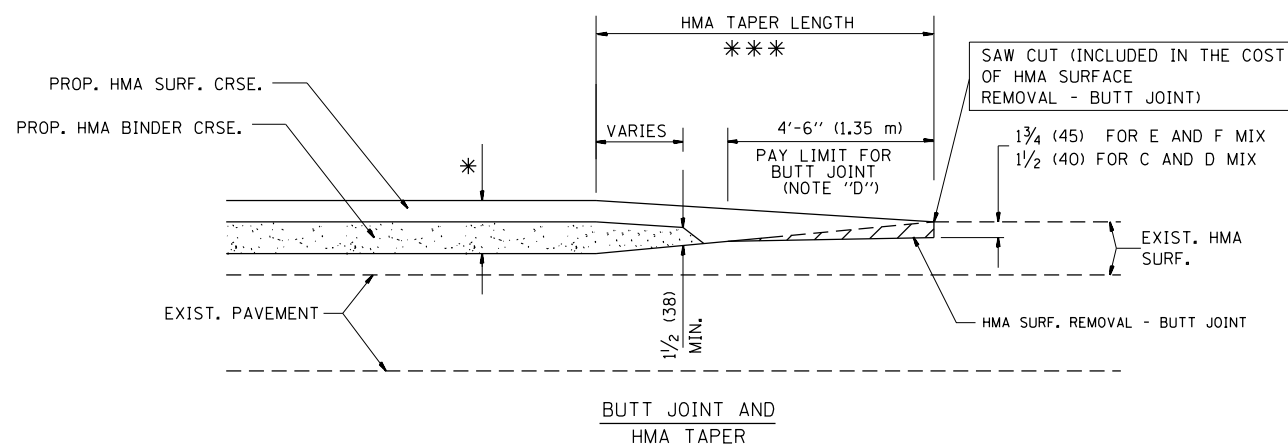

TYPICAL BUTT JOINT AND HMA TAPER FOR MILLING AND RESURFACING

FILE NAME =	USER NAME = JOHNSTONKD	DESIGNED - M. DE YONG	REVISED - R. SHAH 10-25-94
p:\1\084EBIDINTEG.illinois.gov\PIWIDOT\Documents\DOT Offices\District 1\Projects\DI084EBIDINTEG\Design\DistStd.dgn			REVISED - A. ABBAS 03-21-97
	PLOT SCALE = 100.0000' / 1in.	CHECKED -	REVISED - M. GOMEZ 04-06-01
	PLOT DATE = 12/12/2018	DATE - 06-13-90	REVISED - R. BORO 01-01-07

**STATE OF ILLINOIS
DEPARTMENT OF TRANSPORTATION**

**BUTT JOINT AND
HMA TAPER DETAILS**

SCALE: NONE SHEET NO. 1 OF 1 SHEETS STA. TO STA.

F.A.P. RTE.	SECTION	COUNTY	TOTAL SHEETS	SHEET NO.
365	2018-092-RS	DUPAGE	21	16
BD400-05 BD32		CONTRACT NO. 62H24		
FED. ROAD DIST. NO. 1 ILLINOIS FED. AID PROJECT				

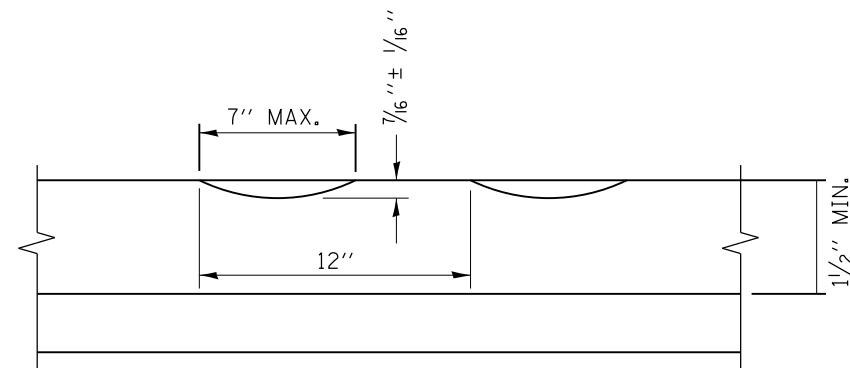

SECTION A-A

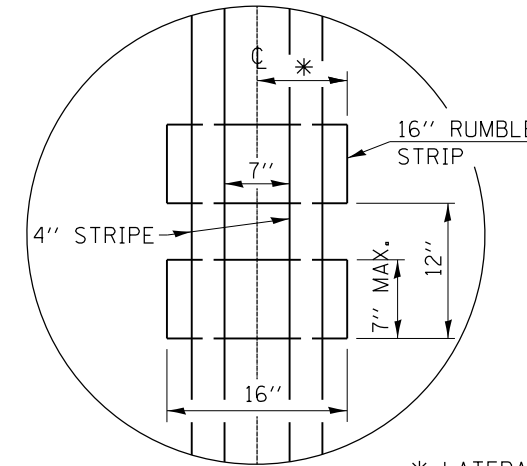

DETAIL B

GENERAL NOTES

- CENTERLINE RUMBLE STRIPS SHALL BE CONSTRUCTED ACCORDING TO SECTION 642 ALONG THE CENTERLINE OF PAVEMENT.
- SEE STANDARD 780001 FOR OTHER STRIPING LAYOUTS.
- RUMBLE STRIPS SHALL NOT BE PLACED ON BRIDGES.
- ALL RUMBLE STRIPS SHALL BE MILLED.
- CENTERLINE RUMBLE STRIPS SHALL BE CONTINUOUS THROUGH CONNECTIONS OF SIDEROADS WITH NO LEFT TURN LANES.
- DISCONTINUE CENTERLINE RUMBLE STRIPS THROUGH THE LIMITS OF ALL LEFT TURN LANES, INCLUDING ANY LANE TAPER SECTIONS.
- AFTER RUMBLE STRIPS ARE INSTALLED, THE PAVEMENT SURFACE SHALL BE SWEEP CLEAN PRIOR TO THE PLACEMENT OF THE NEW PAVEMENT MARKINGS.
- WHERE USED, ADJUST SPACING OF RAISED REFLECTIVE PAVEMENT MARKERS TO FALL IN WIDER GAP BETWEEN RUMBLE STRIPS.

BASIS OF PAYMENT

- THIS WORK WILL BE PAID FOR AT THE CONTRACT UNIT PRICE PER FOOT FOR CENTERLINE-RUMBLE STRIP OF THE WIDTH SPECIFIED.
- HOT-SPRAY THERMOPLASTIC PAVEMENT MARKING WILL BE USED OVER THE RUMBLE STRIPS, AND WILL BE PAID FOR SEPARATELY.

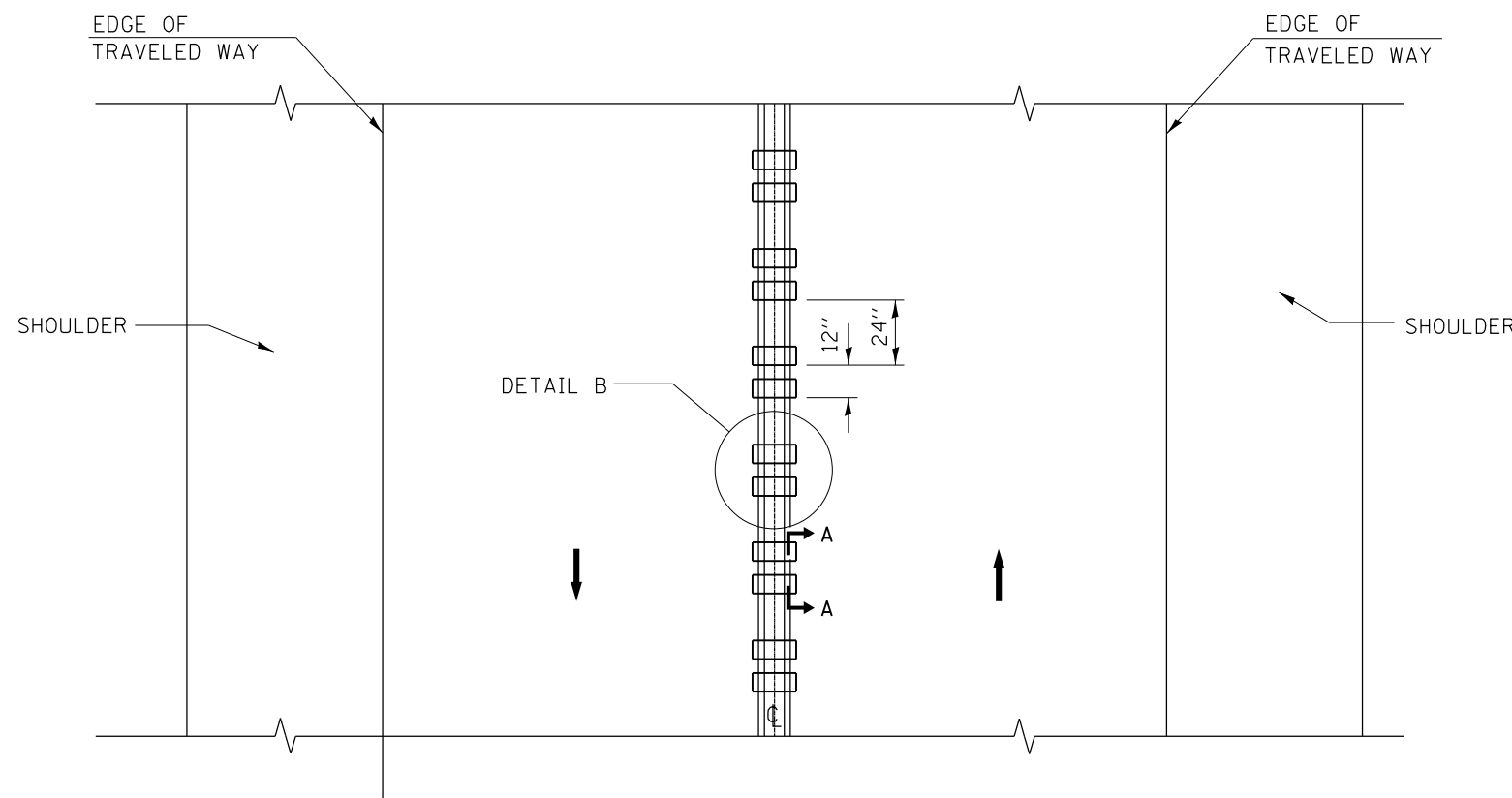

TWO-WAY ROAD

FILE NAME =	USER NAME = JOHNSTONKD	DESIGNED - R. BORO	REVISED -	STATE OF ILLINOIS DEPARTMENT OF TRANSPORTATION	RUMBLE STRIPES FOR CENTERLINE, NON-FREEWAY			F.A.P. RTE.	SECTION	COUNTY	TOTAL SHEETS	SHEET NO.
pw:\IL\084EBIDINTEG.illinois.gov\PWIDOT\Documents\IDOT Offices\District 1\Projects\DI084EBIDINTEG\Design\DistStd.dgn	PLOT SCALE = 100.0000' / 1in.	CHECKED -	REVISED -					365	2018-092-RS	DUPAGE	21	17
PLOT DATE = 12/12/2018	DATE - 08-06-2012	REVISED -	REVISED -		BD 55			CONTRACT NO. 62H24				
					SCALE: NONE	SHEET NO. 1 OF 1 SHEETS	STA.	TO STA.		FED. ROAD DIST. NO. 1 ILLINOIS FED. AID PROJECT		

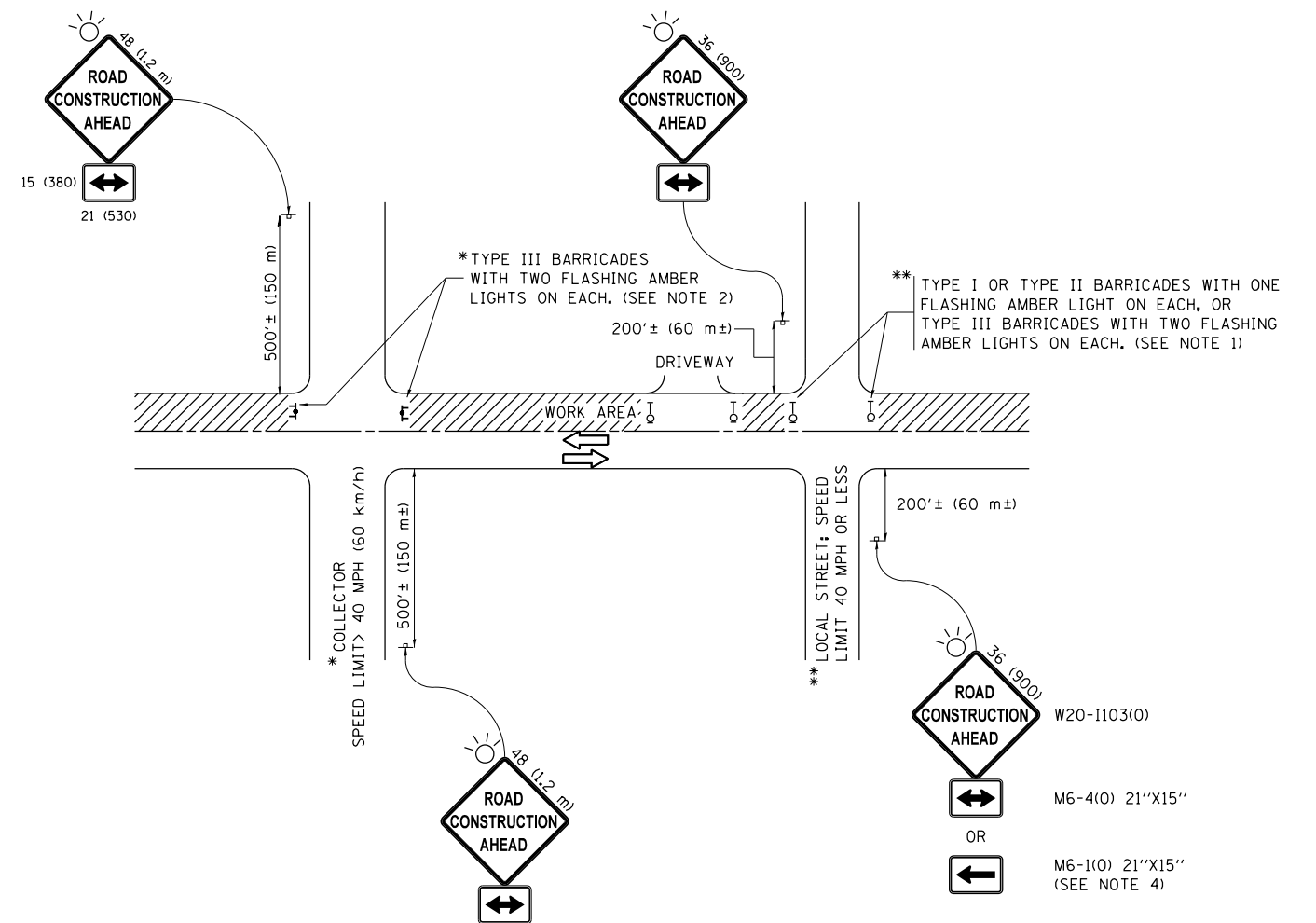

NOTES:

1. SIDE ROAD WITH A SPEED LIMIT OF 40 MPH (60 km/h) OR LESS AS SHOWN ON THE DRAWING AND AS DIRECTED BY THE ENGINEER:
 - a) ONE "ROAD CONSTRUCTION AHEAD" SIGN 36 x 36 (900x900) WITH A FLASHER MOUNTED ON IT APPROXIMATELY 200' (60 m) IN ADVANCE OF THE MAIN ROUTE.
 - b) THE CLOSED PORTION OF THE MAIN ROUTE SHALL BE PROTECTED BY BLOCKING WITH TYPE I, TYPE II OR TYPE III BARRICADES, 1/3 OF THE CROSS SECTION OF THE CLOSED PORTION.
2. SIDE ROAD WITH A SPEED LIMIT GREATER THAN 40 MPH (60 km/h) AS SHOWN ON THE DRAWING AND AS DIRECTED BY THE ENGINEER:
 - a) ONE "ROAD CONSTRUCTION AHEAD" SIGN 48 x 48 (1.2 m x 1.2 m) WITH A FLASHER MOUNTED ON IT APPROXIMATELY 500' (150 m) IN ADVANCE OF THE MAIN ROUTE.
 - b) THE CLOSED PORTION OF THE MAIN ROUTE SHALL BE PROTECTED BY BLOCKING WITH TYPE III BARRICADES, 1/2 OF THE CROSS SECTION OF THE CLOSED PORTION.
3. CONES MAY BE SUBSTITUTED FOR BARRICADES OR DRUMS AT HALF THE SPACING DURING DAY OPERATIONS. CONES SHALL BE A MINIMUM OF 28 (710) IN HEIGHT.
4. WHEN THE SIDE ROAD LIES BETWEEN THE BEGINNING OF THE MAINLINE SIGNING AND THE WORK ZONE, A SINGLE HEADED ARROW (M6-1) SHALL BE USED IN LIEU OF THE DOUBLE HEADED ARROW (M6-4).
5. WHEN WORK IS BEING PERFORMED ON A SIDE ROAD OR DRIVEWAY, FOLLOW THE APPLICABLE STANDARD(S). THE DIRECTIONAL ARROW (M6-1 OR M6-4) SHALL BE COVERED OR REMOVED WHEN NO LONGER CONSISTENT WITH THE TRAFFIC CONTROL SET-UP.
6. ADVANCE WARNING SIGNS ARE TO BE OMITTED ON DRIVEWAYS UNLESS OTHERWISE SPECIFIED IN THE PLANS OR BY THE ENGINEER.
7. THE TRAFFIC CONTROL AND PROTECTION FOR SIDE ROADS, INTERSECTIONS, AND DRIVEWAYS SHALL BE INCLUDED IN THE COST OF SPECIFIED TRAFFIC CONTROL STANDARDS OR ITEMS.

All dimensions are in inches (millimeters) unless otherwise shown.

FILE NAME =	USER NAME = JOHNSTONKD	DESIGNED - L.H.A.	REVISED - A. HOUSEH 10-15-96
pw:\11084EBIDINTEG.illinois.gov\PIWIDOT\Documents\IDOT Offices\District 1\Projects\DI0818\BRAW\Notes\Design\DistStd.dgn			REVISED - T. RAMMACHER 01-06-00
Default	PLOT SCALE = 100.0000' / in.	CHECKED -	REVISED - A. SCHUETZE 07-01-13
	PLOT DATE = 12/12/2018	DATE - 06-89	REVISED - A. SCHUETZE 09-15-16

**STATE OF ILLINOIS
DEPARTMENT OF TRANSPORTATION**

**TRAFFIC CONTROL AND PROTECTION FOR
SIDE ROADS, INTERSECTIONS, AND DRIVEWAYS**

SCALE: NONE SHEET 1 OF 1 SHEETS STA. TO STA.

F.A.P. RTE.	SECTION	COUNTY	TOTAL SHEETS	SHEET NO.
365	2018-092-RS	DUPAGE	21	18
TC-10			CONTRACT NO. 62H24	
ILLINOIS FED. AID PROJECT				

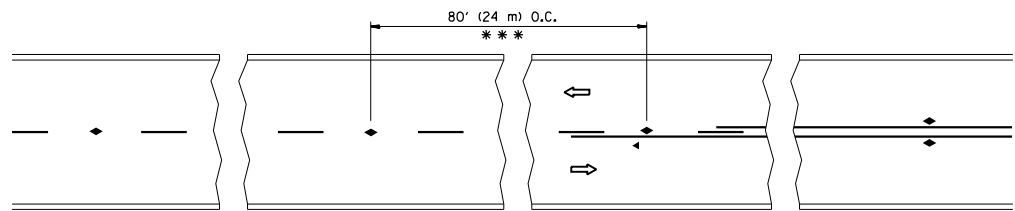

*** REDUCE TO 40' (12 m) O.C. ON CURVES WITH POSTED OR ADVISORY SPEED 45 M.P.H. (70 km/h) OR LESS.

TWO-LANE/TWO-WAY

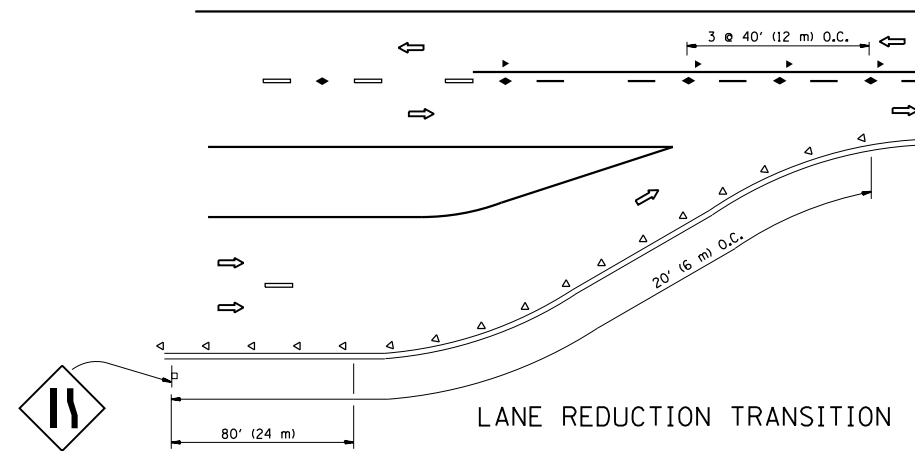

LANE REDUCTION TRANSITION

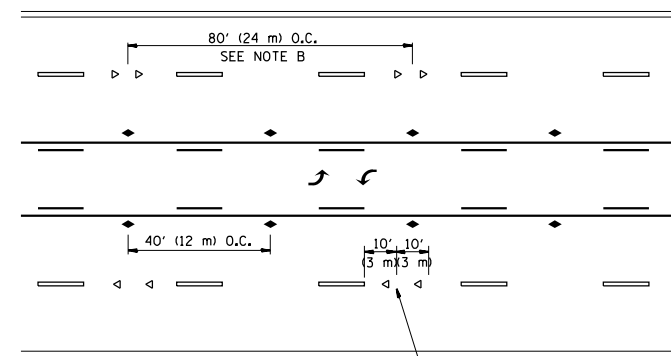

TWO-WAY LEFT TURN

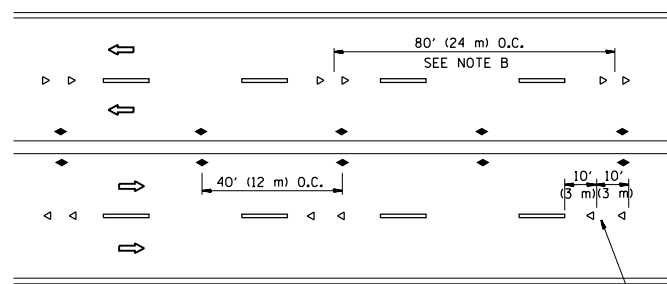

MULTI-LANE/UNDIVIDED

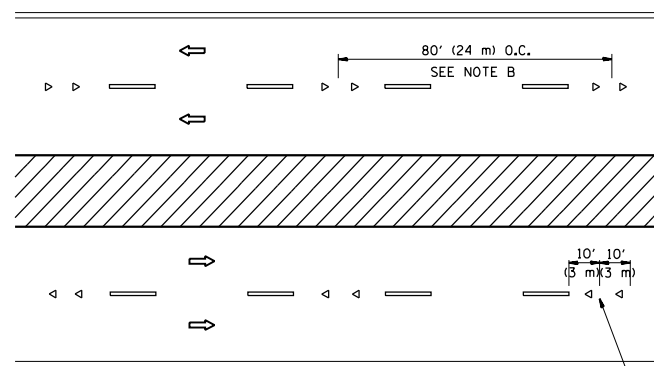

MULTI-LANE/DIVIDED

GENERAL NOTES

1. MARKERS USED WITH DASHED LINES SHALL BE CENTERED IN THE GAP BETWEEN SEGMENTS.
2. MARKERS USED ADJACENT TO SOLID LINES SHALL BE OFFSET 2 TO 3 (50 TO 75) TOWARD TRAFFIC AS SHOWN.
3. MARKERS THROUGH TANGENTS LESS THAN 500' (150 m) IN LENGTH BETWEEN CURVES SHALL BE INSTALLED AT THE LESSER OF THE TWO CURVE SPACINGS.

SYMBOLS

- YELLOW STRIPE
- WHITE STRIPE
- ◀ ONE-WAY AMBER MARKER
- ◁ ONE-WAY CRYSTAL MARKER (W/O)
- ◆ TWO-WAY AMBER MARKER

LANE MARKER NOTES

- A. USE DOUBLE LANE LINE MARKERS SPACED AS SHOWN.
- B. REDUCE TO 40' (12 m) O.C. ON CURVES WHERE ADVISORY SPEEDS ARE 10 M.P.H (20 km/h) LOWER THAN POSTED SPEEDS.

DESIGN NOTES

1. DOUBLE LANE LINE MARKERS SHALL BE USED UNLESS SPECIFIED OTHERWISE.
2. EXCEPT AS SHOWN ON THE LANE REDUCTION TRANSITION AND FREEWAY EXIT RAMP DETAIL, MARKERS ARE NOT TO BE SPECIFIED ON RIGHT EDGE LINES.
3. THE EXACT MARKER LIMITS, SPACING, AND COLOR SHALL BE INCLUDED IN THE PLANS WHEN STANDARD SPECIFICATIONS ARE NOT BEING USED.
4. MARKERS SHOULD NOT BE USED ALONGSIDE CURBS EXCEPT FOR EXTREMELY SHORT SECTIONS OF CURBS WHERE NOT MORE THAN TWO MARKERS WOULD BE INVOLVED.

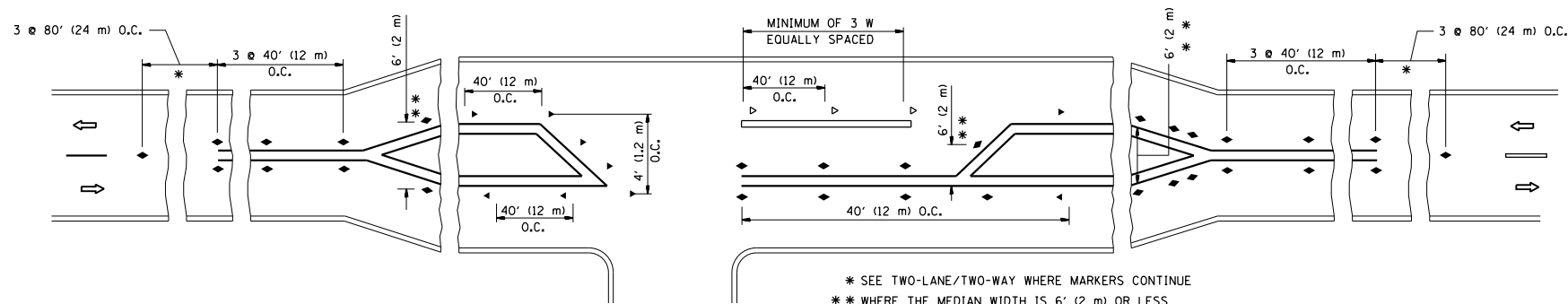

LEFT TURN

* SEE TWO-LANE/TWO-WAY WHERE MARKERS CONTINUE
 ** WHERE THE MEDIAN WIDTH IS 6' (2 m) OR LESS USE TWO-WAY MARKERS.

All dimensions are in inches (millimeters) unless otherwise shown.

FILE NAME =	USER NAME = JOHNSTONKD	DESIGNED -	REVISED - T. RAMMACHER 09-19-94	STATE OF ILLINOIS DEPARTMENT OF TRANSPORTATION	TYPICAL APPLICATIONS RAISED REFLECTIVE PAVEMENT MARKERS (SNOW-PLOW RESISTANT)			F.A.P. RTE.	SECTION	COUNTY	TOTAL SHEETS	SHEET NO.
pw\11084EBIDINTEG.illinois.gov\PIWIDOT\Documents\IDOT Offices\District 1\Projects\DI0818\Drawings\Design\DistStd.dgn	PLOT SCALE = 100.0000' / in.	CHECKED -	REVISED - T. RAMMACHER 03-12-99					365	2018-092-RS	DUPAGE	21	19
PLOT DATE = 12/12/2018	DATE -	REVISED - T. RAMMACHER 01-06-00	REVISED - C. JUCIUS 09-09-09		TC-11			CONTRACT NO. 62H24				
					SCALE: NONE	SHEET NO. 1 OF 1 SHEETS	STA. TO STA.	FED. ROAD DIST. NO. 1 ILLINOIS FED. AID PROJECT				

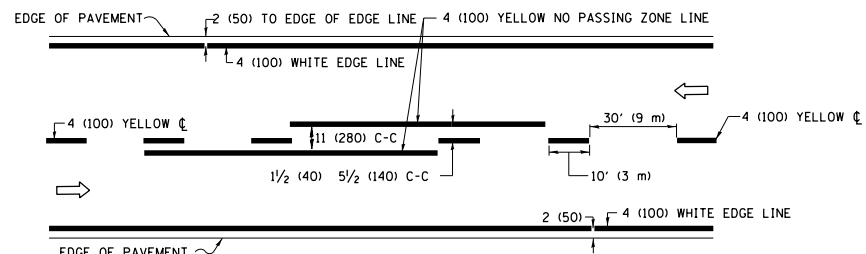

2-LANE ROADWAY

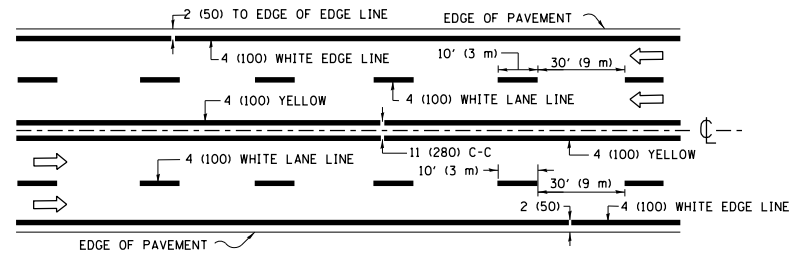

MULTI-LANE UNDIVIDED

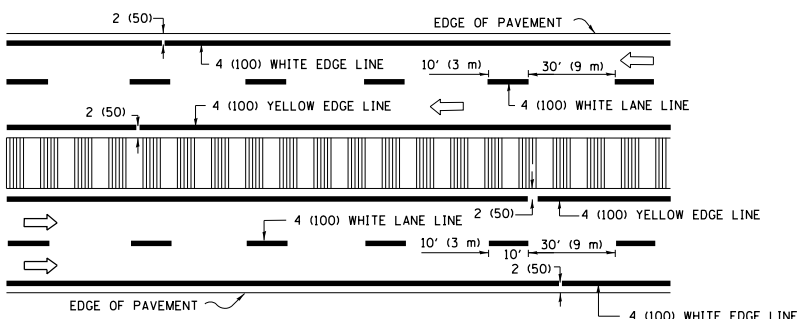

MULTI-LANE DIVIDED WITH MEDIAN

TYPICAL LANE AND EDGE LINE MARKING

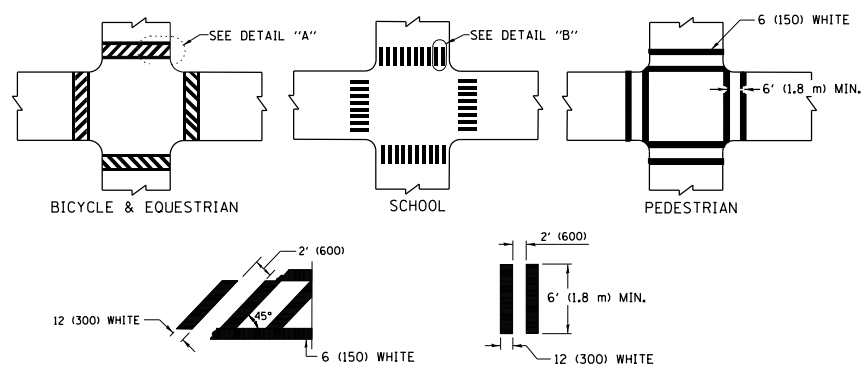

TYPICAL CROSSWALK MARKING

* MARKINGS SHALL BE INSTALLED PARALLEL TO THE CENTERLINE OF THE ROAD WHICH IT CROSSES

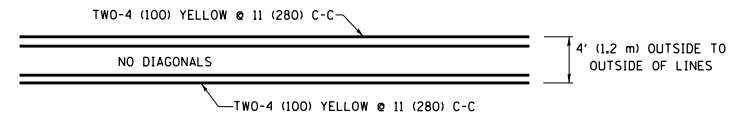

4' (1.2 m) WIDE MEDIANS ONLY

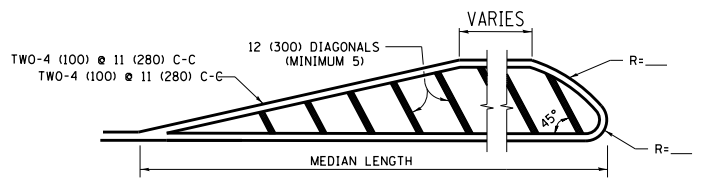

MEDIANS OVER 4' (1.2 m) WIDE

DIAGONAL LINE SPACING: 50' (15 m) C-C (LESS THAN 30MPH (50 km/h))
75' (25 m) C-C 30MPH (50 km/h) TO 45MPH (70 km/h)
150' (45 m) C-C (MORE THAN 45MPH (70 km/h))

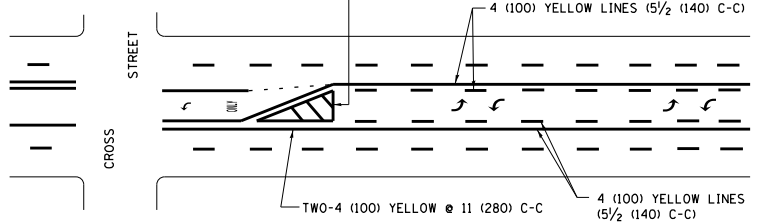

**MEDIAN WITH TWO-WAY LEFT TURN LANE
TYPICAL PAINTED MEDIAN MARKING**

A MINIMUM OF TWO PAIRS OF TURN ARROWS SHALL BE USED, WHITE IN COLOR. ADDITIONAL PAIRS SHALL BE PLACED AT 200' (60 m) TO 300' (90 m) INTERVALS.

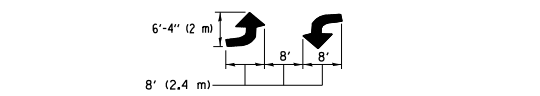

TYPICAL LEFT (OR RIGHT) TURN LANE

TYPICAL TURN LANE MARKING

FULL SIZE LETTERS 8' (2.4 m) AND ARROWS SHALL BE USED.
AREA = 15.6 SQ. FT. (1.5 m²) ONLY AREA = 20.8 SQ. FT. (1.9 m²)
* TURN LANES IN EXCESS OF 400' (120 m) IN LENGTH MAY HAVE AN ADDITIONAL SET OF ARROW - "ONLY" INSTALLED MIDWAY BETWEEN THE OTHER TWO SETS OF ARROW - "ONLY".

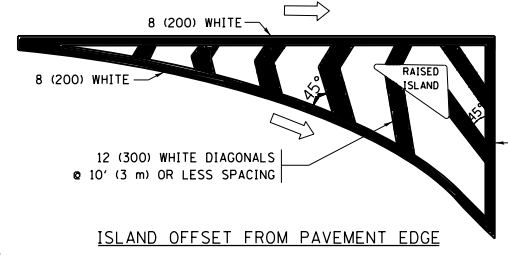

ISLAND OFFSET FROM PAVEMENT EDGE

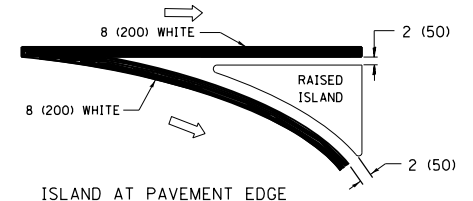

ISLAND AT PAVEMENT EDGE

TYPICAL ISLAND MARKING

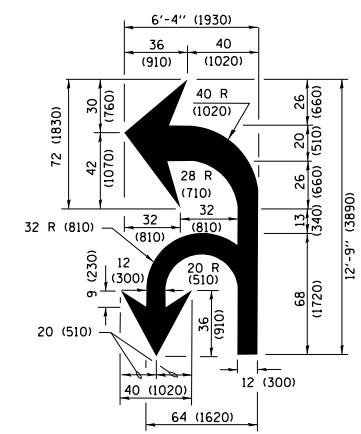

COMBINATION LEFT AND U-TURN

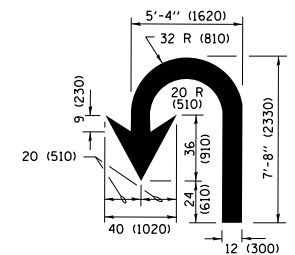

U-TURN

LANE REDUCTION TRANSITION

* LANE REDUCTION ARROWS REQUIRED AT SPEEDS OF 45 MPH OR GREATER OR WHEN SPECIFIED IN PLANS.

D(FT)	SPEED LIMIT
345	30
425	35
500	40
580	45
665	50
750	55

TYPE OF MARKING	WIDTH OF LINE	PATTERN	COLOR	SPACING /REMARKS
CENTERLINE ON 2 LANE PAVEMENT	4 (100)	SKIP-DASH	YELLOW	10' (3 m) LINE WITH 30' (9 m) SPACE
CENTERLINE ON MULTI-LANE UNDIVIDED PAVEMENT	2 @ 4 (100)	SOLID	YELLOW	11 (280) C-C
NO PASSING ZONE LINES FOR ONE DIRECTION FOR BOTH DIRECTIONS	4 (100) 2 @ 4 (100)	SOLID SOLID	YELLOW YELLOW	5 1/2 (140) C-C FROM SKIP-DASH CENTERLINE 11 (280) C-C OMIT SKIP-DASH CENTERLINE BETWEEN
LANE LINES	4 (100) 5 (125) ON FREEWAYS	SKIP-DASH SKIP-DASH	WHITE WHITE	10' (3 m) LINE WITH 30' (9 m) SPACE
DOTTED LINES (EXTENSIONS OF CENTER, LANE OR TURN LANE MARKINGS)	SAME AS LINE BEING EXTENDED	SKIP-DASH	SAME AS LINE BEING EXTENDED	2' (600) LINE WITH 6' (1.8 m) SPACE
EDGE LINES	4 (100)	SOLID	YELLOW-LEFT WHITE-RIGHT	OUTLINE MEDIANS IN YELLOW
TURN LANE MARKINGS	6 (150) LINE; FULL SIZE LETTERS & SYMBOLS (8' (2.4m))	SOLID	WHITE	SEE TYPICAL TURN LANE MARKING DETAIL
TWO WAY LEFT TURN MARKING	2 @ 4 (100) EACH DIRECTION 8' (2.4m) LEFT ARROW	SKIP-DASH AND SOLID IN PAIRS	YELLOW WHITE	10' (3 m) LINE WITH 30' (9 m) SPACE FOR SKIP-DASH; 5 1/2 (140) C-C BETWEEN SOLID LINE AND SKIP-DASH LINE SEE TYPICAL TWO-WAY LEFT TURN MARKING DETAIL
CROSSWALK LINES (PEDESTRIAN) A. DIAGONALS (BIKE & EQUESTRIAN) B. LONGITUDINAL BARS (SCHOOL)	2 @ 6 (150) 12 (300) @ 45° 12 (300) @ 90°	SOLID SOLID SOLID	WHITE WHITE WHITE	NOT LESS THAN 6' (1.8 m) APART 2' (600) APART 2' (600) APART SEE TYPICAL CROSSWALK MARKING DETAILS.
STOP LINES	24 (600)	SOLID	WHITE	PLACE 4' (1.2 m) IN ADVANCE OF AND PARALLEL TO CROSSWALK, IF PRESENT, OTHERWISE, PLACE AT DESIRED STOPPING POINT, PARALLEL TO CROSSROAD CENTERLINE, WHERE POSSIBLE
PAINTED MEDIANS	2 @ 4 (100) WITH 12 (300) DIAGONALS @ 45° NO DIAGONALS USED FOR 4' (1.2 m) WIDE MEDIANS	SOLID	YELLOW; TWO WAY TRAFFIC WHITE; ONE WAY TRAFFIC	11 (280) C-C FOR THE DOUBLE LINE SEE TYPICAL PAINTED MEDIAN MARKING.
GORE MARKING AND CHANNELIZING LINES	8 (200) WITH 12 (300) DIAGONALS @ 45°	SOLID	WHITE	DIAGONALS: 15' (4.5 m) C-C (LESS THAN 30MPH (50 km/h)) 20' (6 m) C-C 30MPH (50 km/h) TO 45MPH (70 km/h) 30' (9 m) C-C (OVER 45MPH (70 km/h))
RAILROAD CROSSING	24 (600) TRANSVERSE LINES; "RR" IS 6' (1.8 m) LETTERS; 16 (400) LINE FOR "X"	SOLID	WHITE	SEE STATE STANDARD 780001 AREA OF: "R"=3.6 SQ. FT. (0.33 m ²) EACH "X"=54.0 SQ. FT. (5.0 m ²)
SHOULDER DIAGONALS (REQUIRED FOR SHOULDERS ≥ 8')	12 (300) @ 45°	SOLID	WHITE - RIGHT YELLOW - LEFT	50' (15 m) C-C (LESS THAN 30MPH (50 km/h)) 75' (25 m) C-C (30 MPH (50 km/h) TO 45MPH (70 km/h)) 150' (45 m) C-C (OVER 45MPH (70 km/h))
U TURN ARROW	SEE DETAIL	SOLID	WHITE	16.3 SF
2 ARROW COMBINATION LEFT AND U TURN	SEE DETAIL	SOLID	WHITE	30.4 SF

FOR FURTHER DETAILS ON PAVEMENT MARKING REFER TO STANDARD SPECIFICATIONS FOR ROAD AND BRIDGE CONSTRUCTION AND STATE STANDARD 780001.

All dimensions are in inches (millimeters) unless otherwise shown.

FILE NAME =	USER NAME = JOHNSTONKD	DESIGNED - EVERS	REVISED - C. JUCIUS 09-09-09
pw\1\084EBIDINTEG\11\inois.gov\PIWDDT\Documents\DOT Offices\District 1\Projects\0181\BRAW\to\Design\DistStd.dgn			REVISED - C. JUCIUS 07-01-13
Default	PLOT SCALE = 100.0000' / in.	CHECKED -	REVISED - C. JUCIUS 12-21-15
	PLOT DATE = 12/12/2018	DATE - 03-19-90	REVISED - C. JUCIUS 04-12-16

**STATE OF ILLINOIS
DEPARTMENT OF TRANSPORTATION**

DISTRICT ONE TYPICAL PAVEMENT MARKINGS			
SCALE: NONE	SHEET 1	OF 1 SHEETS	STA. TO STA.

F.A.P. RTE.	SECTION	COUNTY	TOTAL SHEETS	SHEET NO.
365	2018-092-RS	DUPAGE	21	20
TC-13		CONTRACT NO. 62H24		
ILLINOIS FED. AID PROJECT				

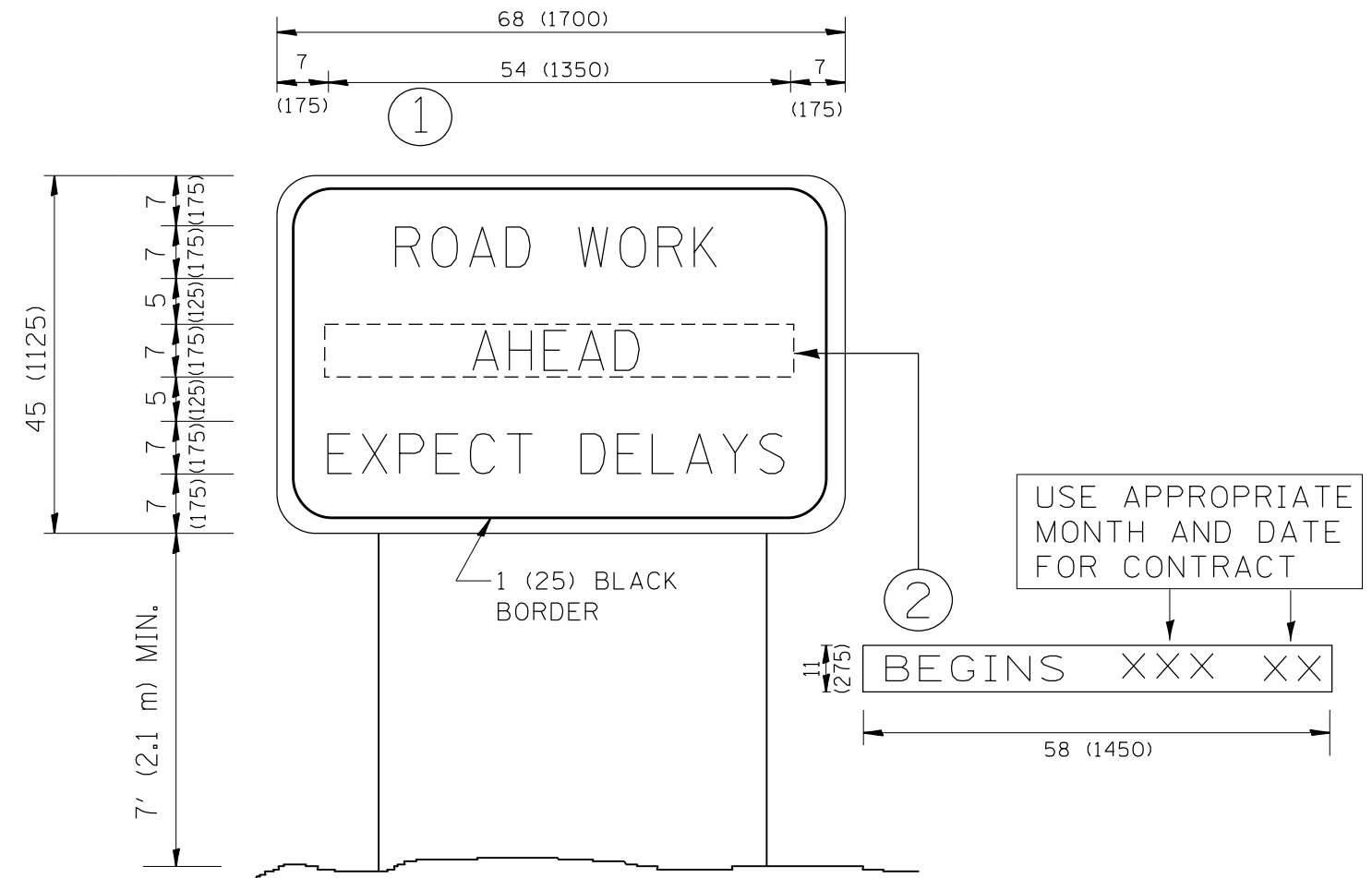

NOTES:

1. USE BLACK LETTERING ON ORANGE BACKGROUND.
2. ERECT SIGNS IN ADVANCE OF THE LOCATION FOR THE "ROAD CONSTRUCTION AHEAD" SIGN AT LOCATIONS AS DIRECTED BY THE ENGINEER.
3. ERECT SIGN ① WITH INSTALLED PANEL ② ONE WEEK PRIOR TO THE START OF CONSTRUCTION.
4. REMOVE PANEL ② SOON AFTER THE START OF CONSTRUCTION.
5. SEE SPECIAL PROVISION FOR "TEMPORARY INFORMATION SIGNING" FOR ADDITIONAL INFORMATION.
6. ONE SIGN ASSEMBLY EQUALS 25.70 SQ. FT. (2.3 SQ. M.)
7. SHALL BE PAID FOR AS TEMPORARY INFORMATION SIGNING.

ALL DIMENSIONS ARE IN INCHES (MILLIMETERS) UNLESS OTHERWISE SHOWN.

FILE NAME =	USER NAME = JOHNSTONKD	DESIGNED -	REVISED - R. MIRS 09-15-97
pw:\IL\084EBIDINTEG.illinois.gov\PWIDOT\Documents\DOT Offices\District 1\Projects\DI084EBIDINTEG\Design\DistStd.dgn			REVISED - R. MIRS 12-11-97
		CHECKED -	REVISED - T. RAMMACHER 02-02-99
		DATE -	REVISED - C. JUCIUS 01-31-07

**STATE OF ILLINOIS
DEPARTMENT OF TRANSPORTATION**

**ARTERIAL ROAD
INFORMATION SIGN**

SCALE: NONE SHEET NO. 1 OF 1 SHEETS STA. TO STA.

F.A.P. RTE.	SECTION	COUNTY	TOTAL SHEETS	SHEET NO.
365	2018-092-RS	DUPAGE	21	21
TC-22		CONTRACT NO. 62H24		
FED. ROAD DIST. NO. 1 ILLINOIS FED. AID PROJECT				