

MODEL: Sheet  
 FILE NAME: B21046.07 IDOT.D6 - PTB 199-030 - W07 - Sangamon County 72159\CADD\Drawings\08272159\_sht\_Roadway\_Plan.dgn

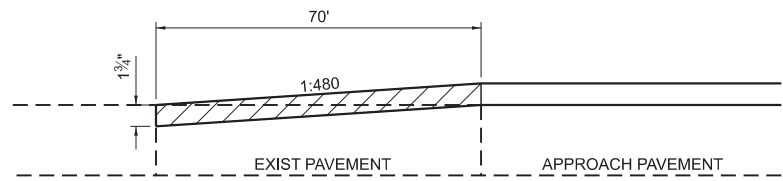

**HOT-MIX ASPHALT SURFACE REMOVAL BUTT-JOINT DETAIL**

**REVISION** 2-29-2024

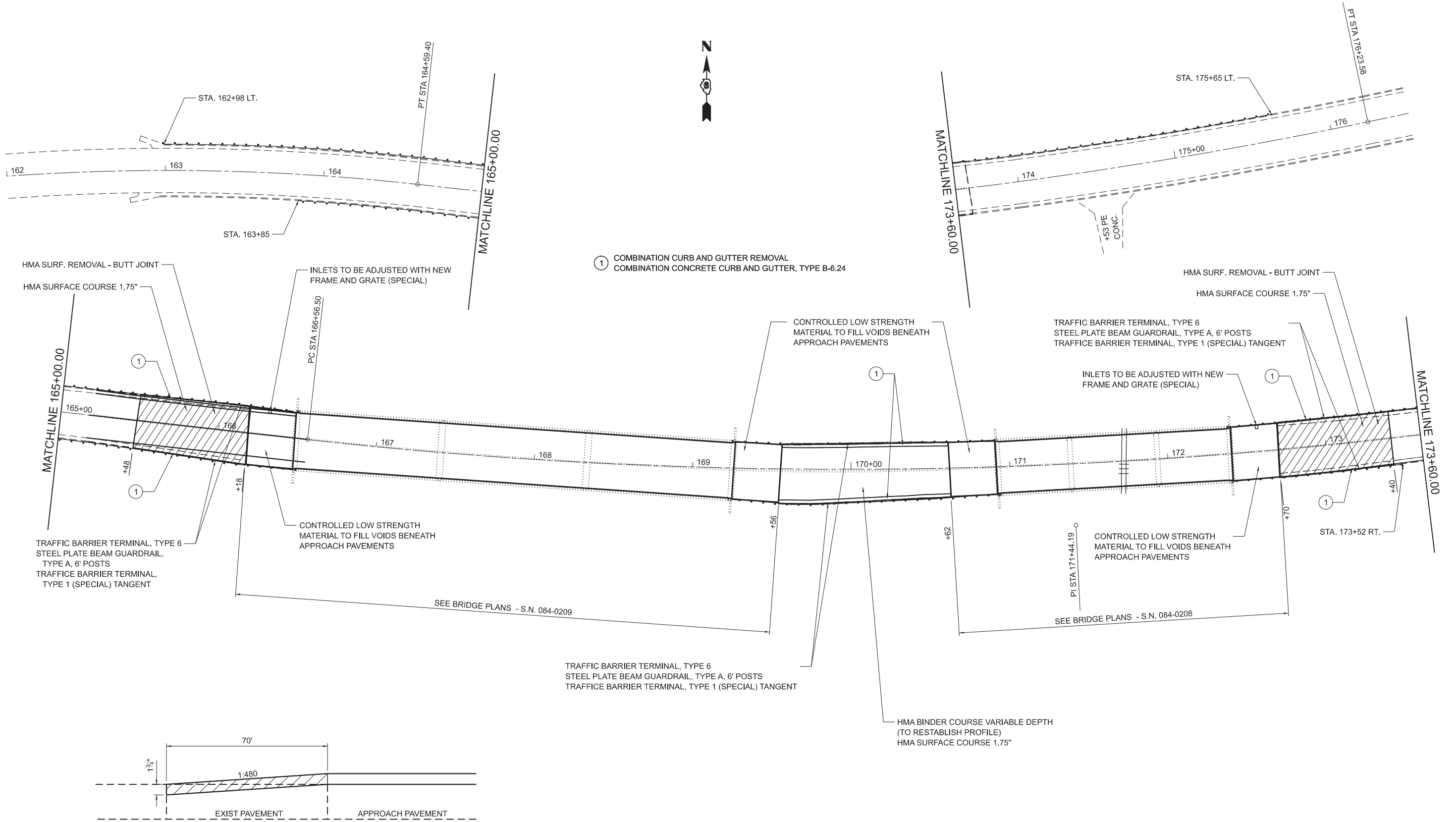

USER NAME = msutheard PLOT SCALE = 0.16666633''/in. PLOT DATE = 2/29/2024	DESIGNED - DRAWN - CHECKED - DATE -	REVISED - REVISED - REVISED - REVISED -
---	--	--

**STATE OF ILLINOIS  
 DEPARTMENT OF TRANSPORTATION**

ROADWAY PLAN			
SCALE:	SHEET 1	OF 1 SHEETS	STA. TO STA.

F.A.U. RTE. 7998	SECTION (110X-2VB-1,B)BDR	COUNTY SANGAMON	TOTAL SHEETS 22	SHEET NO. 8
CONTRACT NO. 72159				
ILLINOIS FED. AID PROJECT				



① SEE STANDARD 701321 FOR ADDITIONAL TRAFFIC CONTROL DETAILS

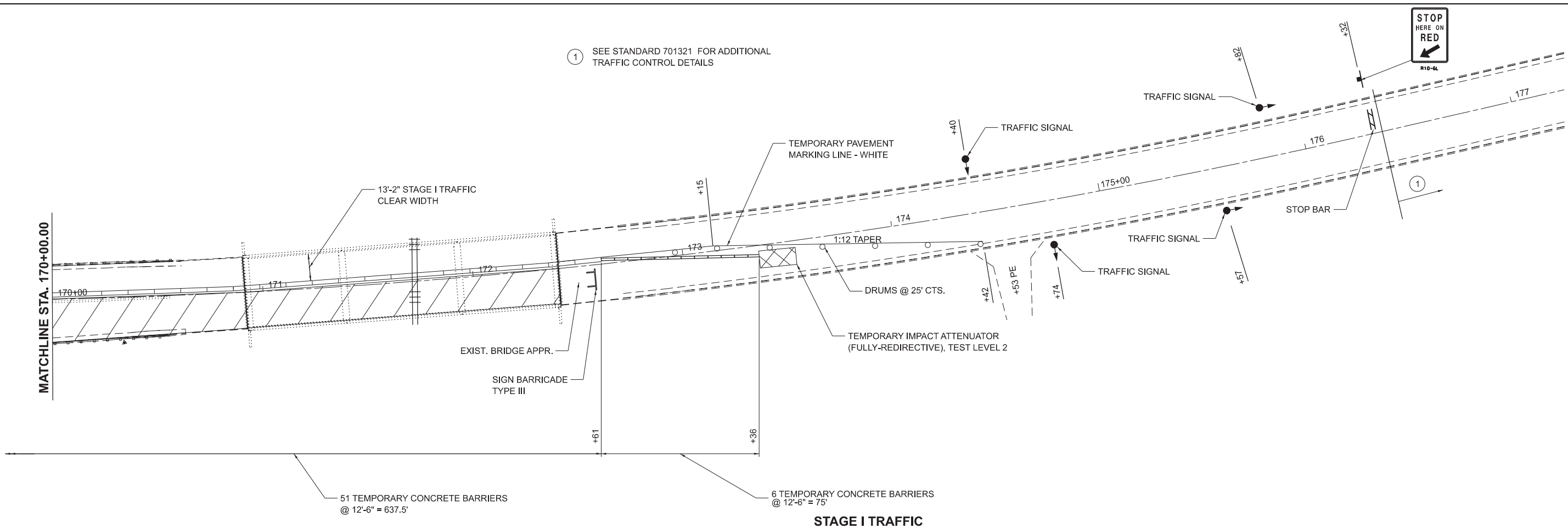

**STAGE I TRAFFIC**

① SEE STANDARD 701321 FOR ADDITIONAL TRAFFIC CONTROL DETAILS

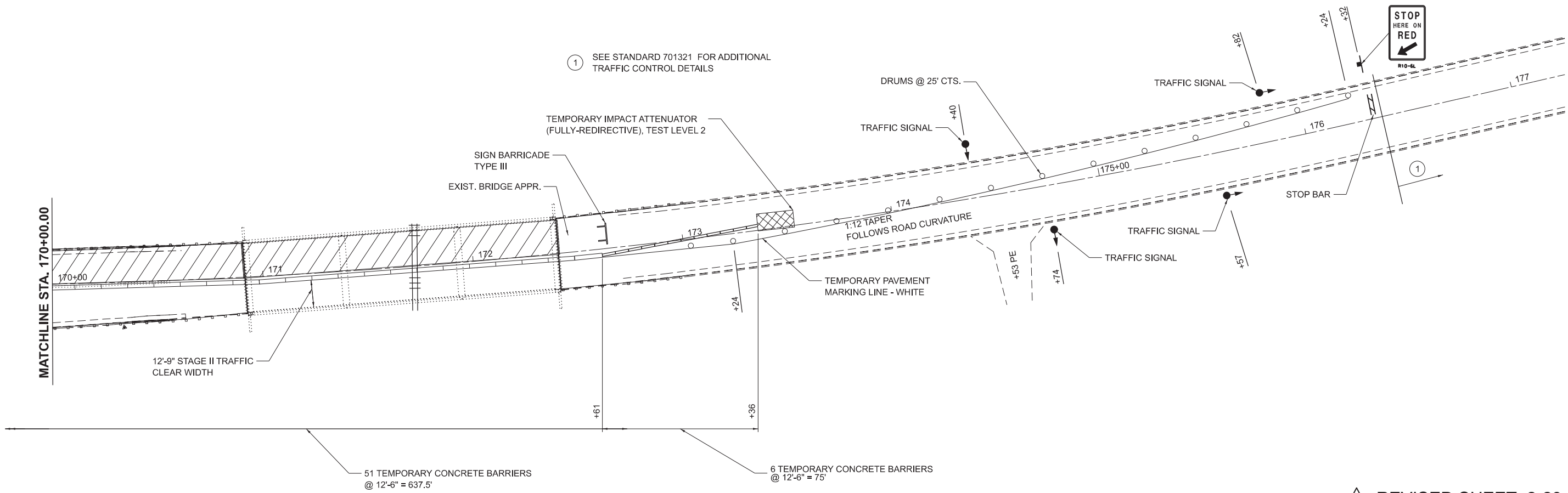

**STAGE II TRAFFIC**

△ REVISED SHEET 2-29-2024

MODEL: Sheet 2  
 FILE NAME: B21046.07 IDOT D6 - PTB 199-030 - W07 - Sangamon County 72159 CAD Data\Cad\Sheet\0672159\_sht\_StageI.dgn  
 Professional Design Firm No. 184-006516



USER NAME = msutheard	DESIGNED -	REVISED -
PLOT SCALE = 0.16666633''/in.	DRAWN -	REVISED -
PLOT DATE = 2/29/2024	CHECKED -	REVISED -
	DATE -	REVISED -

**STATE OF ILLINOIS**  
**DEPARTMENT OF TRANSPORTATION**

<b>STAGING PLAN</b>			
SCALE:	SHEET 2	OF 3 SHEETS	STA. TO STA.

F.A.U. RTE. 7998	SECTION (110X-2VB-1,B)BDR	COUNTY SANGAMON	TOTAL SHEETS 22	SHEET NO. 11
CONTRACT NO. 72159				
ILLINOIS FED. AID PROJECT				