

INDEX OF SHEETS

- 1 COVER
- 2 SUMMARY OF QUANTITIES
- 3 SCHEDULES
- 4 TYPICAL CROSS SECTIONS
- 5 MISCELLANEOUS DETAILS
- 6 ROUTE 9 INTERSECTION DETAILS
- 7 C.H. 13 INTERSECTION DETAILS
- 8 RADIUS GUARDRAIL DETAIL
- 9-18 PLAN VIEW

STATE OF ILLINOIS

DEPARTMENT OF TRANSPORTATION

PROPOSED HIGHWAY PLANS

**FAS ROUTE 491 (C.H. 15)
21-00152-02-RS
MILL & RESURFACE
MCLEAN COUNTY
JOB # C-95-009-24
PROJECT ATPL (285)
FUNDING: STR, TARP, & MATCHING**

F.A.S. RTE.	SECTION	COUNTY	TOTAL SHEETS	SHEET NO.
491	21-00152-02-RS	MCLEAN	18	1
		ILLINOIS	CONTRACT NO. 91637	

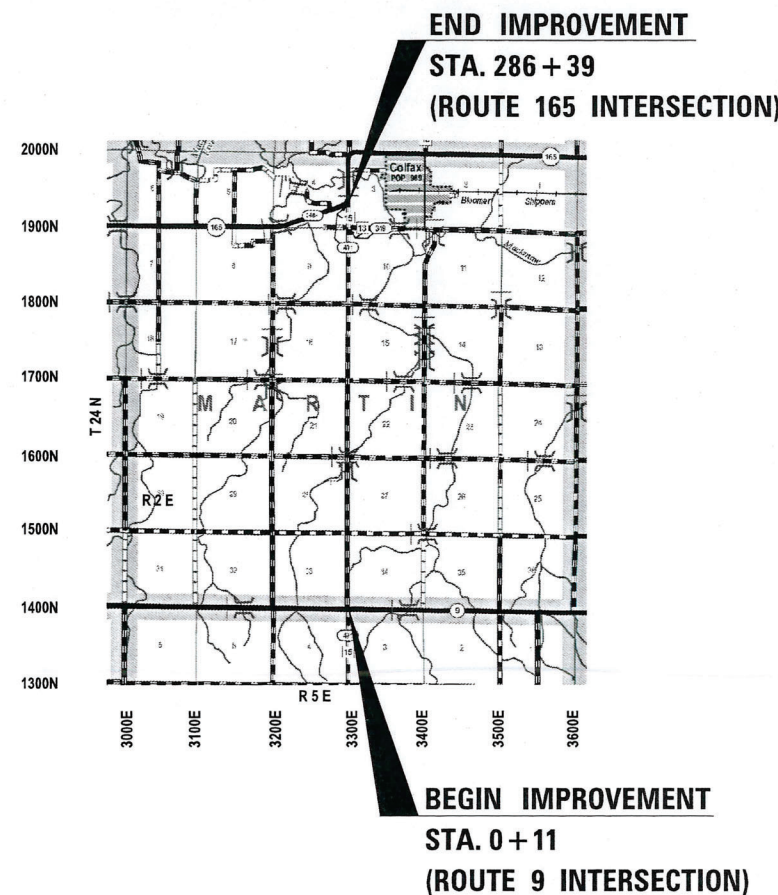
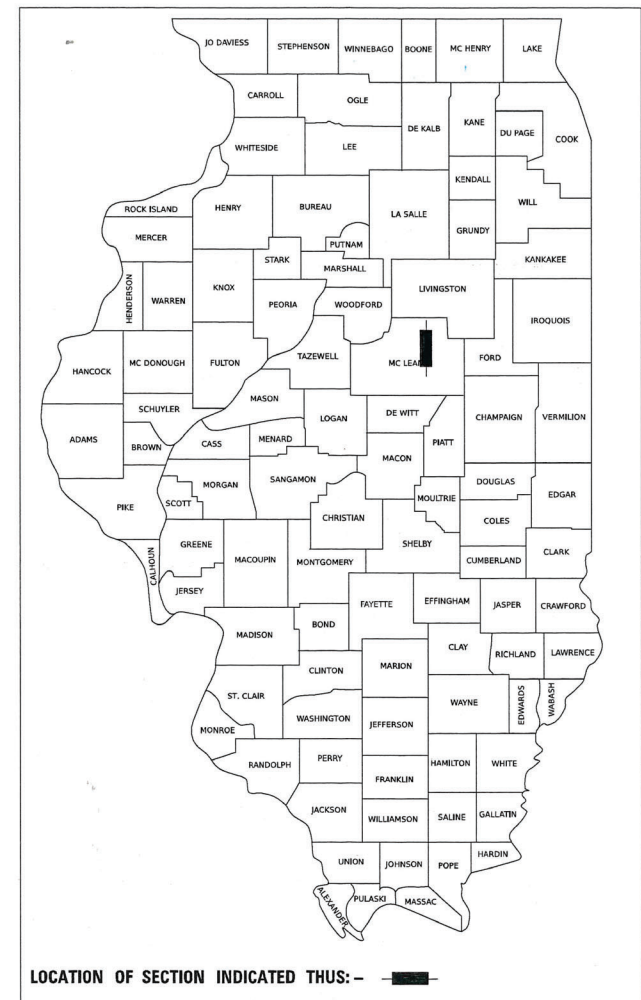

FUNCTIONAL CLASSIFICATION
MAJOR COLLECTOR
2020 ADT = 830

P.C. = 80% S.U. = 5% M.U. = 15%

PLANS NOT TO SCALE
STATIONING FOR CONSTRUCTION PURPOSES ONLY

J.U.L.I.E.
JOINT UTILITY LOCATION INFORMATION FOR EXCAVATION
1-800-892-0123
OR 811

CONTRACT NO. 91637

GROSS LENGTH = 28,628 FT. = 5.422 MILES
NET LENGTH = 28,628 FT. = 5.422 MILES

11/15/2023
DATE



Luke D. Hohlin
LUKE HOHULIN, P.E.
NO. 062-065157
EXPIRATION DATE 11/30/25

STATE OF ILLINOIS
DEPARTMENT OF TRANSPORTATION
DIVISION OF HIGHWAY

APPROVED November 15 2023
Jonny Stokke
MCLEAN CO. HIGHWAY DEPT, COUNTY ENGINEER

STATE OF ILLINOIS
DEPARTMENT OF TRANSPORTATION
PASSED December 4 2023
Brian K Trygg
DISTRICT 5 ENGINEER OF LOCAL ROADS & STREETS

RELEASING FOR BID BASED ON LIMITED REVIEW
December 4 2023
Kensil A. Garnett
REGION 3 ENGINEER

**PRINTED BY THE AUTHORITY
OF THE STATE OF ILLINOIS**

SUMMARY OF QUANTITIES			
ITEM NO.	ITEM	UNIT	TOTAL QUANTITY
20200100	EARTH EXCAVATION	CU YD	47
20200500	EARTH EXCAVATION (WIDENING)	CU YD	4,205
35101400	AGGREGATE BASE COURSE, TYPE B	TON	60
35600650	HOT-MIX ASPHALT BASE COURSE WIDENING, 4"	SQ YD	25,230
40600250	RAPID SETTING POLYMER MODIFIED EMULSION	POUND	36,305
40600290	BITUMINOUS MATERIALS (TACK COAT)	POUND	64,500
40600370	LONGITUDINAL JOINT SEALANT	FOOT	28,435
40600990	TEMPORARY RAMP	SQ YD	195
40602965	HOT-MIX ASPHALT BINDER COURSE, IL-9.5FG, N50	TON	6,700
40604050	HOT-MIX ASPHALT SURFACE COURSE, IL-9.5, MIX "C", N50	TON	8,100
40800029	BITUMINOUS MATERIALS (TACK COAT)	POUND	1,100
40800050	INCIDENTAL HOT-MIX ASPHALT SURFACING	TON	275
44000157	HOT-MIX ASPHALT SURFACE REMOVAL, 2"	SQ YD	69,450
44000500	COMBINATION CURB AND GUTTER REMOVAL	FOOT	265
60604400	COMBINATION CONCRETE CURB AND GUTTER, TYPE B-6.18	FOOT	155
60609800	COMBINATION CONCRETE CURB AND GUTTER, TYPE M-6.18	FOOT	136
* 63000001	STEEL PLATE BEAM GUARDRAIL, TYPE A, 6 FOOT POSTS	FOOT	812.5
* 63000030	STRONG POST GUARDRAIL ATTACHED TO CULVERT	FOOT	62.5
* 63000350	LONG-SPAN GUARDRAIL OVER CULVERT, 12 FT 6 IN SPAN	FOOT	75
* 63100169	TRAFFIC BARRIER TERMINAL, TYPE 1 (SPECIAL) FLARED	EACH	8
63200310	GUARDRAIL REMOVAL	FOOT	756.25
64200108	SHOULDER RUMBLE STRIPS, 8 INCH	FOOT	55,900
67100100	MOBILIZATION	L SUM	1
* 78001120	PAINT PAVEMENT MARKING - LINE 5"	FOOT	68,180
* 78100100	RAISED REFLECTIVE PAVEMENT MARKERS	EACH	359
X4401198	HOT-MIX ASPHALT SURFACE REMOVAL, VARIABLE DEPTH	SQ YD	3,390
* X6330725	STEEL PLATE BEAM GUARDRAIL (SHORT RADIUS)	FOOT	56.25
X7010216	TRAFFIC CONTROL AND PROTECTION, (SPECIAL)	L SUM	1
Z0013798	CONSTRUCTION LAYOUT	L SUM	1
* Z0052000	REPAIR STEEL PLATE BEAM GUARDRAIL, TYPE A	FOOT	12.5
Z0055300	RUMBLE STRIP	EACH	8

***SPECIALTY ITEMS**

HMA MIXTURE REQUIREMENTS				
Location(s):	F.A.S. 491	F.A.S. 491	F.A.S. 491	F.A.S. 491
Mixture Use(s):	Base Course	Binder	Surface	Incidental
PG:	PG 64-22	PG 64-22	PG 64-22	PG 64-22
Design Air Voids:	4.0% @ N50	4.0% @ N50	4.0% @ N50	4.0% @ N50
Mixture Composition:	IL-19	IL-9.5FG	IL-9.5	IL-9.5
Friction Aggregate:	N/A	N/A	Mixture C	Mixture C
Mixture Weight:	112	112	112	112
Quality Management Program:	QC/QA	QC/QA	QC/QA	QC/QA
Sublot Size	N/A	N/A	N/A	N/A
Material Transfer Device (Required?):	No	No	Yes	No

STATE STANDARD DETAILS

- 000001-08 STANDARD SYMBOLS, ABBREVIATIONS, AND PATTERNS
- 001006 DECIMAL OF AN INCH AND OF A FOOT
- 606001-08 CONCRETE CURB TYPE B AND COMBINATION CONCRETE CURB AND GUTTER
- 630001-13 STEEL PLATE BEAM GUARDRAIL
- 630101-11 STRONG POST GUARDRAIL ATTACHED TO CULVERT
- 630106-02 LONG-SPAN GUARDRAIL OVER CULVERT
- 630301-09 SHOULDER WIDENING FOR TYPE 1 (SPECIAL) GUARDRAIL TERMINALS
- 642006-01 SHOULDER RUMBLE STRIPS, 8"
- 701001-02 OFF-RD OPERATIONS, 2L, 2W, MORE THAN 15' (4.5 m) AWAY
- 701006-05 OFF-RD OPERATIONS, 2L, 2W, 15' TO 24" FROM PAVEMENT EDGE
- 701011-04 OFF-RD MOVING OPERATIONS, 2L, 2W, DAY ONLY
- 701201-05 LANE CLOSURE, 2L, 2W, DAY ONLY, FOR SPEEDS ≥ 45 MPH
- 701301-04 LANE CLOSURE, 2L, 2W, SHORT TIME OPERATIONS
- 701306-04 LANE CLOSURE, 2L, 2W, SLOW MOVING OPERATIONS DAY ONLY, FOR SPEEDS ≥ 45 MPH
- 701326-04 LANE CLOSURE, 2L, 2W, PAVEMENT WIDENING FOR SPEEDS ≥ 45 MPH
- 701901-09 TRAFFIC CONTROL DEVICES
- 781001-04 TYPICAL APPLICATIONS RAISED REFLECTIVE PAVEMENT MARKERS
- BLR 18-6 TRAFFIC CONTROL DEVICES - DAY LABOR MAINTENANCE
- BLR 22-7 TYPICAL APPLICATIONS OF TRAFFIC CONTROL DEVICES FOR CONSTRUCTION ON RURAL LOCAL HIGHWAYS

GENERAL NOTES

- MICROSTATION AND GEOPAK FILES OF THIS PROJECT WILL BE MADE AVAILABLE TO THE CONTRACTOR AFTER CONTRACT AWARD. IF THERE IS A CONFLICT BETWEEN THE ELECTRONIC FILES AND THE PRINTED CONTRACT PLAN AND DOCUMENTS, THE PRINTED CONTRACT PLANS AND DOCUMENTS SHALL TAKE PRECEDENCE OVER THE ELECTRONIC FILES. THE CONTRACTOR SHALL ACCEPT ALL RISK ASSOCIATED WITH USING THE ELECTRONIC FILES AND SHALL HOLD THE DEPARTMENT HARMLESS FOR ANY ERRORS OR OMISSIONS IN THE ELECTRONIC FILES AND THE DATA CONTAINED THEREIN. ERRORS OR DELAYS RESULTING FROM THE USE OF THE ELECTRONIC FILES BY THE CONTRACTOR SHALL NOT RESULT IN AN EXTENSION OF TIME FOR ANY INTERIM OR FINAL COMPLETION DATE OR SHALL NOT BE CONSIDERED CAUSE FOR ADDITIONAL COMPENSATION. THE CONTRACTOR SHALL NOT USE, SHARE, OR DISTRIBUTE THESE ELECTRONIC FILES EXCEPT FOR THE PURPOSE OF CONSTRUCTING THIS CONTRACT. ANY CLAIMS BY THIRD PARTIES DUE TO USE OR ERRORS SHALL BE THE SOLE RESPONSIBILITY OF THE CONTRACTOR. THE CONTRACTOR SHALL INCLUDE THIS DISCLAIMER WITH THE TRANSFER OF THESE ELECTRONIC FILES TO ANY OTHER PARTIES AND SHALL INCLUDE APPROPRIATE LANGUAGE BINDING THEM TO SIMILAR RESPONSIBILITIES.
- THE EXISTING TOPOGRAPHIC INFORMATION FOR THIS PROJECT IS BASED ON A TOPOGRAPHIC SURVEY PREPARED BY THE COUNTY. THE CONTRACTOR IS RESPONSIBLE FOR VERIFYING THE TOPOGRAPHIC INFORMATION INDICATED ON THE DRAWINGS AND SHALL DETERMINE THE EXACT LOCATION AND ELEVATION OF ALL EXISTING DATA, ABOVE OR BELOW GROUND, SHOWN OR NOT SHOWN, PRIOR TO CONSTRUCTION. DISCREPANCIES IN EXISTING TOPOGRAPHIC DATA SHALL BE REPORTED TO THE ENGINEER IMMEDIATELY FOR REVIEW. COSTS TO VERIFY EXISTING TOPOGRAPHIC INFORMATION SHALL BE CONSIDERED INCIDENTAL TO THE CONTRACT.
- A FULL DEPTH SAW CUT SHALL BE PROVIDED AT ALL REMOVAL LIMITS. THIS WORK SHALL BE INCLUDED IN THE COST OF REMOVAL ITEMS.
- ALL ELEVATIONS SHOWN IN THE PLANS ARE BASED ON NORTH AMERICAN DATUM OF 1983 (NAD83) AND STATE PLANE COORDINATES, ILLINOIS EAST ZONE.
- THE CONTRACTOR SHALL BE RESPONSIBLE FOR REPAIRS TO ANY UTILITY LINES AND EXISTING IMPROVEMENTS TO REMAIN THAT ARE DAMAGED AS A RESULT OF THE WORK.
- THE COUNTY RESERVES THE RIGHT TO REDUCE ANY QUANTITY OR DELETE ANY PAY ITEMS FROM THIS CONTRACT. NO ADDITIONAL COMPENSATION WILL BE ALLOWED.
- ALL TEMPORARY PAVEMENT MARKINGS & STRIPING WILL BE DONE BY OTHERS (MCLEAN COUNTY).

MODEL: MODELNAMES
FILE NAME: \$FILE\$

USER NAME = \$USERS	DESIGNED -	REVISED -
	DRAWN -	REVISED -
PLOT SCALE = \$SCALE\$	CHECKED -	REVISED -
PLOT DATE = \$DATES	DATE -	REVISED -

**STATE OF ILLINOIS
DEPARTMENT OF TRANSPORTATION**

**COLFAX RD (C.H. 15)
SUMMARY OF QUANTITIES**

SCALE: SHEET 2 OF 18 SHEETS STA. TO STA. ____

F.A.S. RTE.	SECTION	COUNTY	TOTAL SHEETS	SHEET NO.
491	21-00152-02-RS	MCLEAN	18	2
CONTRACT NO. 91637				
ILLINOIS FED. AID PROJECT				

TEMPORARY RAMPS 40600990	
LOCATION	QUANTITY (SQ YD)
Route 9	44.4
BCS Plant	13.9
1500N LT	10.0
1500N RT	10.0
1600N LT	12.2
1600N RT	12.2
1700N LT	11.1
1700N RT	11.1
1800N LT	11.1
1800N RT	8.9
CH 13	16.7
Route 165	33.3
QUANTITY TOTAL	195

COMBINATION CURB AND GUTTER REMOVAL 44000500		
LOCATION	QUANTITY (FT) LT	QUANTITY (FT) RT
NE Quad at Route 9	55	
NW Quad at Route 9		55
NE Quad at CH 13		155
QUANTITY TOTAL	55	210

COMBINATION CONCRETE CURB AND GUTTER, TYPE M-6.18 60609800		
LOCATION	QUANTITY (FT) LT	QUANTITY (FT) RT
Intersection at Route 9	68	68
QUANTITY TOTAL	68	68

COMBINATION CONCRETE CURB AND GUTTER, TYPE B-6.18 60604400		
LOCATION	QUANTITY (FT) LT	QUANTITY (FT) RT
Intersection at CH 13 - NE Quad		155
QUANTITY TOTAL	0	155

SHOULDER RUMBLE STRIPS, 8 INCH 64200108	
LEFT	RIGHT
STA 0+89 - STA 285+00	STA 0+89 - STA 286+88
QUANTITY TOTAL	55900 FT

EARTH EXCAVATION WIDENING, (6" DEPTH) SCHEDULE 20200500		
	4' WIDENING LEFT	4' WIDENING RIGHT
	STA 0+89 - STA 285+00	STA 0+89 - STA 266+21
		STA 268+66 - STA 286+88
QUANTITY TOTAL	2105 CU YD	2100 CU YD

HOT MIX ASPHALT BASE COURSE WIDENING, (4" DEPTH) SCHEDULE 35600650		
	4' WIDENING LEFT	4' WIDENING RIGHT
	STA 0+89 - STA 285+00	STA 0+89 - STA 266+21
		STA 268+66 - STA 286+88
QUANTITY TOTAL	12628 SQ YD	12602 SQ YD

RUMBLE STRIP Z0055300			
LOCATION			
Route 9 int.	SBL	4	EACH
Route 165 int.	NBL	4	EACH
QUANTITY TOTAL		8	EACH

MILLING SCHEDULE		
	HMA SURFACE REMOVAL, 2" 44000157	HMA SURFACE REMOVAL, VARIABLE DEPTH X4401198
LOCATION	STA 0+89 - STA 285+00 (22')	intersection at Route 9
		intersection at CH 13
		intersection at Route 165
		INCIDENTALS
QUANTITY TOTAL	69450 SQ YD	3390 SQ YD

PAVING SCHEDULE		
	HMA BINDER COURSE, 1-1/4" 40602965	HMA SURFACE COURSE, 1-1/2" 40604050
LOCATION	STA 0+65 - STA 266+21 (30')	STA 0+11 - STA 266+21 (30')
	STA 266+21 - STA 268+66 (26')	STA 266+21 - STA 268+66 (26')
	STA 268+66 - STA 285+00 (30')	STA 268+66 - STA 285+00 (30')
		STA 285+00 - STA 268+88
QUANTITY TOTAL	6700 TONS	8100 TONS

LONGITUDINAL JOINT SEALANT SCHEDULE 40600370	
	STA 00+65 - STA 285+00
QUANTITY TOTAL	28435 FT

GUARDRAIL REMOVAL SCHEDULE				
LOCATION	LANE	LOCATION		GUARDRAIL REMOVAL (FT) 63200310
2	RT	94+13	97+63	350
	LT	94+82	98+32	350
3	RT	Intersection of CH 15 and 1600N Road (NE Quad)		56.25
QUANTITY TOTAL				756.25

RAPID SETTING POLYMER MODIFIED EMULSION SCHEDULE 40600250	
	STA 00+65 - STA 285+00 (28')
QUANTITY TOTAL	36305 POUNDS

GUARDRAIL SCHEDULE										
LOCATION	LANE	PROPOSED STATION		OFFSET NEW EOP (FT)	SPBGR TY A 6' POST 63000001	SPGR ATT TO CULVERT 63000030	LSG OV CUL 12' 6" SPAN 63000350	SPBG (SHORT RADIUS) X6330725	REPAIR SPBG, TYPE A Z0052000	TR BAR TRM T1 SPL FLARE 63100169 EACH TERMINAL IS 25 FT
1	RT	STA 22+07	STA 24+20	3	125		37.5			2
	LT	STA 22+32	STA 24+45		125		37.5			2
2	RT	STA 94+01	STA 97+64	3	281.25	31.25				2
	LT	STA 94+82	STA 98+45		281.25	31.25				2
3	RT	Intersection of CH 15 and 1600N Road (NE Quad)		existing				56.25	12.5	
QUANTITY TOTAL					812.5 FT	62.5 FT	75 FT	56.25 FT	12.5 FT	8 EACH

MODEL: RUMBLE STRIPS
FILE NAME: SFILES

USER NAME = \$USERS	DESIGNED -	REVISED -
	DRAWN -	REVISED -
PLOT SCALE = \$\$SCALE\$	CHECKED -	REVISED -
PLOT DATE = \$DATES	DATE -	REVISED -

STATE OF ILLINOIS
DEPARTMENT OF TRANSPORTATION

COLFAX RD (C.H. 15)
SCHEDULES

SCALE: SHEET 3 OF 18 SHEETS STA. TO STA. ____

F.A.S RTE.	SECTION	COUNTY	TOTAL SHEETS	SHEET NO.
491	21-00152-02-RS	MCLEAN	18	3
CONTRACT NO. 91637				
ILLINOIS FED. AID PROJECT				

EXISTING TYPICAL CROSS SECTION

21-00152-02-RS
COLFAX RD (C.H. 15)
STA. 0+11 TO STA. 286+39
(NOT TO SCALE)

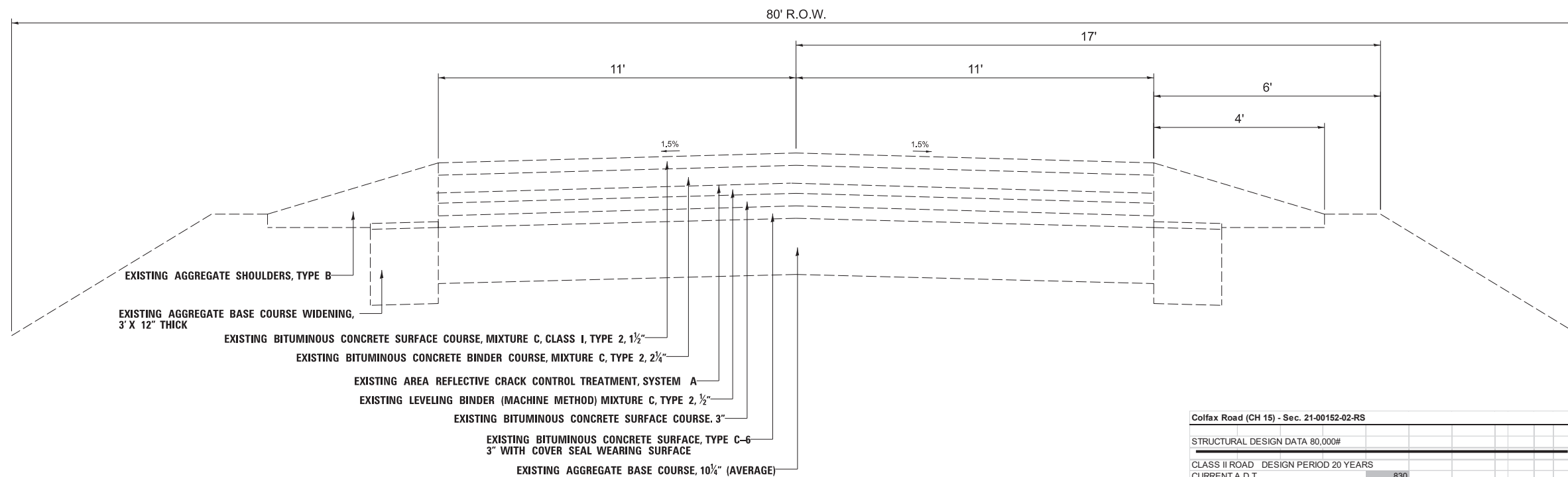

Colfax Road (CH 15) - Sec. 21-00152-02-RS					
STRUCTURAL DESIGN DATA 80,000#					
CLASS II ROAD DESIGN PERIOD 20 YEARS					
CURRENT A.D.T.	830				
STRUCTURAL DESIGN TRAFFIC:	1013	YEAR:	2043		
PERCENT OF DESIGN TRAFFIC IN DESIGN LANE:					
P.C.	80%	S.U.	5%	M.U.	15%
P.C.	810	S.U.	51	M.U.	152
MINIMUM SOIL SUPPORT: IBR= 3.0					
TRAFFIC FACTOR (T.F.)= 0.644					
STRUCTURAL NUMBER (D _s)= 3.90					
PAVEMENT STRUCTURE MATERIALS:					
SURFACE: PROPOSED HMA PAVEMENT 2.75 @ 0.40 a1= 1.10					
BASE: EXISTING HMA PAVEMENT 8.75 @ 0.23 a2= 2.01					
SUBBASE: EXISTING AGGREGATE BASE COURSE 10.25 @ 0.10 a3= 1.03					
PROPOSED D _s TOTAL					4.14

PROPOSED TYPICAL CROSS SECTION

21-00152-02-RS
COLFAX RD (C.H. 15)
STA. 0+11 TO STA. 286+39
(NOT TO SCALE)

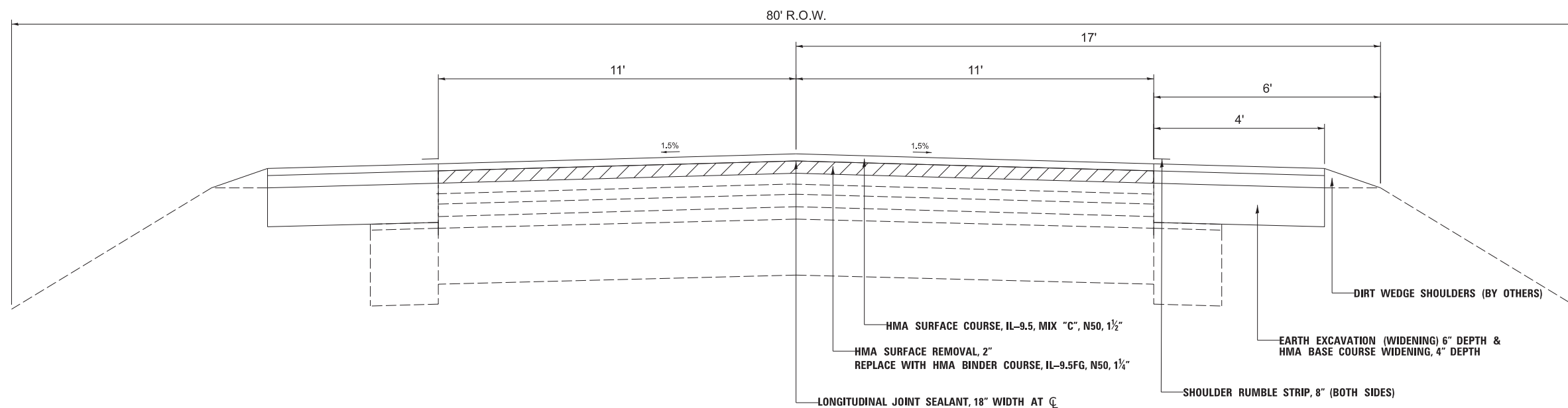

MODEL: SHORLNAME\$
FILE NAME: \$FILE\$

USER NAME = \$USERS	DESIGNED -	REVISED -
	DRAWN -	REVISED -
PLOT SCALE = \$\$SCALE\$	CHECKED -	REVISED -
PLOT DATE = \$DATES	DATE -	REVISED -

STATE OF ILLINOIS
DEPARTMENT OF TRANSPORTATION

COLFAX RD (C.H. 15)
TYPICAL CROSS SECTIONS

SCALE: SHEET 4 OF 18 SHEETS STA. TO STA. _____

F.A.S RTE.	SECTION	COUNTY	TOTAL SHEETS	SHEET NO.
491	21-00152-02-RS	MCLEAN	18	4
CONTRACT NO. 91637				
ILLINOIS FED. AID PROJECT				

TYPICAL RURAL PRIVATE ENTRANCE

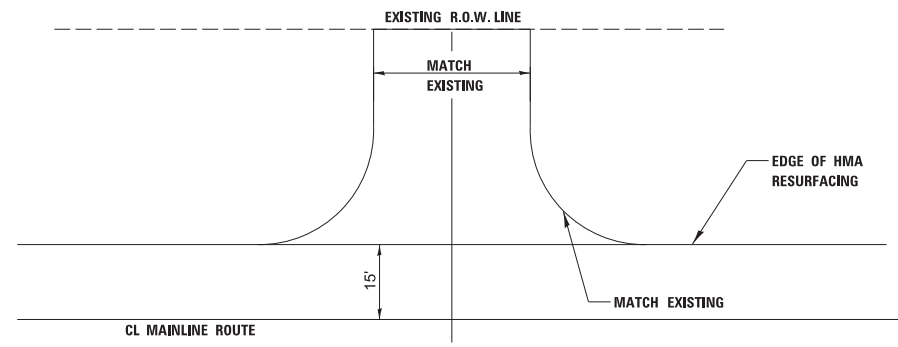

PLAN A

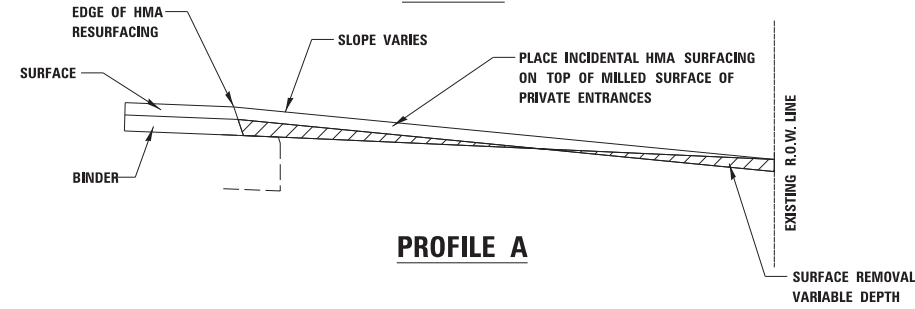

PROFILE A

TYPICAL RURAL MAILBOX TURNOUT

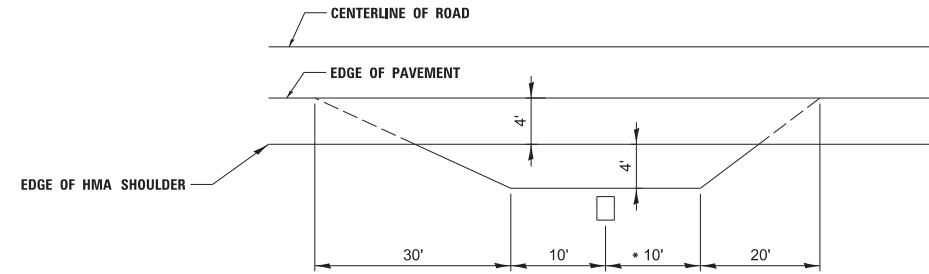

*NOTE: MULTIPLE MAILBOX CLUSTERS TO BE EXTENDED 2' FOR EACH ADDITIONAL MAILBOX

PLAN B

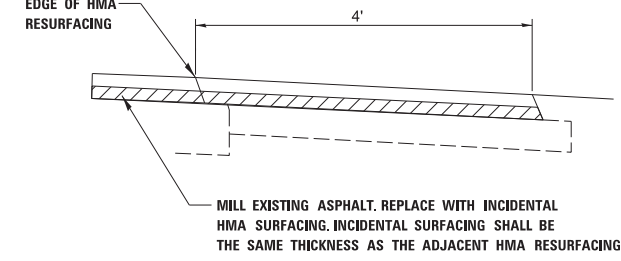

PROFILE B

SAW CUT RUMBLE STRIP STANDARD

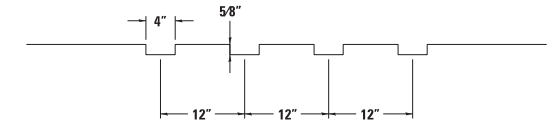

NOTES:

- 1) SAWCUTS 4" WIDE X 5/8" DEEP ON 12" CENTERS
- 2) MEASUREMENTS FROM STOP SIGN TO FAR END OF RUMBLE STRIP
- 3) MUST BE CUT AFTER SHOULDERS

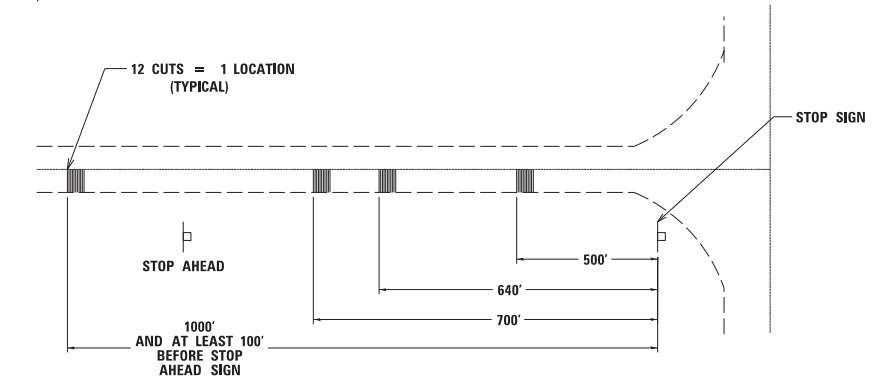

CURB & GUTTER OUTLET DETAIL

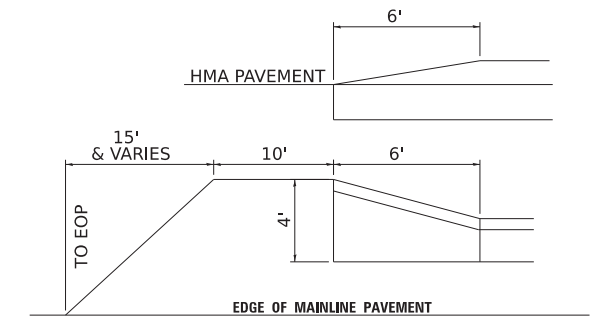

NOTE: CURB & GUTTER OUTLETS WILL BE PAID FOR AS COMBINATION CONCRETE CURB & GUTTER, TYPE B-6.18 OR TYPE M-6.18 AND MEASURED ALONG FACE OF CURB FOR PAYMENT BY THE FOOT AND IS INCLUDED IN PLAN QUANTITY. NO ADDITIONAL COMPENSATION WILL BE ALLOWED.

NOTES:

1. ALL SIDE ROAD RETURNS, PRIVATE ENTRANCES, COMMERCIAL ENTRANCES AND RURAL MAILBOX TURNOUTS ARE TO BE CONSTRUCTED AND PAID FROM INCIDENTAL HOT-MIX ASPHALT SURFACING.

MODEL: S:\MODELS\MAMES
FILE NAME: SFILES

USER NAME = \$USERS	DESIGNED -	REVISED -
	DRAWN -	REVISED -
PLOT SCALE = \$\$SCALE\$	CHECKED -	REVISED -
PLOT DATE = \$DATES	DATE -	REVISED -

**STATE OF ILLINOIS
DEPARTMENT OF TRANSPORTATION**

**COLFAX RD (C.H. 15)
MISCELLANEOUS DETAILS**

SCALE: SHEET 5 OF 18 SHEETS STA. TO STA. _____

F.A.S RTE.	SECTION	COUNTY	TOTAL SHEETS	SHEET NO.
491	21-00152-02-RS	MCLEAN	18	5
CONTRACT NO. 91637				
ILLINOIS FED. AID PROJECT				

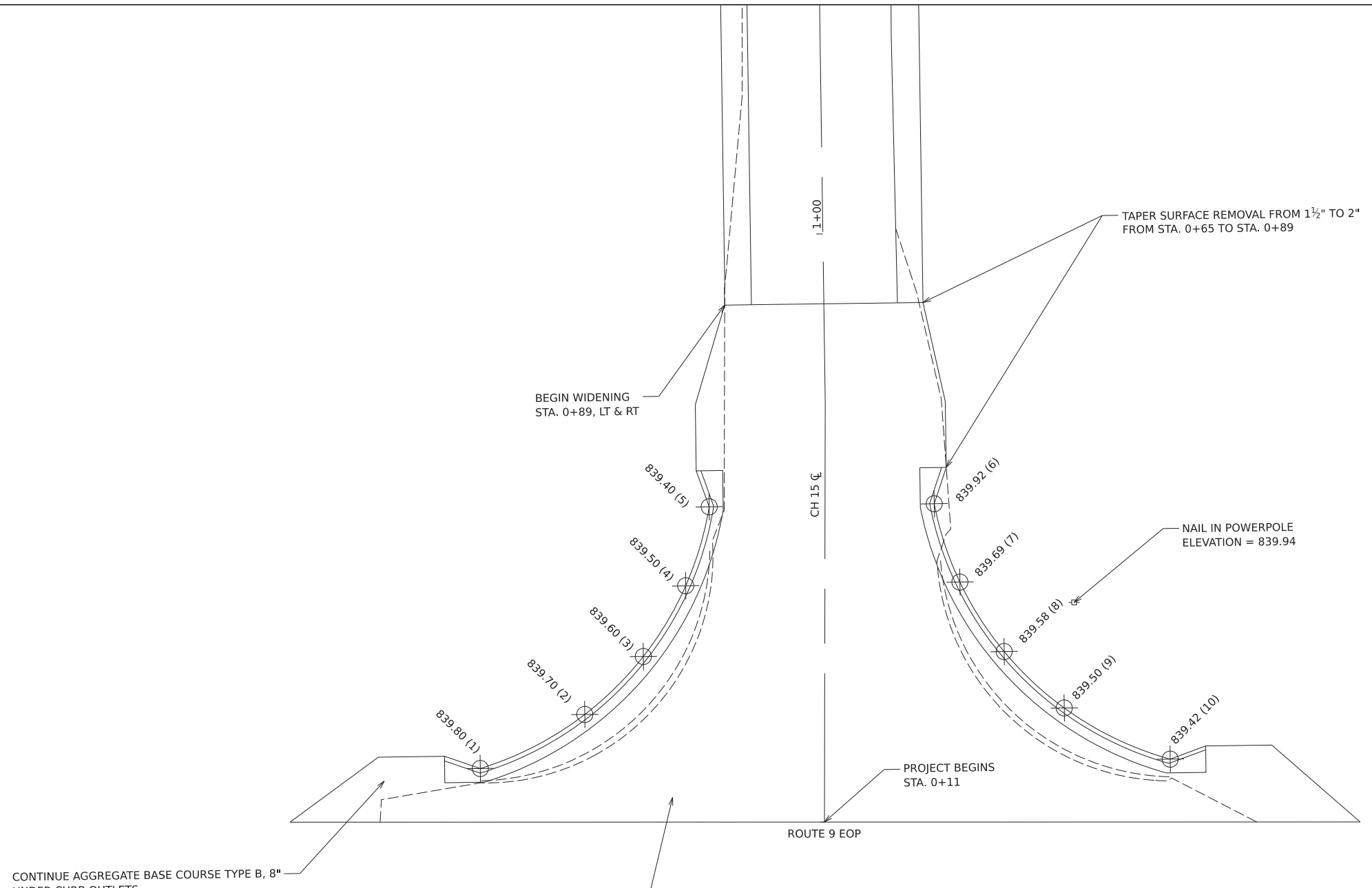

Location Number	Centerline	Station	Offset	Elevation
1	CH15	0+19	52.07' LT	839.80
2	CH15	0+27	36.28' LT	839.70
3	CH15	0+36	27.44' LT	839.60
4	CH15	0+46.72	21.05' LT	839.50
5	CH15	0+58.68	17.51' LT	839.40
6	CH15	0+59.20	16.51' RT	839.92
7	CH15	0+47.35	20.42' RT	839.69
8	CH15	0+36.85	27.13' RT	839.58
9	CH15	0+28.33	36.23' RT	839.5
10	CH 15	0+20.61	52.27' RT	839.42

NOTE: ALL ELEVATIONS ARE TO TOP OF CURB.
CURB IS TYPE M-6.18 AT ROUTE 9 INTERSECTION.

CONTINUE AGGREGATE BASE COURSE TYPE B, 8"
UNDER CURB OUTLETS

HMA SURFACE REMOVAL VARIABLE DEPTH (1 1/2")
REPLACE WITH 1 1/2" HMA SURFACE
PAID FOR OUT OF MAINLINE HMA SURFACE QUANTITY

INTERSECTION CROSS SECTION DETAIL
C.H. 15 & ROUTE 9 INTERSECTION

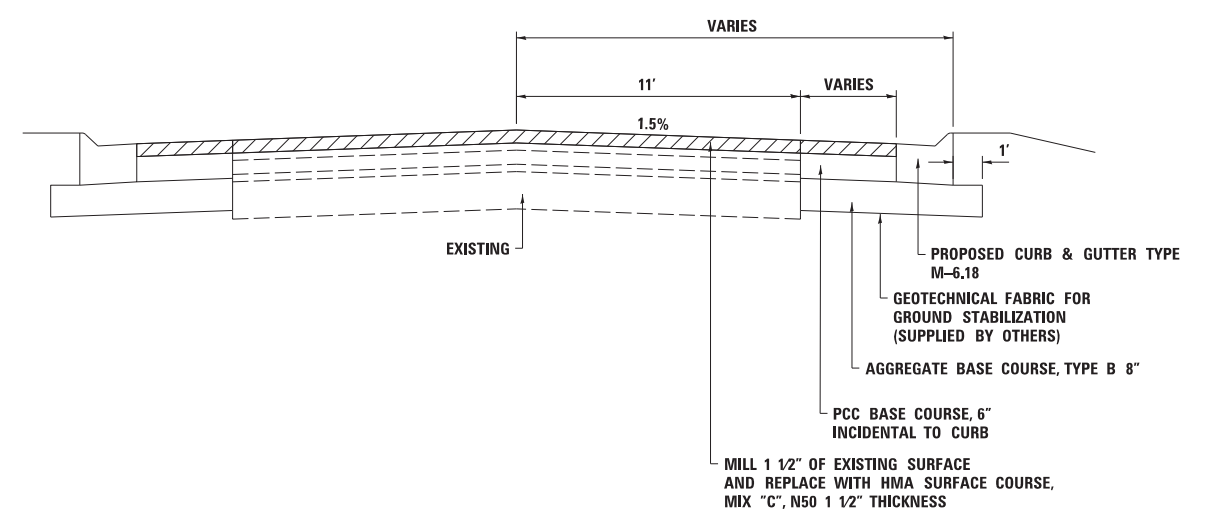

MODEL: 91637.DWG
FILE NAME: 91637.DWG

USER NAME = \$USERS	DESIGNED -	REVISED -
	DRAWN -	REVISED -
PLOT SCALE = \$\$SCALE\$	CHECKED -	REVISED -
PLOT DATE = \$DATES	DATE -	REVISED -

STATE OF ILLINOIS
DEPARTMENT OF TRANSPORTATION

COLFAX RD (C.H. 15)
ROUTE 9 INTERSECTION

SCALE: 1"=10' SHEET 6 OF 18 SHEETS STA. TO STA.

F.A.S RTE.	SECTION	COUNTY	TOTAL SHEETS	SHEET NO.
491	21-00152-02-RS	MCLEAN	18	6
CONTRACT NO. 91637				
ILLINOIS FED. AID PROJECT				

NAIL IN POWERPOLE
ELEVATION = 755.33

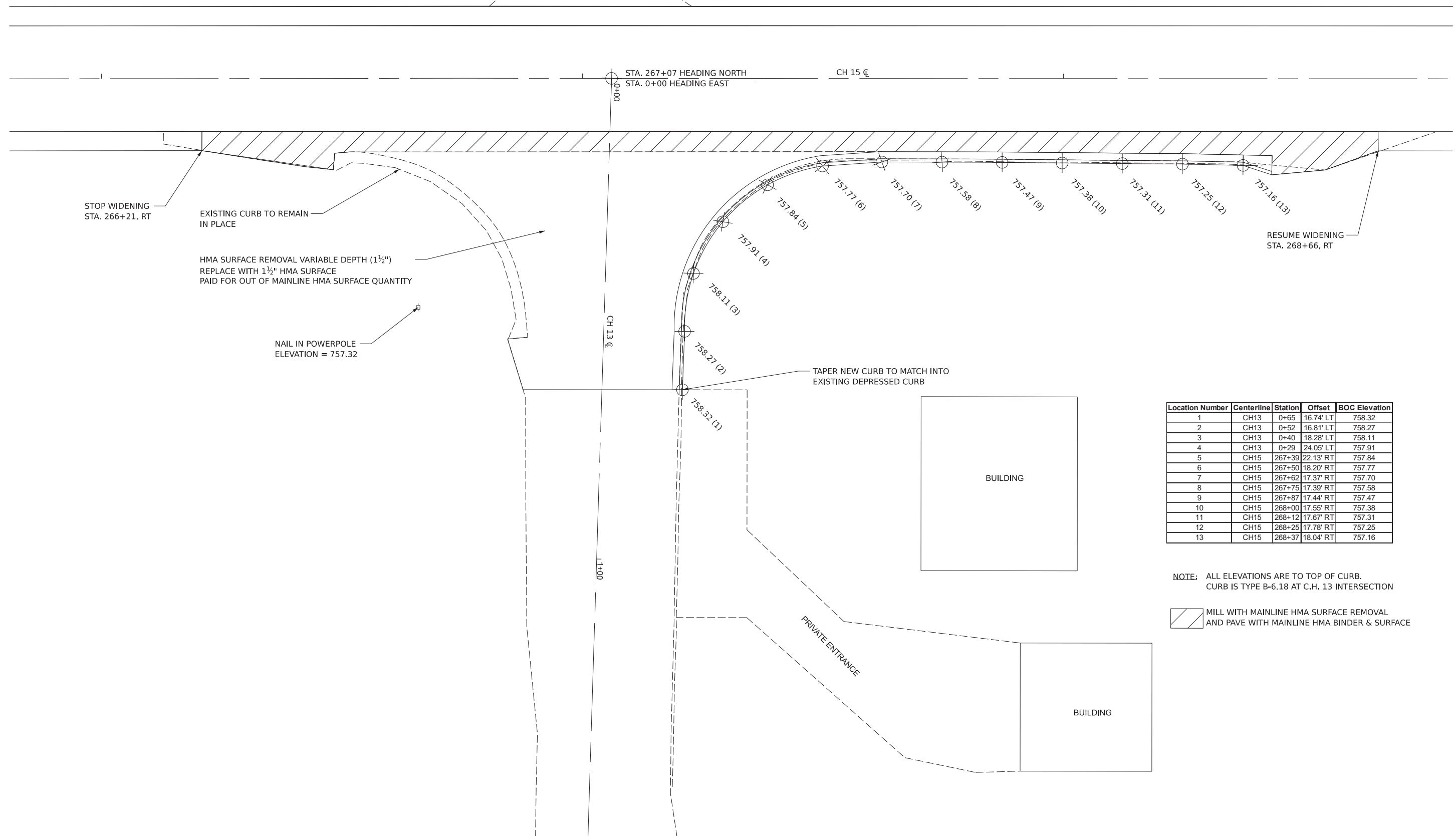

STOP WIDENING
STA. 266+21, RT

EXISTING CURB TO REMAIN
IN PLACE

HMA SURFACE REMOVAL VARIABLE DEPTH (1 1/2")
REPLACE WITH 1 1/2" HMA SURFACE
PAID FOR OUT OF MAINLINE HMA SURFACE QUANTITY

NAIL IN POWERPOLE
ELEVATION = 757.32

STA. 267+07 HEADING NORTH
STA. 0+00 HEADING EAST

CH 15 CL

CH 13 CL

1+000

TAPER NEW CURB TO MATCH INTO
EXISTING DEPRESSED CURB

BUILDING

PRIVATE ENTRANCE

BUILDING

RESUME WIDENING
STA. 268+66, RT

Location Number	Centerline	Station	Offset	BOC Elevation
1	CH13	0+65	16.74' LT	758.32
2	CH13	0+52	16.81' LT	758.27
3	CH13	0+40	18.28' LT	758.11
4	CH13	0+29	24.05' LT	757.91
5	CH15	267+39	22.13' RT	757.84
6	CH15	267+50	18.20' RT	757.77
7	CH15	267+62	17.37' RT	757.70
8	CH15	267+75	17.39' RT	757.58
9	CH15	267+87	17.44' RT	757.47
10	CH15	268+00	17.55' RT	757.38
11	CH15	268+12	17.67' RT	757.31
12	CH15	268+25	17.78' RT	757.25
13	CH15	268+37	18.04' RT	757.16

NOTE: ALL ELEVATIONS ARE TO TOP OF CURB.
CURB IS TYPE B-6.18 AT C.H. 13 INTERSECTION

MILL WITH MAINLINE HMA SURFACE REMOVAL
AND PAVE WITH MAINLINE HMA BINDER & SURFACE

MODEL: S:\MODEL\NAMES
FILE NAME: SFILES

USER NAME = \$USERS	DESIGNED -	REVISED -
PLOT SCALE = \$\$SCALE\$	DRAWN -	REVISED -
PLOT DATE = \$DATES	CHECKED -	REVISED -
	DATE -	REVISED -

STATE OF ILLINOIS
DEPARTMENT OF TRANSPORTATION

COLFAX RD (C.H. 15)
C.H. 13 INTERSECTION DETAIL

SCALE: 1"=10' SHEET 7 OF 18 SHEETS STA. TO STA.

F.A.S RTE.	SECTION	COUNTY	TOTAL SHEETS	SHEET NO.
491	21-00152-02-RS	MCLEAN	18	7
CONTRACT NO. 91637				
ILLINOIS FED. AID PROJECT				

FOR INFORMATION ONLY



GUARDRAIL REPAIRS

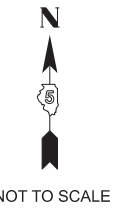

SE 1/4 SEC 21, T24N, R5E, 3rd PM

WORK TO BE DONE
BY McLEAN COUNTY
HIGHWAY DEPARTMENT
STA 30+72.90
PIPE CULVERT, CLASS D
TYPE 1 24"x57" @ 2.0%
W/END SECTIONS
USFL=789.73/22' LT
DSFL=788.59/35' RT

IMPROVEMENT BEGINS
STA 10+11.50

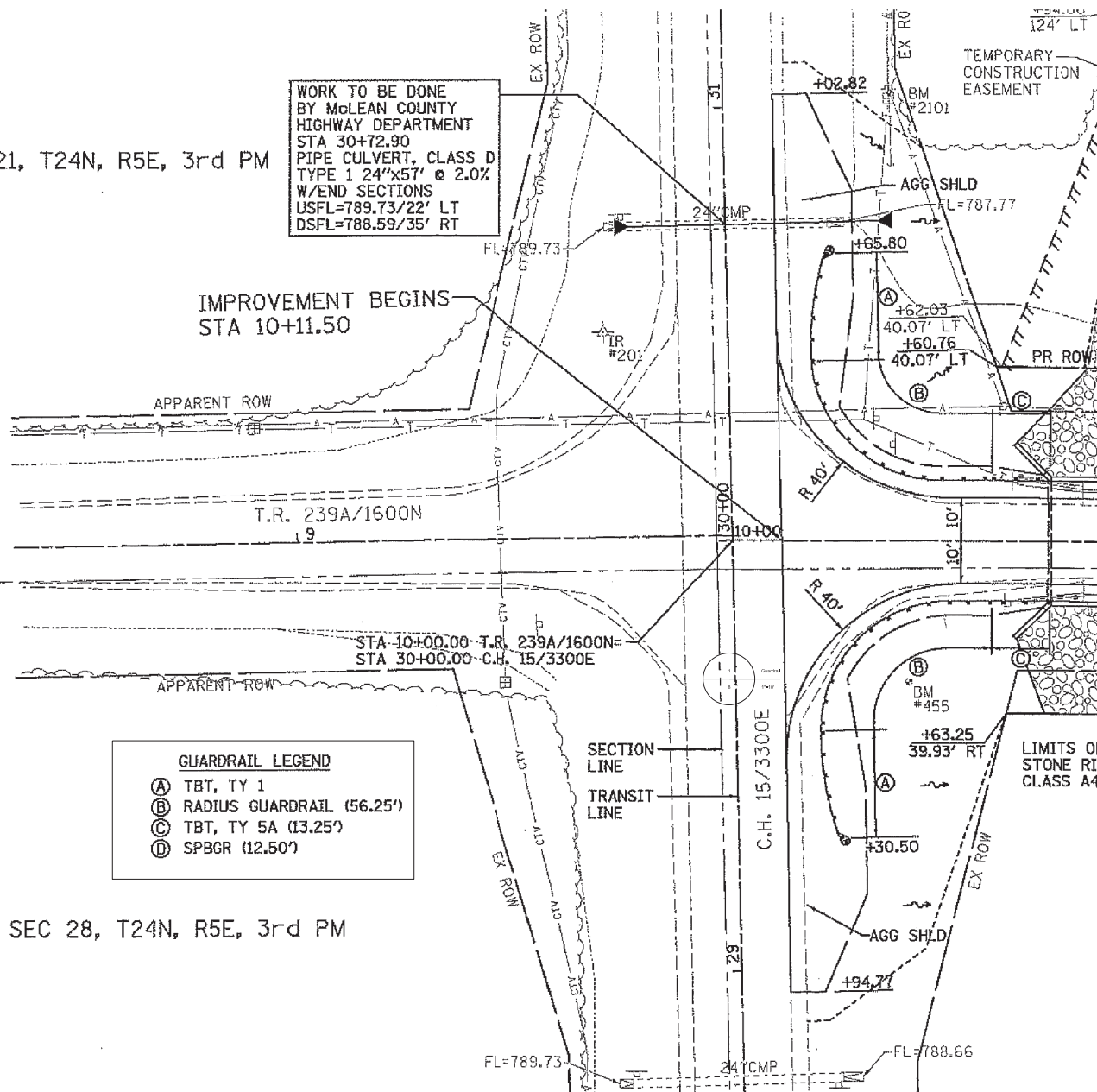

GUARDRAIL LEGEND
 (A) TBT, TY 1
 (B) RADIUS GUARDRAIL (56.25')
 (C) TBT, TY 5A (13.25')
 (D) SPBGR (12.50')

NE 1/4 SEC 28, T24N, R5E, 3rd PM

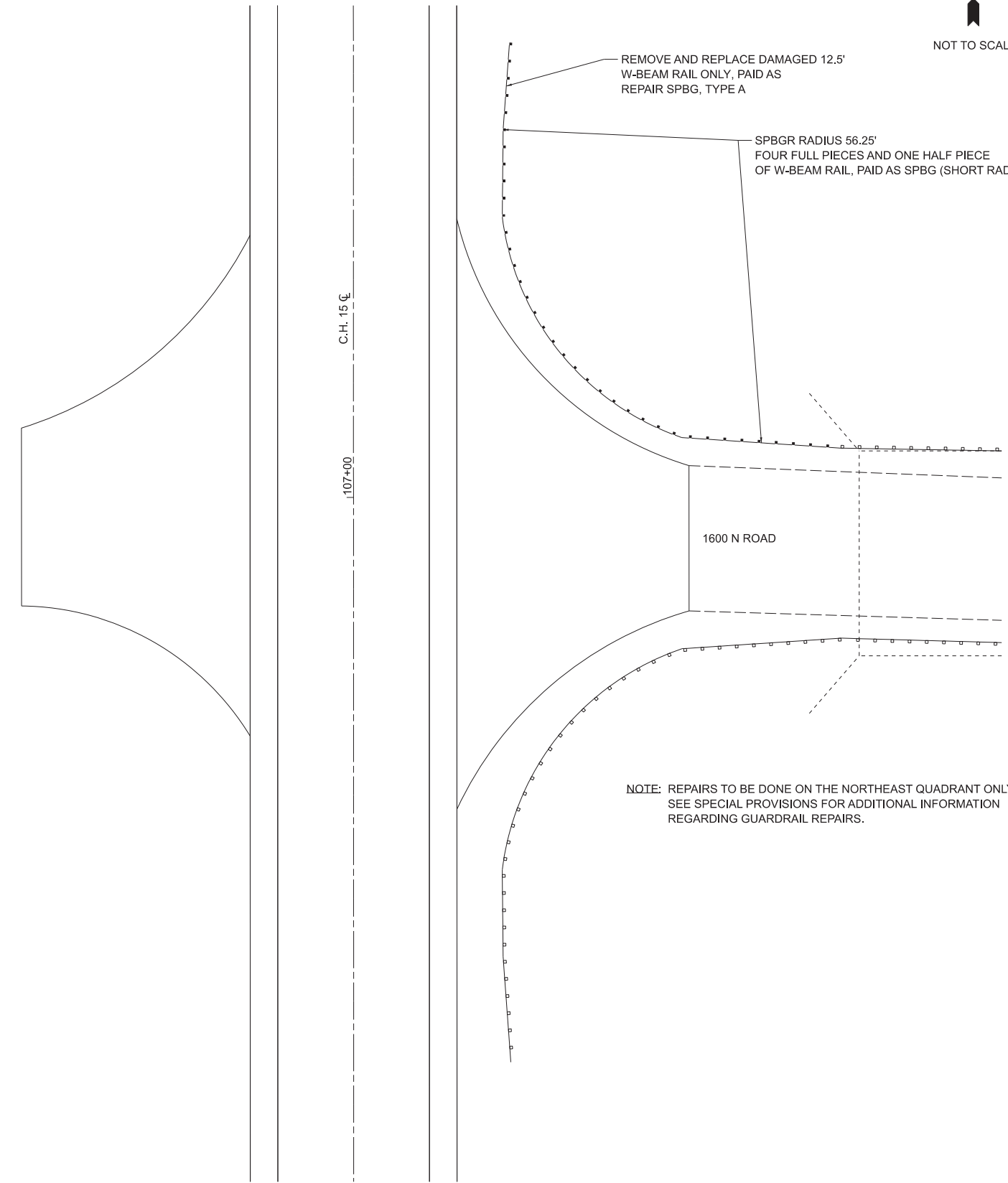

NOTE: REPAIRS TO BE DONE ON THE NORTHEAST QUADRANT ONLY.
SEE SPECIAL PROVISIONS FOR ADDITIONAL INFORMATION REGARDING GUARDRAIL REPAIRS.

MODEL: 4100121.MXD
FILE NAME: ST1E15

USER NAME = \$USERS	DESIGNED -	REVISED -
	DRAWN -	REVISED -
PLOT SCALE = \$SCALES	CHECKED -	REVISED -
PLOT DATE = \$DATES	DATE -	REVISED -

STATE OF ILLINOIS
DEPARTMENT OF TRANSPORTATION

COLFAX RD (C.H. 15)
RADIUS GUARDRAIL DETAIL

SHEET 8 OF 18 SHEETS STA. ___+___ TO STA. ___+___

F.A.S RTE.	SECTION	COUNTY	TOTAL SHEETS	SHEET NO.
491	21-00152-02-RS	MCLEAN	18	8
CONTRACT NO. 91637				
ILLINOIS FED. AID PROJECT				

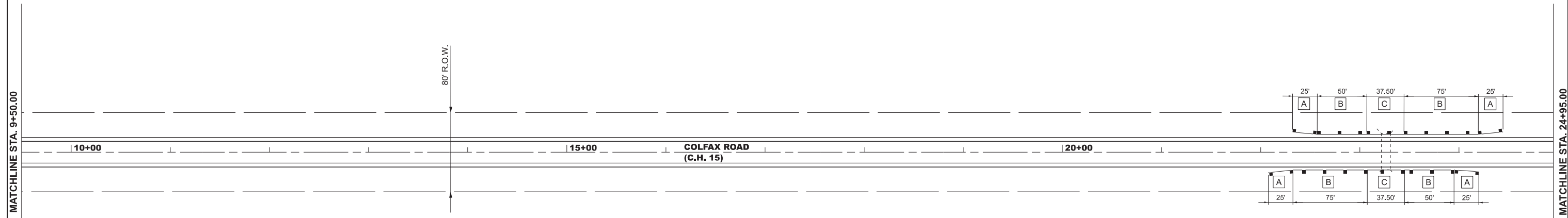
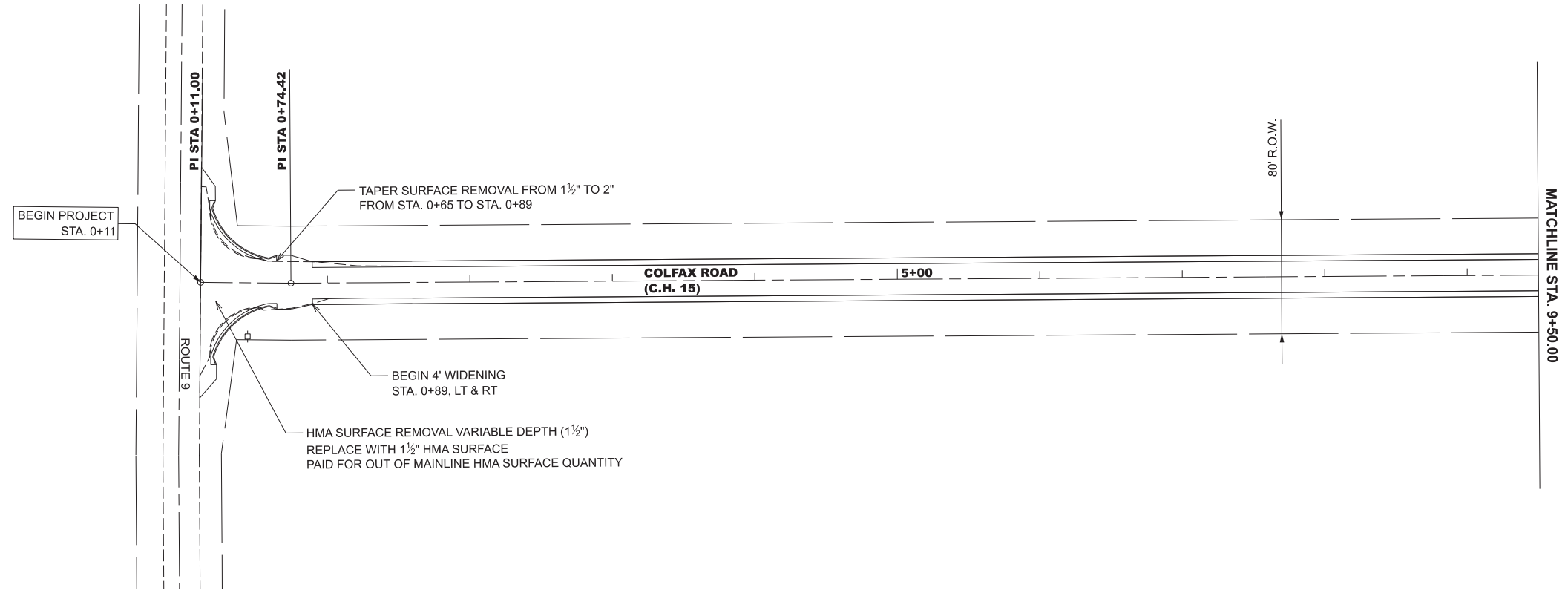

GUARDRAIL LOCATION #1

- A** = TR BAR TERM T1 SPL FLARE
- B** = SPBGR TY A 6' POSTS
- C** = LSG OV CULV 12' 6" SPAN

MODEL: MODELNAMES
FILENAME: \$FILES\$

USER NAME = \$USERS	DESIGNED -	REVISED -
	DRAWN -	REVISED -
PLOT SCALE = \$\$SCALE\$	CHECKED -	REVISED -
PLOT DATE = \$DATES	DATE -	REVISED -

**STATE OF ILLINOIS
DEPARTMENT OF TRANSPORTATION**

**COLFAX RD (C.H. 15)
PLAN VIEW**

SCALE: 1"=50' SHEET 9 OF 18 SHEETS STA. 0+11 TO STA. 24+95

F.A.S RTE.	SECTION	COUNTY	TOTAL SHEETS	SHEET NO.
491	21-00152-02-RS	MCLEAN	18	9
CONTRACT NO. 91637				
ILLINOIS FED. AID PROJECT				

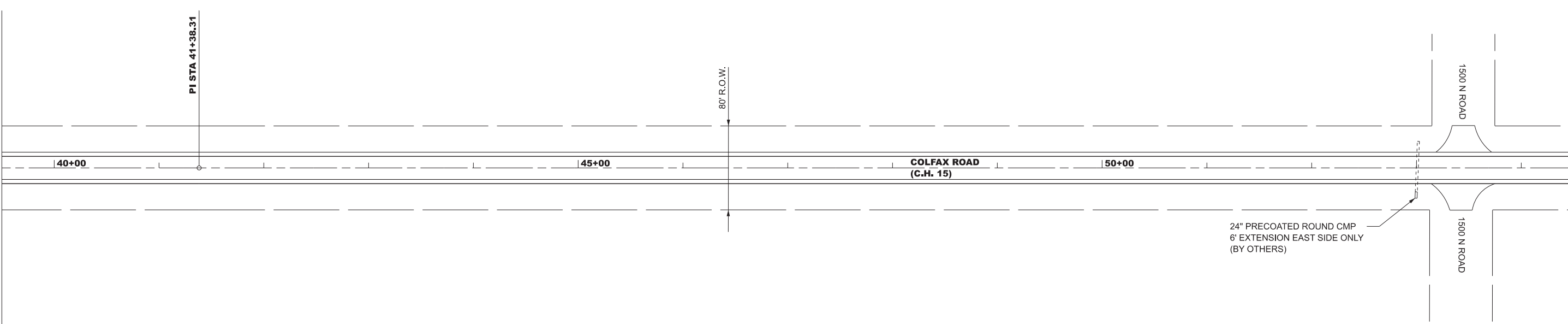
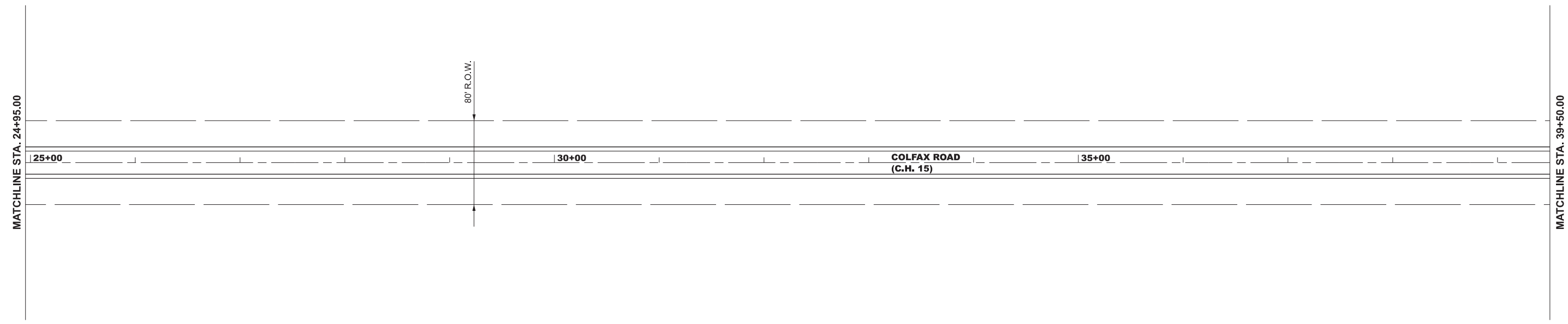

MODEL: S:\MODELS\MAMES
FILE NAME: SFILES

USER NAME = \$USERS	DESIGNED -	REVISED -
	DRAWN -	REVISED -
PLOT SCALE = \$\$SCALE\$	CHECKED -	REVISED -
PLOT DATE = \$DATES	DATE -	REVISED -

**STATE OF ILLINOIS
DEPARTMENT OF TRANSPORTATION**

**COLFAX RD (C.H. 15)
PLAN VIEW**

SCALE: 1"=50' SHEET 10 OF 18 SHEETS STA. 24+95 TO STA. 54+50

F.A.S RTE.	SECTION	COUNTY	TOTAL SHEETS	SHEET NO.
491	21-00152-02-RS	MCLEAN	18	10
CONTRACT NO. 91637			ILLINOIS FED. AID PROJECT	



80' R.O.W.

80' R.O.W.

PI STA 82+65.61

MATCHLINE STA. 54+50.00

MATCHLINE STA. 69+50.00

MATCHLINE STA. 69+50.00

MATCHLINE STA. 84+50.00

55+00

60+00

COLFAX ROAD
(C.H. 15)

65+00

70+00

75+00

COLFAX ROAD
(C.H. 15)

80+00

MODEL: \$MODELNAME\$
FILENAME: \$FILES\$

USER NAME = \$USERS	DESIGNED -	REVISED -
	DRAWN -	REVISED -
PLOT SCALE = \$\$SCALE\$	CHECKED -	REVISED -
PLOT DATE = \$DATES	DATE -	REVISED -

STATE OF ILLINOIS
DEPARTMENT OF TRANSPORTATION

COLFAX RD (C.H. 15)
PLAN VIEW

SCALE: 1"=50' SHEET 11 OF 18 SHEETS STA. 54+50 TO STA. 84+50

F.A.S RTE.	SECTION	COUNTY	TOTAL SHEETS	SHEET NO.
491	21-00152-02-RS	MCLEAN	18	11
CONTRACT NO. 91637			ILLINOIS FED. AID PROJECT	



MATCHLINE STA. 84+50.00

MATCHLINE STA. 99+50.00

85+00

90+00

COLFAX ROAD
(C.H. 15)

95+00

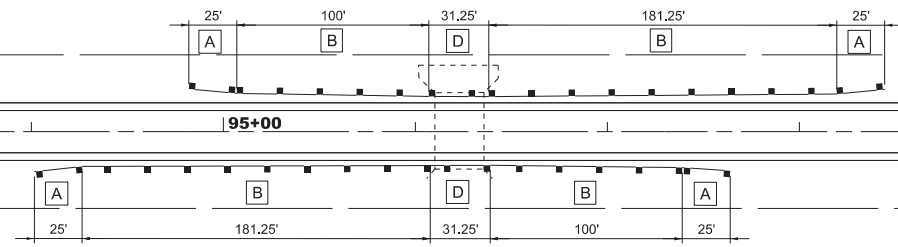

GUARDRAIL LOCATION #2

- A = TR BAR TERM T1 SPL FLARE
- B = SPBGR TY A 6' POSTS
- D = SPBGR ATT TO CULVERT



MATCHLINE STA. 99+50.00

MATCHLINE STA. 114+50.00

100+00

COLFAX ROAD
(C.H. 15)

105+00

110+00

80' R.O.W.

1600 N ROAD

PI STA 109+65.61

24" PRECOATED ROUND CMP
10' EXTENSION EAST SIDE ONLY
(BY OTHERS)

SEE RADIUS GUARDRAIL DETAIL SHEET
FOR MORE INFORMATION

GUARDRAIL LOCATION #3

MODEL: \$MODELNAME\$
FILENAME: \$FILE\$

USER NAME = \$USERS	DESIGNED -	REVISED -
	DRAWN -	REVISED -
PLOT SCALE = \$\$SCALE\$	CHECKED -	REVISED -
PLOT DATE = \$DATES	DATE -	REVISED -

STATE OF ILLINOIS
DEPARTMENT OF TRANSPORTATION

COLFAX RD (C.H. 15)
PLAN VIEW

SCALE: 1"=50' SHEET 12 OF 18 SHEETS STA. 84+50 TO STA. 114+50

F.A.S RTE.	SECTION	COUNTY	TOTAL SHEETS	SHEET NO.
491	21-00152-02-RS	MCLEAN	18	12
CONTRACT NO. 91637				
ILLINOIS FED. AID PROJECT				



MATCHLINE STA. 114+50.00

MATCHLINE STA. 129+50.00

MATCHLINE STA. 129+50.00

MATCHLINE STA. 144+50.00

115+00

120+00

COLFAX ROAD
(C.H. 15)

125+00

PI STA 125+71.81

80' R.O.W.

130+00

135+00

COLFAX ROAD
(C.H. 15)

140+00

80' R.O.W.

MODEL: \$MODELNAME\$
FILE NAME: \$FILES\$

USER NAME = \$USERS	DESIGNED -	REVISED -
	DRAWN -	REVISED -
PLOT SCALE = \$\$SCALE\$	CHECKED -	REVISED -
PLOT DATE = \$DATES	DATE -	REVISED -

**STATE OF ILLINOIS
DEPARTMENT OF TRANSPORTATION**

**COLFAX RD (C.H. 15)
PLAN VIEW**

SCALE: 1"=50' SHEET 13 OF 18 SHEETS STA. 114+50 TO STA. 144+50

F.A.S RTE.	SECTION	COUNTY	TOTAL SHEETS	SHEET NO.
491	21-00152-02-RS	MCLEAN	18	13
CONTRACT NO. 91637				
ILLINOIS FED. AID PROJECT				

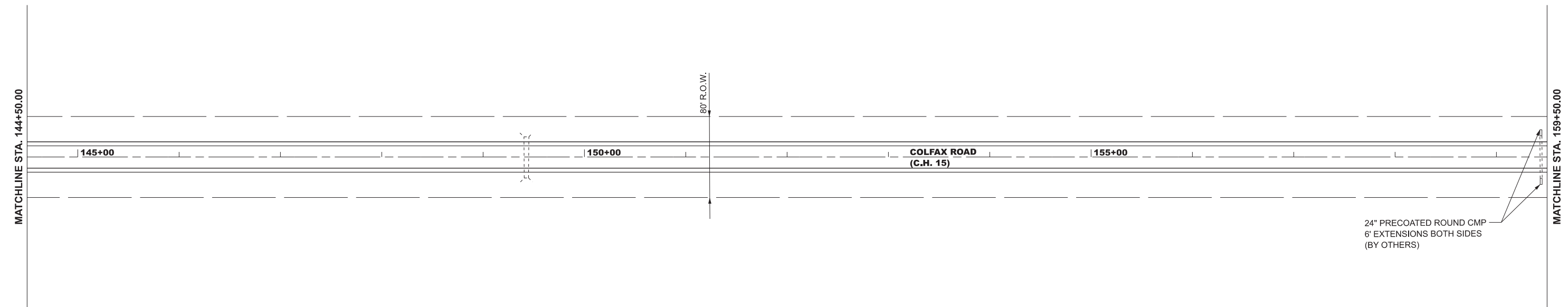

24" PRECOATED ROUND CMP
6' EXTENSIONS BOTH SIDES
(BY OTHERS)

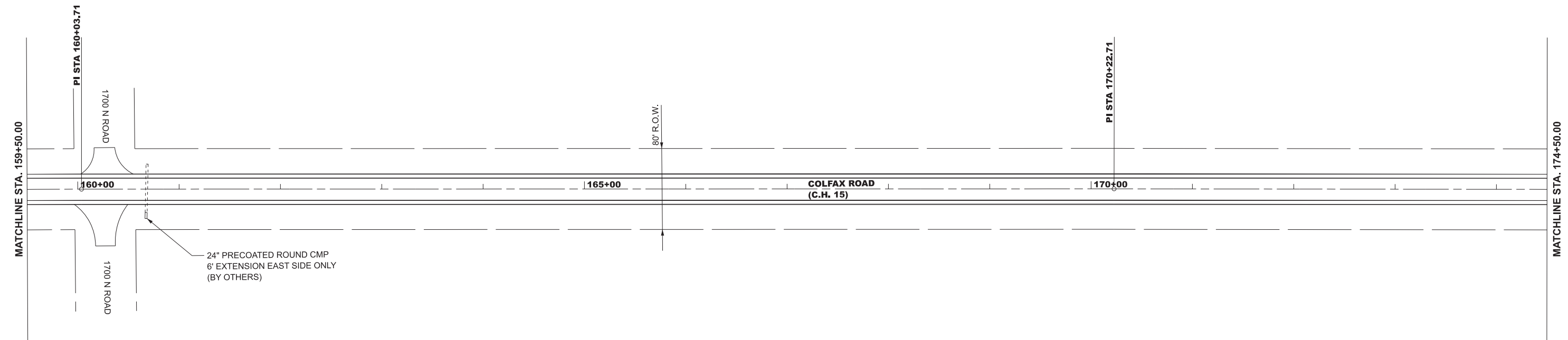

24" PRECOATED ROUND CMP
6' EXTENSION EAST SIDE ONLY
(BY OTHERS)

MODEL: S:\MODELS\MAMES
FILE NAME: SFILES

USER NAME = \$USERS	DESIGNED -	REVISED -
	DRAWN -	REVISED -
PLOT SCALE = \$\$SCALE\$	CHECKED -	REVISED -
PLOT DATE = \$DATES	DATE -	REVISED -

**STATE OF ILLINOIS
DEPARTMENT OF TRANSPORTATION**

**COLFAX RD (C.H. 15)
PLAN VIEW**

SCALE: 1"=50' SHEET 14 OF 18 SHEETS STA. 144+50 TO STA. 174+50

F.A.S RTE.	SECTION	COUNTY	TOTAL SHEETS	SHEET NO.
491	21-00152-02-RS	MCLEAN	18	14
CONTRACT NO. 91637				
ILLINOIS FED. AID PROJECT				



MATCHLINE STA. 174+50.00

MATCHLINE STA. 189+50.00

175+00

180+00

COLFAX ROAD
(C.H. 15)

185+00

PI STA 188+28.01

80' R.O.W.

MATCHLINE STA. 189+50.00

MATCHLINE STA. 204+50.00

190+00

195+00

COLFAX ROAD
(C.H. 15)

200+00

80' R.O.W.

MODEL: S:\MODELS\MAMES
FILE NAME: SFILES

USER NAME = \$USERS	DESIGNED -	REVISED -
	DRAWN -	REVISED -
PLOT SCALE = \$\$SCALE\$	CHECKED -	REVISED -
PLOT DATE = \$DATES	DATE -	REVISED -

STATE OF ILLINOIS
DEPARTMENT OF TRANSPORTATION

COLFAX RD (C.H. 15)
PLAN VIEW

SCALE: 1"=50' SHEET 15 OF 18 SHEETS STA. 174+50 TO STA. 204+50

F.A.S RTE.	SECTION	COUNTY	TOTAL SHEETS	SHEET NO.
491	21-00152-02-RS	MCLEAN	18	15
CONTRACT NO. 91637			ILLINOIS FED. AID PROJECT	



MATCHLINE STA. 204+50.00

MATCHLINE STA. 219+50.00

205+00

210+00

COLFAX ROAD
(C.H. 15)

215+00

80' R.O.W.

24" PRECOATED ROUND CMP
6' EXTENSION WEST SIDE ONLY
(BY OTHERS)

PI STA 213+39.61

1800 N ROAD

1800 N ROAD



MATCHLINE STA. 219+50.00

MATCHLINE STA. 234+50.00

220+00

225+00

COLFAX ROAD
(C.H. 15)

230+00

80' R.O.W.

MODEL: S:\MODELS\MAMES
FILE NAME: SFILES

USER NAME = \$USERS	DESIGNED -	REVISED -
	DRAWN -	REVISED -
PLOT SCALE = \$\$SCALE\$	CHECKED -	REVISED -
PLOT DATE = \$DATES	DATE -	REVISED -

STATE OF ILLINOIS
DEPARTMENT OF TRANSPORTATION

COLFAX RD (C.H. 15)
PLAN VIEW

SCALE: 1"=50' SHEET 16 OF 18 SHEETS STA. 204+50 TO STA. 234+50

F.A.S RTE.	SECTION	COUNTY	TOTAL SHEETS	SHEET NO.
491	21-00152-02-RS	MCLEAN	18	16
CONTRACT NO. 91637				
ILLINOIS FED. AID PROJECT				



MATCHLINE STA. 234+50.00

MATCHLINE STA. 249+50.00

235+00

240+00

COLFAX ROAD
(C.H. 15)

245+00

80' R.O.W.

MATCHLINE STA. 249+50.00

MATCHLINE STA. 264+50.00

250+00

255+00

COLFAX ROAD
(C.H. 15)

260+00

80' R.O.W.

PI STA 251+27.21

MODEL: S:\MODEL\NAMES
FILE NAME: SFILES

USER NAME = \$USERS	DESIGNED -	REVISED -
	DRAWN -	REVISED -
PLOT SCALE = \$\$SCALE\$	CHECKED -	REVISED -
PLOT DATE = \$DATES	DATE -	REVISED -

STATE OF ILLINOIS
DEPARTMENT OF TRANSPORTATION

COLFAX RD (C.H. 15)
PLAN VIEW

SCALE: 1"=50' SHEET 17 OF 18 SHEETS STA. 234+50 TO STA. 264+50

F.A.S RTE.	SECTION	COUNTY	TOTAL SHEETS	SHEET NO.
491	21-00152-02-RS	MCLEAN	18	17
CONTRACT NO. 91637				
ILLINOIS FED. AID PROJECT				



MATCHLINE STA. 264+50.00

MATCHLINE STA. 279+50.00

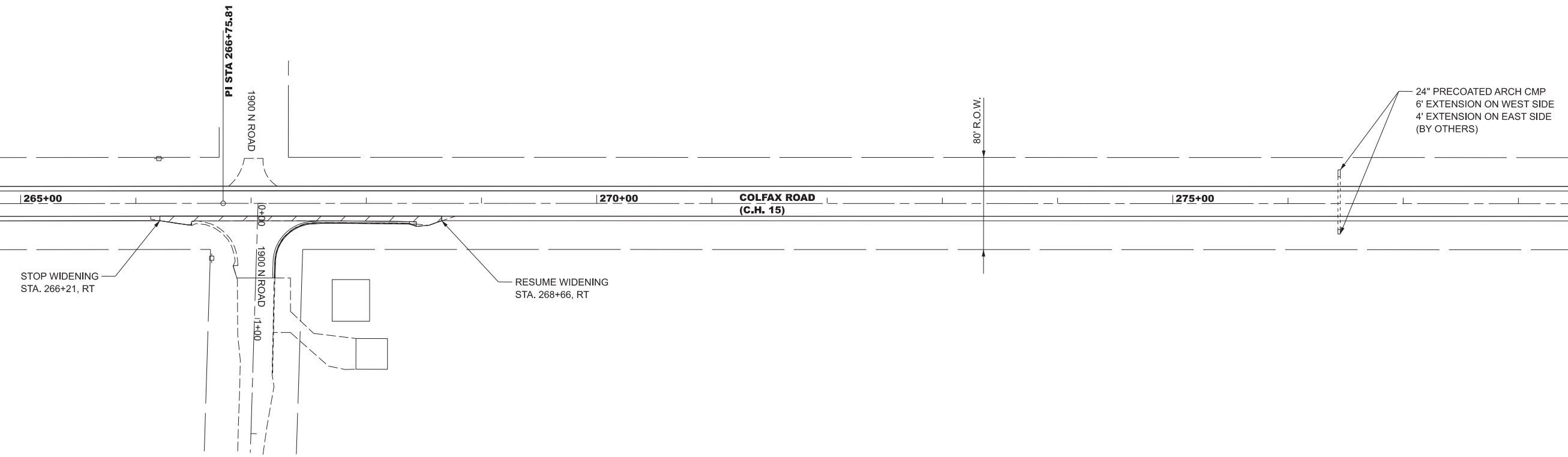

MATCHLINE STA. 279+50.00

MATCHLINE STA. 286+39.11

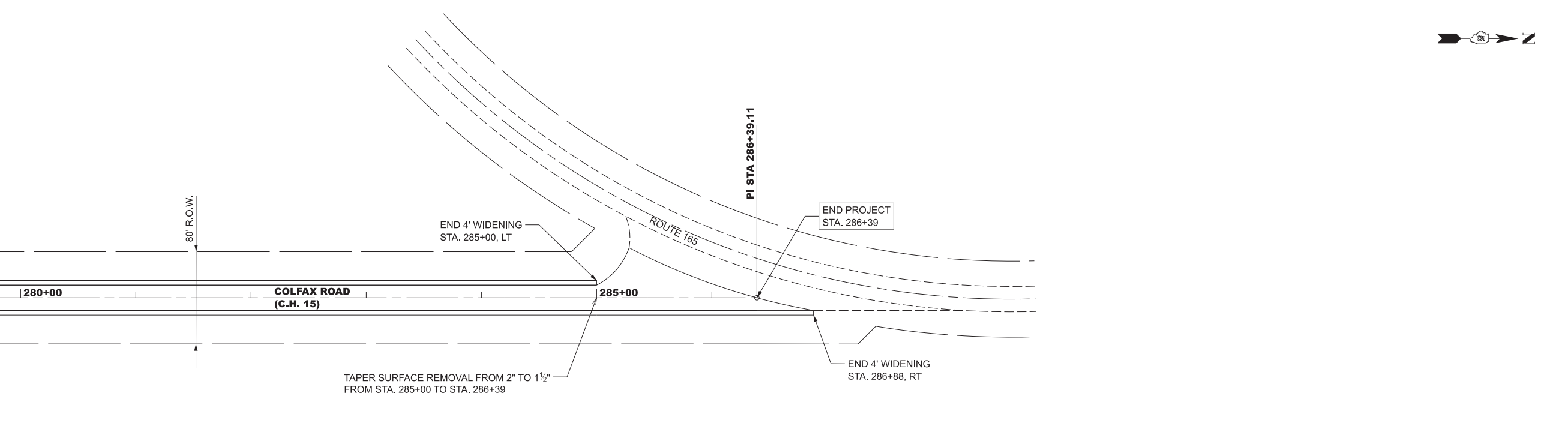

MODEL: S:\MODEL\NAMES
FILE NAME: SFILES

USER NAME = \$USERS	DESIGNED -	REVISED -
PLOT SCALE = \$\$SCALE\$	DRAWN -	REVISED -
PLOT DATE = \$DATES	CHECKED -	REVISED -
	DATE -	REVISED -

**STATE OF ILLINOIS
DEPARTMENT OF TRANSPORTATION**

**COLFAX RD (C.H. 15)
PLAN VIEW**

SCALE: 1"=50' SHEET 18 OF 18 SHEETS STA. 264+50 TO STA. 286+39

F.A.S RTE.	SECTION	COUNTY	TOTAL SHEETS	SHEET NO.
491	21-00152-02-RS	MCLEAN	18	18
CONTRACT NO. 91637				
ILLINOIS FED. AID PROJECT				