

INDEX OF SHEETS

03-08-2024 LETTING ITEM 169

- 1 COVER SHEET
- 2 GENERAL NOTES
- 3-6 SUMMARY OF QUANTITIES
- 7 TYPICAL SECTIONS
- 8-13 SCHEDULES
- 14 PROJECT LAYOUT
- 15-20 DETAILS

LIST OF ILLINOIS DOT HIGHWAY STANDARDS

- 000001-08 STANDARD SYMBOLS, ABBREVIATIONS AND PATTERNS
- 001006 DECIMAL OF AN INCH AND OF A FOOT
- 406201-01 MAILBOX TURNOUT
- 420406 PAVEMENT CONNECTOR (HMA) FOR BRIDGE APPROACH SLAB
- 442101-09 CLASS B PATCHES
- 542301-03 PRECAST REINFORCED CONCRETE FLARED END SECTION
- 635001-02 DELINEATORS
- 667101-02 PERMANENT SURVEY MARKERS
- 701001-02 OFF-ROAD OPERATIONS 2L, 2W, MORE THAN 15' AWAY
- 701006-05 OFF-ROAD OPERATIONS 2L, 2W, 15' TO 24" FROM PAVEMENT EDGE
- 701011-04 OFF-ROAD MOVING OPERATIONS 2L, 2W, DAY ONLY
- 701201-05 LANE CLOSURE, 2L, 2W, DAY ONLY, FOR SPEEDS \geq 45 MPH
- 701306-04 LANE CLOSURE, 2L, 2W, SLOW MOVING OPERATIONS DAY ONLY, FOR SPEEDS \geq 45 MPH
- 701311-03 LANE CLOSURE, 2L, 2W, MOVING OPERATIONS - DAY ONLY
- 701901-08 TRAFFIC CONTROL DEVICES
- 780001-05 TYPICAL PAVEMENT MARKINGS
- 781001-04 TYPICAL APPLICATIONS RAISED REFLECTIVE PAVEMENT MARKERS
- 782006-01 GUARDRAIL AND BARRIER WALL REFLECTOR MOUNTING DETAILS

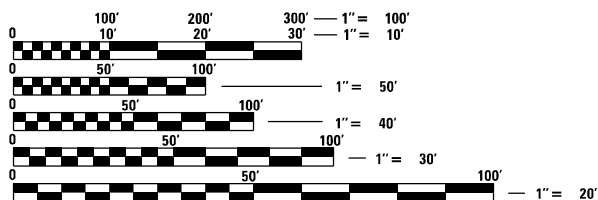

FULL SIZE PLANS HAVE BEEN PREPARED USING STANDARD ENGINEERING SCALES, REDUCED SIZED PLANS WILL NOT CONFORM TO STANDARD SCALES. IN MAKING MEASUREMENTS ON REDUCED PLANS, THE ABOVE SCALES MAY BE USED.

J.U.L.I.E.
JOINT UTILITY LOCATION INFORMATION FOR EXCAVATION
1-800-892-0123
OR 811

PROJECT ENGINEER: JOE KANNEL, P.E.
UNIT CHIEF: DARCY MITCHELL
DISTRICT 3 NO. (815) 434-6131
CONTRACT NO. 66M96

STATE OF ILLINOIS
DEPARTMENT OF TRANSPORTATION

PROPOSED
HIGHWAY PLANS

FAS ROUTE 248 (TISKILWA SPUR)
SECTION (117)RS-4
PROJECT STP-3L1D(999)
MILL & RESURFACE (DESIGNED OVERLAY)
BUREAU COUNTY

C-93-022-23

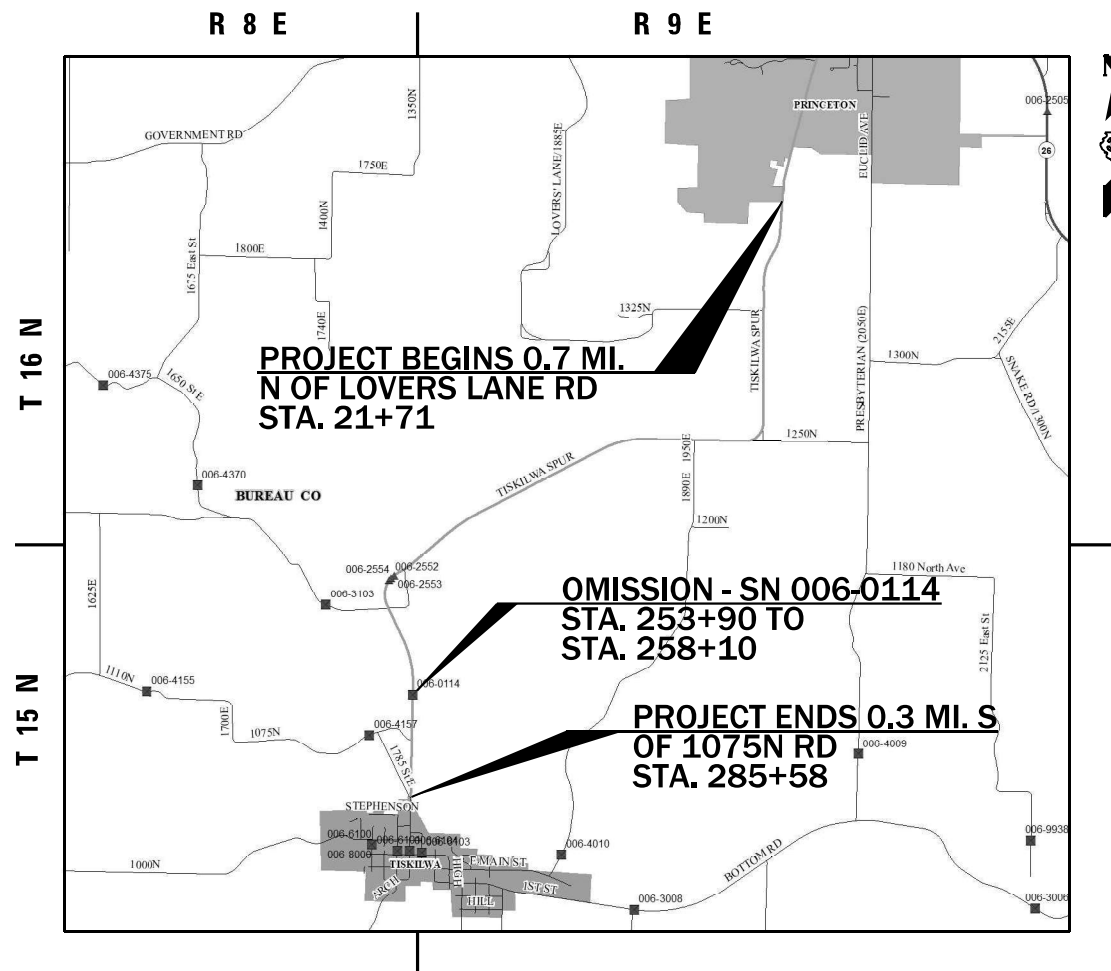

GROSS LENGTH = 26,587.5 FT. = 5.04 MILE
NET LENGTH = 26,167.5 FT. = 4.95 MILE

F.A.S. RTE.	SECTION	COUNTY	TOTAL SHEETS	SHEET NO.
248	(117)RS-4	BUREAU	20	1
		ILLINOIS	CONTRACT NO. 66M96	

D-93-002-23

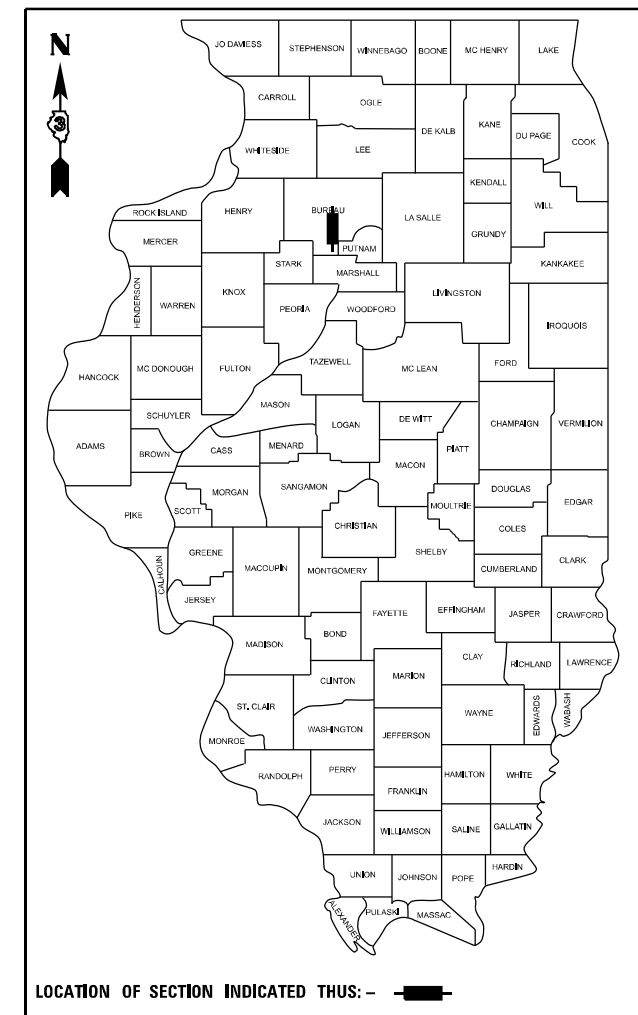

LOCATION OF SECTION INDICATED THUS: - [black rectangle] -

MINOR ARTERIAL RURAL
2020 ADT = 1700
PV = 94.2% SU = 4.7% MU = 1.1%

STATE OF ILLINOIS
DEPARTMENT OF TRANSPORTATION

SUBMITTED December 13, 2023

Joseph Almond
REGIONAL ENGINEER

February 2, 2024
Scott A. Etk
ENGINEER OF DESIGN AND ENVIRONMENT

February 2, 2024
Stephen M. Smith
DIRECTOR OF HIGHWAYS PROJECT IMPLEMENTATION

PRINTED BY THE AUTHORITY
OF THE STATE OF ILLINOIS

GENERAL NOTES

THE HMA SURFACE OF ALL MAILBOX TURNOUTS, PRIVATE ENTRANCES, COMMERCIAL ENTRANCES, AND SIDE ROADS SHALL BE MADE NEATLY, IN A WORKMANLIKE MANNER, AND SHALL ACCURATELY CONFORM TO THE SHAPES AND DIMENSIONS SHOWN ON THE PLAN DETAILS. IF REQUIRED BY THE ENGINEER, THE CONTRACTOR SHALL SAW CUT THE HMA SURFACE TO CONFORM TO THE SHAPES AND DIMENSIONS SHOWN ON THE PLAN DETAILS. THIS WORK WILL BE INCLUDED IN THE COST OF THE HMA SURFACE.

EXCEPT AS NOTED ON THE PLANS, PAVEMENT GRADES SHOWN ARE AT THE TOP OF PAVEMENT SURFACES.

BEFORE ORDERING PIPE CULVERTS OR PIPE DRAINS, THE CONTRACTOR SHALL CONSULT THE ENGINEER FOR EXACT LENGTHS.

THE ENGINEER WILL BE THE SOLE JUDGE CONCERNING CURING TIME FOR THE VARIOUS HMA LIFTS.

THE FINISHED EARTHWORK SHALL HAVE A VEGETATION SUSTAINING SOIL COVERING THE TOP FOUR INCHES (100 MILLIMETERS) IN AREAS TO BE SEEDED OR SODDED. THE VEGETATION SUSTAINING SOIL REQUIRED WILL NOT BE PAID FOR SEPARATELY BUT WILL BE INCLUDED IN THE COST OF FURNISHED EXCAVATION.

AT CULVERT NO. 4626 (STA. 23+71), WHICH IS LOCATED WITHIN REC SITE #4524-2, ANY EXCESS MATERIAL AT THIS LOCATION SHALL REMAIN ON SITE.

ON EXISTING PAVEMENT WHICH MAY BE SUPERELEVATED, THE NEW HMA PAVEMENT SHALL BE BUILT WITH THE SAME SUPERELEVATION UNLESS NEW SUPERELEVATION RATES ARE GIVEN ON THE PLANS.

ALL ELEVATIONS REFERRING TO U.S.G.S. MEAN SEA LEVEL DATUM.

THE FOLLOWING RATES OF APPLICATION HAVE BEEN USED IN CALCULATING PLAN QUANTITIES:

GRANULAR MATERIALS	2.05	TONS / CU YD
HMA RESURFACING	112	LBS / SQ YD / IN
SHORT TERM PAVEMENT MARKING	10	FT /100 FT OF APPLICATION
MIX FOR CRACKS, JTS & FLGWYS	0.0003	TONS / SQ YD

MEMBERS OF JULIE KNOWN TO BE WITHIN THE LIMITS OF THE IMPROVEMENT ARE: AMEREN, AT&T, COMCAST, FRONTIER, METRO COMMUNICATIONS, NICOR, VERIZON, AND THE CITY OF PRINCETON

NON-MEMBERS OF JULIE KNOWN TO BE WITHIN THE LIMITS OF THE IMPROVEMENT ARE: NO KNOWN NON-MEMBERS OF JULIE WITHIN THE LIMITS.

THE CONTRACTOR SHALL CONTACT JULIE AT LEAST 48 HOURS PRIOR TO EXCAVATION TO DETERMINE WHICH UTILITIES ARE IN THE AREA.

COMMITMENTS:

NONE

HMA MIXTURE REQUIREMENT TABLE			
LOCATIONS:	ENTIRE PROJECT	ENTIRE PROJECT	ENTIRE PROJECT
MIXTURE USE(S):	HMA BINDER	HMA SURFACE	HMA INCIDENTAL
BINDER GRADE (PG):	PG 64-22	PG 64-22	PG 64-22
DESIGN AIR VOIDS:	4.0% @ N50	4.0% @ N50	4.0% @ N50
MIXTURE COMPOSITION: (MIXTURE GRADATION)	IL 19.0	IL 9.5	IL 9.5
FRICITION AGGREGATE:		MIXTURE C	
MIXTURE WEIGHT:	112.0 LB/SY/IN	112.0 LB/SY/IN	112.0 LB/SY/IN
QUALITY MANAGEMENT PROGRAM:	QCP	QCP	QCQA
SUBLOT SIZE:	1000 TONS	1000 TONS	N/A
DENSITY TEST METHOD:	CORES	CORES	CORES/NUCLEAR
MATERIAL TRANSFER DEVICE (REQUIRED)	YES	YES	NO

STATE OF ILLINOIS
DEPARTMENT OF TRANSPORTATION
DISTRICT THREE
AS BUILT INFORMATION

SUPERVISING CONSTRUCTION FIELD ENGINEER

RESIDENT ENGINEER / TECHNICIAN

START & END DATES
OF CONSTRUCTION:

INSPECTORS:

MODEL: D:\info\... FILE NAME: ...

USER NAME = tlmthy_zletsch	DESIGNED -	REVISED -
	DRAWN -	REVISED -
PLOT SCALE = 100,000' / in.	CHECKED -	REVISED -
PLOT DATE = 12/13/2023	DATE -	REVISED -

**STATE OF ILLINOIS
DEPARTMENT OF TRANSPORTATION**

GENERAL NOTES

SCALE: SHEET OF SHEETS STA. TO STA.

F.A.S. RTE.	SECTION	COUNTY	TOTAL SHEETS	SHEET NO.
248	(117)RS-4	BUREAU	20	2
CONTRACT NO. 66M96				
ILLINOIS FED. AID PROJECT				

80% FED
20% STATE

CODE NO.	ITEM	UNIT	TOTAL QUANTITY	CONSTRUCTION CODE	
				ROADWAY 0005 RURAL	ROADWAY 0005 URBAN
20200100	EARTH EXCAVATION	CU YD	5.8	5	0.8
20400800	FURNISHED EXCAVATION	CU YD	9	9	
21400100	GRADING AND SHAPING DITCHES	FOOT	1520	1520	
25000210	SEEDING, CLASS 2A	ACRE	0.2	0.2	
25000400	NITROGEN FERTILIZER NUTRIENT	POUND	19	19	
25000500	PHOSPHORUS FERTILIZER NUTRIENT	POUND	19	19	
25000600	POTASSIUM FERTILIZER NUTRIENT	POUND	19	19	
25100630	EROSION CONTROL BLANKET	SQ YD	1013	1013	
28100707	STONE DUMPED RIPRAP, CLASS A4	SQ YD	38	38	
28200200	FILTER FABRIC	SQ YD	38	38	
40200800	AGGREGATE SURFACE COURSE, TYPE B	TON	182	182	
40600290	BITUMINOUS MATERIALS (TACK COAT)	POUND	7116	6919	197
40600370	LONGITUDINAL JOINT SEALANT	FOOT	23959	23236	723
40600400	MIXTURE FOR CRACKS, JOINTS, AND FLANGEWAYS	TON	21	20	1

* SPECIALTY ITEM

MODEL: D:\info\...
 FILE NAME: ...

USER NAME = tlmthy.zletsch	DESIGNED -	REVISED -	STATE OF ILLINOIS DEPARTMENT OF TRANSPORTATION	SUMMARY OF QUANTITIES				F.A.S. RTE.	SECTION	COUNTY	TOTAL SHEETS	SHEET NO.
PLOT SCALE = 100,000' / in.	DRAWN -	REVISED -						248	(117)RS-4	BUREAU	20	3
PLOT DATE = 12/14/2023	CHECKED -	REVISED -		SCALE: SHEET OF SHEETS STA. TO STA.				CONTRACT NO. 66M96		ILLINOIS FED. AID PROJECT		
	DATE -	REVISED -						Long Section Number				

80% FED
20% STATE

CODE NO.	ITEM	UNIT	TOTAL QUANTITY	CONSTRUCTION CODE	
				ROADWAY	ROADWAY
				0005 RURAL	0005 URBAN
40600990	TEMPORARY RAMP	SQ YD	402	366	36
40603080	HOT-MIX ASPHALT BINDER COURSE, IL-19.0, N50	TON	8674	8411	263
40604050	HOT-MIX ASPHALT SURFACE COURSE, IL-9.5, MIX "C", N50	TON	5828	5653	175
40800050	INCIDENTAL HOT-MIX ASPHALT SURFACING	TON	630	617	13
44000155	HOT-MIX ASPHALT SURFACE REMOVAL, 1 1/2"	SQ YD	535	535	
44000164	HOT-MIX ASPHALT SURFACE REMOVAL, 3 3/4"	SQ YD	68846	66757	2089
44200956	CLASS B PATCHES, TYPE II, 9 INCH	SQ YD	586	586	
44200962	CLASS B PATCHES, TYPE III, 9 INCH	SQ YD	24	24	
44201294	CLASS B PATCH - EXPANSION JOINT	FOOT	1738	1738	
44201299	DOWEL BARS 1 1/2"	EACH	1580	1580	
44213000	PATCHING REINFORCEMENT	SQ YD	610	610	
44213200	SAWCUTS	FOOT	3125	3125	
48102100	AGGREGATE WEDGE SHOULDER, TYPE B	TON	1819	1764	55
50800205	REINFORCEMENT BARS, EPOXY COATED	POUND	32		32

* SPECIALTY ITEM

MODEL: D:\info\...
 FILE NAME: ...

USER NAME = tlmthy.zletsch	DESIGNED -	REVISED -
PLOT SCALE = 100,000' / in.	DRAWN -	REVISED -
PLOT DATE = 12/14/2023	CHECKED -	REVISED -
	DATE -	REVISED -

**STATE OF ILLINOIS
DEPARTMENT OF TRANSPORTATION**

SUMMARY OF QUANTITIES

SCALE: SHEET OF SHEETS STA. TO STA.

F.A.S. RTE.	SECTION	COUNTY	TOTAL SHEETS	SHEET NO.
248	(117)RS-4	BUREAU	20	4
			CONTRACT NO. 66M96	
Long Section Number		ILLINOIS	FED. AID PROJECT	

80% FED
20% STATE

CODE NO.	ITEM	UNIT	TOTAL QUANTITY	CONSTRUCTION CODE	
				ROADWAY 0005 RURAL	ROADWAY 0005 URBAN
542D0217	PIPE CULVERTS, CLASS D, TYPE 1 12"	FOOT	8	8	
54248510	CONCRETE COLLAR	CU YD	0.6		0.6
54262712	METAL FLARED END SECTIONS 12"	EACH	1	1	
60905305	BOX CULVERTS TO BE CLEANED	FOOT	70	70	
63500105	DELINEATORS	EACH	32	30	2
66700205	PERMANENT SURVEY MARKERS, TYPE I	EACH	2	2	
67000400	ENGINEER'S FIELD OFFICE, TYPE A	CAL MO	4	4	
67100100	MOBILIZATION	L SUM	1	1	
70100460	TRAFFIC CONTROL AND PROTECTION, STANDARD 701306	L SUM	1	0.9	0.1
70300100	SHORT TERM PAVEMENT MARKING	FOOT	7993	7776	217
70300150	SHORT TERM PAVEMENT MARKING REMOVAL	SQ FT	888	864	24
* 78000100	THERMOPLASTIC PAVEMENT MARKING - LETTERS AND SYMBOLS	SQ FT	58	58	
* 78000650	THERMOPLASTIC PAVEMENT MARKING - LINE 24"	FOOT	44	44	
* 78009004	MODIFIED URETHANE PAVEMENT MARKING - LINE 4"	FOOT	165661	161319	4342

* SPECIALTY ITEM

MODEL: D:\info\...
 FILE NAME: ...

USER NAME = tlmthy.zletsch	DESIGNED -	REVISED -
PLOT SCALE = 100,000' / in.	DRAWN -	REVISED -
PLOT DATE = 12/14/2023	CHECKED -	REVISED -
	DATE -	REVISED -

**STATE OF ILLINOIS
DEPARTMENT OF TRANSPORTATION**

SUMMARY OF QUANTITIES			
SCALE:	SHEET	OF	SHEETS

F.A.S. RTE. 248	SECTION (117)RS-4	COUNTY	TOTAL SHEETS 20	SHEET NO. 5
ILLINOIS FED. AID PROJECT			CONTRACT NO. 66M96	

Long Section Number

80% FED
20% STATE

CODE NO.	ITEM	UNIT	TOTAL QUANTITY	CONSTRUCTION CODE	
				ROADWAY 0005 RURAL	ROADWAY 0005 URBAN
* 78009006	MODIFIED URETHANE PAVEMENT MARKING - LINE 6"	FOOT	13320	12959	361
* 78011000	GROOVING FOR RECESSED PAVEMENT MARKING, LETTERS AND SYMBOLS	SQ FT	58	58	
* 78011125	GROOVING FOR RECESSED PAVEMENT MARKING 25"	FOOT	44	44	
* 78100100	RAISED REFLECTIVE PAVEMENT MARKER	EACH	334	325	9
78300200	RAISED REFLECTIVE PAVEMENT MARKER REMOVAL	EACH	334	325	9
X4401198	HOT-MIX ASPHALT SURFACE REMOVAL, VARIABLE DEPTH	SQ YD	4250	4161	89
X5427601	REMOVE AND RELAY END SECTIONS	EACH	1	1	
X6350204	LINEAR DELINEATOR PANELS, 4 INCH	EACH	69	69	
X6350206	LINEAR DELINEATOR PANELS, 6 INCH	EACH	14	14	
Z0030850	TEMPORARY INFORMATION SIGNING	SQ FT	42	21	21
Z0034105	MATERIAL TRANSFER DEVICE	TON	14570	14131	439
Z0048665	RAILROAD PROTECTIVE LIABILITY INSURANCE	L SUM	1	1	

* SPECIALTY ITEM

MODEL: D:\data\... FILE NAME: ...

USER NAME = tlmthy.zletsch	DESIGNED -	REVISED -	STATE OF ILLINOIS DEPARTMENT OF TRANSPORTATION	SUMMARY OF QUANTITIES				F.A.S. RTE.	SECTION	COUNTY	TOTAL SHEETS	SHEET NO.	
PLOT SCALE = 100,000' / in.	DRAWN -	REVISED -		SCALE:	SHEET	OF	SHEETS	STA.	TO STA.	(117)RS-4	BUREAU	20	6
PLOT DATE = 12/14/2023	CHECKED -	REVISED -		CONTRACT NO. 66M96									
	DATE -	REVISED -		ILLINOIS FED. AID PROJECT									

MODEL: D:\info\...
 FILE NAME: ...
 PROJECT: ...
 DATE: ...

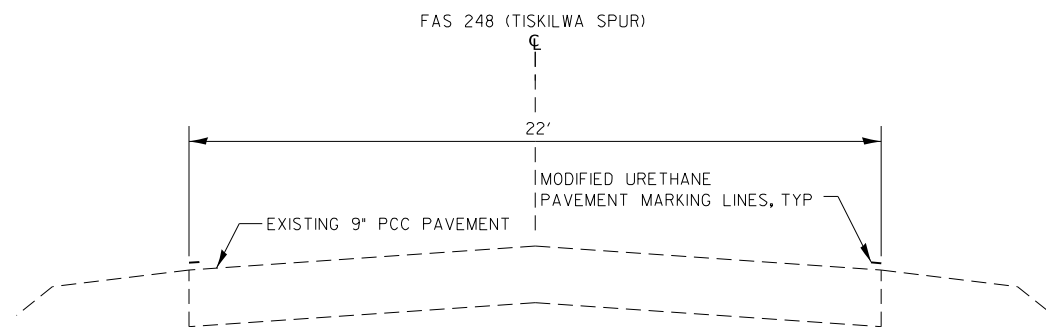

EXISTING PCC TYPICAL SECTION

STA. 263+30 TO STA. 285+58

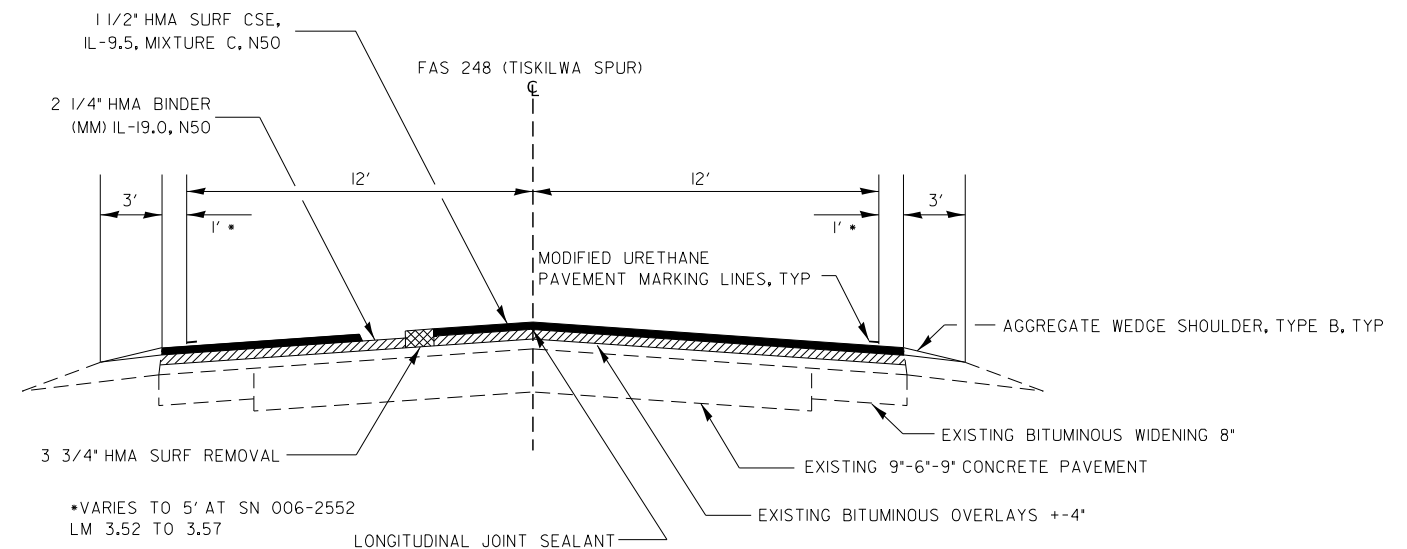

PROPOSED TYPICAL SECTION

STA. 19+96 TO STA. 165+77
 STA. 178+93 TO STA. 263+30

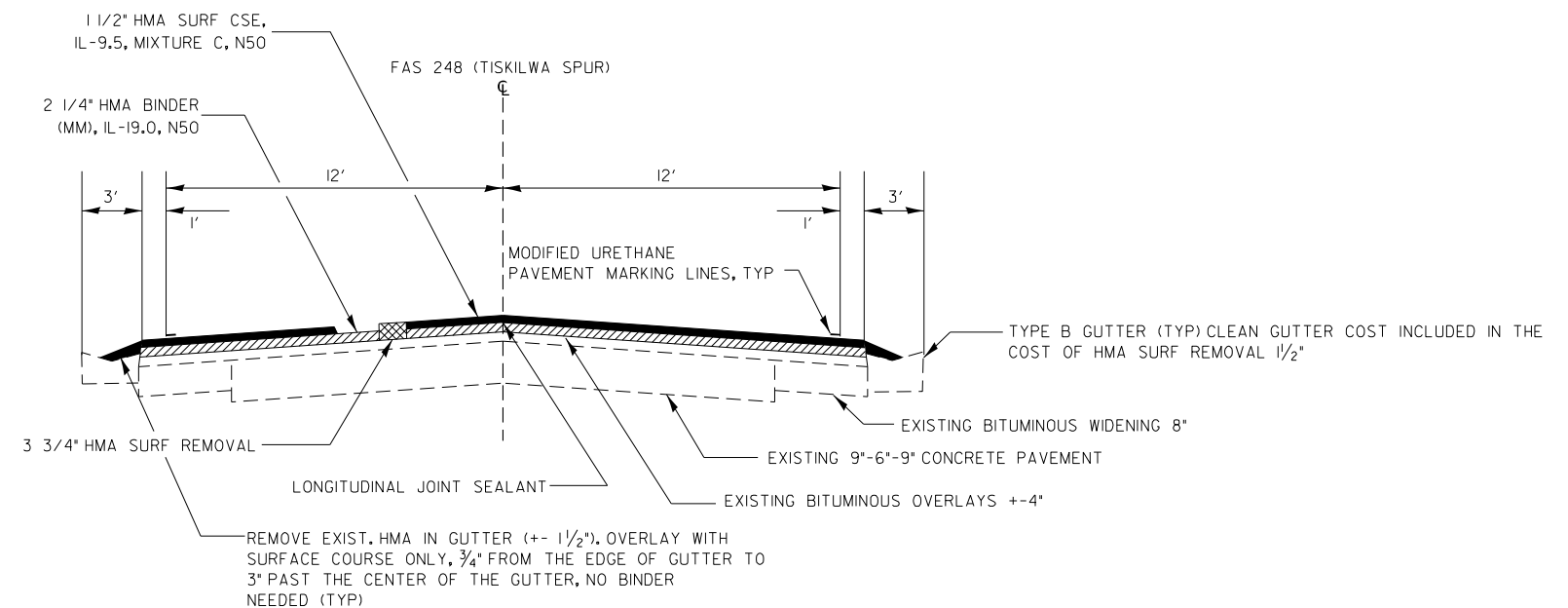

PROPOSED TYPICAL SECTION

STA. 165+77 TO STA. 178+93

USER NAME = tlmthy.zletsch	DESIGNED -	REVISED -
DRAWN -	REVISED -	
PLOT SCALE = 100,000' / in.	CHECKED -	REVISED -
PLOT DATE = 12/14/2023	DATE -	REVISED -

STATE OF ILLINOIS
 DEPARTMENT OF TRANSPORTATION

TYPICAL SECTIONS	
SCALE:	SHEET OF SHEETS STA. TO STA.

F.A.S. RTE.	SECTION	COUNTY	TOTAL SHEETS	SHEET NO.
248	(117)RS-4	BUREAU	20	7
CONTRACT NO. 66M96				
ILLINOIS FED. AID PROJECT				

Long Section Number

MAINLINE SCHEDULE												
STA. TO STA.	LENGTH	MAINLINE WIDTH	HMA SURFACE REMOVAL	HMA SURF.CSE MIX.C IL-9.5,N50	BINDER COURSE IL-19.0 N50	MATERIAL TRANSFER DEVICE	MIX FOR JTS, CRACKS & FLGWYS	BIT. MAT'L (TACK COAT)	LONG JOINT SEAL	AGG WEDGE TY B	TEMP RAMP	
	FT	FT	3 3/4" SQ YD	1 1/2" TONS	2 1/4" TONS	TON	TONS	POUND	FOOT	TONS	SQ YD	
URBAN												
21+71	28+94.	723	26	2089	175.4	263	438.6	0.6	157	723	54.9	36.1
URBAN SUBTOTALS				2089	175	263	439	1	157	723	55	36
RURAL												
28+94.	47+98.37	1904	26	5502	462.1	693	1155.3	1.7	413	1904	144.6	
STA EQ 47+98.37BK=47+96.37AH												
47+96.37	99+58.05	5162	26	14912	1252.6	1879	3131.4	4.5	1118	5162	391.9	
STA EQ 99+58.05BK=99+56.95AH												
99+56.95	129+22.35	2965	26	8567	719.6	1079	1799.0	2.6	643	2965	225.2	
STA EQ 129+22.35BK=129+23.00AH												
129+23.	143+43.8	1421	26	4105	344.8	517	862.0	1.2	308	1421	107.9	
STA EQ 143+43.80BK=143+46.30AH												
143+46.3	165+77.	2231	26	6444.2	541.3	812	1353.3	1.9	483	2231	169.4	
165+77.	178+93.	1316	29.34	4290.2	360.4	541	900.9	1.3	322	1316	99.9	
178+93.	185+17.68	625	26	1804.6	151.6	227	379.0	0.5	135	625	47.4	
STA EQ 185+17.68BK=185+16.64AH												
185+16.64	229+14.75	4398	26	12705.7	1067.3	1601	2668.2	3.8	953	4398	333.9	
STA EQ 229+14.75BK=228+90.50AH												
228+90.5	253+78.	2487.5	26	7186.1	603.6	905	1509.1	2.2	539	2488	188.9	36.1
253+78.	258+22.	444		BRIDGE OMISSION (SN 006-0114)								
258+22.	263+30.	508	22	1241.8	104.3	156	260.8	0.4	93	508	38.6	61.1
263+30.	285+58.	2228		PCC PAVEMENT OMISSION								
285+58.	286+51.	93	22	227.3	19.1	29	47.7	0.1	17	93	7.1	61.1
286+51.	286+60.	9		RAILROAD OMISSION								
286+60.	287+86.	126	22	308.0	25.9	39	64.7	0.1	23	126	9.6	61.1
RURAL SUBTOTALS				67292	5653	8479	14131	20	5047	23236	1764	219
TOTALS				69381	5828	8742	14570	21	5204	23959	1819	255

SIDEROADS SCHEDULE															
STATION	NAME	SIDE	MATERIAL	WIDTH FRONT	WIDTH BACK	VARIABLE DEPTH SURF REM	INCIDENTAL HMA SURF	BIT MATL (TACK COAT)	TEMP RAMP	FURNISH EX	SEEDING, CL 2A *	NITROGEN FERTILIZER NUTRIENT *	PHOSPHORUS FERTILIZER NUTRIENT *	POTASSIUM FERTILIZER NUTRIENT *	EROSION CONTROL BLANKET *
						SQ YD	TON	POUND	SQ YD	CU YD	ACRE	POUND	POUND	POUND	SQ YD
56+92	LOVER'S LANE	RT	HMA	60	20	133.3	19.8	60.0	11.1	0.4	0.002	0.2	0.2	0.2	10.0
92+50	SIDEROAD	LT	HMA	130	32	231.1	34.3	104.0	17.8	0.4	0.002	0.2	0.2	0.2	10.0
98+28	1250 NORTH AVE	LT	HMA	145	35	281.9	41.8	126.9	19.4	0.4	0.002	0.2	0.2	0.2	10.0
115+06	1950 EAST ROAD	LT	HMA	70	20	150.0	22.3	67.5	11.1	0.4	0.002	0.2	0.2	0.2	10.0
166+35	OLD ORCHARD ROAD	LT	PCC												
214+10	1795 EAST ROAD	LT	HMA	70	28	163.3	24.2	73.5	15.6	0.4	0.002	0.2	0.2	0.2	10.0
228+78	1150 NORTH ROAD	RT	HMA	88	32	200.0	29.7	90.0	17.8	0.4	0.002	0.2	0.2	0.2	10.0
228+78	1150 NORTH ROAD	LT	HMA	135	28	271.7	40.3	122.3	15.6	0.4	0.002	0.2	0.2	0.2	10.0
269+76	1075 NORTH ROAD	RT	HMA	106	24	216.7	32.2	97.5	13.3	0.4	0.002	0.2	0.2	0.2	10.0
287+32	1785 EAST ROAD	RT	HMA	100	45	241.7	35.9	108.8	25.0	0.4	0.002	0.2	0.2	0.2	10.0
TOTALS						1890	280	850	147	4	0.02	2	2	2	90

* SEEDING PAY ITEMS WILL NOT BE PAID FOR SEPARATELY, BUT WILL BE INCLUDED IN THE COST OF FURNISHED EXCAVATION.

MODEL: D:\h111...
 FILE NAME: ...
 PROJECT: ...
 DRAWING: ...
 SHEET: ...

USER NAME = tlmthy.zletsch	DESIGNED -	REVISED -	STATE OF ILLINOIS DEPARTMENT OF TRANSPORTATION	SCHEDULES				F.A.S. RTE.	SECTION	COUNTY	TOTAL SHEETS	SHEET NO.
DRAWN -	REVISED -	248						(117)RS-4	BUREAU	20	8	
PLOT SCALE = 100,000' / in.	CHECKED -	REVISED -		SCALE: SHEET OF SHEETS STA. TO STA.				ILLINOIS FED. AID PROJECT				
PLOT DATE = 12/13/2023	DATE -	REVISED -		CONTRACT NO. 66M96 Long Section Number								

PAVEMENT MARKING SCHEDULE											
LOCATION			LENGTH	MODIFIED URETHANE (2 APPLICATIONS)		THERMOPLASTIC PAVEMENT MARKING		GROOVING FOR RECESSED PAVT MKG		RAISED REFLECT PVMT MARK	RAISED REFLECT PVMT MARK REMOVAL
				LINE 4" WHITE	LINE 6" YELLOW	LET & SYM WHITE	LINE 24" WHITE	LET & SYM	LINE 25"		
STATION			FOOT	FOOT	FOOT	SQ FT	FOOT	SQ FT	FOOT	EACH	EACH
URBAN											
21+71	TO	28+94	723	2892	361.5					9	9
URBAN SUBTOTALS				2892	361.5					9	9
RURAL											
28+94	TO	47+98.37	1904.37	7617.48	952.185					24	24
STA EQ 47+98.37BK = 47+96.37AH											
47+96.37	TO	99+58.05	5161.68	20646.72	2580.84					65	65
STA EQ 99+58.05BK = 99+56.95AH											
99+56.95	TO	129+22.35	2965.4	11861.6	1482.7					37	37
STA EQ 129+22.35BK = 129+23.00AH											
129+23.00	TO	143+43.80	1420.8	5683.2	710.4					18	18
STA EQ 143+43.80BK = 143+46.30AH											
143+46.30	TO	185+17.68	4171.38	16685.52	2085.69					52	52
STA EQ 185+17.68BK = 185+16.64AH											
185+16.64	TO	229+14.75	4398.11	17592.44	2199.055					55	55
STA EQ 229+14.75BK = 228+90.50AH											
228+90.50	TO	287+86.00	5895.5	23582	2947.75	58	44	58	44	74	74
RURAL SUBTOTALS				103669	12959	58	44	58	44	325	325
TOTAL				106561	13320	58	44	58	44	334	334

PAVEMENT MARKING INCLUDES BRIDGE OMISSION

PAVEMENT MARKING SCHEDULE (NO PASSING ZONES)					
LOCATION			LOCATION	MODIFIED URETHANE (2 APPLICATIONS)	
STATION				NB / SB	LINE 4" YELLOW
URBAN					
21+71	TO	28+94	SB		860
21+71	TO	28+94	NB		590
URBAN SUBTOTALS					1450
RURAL					
28+94	TO	287+86.00	SB		30380
28+94.00	TO	287+86.00	NB		27270
RURAL SUBTOTALS					57650
TOTAL					59100

THE RESIDENT ENGINEER SHALL VERIFY THE LOCATIONS OF THE NO PASSING ZONES.

SHORT TERM PAVEMENT MARKINGS					
LOCATION			LENGTH	SHORT TERM PVMT	SHORT TERM PVMT REM
STATION			FOOT	FOOT	SQ FT
URBAN					
21+71	TO	28+94	723	217	24
URBAN SUBTOTALS			723	217	24
RURAL					
28+94	TO	47+98.37	1904	571	63
STA EQ 47+98.37BK = 47+96.37AH					
47+96.37	TO	99+58.05	5162	1549	172
STA EQ 99+58.05BK = 99+56.95AH					
99+56.95	TO	129+22.35	2965	890	99
STA EQ 129+22.35BK = 129+23.00AH					
129+23.00	TO	143+43.80	1421	426	47
STA EQ 143+43.80BK = 143+46.30AH					
143+46.30	TO	185+17.68	4171	1251	139
STA EQ 185+17.68BK = 185+16.64AH					
185+16.64	TO	229+14.75	4398	1319	147
STA EQ 229+14.75BK = 228+90.50AH					
228+90.50	TO	287+86.00	5896	1769	197
RURAL SUBTOTALS			25917	7776	864
TOTAL			26640	7993	888

*THIS QUANTITY IS FOR 3 APPLICATIONS IF NEEDED.

MODEL: D:\info\... FILE NAME: ...

USER NAME = tlmothy.zletsch	DESIGNED -	REVISED -
PLOT SCALE = 100,000' / in.	DRAWN -	REVISED -
PLOT DATE = 12/14/2023	CHECKED -	REVISED -
	DATE -	REVISED -

STATE OF ILLINOIS
DEPARTMENT OF TRANSPORTATION

SCHEDULES			
SCALE:	SHEET	OF	SHEETS
	STA.		TO STA.

F.A.S. RTE.	SECTION	COUNTY	TOTAL SHEETS	SHEET NO.
248	(117)RS-4	BUREAU	20	10
CONTRACT NO. 66M96				
ILLINOIS FED. AID PROJECT				

Long Section Number

GRADING AND SHAPING DITCHES SCHEDULE												
STATION		LOCATION	LENGTH	WIDTH	DEPTH	DIRECTION OF FLOW	GRADING AND SHAPING DITCHES	SEEDING CL 2A	NITRO FERT NUT	PHOSP FERT NUT	POT FERT NUT	EROSION CONTROL BLANKET
STA. TO STA.		N/S/E/W	FOOT	FOOT	FOOT		FOOT	ACRE	LB	LB	LB	SQ YD
34+00	34+50	EAST	50	6	0.5	SOUTH	50	0.01	0.6	0.6	0.6	33
37+06	37+06	EAST	20	6	0.5	EAST	20	0.00	0.2	0.2	0.2	13
38+50	39+50	EAST	100	6	0.5	NORTH	100	0.01	1.2	1.2	1.2	67
42+50	44+50	EAST	200	6	0.5	NORTH	200	0.03	2.5	2.5	2.5	133
44+50	45+50	WEST	100	6	0.5	SOUTH	100	0.01	1.2	1.2	1.2	67
64+00	66+00	WEST	200	6	0.5	SOUTH	200	0.03	2.5	2.5	2.5	133
100+50	101+50	NORTH	100	6	0.5	EAST	100	0.01	1.2	1.2	1.2	67
105+50	106+50	NORTH	100	6	0.5	EAST	100	0.01	1.2	1.2	1.2	67
204+50	206+00	NORTH	150	6	0.5	WEST	150	0.02	1.9	1.9	1.9	100
207+00	208+00	NORTH	100	6	0.5	WEST	100	0.01	1.2	1.2	1.2	67
218+05	218+05	SOUTH	50	6	0.5	SOUTH	50	0.01	0.6	0.6	0.6	33
226+00	227+50	WEST	150	6	0.5	SOUTH	150	0.02	1.9	1.9	1.9	100
274+80	276+80	EAST	200	6	0.5	SOUTH	200	0.03	2.5	2.5	2.5	133
TOTALS							1520	0.2	19	19	19	1013

* GRADE DOWNSTREAM FROM CULVERT #4625
 ** GRADE DOWNSTREAM FROM CULVERT #4611

DRAINAGE STRUCTURE REPAIR SCHEDULE													
STRUCTURE NUMBER	STATION	LOCATION	BOX OR PIPE SIZE	STONE DUMPED RIPRAP, CLASS A4	FILTER FABRIC	EARTH EX	FURN EX	BOX CULVERTS TO BE CLEANED	REMOVE AND RELAY END SECTIONS	PIPE CULVERTS, CLASS D, TYPE 1, 12"	METAL FLARED END SECTIONS 12"	CONCRETE COLLAR	DESCRIPTION OF WORK
				SQ YD	SQ YD	CU YD	CU YD	FOOT	EACH	FOOT	EACH	CU YD	
URBAN													
#4626 *	23+71	W	24"			0.8						0.6	POUR COLLAR AROUND WEST END SECTION
URBAN SUBTOTALS				0	0	0.8	0	0	0	0	0	0.6	
RURAL													
#4621	99+10	S	4' X 1.5'	8	8								PLACE 8 SQ YD RR4 AND FILTER FABRIC, 4 SQ YD AT THE OUTLET AND 4 SQ YD TO THE EAST TO STABILIZE EMBANKMENT
#4619	130+45	S	4' X 1.5'	4	4								PLACE 4 SQ YD OF RR4 AND FILTER FABRIC AT SOUTH APPROACH
#4616	164+50	N	3' X 2'	4	4								PLACE 4 SQ YD OF RR4 AND FILTER FABRIC BETWEEN TILE OUTLET AND NORTH END SECTION
006-2616	181+90	NW & SE	6' X 6'			5		35					CLEAN BARREL, EXCAVATE SILT AT UPSTREAM AND DOWNSTREAM FACES
#4614	193+50	N & S	4' X 3'	8	8								PLACE 4 SQ YD RR4 AND FILTER FABRIC AT NORTH OUTLET, AND 2 SQ YD EACH ALONG OUTSIDE FACE OF BOTH SOUTH WINGS
#4612	207+20	NW & SE	3' X 1.5'					35					CLEAN BARREL
#4610	213+95	NW & SE	24"				5		1				PLACE FURN EX AND SEEDING AROUND MANHOLE JCT. AND RESET END SECTION AND FIRST SECTION OF PIPE DOWNSTREAM END
	218+00	S		4	4								PLACE 4 SQ YD, 12' X 3', AT WASHOUT BY UNDERDRAIN, ALONG SOUTH EMBANKMENT
006-2554	219+37	SW	10' X 10'	6	6								PLACE 6 SQ YD RR4 AND FILTER FABRIC ALONG OUTSIDE FACE OF SW WING
006-0114	256+00	NE	BRIDGE	4	4					8	1		REPLACE LAST 8' OF CMP, PLUS END SECTION, AND PLACE 4 SQ YD RR4 AND FILTER FABRIC AT THE NE QUAD
RURAL SUBTOTALS				38	38	5	5	70	1	8	1	0	
TOTAL				38	38	6	5	70	1	8	1	0.6	

* REC SITE # 4524-2, ANY EXCESS MATERIAL AT THIS LOCATION SHALL REMAIN ON SITE.

MODEL: D:\data\...
 FILE NAME: ...

USER NAME = tlmthy_zletsch	DESIGNED -	REVISED -	STATE OF ILLINOIS DEPARTMENT OF TRANSPORTATION	SCHEDULES				F.A.S. RTE.	SECTION	COUNTY	TOTAL SHEETS	SHEET NO.
DRAWN -	REVISED -					248	(117)RS-4	BUREAU	20	12		
PLOT SCALE = 100,000' / in.	CHECKED -	REVISED -		SCALE: SHEET OF SHEETS STA. TO STA.				CONTRACT NO. 66M96				
PLOT DATE = 12/13/2023	DATE -	REVISED -						ILLINOIS FED. AID PROJECT				

Long Section Number

LINEAR DELINEATOR PANEL SCHEDULE						
STRUCTURE NUMBER	SIDE	STRUCTURE CENTERLINE	GUARDRAIL LENGTH	PARAPET LENGTH	LINEAR DELINEATOR PANELS, 4"	LINEAR DELINEATOR PANELS, 6"
		STATION	FT	FT	EACH	EACH
006-2616	LEFT	181+90.00	500.0		8	
006-2616	RIGHT	181+90.00	550.0		9	
4614	LEFT	193+50.00	112.5		3	
4614	RIGHT	193+50.00	125.0		4	
4613	LEFT	204+56.00	112.5		3	
4613	RIGHT	204+56.00	162.5		4	
4610	LEFT	213+95.00	87.5		3	
4610	RIGHT	213+95.00	100.0		3	
006-2552	LEFT	218+46.00	725.0		11	
006-2552	RIGHT	218+46.00	437.5		7	
006-0114	LEFT	256+00.00	300.0	378.99	6	7
006-0114	RIGHT	256+00.00	237.5	378.99	8	7
TOTAL			3450	758	69	14

MONUMENT NUMBER	DESCRIPTION	APPROXIMATE LOCATION	EXISTING MONUMENT TYPE	PROPOSED MONUMENT TYPE	MONUMENT RECORD TO BE RECORDED	RESPONSIBILITY
TS001	E QTR CORNER SECTION 12, T15N, R8E, 4TH PM	300' +/- NORTH OF TRACKS	CUT CROSS	TYPE 1	YES	1
TS002	W QTR CORNER SECTION 7, T15N, R9E, 4TH PM	300' +/- NORTH OF TRACKS	CUT CROSS	TYPE 1	YES	1
<p>ONLY THE ORIGINAL SCOPE OF THIS JOB HAS BEEN SEARCHED FOR MONUMENTS. R.E. MUST INFORM PLATS AND PLANS TO SEARCH FOR ADDITIONAL MONUMENTS PRIOR TO MILLING IF ADDENDUMS HAVE BEEN ADDED TO THIS JOB.</p> <p>UNKNOWN MONUMENTS MAY EXIST. IF AN UNLISTED MONUMENT IS FOUND, R.E. IS REQUIRED TO PROTECT THE MONUMENT FROM DAMAGE UNTIL A PLATS AND PLANS LAND SURVEYOR CAN DOCUMENT THE MONUMENT. PLATS AND PLANS WILL RESET SUCH MONUMENTS IN KIND FOLLOWING CONSTRUCTION.</p> <p>UPON PAVING COMPLETION, R.E. WILL DIRECT PLATS AND PLANS TO STAKE THE TYPE 1 PSM CORING LOCATIONS.</p> <p>NOTE: FOR BIDDING PURPOSES NO CONTRACTED LAND SURVEYING SERVICES WILL BE REQUIRED. PLATS AND PLANS WILL PREPARE THE REQUIRED MONUMENT RECORDS.</p> <p>RESPONSIBILITY:</p> <p>1) RESIDENT TO RE-ESTABLISH MONUMENT (PAY ITEM REQUIRED. PERMANENT SURVEY MARKER, TYPE 1)</p> <p>2) PLATS AND PLANS TO RE-ESTABLISH MONUMENT</p>						

MODEL: D:\data\...
 FILE NAME: ...

USER NAME = tlmthy.zletsch	DESIGNED -	REVISED -
PLOT SCALE = 100,000' / in.	DRAWN -	REVISED -
PLOT DATE = 12/14/2023	CHECKED -	REVISED -
	DATE -	REVISED -

**STATE OF ILLINOIS
DEPARTMENT OF TRANSPORTATION**

SCHEDULES

SCALE: SHEET OF SHEETS STA. TO STA.

F.A.S. RTE.	SECTION	COUNTY	TOTAL SHEETS	SHEET NO.
248	(117)RS-4	BUREAU	20	13
CONTRACT NO. 66M96				
ILLINOIS FED. AID PROJECT				

Long Section Number

DATE	BY	SURVEYED	PLOTTED	TEMPLATE	AREAS CHECKED
NO.	NO.	NO.	NO.	NO.	NO.

DATE	BY	SURVEYED	PLOTTED	TEMPLATE	AREAS CHECKED
NO.	NO.	NO.	NO.	NO.	NO.

MODEL: D:\infra\...
 FILE NAME: j:\work\p\...
 PROJECT: D:\infra\...
 LAYOUT: Main.dgn

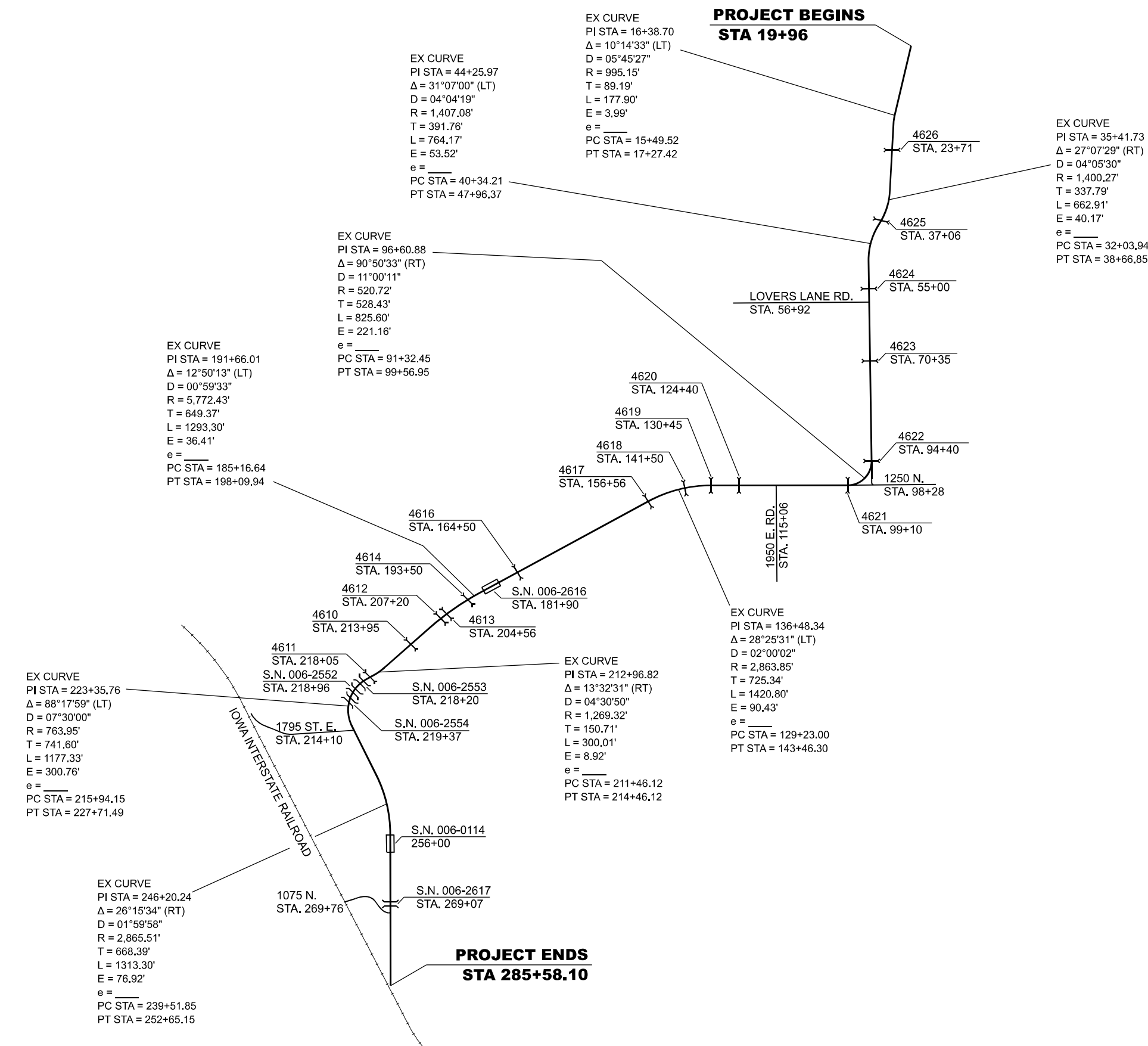

USER NAME = tlmthy_zletsch	DESIGNED -	REVISED -
DRAWN -	REVISED -	
PLOT SCALE = 100,000' / in.	CHECKED -	REVISED -
PLOT DATE = 12/13/2023	DATE -	REVISED -

**STATE OF ILLINOIS
DEPARTMENT OF TRANSPORTATION**

LOCATION MAP			
SCALE:	SHEET	OF SHEETS	STA. TO STA.

F.A.S. RTE.	SECTION	COUNTY	TOTAL SHEETS	SHEET NO.
248	(117)RS-4	BUREAU	20	14
CONTRACT NO. 66M96				
ILLINOIS		FED. AID PROJECT		

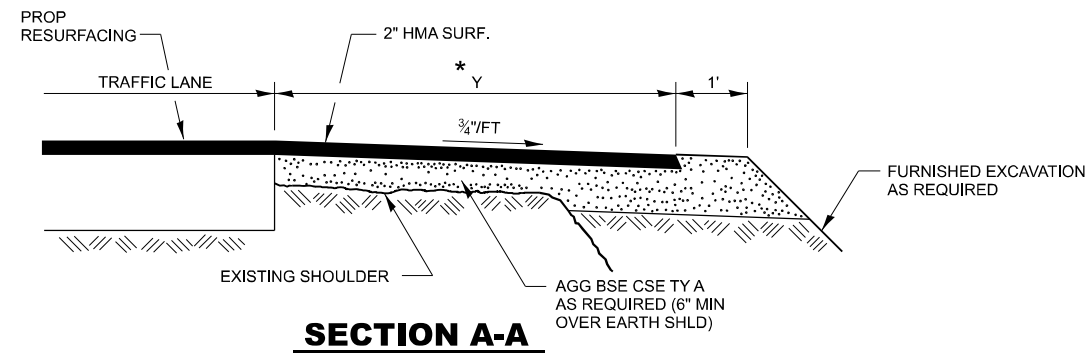
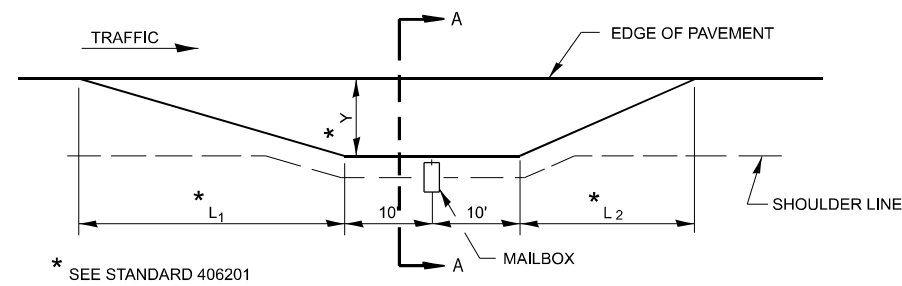

RURAL MAILBOX TURNOUT DETAILS

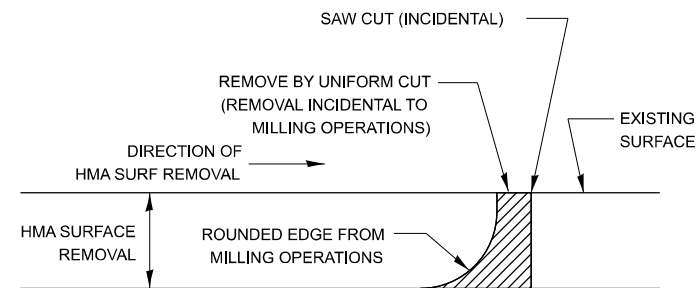

NOTE:
WHEN MILLING OPERATIONS PRODUCE A ROUNDED EDGE, THEN A SAW CUT SHALL BE USED TO MANUFACTURE A PERPENDICULAR EDGE AS SHOWN IN THE DETAIL. THE ENGINEER SHALL BE THE SOLE JUDGE CONCERNING THE USE OF THIS DETAIL

HMA BUTT JOINT SAW CUTS

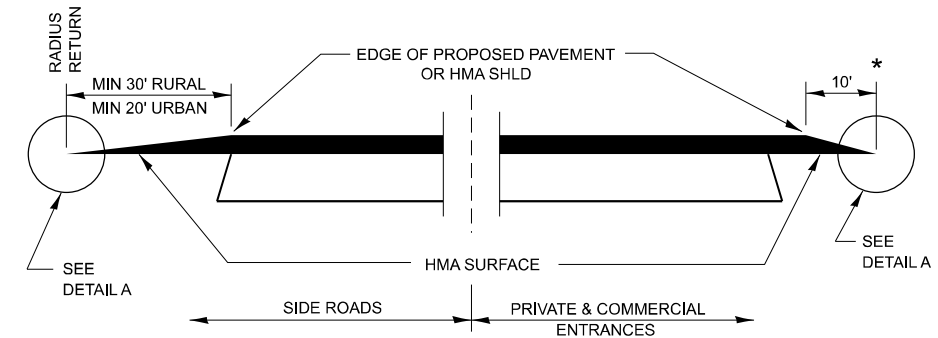

SECTION A-A DETAILS AT ENTRANCES & SIDE ROADS

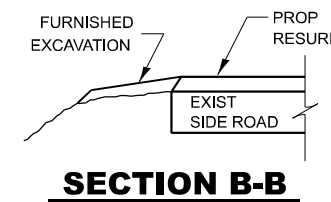

THE COST OF REMOVAL AT EXISTING HMA OR PCC LOCATIONS SHALL BE PAID FOR PER SQ YD BY THE APPROPRIATE PAY ITEM. REMOVAL AT THE EXISTING AGG LOCATIONS SHALL BE INCIDENTAL TO THE HMA. A-3 LOCATIONS SHALL BE FEATHER TAPERED.

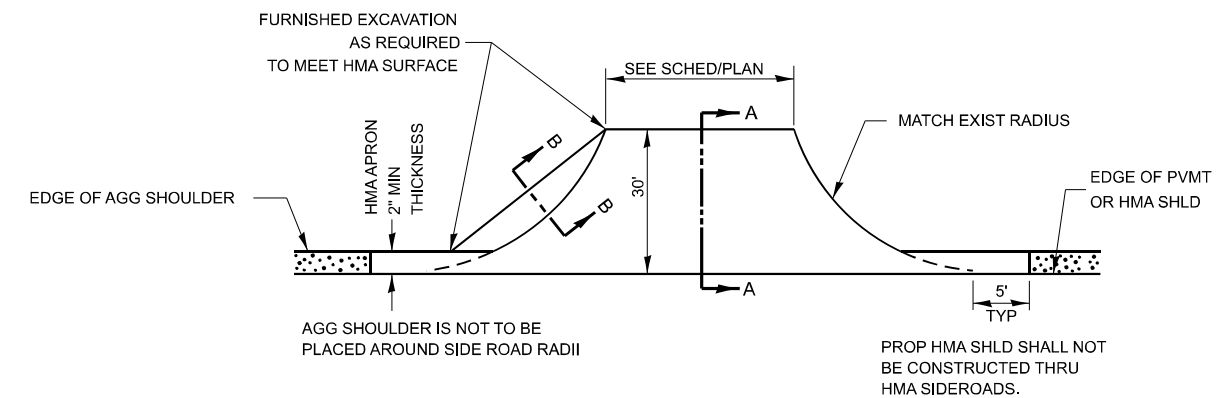
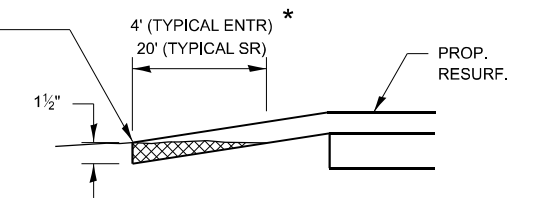

PLAN AT SIDE ROADS

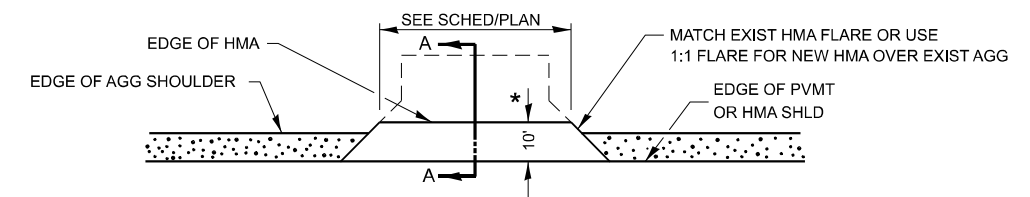

PLAN AT PRIVATE & COMMERCIAL ENTRANCES

(DO NOT RESURFACE FIELD ENTRANCES)

* PROPOSED HMA RESURFACING AT PUBLIC EDUCATIONAL FACILITY ENTRANCES SHALL BE EXTENDED TO THE RIGHT-OF-WAY LIMITS.

MODEL: Detail
FILE NAME: p:\projects\66M96\Drawings\DOT\Drawings\66M96\CAD\Drawings\66M96\Detail.dgn

USER NAME = tlmothy.zletsch	DESIGNED -	REVISED -
PLOT SCALE = 2,000' / in.	DRAWN -	REVISED -
PLOT DATE = 12/13/2023	CHECKED -	REVISED -
	DATE -	REVISED -

STATE OF ILLINOIS
DEPARTMENT OF TRANSPORTATION

SCALE:		SHEET OF SHEETS		STA. TO STA.	

F.A.S. RTE.	SECTION	COUNTY	TOTAL SHEETS	SHEET NO.
248	(117)RS-4	BUREAU	20	15
CONTRACT NO. 66M96				
ILLINOIS FED. AID PROJECT				

Long Section Number

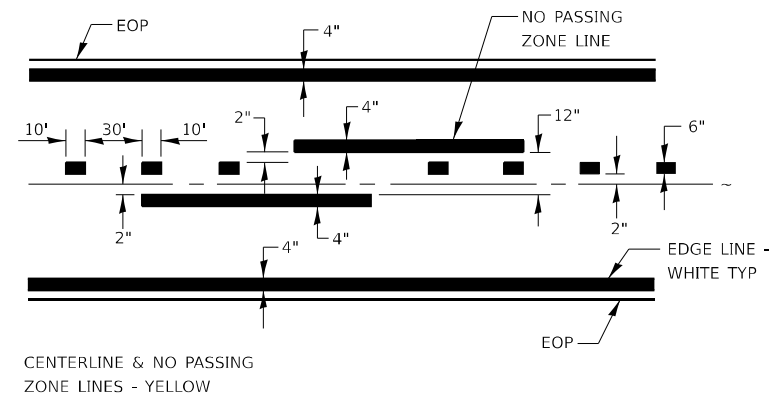

PAVEMENT MARKING

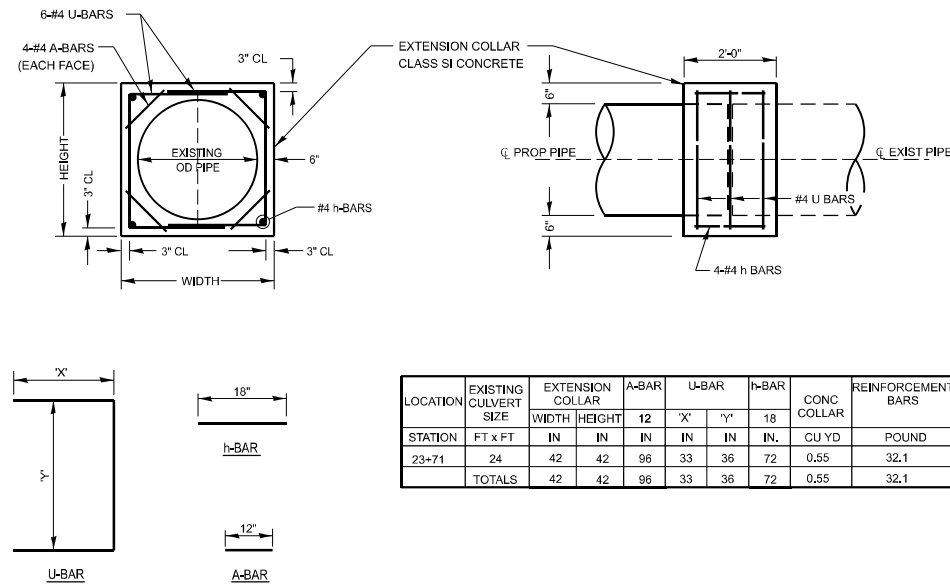

CONCRETE COLLAR DETAIL

LOCATION	EXISTING CULVERT SIZE	EXTENSION COLLAR		A-BAR		U-BAR		h-BAR		CONC COLLAR	REINFORCEMENT BARS
STATION	FT x FT	WIDTH	HEIGHT	12	X'	Y'	18			CU YD	POUND
23+71	24	42	42	96	33	36	72	0.55			32.1
TOTALS		42	42	96	33	36	72	0.55			32.1

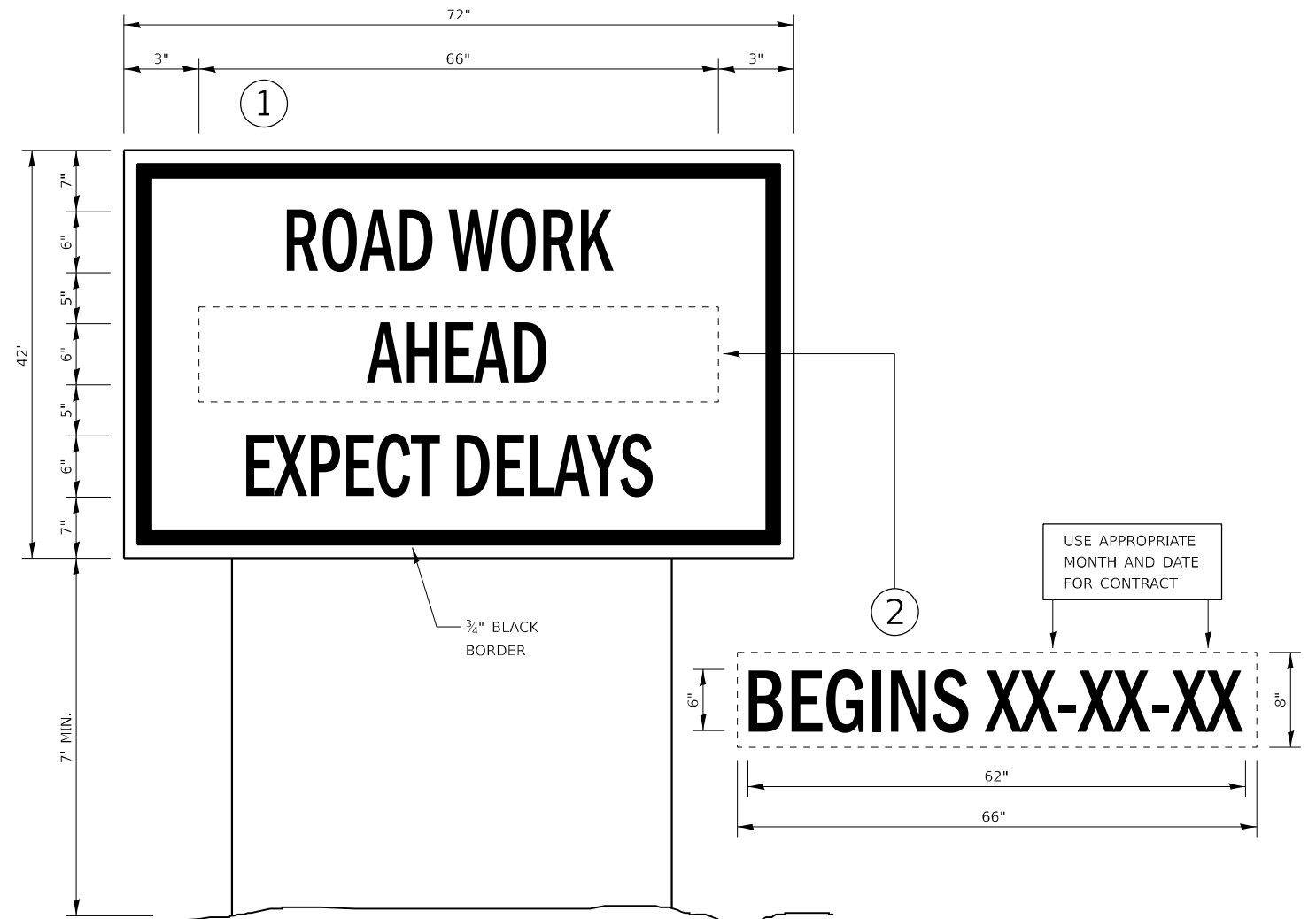

TEMPORARY INFORMATION SIGNING

NOTES:

- USE 6" D BLACK LETTERING ON FLUORESCENT ORANGE BACKGROUND.
- ERECT SIGNS AT LOCATIONS IN ADVANCE OF THE "ROAD CONSTRUCTION AHEAD" SIGNS AS DIRECTED BY THE ENGINEER.
- ERECT SIGN ① WITH INSTALLED PANEL ② A MINIMUM OF ONE WEEK PRIOR TO THE START OF THE LANE CLOSURE.
- REMOVE PANEL ② ON THAT DATE.
- SEE SPECIAL PROVISION "TEMPORARY INFORMATION SIGNING" FOR ADDITIONAL INFORMATION.
- WILL BE PAID FOR PER SQ FT AS "TEMPORARY INFORMATION SIGNING". EACH SIGN = 21 SQ FT AND THE DATE PANEL ② WILL NOT BE MEASURED SEPARATELY FOR PAYMENT.

MODEL: D:\info... FILE NAME: ...

USER NAME = tlmothy.zletsch	DESIGNED -	REVISED -
PLOT SCALE = 2,000' / in.	DRAWN -	REVISED -
PLOT DATE = 12/13/2023	CHECKED -	REVISED -
	DATE -	REVISED -

**STATE OF ILLINOIS
DEPARTMENT OF TRANSPORTATION**

SCALE:		SHEET	OF	SHEETS	STA.	TO STA.
--------	--	-------	----	--------	------	---------

F.A.S. RTE.	SECTION	COUNTY	TOTAL SHEETS	SHEET NO.
248	(117)RS-4	BUREAU	20	16
CONTRACT NO. 66M96				
ILLINOIS FED. AID PROJECT				

Long Section Number

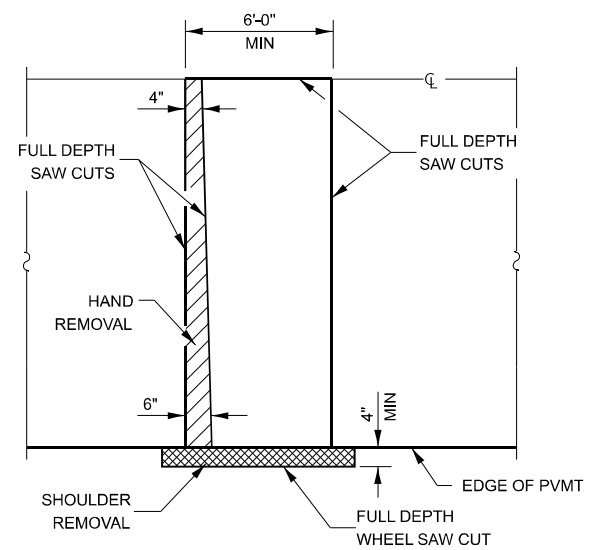

PAVEMENT SAWING DETAIL
(HMA SHOULDER)

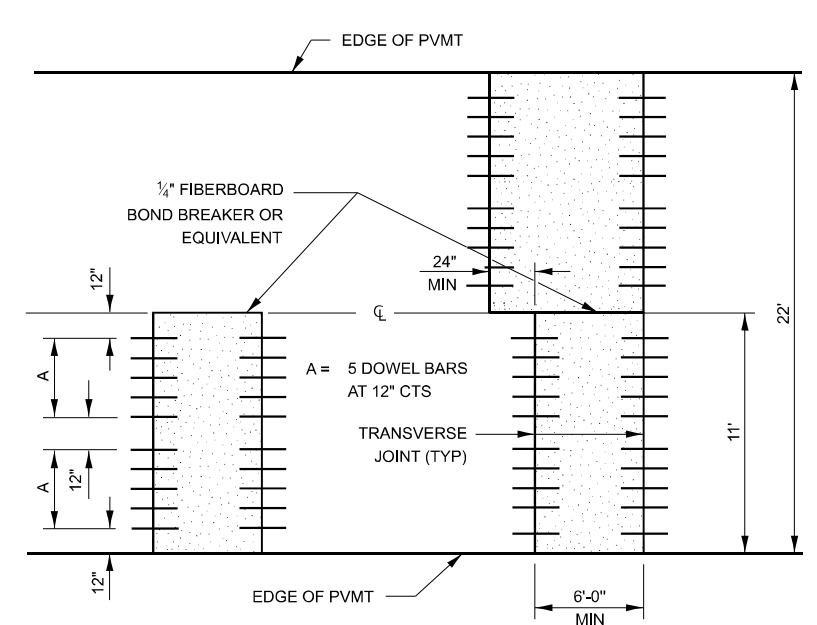

11' WIDE LANES

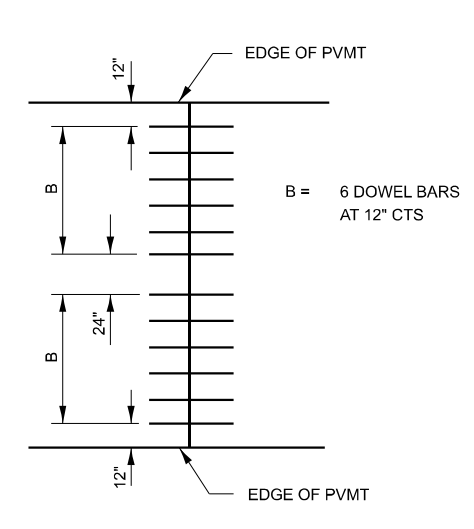

14' WIDE RAMP

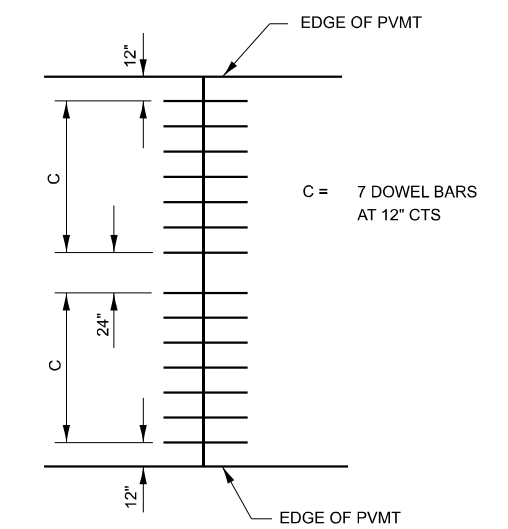

16' WIDE RAMP

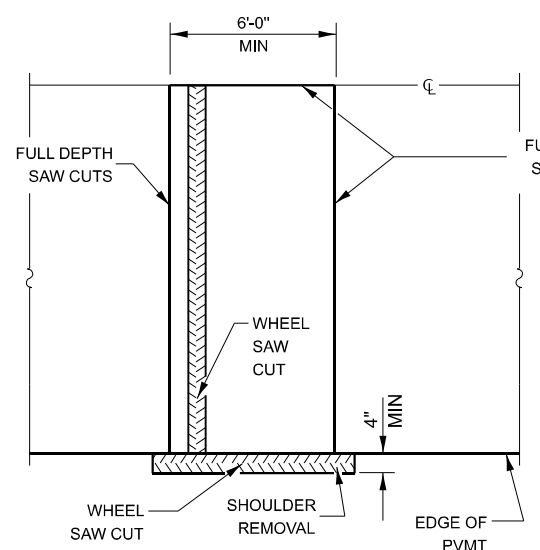

ALTERNATE SAWING DETAIL
(HMA SHOULDER)

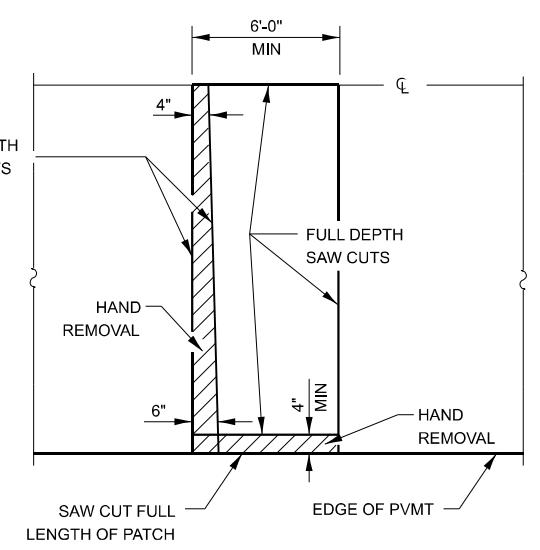

PAVEMENT SAWING DETAIL
(PCC SHOULDER)

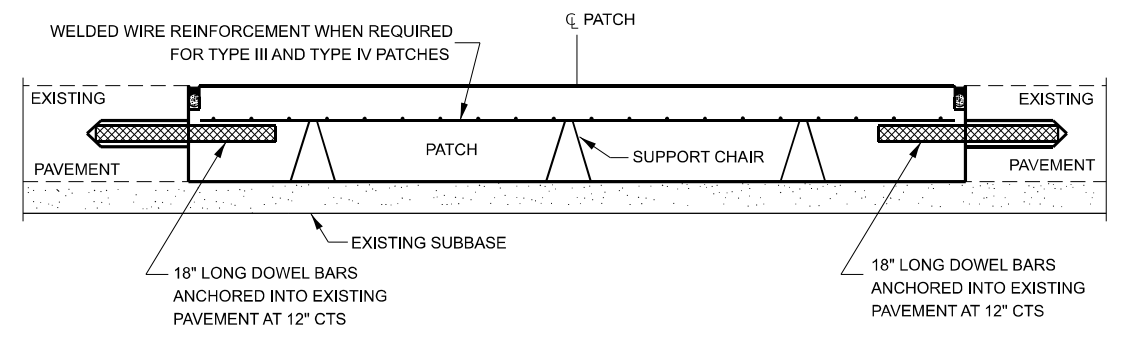

PATCHING WITHOUT HMA OVERLAY

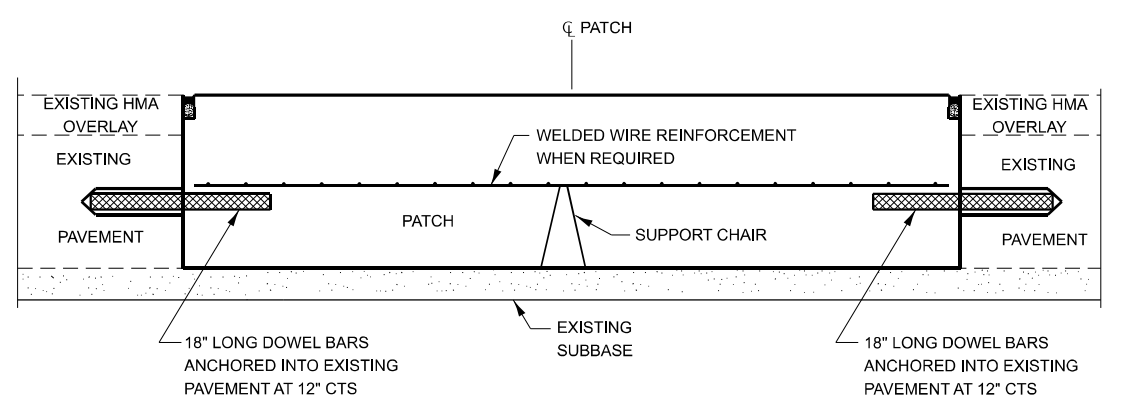

PATCHING WITH HMA OVERLAY

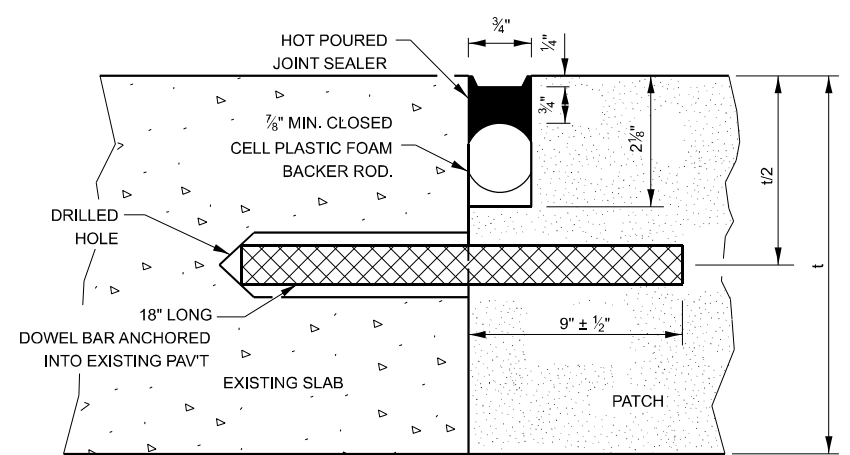

TRANSVERSE JOINT

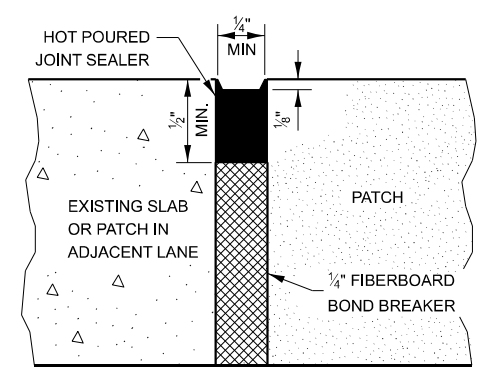

CENTERLINE JOINT

DOWEL BAR TABLE		
PAVEMENT THICKNESS	DOWEL BAR DIAMETER	HOLE DIAMETER
8" OR GREATER	1 1/2"	1 5/8"
7" THRU 7.99"	1 1/4"	1 3/8"
LESS THAN 7"	1"	1 1/8"

GENERAL NOTES

THE TRANSVERSE JOINTS FOR CLASS B PATCHES SHALL ALIGN WITH JOINTS OR CRACKS IN THE ADJACENT LANE WHENEVER POSSIBLE.

SEE STANDARD 420701 FOR DETAILS OF PAVEMENT WELDED WIRE REINFORCEMENT.

MODEL: D:\info\... FILE NAME: ...

USER NAME = tlmothy.zletsch	DESIGNED -	REVISED -
DRAWN -	REVISOR -	REVISION -
PLOT SCALE = 2,000' / 1 in.	CHECKED -	REVISOR -
PLOT DATE = 12/13/2023	DATE -	REVISION -

**STATE OF ILLINOIS
DEPARTMENT OF TRANSPORTATION**

CLASS B PATCHING DETAILS

SCALE:	SHEET	OF	SHEETS	STA.	TO STA.
--------	-------	----	--------	------	---------

F.A.S. RTE.	SECTION	COUNTY	TOTAL SHEETS	SHEET NO.
248	(117)RS-4	BUREAU	20	17
CONTRACT NO. 66M96				
ILLINOIS FED. AID PROJECT				

Long Section Number

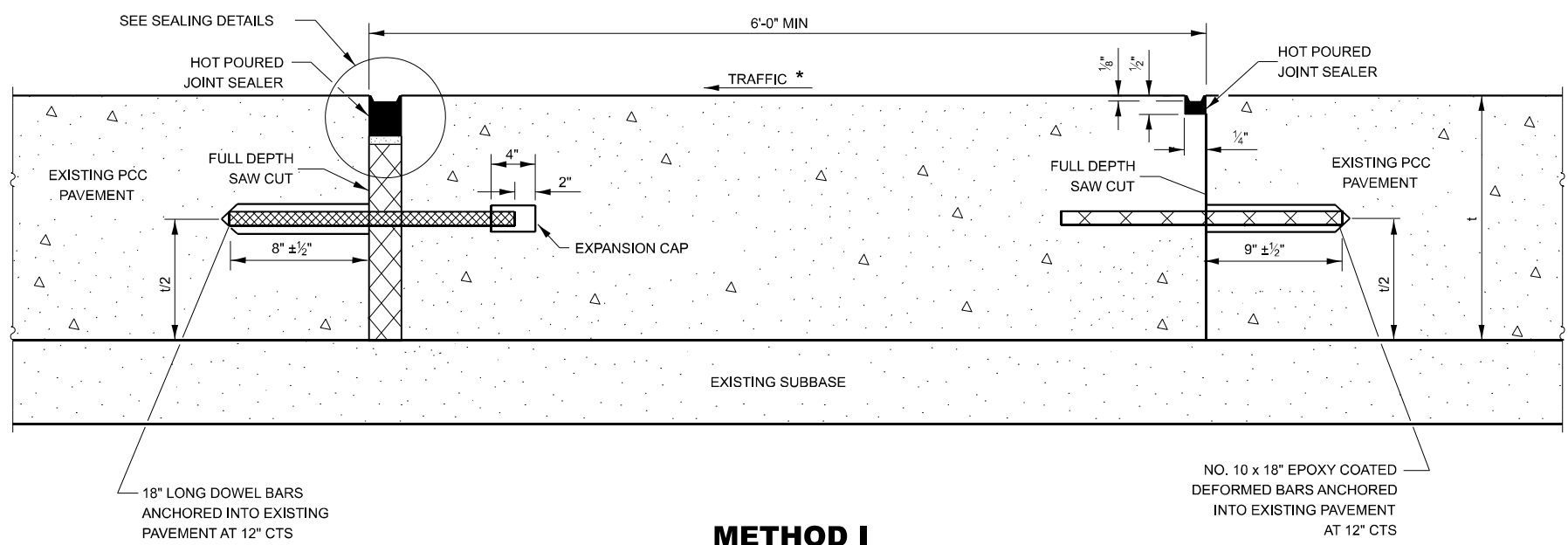

METHOD I
(WITHOUT HMA OVERLAY)

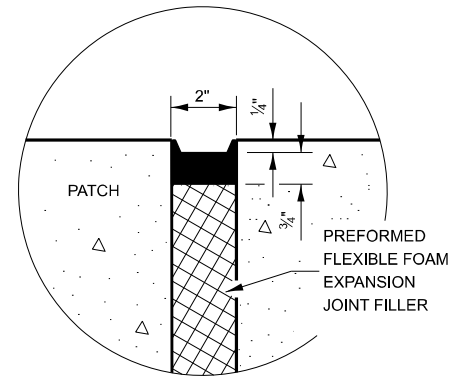

SEALING DETAIL

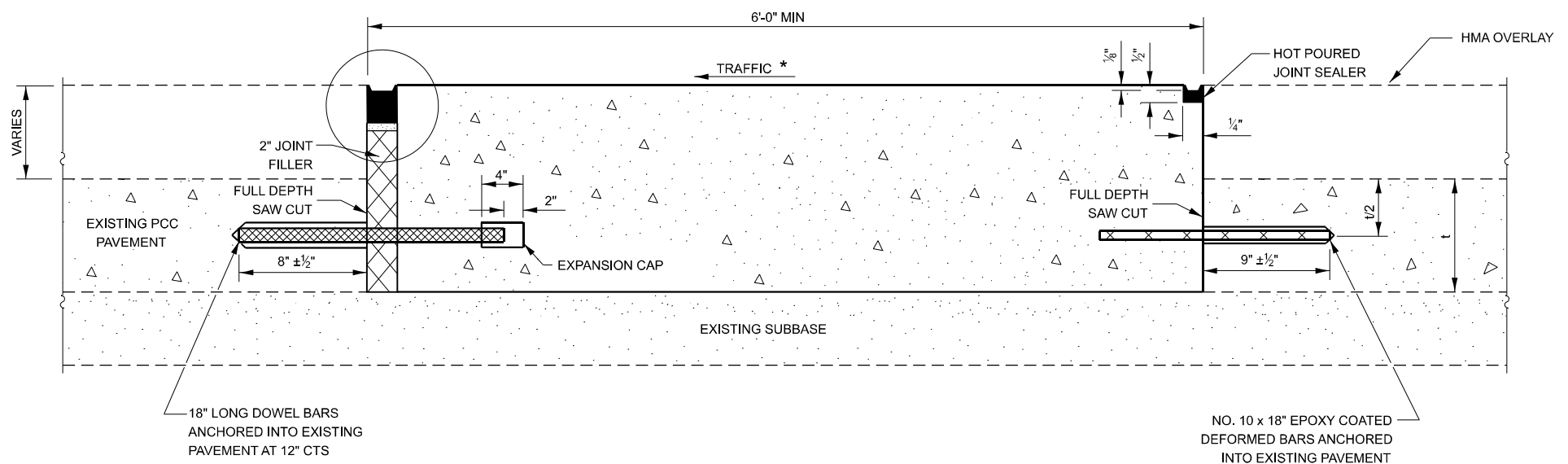

METHOD II
(WITH HMA OVERLAY)

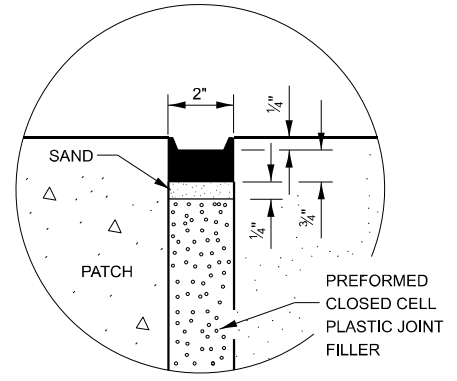

SEALING DETAIL

NOTE

* WHEN RE-ESTABLISHING A TRANSVERSE EXPANSION JOINT ON A TWO-WAY ROAD, REVERSE THE ORIENTATION OF THE DOWEL BARS WITH RESPECT TO TRAFFIC FOR ONE OF THE PATCHES SUCH THAT THE JOINT WILL BE CONTINUOUS ACROSS BOTH LANES.

MODEL: D:\info... FILE NAME: ...

USER NAME = tlmothy.zletsch	DESIGNED -	REVISED -
DRAWN -	REVISED -	
PLOT SCALE = 2,000 1/16"	CHECKED -	REVISED -
PLOT DATE = 12/13/2023	DATE -	REVISED -

STATE OF ILLINOIS
DEPARTMENT OF TRANSPORTATION

CLASS B PATCHING DETAILS

SCALE: SHEET OF SHEETS STA. TO STA.

F.A.S. RTE.	SECTION	COUNTY	TOTAL SHEETS	SHEET NO.
248	(117)RS-4	BUREAU	20	18
CONTRACT NO. 66M96				
ILLINOIS		FED. AID PROJECT		

Long Section Number

IDENTIFICATION OF ROADSIDE HAZARDS FOR TWO-LANE ROADWAYS

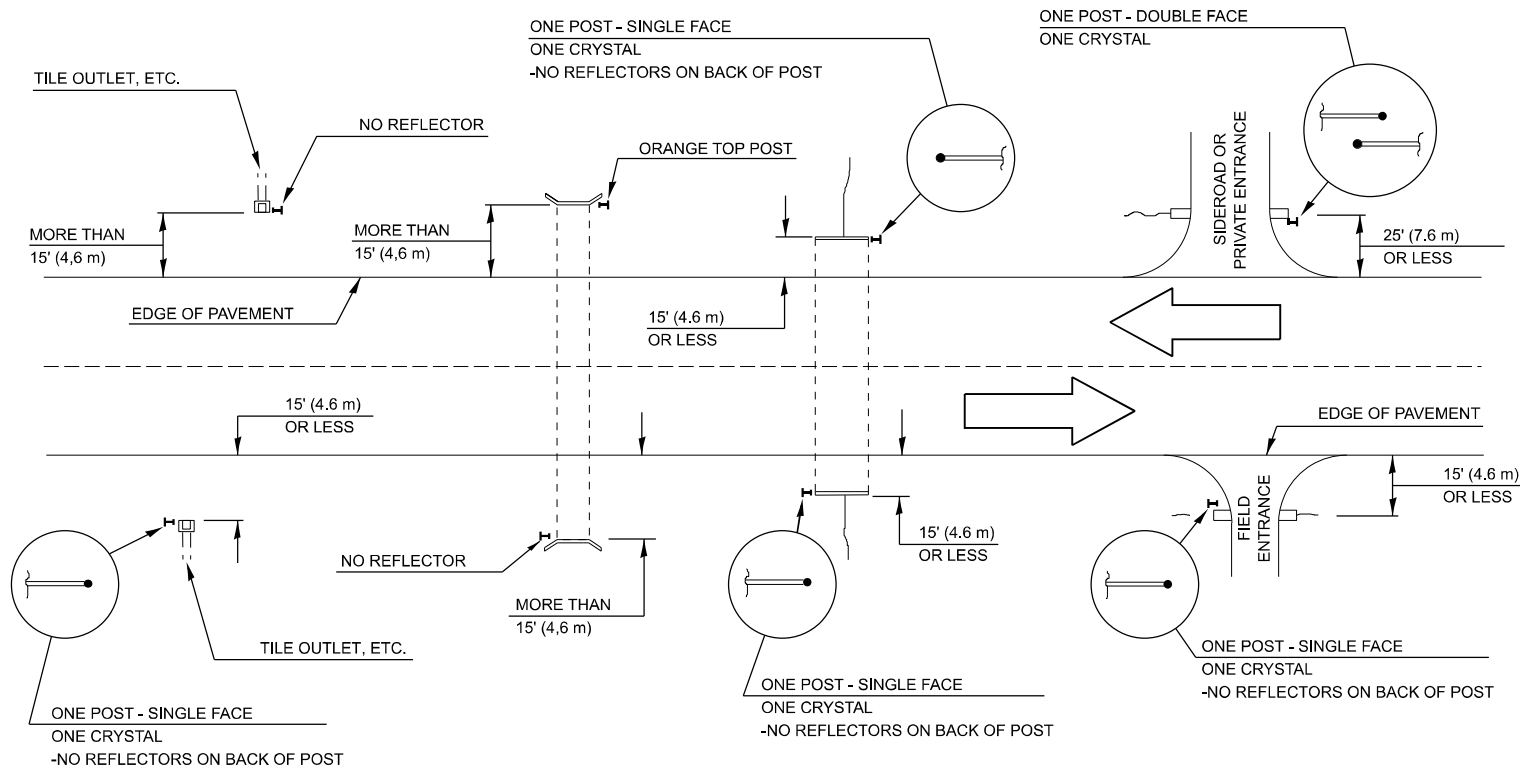

ROADSIDE HAZARDS DELINEATOR SCHEDULE			
STRUCTURE NUMBER	SIDE	STRUCTURE CENTERLINE STATION	DELINEATORS EACH
URBAN			
4626	LT, RT	23+71	2
TOTAL			2
RURAL			
4625	LT, RT	37+06	2
4624	LT, RT	55+00	2
4623	LT, RT	70+35	2
4622	LT, RT	94+40	2
4621	LT, RT	99+10	2
4620	LT, RT	124+40	2
4619	LT, RT	130+45	2
4618	LT, RT	141+50	2
4617	LT, RT	156+54	2
4616	LT, RT	164+50	2
4614	LT, RT	193+50	2
4613	LT, RT	204+56	2
4612	LT, RT	207+20	2
4610	LT, RT	213+95	2
4611	LT, RT	218+05	2
TOTAL			30
TOTAL			32

NOTE:

DELINEATORS FOR ROADSIDE HAZARDS SHALL ONLY BE PLACED AT LOCATIONS WHERE THERE IS NO GUARDRAIL, OR OTHER PERMANENT BARRIER, ON THE SAME SIDE OF THE ROAD AS THE HAZZARD.

DELINEATORS FOR ROADSIDE HAZARDS SHALL ONLY BE PLACED AT LOCATIONS WHERE DELINEATORS ARE NOT IN PLACE ALONG THE EDGE OF SHOULDER.

EACH POST SHALL BE CONSIDERED AS ONE DELINEATOR FOR PAYMENT, REGARDLESS OF THE NUMBER OF DELINEATORS ATTACHED TO IT.

FOR ONE-WAY AND INTERSTATE ROADWAYS THE APPLICATION SHALL BE SIMILAR WITH DELINEATORS PLACED ON THE TRAFFIC APPROACH SIDE OF HAZARDS AND OBJECTS, ONLY SINGLE FACE DELINEATORS WILL BE REQUIRED ON ONE-WAY ROADWAYS, CRYSTAL ON THE RIGHT SIDE AND AMBER ON THE LEFT SIDE.

FOR OTHER DELINEATOR APPLICATIONS, REFER TO HIGHWAY STANDARD 635001.

MODEL: D:\info\... FILE NAME: ...

USER NAME = tlmothy.zletsch	DESIGNED -	REVISED -
DRAWN -	REVISED -	
PLOT SCALE = 2,000' / 1 in.	CHECKED -	REVISED -
PLOT DATE = 12/13/2023	DATE -	REVISED -

**STATE OF ILLINOIS
DEPARTMENT OF TRANSPORTATION**

DELINEATOR PLACEMENT	
SCALE:	SHEET OF SHEETS STA. TO STA.

F.A.S. RTE.	SECTION	COUNTY	TOTAL SHEETS	SHEET NO.
248	(117)RS-4	BUREAU	20	19
CONTRACT NO. 66M96				
Long Section Number				

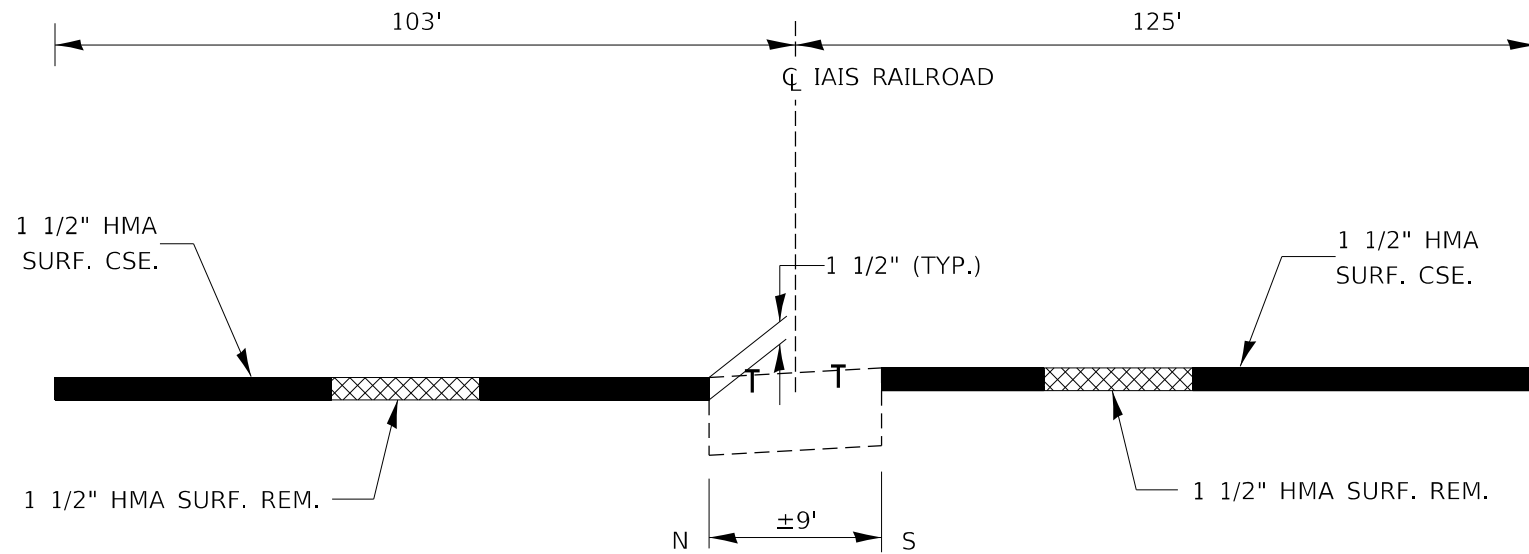

NOTE: STATIONS MAY VARY BASED ON SKEW.

HMA SURFACE REMOVAL AT IOWA INTERSTATE RAILROAD GRADE CROSSING

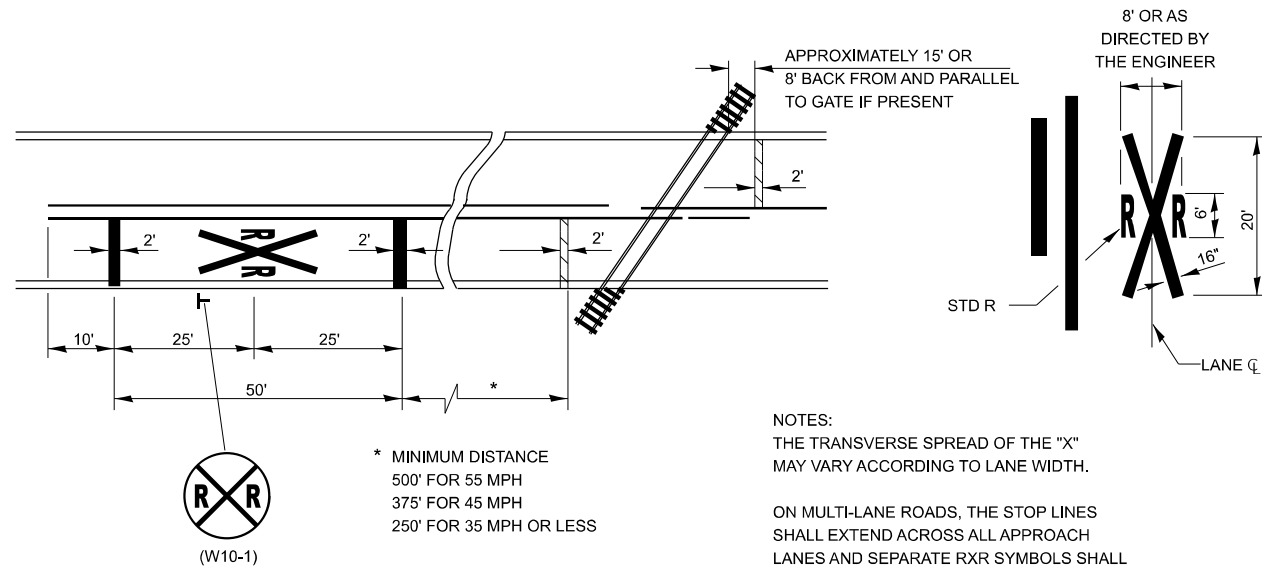

PAVEMENT MARKINGS AT RAILROAD-HIGHWAY GRADE CROSSING

NOTES:
 THE TRANSVERSE SPREAD OF THE "X" MAY VARY ACCORDING TO LANE WIDTH.
 ON MULTI-LANE ROADS, THE STOP LINES SHALL EXTEND ACROSS ALL APPROACH LANES AND SEPARATE RXR SYMBOLS SHALL BE PLACED ADJACENT TO EACH OTHER IN EACH LANE.
 WHEN THE PAVEMENT MARKING SYMBOL IS USED, A PORTION OF THE SYMBOL SHOULD BE LOCATED DIRECTLY ADJACENT TO THE ADVANCE WARNING SIGN (W10-1).

MODEL: D:\h111...
 FILE NAME: ...
 PROJECT: ...
 DATE: 12/14/2023

USER NAME = tlmthy.zletsch	DESIGNED -	REVISED -
DRAWN -	REVISIONS -	
PLOT SCALE = 2,000' / in.	CHECKED -	REVISED -
PLOT DATE = 12/14/2023	DATE -	REVISED -

STATE OF ILLINOIS
 DEPARTMENT OF TRANSPORTATION

RAILROAD CROSSING PAVEMENT MARKING AND MILLING DETAILS

SCALE: SHEET OF SHEETS STA. TO STA.

F.A.S. RTE.	SECTION	COUNTY	TOTAL SHEETS	SHEET NO.
248	(117)RS-4	BUREAU	20	20
CONTRACT NO. 66M96				
ILLINOIS FED. AID PROJECT				

Long Section Number