



Illinois Department of Transportation

Office of Intermodal Project Implementation / Division of Aeronautics
1 Langhorne Bond Drive / Springfield, Illinois 62707-8415

March 5, 2024

SUBJECT: St. Louis Downtown Airport
Cahokia Heights, Illinois
St. Clair County
Illinois Project Number: CPS-4833
SBG Project Number: 3-17-SBGP-TBD
Contract No. SD062
Item No. 06A, 3/08/2024 Letting
Addendum A

NOTICE TO PROSPECTIVE BIDDERS

Attached is an addendum to the plans or proposal. This addendum involves revised and/or added material.

Reason for Addendum:

Revisions to Plans to delete one (1) proposed roadway sign relocation;
Revisions to Plans to shift the location of the proposed taxi lane crossing pavement;
Addition of new scope included as Additive Alternate No. 1.

To All Plan Holders:

Plan Changes:

The following plan sheets are reissued with the attached versions, dated 3/1/2024, to reflect the revisions described above:

Sheet 2, Summary of Quantities and Index to Sheets
Sheet 4: Maintenance of Traffic Plan Phase 1
Sheet 5: Maintenance of Traffic Plan Phase 2
Sheet 6: Maintenance of Traffic Plan Phase 3
Sheet 9: Typical Sections
Sheet 13: Proposed Demolition Plan
Sheet 14: Proposed Grading Plan
Sheet 15: Proposed Construction Plan
Sheet 19: Proposed Marking Plan
Sheet 20: Proposed Marking Details
Sheet 21: Proposed Storm Water Pollution Prevention Plan

Special Provisions Changes:

The following special provisions are reissued with the attached versions, dated 3/1/2024, to reflect the revisions described above:
Item 102 Temporary Air and Water Pollution, Soil Erosion, and Siltation Control
Item 152 Excavation, Subgrade, and Embankment
Item 209 Crushed Aggregate Base Course
Item 401 Asphalt Mix Pavement Surface Course
Item 602 Emulsified Asphalt Prime Coat
Item 603 Emulsified Asphalt Tack Coat
Item 910200 Roadway Sign (includes clarification to address a bidder question.)
Item 901 Seeding
Item 908 Mulching

The following special provisions are added by the attached versions, dated 3/1/2024, to reflect the revisions described above:
Item 701, Pipe for Storm Drains and Culverts

Schedule of Prices Changes:

The quantity for Base Bid pay item AR209606, Crushed Agg. Base Course-6", is revised to read **713 SQ YD**.

The quantity for Base Bid pay item AR401613, Bit. Surf. Cse.-Method I, Superpave, is revised to read **1,137 TON**.

The quantity for Base Bid pay item AR910975, Relocate Roadway Sign, is revised to read **4 EACH**.

The new Additive Alternate 1 quantity table and pay items listed below are added to the project as shown in the contract documents and the attached revised Plan Sheet 2:

Item AS152411 Unclassified Excavation

Item AS156540 Riprap

Item AS209606 Crushed Agg. Base Course-6"

Item AS401613 Bit. Surf. Cse.-Method I, Superpave

Item AS602510 Bituminous Prime Coat

Item AS603510 Bituminous Tack Coat

Item AS701615 15" RCP, Class V

Item AS901510 Seeding

Item AS908514 Light-Duty Hydraulic Mulch

Prime contractors must utilize the enclosed material when preparing their bid and must include any changes to the Schedule of Prices in their bid.

Questions on this addendum may be directed to Barry Stolz, P.E. of Hanson Professional Services at 314.942.5288.



**ST. LOUIS
DOWNTOWN AIRPORT**

Bi-State Development
6100 Archview Drive
Cahokia Heights, IL 62206-1445

EXP. 11/30/2025

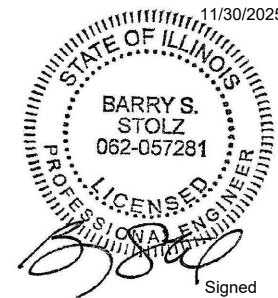

Signed 1/12/2024

**RECONSTRUCT
ACCESS ROAD:
CURTISS STEINBERG
DRIVE, PHASE 2**

IDA No: CPS-4833

Contract No. SD062

ADDENDUM A					
NO.	DATE	DESCRIPTION	DES	DWN	REV
1	3/1/2024	BSS HLE BSS			

ISSUE: JANUARY 12, 2024
PROJECT NO: 21A0081D
CAD FILE: G-002-FLP.DWG
DESIGN BY: MJD 7/6/2022
DRAWN BY: HLE 7/6/2022
REVIEWED BY: BSS 1/12/2024

SHEET TITLE

**SUMMARY OF
QUANTITIES AND
INDEX TO SHEETS**

SUMMARY OF QUANTITIES - BASE BID				
ITEM NO.	DESCRIPTION	UNIT	TOTAL QUANTITY	AS-BUILT QUANTITY
AR150510	ENGINEER'S FIELD OFFICE	L SUM	1	
AR150520	MOBILIZATION	L SUM	1	
AR150530	TRAFFIC MAINTENANCE	L SUM	1	
AR152410	UNCLASSIFIED EXCAVATION	CU YD	240	
AR152480	SHOULDER ADJUSTMENT	SQ YD	1,277	
AR156500	TEMPORARY EROSION CONTROL	L SUM	1	
AR156540	RIPRAP	SQ YD	140	
AR162750	DETECTOR LOOP	L SUM	1	
AR209606	CRUSHED AGG. BASE COURSE-6"	SQ YD	713	
AR401613	BIT. SURF. CSE.-METHOD I, SUPERPAVE	TON	1,137	
AR401650	BITUMINOUS PAVEMENT MILLING	SQ YD	2,856	
AR401915	REM & REP BIT PAVEMENT-TYPE A	SQ YD	130	
AR602510	BITUMINOUS PRIME COAT	GALLON	248	
AR603510	BITUMINOUS TACK COAT	GALLON	1,006	
AR620520	PAVEMENT MARKING-WATERBORNE	SQ FT	1,094	
AR701200	SLOTTED DRAIN	FOOT	20	
AR705504	4" PERFORATED UNDERDRAIN	FOOT	260	
AR705620	UNDERDRAIN END SECTION	EACH	3	
AR705640	UNDERDRAIN CLEANOUT	EACH	3	
AR800536	SPEED BUMP	FOOT	54	
AR800583	REFLECTIVE CRACK CONTROL MATERIAL	SQ YD	3,527	
AR901510	SEEDING	ACRE	0.30	
AR908514	LIGHT-DUTY HYDRAULIC MULCH	ACRE	0.30	
AR910200	ROADWAY SIGN	EACH	2	
AR910975	RELOCATE ROADWAY SIGN	EACH	4	

SUMMARY OF QUANTITIES - ADDITIVE ALTERNATE 1				
ITEM NO.	DESCRIPTION	UNIT	TOTAL QUANTITY	AS-BUILT QUANTITY
AS152411	UNCLASSIFIED EXCAVATION	L SUM	1	
AS156540	RIPRAP	SQ YD	4	
AS209606	CRUSHED AGG. BASE COURSE-6"	SQ YD	105	
AS401613	BIT. SURF. CSE.-METHOD I, SUPERPAVE	TON	21	
AS602510	BITUMINOUS PRIME COAT	GALLON	27	
AS603510	BITUMINOUS TACK COAT	GALLON	7	
AS701615	15" RCP, CLASS V	FOOT	48	
AS901510	SEEDING	ACRE	0.02	
AS908514	LIGHT-DUTY HYDRAULIC MULCH	ACRE	0.02	

INDEX TO SHEETS	
SHEET NO.	SHEET TITLE
1	COVER SHEET
2	SUMMARY OF QUANTITIES AND INDEX TO SHEETS
3	SCOPE OF WORK
4	MAINTENANCE OF TRAFFIC PLAN PHASE 1
5	MAINTENANCE OF TRAFFIC PLAN PHASE 2
6	MAINTENANCE OF TRAFFIC PLAN PHASE 3
7	MAINTENANCE OF TRAFFIC PLAN PHASE 4
8	CONSTRUCTION SAFETY DETAILS AND NOTES
9	TYPICAL SECTIONS
10	UNDERDRAIN DETAILS
11	MISCELLANEOUS DETAILS
12	PROPOSED ALIGNMENT PLAN
13	PROPOSED DEMOLITION PLAN
14	PROPOSED GRADING PLAN
15	PROPOSED CONSTRUCTION PLAN
16	PROPOSED DRAINAGE PLAN
17	PROPOSED PLAN AND PROFILE - STA. 0+00-11+50
18	PROPOSED PLAN AND PROFILE - STA. 11+50-21+00
19	PROPOSED MARKING PLAN
20	PROPOSED MARKING DETAILS
21	PROPOSED STORM WATER POLLUTION PREVENTION PLAN

GENERAL NOTES:

QUANTITIES
PAYMENT WILL BE MADE UNDER THE ITEM NUMBERS, DESCRIPTIONS AND UNITS NOTED IN THE ABOVE TABLE IN ACCORDANCE WITH THE BASIS OF PAYMENT FOR EACH RESPECTIVE WORK ITEM COMPLETED AND ACCEPTED BY THE ENGINEER.

CERTIFIED PAYROLLS
THE RESIDENT ENGINEER/TECHNICIAN CANNOT FORWARD CONSTRUCTION REPORTS TO THE ILLINOIS DIVISION OF AERONAUTICS FOR PROCESSING UNTIL ALL CERTIFIED PAYROLLS FOR THE PERIOD HAVE BEEN RECEIVED.

MATERIAL CERTIFICATIONS
MATERIALS TO BE INCORPORATED INTO THE PROJECT CANNOT BE USED WITHOUT PRIOR APPROVAL. ALL MATERIALS TO BE USED IN THE PROJECT MUST BE SUBMITTED TO THE RESIDENT ENGINEER FOR APPROVAL. USE OF MATERIALS WITHOUT PRIOR APPROVAL AND ULTIMATELY DETERMINED TO BE UNACCEPTABLE BY THE ILLINOIS DIVISION OF AERONAUTICS ARE SUBJECT TO REMOVAL AND/OR NON-PAYMENT.

FILES
FOLLOWING THE PROJECT AWARD, THE ENGINEER CAN PROVIDE THE RELEVANT AUTOCAD MODEL FILES TO THE AWARDED CONTRACTOR UPON REQUEST TO ASSIST WITH CONSTRUCTION LAYOUT.

FOR BID

PHASE 1 NOTES

1. THE CONTRACTOR MAY NOT WORK IN MULTIPLE PHASES SIMULTANEOUSLY. ALL PHASE 1 WORK SHALL BE COMPLETED PRIOR TO BEGINNING WORK ON PHASE 2.
2. ALL NECESSARY TEMPORARY SIGNS, BARRICADES/DRUMS AND OTHER TRAFFIC CONTROL DEVICES SHALL BE IN PLACE PRIOR TO BEGINNING CONSTRUCTION.
3. AT ALL TIMES, THE CONTRACTOR'S OPERATIONS SHALL BE SUCH AS TO MINIMIZE DISRUPTION TO AIRPORT TRAFFIC, INCLUDING VEHICLE AND PEDESTRIAN.
4. AT THE COMPLETION OF ALL PROJECT CONSTRUCTION, THE HAUL ROUTE AND CONSTRUCTION EQUIPMENT PARKING AREA SHALL BE RESTORED TO PRE-CONSTRUCTION CONDITIONS PER THE SPECIFICATIONS.
5. THE COSTS FOR PROVISION, PLACEMENT, MAINTENANCE AND REMOVAL OF TEMPORARY SIGNS, BARRICADES/DRUMS, OTHER TRAFFIC CONTROL DEVICES AND ALL ASSOCIATED INCIDENTS SHALL BE PAID FOR UNDER TRAFFIC MAINTENANCE.
6. THE COSTS FOR CONSTRUCTION/MAINTENANCE OF HAUL ROUTE AND EQUIPMENT STAGING AREA, AND ALL ASSOCIATED INCIDENTALS SHALL BE PAID FOR UNDER MOBILIZATION.
7. AN OCCASIONAL AIRCRAFT MAY BE TUGGED DOWN THE EXISTING TAXILANE BETWEEN HANGARS B AND C, WITH ADVANCE NOTICE. THE CONTRACTOR SHALL PULL BACK EQUIPMENT AND PERSONNEL FROM THE TAXILANE DURING THIS SHORT OPERATION TO ALLOW AIRCRAFT TO PASS. THE PROPOSED CONSTRUCTION WILL NOT NECESSITATE CLOSING ANY OTHER AIRFIELD PAVEMENT. ALL WORK WILL BE ON THE "LAND SIDE" OF THE AIRPORT PERIMETER FENCE.

WORK ZONE TRAFFIC CONTROL - GENERAL NOTES:

1. ALL TRAFFIC CONTROL DEVICES AND CONFIGURATIONS SHALL CONFORM TO THE MANUAL OF UNIFORM TRAFFIC CONTROL DEVICES (MUTCD), CURRENT EDITION.
2. ONE LANE OF THE MAIN ROADWAY SHALL BE ACCESSIBLE TO PUBLIC VEHICLE TRAFFIC AT ALL TIMES DURING CONSTRUCTION, UNLESS OTHERWISE COORDINATED IN ADVANCE WITH THE OWNER. THE COST OF MAINTAINING THE ACCESS SHALL BE INCIDENTAL TO ITEM AR150530 - TRAFFIC MAINTENANCE, AND NO FURTHER CONSIDERATION WILL BE ALLOWED.
3. ADDITIONAL MEASURES MAY BE REQUIRED, PARTICULARLY DURING NON-WORKING HOURS, TO INSURE THE SAFETY OF WORKS AND THE PUBLIC THROUGH THE CONSTRUCTION ZONE. SAID MEASURES SHALL BE INCIDENTAL TO TRAFFIC MAINTENANCE, AND NO FURTHER CONSIDERATION WILL BE ALLOWED.
4. THE CONTRACTOR SHALL PROVIDE ACCESS FOR EMERGENCY VEHICLES AT ALL TIMES DURING CONSTRUCTION.
5. THE POSTED SPEED THROUGH THE WORK ZONE SHALL BE 15MPH MAXIMUM, OR LESS IF DETERMINED BY THE RESIDENT ENGINEER/TECHNICIAN TO BE NECESSARY FOR THE SAFETY OF WORKERS AND THE TRAVELING PUBLIC. THE CONTRACTOR SHALL PROVIDE APPROPRIATE ADVANCE SIGNING, PER THE MUTCD AND STATE DOT (IF APPLICABLE), TO ADVISE AND WARN THE TRAVELING PUBLIC OF THE SPEED LIMIT DURING CONSTRUCTION.
6. THE SUGGESTED TRAFFIC CONTROL MEASURES ARE CONSIDERED THE MINIMUM FOR THIS PROJECT. IF THE CONTRACTOR'S OPERATIONS REQUIRE ADDITIONAL TRAFFIC CONTROL MEASURES, HE SHALL DEVELOP AND SUBMIT A REVISED TRAFFIC CONTROL PLAN FOR REVIEW AND APPROVAL BY THE RESIDENT ENGINEER/TECHNICIAN PRIOR TO BEGINNING SUCH WORK. ALL TRAFFIC CONTROL MEASURES, WHETHER INCLUDED IN THE CONSTRUCTION DRAWINGS OR DUE TO THE CONTRACTOR'S OPERATIONS, SHALL BE INCIDENTAL TO ITEM AR150530 - TRAFFIC MAINTENANCE, WITH NO EXCEPTIONS.
7. THE PRIORITY CONTROL SETUP OF THE TEMPORARY TRAFFIC SIGNALS SHALL BE COORDINATED WITH THE AIRPORT IN ADVANCE TO ENSURE PROPER ACCOUNTING FOR PEAK TIMES OF HEAVY TRAFFIC THROUGH THE CONSTRUCTION ZONE. CERTAIN TIMES DURING CONSTRUCTION MAY REQUIRE THE CONTRACTOR TO MODIFY THE SETUP. MODIFICATIONS, OPERATION AND MAINTENANCE OF THE TEMPORARY TRAFFIC SIGNALS SHALL BE INCIDENTAL TO ITEM AR150530 - TRAFFIC MAINTENANCE, WITH NO EXCEPTIONS.

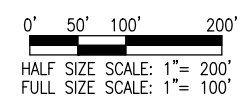
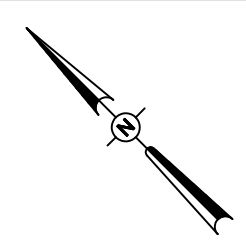

LEGEND

	EXISTING PAVEMENT
	PROPOSED PAVEMENT LIMIT
	PROPOSED WORK AREA
	EXISTING BUILDINGS
	PROPOSED CONTRACTOR STAGING AREA
	EXISTING FENCE
	PROPOSED PUBLIC TRAFFIC ROUTE
	PROPOSED CONTRACTOR HAUL ROUTE
	PROPOSED BARRICADES/DRUMS
	TEMP. CONSTRUCTION SIGN

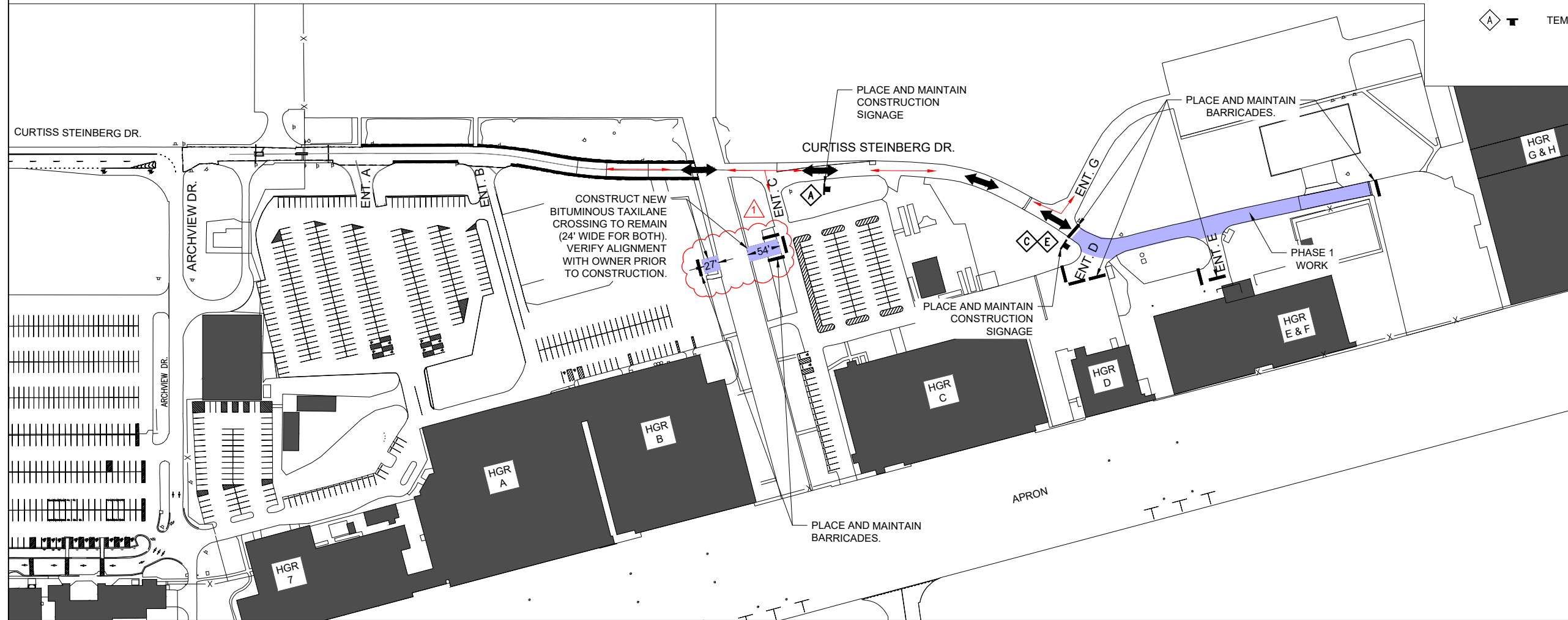

HANSON
Engineering | Planning | Allied Services
Offices Nationwide
www.hanson-inc.com
Hanson Professional Services Inc.
1525 S. 6th Street
Springfield, IL 62703
phone: 217-788-2450
fax: 217-788-2503

Illinois Licensed
Professional Service Corporation
#184-001084

**ST. LOUIS
DOWNTOWN AIRPORT**
Bi-State Development
6100 Archview Drive
Cahokia Heights, IL 62206-1445

EXP. 11/30/2025
BARRY S. STOLZ
062-057281
LICENSED PROFESSIONAL ENGINEER
Signed 1/12/2024

**RECONSTRUCT
ACCESS ROAD:
CURTISS STEINBERG
DRIVE, PHASE 2**

IDA No: CPS-4833
Contract No. SD062

NO.	DATE	DESCRIPTION		
		DES	DWN	REV
1	3/1/2024	BSS	HLE	BSS

ISSUE: JANUARY 12, 2024
PROJECT NO: 21A0081D
CAD FILE: G-005-SFY.DWG
DESIGN BY: MJD 7/20/2022
DRAWN BY: HLE 7/20/2022
REVIEWED BY: BSS 1/12/2024

SHEET TITLE

**MAINTENANCE OF
TRAFFIC PLAN
PHASE 1**

MAR 01, 2024 12:14 PM ENGELO1909
I:\21A0081D\CAD\AIRPORT\1\SHEETG-005-SFY.DWG

FOR BID

PHASE 2 NOTES

1. THE CONTRACTOR MAY NOT WORK IN MULTIPLE PHASES SIMULTANEOUSLY. ALL PHASE 2 WORK SHALL BE COMPLETED PRIOR TO BEGINNING WORK ON PHASE 3.
2. ALL NECESSARY TEMPORARY SIGNS, BARRICADES/DRUMS AND OTHER TRAFFIC CONTROL DEVICES SHALL BE IN PLACE PRIOR TO BEGINNING CONSTRUCTION.
3. AT ALL TIMES, THE CONTRACTOR'S OPERATIONS SHALL BE SUCH AS TO MINIMIZE DISRUPTION TO AIRPORT TRAFFIC, INCLUDING VEHICLE AND PEDESTRIAN.
4. AT THE COMPLETION OF ALL PROJECT CONSTRUCTION, THE HAUL ROUTE AND CONSTRUCTION EQUIPMENT PARKING AREA SHALL BE RESTORED TO PRE-CONSTRUCTION CONDITIONS PER THE SPECIFICATIONS.
5. THE COSTS FOR PROVISION, PLACEMENT, MAINTENANCE AND REMOVAL OF TEMPORARY SIGNS, BARRICADES/DRUMS, OTHER TRAFFIC CONTROL DEVICES AND ALL ASSOCIATED INCIDENTS SHALL BE PAID FOR UNDER TRAFFIC MAINTENANCE.
6. THE COSTS FOR CONSTRUCTION/MAINTENANCE OF HAUL ROUTE AND EQUIPMENT STAGING AREA, AND ALL ASSOCIATED INCIDENTALS SHALL BE PAID FOR UNDER MOBILIZATION.
7. AN OCCASIONAL AIRCRAFT MAY BE TUGGED DOWN THE EXISTING TAXILANE BETWEEN HANGARS B AND C, WITH ADVANCE NOTICE. THE CONTRACTOR SHALL PULL BACK EQUIPMENT AND PERSONNEL FROM THE TAXILANE DURING THIS SHORT OPERATION TO ALLOW AIRCRAFT TO PASS. THE PROPOSED CONSTRUCTION WILL NOT NECESSITATE CLOSING ANY OTHER AIRFIELD PAVEMENT. ALL WORK WILL BE ON THE "LAND SIDE" OF THE AIRPORT PERIMETER FENCE.

WORK ZONE TRAFFIC CONTROL - GENERAL NOTES:

1. ALL TRAFFIC CONTROL DEVICES AND CONFIGURATIONS SHALL CONFORM TO THE MANUAL OF UNIFORM TRAFFIC CONTROL DEVICES (MUTCD), CURRENT EDITION.
2. ONE LANE OF THE MAIN ROADWAY SHALL BE ACCESSIBLE TO PUBLIC VEHICLE TRAFFIC AT ALL TIMES DURING CONSTRUCTION, UNLESS OTHERWISE COORDINATED IN ADVANCE WITH THE OWNER. THE COST OF MAINTAINING THE ACCESS SHALL BE INCIDENTAL TO ITEM AR150530 - TRAFFIC MAINTENANCE, AND NO FURTHER CONSIDERATION WILL BE ALLOWED.
3. ADDITIONAL MEASURES MAY BE REQUIRED, PARTICULARLY DURING NON-WORKING HOURS, TO INSURE THE SAFETY OF WORKS AND THE PUBLIC THROUGH THE CONSTRUCTION ZONE. SAID MEASURES SHALL BE INCIDENTAL TO TRAFFIC MAINTENANCE, AND NO FURTHER CONSIDERATION WILL BE ALLOWED.
4. THE CONTRACTOR SHALL PROVIDE ACCESS FOR EMERGENCY VEHICLES AT ALL TIMES DURING CONSTRUCTION.
5. THE POSTED SPEED THROUGH THE WORK ZONE SHALL BE 15MPH MAXIMUM, OR LESS IF DETERMINED BY THE RESIDENT ENGINEER/TECHNICIAN TO BE NECESSARY FOR THE SAFETY OF WORKERS AND THE TRAVELING PUBLIC. THE CONTRACTOR SHALL PROVIDE APPROPRIATE ADVANCE SIGNING, PER THE MUTCD AND STATE DOT (IF APPLICABLE), TO ADVISE AND WARN THE TRAVELING PUBLIC OF THE SPEED LIMIT DURING CONSTRUCTION.
6. THE SUGGESTED TRAFFIC CONTROL MEASURES ARE CONSIDERED THE MINIMUM FOR THIS PROJECT. IF THE CONTRACTOR'S OPERATIONS REQUIRE ADDITIONAL TRAFFIC CONTROL MEASURES, HE SHALL DEVELOP AND SUBMIT A REVISED TRAFFIC CONTROL PLAN FOR REVIEW AND APPROVAL BY THE RESIDENT ENGINEER/TECHNICIAN PRIOR TO BEGINNING SUCH WORK. ALL TRAFFIC CONTROL MEASURES, WHETHER INCLUDED IN THE CONSTRUCTION DRAWINGS OR DUE TO THE CONTRACTOR'S OPERATIONS, SHALL BE INCIDENTAL TO ITEM AR150530 - TRAFFIC MAINTENANCE, WITH NO EXCEPTIONS.
7. THE PRIORITY CONTROL SETUP OF THE TEMPORARY TRAFFIC SIGNALS SHALL BE COORDINATED WITH THE AIRPORT IN ADVANCE TO ENSURE PROPER ACCOUNTING FOR PEAK TIMES OF HEAVY TRAFFIC THROUGH THE CONSTRUCTION ZONE. CERTAIN TIMES DURING CONSTRUCTION MAY REQUIRE THE CONTRACTOR TO MODIFY THE SETUP. MODIFICATIONS, OPERATION AND MAINTENANCE OF THE TEMPORARY TRAFFIC SIGNALS SHALL BE INCIDENTAL TO ITEM AR150530 - TRAFFIC MAINTENANCE, WITH NO EXCEPTIONS.

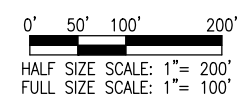
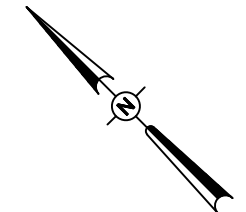

LEGEND

	EXISTING PAVEMENT
	PROPOSED PAVEMENT LIMIT
	PROPOSED WORK AREA
	EXISTING BUILDINGS
	PROPOSED CONTRACTOR STAGING AREA
	EXISTING FENCE
	PROPOSED PUBLIC TRAFFIC ROUTE
	PROPOSED CONTRACTOR HAUL ROUTE
	PROPOSED BARRICADES/DRUMS
	TEMP. CONSTRUCTION SIGN

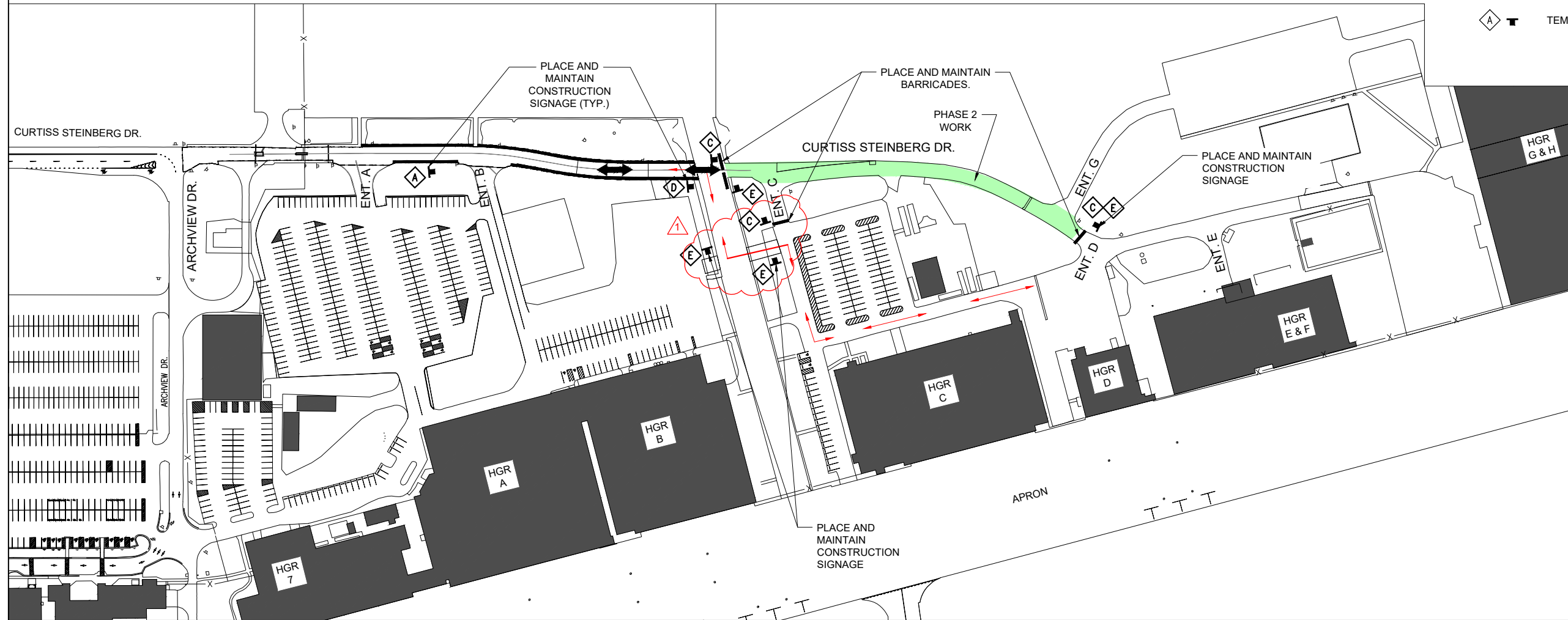

HANSON
Engineering | Planning | Allied Services

Offices Nationwide
www.hanson-inc.com

Hanson Professional Services Inc.
1525 S. 6th Street
Springfield, IL 62703
phone: 217-788-2450
fax: 217-788-2503

Illinois Licensed
Professional Service Corporation
#184-001084

**ST. LOUIS
DOWNTOWN AIRPORT**

Bi-State Development
6100 Archview Drive
Cahokia Heights, IL 62206-1445

EXP. 11/30/2025

BARRY S. STOLZ
062-057281
LICENSED PROFESSIONAL ENGINEER

Signed 1/12/2024

**RECONSTRUCT
ACCESS ROAD:
CURTISS STEINBERG
DRIVE, PHASE 2**

IDA No: CPS-4833
Contract No. SD062

NO.	DATE	DESCRIPTION		
		DES	DWN	REV
1	3/1/2024	BSS	HLE	BSS

ISSUE: JANUARY 12, 2024
PROJECT NO: 21A0081D
CAD FILE: G-005-SFY.DWG
DESIGN BY: MJD 7/20/2022
DRAWN BY: HLE 7/20/2022
REVIEWED BY: BSS 1/12/2024

SHEET TITLE

**MAINTENANCE OF
TRAFFIC PLAN
PHASE 2**

MAR 01, 2024 1:26 PM STOLZ01547
I:\21A0081D\CAD\AIRPORT\SHHEETG-005-SFY.DWG

FOR BID

PHASE 3 NOTES

1. THE CONTRACTOR MAY NOT WORK IN MULTIPLE PHASES SIMULTANEOUSLY. ALL PHASE 3 WORK SHALL BE COMPLETED PRIOR TO BEGINNING WORK ON PHASE 4.
2. ALL NECESSARY TEMPORARY SIGNS, BARRICADES/DRUMS AND OTHER TRAFFIC CONTROL DEVICES SHALL BE IN PLACE PRIOR TO BEGINNING CONSTRUCTION.
3. AT ALL TIMES, THE CONTRACTOR'S OPERATIONS SHALL BE SUCH AS TO MINIMIZE DISRUPTION TO AIRPORT TRAFFIC, INCLUDING VEHICLE AND PEDESTRIAN.
4. AT THE COMPLETION OF ALL PROJECT CONSTRUCTION, THE HAUL ROUTE AND CONSTRUCTION EQUIPMENT PARKING AREA SHALL BE RESTORED TO PRE-CONSTRUCTION CONDITIONS PER THE SPECIFICATIONS.
5. THE COSTS FOR PROVISION, PLACEMENT, MAINTENANCE AND REMOVAL OF TEMPORARY SIGNS, BARRICADES/DRUMS, OTHER TRAFFIC CONTROL DEVICES AND ALL ASSOCIATED INCIDENTS SHALL BE PAID FOR UNDER TRAFFIC MAINTENANCE.
6. THE COSTS FOR CONSTRUCTION/MAINTENANCE OF HAUL ROUTE AND EQUIPMENT STAGING AREA, AND ALL ASSOCIATED INCIDENTALS SHALL BE PAID FOR UNDER MOBILIZATION.
7. AN OCCASIONAL AIRCRAFT MAY BE TUGGED DOWN THE EXISTING TAXILANE BETWEEN HANGARS B AND C, WITH ADVANCE NOTICE. THE CONTRACTOR SHALL PULL BACK EQUIPMENT AND PERSONNEL FROM THE TAXILANE DURING THIS SHORT OPERATION TO ALLOW AIRCRAFT TO PASS. THE PROPOSED CONSTRUCTION WILL NOT NECESSITATE CLOSING ANY OTHER AIRFIELD PAVEMENT. ALL WORK WILL BE ON THE "LAND SIDE" OF THE AIRPORT PERIMETER FENCE.

WORK ZONE TRAFFIC CONTROL - GENERAL NOTES:

1. ALL TRAFFIC CONTROL DEVICES AND CONFIGURATIONS SHALL CONFORM TO THE MANUAL OF UNIFORM TRAFFIC CONTROL DEVICES (MUTCD), CURRENT EDITION.
2. ONE LANE OF THE MAIN ROADWAY SHALL BE ACCESSIBLE TO PUBLIC VEHICLE TRAFFIC AT ALL TIMES DURING CONSTRUCTION, UNLESS OTHERWISE COORDINATED IN ADVANCE WITH THE OWNER. THE COST OF MAINTAINING THE ACCESS SHALL BE INCIDENTAL TO ITEM AR150530 - TRAFFIC MAINTENANCE, AND NO FURTHER CONSIDERATION WILL BE ALLOWED.
3. ADDITIONAL MEASURES MAY BE REQUIRED, PARTICULARLY DURING NON-WORKING HOURS, TO INSURE THE SAFETY OF WORKS AND THE PUBLIC THROUGH THE CONSTRUCTION ZONE. SAID MEASURES SHALL BE INCIDENTAL TO TRAFFIC MAINTENANCE, AND NO FURTHER CONSIDERATION WILL BE ALLOWED.
4. THE CONTRACTOR SHALL PROVIDE ACCESS FOR EMERGENCY VEHICLES AT ALL TIMES DURING CONSTRUCTION.
5. THE POSTED SPEED THROUGH THE WORK ZONE SHALL BE 15MPH MAXIMUM, OR LESS IF DETERMINED BY THE RESIDENT ENGINEER/TECHNICIAN TO BE NECESSARY FOR THE SAFETY OF WORKERS AND THE TRAVELING PUBLIC. THE CONTRACTOR SHALL PROVIDE APPROPRIATE ADVANCE SIGNING, PER THE MUTCD AND STATE DOT (IF APPLICABLE), TO ADVISE AND WARN THE TRAVELING PUBLIC OF THE SPEED LIMIT DURING CONSTRUCTION.
6. THE SUGGESTED TRAFFIC CONTROL MEASURES ARE CONSIDERED THE MINIMUM FOR THIS PROJECT. IF THE CONTRACTOR'S OPERATIONS REQUIRE ADDITIONAL TRAFFIC CONTROL MEASURES, HE SHALL DEVELOP AND SUBMIT A REVISED TRAFFIC CONTROL PLAN FOR REVIEW AND APPROVAL BY THE RESIDENT ENGINEER/TECHNICIAN PRIOR TO BEGINNING SUCH WORK. ALL TRAFFIC CONTROL MEASURES, WHETHER INCLUDED IN THE CONSTRUCTION DRAWINGS OR DUE TO THE CONTRACTOR'S OPERATIONS, SHALL BE INCIDENTAL TO ITEM AR150530 - TRAFFIC MAINTENANCE, WITH NO EXCEPTIONS.
7. THE PRIORITY CONTROL SETUP OF THE TEMPORARY TRAFFIC SIGNALS SHALL BE COORDINATED WITH THE AIRPORT IN ADVANCE TO ENSURE PROPER ACCOUNTING FOR PEAK TIMES OF HEAVY TRAFFIC THROUGH THE CONSTRUCTION ZONE. CERTAIN TIMES DURING CONSTRUCTION MAY REQUIRE THE CONTRACTOR TO MODIFY THE SETUP. MODIFICATIONS, OPERATION AND MAINTENANCE OF THE TEMPORARY TRAFFIC SIGNALS SHALL BE INCIDENTAL TO ITEM AR150530 - TRAFFIC MAINTENANCE, WITH NO EXCEPTIONS.

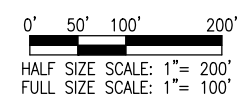
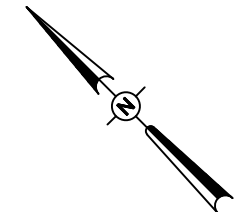

LEGEND

- EXISTING PAVEMENT
- PROPOSED PAVEMENT LIMIT
- PROPOSED WORK AREA
- EXISTING BUILDINGS
- PROPOSED CONTRACTOR STAGING AREA
- EXISTING FENCE
- PROPOSED PUBLIC TRAFFIC ROUTE
- PROPOSED CONTRACTOR HAUL ROUTE
- PROPOSED BARRICADES/DRUMS
- TEMP. CONSTRUCTION SIGN

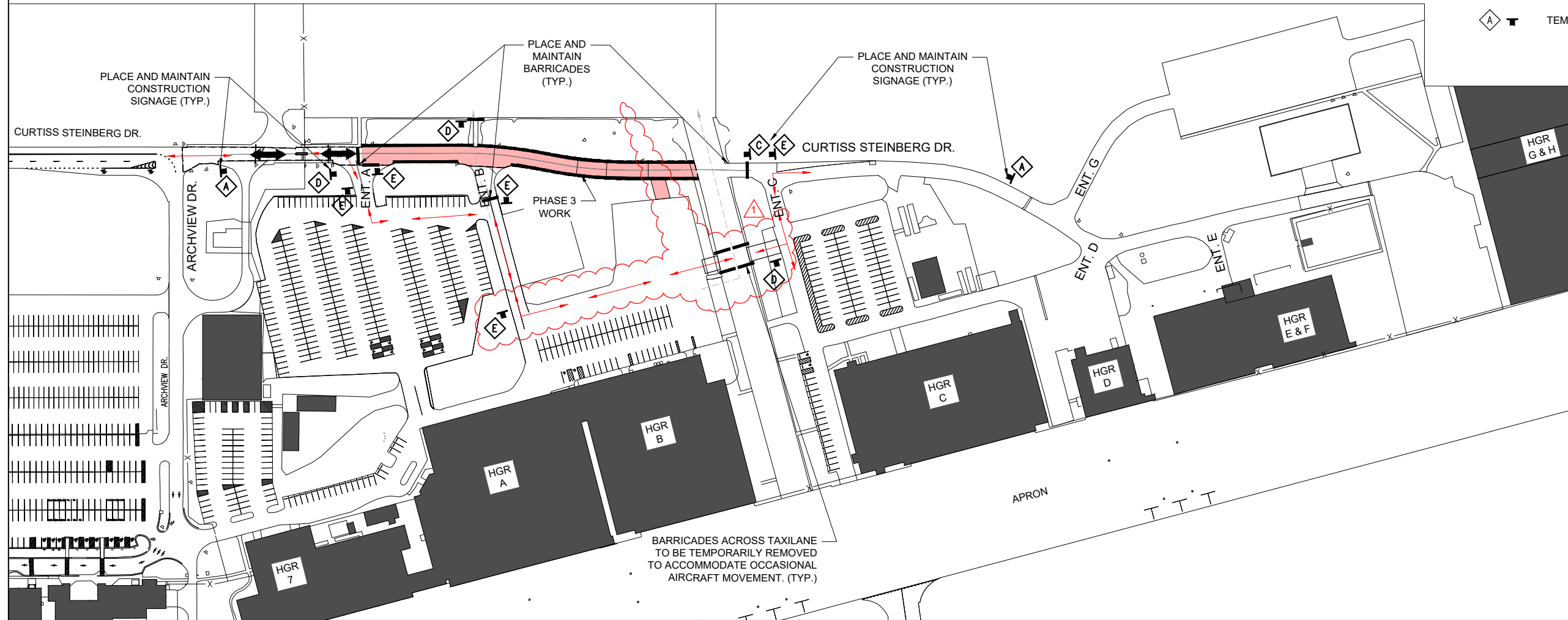

HANSON
Engineering | Planning | Allied Services
Offices Nationwide
www.hanson-inc.com
Hanson Professional Services Inc.
1525 S. 6th Street
Springfield, IL 62703
phone: 217-788-2450
fax: 217-788-2503

Illinois Licensed
Professional Service Corporation
#184-001084



Bi-State Development
6100 Archview Drive
Cahokia Heights, IL 62206-1445
EXP. 11/30/2025



RECONSTRUCT ACCESS ROAD: CURTISS STEINBERG DRIVE, PHASE 2

IDA No: CPS-4833
Contract No. SD062

NO.	DATE	DESCRIPTION		
		DES	DWN	REV
1	3/1/2024	BSS	HLE	BSS

ISSUE: JANUARY 12, 2024
PROJECT NO: 21A0081D
CAD FILE: G-005-SFY.DWG
DESIGN BY: MJD 7/20/2022
DRAWN BY: HLE 7/20/2022
REVIEWED BY: BSS 1/12/2024

SHEET TITLE

MAINTENANCE OF TRAFFIC PLAN PHASE 3

MAR 01, 2024 1:27 PM STOLZ01547
I:\21A0081D\CAD\AIRPORT\1\SHEETG-005-SFY.DWG

FOR BID



**ST. LOUIS
DOWNTOWN AIRPORT**

Bi-State Development
6100 Archview Drive
Cahokia Heights, IL 62206-1445

EXP. 11/30/2025

Signed 1/12/2024

**RECONSTRUCT
ACCESS ROAD:
CURTISS STEINBERG
DRIVE, PHASE 2**

IDA No: CPS-4833

Contract No. SD062

ADDENDUM A			
NO.	DATE	DESCRIPTION	REV
1	3/1/2024	BSS HLE BSS	
		DES	DWN

ISSUE: JANUARY 12, 2024
PROJECT NO: 21A0081D
CAD FILE: C-302-TYP.DWG
DESIGN BY: MJD 7/20/2022
DRAWN BY: HLE 7/20/2022
REVIEWED BY: BSS 1/12/2024

SHEET TITLE

TYPICAL SECTIONS

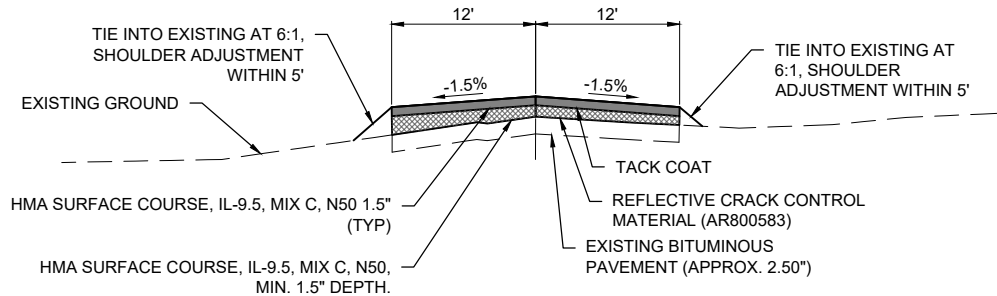

**BITUMINOUS OVERLAY
PROPOSED TYPICAL SECTION - (STA. 9+55 - 19+68)**
NOT TO SCALE

*WIDTHS AND GRADES VARY AT INTERSECTIONS. AVERAGE WIDTHS AND GRADES SHOWN.

- NOTES:
- CONTRACTOR SHALL MAINTAIN A CONTINUOUS PAVING OPERATION AS MUCH AS POSSIBLE.
 - SURFACE COURSE SHALL BE PG 70-22.
 - SHOULDER GRADING VARIES.

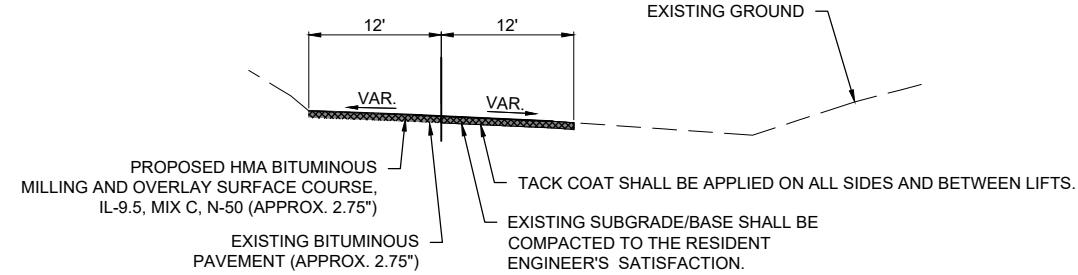

PROPOSED TYPICAL SECTION - (STA. 19+68 - 20+92)
NOT TO SCALE

*WIDTHS AND GRADES VARY AT INTERSECTIONS. AVERAGE WIDTHS AND GRADES SHOWN.

- NOTES:
- CONTRACTOR SHALL MAINTAIN A CONTINUOUS PAVING OPERATION AS MUCH AS POSSIBLE.
 - SURFACE COURSE SHALL BE PG 70-22.
 - SHOULDER GRADING VARIES.

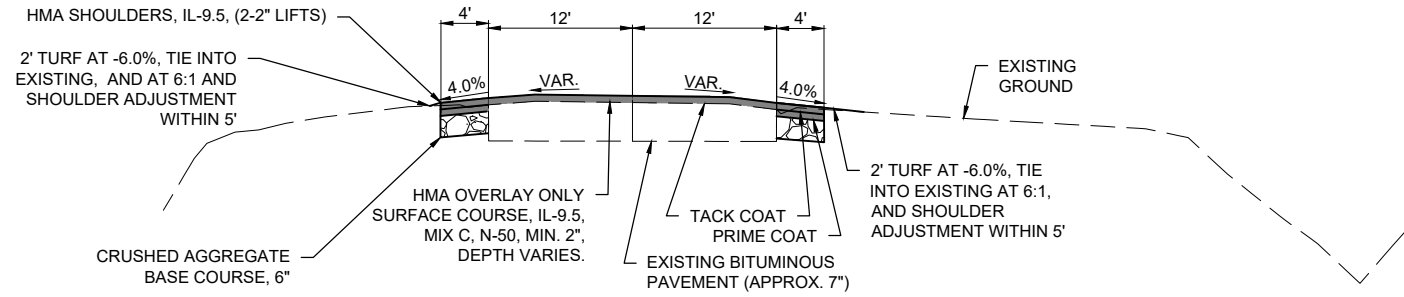

PROPOSED TYPICAL SECTION - (STA. 7+00 - 7+50 AND 8+21 - 8+98)
NOT TO SCALE

*WIDTHS AND GRADES VARY AT INTERSECTIONS. AVERAGE WIDTHS AND GRADES SHOWN.

- NOTES:
- CONTRACTOR SHALL MAINTAIN A CONTINUOUS PAVING OPERATION AS MUCH AS POSSIBLE.
 - SURFACE COURSE SHALL BE PG 70-22.

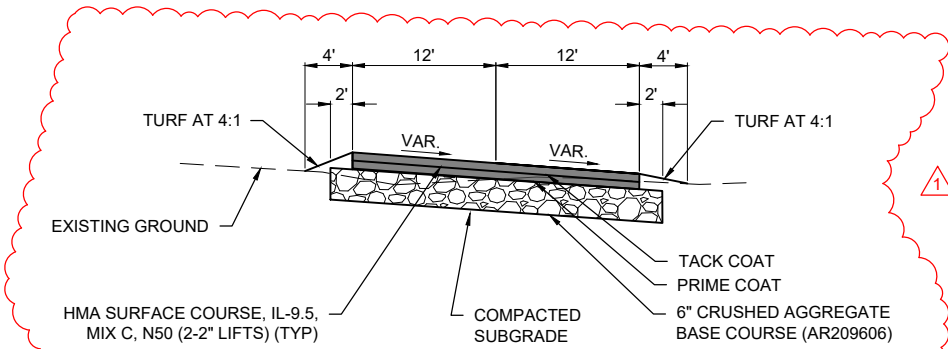

**PROPOSED TAXILANE CROSSING AND PARKING LOT
CONNECTOR TYPICAL SECTION**
NOT TO SCALE

*WIDTHS AND GRADES VARY AT INTERSECTIONS. AVERAGE WIDTHS AND GRADES SHOWN.

- NOTES:
- CONTRACTOR SHALL MAINTAIN A CONTINUOUS PAVING OPERATION AS MUCH AS POSSIBLE.
 - SURFACE COURSE SHALL BE PG 70-22.

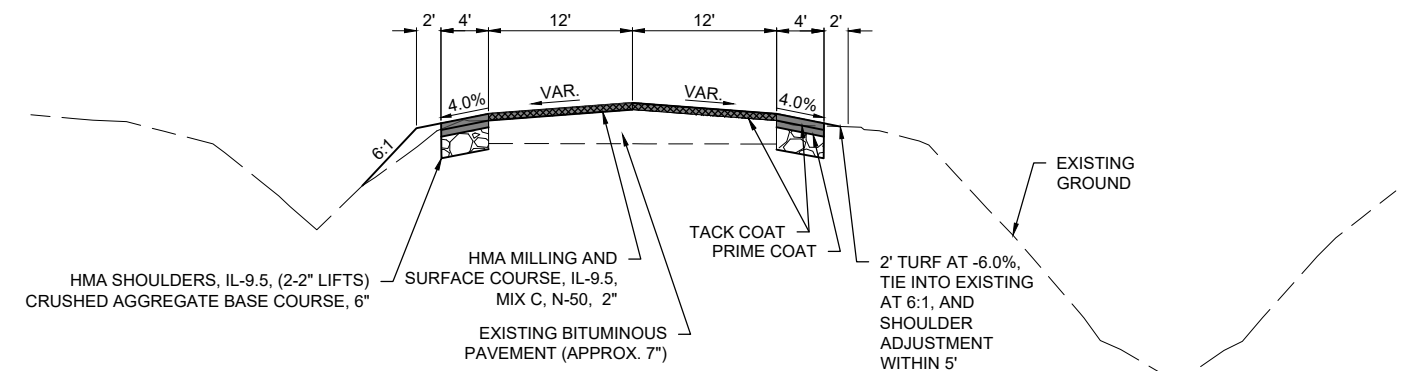

PROPOSED TYPICAL SECTION - (STA. 0+26 - 7+00 AND 7+50 - 8+21)
NOT TO SCALE

*WIDTHS AND GRADES VARY AT INTERSECTIONS. AVERAGE WIDTHS AND GRADES SHOWN.

- NOTES:
- CONTRACTOR SHALL MAINTAIN A CONTINUOUS PAVING OPERATION AS MUCH AS POSSIBLE.
 - SURFACE COURSE SHALL BE PG 70-22.

APPLICATION	HMA MIXTURE REQUIREMENTS				
	AC / PG	DESIGN AIR Voids	MIXTURE COMPOSITION	FRICTION AGGREGATE	QUALITY MANAGEMENT
HMA SURFACE COURSE (TOP LIFTS / OVERLAY)	70-22	4.0% @ Ndesign = 50	IL-9.5	MIX C	QC/QA
HMA SHOULDERS	70-22	4.0% @ N50	IL-9.5	MIX C	QC/QA

FOR BID



**ST. LOUIS
DOWNTOWN AIRPORT**

Bi-State Development
6100 Archview Drive
Cahokia Heights, IL 62206-1445

EXP. 11/30/2025

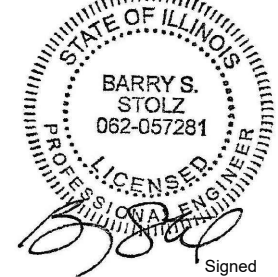

Signed
11/12/2024

**RECONSTRUCT
ACCESS ROAD:
CURTISS STEINBERG
DRIVE, PHASE 2**

IDA No: CPS-4833

Contract No. SD062

NO.	DATE	DESCRIPTION	DES	DWN	REV
1	3/1/2024	ADDENDUM A	BSS	HLE	BSS

ISSUE: JANUARY 12, 2024
PROJECT NO: 21A0081D
CAD FILE: C-131-DEM.DWG
DESIGN BY: MJD 7/20/2022
DRAWN BY: HLE 7/20/2022
REVIEWED BY: BSS 1/12/2024

SHEET TITLE

**PROPOSED
DEMOLITION PLAN**

FOR BID

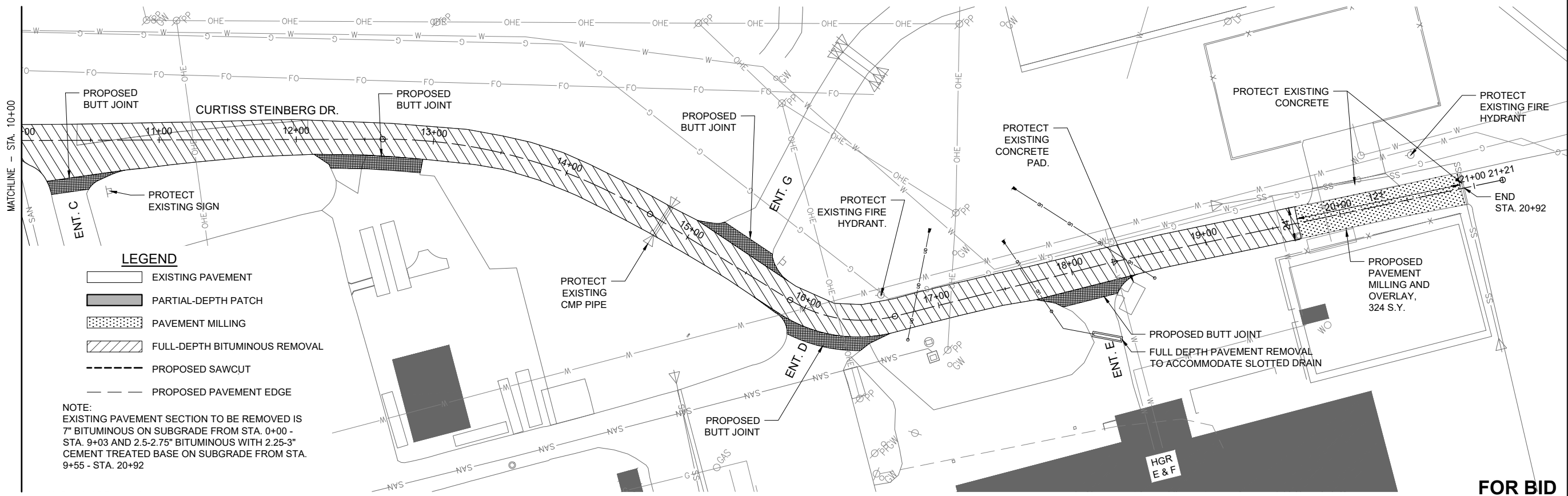
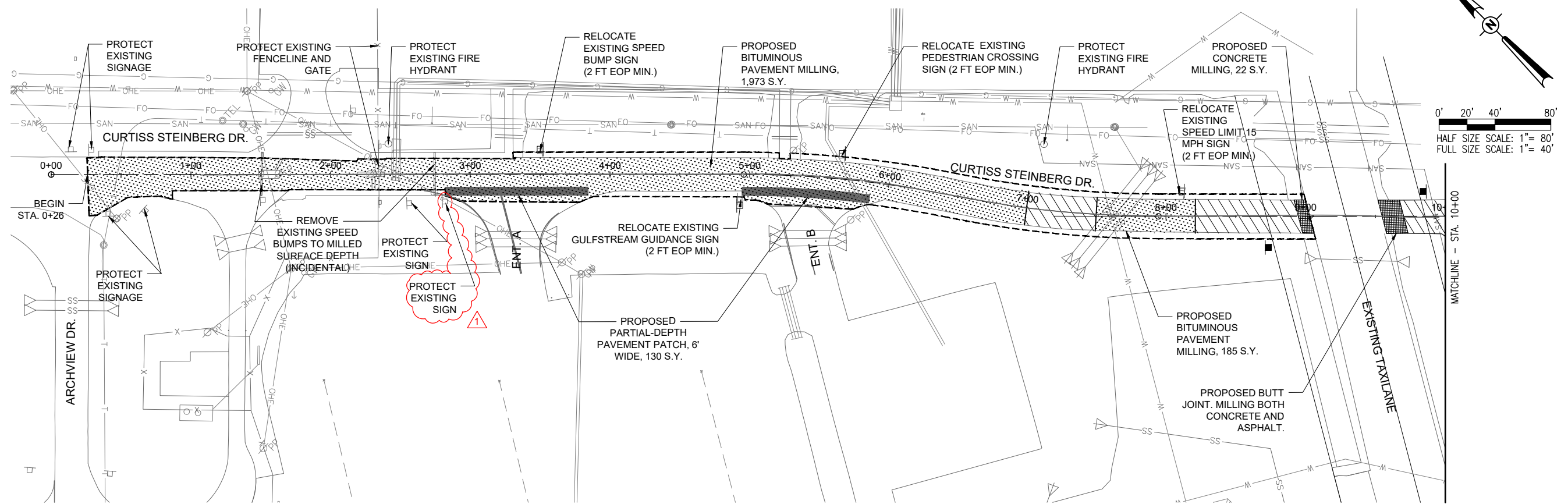

- LEGEND**
- EXISTING PAVEMENT
 - PARTIAL-DEPTH PATCH
 - PAVEMENT MILLING
 - FULL-DEPTH BITUMINOUS REMOVAL
 - PROPOSED SAWCUT
 - PROPOSED PAVEMENT EDGE

NOTE:
EXISTING PAVEMENT SECTION TO BE REMOVED IS
7" BITUMINOUS ON SUBGRADE FROM STA. 0+00 -
STA. 9+03 AND 2.5-2.75" BITUMINOUS WITH 2.25-3"
CEMENT TREATED BASE ON SUBGRADE FROM STA.
9+55 - STA. 20+92



**ST. LOUIS
DOWNTOWN AIRPORT**

Bi-State Development
6100 Archview Drive
Cahokia Heights, IL 62206-1445

EXP. 11/30/2025

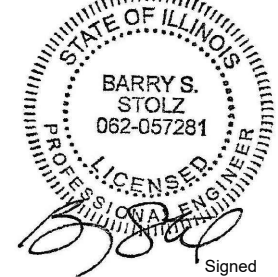

**RECONSTRUCT
ACCESS ROAD:
CURTISS STEINBERG
DRIVE, PHASE 2**

IDA No: CPS-4833

Contract No. SD062

NO.	DATE	DESCRIPTION
1	3/1/2024	ADDENDUM A BSS HLE BSS
		DES DWN REV

ISSUE: JANUARY 12, 2024
PROJECT NO: 21A0081D
CAD FILE: C-121-DRN.DWG
DESIGN BY: MJD 7/20/2022
DRAWN BY: HLE 7/20/2022
REVIEWED BY: BSS 1/12/2024

SHEET TITLE

**PROPOSED GRADING
PLAN**

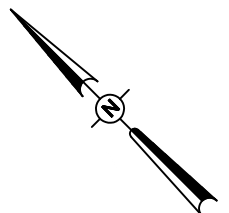
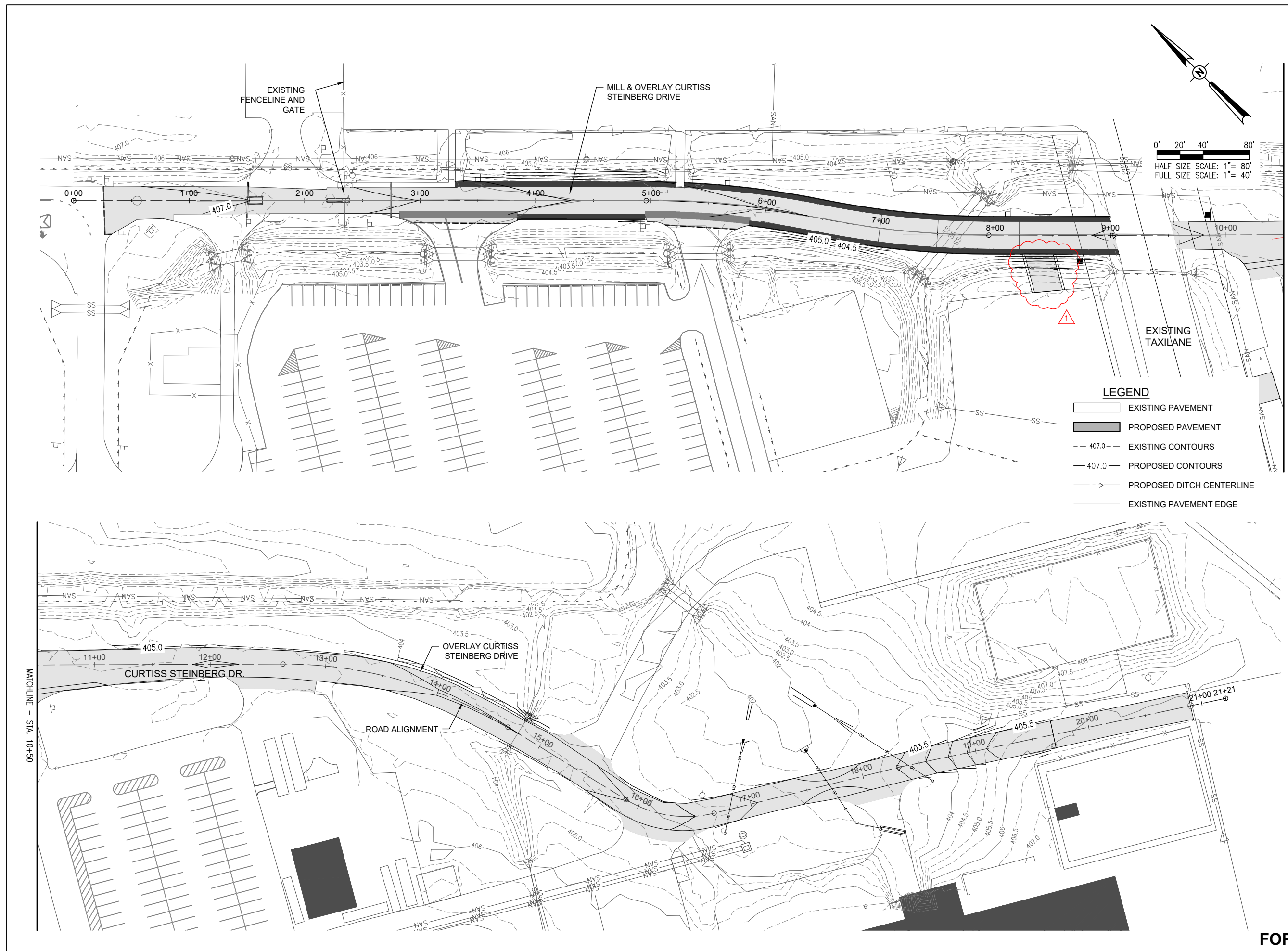

0' 20' 40' 80'
HALF SIZE SCALE: 1" = 80'
FULL SIZE SCALE: 1" = 40'

- LEGEND**
- EXISTING PAVEMENT
 - PROPOSED PAVEMENT
 - EXISTING CONTOURS
 - PROPOSED CONTOURS
 - PROPOSED DITCH CENTERLINE
 - EXISTING PAVEMENT EDGE

FOR BID

MAR 01, 2024 12:18 PM ENGELO1909
I:\21A0081D\CAD\AIRPORT\SHEETC-121-DRN.DWG



**ST. LOUIS
DOWNTOWN AIRPORT**

Bi-State Development
6100 Archview Drive
Cahokia Heights, IL 62206-1445

EXP. 11/30/2025

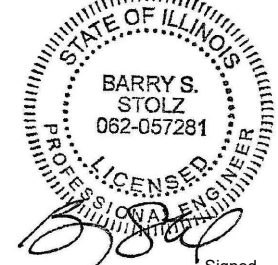

Signed 11/12/2024

**RECONSTRUCT
ACCESS ROAD:
CURTISS STEINBERG
DRIVE, PHASE 2**

IDA No: CPS-4833

Contract No. SD062

NO.	DATE	DESCRIPTION	DES	DWN	REV
1	3/1/2024	ADDENDUM A BSS HLE BSS			

ISSUE: JANUARY 12, 2024
PROJECT NO: 21A0081D
CAD FILE: C-121-CON.DWG
DESIGN BY: MJD 7/20/2022
DRAWN BY: HLE 7/20/2022
REVIEWED BY: BSS 1/12/2024

SHEET TITLE

**PROPOSED
CONSTRUCTION
PLAN**

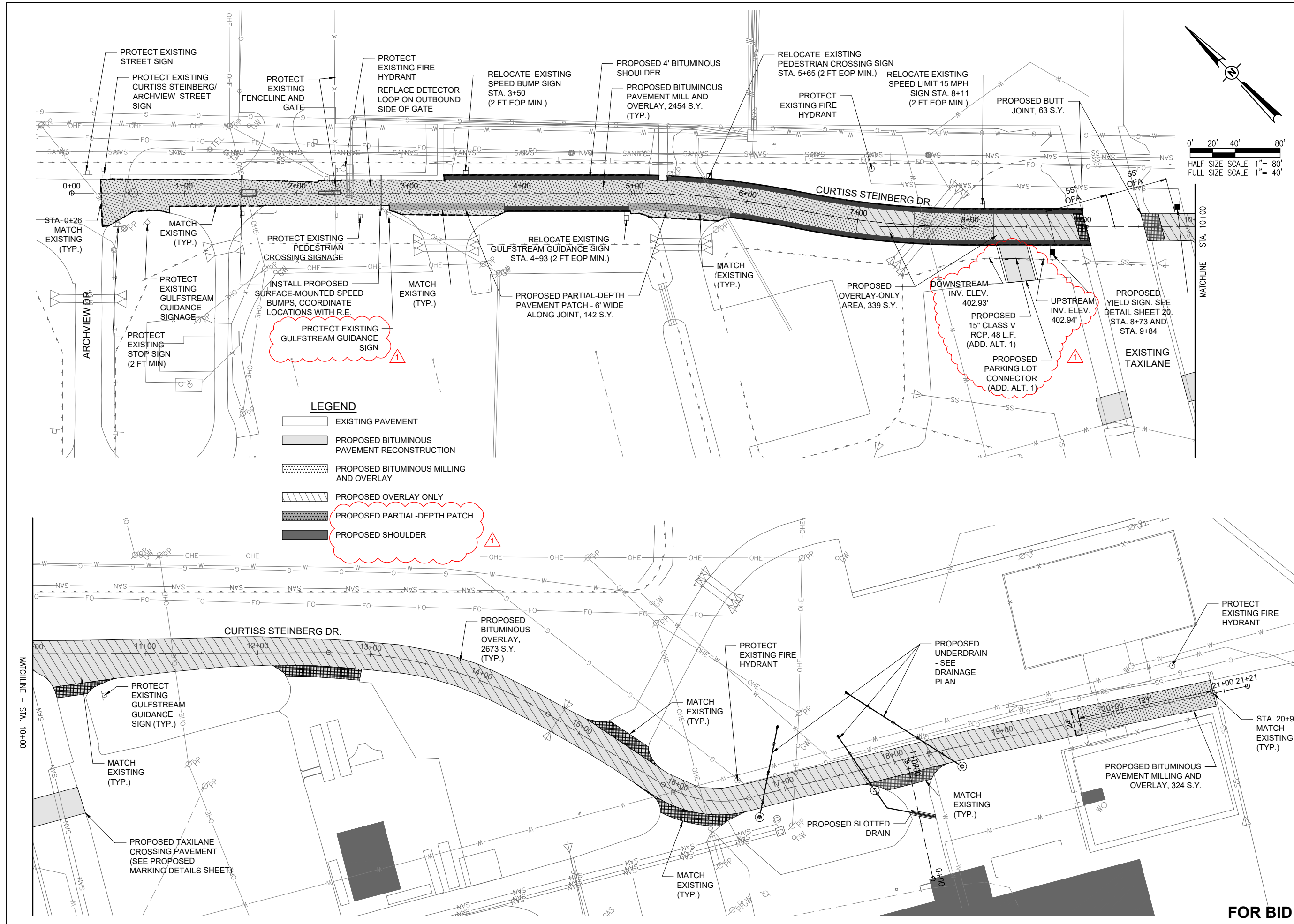

FOR BID

MAR 01, 2024 1:29 PM STOLZ01547
I:\21A0081D\CAD\AIRPORT\PHASE2\121-CON.DWG



**ST. LOUIS
DOWNTOWN AIRPORT**

Bi-State Development
6100 Archview Drive
Cahokia Heights, IL 62206-1445

EXP. 11/30/2025

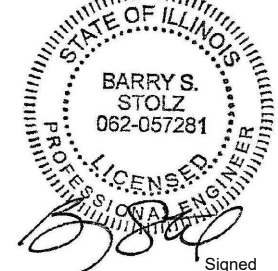

Signed
11/12/2024

**RECONSTRUCT
ACCESS ROAD:
CURTISS STEINBERG
DRIVE, PHASE 2**

IDA No: CPS-4833

Contract No. SD062

NO.	DATE	DESCRIPTION	DES	DWN	REV
1	3/1/2024	ADDENDUM A	BSS	HLE	BSS

ISSUE: JANUARY 12, 2024
PROJECT NO: 21A0081D
CAD FILE: C-151-MRK.DWG
DESIGN BY: MJD 7/20/2022
DRAWN BY: HLE 7/20/2022
REVIEWED BY: BSS 1/12/2024

SHEET TITLE

**PROPOSED MARKING
PLAN**

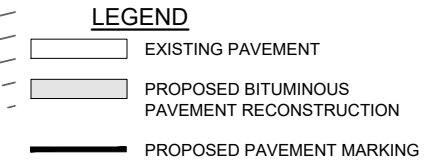
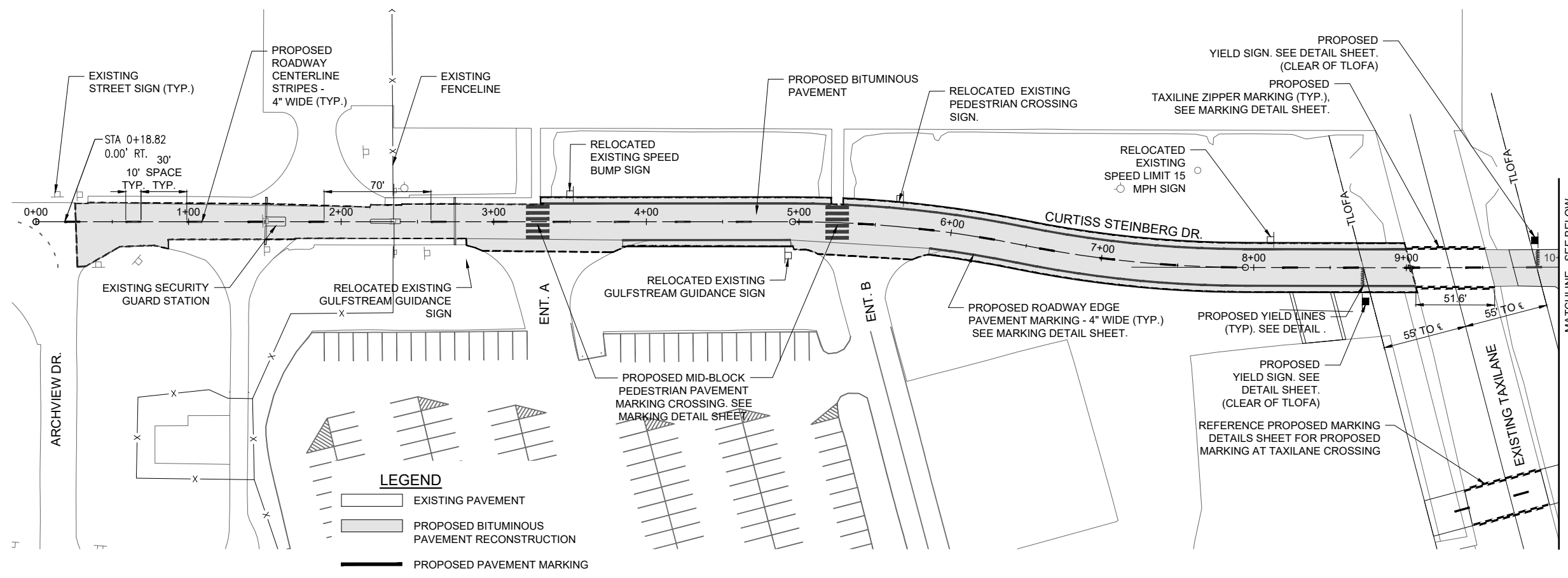
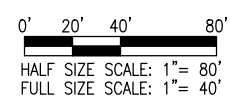
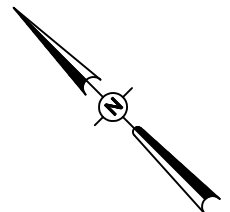

NOTE: SEE PROPOSED PLAN AND PROFILE SHEETS FOR PROPOSED PAVEMENT ALIGNMENT BEGINNINGS AND ENDINGS.

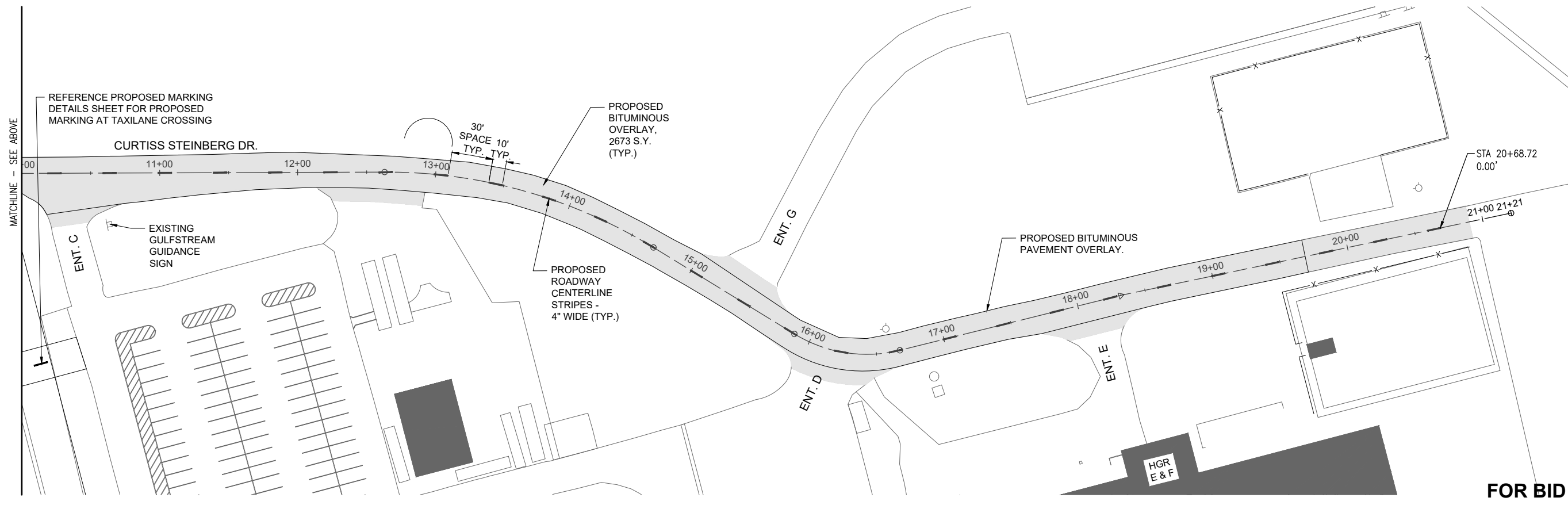

FOR BID

MAR 01, 2024 12:20 PM ENGELO1909
I:\21\JOBS\21A081D\CAD\AIRPORT\151-MRK.DWG



**ST. LOUIS
DOWNTOWN AIRPORT**

Bi-State Development
6100 Archview Drive
Cahokia Heights, IL 62206-1445

EXP.
11/30/2025

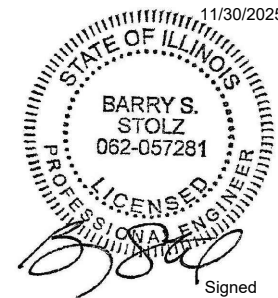

Signed
11/2/2024

**RECONSTRUCT
ACCESS ROAD:
CURTISS STEINBERG
DRIVE, PHASE 2**

IDA No: CPS-4833

Contract No. SD062

NO.	DATE	DESCRIPTION		
		DES	DWN	REV
1	3/1/2024	ADDENDUM A		
		BSS	HLE	BSS

ISSUE: JANUARY 12, 2024
PROJECT NO: 21A0081D
CAD FILE: C-501-MRK.DWG
DESIGN BY: MJD 7/20/2022
DRAWN BY: HLE 7/20/2022
REVIEWED BY: BSS 12/14/2023

SHEET TITLE

**PROPOSED MARKING
DETAILS**

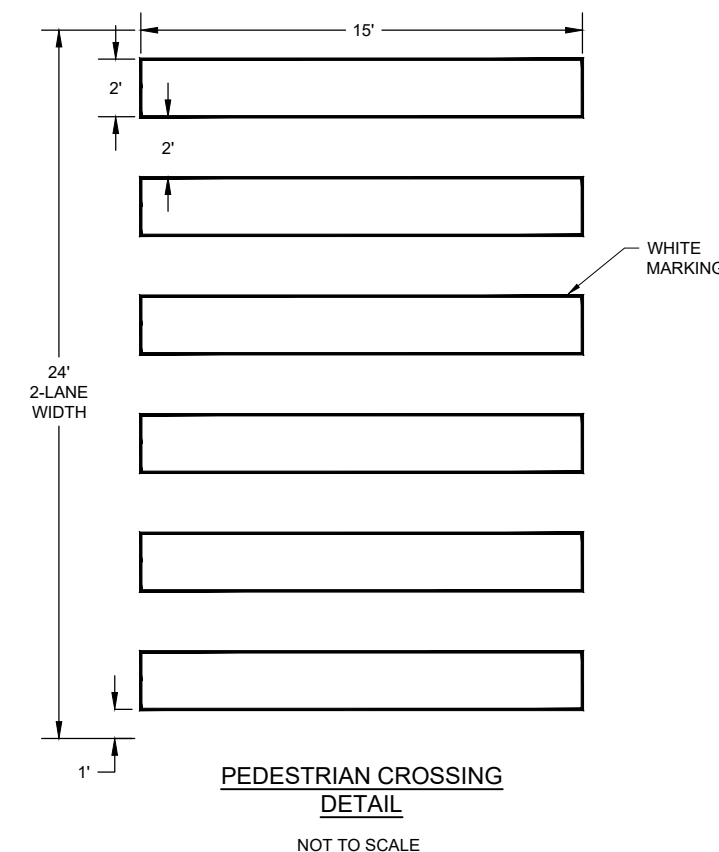
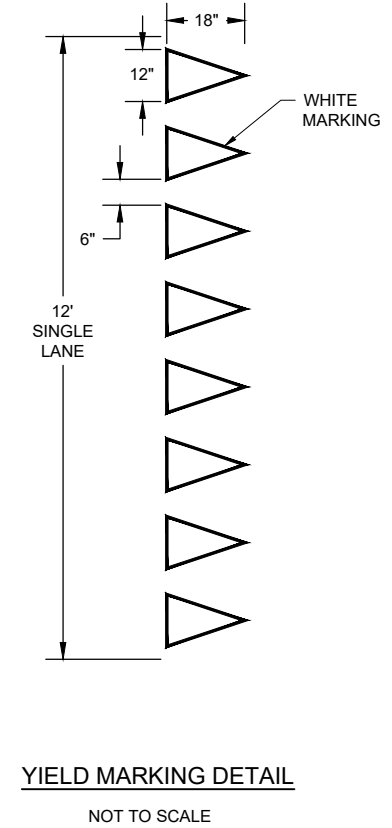
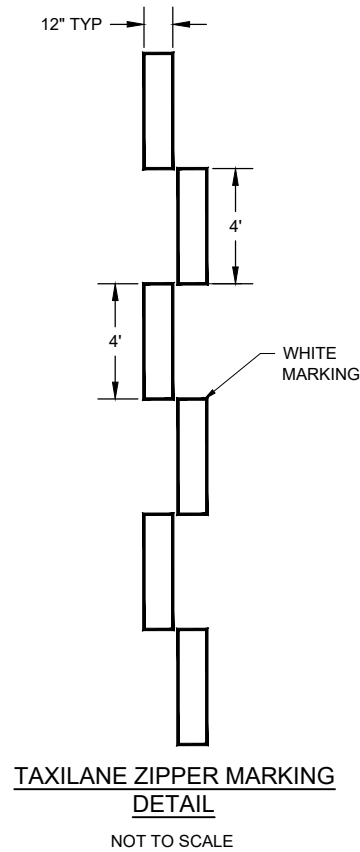
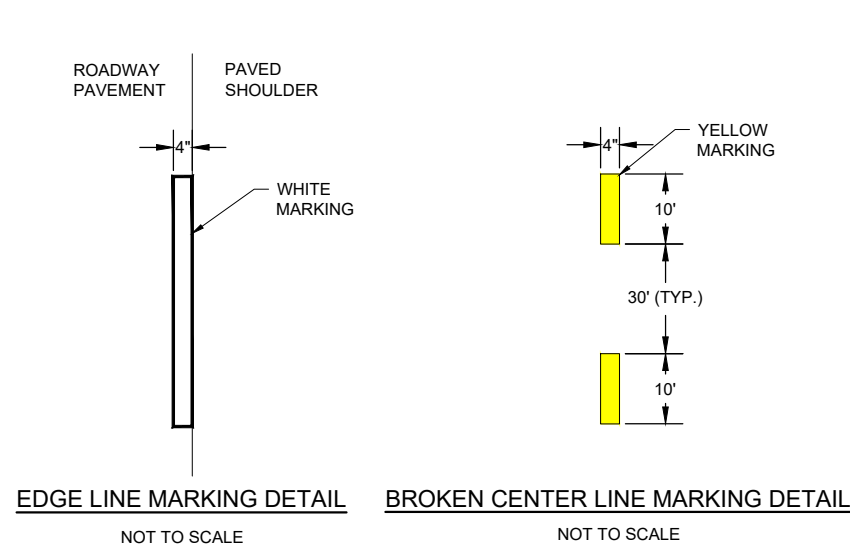

PAVEMENT MARKING

1. THE PAVEMENT MARKING-WATERBORNE (620) SHALL BE PLACED IN ACCORDANCE WITH ITEM 620 "RUNWAY AND TAXIWAY MARKING" AS STATED ON PAGE 535 OF THE ILLINOIS STANDARD SPECIFICATIONS FOR CONSTRUCTION OF AIRPORTS, ADOPTED MARCH 22, 2023.
2. THIS ITEM SHALL CONSIST OF ROADWAY MARKINGS IN ACCORDANCE WITH THESE SPECIFICATIONS AND AT THE LOCATIONS SHOWN ON THE CONSTRUCTION PLANS. ALL MARKING WILL BE EITHER WHITE OR YELLOW IN COLOR. THE PROPOSED PAVEMENT MARKING WILL BE APPLIED IN TWO APPLICATIONS.
3. ANY MATERIAL DELIVERED THAT FAILS TO MEET THE SPECIFICATIONS SHALL BE DISPOSED OF BY THE VENDOR AND IMMEDIATELY REPLACED WITH ACCEPTABLE MATERIAL ENTIRELY AT THE VENDOR'S EXPENSE, INCLUDING HANDLING AND TRANSPORTATION CHARGES.
4. CUT-OFF SHEETS WILL BE REQUIRED TO INSURE STRAIGHT EDGES.

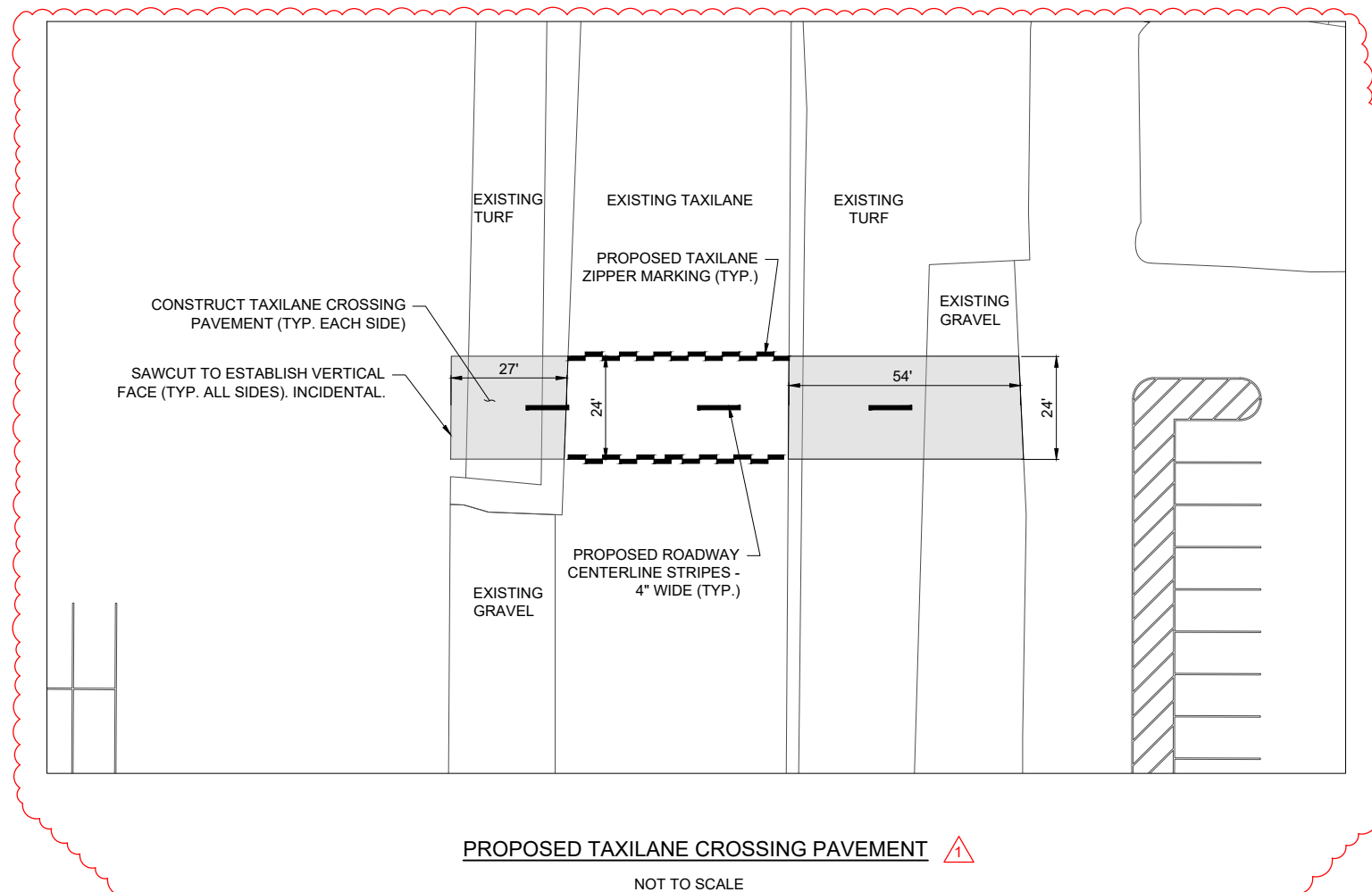
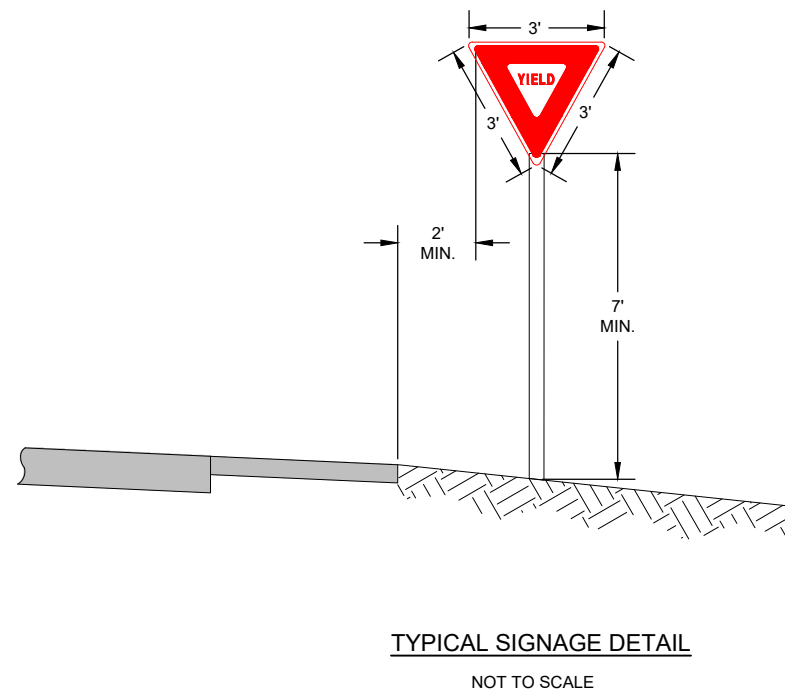

FOR BID



**ST. LOUIS
DOWNTOWN AIRPORT**

Bi-State Development
6100 Archview Drive
Cahokia Heights, IL 62206-1445

EXP.
11/30/2025

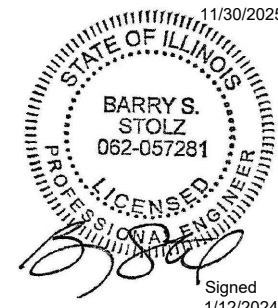

**RECONSTRUCT
ACCESS ROAD:
CURTISS STEINBERG
DRIVE, PHASE 2**

IDA No: CPS-4833

Contract No. SD062

NO.	DATE	DESCRIPTION			
		DES	DWN	REV	
1	3/1/2024	ADDENDUM A	BSS	HLE	BSS

ISSUE: JANUARY 12, 2024
PROJECT NO: 21A0081D
CAD FILE: C-141-SWP.DWG
DESIGN BY: MJD 7/20/2022
DRAWN BY: HLE 7/20/2022
REVIEWED BY: BSS 1/12/2024

SHEET TITLE

**PROPOSED STORM
WATER POLLUTION
PREVENTION PLAN**

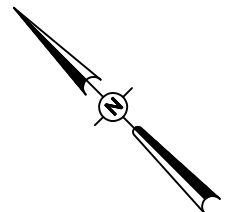

0' 20' 40' 80'
HALF SIZE SCALE: 1" = 80'
FULL SIZE SCALE: 1" = 40'

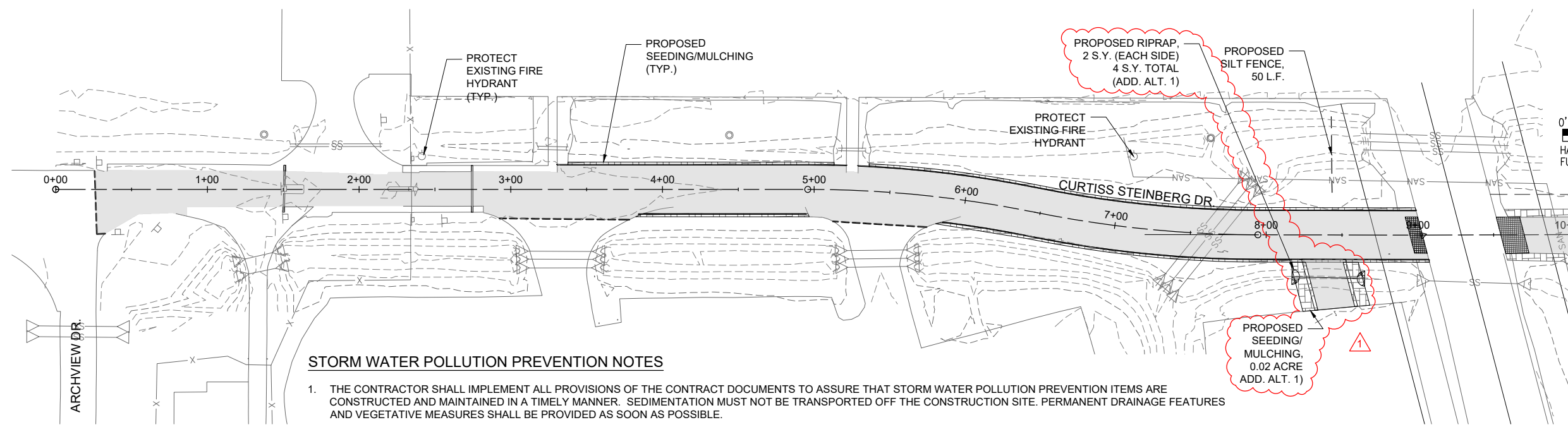

STORM WATER POLLUTION PREVENTION NOTES

1. THE CONTRACTOR SHALL IMPLEMENT ALL PROVISIONS OF THE CONTRACT DOCUMENTS TO ASSURE THAT STORM WATER POLLUTION PREVENTION ITEMS ARE CONSTRUCTED AND MAINTAINED IN A TIMELY MANNER. SEDIMENTATION MUST NOT BE TRANSPORTED OFF THE CONSTRUCTION SITE. PERMANENT DRAINAGE FEATURES AND VEGETATIVE MEASURES SHALL BE PROVIDED AS SOON AS POSSIBLE.
2. THE CONTRACTOR SHALL BE REQUIRED TO IMPLEMENT AND MAINTAIN STORM WATER POLLUTION PREVENTION PRACTICES AND MEASURES PRIOR TO THE STRIPPING OF EXISTING VEGETATION WHERE EVER POSSIBLE AND AS SOON AS CONSTRUCTION PERMITS IN OTHER AREAS. POLLUTION CONTROL MEASURES SHALL BE IN ACCORDANCE WITH THE CONTRACT DOCUMENTS, INCLUDING THESE CONSTRUCTION PLANS, AND WITH STANDARDS AND SPECIFICATIONS FOR SOIL EROSION AND SEDIMENT CONTROL, ILLINOIS ENVIRONMENTAL PROTECTION AGENCY, CURRENT ISSUE. THE CONTRACTOR SHALL ADJUST HIS OPERATIONS AND IMPLEMENT POLLUTION CONTROL MEASURES SO THAT NO RUNOFF FROM STRIPPED AREAS WILL LEAVE THE CONSTRUCTION SITE OTHER THAN THROUGH SEDIMENT TRAPS OR OTHER SUITABLE CONTROL MEASURES.
3. POLLUTION CONTROL ITEMS SHALL BE PROVIDED AS NOTED ON THE STORM WATER POLLUTION PREVENTION PLAN AND IN THE STORM WATER POLLUTION PREVENTION DETAILS AND AS DIRECTED BY THE ENGINEER. THE LIMITS OF SUCH MEASURES SHALL BE STAKED BY THE CONTRACTOR PRIOR TO THE COMMENCEMENT OF CONSTRUCTION. SUCH LIMITS MAY BE ADJUSTED BY THE ENGINEER TO ACCOUNT FOR ACTUAL SITE CONDITIONS EXPERIENCED DURING CONSTRUCTION. ADDITIONAL COMPENSATION FOR MEASURES EXCEEDING THE PLAN QUANTITIES WILL BE PAID FOR AT THE CONTRACT UNIT PRICE FOR EACH ITEM.
4. THE CONTRACTOR IS TO MAINTAIN AND ADJUST, REPAIR OR REPLACE ALL POLLUTION PREVENTION MEASURES AS REQUIRED OR AS DIRECTED BY THE ENGINEER UNTIL PERMANENT VEGETATION HAS BEEN ESTABLISHED. MAINTENANCE OF POLLUTION CONTROL MEASURES IS TO BE PROVIDED AT NO ADDITIONAL COST TO THE CONTRACT.

LEGEND

- EXISTING PAVEMENT
- PROPOSED PAVEMENT
- PROPOSED SEEDING/MULCHING
- PROPOSED SILT FENCE

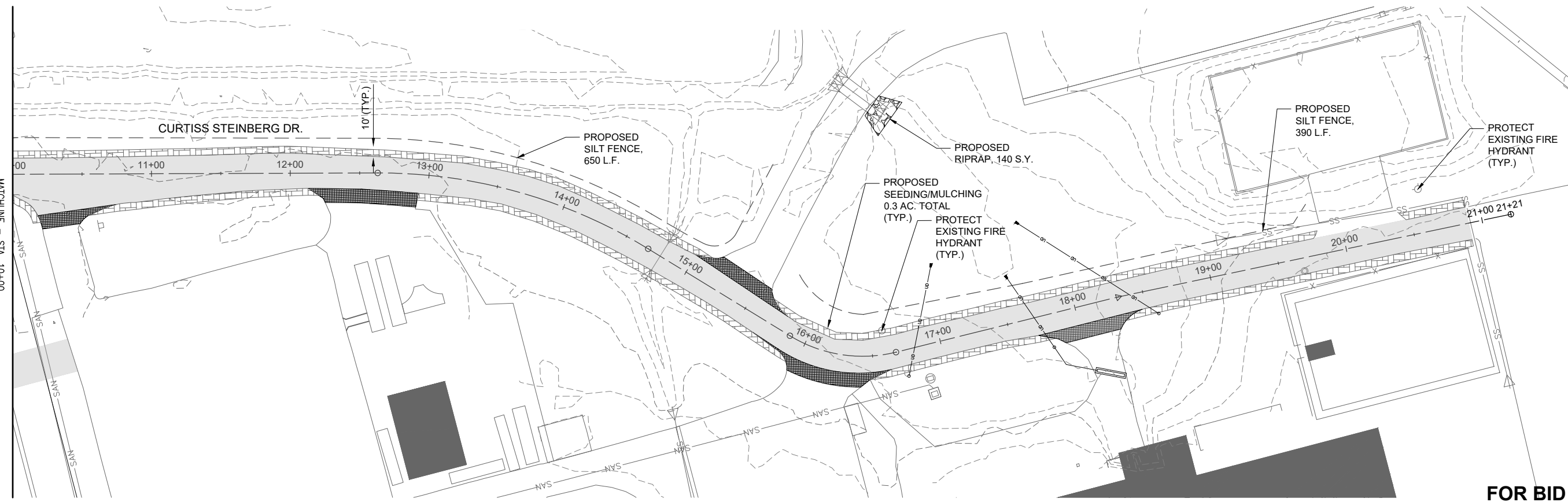

FOR BID

PART 2 – GENERAL CONSTRUCTION ITEMS

ITEM 102 TEMPORARY AIR AND WATER POLLUTION, SOIL EROSION, AND SILTATION CONTROL (UPDATED PER ADDENDUM A, 3/1/2024)

METHOD OF MEASUREMENT

102-4.1 Delete and replace with the following:

Temporary Erosion Control shall not be measured for payment and shall be paid for as a lump sum item. The price shall be full compensation for furnishing all materials and for all labor, equipment, tools, and incidentals necessary to complete the item.

102-4.2 through 102-4.8. Delete these sections.

102-4.10. Delete this section.

BASIS OF PAYMENT

102-5.1 Add the following to this section:

“Payment will be made under:

Item AR156500 Temporary Erosion Control - per lump sum
Item AR156540 Riprap – per square yard
Item AS156540 Riprap – per square yard”

END OF ITEM 102

ITEM 152 EXCAVATION, SUBGRADE, AND EMBANKMENT
(UPDATED PER ADDENDUM A, 3/1/2024)

GENERAL

For the purposes of this project, the pavement is designed for aircraft weighing less than 60,000 pounds.

The intent of the Unclassified Excavation pay item is to cover excavation required for construction of the paved shoulder widening as well as the taxiway crossing pavement. The intent of the Shoulder Adjustment pay items is to cover final grading adjacent to the proposed pavement edges.

Dirt/topsoil for Shoulder Adjustment is intended to be obtained from on-site from either stripping of topsoil from within the project limits or from the existing borrow/stockpile area as shown on the Scope of Work plan sheet. Stripping of the topsoil and placing in-place as shoulder adjustment and/or in temporary stockpiles shall be paid under Item AR152410. Any loading and haul of topsoil material from one area of the Project to another area of the Project, which may be required to provide for the required redistribution of topsoil material within the overall Project (i.e. double handling), will not be measured for payment, but shall be incidental to Item AR152410 or AR152480. Topsoil movement shall be paid only once.

CONSTRUCTION METHODS

152-3.8 Formation of embankments. Add the following to this section:

“The areas adjacent to the proposed pavement shall be cultivated/disked to the satisfaction of the Resident Engineer/Technician prior to placement of additional material. Following placement these areas will require light compaction to the satisfaction of the Resident Engineer/Technician.”

METHOD OF MEASUREMENT

152-4.1 Add the following to this section:

“e. Shoulder adjustment shall be measured for payment by the number of square yards as specified, completed, and accepted by the Resident Engineer/Technician. Shoulder adjustment material shall be approved prior to installation and contain enough organic content to sustain a stand of grass. No pH, gradation or organic will be required.”

BASIS OF PAYMENT

152-5.1 Add the following to this section:

“Payment will be made under:

Item AR152410 – Unclassified Excavation - per cubic yard.
Item AR152480 – Shoulder Adjustment - per square yard.
Item AS152411 – Unclassified Excavation - per lump sum.”

END OF ITEM 152

PART 4 – BASE COURSES

ITEM 209 CRUSHED AGGREGATE BASE COURSE (UPDATED PER ADDENDUM A, 3/1/2024)

BASIS OF PAYMENT

209-5.1 Add the following to this section:

“Payment will be made under:

Item AR209606 – Crushed Agg. Base Course-6” - per square yard.
Item AS209606 – Crushed Agg. Base Course-6” - per square yard.”

END OF ITEM 209

PART 6 – FLEXIBLE PAVEMENTS

ITEM 401 ASPHALT MIX PAVEMENT SURFACE COURSE (UPDATED PER ADDENDUM A, 3/1/2024)

DESCRIPTION

401-1.1 Delete section and add the following:

Section 406 of the Standard Specifications for Road and Bridge Construction, Adopted January 1, 2022 shall govern all material and design requirements for this item. Mix design shall meet criteria set forth in the Plans under the Hot-Mix Asphalt Mixture Requirements Table. For purposes of testing, the item will meet Method I - Under 2,500 tons.

MATERIALS

401-2.3 Asphalt binder. Delete the first sentence and Asphalt Binder Selection table and replace with the following:

Performance Graded asphalt PG 64-22 shall be used for all HMA produced unless otherwise specified.

COMPOSITION

401-3.3 Job mix formula (JMF). Delete and add the following:

The job mix formula shall meet criteria set forth the Plans under the Hot-Mix Asphalt Mixture Requirements Table and in accordance with the Standard Specifications for Road and Bridge Construction, Adopted January 1, 2022.

401-3.5 Test strip. Delete this section (Test Strip not required).

401-4.2 Equipment. Regarding paragraph c. Material transfer vehicle (MTV), a material transfer vehicle is not required for this project. However if one is used it shall follow the requirements of this paragraph.

BASIS OF PAYMENT

401-8.1 Add the following to this section:

“Payment will be made under:

Item AR401613 – Bit. Surf. Cse.-Method I, Superpave - per ton.
Item AS401613 – Bit. Surf. Cse.-Method I, Superpave - per ton.”

END OF ITEM 401

ITEM 602 EMULSIFIED ASPHALT PRIME COAT
(UPDATED PER ADDENDUM A, 3/1/2024)

BASIS OF PAYMENT

602-5.1 Add the following to this section:

“Payment will be made under:

Item AR602510 - Bituminous Prime Coat - per gallon.
Item AS602510 - Bituminous Prime Coat - per gallon.”

END OF ITEM 602

ITEM 603 EMULSIFIED ASPHALT TACK COAT
(UPDATED PER ADDENDUM A, 3/1/2024)

BASIS OF PAYMENT

603-5.1 Add the following to this section:

“Payment will be made under:

Item AR603510 - Bituminous Tack Coat - per gallon
Item AS603510 - Bituminous Tack Coat - per gallon.”

END OF ITEM 603

**ITEM 910200 ROADWAY SIGN
(UPDATED PER ADDENDUM A, 3/1/2024)**

GENERAL

This item of work shall consist of providing and erecting roadway signs (or removing signs) of the types and at the locations shown in the Construction Plans.

MATERIALS

The proposed signs shall be standard signs, as designated on the plan sheets.

The proposed sign supports, fasteners, and accessories shall be IDOT approved, and the support shall be telescoping in structure.

The signs to be relocated that are noted as “speed bump sign”, “pedestrian crossing sign”, and “speed limit sign” are all single U-channel posts. The signs to be relocated that are noted as “Gulfstream guidance sign” have two posts that are square aluminum. If the existing posts are in satisfactory condition and can be reused/reinstalled following relocation, that will be acceptable, otherwise the Contractor shall be required to install new posts similar to the existing type. Cost of posts shall be included in pay item AR910975.

CONSTRUCTION METHODS

The signs shall be placed as shown on the Construction Plans at a distance 6 feet from the edge of pavement, unless directed otherwise by the Owner. The bottom of the sign will be mounted 5 ft above the adjacent pavement elevation. Each sign support shall be installed in accordance with IDOT Standard 728001-01.

The Contractor shall be responsible for locating underground utilities prior to installation of the sign posts in order to avoid conflicts with existing utilities.

The signs noted for removal shall include removal of the sign panels, sign posts and foundations. The void left from the foundation removal shall be backfilled with clean fill material and the surface condition restored to match the surrounding surface.

BASIS OF PAYMENT

Payment will be made at the contract unit price per each roadway sign installed (or removed) and accepted. This price shall be full compensation for furnishing all materials and for all preparation, assembly, and installation of these materials; and for all labor, equipment, tools, and incidentals necessary to complete this item.

Payment will be made under:

- Item AR910200 Roadway Sign - per each.
- Item AR910975 Relocate Roadway Sign - per each.

END OF ITEM 910200

PART 11 – DRAINAGE

ITEM 701 PIPE FOR STORM DRAINS AND CULVERTS (UPDATED PER ADDENDUM A, 3/1/2024)

BASIS OF PAYMENT

701-5.1. Add the following to this section:

“Payment will be made under:

Item AS701615 – 15” RCP, Class V – per linear foot.”

END OF ITEM 701

PART 12 – TURFING

ITEM 901 SEEDING (UPDATED PER ADDENDUM A, 3/1/2024)

BASIS OF PAYMENT

901-5.1 Add the following to this section:

“Payment will be made under:

Item AR901510 Seeding - per acre
Item AS901510 Seeding - per acre”

END OF ITEM 901

ITEM 908 MULCHING
(UPDATED PER ADDENDUM A, 3/1/2024)

BASIS OF PAYMENT

908-5.1 Add the following to this section:

“Payment will be made under:

Item AR908514 Light-Duty Hydraulic Mulch – per acre
Item AS908514 Light-Duty Hydraulic Mulch – per acre”

END OF ITEM 908