

PROFILE SURVEYED BY DATE
 GRADES CHECKED
 E.M. NOTED
 STRUCTURE NOTATION CARD
 NO.

F.A.I. RTE.	SECTION	COUNTY	TOTAL SHEETS	SHEET NO.
84	2005-048 L	COOK	85	75
STA. 2003+00.00 TO STA. 2365+00.00				
FED. ROAD DIST. NO.		ILLINOIS FED. AID PROJECT		80A23

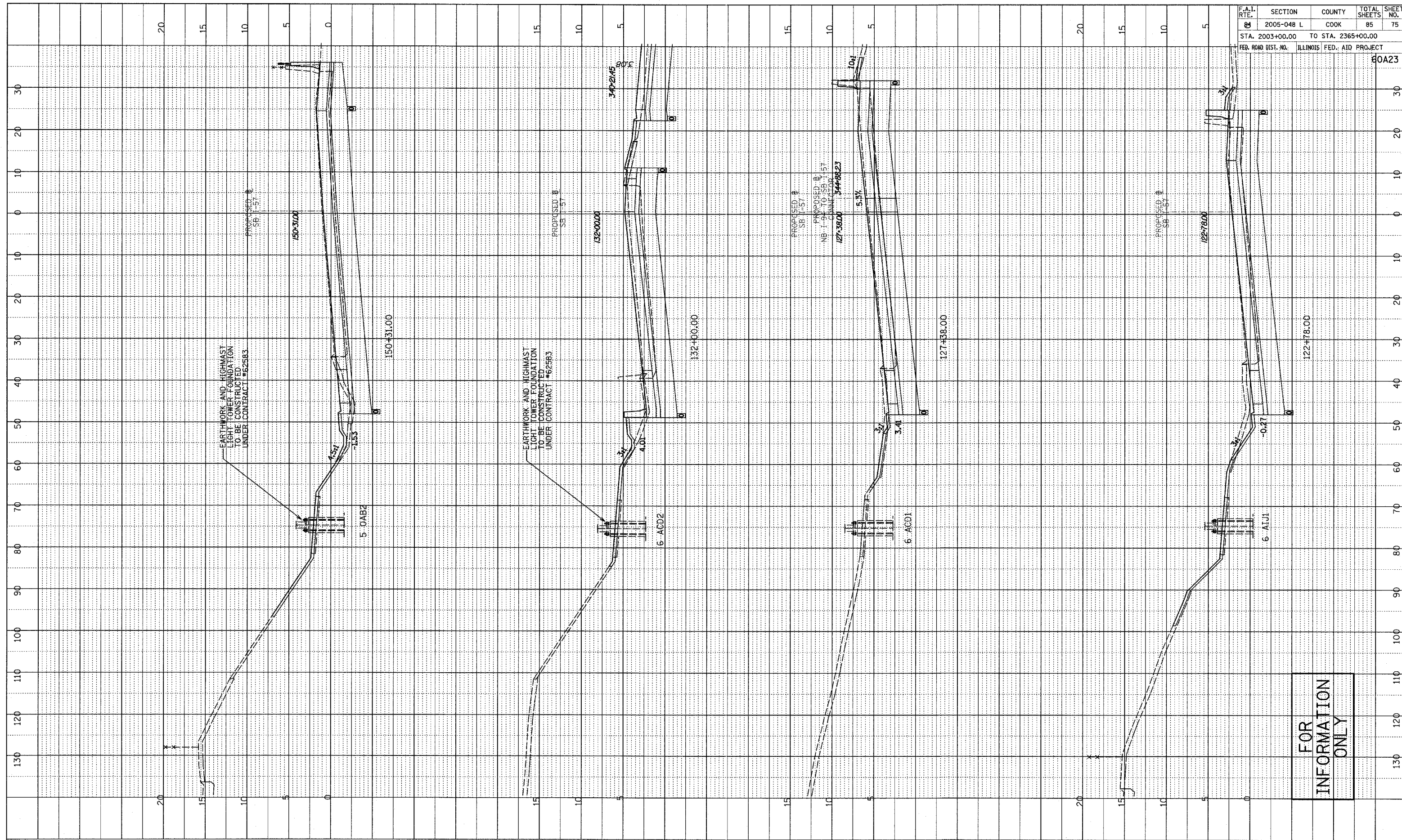

FOR INFORMATION ONLY

TYLIN INTERNATIONAL

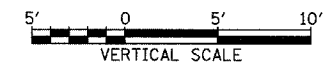
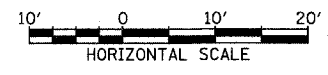

SOUTHBOUND I-57
STA. 122+78 TO STA. 150+31

P:\02\37\Road\c40\gpk\40\briss\hbs7.dgn