

PROFILE	SURVEYED	DATE
NOTE BOOK NO.	GRADES CHECKED	
	BY	
	STRUCTURE NOTATIONS	CHFD

F.A.I. RTE.	SECTION	COUNTY	TOTAL SHEETS	SHEET NO.
94	2005-048 L	COOK	85	77
STA. 2003+00.00 TO STA. 2365+00.00		FED. ROAD DIST. NO. ILLINOIS FED. AID PROJECT		
				60A23

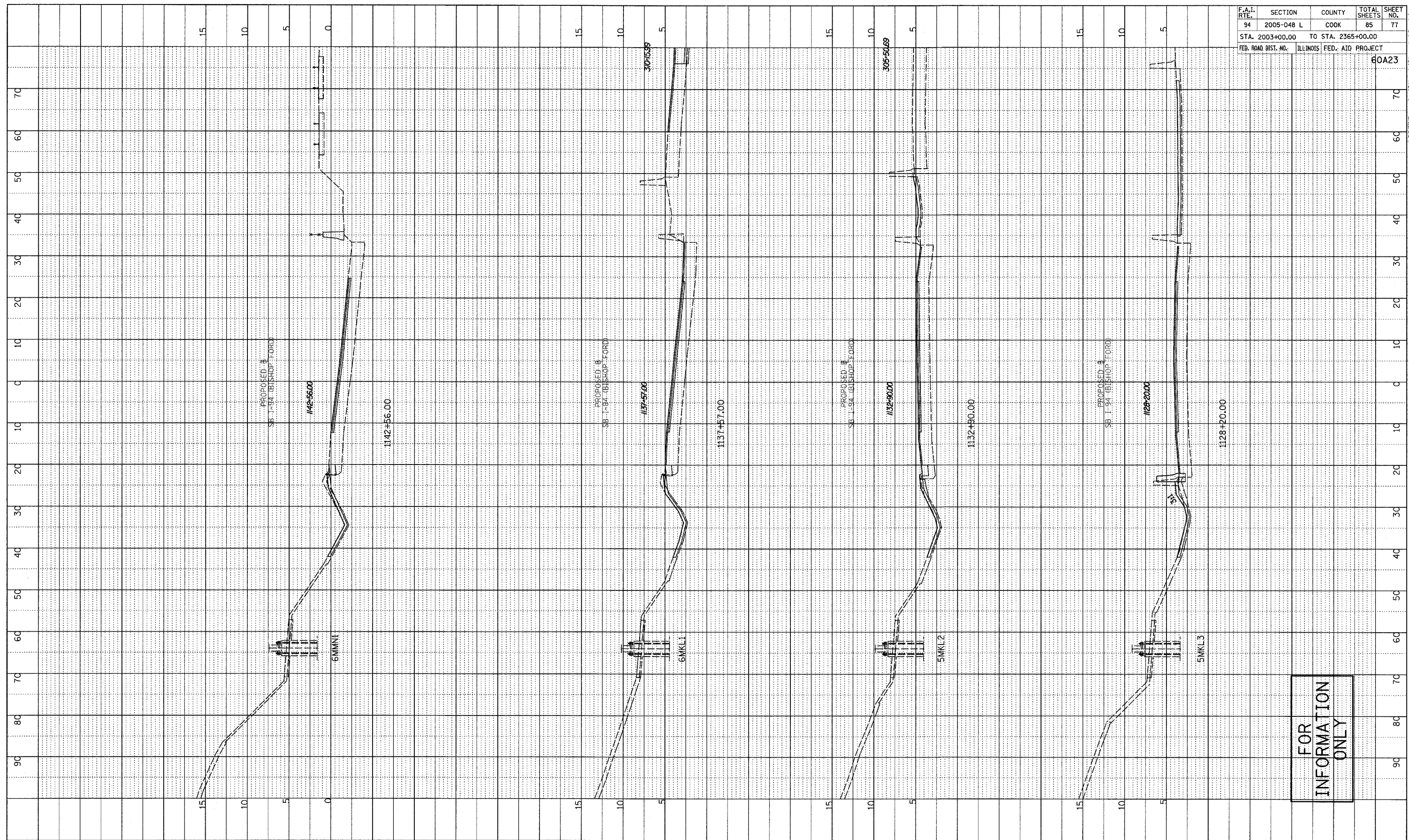

FOR
INFORMATION
ONLY

TYLIN INTERNATIONAL

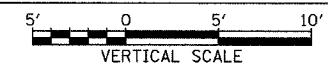
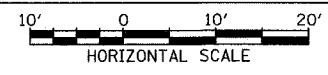

SOUTHBOUND I-94 (BISHOP FORD FWY)
STA. 1128+20 TO STA. 1142+56

PA:0237:Syroad\c40b\gpk40b\ss\shbl\ord.dgn