

SECTION	COUNTY	TOTAL SHEETS	SHEET NO.
1602 *	Cook	38	18
STA. TO STA.		FED. ROAD DIST. NO. 7 ILLINOIS	
		FED. AID PROJECT	
* (0405-1 & 0506-2) RS-1			

CONTROLLER SEQUENCE

REFERRING TO STANDARD 2393, THE VEHICULAR AND PEDESTRIAN PHASES USED ARE DESIGNATED BELOW.

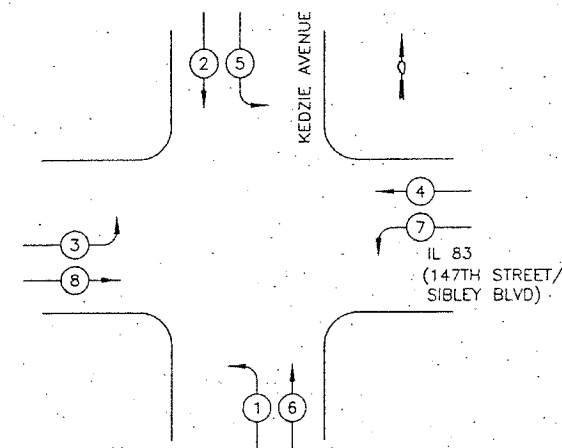

LEGEND

- DUAL ENTRY PHASE
- PEDESTRIAN MOVEMENT
- NUMBER REFERS TO ASSOCIATED PHASE

PHASE DESIGNATION DIAGRAM

DUAL ENTRY - ALL LEGS
PROTECTED/PERMITTED LEFT TURN PHASING

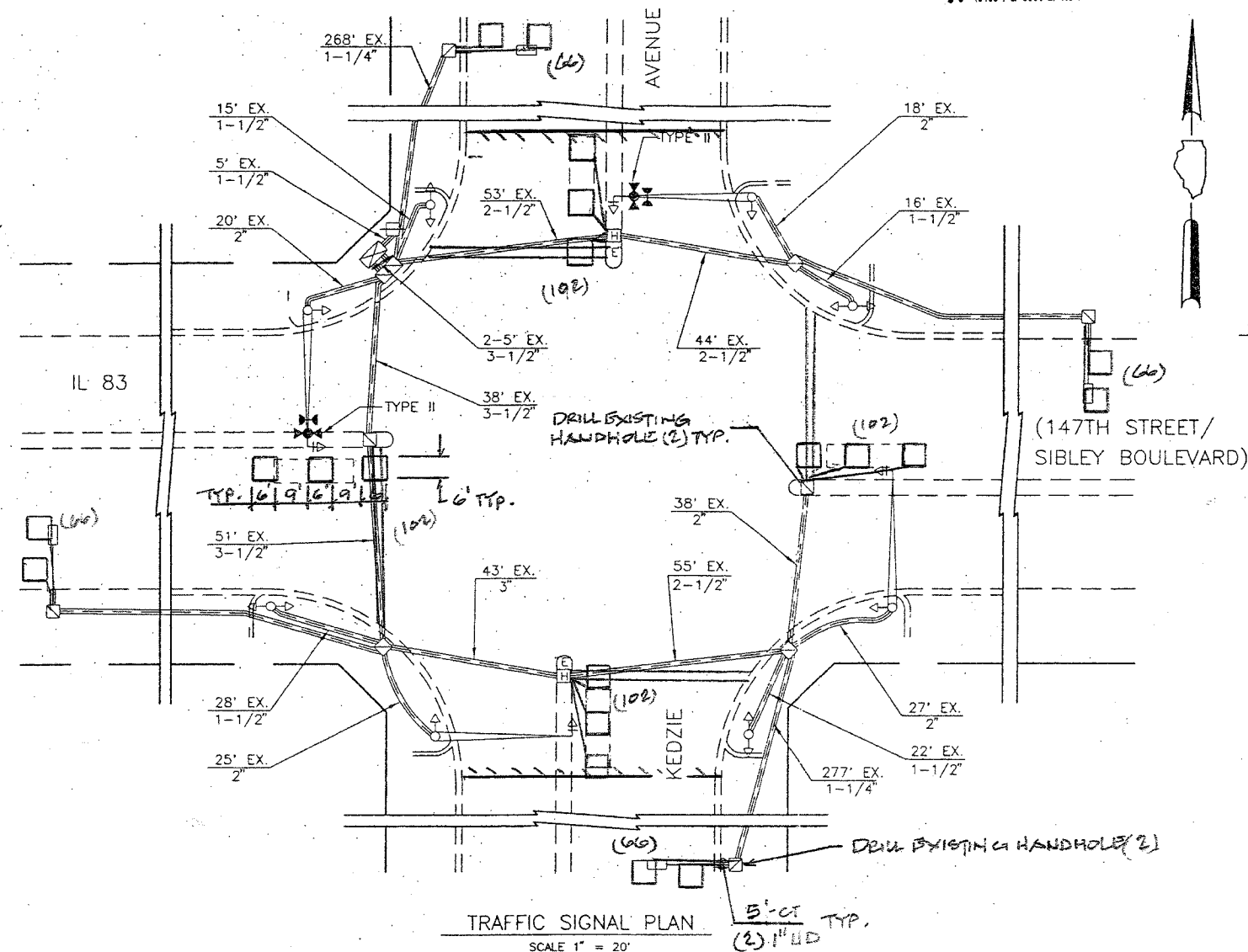

TRAFFIC SIGNAL PLAN
SCALE 1" = 20'

RESURFACING - TRAFFIC SIGNAL SCHEDULE OF QUANTITIES

The * "Pay Items" below are paid separately when it is necessary to remove and replace detection beyond the limit of resurfacing for these items the "D-1 Standard Traffic Signal Specifications" will apply. The remaining items are paid as per attached "Specification" for MAGNETIC DETECTOR REMOVAL AND DETECTOR LOOP INSTALLATION for resurfacing & patching operations.

Code No.	Pay Item	Unit	Quantity
85000200	MAINTENANCE OF EXISTING TRAFFIC SIGNAL INSTALLATION	EACH	1
87301305	ELECTRIC CABLE IN CONDUIT, LEAD-IN, NO.14 1 PAIR	FOOT	*720 870
88500100	INDUCTIVE LOOP DETECTOR	EACH	* 2 2
88600100	DETECTOR LOOP, TYPE I	FOOT	* 132 540
87900200	DRILL EXISTING HANDHOLE	EACH	* 4 -
89502300	REMOVE ELECTRIC CABLE FROM CONDUIT	FOOT	* 742 -

REPLACE ALL DETECTOR LOOPS AS SHOWN

(WITHIN THE RESURFACING LIMITS)

CODE NO.	QUANTITY	UNIT	ITEM
86600600	SEE ABOVE	Foot	Detector Loop Replacement

REVISIONS	
NAME	DATE

NOTE:
THIS PLAN IS FOR THE PURPOSE OF REPLACING THE DETECTOR LOOPS ONLY. ALL OTHER INFORMATION SHOWN IS NOT RELATED AND WILL BE DISREGARDED.

ILLINOIS DEPARTMENT OF TRANSPORTATION
DETECTOR LOOP REPLACEMENT
ILLINOIS ROUTE B3 (147TH ST) @ KEDZIE AVE.
SCALE: NONE
DATE: OCTOBER 2006
DRAWN BY: JHE
DESIGNED BY: JHE
CHECKED BY: D.A.D.