

ALL DIMENSIONS IN METERS EXCEPT PAY ITEMS AND UNLESS NOTED OTHERWISE

F.A.I. RTE.	SECTION	COUNTY	TOTAL SHEETS	SHEET NO.
80/94	2003-106LS	COOK	88	71
STA.	TO STA.			
FED. ROAD DIST. NO.	ILLINOIS FED. AID PROJECT			
CONTRACT NO. 62699				

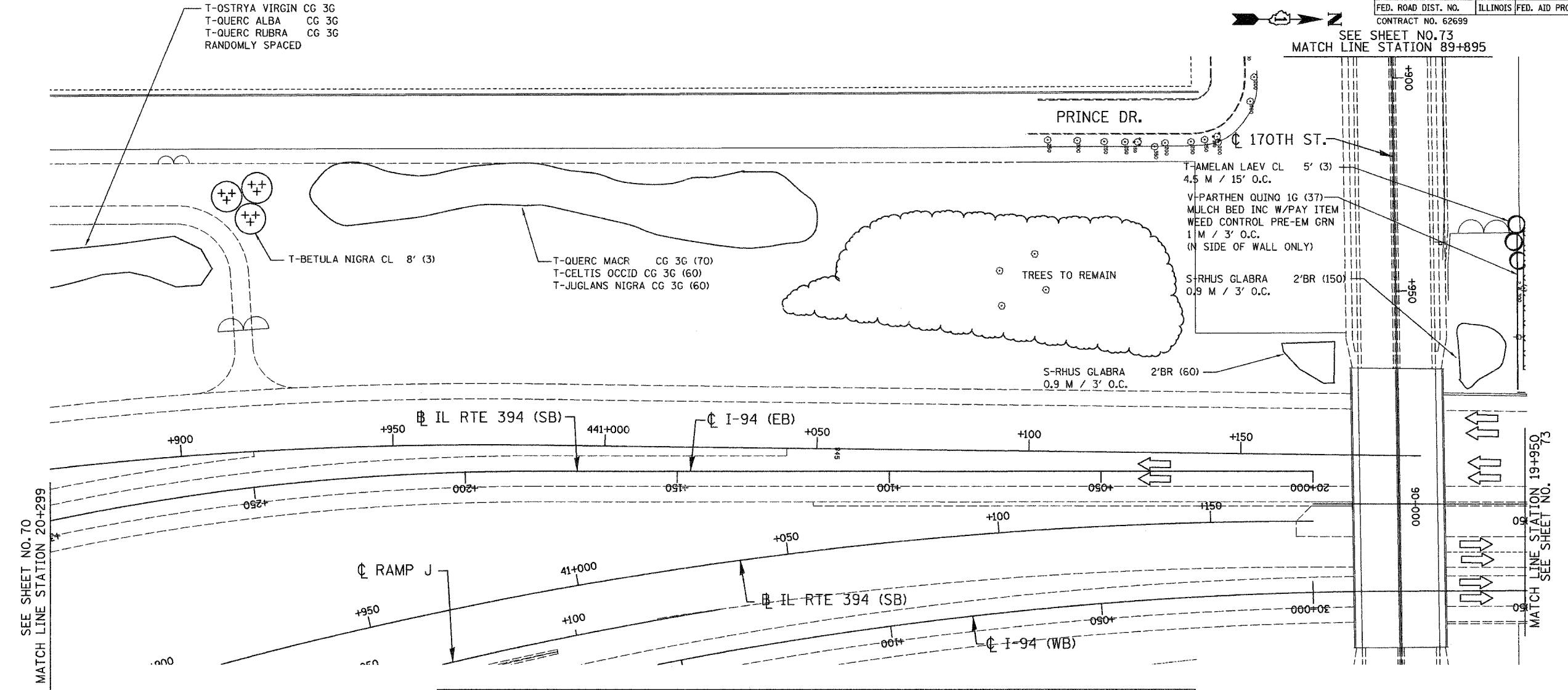

SEE SHEET NO. 70  
MATCH LINE STATION 20+299

MATCH LINE STATION 19+950  
SEE SHEET NO. 73

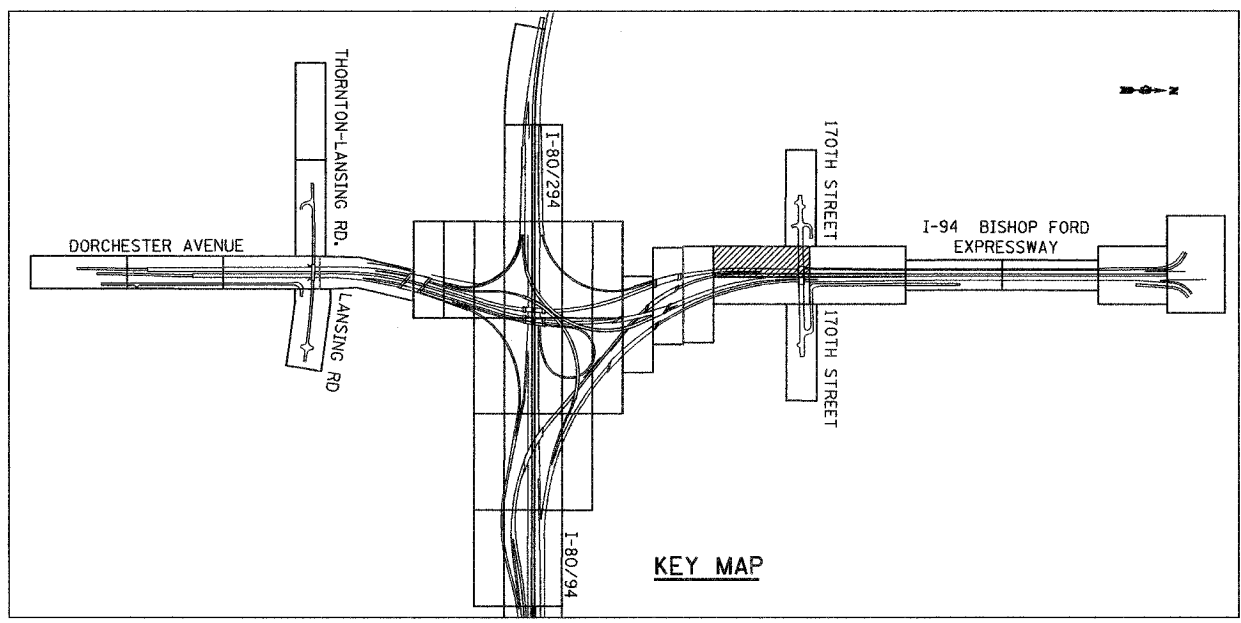

LSNS - 58

ILLINOIS DEPARTMENT OF TRANSPORTATION  
 I-80/94/US 6  
 KINGERY-BORMAN EXPRESSWAY  
 BURNHAM ROAD TO US 41  
**LANDSCAPING PLAN**  
 I-94 BISHOP FORD EXPWAY

REVISIONS	
NAME	DATE

SCALE 1:500  
 DATE 12/13/06  
 DRAWN BY ACE/CAD  
 CHECKED BY TJW



12/12/2006  
 3:05:53 PM  
 S:\Project\2014080\CADD\Contract LS\LS\_68.rvt