

F.A.P. RTE.	SECTION	COUNTY	TOTAL SHEETS	SHEET NO.
343		COOK	283	30
STA. 9+713.000		TO STA. 10+151.000		
FED. ROAD DIST. NO. 1		ILLINOIS FED. AID PROJECT		
700-Y-B-R & 704B-R-1		62897		

- NOTES:**
1. ALL DIMENSIONS ARE IN METERS (m) UNLESS OTHERWISE NOTED
 2. FOR MORE INTERSECTION INFORMATION SEE INTERSECTION LAYOUT DETAILS
 3. FOR MORE INTERSECTION INFORMATION SEE INTERSECTION ELEVATION DETAILS
 4. FOR PROPOSED GUARDRAIL LOCATIONS SEE PAVEMENT MARKING AND LANDSCAPING PLANS
 5. FOR MORE CONCRETE BARRIER INFORMATION SEE INTERSECTION DETAILS - 1.

NOTE:
"BITUMINOUS CONCRETE SUPERPAVE" SHALL BE INTERPRETED AS NOTED ON PROPOSED TYPICAL SECTIONS.

PLAN	SURVEYED	DATE
	PLOTTED	
	ALIGNED	
	CHECKED	
	RT. OF WAY	
	CHECKED	
	NO.	
	CADD FILE NAME	

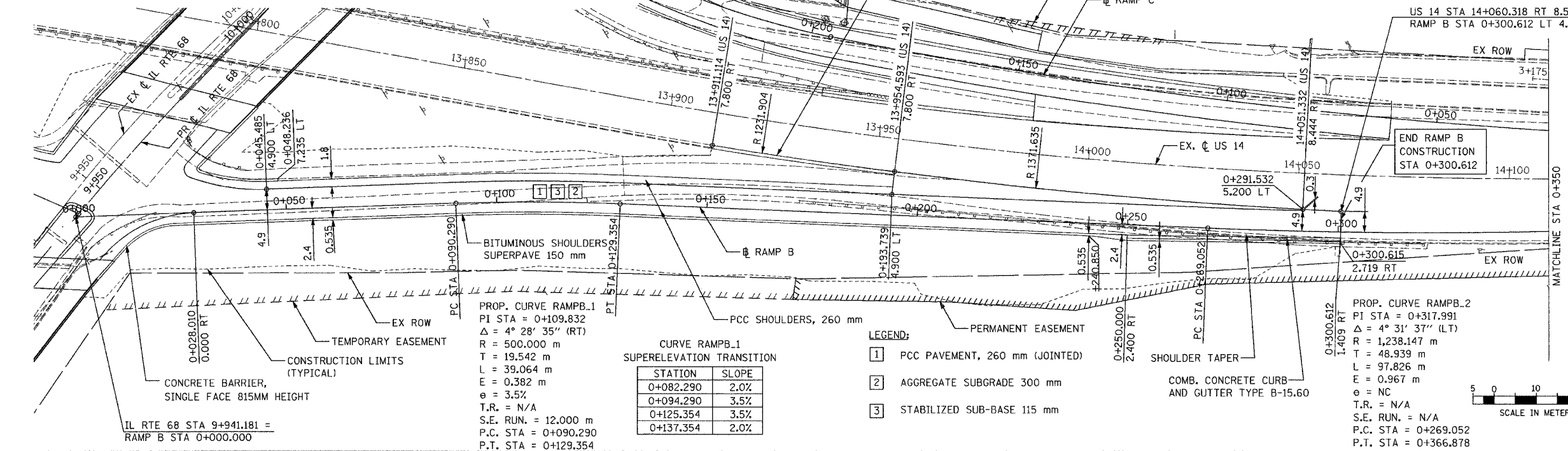

CURVE RAMPB.1 SUPERELEVATION TRANSITION

STATION	SLOPE
0+082.290	2.0%
0+094.290	3.5%
0+125.354	3.5%
0+137.354	2.0%

- LEGEND:**
- 1 PCC PAVEMENT, 260 mm (JOINTED)
 - 2 AGGREGATE SUBGRADE 300 mm
 - 3 STABILIZED SUB-BASE 115 mm

PROP. CURVE RAMPB.2
 PI STA = 0+317.991
 $\Delta = 4^\circ 31' 37''$ (LT)
 R = 1,238.147 m
 T = 48.939 m
 L = 97.826 m
 E = 0.967 m
 e = NC
 T.R. = N/A
 S.E. RUN. = N/A
 P.C. STA = 0+269.052
 P.T. STA = 0+366.878

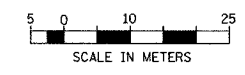

PROFILE	SURVEYED	DATE
	PLOTTED	
	GRADES	
	CHECKED	
	B.M. NOTED	
	NO.	
	STRUCTURE NOTATIONS	
	CHKD	

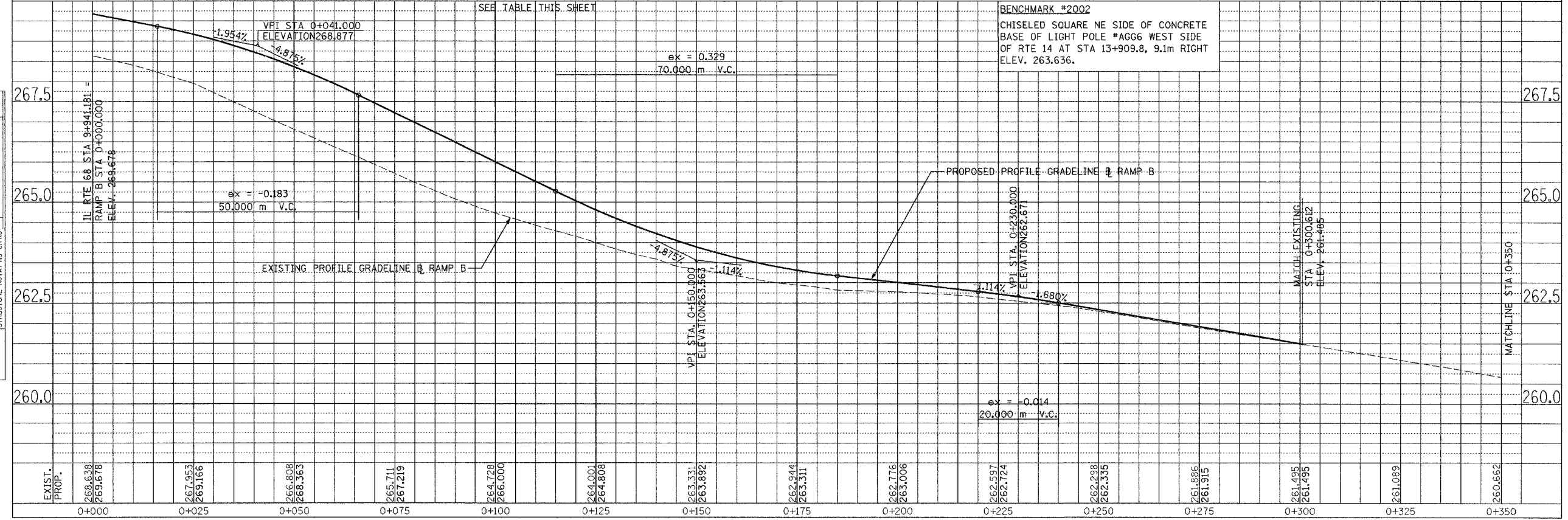

BENCHMARK #2002
 CHISELED SQUARE NE SIDE OF CONCRETE BASE OF LIGHT POLE #AGG6 WEST SIDE OF RTE 14 AT STA 13+909.8, 9.1m RIGHT ELEV. 263.636.

SCALE: H=1:500, V=1:50 RAMP B-PROPOSED PLAN AND PROFILE -4