

F.A.P. RTE.	SECTION	COUNTY	TOTAL SHEETS	SHEET NO.
343	•	COOK	283	72
STA. 9+713.000		TO STA. 10+151.000		
FED. ROAD DIST. NO. 1 ILLINOIS FED. AID PROJECT				
• 70D-Y-B-R & 70HB-R-1 62897				

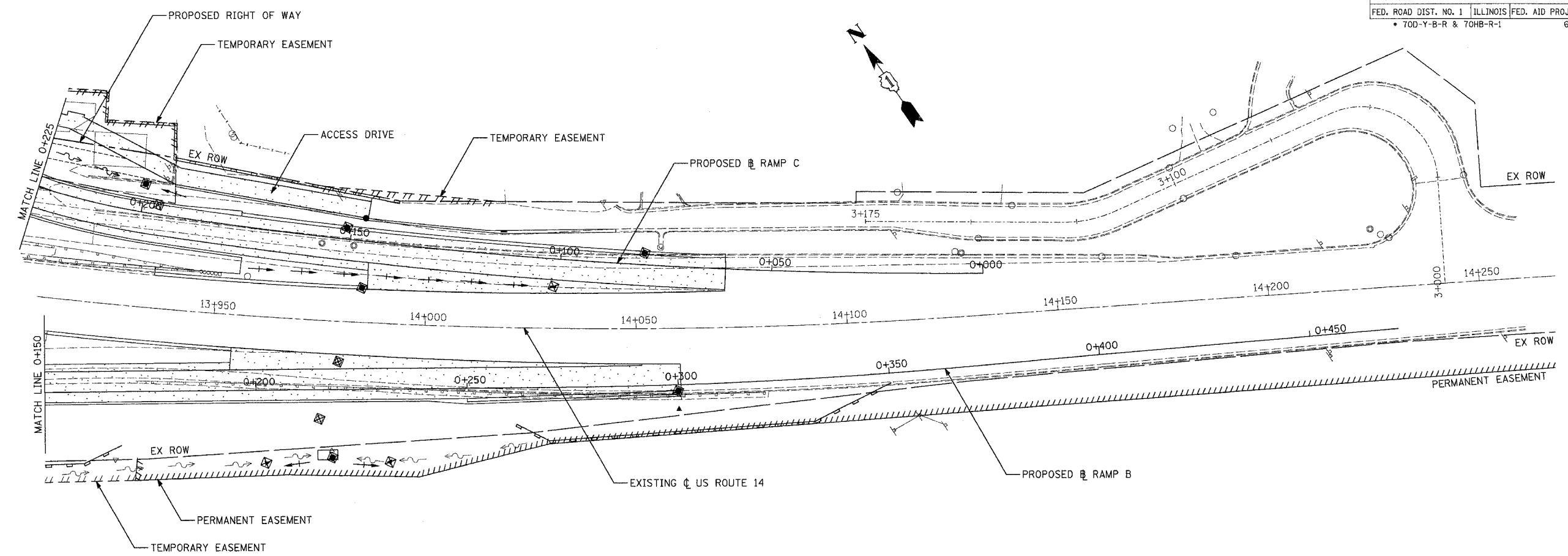

- NOTES:**
1. FOR MORE DRAINAGE INFORMATION SEE PROPOSED DRAINAGE PLANS.
 2. PERIMETER EROSION BARRIER IS LOCATED ON TEMP. EASEMENT/PERM. EASEMENT/R.O.W. LINE AS SHOWN ON THE PLANS.
 3. FOR PERMANENT EROSION CONTROL INFORMATION SEE LANDSCAPING PLANS.
 4. FOR MORE STAGE CONSTRUCTION INFORMATION SEE MOT PLANS.

LEGEND:

	INLET AND PIPE PROTECTION
	PERIMETER EROSION BARRIER
	TEMPORARY DITCH CHECK
	DITCH FLOW
	SWALE
	TEMPORARY FENCE
	CONSTRUCTION ZONE
	TEMPORARY PAVEMENT
	TEMPORARY PAVEMENT (PREVIOUS STAGES)
	COMPLETED CONSTRUCTION (PREVIOUS STAGES)

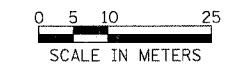

REVISIONS	
NAME	DATE

ILLINOIS DEPARTMENT OF TRANSPORTATION
ILLINOIS ROUTE 68
TEMPORARY EROSION CONTROL PLAN
ILLINOIS ROUTE 68 STAGE 2A AND 2B
STA. 13+900 TO STA. 14+270 US 14

SCALE 1:500
DATE OCTOBER, 2006

DRAWN BY GRH
CHECKED BY PK