

F.A.P. RTE.	SECTION	COUNTY	TOTAL SHEETS	SHEET NO.
567	34X-BR	DEKALB	90	55

STA.	TO STA.
FED. ROAD DIST. NO.	ILLINOIS FED. AID PROJECT

DATE	BY	CHKD	DATE	BY	CHKD
2/24/06	JL	DL	1/5	1/3	

SHEET NO. 9
9 SHEETS

STATE OF ILLINOIS
DEPARTMENT OF TRANSPORTATION

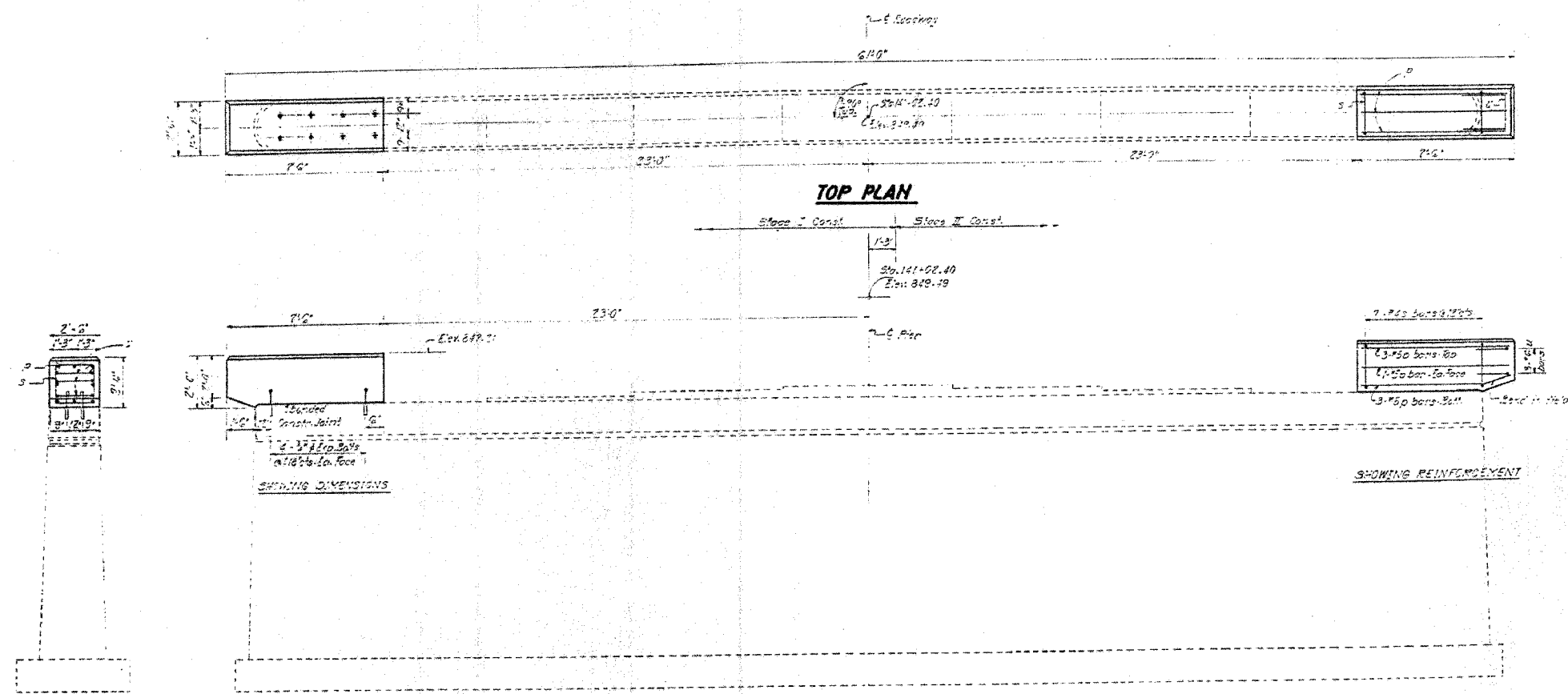

BILL OF MATERIAL

Bar	No.	Size	Length	Sh. wt.
Ø	16	#5	7.5'	
Ø	16	#4	0.5'	
U	6	#6	7.1'	
Class X Concrete		Cu. Yd.	2.6	
Reinforcement Bars		Wt. (Lbs.)	27.8	
Expansion Bars (3#)		Each	16	

Notes:
Expansion bars shall be anchored in sound concrete.
All edges shall have standard 45-degree chamfers unless otherwise noted.

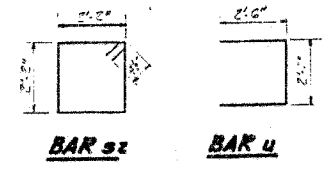

PIER
F.A.R.T. 567 SEC. 34-X-BY
DEKALB COUNTY
STA. 141+02.40

DESIGNED	JL	EXAMINED	March 20 1977 Carl E. Hummer
CHECKED	JL	PASSED	
DRAWN	S.V.	APPROVED	
CHECKED	J.L.G.		

FOR INFORMATION ONLY

REVISIONS	
NAME	DATE

ILLINOIS DEPARTMENT OF TRANSPORTATION
EXISTING BRIDGE PLANS

FAP RTE 567 (IL RTE 38)
SECTION 34X-BR
DEKALB COUNTY

SCALE: VERT. DRAWN BY SUTHEARD
HORIZ. CHECKED BY BOIT
DATE 2/24/06

GREENE & BRADFORD, INC.
OF SPRINGFIELD
CONSULTING ENGINEERS
PROFESSIONAL ENGINEERS
PROFESSIONAL SURVEYORS
PROFESSIONAL ARCHITECTS
107-109 BROADWAY, 10TH FLOOR, NEW YORK, N.Y. 10038
TEL: 212-693-1000 FAX: 212-693-1001

COMPUTER FILE NO.
D10800EPLN
PROJECT 05198
2/27/06-MDS

EXISTING BRIDGE PLANS

PLOT DATE = ADATES
FILE NAME = #FILE#
PLOT SCALE = #SCALE#
REFERENCE = #REF#
OPERATOR = #USERS