

F.A.P. RTE.	SECTION	COUNTY	TOTAL SHEETS	SHEET NO.
567	34X-BR	DEKALB	90	62
STA.		TO STA.		
FED. ROAD DIST. NO.		ILLINOIS FED. AID PROJECT		

NO.	SECTION	QUANTITY	TOTAL FEET	PER SHEET
6	34X-B	DEKALB	13	10

SHEET NO. 6
8 SHEETS

STATE OF ILLINOIS
DEPARTMENT OF PUBLIC WORKS & BUILDINGS
DIVISION OF HIGHWAYS

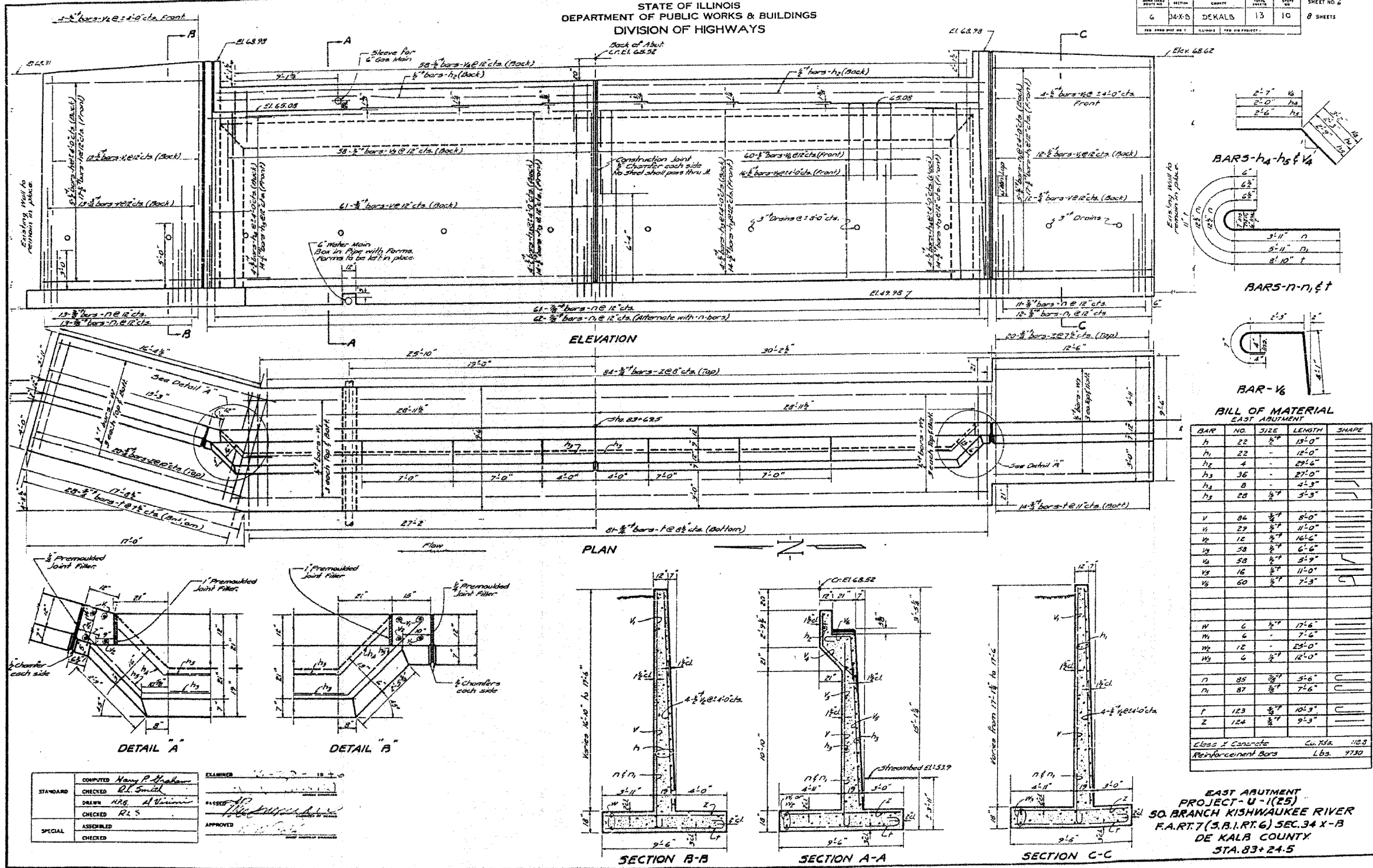

FOR INFORMATION ONLY

PLOT DATE = 04/27/06
FILE NAME = 05198.DWG
PLOT SCALE = 1/8"=1'-0"
PLOT DATE = 04/27/06
OPERATOR = MJS

COMPUTED	Nancy P. Shaban	EXAMINED	[Signature]
CHECKED	D.L. Smith	DATE	10/20/05
DRAWN	M.A.B. al-Wassim	PASSED	[Signature]
CHECKED	R.L.S.	APPROVED	[Signature]
SPECIAL	ASSEMBLED		
	CHECKED		

REVISIONS	
NAME	DATE

ILLINOIS DEPARTMENT OF TRANSPORTATION
EXISTING BRIDGE PLANS

FAP RTE 567 (IL RTE 38)
SECTION 34X-BR
DEKALB COUNTY

SCALE: VERT. 1/8"=1'-0"
HORIZ. 1/4"=1'-0"
DATE 2/24/06

DRAWN BY SUTHEARD
CHECKED BY BOTT

GREENE & BRADFORD, INC.
OF SPRINGFIELD

COMPUTER FILE NO. D10800EPLN
PROJECT 05198
2/27/06-MDS