

F.A.P. RTE.	SECTION	COUNTY	TOTAL SHEETS	SHEET NO.
754	101M&TS	BOONE	95	1

(IL 76)

STATE OF ILLINOIS
DEPARTMENT OF TRANSPORTATION
DIVISION OF HIGHWAYS

**PROPOSED
HIGHWAY PLANS**

FAP ROUTE 754 (IL 76)
SECTION 101M&TS
PROJECT HSIP-0754(008)
BOONE COUNTY
C-92-117-06

FOR INDEX OF SHEETS, SEE SHEET NO. 2
FOR STATE STANDARDS, SEE SHEET NO. 2

PROJECT ENGINEER: MASOOD AHMAD
SENIOR SQUAD LEADER: SAM ABDULLAH (815) 284-5935
SQUAD LEADER: CHAD SPREEMAN (815) 284-5934



SECTION AND IMPROVEMENT
BEGINS - STA. 229 + 89.48

BELVIDERE TOWNSHIP - SECTION 14

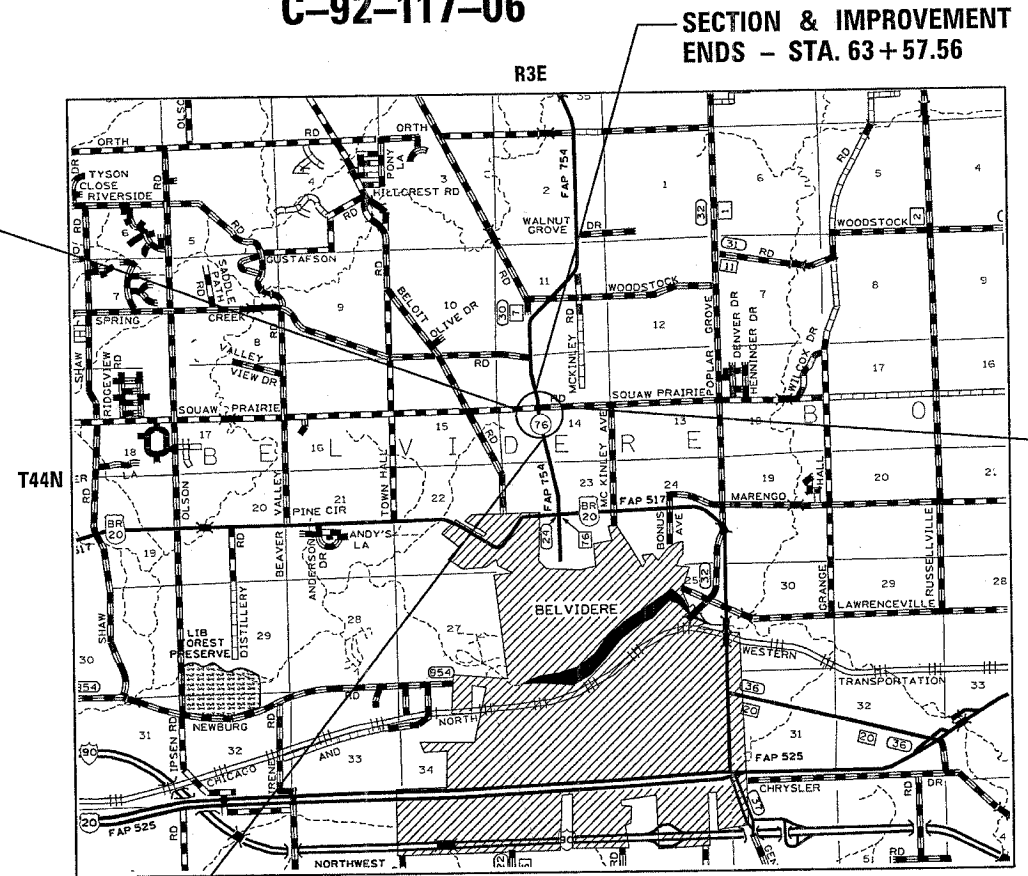

SECTION ENDS - STA. 246 + 89
IMPROVEMENT ENDS - STA. 247 + 00

SECTION & IMPROVEMENT
BEGINS - STA. 44 + 23.86

FULL SIZE PLANS HAVE BEEN PREPARED USING STANDARD
ENGINEERING SCALES. REDUCED SIZED PLANS WILL NOT
CONFORM TO STANDARD SCALES. IN MAKING MEASUREMENTS
ON REDUCED PLANS, THE ABOVE SCALES MAY BE USED.

J.U.L.I.E.
JOINT UTILITY LOCATION INFORMATION FOR EXCAVATION
1-800-892-0123

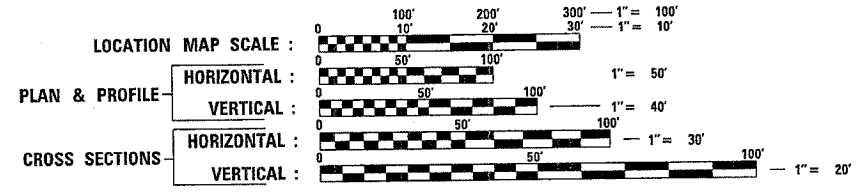

NET LENGTH OF PROJECT = 1933.7 FT = 0.366 MILE
GROSS LENGTH OF PROJECT = 3633.2 FT = 0.688 MILE

STATE OF ILLINOIS
DEPARTMENT OF TRANSPORTATION
DIVISION OF HIGHWAYS

SUBMITTED December 12, 2006

Joseph E. Gorman
DEPUTY DIRECTOR OF HIGHWAYS, REGION ENGINEER

February 2, 2007
Eric E. Howard
ENGINEER OF DESIGN AND ENVIRONMENT

February 2, 2007
Milton R. Sees, P.E.
DIRECTOR OF HIGHWAYS/CHIEF ENGINEER

**PRINTED BY THE AUTHORITY
OF THE STATE OF ILLINOIS**

CONTRACT NO. 64B81

FAP ROUTE 754 (IL 76) - SECTION 101M&TS - BOONE COUNTY