

F.A.I. RTE.	SECTION	COUNTY	TOTAL SHEETS	SHEET NO.
39	141 / 201		46	8
STA. 13+00 (RAMP H) TO STA. 1480+00				
FED. ROAD DIST. NO. ILLINOIS FED. AID PROJECT				
*OGLE / WINNEBAGO				

U.S.G.S. DATUM
5th G.A. (1929)

SEC. 29, T40N, R2E, 3rd PM.

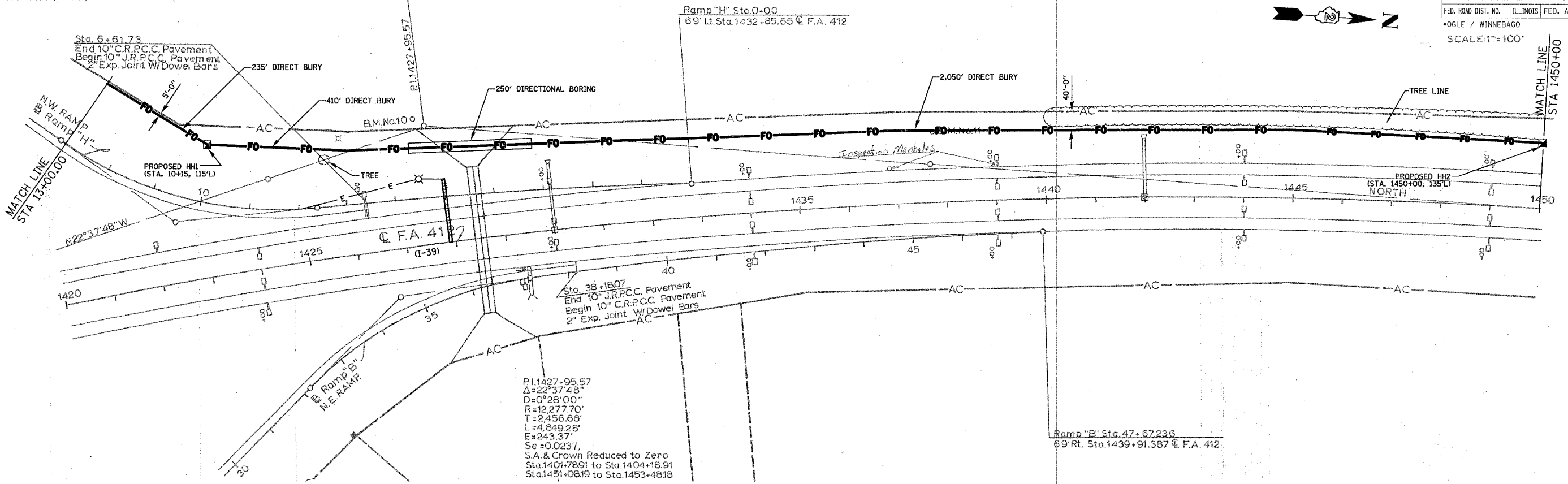

5th G.A. (1929)

SEC. 29, T40N, R2E, 3rd PM.

SEC. 20, T40N, R2E, 3rd PM.

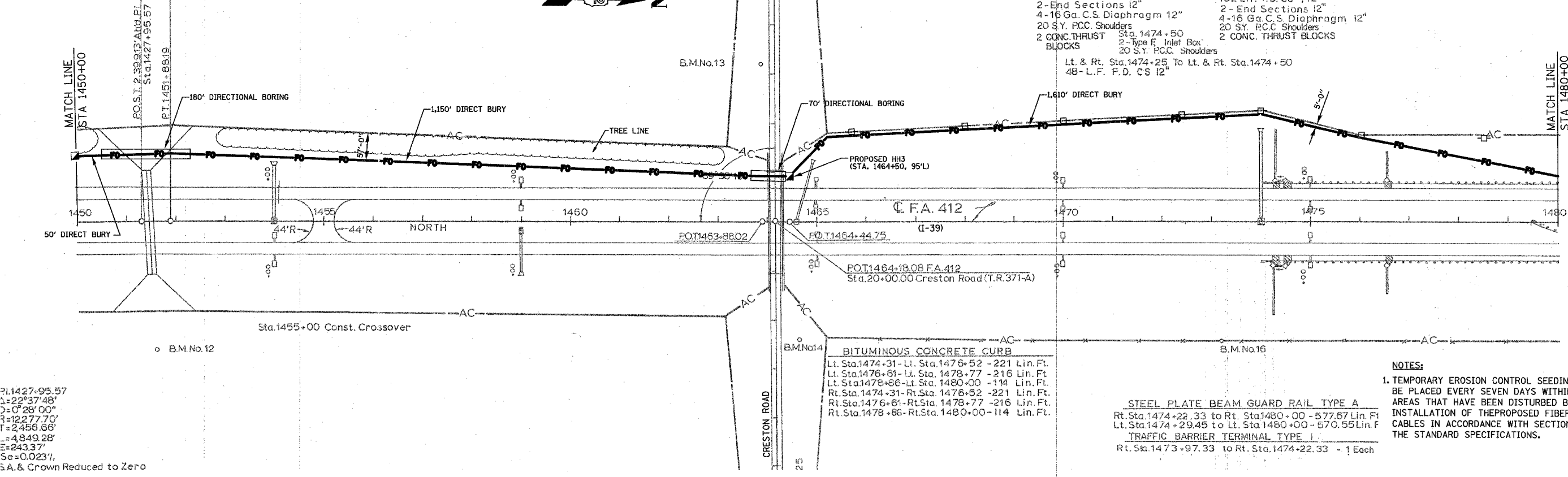

- 2 - Type H Inlet Box
- 220 - L.F. P.D. CS 12"
- 2 - End Sections 12"
- 4 - 16 Ga. C.S. Diaphragm 12"
- 20 SY. P.C.C. Shoulders
- 2 CONC. THRUST BLOCKS
- 2 - Type F Inlet Box
- 20 SY. P.C.C. Shoulders
- 2 - Type F Inlet Box
- 132 L.F. P.D. CS 12"
- 2 - End Sections 12"
- 4 - 16 Ga. C.S. Diaphragm 12"
- 20 SY. P.C.C. Shoulders
- 2 CONC. THRUST BLOCKS

Lt. & Rt. Sta. 1474+25 To Lt. & Rt. Sta. 1474+50
48 - L.F. P.D. CS 12"

BITUMINOUS CONCRETE CURB
 Lt. Sta. 1474+31 - Lt. Sta. 1476+52 - 221 Lin. Ft.
 Lt. Sta. 1476+61 - Lt. Sta. 1478+77 - 216 Lin. Ft.
 Lt. Sta. 1478+86 - Lt. Sta. 1480+00 - 114 Lin. Ft.
 Rt. Sta. 1474+31 - Rt. Sta. 1476+52 - 221 Lin. Ft.
 Rt. Sta. 1476+61 - Rt. Sta. 1478+77 - 216 Lin. Ft.
 Rt. Sta. 1478+86 - Rt. Sta. 1480+00 - 114 Lin. Ft.

STEEL PLATE BEAM GUARD RAIL TYPE A
 Rt. Sta. 1474+22.33 to Rt. Sta. 1480+00 - 577.67 Lin. Ft.
 Lt. Sta. 1474+29.45 to Lt. Sta. 1480+00 - 570.55 Lin. Ft.
TRAFFIC BARRIER TERMINAL TYPE I
 Rt. Sta. 1473+97.33 to Rt. Sta. 1474+22.33 - 1 Each

NOTES:
 1. TEMPORARY EROSION CONTROL SEEDING SHALL BE PLACED EVERY SEVEN DAYS WITHIN THOSE AREAS THAT HAVE BEEN DISTURBED BY THE INSTALLATION OF THE PROPOSED FIBER OPTIC CABLES IN ACCORDANCE WITH SECTION 280 OF THE STANDARD SPECIFICATIONS.

PLOT DATE = 12/14/2006
 FILE NAME = G:\ENR\06-6798-13\DOT\CV\SHA\SHT026.FLD\PLN_02.dgn
 USER = RUSSELL

P.I. 1427+95.57
 $\Delta = 22^\circ 37' 48''$
 $D = 0^\circ 28' 00''$
 $R = 12,277.70'$
 $T = 2,456.66'$
 $L = 4,849.28'$
 $E = 243.37'$
 $Se = 0.023\%$
 S.A. & Crown Reduced to Zero