

F.A.I. RTE.	SECTION	COUNTY	TOTAL SHEETS	SHEET NO.
39	141 / 201	•	46	12

STA. 1570+00 TO STA. 1630+00

FED. ROAD DIST. NO. ILLINOIS FED. AID PROJECT

• OGLE / WINNEBAGO

SCALE 1" = 100'

I.S.G.S. DATUM
(th G.A. 1929)

SEC. 8 T40N, R2E, 3rd. P.M.

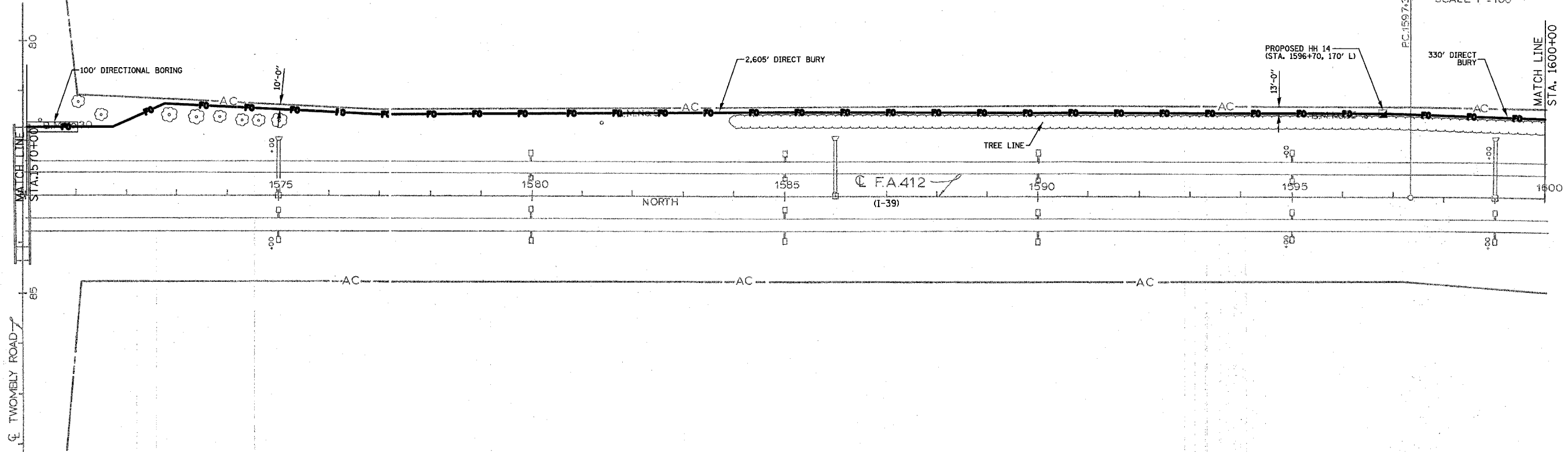

SEC. 8, T40N, R2E, 3rd. P.M.

I.S.G.S. DATUM
(th G.A. 1929)

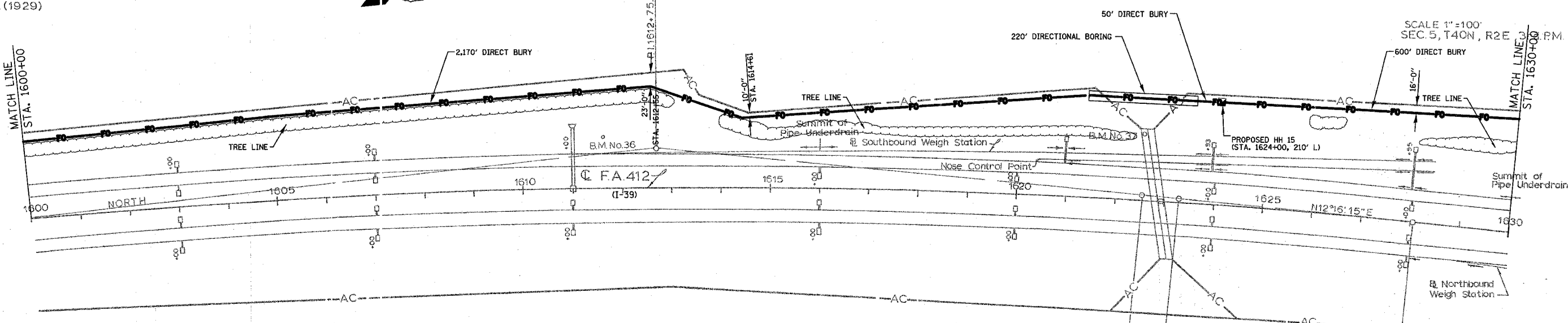

P1.1612+75.94
 $\Delta = 12^\circ 16' 15''$
 $D = 0^\circ 24' 00''$
 $R = 14,323.90'$
 $T = 1,539.74'$
 $L = 3,067.71'$
 $E = 62.52'$
 $Se = 0.020\%$
 S.A. & Crown Reduced to Zero
 Sta. 1595+76.20 to Sta. 1598+1620
 Sta. 1627+2391 to Sta. 1629+63.91

NOTES:
 1. TEMPORARY EROSION CONTROL SEEDING SHALL BE PLACED EVERY SEVEN DAYS WITHIN THOSE AREAS THAT HAVE BEEN DISTURBED BY THE INSTALLATION OF THE PROPOSED FIBER OPTIC CABLES IN ACCORDANCE WITH SECTION 280 OF THE STANDARD SPECIFICATIONS.

PLOT DATE = 12/11/2006
 FILE NAME = D:\ENGIN\0798-13\DOT\CA\SHA\SHR102.FCP\in_06.dgn
 PLOT SCALE = 1/8"=1'-0"
 USER NAME = JUSEN8