

F.A.I. RTE.	SECTION	COUNTY	TOTAL SHEETS	SHEET NO.
39	141 / 201		46	27

B.M. MONUMENT 169 RT.  
STA. 2329+98 EL. 787.82

JOHN E. & DOROTHY A. CARLSON

B.M. MONUMENT STA. 2340+00.2  
EL. 791.50

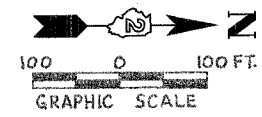

STA. 2325+00 TO STA. 13+00 (NW RAMP)  
FED. ROAD DIST. NO. ILLINOIS FED. AID PROJECT  
\*00LE / WINNEBAGO

ARVID W. SEAGREN

EMERY J. & LINDA RUTH WATSON

PIPE UNDERDRAIN, SPECIAL BY GRADING CONTRACTOR (TYPICAL DESIGNATION) VERIFY EXACT LOCATION PRIOR TO TRENCHING FOR PIPE UNDERDRAIN.

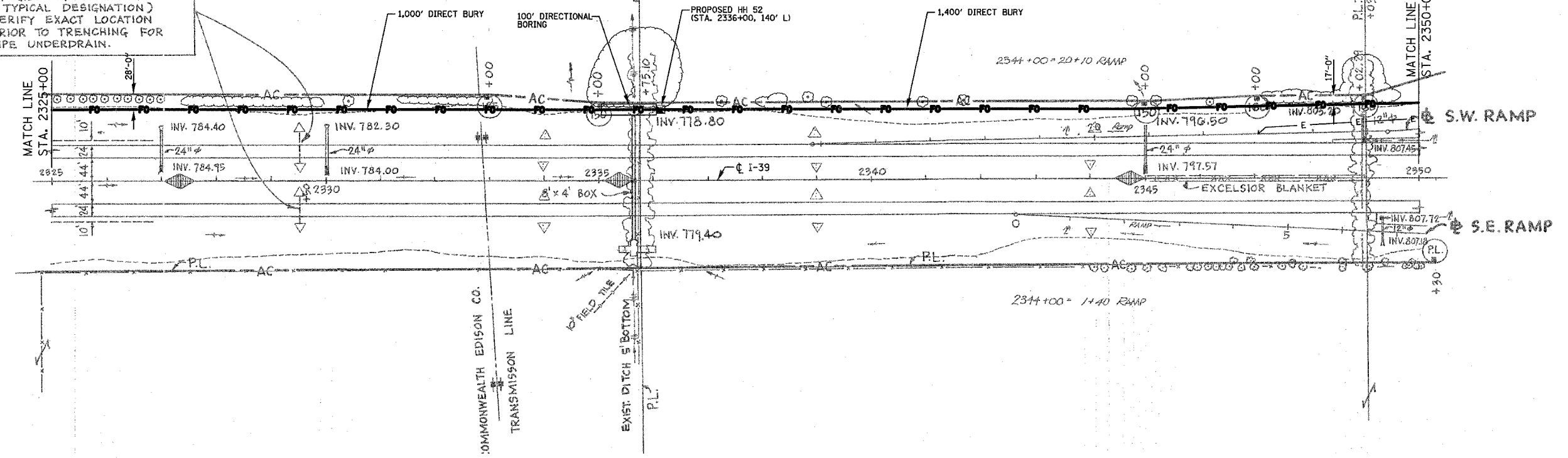

STA.	TO STA.
F. INV. A. REG. NO. 4	ILLINOIS

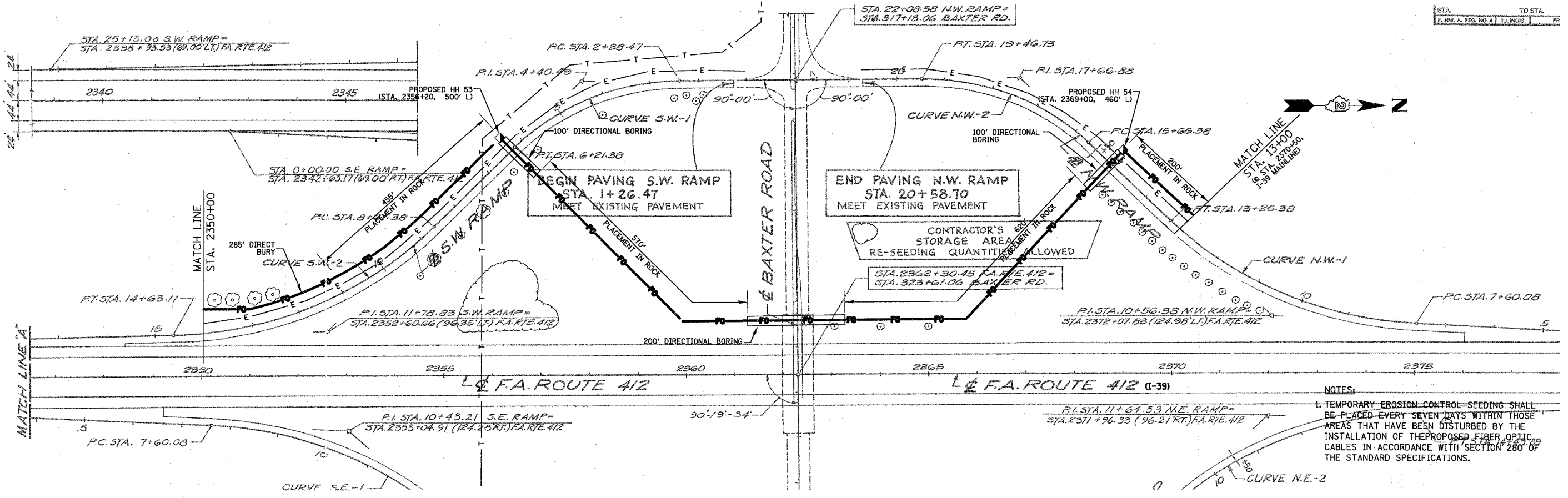

NOTES:  
1. TEMPORARY EROSION CONTROL-SEEDING SHALL BE PLACED EVERY SEVEN DAYS WITHIN THOSE AREAS THAT HAVE BEEN DISTURBED BY THE INSTALLATION OF THE PROPOSED FIBER OPTIC CABLES IN ACCORDANCE WITH SECTION 280 OF THE STANDARD SPECIFICATIONS.

DATE = 12/14/2006  
FILE NAME = 64C83-141-201-27.dwg  
PLOT SCALE = 1"=40'  
USER NAME = MUSER8