

F.A.P. RTE.	SECTION	COUNTY	TOTAL SHEETS	SHEET NO.
623		LASALLE	126	22
STA. 1034+00		TO STA. 1040+00		
FED. ROAD DIST. NO.		ILLINOIS FED. AID PROJECT		
• (34)R, DM & (X-1)RS & BR				

PLAN	SURVEYED	DATE
	PLOTTED	
	CHECKED	
	BY	
	NO. OF WAY CHECKED	
	PAID FILE NAME	

PROFILE	SURVEYED	DATE
	PLOTTED	
	CHECKED	
	BY	
	NO. OF WAY CHECKED	
	STRUCTURE NOTATIONS CHKD	

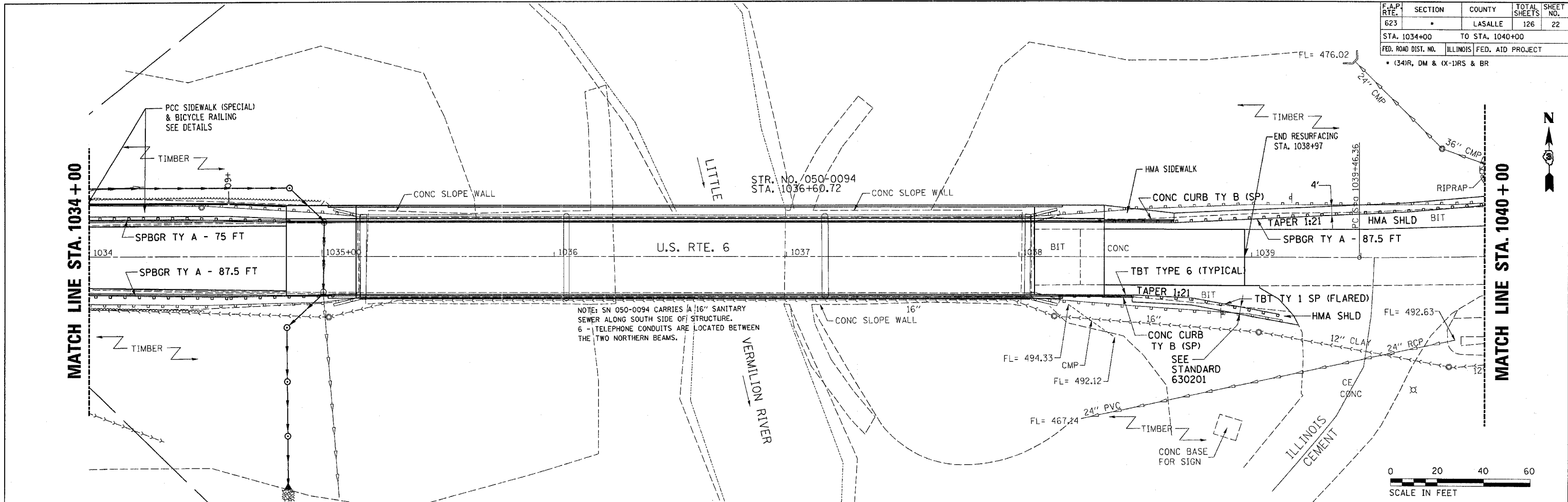

NOTE: SN 050-0094 CARRIES A 16" SANITARY SEWER ALONG SOUTH SIDE OF STRUCTURE. 6 - TELEPHONE CONDUITS ARE LOCATED BETWEEN THE TWO NORTHERN BEAMS.

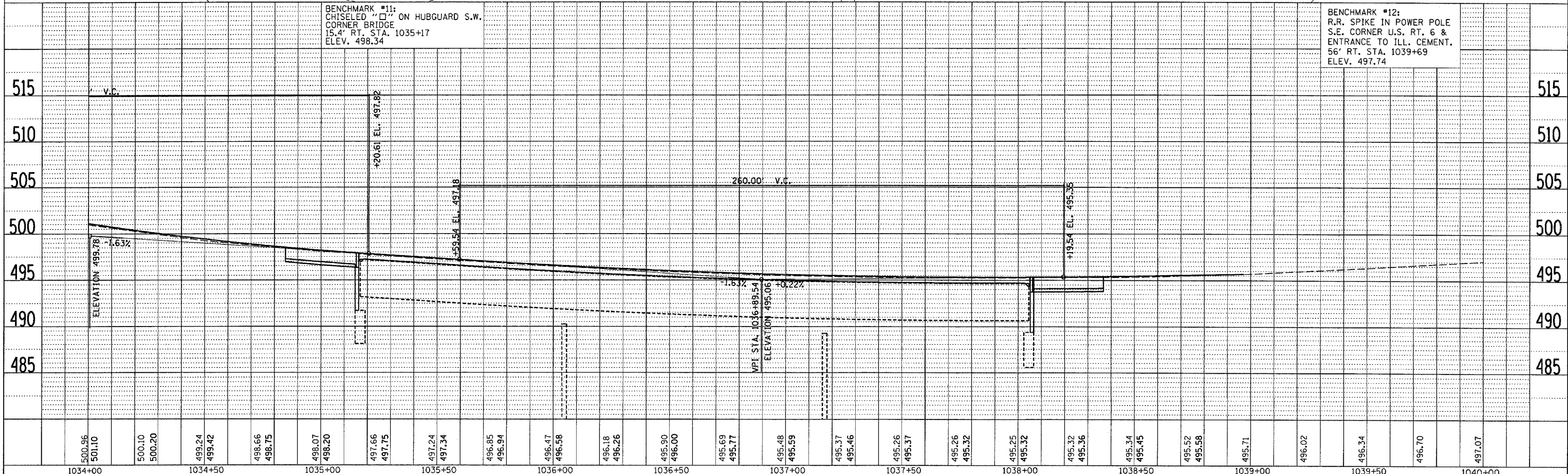

June 20, 2006  
 \ep01701\consult\p&pshts.dgn