

F.A.P. RTE.	SECTION	COUNTY	TOTAL SHEETS	SHEET NO.
623	*	LASALLE	126	38
STA.		TO STA.		
FED. ROAD DIST. NO.		ILLINOIS FED. AID PROJECT		

*(34)R,DM&(X-1)RS&BR

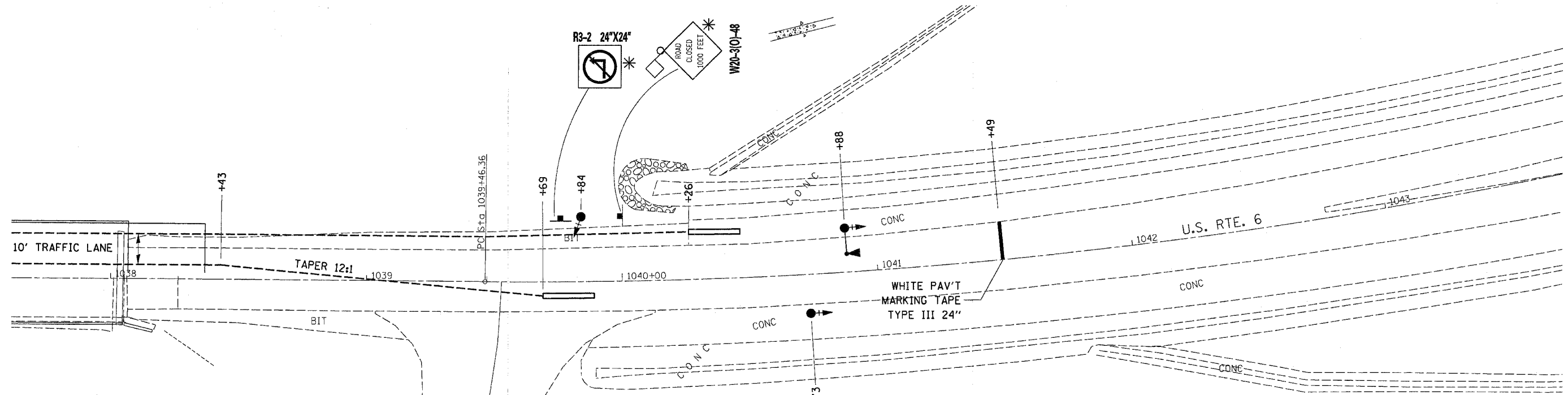
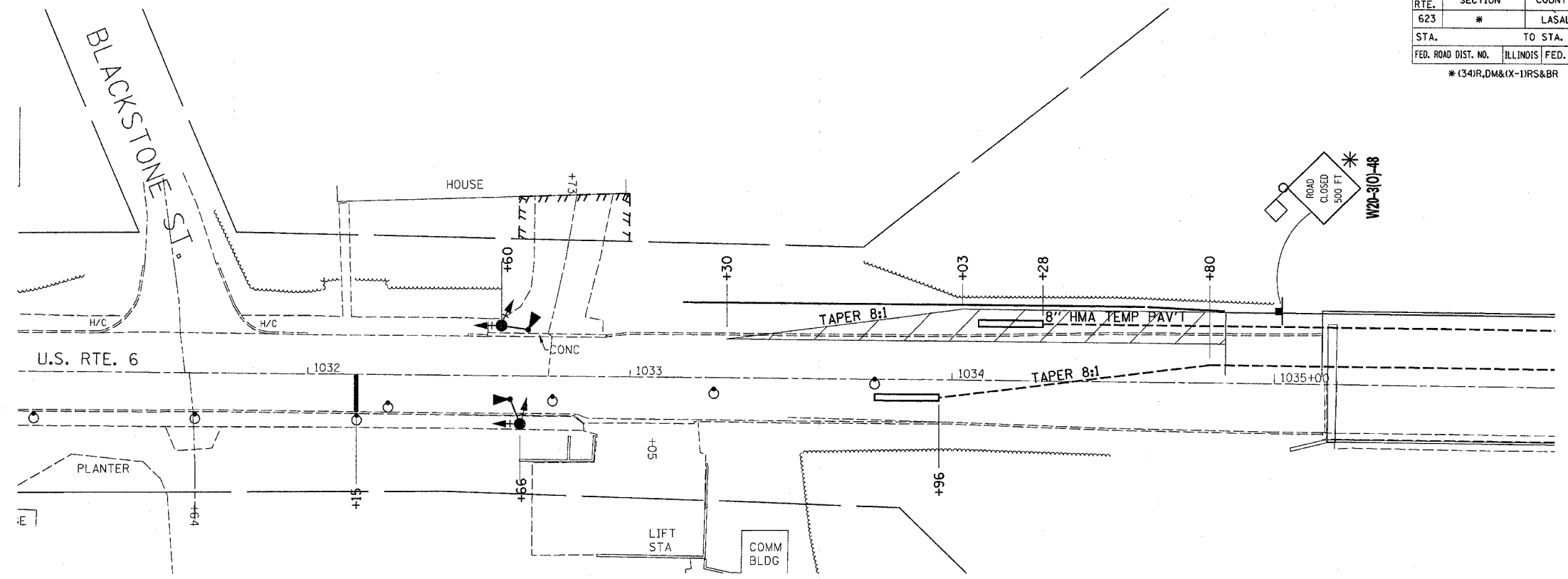

EXIST. CURVE EXCL-2
 PI STA. = 1044+91.97
 $\Delta = 31^\circ 53' 33''$ (LT)
 $D = 3^\circ 00' 02''$
 $R = 1,909.53'$
 $T = 545.61'$
 $L = 1,062.90'$
 $E = 76.42'$
 $\theta = \text{---}$
 $T.R. = \text{---}$
 $S.E. \text{ RUN} = \text{---}$

- TYPE III BARRICADE
- SIGN
- DRUM WITH STEADY BURNING LIGHT
- TRAFFIC SIGNAL WITH BACKPLATE
- MICROWAVE
- TEMPORARY CONCRETE BARRIER
- IMPACT ATTENUATOR

NOT TO SCALE
 ILLINOIS DEPARTMENT OF TRANSPORTATION
 STAGE CONSTRUCTION
 TRAFFIC CONTROL
 SN 050-0094
STAGE II