

F.A.P. RTE.	SECTION	COUNTY	TOTAL SHEETS	SHEET NO.
698	*	BUREAU	22	15
STA. 1786+00		TO STA. 15+00		
FED. ROAD DIST. NO.		ILLINOIS	FED. AID PROJECT	

* (102)RS-4 & (TX-1)17RS-2

EXIST. CURVE DIST2-3
 P.I. STA. = 868+19.24
 $\Delta = 45^\circ 02' 33''$ (LT)
 $\Delta = 859.44'$
 $\Delta = 556.37'$
 $\Delta = 675.64'$
 $\Delta = 70.85'$
 S.T.R. =
 S.E. RUN = 865+22.98
 P.C. STA. = 871+98.62
 P.T. STA. = 871+98.62

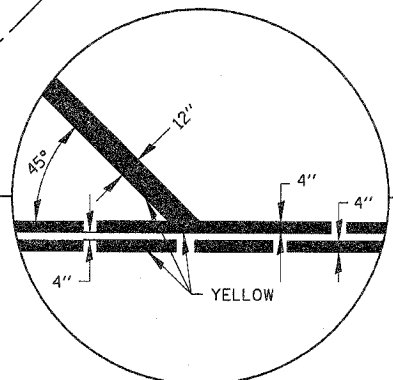
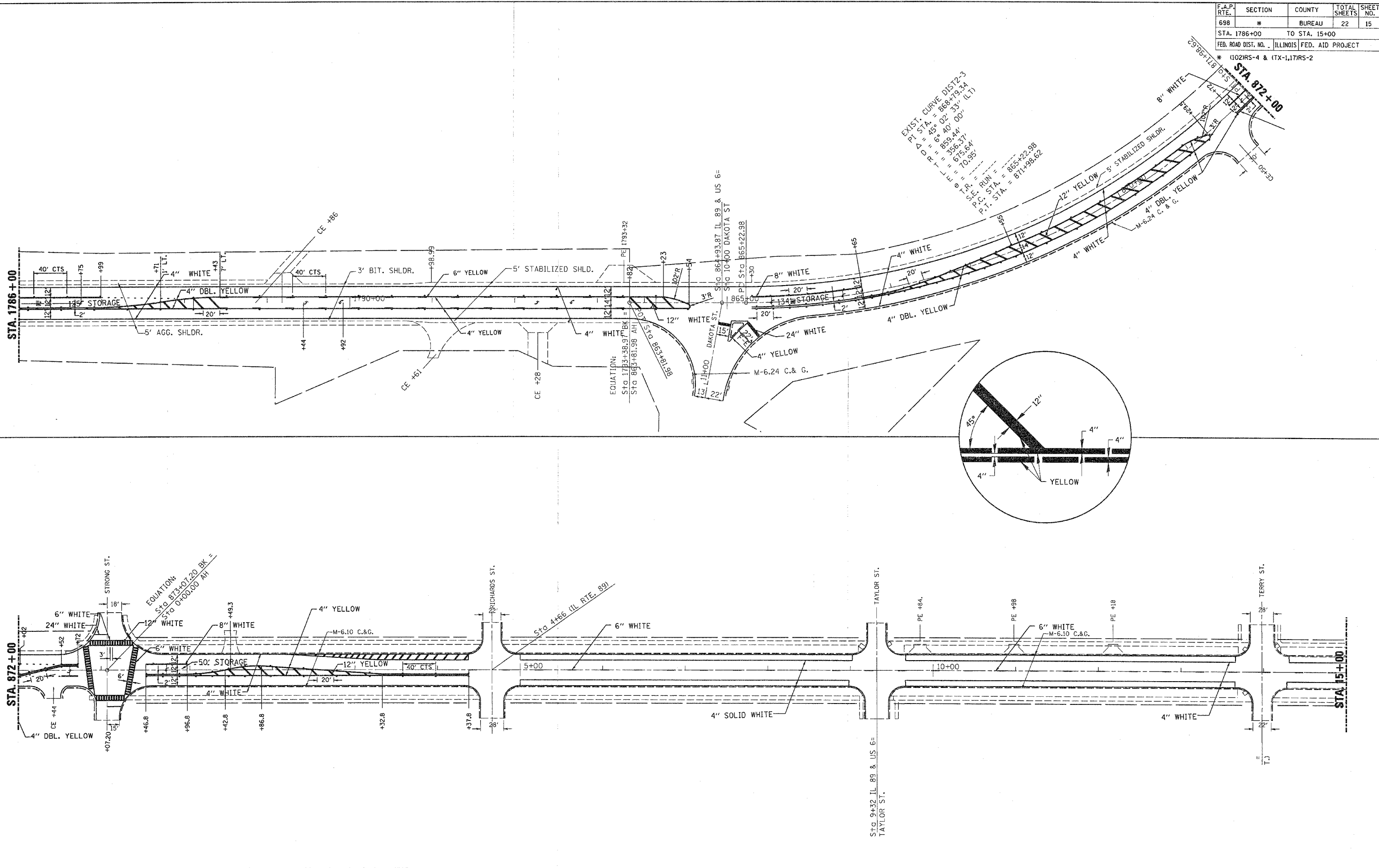

12/19/2006 9:45:36 AM
 c:\pro\jocry\ep01706\pkm\pkm.dgn