

CONTRACT NO. 66642			
F.A. RTE.	SECTION	COUNTY	TOTAL SHEETS
5605	(TX-1, 171L)	BAKEAUX LA SALLE	14
STA.		TO STA.	
FED. ROAD DIST. NO. ILLINOIS		FED. AID PROJECT	

PLAN	DATE
BY	
REVISIONS	
NO.	
DESCRIPTION	
DATE	

PROFILE	DATE
BY	
REVISIONS	
NO.	
DESCRIPTION	
DATE	

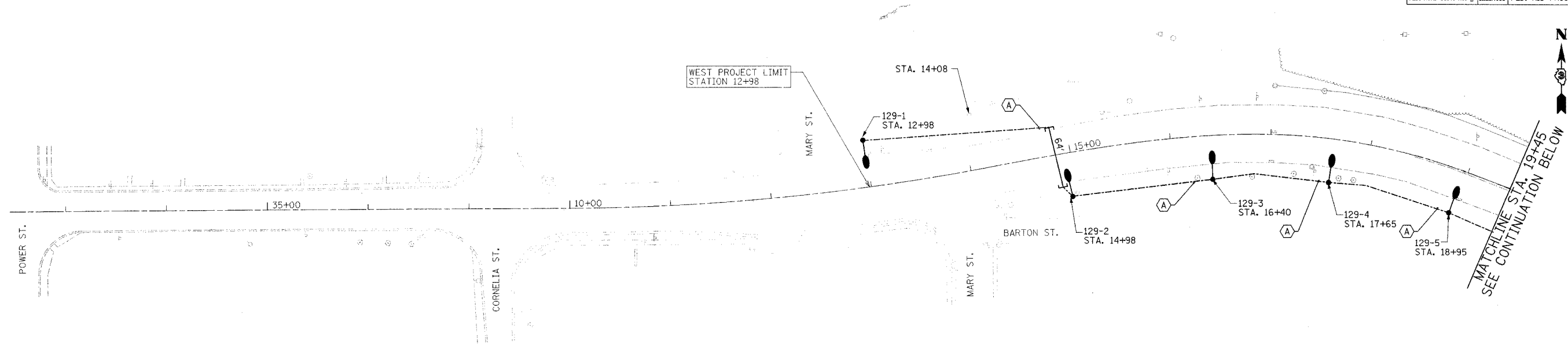

- LEGEND:**
- ☒ PROPOSED LIGHTING CONTROLLER, TYPE CB-RCS, 100 AMP, 240/480 V, 1 PH, 3-W
  - ⚡ ELECTRIC UTILITY SERVICE TRANSFORMER, 240/480 V SECONDARY
  - LIGHT POLE, ALUMINUM, 45 FT. M.H., WITH 15 FT. MAST ARM AND LUMINAIRE, SODIUM VAPOR, HORIZONTAL MOUNT, 400 WATT AT 15' OFFSET FROM EDGE OF PAVEMENT, UNLESS OTHERWISE NOTED
  - ⓐ UNIT DUCT, WITH 2-1/2 NO. 6 AND 1/2 NO. 8 GROUND, 600V (XLP-TYPE USE), 1 1/4" DIA., POLYETHYLENE
  - ⓑ UNIT DUCT, WITH 2-1/2 NO. 4 AND 1/2 NO. 6 GROUND, 600V (XLP-TYPE USE), 1 1/4" DIA., POLYETHYLENE
  - CONDUIT PUSHED, 3" DIA., GALVANIZED STEEL. LENGTH AS NOTED ON PLANS.
  - CONDUIT ATTACHED TO STRUCTURE, 3" DIA., GALVANIZED STEEL. LENGTH AS NOTED ON PLANS.

**NOTES:**

THE LOCATION OF THE LIGHT POLE MAY BE ADJUSTED TO AVOID UNDERGROUND UTILITIES. THE MINIMUM DISTANCE A POLE CAN BE FROM THE EDGE OF TRAVELLED PAVEMENT IS 12' WHEN THERE IS NO GUARDRAIL.

LIGHT POLES SHALL NOT BE INSTALLED IN THE FLOWLINE OF A DITCH.

LIGHT POLES BEHIND GUARD RAIL SHALL BE INSTALLED 5' FROM THE FACE OF THE GUARD RAIL.

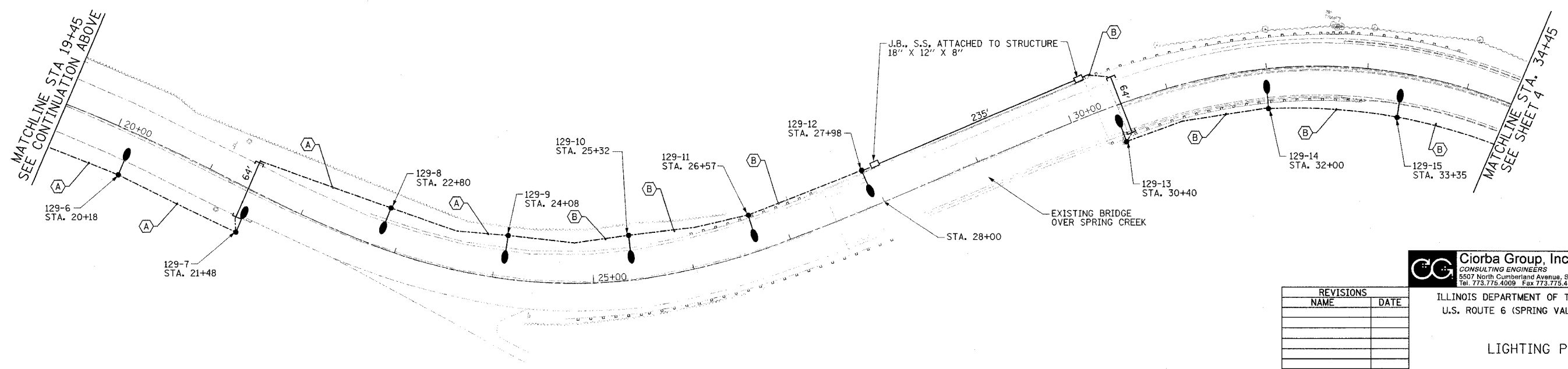
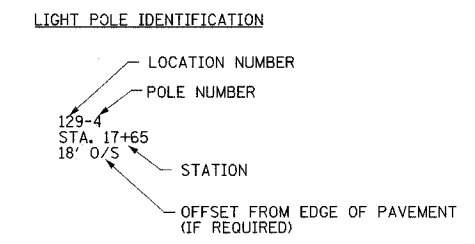

REVISIONS	
NAME	DATE

**Ciorba Group, Inc.**  
 CONSULTING ENGINEERS  
 5507 North Cumberland Avenue, Suite 402 Chicago, Illinois 60658  
 Tel. 773.775.4009 Fax 773.775.4014 Email chicago@ciorba.com

ILLINOIS DEPARTMENT OF TRANSPORTATION  
 U.S. ROUTE 6 (SPRING VALLEY) LIGHTING

**LIGHTING PLAN**

SCALE: 1"=50'  
 DATE: DEC. 2006

DRAWN BY: MLB  
 CHECKED BY: JMV

DATE: 12/19/2006  
 FILENAME: I:\proj\2006\Highway\Lighting\Proposed\plan\3445\plan34.dwg