

F.A.P. RTE.	SECTION	COUNTY	TOTAL SHEETS	SHEET NO.
313		KNOX	11	6
STA. 18+89.01		TO STA. 20+92.60		
FED. ROAD DIST. NO. 4		ILLINOIS FED. AID PROJECT		

* D4 BRIDGE REPAIR 2007-1

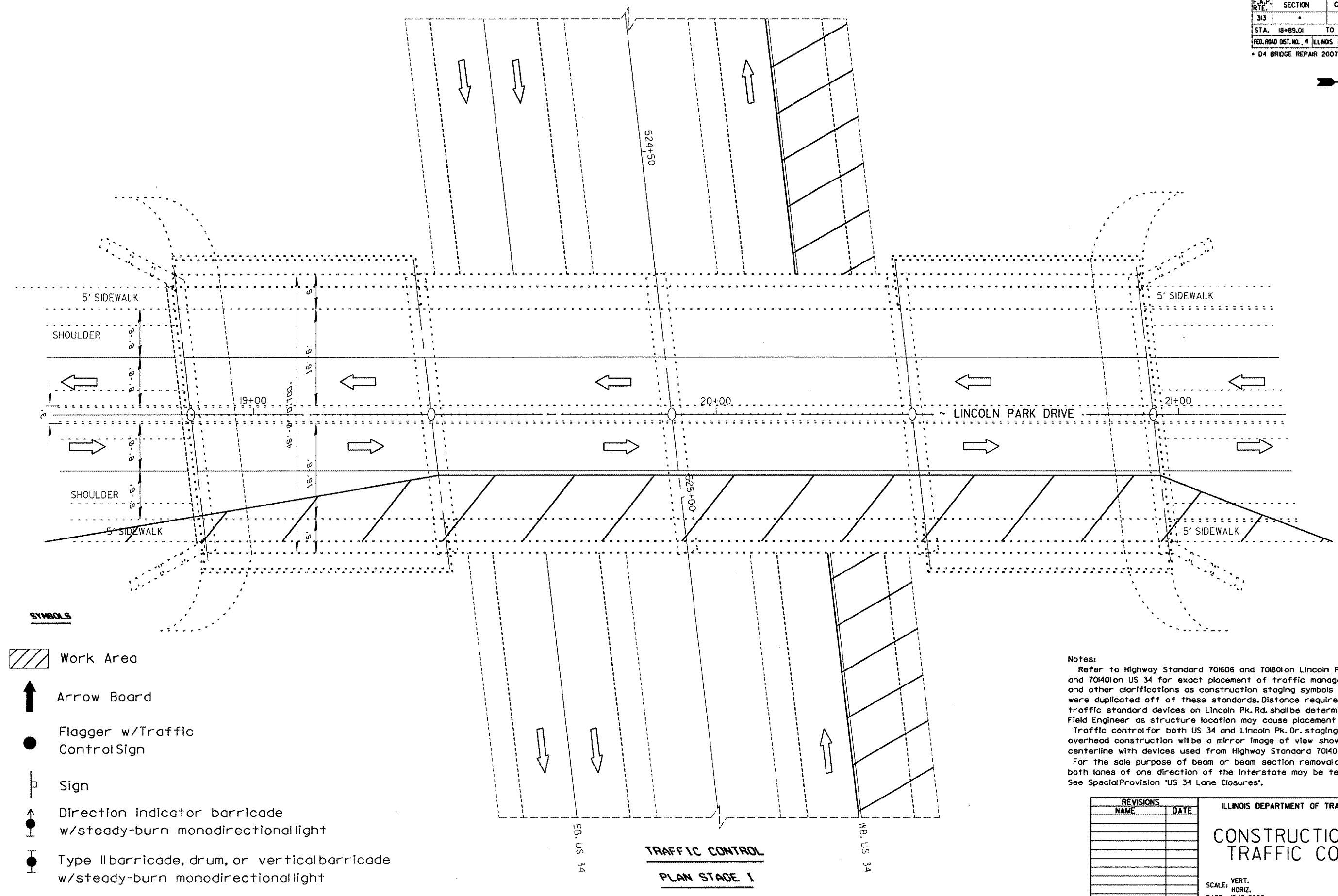

SYMBOLS

- Work Area
- Arrow Board
- Flagger w/Traffic Control Sign
- Sign
- Direction Indicator barricade w/steady-burn monodirectional light
- Type II barricade, drum, or vertical barricade w/steady-burn monodirectional light

Notes:
 Refer to Highway Standard 701606 and 701801 on Lincoln Pk. Rd. and 701401 on US 34 for exact placement of traffic management devices and other clarifications as construction staging symbols and dimensioning were duplicated off of these standards. Distance requirements for traffic standard devices on Lincoln Pk. Rd. shall be determined by the Field Engineer as structure location may cause placement limitations.
 Traffic control for both US 34 and Lincoln Pk. Dr. staging for overhead construction will be a mirror image of view shown about centerline with devices used from Highway Standard 701401.
 For the sole purpose of beam or beam section removal and replacement both lanes of one direction of the interstate may be temporarily closed. See Special Provision "US 34 Lane Closures".

REVISIONS	
NAME	DATE

ILLINOIS DEPARTMENT OF TRANSPORTATION

CONSTRUCTION AND TRAFFIC CONTROL

SCALE: VERT. _____
 HORIZ. _____
 DATE 12-15-2006

DRAWN BY CEJ
 CHECKED BY _____

PLOT DATE * DATE *
 FILE NAME * FILE *
 PLOT SCALE * SCALE *
 REFERENCE * REF *

**TRAFFIC CONTROL
 PLAN STAGE 1**

EB, US 34

WB, US 34