

F.A.P. RTE.	SECTION	COUNTY	TOTAL SHEETS	SHEET NO.
702	(113B)	WOODFORD	38	7
STA. 13+30		TO STA. 17+00		
FED. ROAD DIST. NO. 4   ILLINOIS   FED. AID PROJECT				

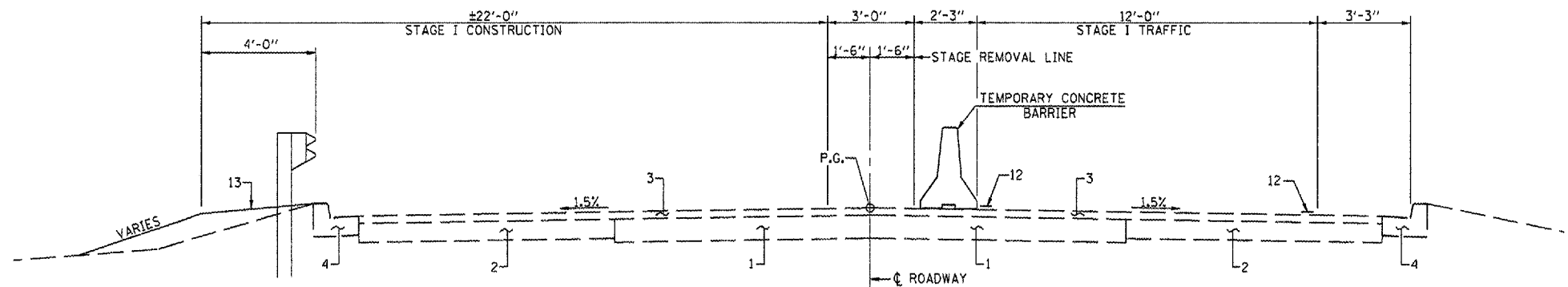

**STAGE I TRAFFIC**  
 STA. 14+82.5 TO STA. 15+04 &  
 STA. 15+86 TO STA. 16+07.5

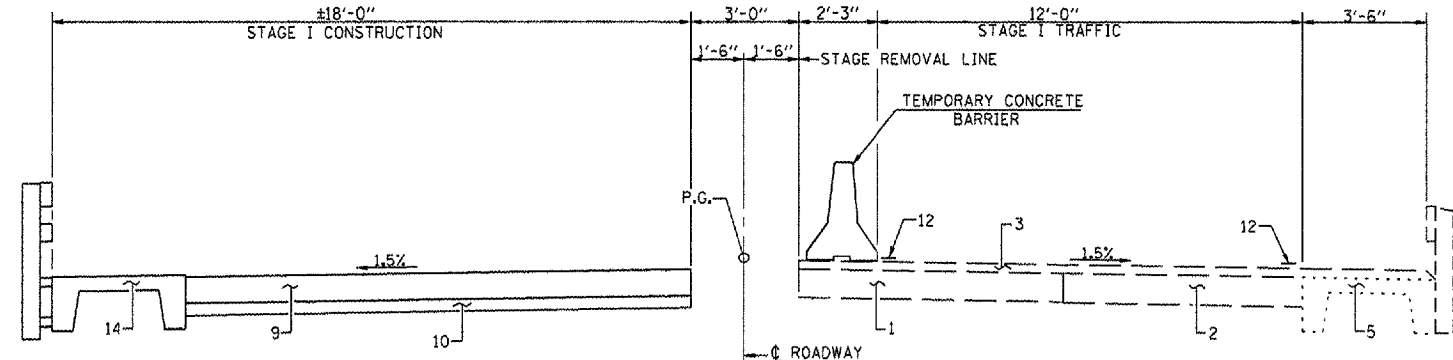

**STAGE I TRAFFIC**  
 STA. 15+04 TO STA. 15+24 &  
 STA. 15+66 TO STA. 15+86

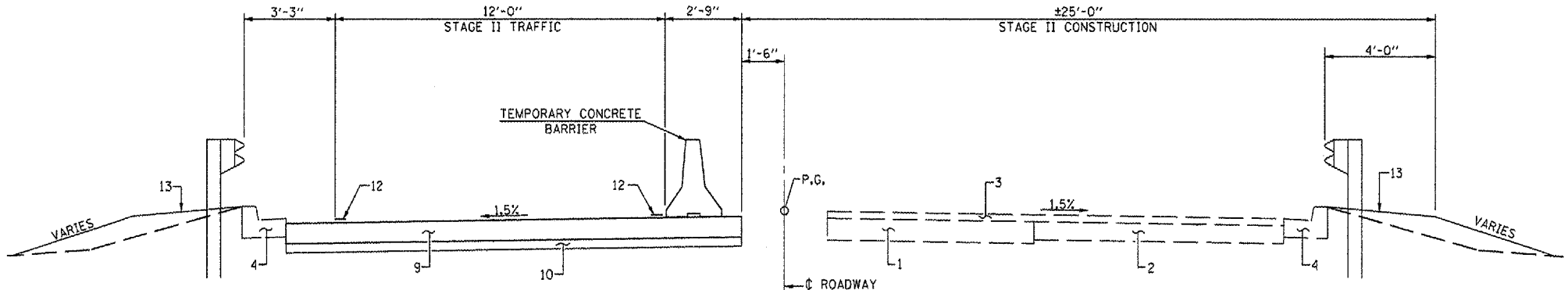

**STAGE II TRAFFIC**  
 STA. 14+82.5 TO STA. 15+04 &  
 STA. 15+86 TO STA. 16+07.5

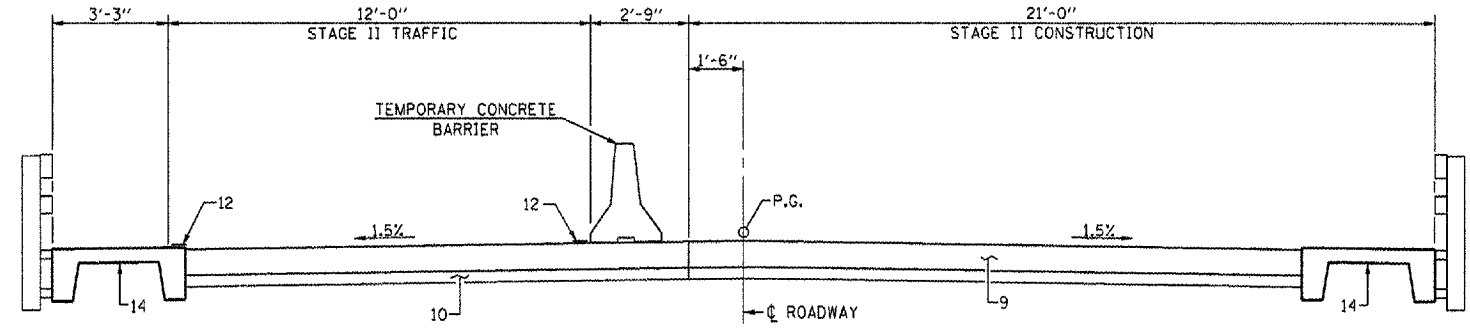

**STAGE II TRAFFIC**  
 STA. 15+04 TO STA. 15+24 &  
 STA. 15+66 TO STA. 15+86

**PAVEMENT LEGEND**

1. EXISTING P.C.C. PAVEMENT
2. EXISTING P.C.C. BASE COURSE WIDENING 8"
3. EXISTING HOT MIX ASPHALT OVERLAY
4. EXISTING TYPE B-6.12 CONCRETE CURB & GUTTER
5. EXISTING PRECAST CONCRETE BRIDGE SLAB
6. PROPOSED HOT MIX ASPHALT SURFACE REMOVAL - BUTT JOINT
7. PROPOSED LEVELING BINDER (MACHINE METHOD), N50 (MIN. 3/4")
8. PROPOSED HOT MIX ASPHALT SURFACE COURSE, MIX "C", N50 (1 1/2")
9. PROPOSED P.C.C. PAVEMENT 9"
10. PROPOSED SUB-BASE GRANULAR MATERIAL TYPE A 4"
11. PROPOSED PAINT PAVEMENT MARKING - LINE 4" (STRIPE FOR 11'-0" LANE)
12. PROPOSED TEMPORARY PAVEMENT MARKING LINE - 4"
13. PROPOSED EARTH SHOULDER
14. PROPOSED PROPOSED CONCRETE BRIDGE SLAB

NOTES: ALL TYPICAL SECTIONS LOOKING NORTH  
 WORK THIS SHEET WITH SHEETS 8 & 9 OF 38.

**STAGE CONSTRUCTION TRAFFIC DETAILS**  
 IL ROUTE 117 OVER WALNUT CREEK  
 F.A.P. RTE. 702 - SECTION (113B)  
 WOODFORD COUNTY  
 STA. 15+45.00  
 S.N. 102-0018