

F.A.I. RTE.	SECTION	COUNTY	TOTAL SHEETS	SHEET NO.
74	57-18WS-2	MCLEAN	26	1

STATE OF ILLINOIS  
DEPARTMENT OF TRANSPORTATION  
DIVISION OF HIGHWAYS

# PROPOSED HIGHWAY PLANS

F.A.I. ROUTE 74  
SECTION 57-18WS-2

MCLEAN COUNTY

C-95-084-06

D-95-084-06

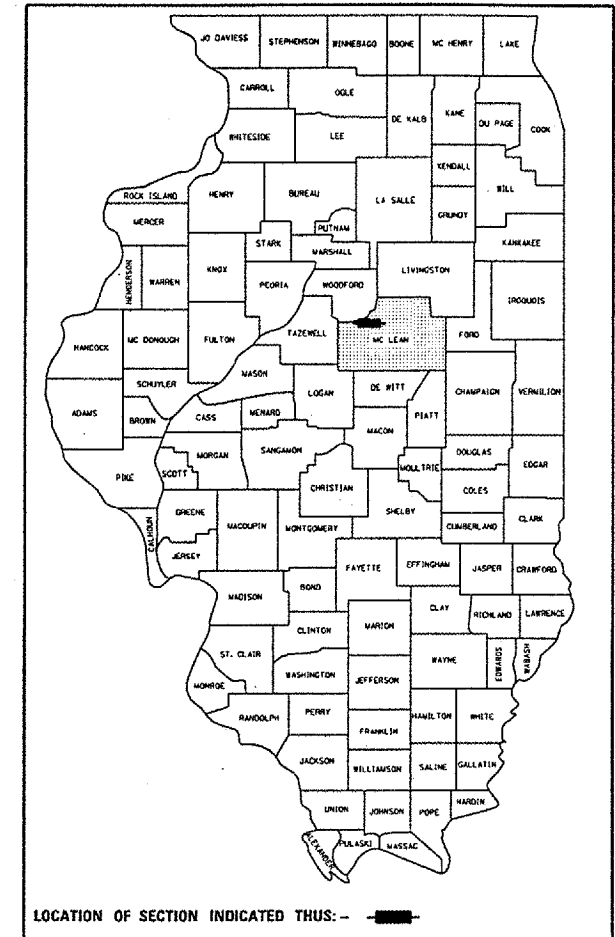

FOR INDEX OF SHEETS, SEE SHEET NO. 2  
FOR SUMMARY OF QUANTITIES, SEE SHEET NO. 4

WESTBOUND WEIGH STATION  
STA. 15+45.00 TO STA. 19+32.00

WEIGH STATION REPAIRS AT CARLOCK

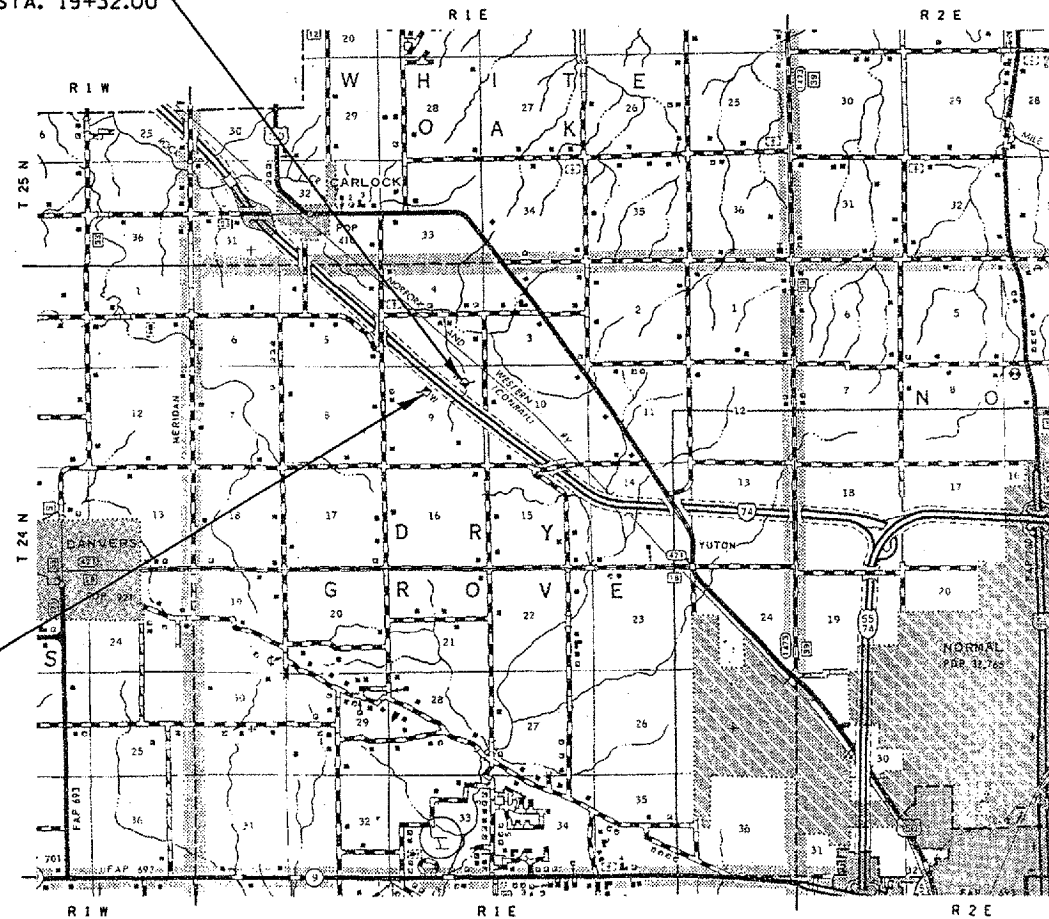

### CURRENT TRAFFIC DATA I-74 WEIGH STATION NEAR CARLOCK

CURRENT ADT	=	22,600
20 YR ADT	=	29,000
PU & PC %	=	86.6
SU %	=	2.1
MU %	=	3.9

### DESIGN DESIGNATION INTERSTATE

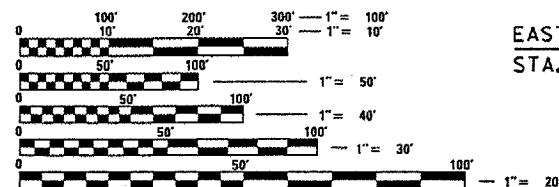

EASTBOUND WEIGH STATION  
STA. 13+05.00 TO STA. 19+45.00

FULL SIZE PLANS HAVE BEEN PREPARED USING STANDARD ENGINEERING SCALES. REDUCED SIZED PLANS WILL NOT CONFORM TO STANDARD SCALES. IN MAKING MEASUREMENTS ON REDUCED PLANS, THE ABOVE SCALES MAY BE USED.

J.U.L.I.E.  
JOINT UTILITY LOCATION INFORMATION FOR EXCAVATION  
1-800-892-0123

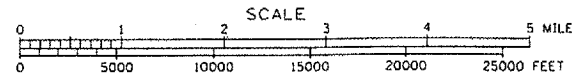

TOTAL LENGTH OF SECTION & PROJECT = 1027.000 FEET = 0.195 MILES  
NET LENGTH OF SECTION & PROJECT = 1027.000 FEET = 0.195 MILES

STATE OF ILLINOIS  
DEPARTMENT OF TRANSPORTATION  
DIVISION OF HIGHWAYS

SUBMITTED *Dec 7 2006*

*[Signature]*  
DEPUTY DIRECTOR OF HIGHWAYS, REGION THREE ENGINEER

*February 2, 2007*  
*Eric E. Harms*  
ENGINEER OF DESIGN AND ENVIRONMENT

*February 2, 2007*  
*Milton R. Sess*  
DIRECTOR OF HIGHWAYS, CHIEF ENGINEER

PRINTED BY THE AUTHORITY  
OF THE STATE OF ILLINOIS

PROJECT ENGINEER: TIM BRANDENBURG  
SQUAD LEADER: JEFF SHERER  
DESIGNER: JEFF SHERER

CONTRACT NO. 70569