

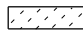



FAU ROUTE	SECTION	COUNTY	TOTAL SHEETS	SHEET NO.
8071	*	SANGAMON	559	88
STA. TO STA.		ILLINOIS FED. AID PROJECT		
184-9-41A,HBK,BY,BY-1		* 02-00382-02-PV		

LEGEND

-  SODDING SALT TOLERANT
-  MAS-18 INDICATES BORING LOCATION & NUMBER THIS SHEET * (MAS-18, MAS-22) SEE BORINGS SHEET FOR DATA
-  (A) BRIDGE APPROACH PAVEMENT BY OTHERS.
-  (XX) DRAINAGE STRUCTURE NOT CONSTRUCTED IN GRADING & STRUCTURES CONTRACT. SHOWN FOR INFORMATION ONLY.

DATE	BY
DATE	BY
DATE	BY

DATE	BY
DATE	BY
DATE	BY

DATE	BY
DATE	BY
DATE	BY

DATE	BY
DATE	BY
DATE	BY

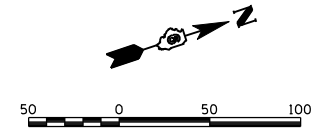
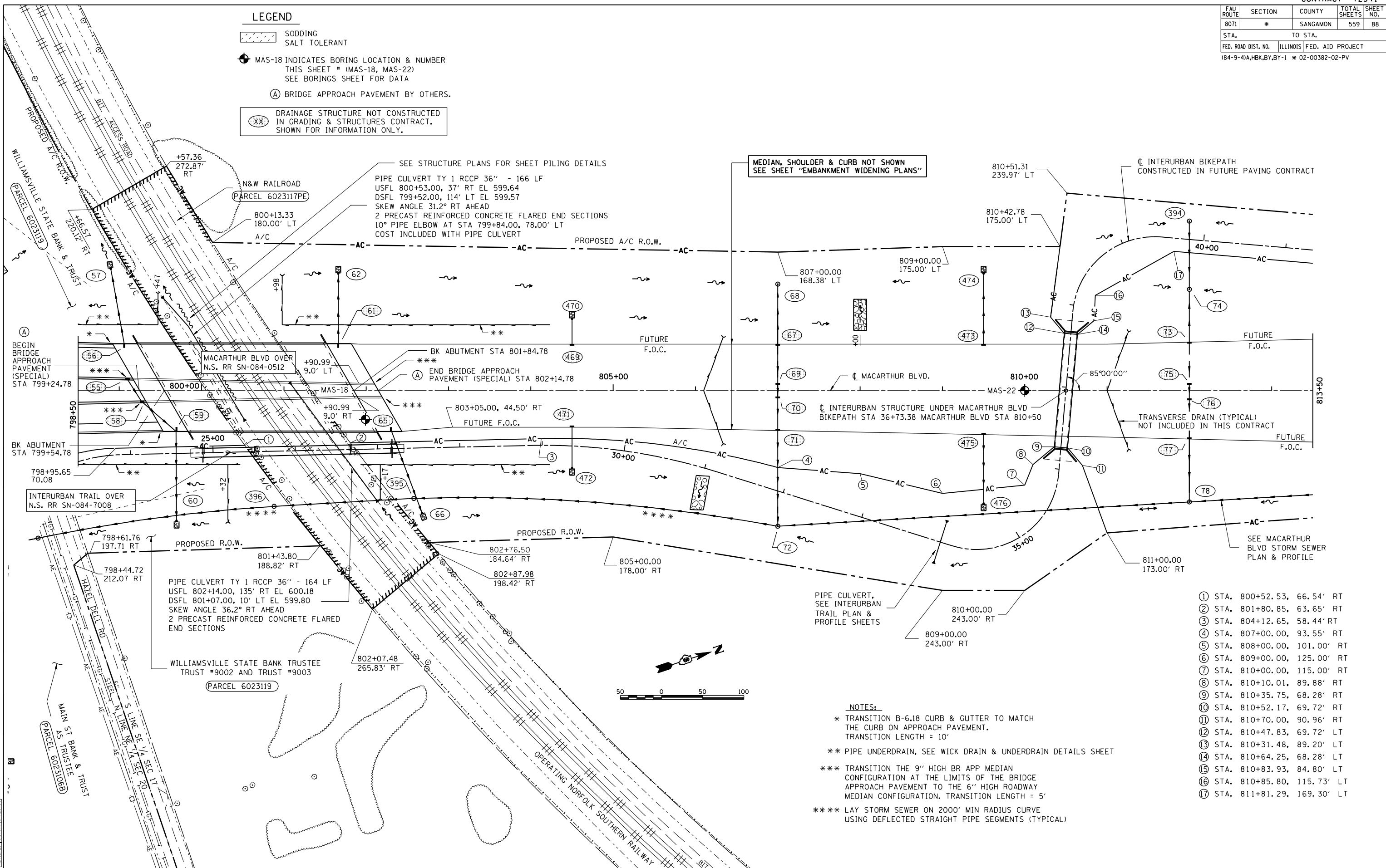

- ① STA. 800+52.53, 66.54' RT
- ② STA. 801+80.85, 63.65' RT
- ③ STA. 804+12.65, 58.44' RT
- ④ STA. 807+00.00, 93.55' RT
- ⑤ STA. 808+00.00, 101.00' RT
- ⑥ STA. 809+00.00, 125.00' RT
- ⑦ STA. 810+00.00, 115.00' RT
- ⑧ STA. 810+10.01, 89.88' RT
- ⑨ STA. 810+35.75, 68.28' RT
- ⑩ STA. 810+52.17, 69.72' RT
- ⑪ STA. 810+70.00, 90.96' RT
- ⑫ STA. 810+47.83, 69.72' LT
- ⑬ STA. 810+31.48, 89.20' LT
- ⑭ STA. 810+64.25, 68.28' LT
- ⑮ STA. 810+83.93, 84.80' LT
- ⑯ STA. 810+85.80, 115.73' LT
- ⑰ STA. 811+81.29, 169.30' LT

- NOTES:**
- * TRANSITION B-6.18 CURB & GUTTER TO MATCH THE CURB ON APPROACH PAVEMENT. TRANSITION LENGTH = 10'
 - ** PIPE UNDERDRAIN, SEE WICK DRAIN & UNDERDRAIN DETAILS SHEET
 - *** TRANSITION THE 9" HIGH BR APP MEDIAN CONFIGURATION AT THE LIMITS OF THE BRIDGE APPROACH PAVEMENT TO THE 6" HIGH ROADWAY MEDIAN CONFIGURATION. TRANSITION LENGTH = 5'
 - **** LAY STORM SEWER ON 2000' MIN RADIUS CURVE USING DEFLECTED STRAIGHT PIPE SEGMENTS (TYPICAL)