

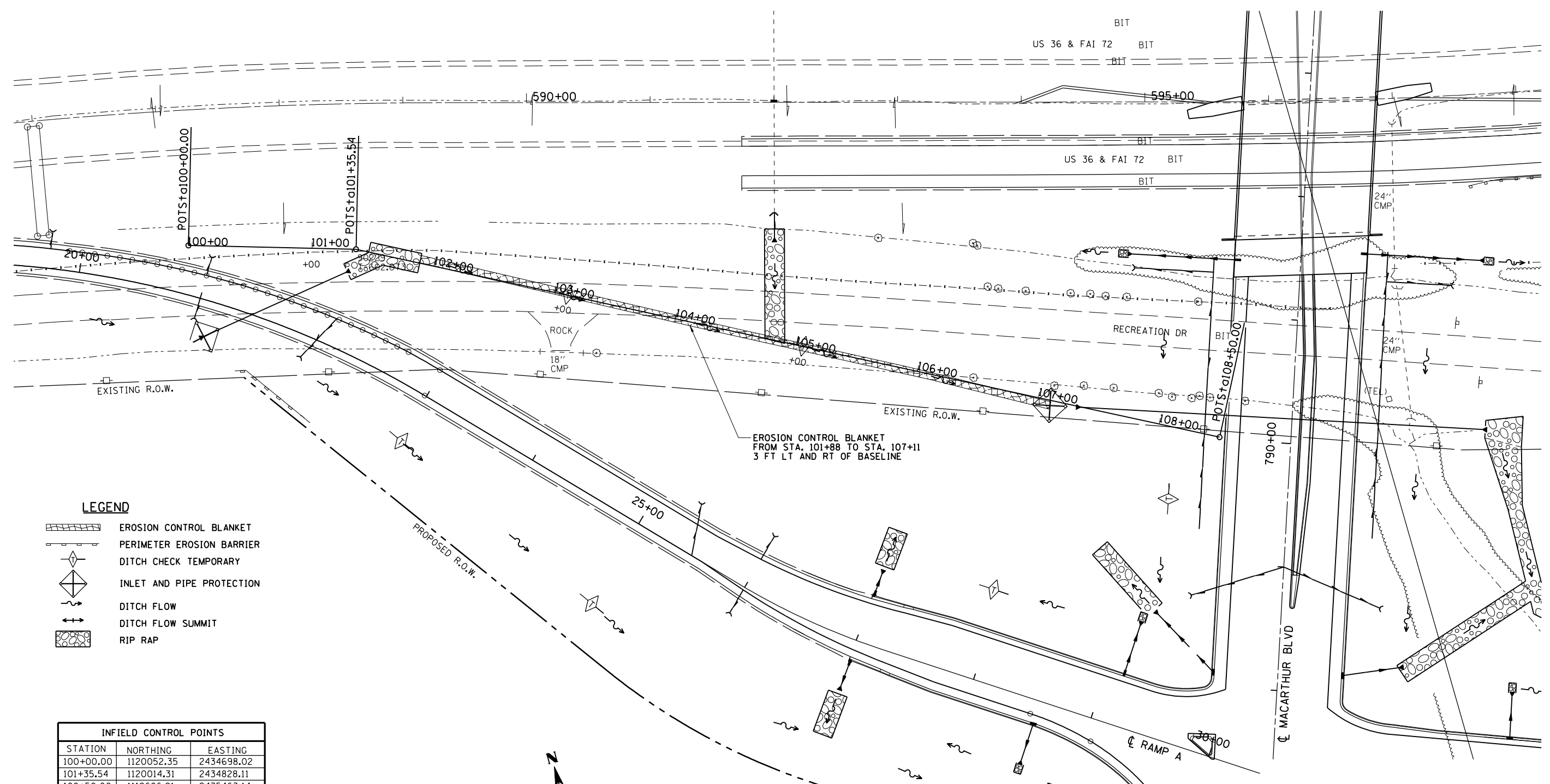





FAU ROUTE	SECTION	COUNTY	TOTAL SHEETS	SHEET NO.
8071	*	SANGAMON	559	152
STA.		TO STA.		
FED. ROAD DIST. NO.		ILLINOIS FED. AID PROJECT		
(84-9-4)A,HBK,BY,BY-1		* 02-00382-02-PV		

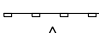
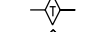

LEGEND

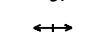
-  EROSION CONTROL BLANKET
-  PERIMETER EROSION BARRIER
-  DITCH CHECK TEMPORARY
-  INLET AND PIPE PROTECTION
-  DITCH FLOW
-  DITCH FLOW SUMMIT
-  RIP RAP

INFIELD CONTROL POINTS		
STATION	NORTHING	EASTING
100+00.00	1120052.35	2434698.02
101+35.54	1120014.31	2434828.11
108+50.00	1119686.91	2435463.14

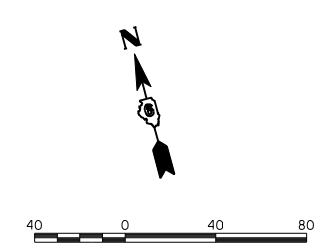

REVISIONS	
NAME	DATE

ILLINOIS DEPARTMENT OF TRANSPORTATION
EROSION CONTROL PLAN
INFIELD AREA A
 SEC NO. 02-00382-02-PV
 SEC NO. (84-9-4)A,HBK,BY,BY-1
 SANGAMON COUNTY, ILLINOIS

SCALE: VERT. _____
 HORIZ. _____
 DATE: 12/16/2006

DRAWN BY: DJP
 CHECKED BY: JWM

12/16/2006
 \$FILES
 LAYOUT: CLG 08/05/06
 DRAWN: CLG 08/05/06
 REVIEWED: JMD/JMW 08/05/06