

FAU ROUTE	SECTION	COUNTY	TOTAL SHEETS	SHEET NO.
8071	*	SANGAMON	559	170
STA.		TO STA.		
FED. ROAD DIST. NO.	ILLINOIS	FED. AID PROJECT		
(84-9-4)A,HBK,BY,BY-1 * 02-00382-02-PV				

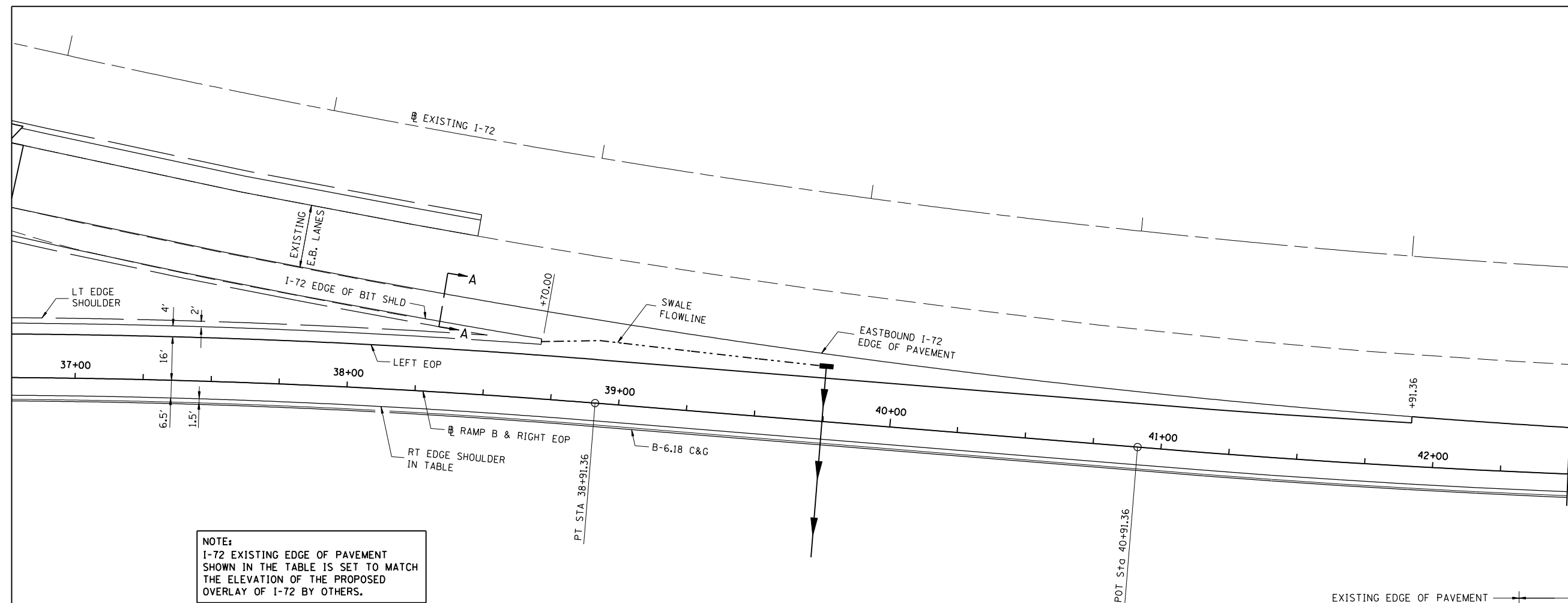

NOTE:
I-72 EXISTING EDGE OF PAVEMENT SHOWN IN THE TABLE IS SET TO MATCH THE ELEVATION OF THE PROPOSED OVERLAY OF I-72 BY OTHERS.

STATION	NORTHING	EASTING	ELEVATION AT RAMP BASELINE	I-72 EXISTING EDGE OF PAVEMENT		I-72 EDGE OF BIT SHOULDER		SWALE FLOWLINE			RAMP LT EDGE OF SHOULDER		RAMP LT EDGE OF PAVEMENT		RAMP RT EDGE SHOULDER	
				OFFSET LT	ELEV	OFFSET LT	ELEV	OFFSET LT	ELEV	WIDTH	OFFSET LT	ELEV	OFFSET LT	ELEV	OFFSET RT	ELEV
37+00.00	1,119,753.607	2,437,005.015	632.64	57.36	633.34	47.36	632.94	34.90	631.20	4.00	22.00	633.01	16.00	633.25	6.50	632.38
37+25.00	1,119,761.957	2,437,028.579	632.57	52.44	633.23	42.44	632.83	32.55	631.43	3.00	22.00	632.94	16.00	633.18	6.50	632.31
37+50.00	1,119,770.104	2,437,052.214	632.49	47.94	633.12	37.94	632.72	30.40	631.63	2.00	22.00	632.86	16.00	633.10	6.50	632.23
A 37+61.36	1,119,773.738	2,437,062.975	632.46	46.04	633.07	36.04	632.67	29.50	631.71	1.55	22.00	632.83	16.00	633.07	6.50	632.20
37+75.00	1,119,778.047	2,437,075.919	632.42	43.86	633.01	33.86	632.61	28.41	631.79	1.00	22.00	632.77	16.00	633.01	6.50	632.16
38+00.00	1,119,785.785	2,437,099.691	632.35	40.19	632.90	30.19	632.50	26.55	631.89	0.00	22.00	632.66	16.00	632.90	6.50	632.09
38+25.00	1,119,793.317	2,437,123.529	632.22	36.93	632.74	26.93	632.37	24.87	632.02	0.00	22.00	632.50	16.00	632.74	6.50	631.96
38+50.00	1,119,800.644	2,437,147.431	632.09	34.08	632.58	24.08	632.33	23.07	632.16	0.00	22.00	632.34	16.00	632.58	6.50	631.83
38+70.00	1,119,806.358	2,437,166.598	631.99	32.00	632.44			21.00	632.28			16.00	632.44	6.50	631.73	
38+75.00	1,119,807.765	2,437,171.396	631.96	31.63	632.41			21.45	632.26			16.00	632.41	6.50	631.70	
B 38+91.36	1,119,812.312	2,437,187.108	631.88	30.15	632.30			23.08	632.20			16.00	632.30	6.50	631.62	
39+00.00	1,119,814.691	2,437,195.417	631.83	29.57	632.24			22.79	632.14			16.00	632.24	6.50	631.57	
39+25.00	1,119,821.573	2,437,219.451	631.67	27.74	632.05			21.87	631.96			16.00	632.05	6.50	631.41	
39+50.00	1,119,828.455	2,437,243.485	631.49	26.09	631.84			21.05	631.76			16.00	631.84	6.50	631.23	
39+75.00	1,119,835.337	2,437,267.519	631.32	24.61	631.62			20.31	631.56			16.00	631.62	6.50	631.06	
40+00.00	1,119,842.219	2,437,291.553	631.14	23.31	631.41							16.00	631.41	6.50	630.88	
40+25.00	1,119,849.101	2,437,315.588	630.92	22.18	631.15							16.00	631.15	6.50	630.66	
40+50.00	1,119,855.983	2,437,339.622	630.68	21.22	630.88							16.00	630.88	6.50	630.42	
40+75.00	1,119,862.865	2,437,363.656	630.44	20.43	630.61							16.00	630.61	6.50	630.18	
C 40+91.36	1,119,867.368	2,437,379.382	630.29	20.00	630.43							16.00	630.43	6.50	630.03	
41+00.00	1,119,869.747	2,437,387.690	630.21	19.81	630.34							16.00	630.34	6.50	629.95	
41+25.00	1,119,876.685	2,437,411.708	629.94	19.31	630.04							16.00	630.04	6.50	629.68	
41+50.00	1,119,883.788	2,437,435.677	629.64	18.81	629.69							16.00	629.69	6.50	629.38	
41+75.00	1,119,891.055	2,437,459.598	629.33	18.31	629.35							16.00	629.35	6.50	629.07	
D 41+91.36	1,119,895.879	2,437,475.226	629.13	18.00	629.13							16.00	629.13	6.50	628.87	
42+00.00	1,119,898.485	2,437,483.468	629.05	17.81	629.01									6.50	628.79	
42+25.00	1,119,906.079	2,437,507.286	628.82	17.31	628.64									6.50	628.56	
42+50.00	1,119,913.836	2,437,531.053	628.53	16.81	628.24									6.50	628.27	

ESTIMATED EXISTING OFFSET/ELEVATION. MATCH EXISTING

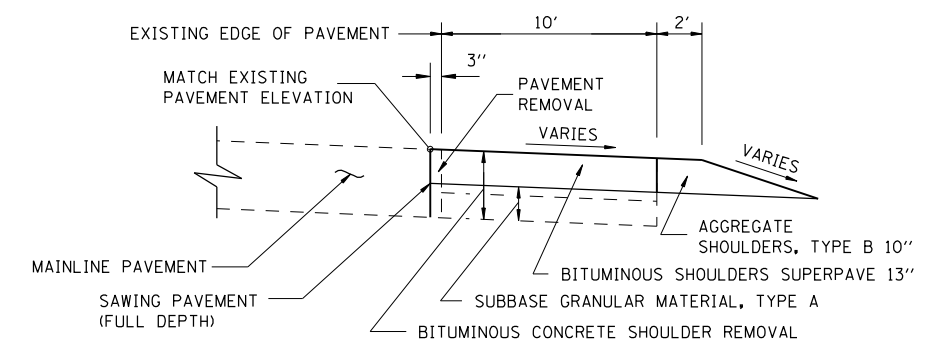

EXCEPT FOR GRADING, WORK ON THIS SHEET FOR INFORMATION ONLY NOT INCLUDED IN GRADING & STRUCTURES CONTRACT



REVISIONS	
NAME	DATE

ILLINOIS DEPARTMENT OF TRANSPORTATION
RAMP B TERMINAL DETAIL-1
FAI-72, MACARTHUR BLVD
SEC NO. 02-00382-02-PV
SEC NO. (84-9-4)A,HBK,BY,BY-1
SANGAMON COUNTY, ILLINOIS
SCALE: VERT. HORIZ. DATE 12/16/2006
DRAWN BY CLG CHECKED BY JAD



12/16/2006 \$FILES
LAYOUT CLG 04/28/06
DRAWN CLG 04/28/06
REVIEWED JAD/JM 04/28/06