

DEAD LOAD DEFLECTION DIAGRAM

(Includes weight of concrete, excluding beams).

Note: The above deflections are not to be used in the field if the engineer is working from the grade elevations adjusted for dead load deflections as shown on sheets 04 thru 07 of 24

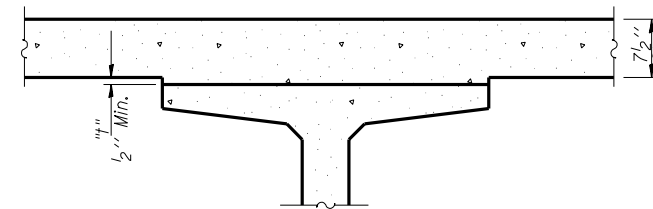

To determine "t": After all precast prestressed beams have been erected, elevations of the top flanges of the beams shall be taken at intervals on the diagrammatic plan. These elevations subtracted from the "Theoretical Grade Elevations Adjusted for Dead Load Deflections" minus slab thickness, equals the fillet heights "t" above top flanges of beams.

FILLET HEIGHTS

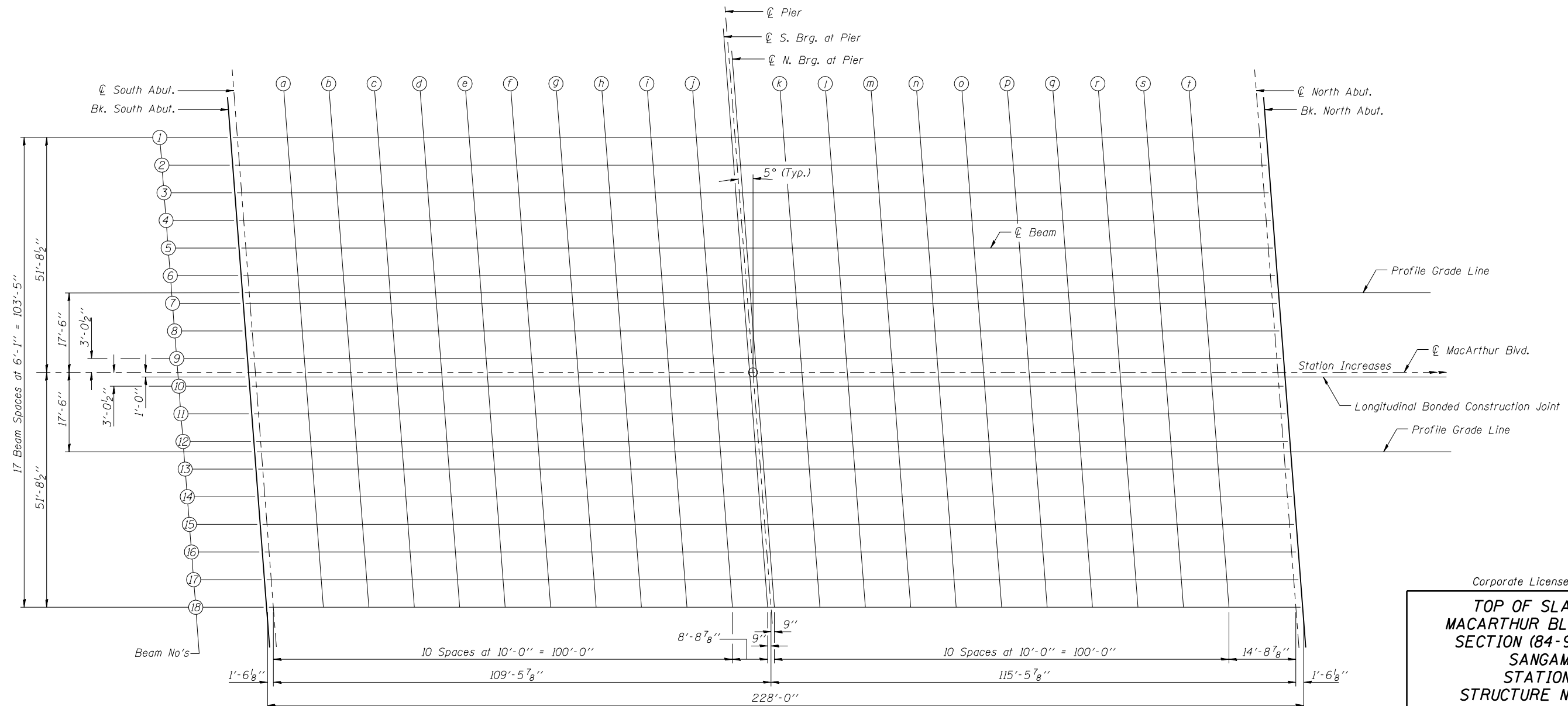

DIAGRAMMATIC PLAN

Corporate License Number 184-001-084

**TOP OF SLAB ELEVATIONS
MACARTHUR BLVD. OVER F.A.I. 72
SECTION (84-9-4)A, H.B.K., B.Y., B.Y.-1
SANGAMON COUNTY
STATION 792+77.64
STRUCTURE NUMBER 084-0513**

© Copyright Hanson Professional Services Inc. \$MS_YEAR\$



JOB# 96S2002B

DATE 02/02/05

LAYOUT	MM	10/22/04
DRAWN	DAP	01/04/05
REVIEWED	JMM	02/02/05

\$FILE\$ 12/16/2006