

F.A.P. RTE.	SECTION	COUNTY	TOTAL SHEETS	SHEET NO.
310	115(RS-3,B-2)	MORGAN	42	12
STA. 661+00.00 TO STA. 667+00.00		FED. AID PROJECT		
FED. ROAD DIST. NO.		ILLINOIS		
STATE CONTRACT NO. 72663				

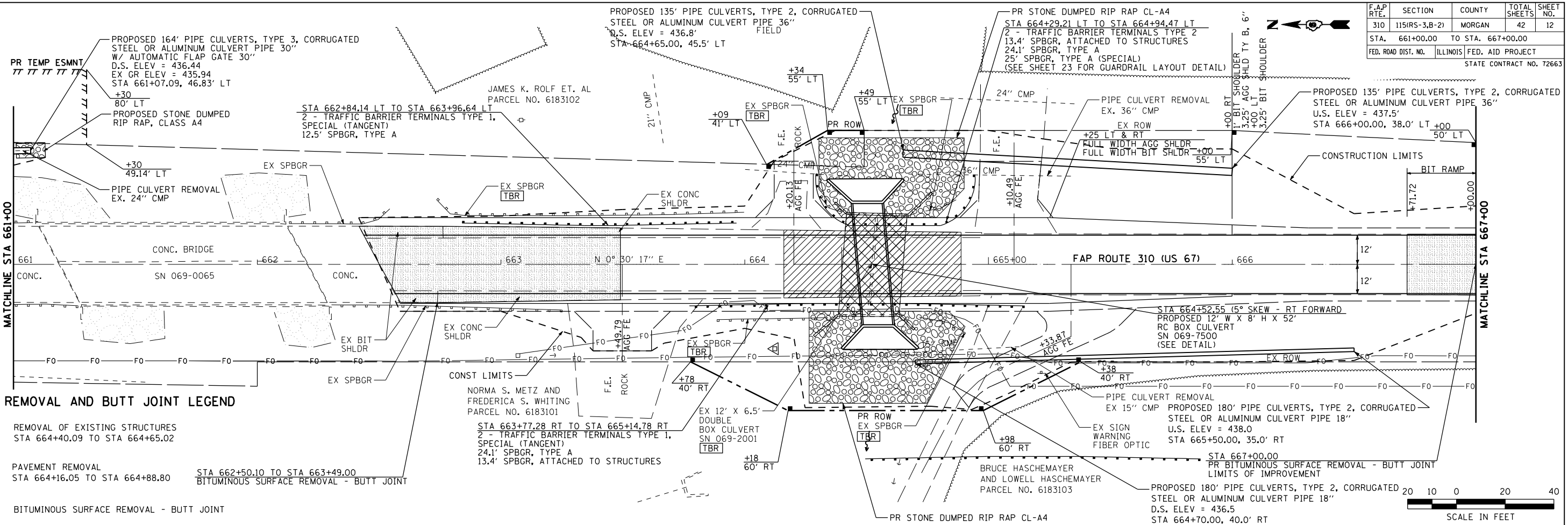

**PAVEMENT REMOVAL AND BUTT JOINT LEGEND**

	REMOVAL OF EXISTING STRUCTURES STA 664+40.09 TO STA 664+65.02
	PAVEMENT REMOVAL STA 664+16.05 TO STA 664+88.80
	BITUMINOUS SURFACE REMOVAL - BUTT JOINT STA 662+50.10 TO STA 663+49.00

PLAN	DATE
BY	
REVISIONS	
NO.	

PROFILE	DATE
BY	
REVISIONS	
NO.	

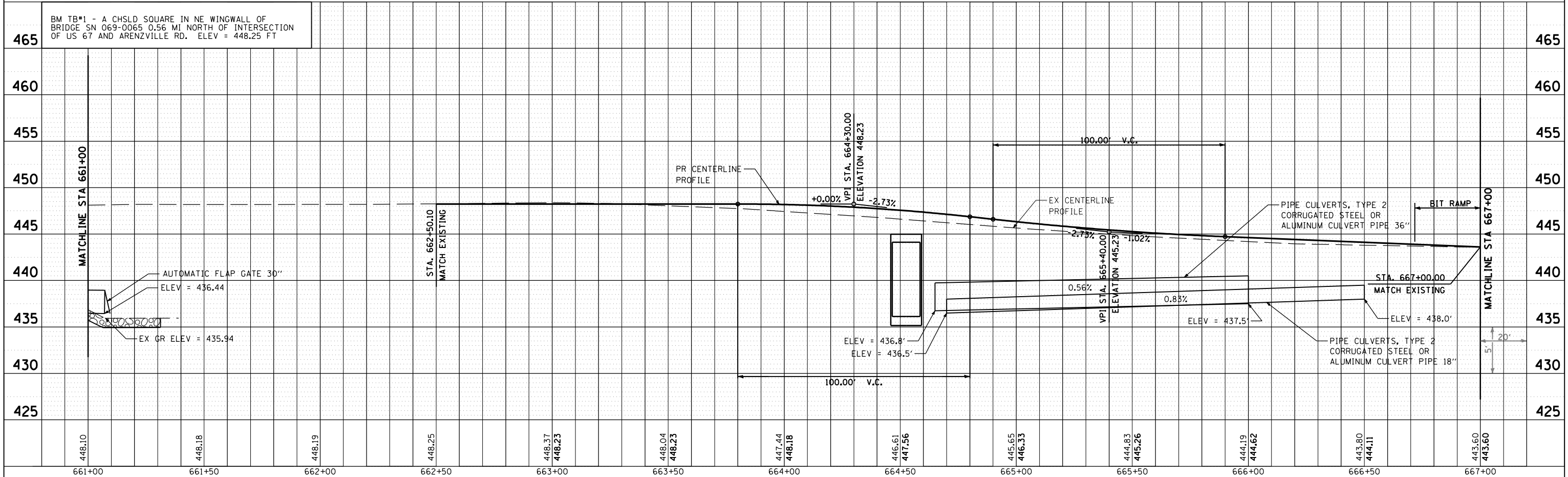

FAP ROUTE 310 (US 67) PLAN & PROFILE STA 661+00 TO 667+00