

F.A.P. RTE.	SECTION	COUNTY	TOTAL SHEETS	SHEET NO.
75	••	CHRISTIAN	97	41
STA.		TO STA.		
FED. ROAD DIST. NO.	ILLINOIS	FED. AID PROJECT		

• D 6 RESURFACING 2007

- LEGEND
- 1.THERMOPLASTIC PAVEMENT MARKING - LINE 5" (WHITE)
 - 2.THERMOPLASTIC PAVEMENT MARKING - LINE 5" (YELLOW)
 - 2b.THERMOPLASTIC PAVEMENT MARKING - LINE 5" (DOUBLE YELLOW)
 - 2b. THERMOPLASTIC PAVEMENT MARKING LINE 6" (WHITE)
 - 3.THERMOPLASTIC PAVEMENT MARKING - LINE 8" (WHITE)
 - 4.THERMOPLASTIC PAVEMENT MARKING - LINE 12" (WHITE)
 - 5.THERMOPLASTIC PAVEMENT MARKING - LINE 12" (YELLOW)
 - 6.PREFORMED PLASTIC PAVEMENT MARKING, TYPE B - LINE 5" (WHITE)
 - 7.PREFORMED PLASTIC PAVEMENT MARKING, TYPE B - LINE 6" (WHITE)
 - 8.PREFORMED PLASTIC PAVEMENT MARKING, TYPE B - LINE 24" (WHITE)
 - 9.PREFORMED PLASTIC PAVEMENT MARKING, TYPE B - LETTERS AND SYMBOLS (WHITE)
 - ◆ TWO-WAY AMBER RPM
 - ▶ ONE-WAY AMBER RPM
 - ▷ ONE-WAY CRYSTAL RPM

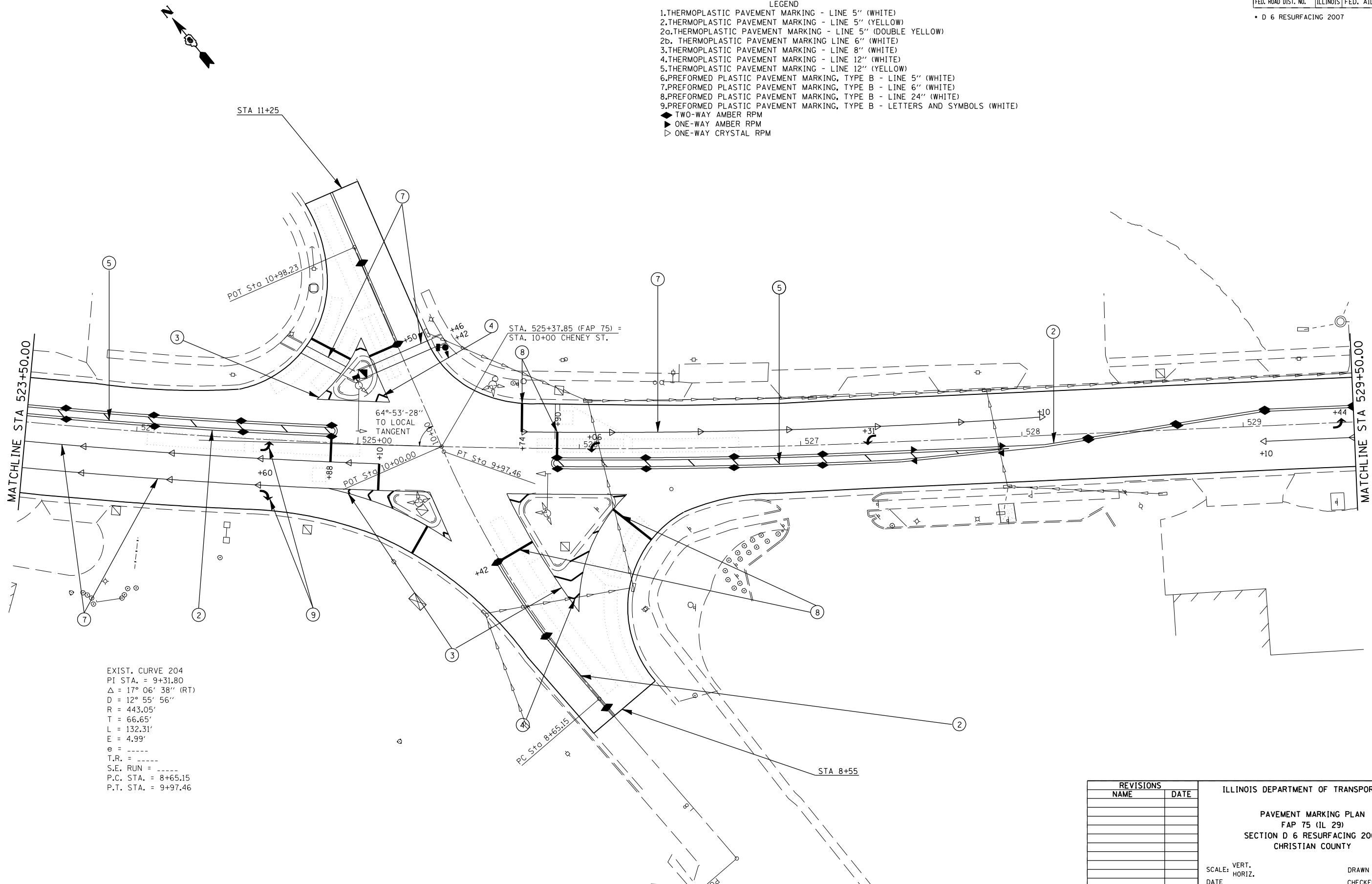

EXIST. CURVE 204
 PI STA. = 9+31.80
 $\Delta = 17^\circ 06' 38''$ (RT)
 $D = 12^\circ 55' 56''$
 $R = 443.05'$
 $T = 66.65'$
 $L = 132.31'$
 $E = 4.99'$
 $e = \text{-----}$
 $T.R. = \text{-----}$
 $S.E. \text{ RUN} = \text{-----}$
 $P.C. \text{ STA.} = 8+65.15$
 $P.T. \text{ STA.} = 9+97.46$

PLOT DATE = 12/15/2006
 FILE NAME = c:\p\projects\654683\20\mpl\an.dgn
 PLOT SCALE = 42,352% / IN.
 USER NAME = laughlin-1

REVISIONS	
NAME	DATE

ILLINOIS DEPARTMENT OF TRANSPORTATION

PAVEMENT MARKING PLAN
 FAP 75 (IL 29)
 SECTION D 6 RESURFACING 2007
 CHRISTIAN COUNTY

SCALE: VERT. _____
 HORIZ. _____
 DATE _____

DRAWN BY _____
 CHECKED BY _____