

F.A.P. RTE.	SECTION	COUNTY	TOTAL SHEETS	SHEET NO.
75	**	CHRISTIAN	97	46

STA.	TO STA.
FED. ROAD DIST. NO.	ILLINOIS FED. AID PROJECT

• D 6 RESURFACING 2007

- LEGEND
- 1.THERMOPLASTIC PAVEMENT MARKING - LINE 5" (WHITE)
 - 2.THERMOPLASTIC PAVEMENT MARKING - LINE 5" (YELLOW)
 - 2a.THERMOPLASTIC PAVEMENT MARKING - LINE 5" (DOUBLE YELLOW)
 - 2b.THERMOPLASTIC PAVEMENT MARKING - LINE 6" (WHITE)
 - 3.THERMOPLASTIC PAVEMENT MARKING - LINE 8" (WHITE)
 - 4.THERMOPLASTIC PAVEMENT MARKING - LINE 12" (WHITE)
 - 5.THERMOPLASTIC PAVEMENT MARKING - LINE 12" (YELLOW)
 - 6.PREFORMED PLASTIC PAVEMENT MARKING, TYPE B - LINE 5" (WHITE)
 - 7.PREFORMED PLASTIC PAVEMENT MARKING, TYPE B - LINE 6" (WHITE)
 - 8.PREFORMED PLASTIC PAVEMENT MARKING, TYPE B - LINE 24" (WHITE)
 - 9.PREFORMED PLASTIC PAVEMENT MARKING, TYPE B - LETTERS AND SYMBOLS (WHITE)
 - ◆ TWO-WAY AMBER RPM
 - ▲ ONE-WAY AMBER RPM
 - ▷ ONE-WAY CRYSTAL RPM

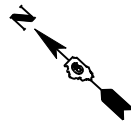

EXIST. CURVE 215
 PI STA. = 1+60.00
 $\Delta = 41^\circ 34' 55''$ (RT)
 $D = 25^\circ 51' 22''$
 $R = 221.59'$
 $T = 84.14'$
 $L = 160.82'$
 $E = 15.43'$
 $e = \text{---}$
 $T.R. = \text{---}$
 $S.E. \text{ RUN} = \text{---}$
 $P.C. \text{ STA.} = 0+75.87$
 $P.T. \text{ STA.} = 2+36.69$

EXIST. CURVE P202
 PI STA. = 558+66.06
 $\Delta = 52^\circ 06' 35''$ (RT)
 $D = 7^\circ 59' 28''$
 $R = 717.00'$
 $T = 350.55'$
 $L = 652.10'$
 $E = 81.11'$
 $e = \text{---}$
 $T.R. = \text{---}$
 $S.E. \text{ RUN} = \text{---}$
 $P.C. \text{ STA.} = 555+15.51$
 $P.T. \text{ STA.} = 561+67.61$

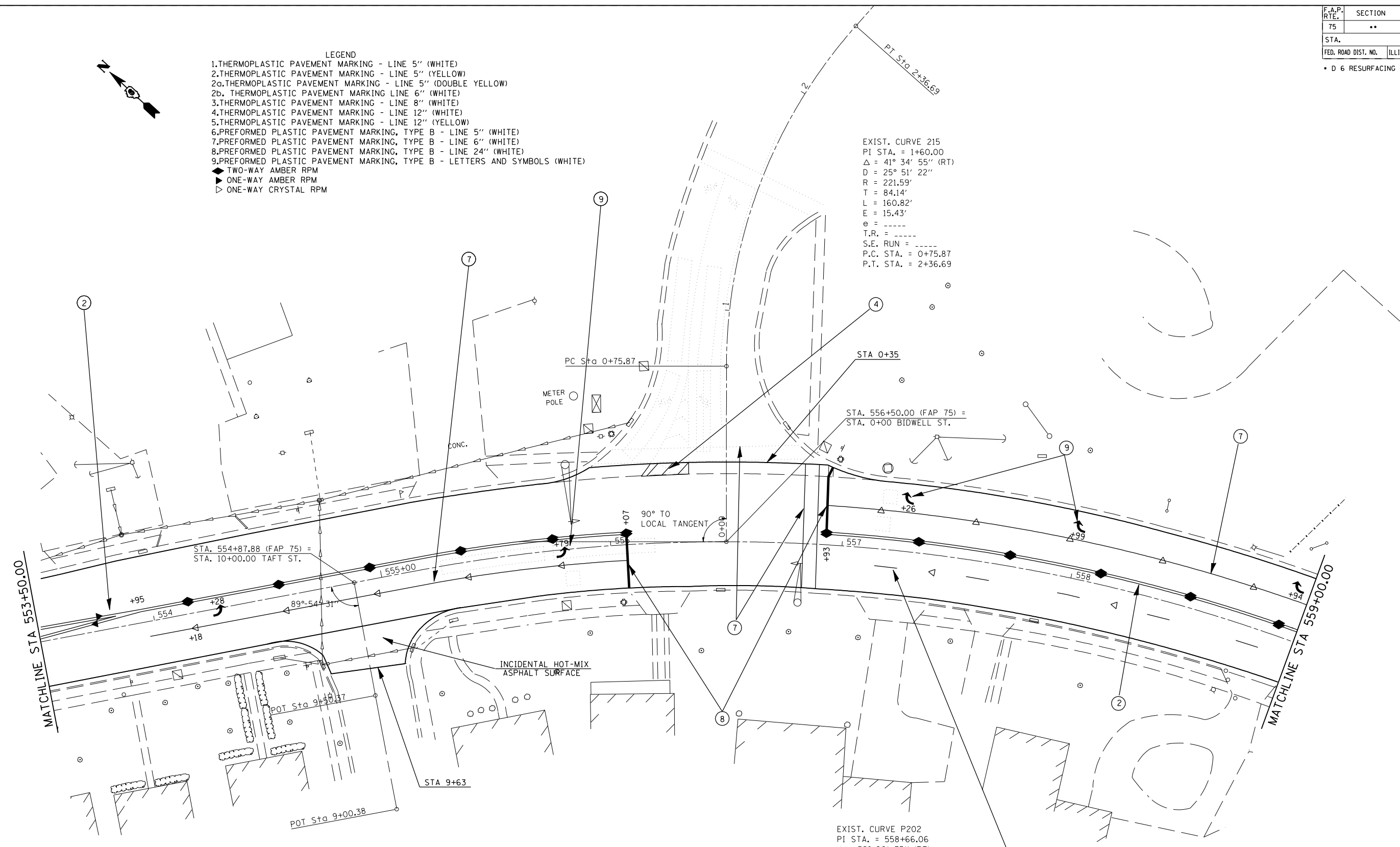

REVISIONS	
NAME	DATE

ILLINOIS DEPARTMENT OF TRANSPORTATION

PAVEMENT MARKING PLAN
 FAP 75 (IL 29)
 SECTION D 6 RESURFACING 2007
 CHRISTIAN COUNTY

SCALE: VERT. _____
 HORIZ. _____

DATE _____ DRAWN BY _____
 CHECKED BY _____

PLOT DATE = 12/15/2006
 FILE NAME = c:\p\projects\654683\20\mpl\plan.dgn
 PLOT SCALE = 42.352% / IN.
 USER NAME = laughlin-1