

F.A.P. RTE.	SECTION	COUNTY	TOTAL SHEETS	SHEET NO.
75	**	CHRISTIAN	97	50
STA.		TO STA.		
FED. ROAD DIST. NO.	ILLINOIS	FED. AID PROJECT		

• D 6 RESURFACING 2007

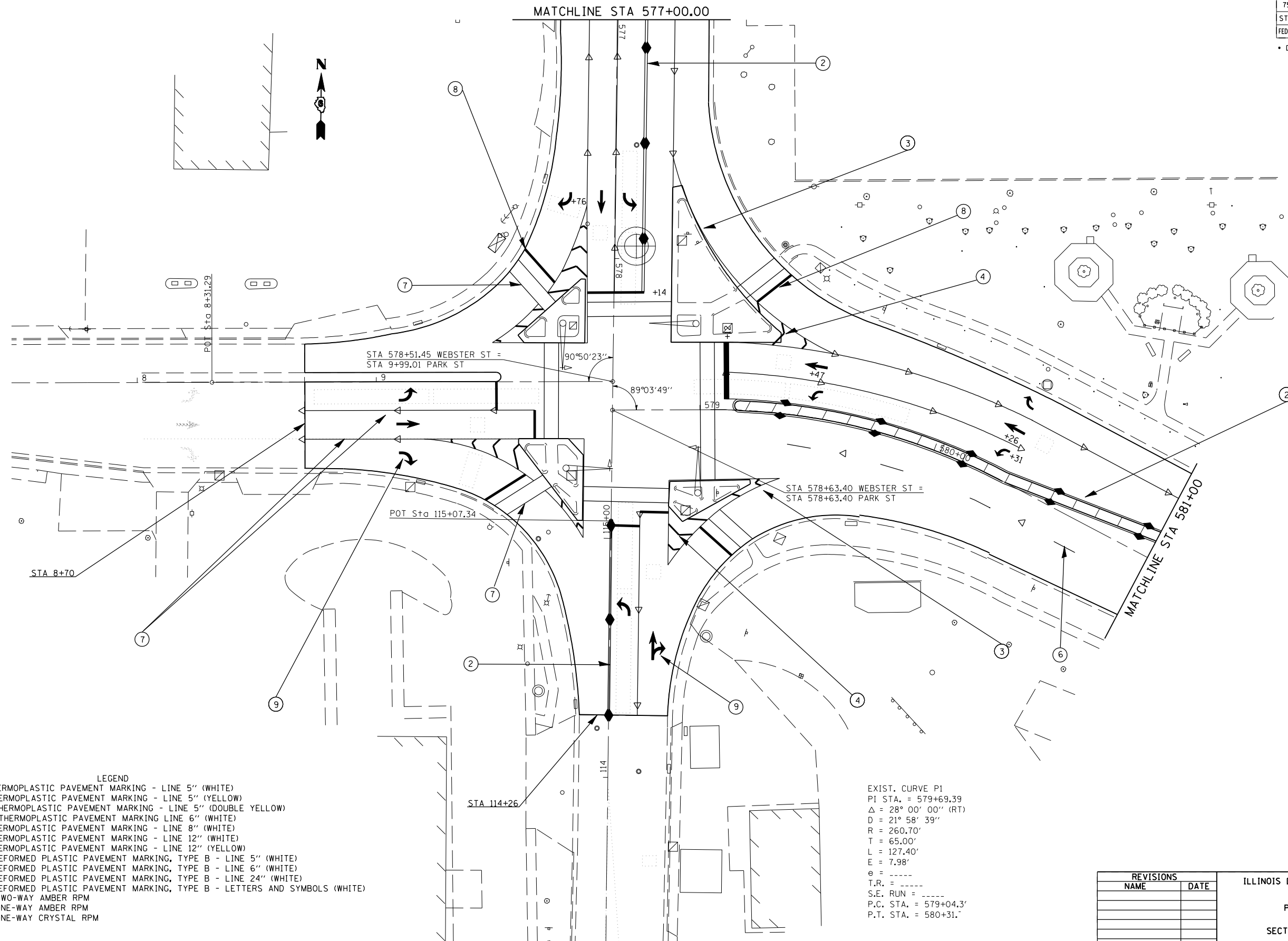

- LEGEND
- 1.THERMOPLASTIC PAVEMENT MARKING - LINE 5" (WHITE)
 - 2.THERMOPLASTIC PAVEMENT MARKING - LINE 5" (YELLOW)
 - 2a.THERMOPLASTIC PAVEMENT MARKING - LINE 5" (DOUBLE YELLOW)
 - 2b. THERMOPLASTIC PAVEMENT MARKING LINE 6" (WHITE)
 - 3.THERMOPLASTIC PAVEMENT MARKING - LINE 8" (WHITE)
 - 4.THERMOPLASTIC PAVEMENT MARKING - LINE 12" (WHITE)
 - 5.THERMOPLASTIC PAVEMENT MARKING - LINE 12" (YELLOW)
 - 6.PREFORMED PLASTIC PAVEMENT MARKING, TYPE B - LINE 5" (WHITE)
 - 7.PREFORMED PLASTIC PAVEMENT MARKING, TYPE B - LINE 6" (WHITE)
 - 8.PREFORMED PLASTIC PAVEMENT MARKING, TYPE B - LINE 24" (WHITE)
 - 9.PREFORMED PLASTIC PAVEMENT MARKING, TYPE B - LETTERS AND SYMBOLS (WHITE)
 - ◆ TWO-WAY AMBER RPM
 - ▲ ONE-WAY AMBER RPM
 - ▽ ONE-WAY CRYSTAL RPM

EXIST. CURVE P1
 PI STA. = 579+69.39
 $\Delta = 28^\circ 00' 00''$ (RT)
 $D = 21^\circ 58' 39''$
 $R = 260.70'$
 $T = 65.00'$
 $L = 127.40'$
 $E = 7.98'$
 $e =$ -----
 $T.R. =$ -----
 $S.E. RUN =$ -----
 $P.C. STA. = 579+04.3'$
 $P.T. STA. = 580+31.'$

REVISIONS	
NAME	DATE

ILLINOIS DEPARTMENT OF TRANSPORTATION

PAVEMENT MARKING PLAN
 FAP 75 (IL 29)
 SECTION D 6 RESURFACING 2007
 CHRISTIAN COUNTY

SCALE: VERT. _____
 HORIZ. _____

DATE _____

DRAWN BY _____
 CHECKED BY _____

PLOT DATE = 12/15/2006
 FILE NAME = c:\p\projects\654683\20\pmp\plan.dgn
 PLOT SCALE = 4.23524 / IN.
 USER NAME = laughlin-1