

F.A.P. RTE.	SECTION	COUNTY	TOTAL SHEETS	SHEET NO.
75	.	CHRISTIAN	97	87
STA.		TO STA.		
FED. ROAD DIST. NO.	ILLINOIS	FED. AID PROJECT		

• D 6 RESURFACING 2007

TRAFFIC SIGNAL QUANTITIES

LOCATION: IL 29 & BIDWELL

QUANTITY	UNIT	ITEM
350.0	FOOT	DETECTOR LOOP, TYPE I

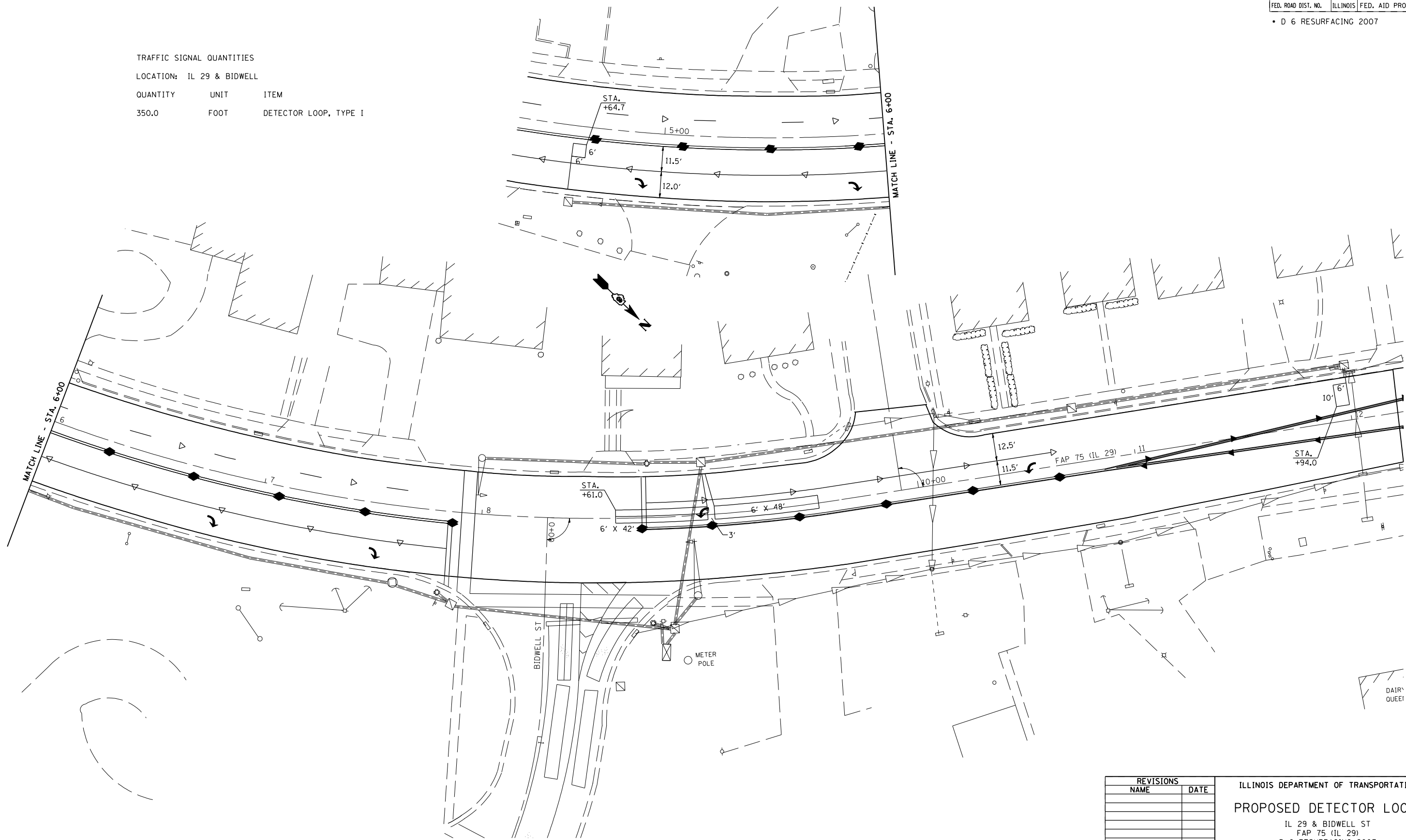

REVISIONS		NAME	DATE
NO.	DESCRIPTION		

ILLINOIS DEPARTMENT OF TRANSPORTATION			
PROPOSED DETECTOR LOOPS			
IL 29 & BIDWELL ST			
FAP 75 (IL 29)			
D 6 RESURFACING 2007			
CHRISTIAN COUNTY			
SCALE: VERT. 1" = 20'	DRAWN BY: KDA		CHECKED BY:
HORIZ. 1" = 20'	DATE: APR '06		

PLOT DATE = 12/15/2006
 PLOT SCALE = 42.3528 / IN