

F.A.P. RTE.	SECTION	COUNTY	TOTAL SHEETS	SHEET NO.
75	.	CHRISTIAN	97	90
STA.		TO STA.		
FED. ROAD DIST. NO.	ILLINOIS	FED. AID PROJECT		
• D 6 RESURFACING 2007				

TRAFFIC SIGNAL QUANTITIES

LOCATION: IL 29 & WALNUT

QUANTITY	UNIT	ITEM
514.0	FOOT	DETECTOR LOOP, TYPE I

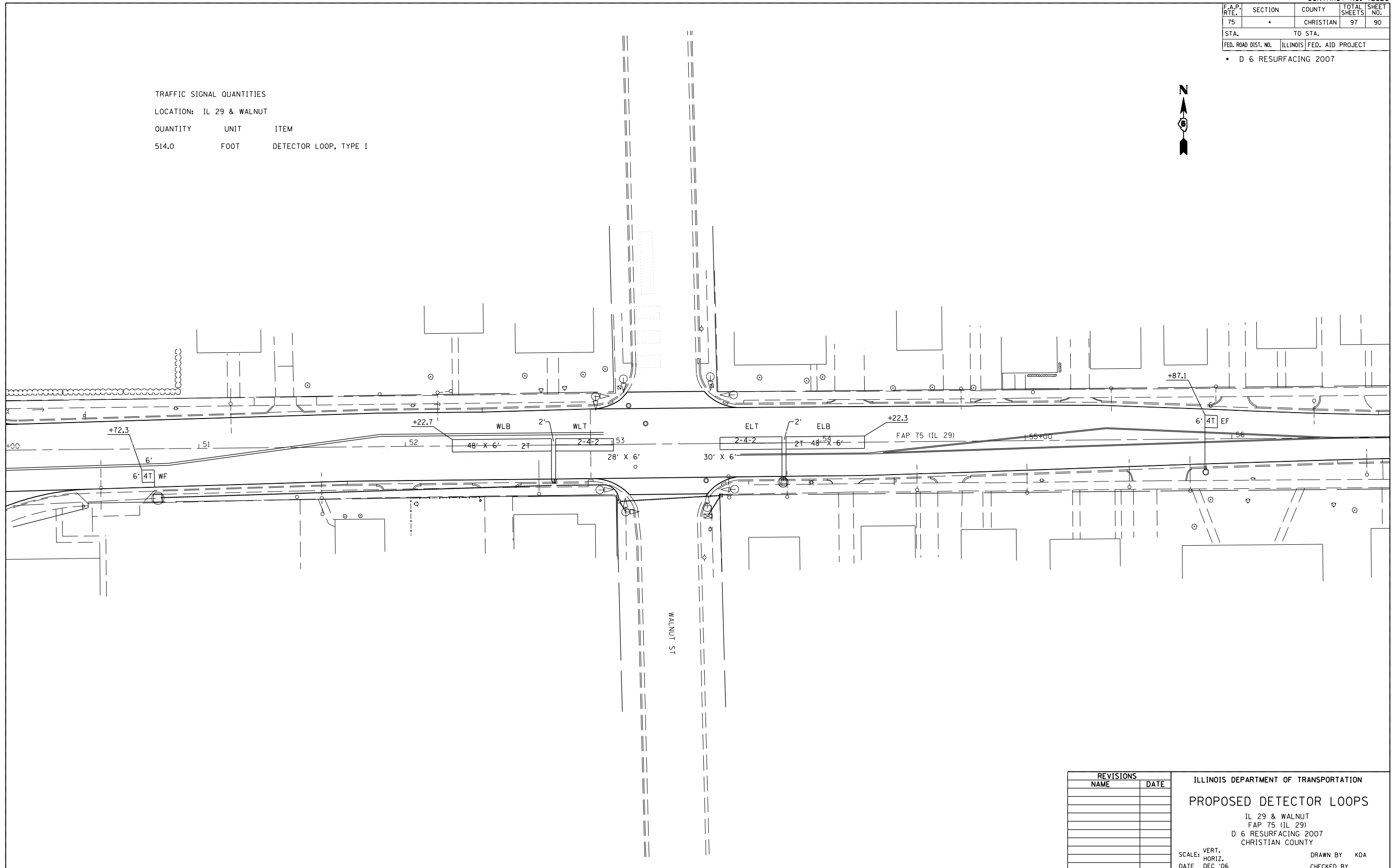

PLOT DATE = 12/15/2006
 PLOT SCALE = 42.3528 / IN
 PLOT SCALE = 42.3528 / IN

REVISIONS	
NAME	DATE

ILLINOIS DEPARTMENT OF TRANSPORTATION
PROPOSED DETECTOR LOOPS
 IL 29 & WALNUT
 FAP 75 (IL 29)
 D 6 RESURFACING 2007
 CHRISTIAN COUNTY

SCALE: VERT. DRAWN BY KDA
 HORIZ. CHECKED BY
 DATE DEC '06