

F.A. RTE.	SECTION	COUNTY	TOTAL SHEETS	SHEET NO.
*	**	SANGMAON	12	8
STA.		TO STA.		
FED. ROAD DIST. NO.	ILLINOIS	FED. AID PROJECT		
* VARIOUS				
** D-6 TRAFFIC SIGNAL MOD 2007-2				

TRAFFIC SIGNAL QUANTITIES

JEFFERSON & FIFTH

QNTY	UNIT	ITEM
20.0	FOOT	ELECTRIC CABLE IN CONDUIT, SIGNAL NO. 14, 5/C
1	EACH	SIGNAL HEAD, POLYCARBONATE, LED, 1-FACE, 3-SECTION, MAST ARM MOUNTED
1	EACH	TRAFFIC SIGNAL BACKPLATE
1	EACH	MODIFY EXISTING TRAFFIC SIGNAL BACKPLATE
1	EACH	RELOCATE SIGN PANEL

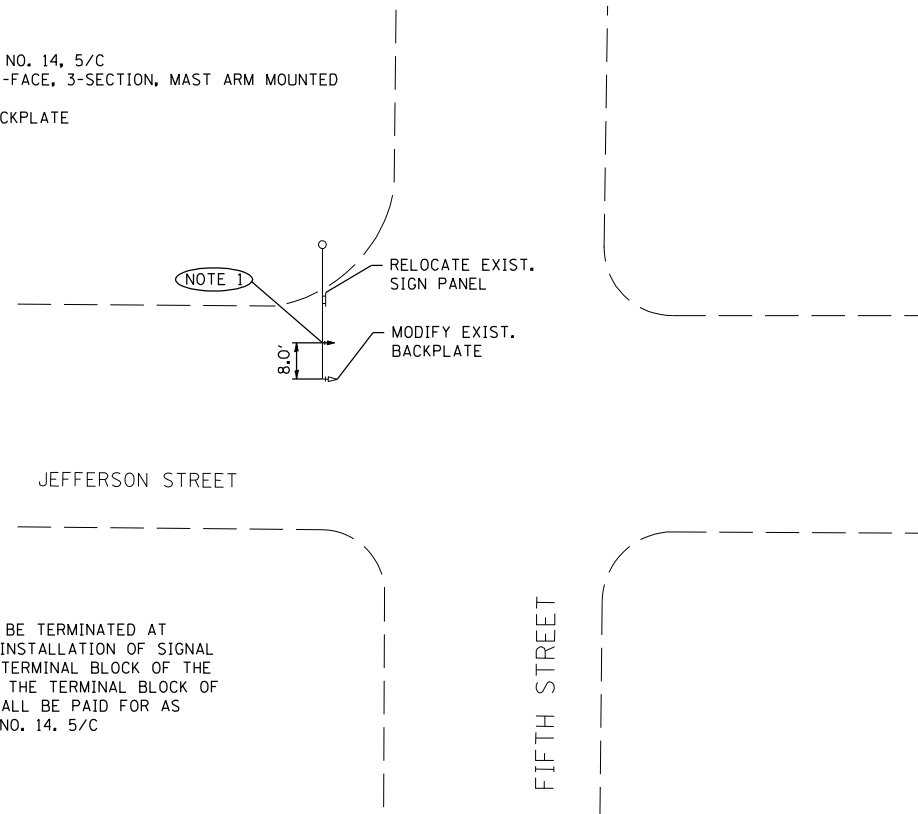

NOTE 1: EXISTING WIRING IN MAST ARM SHALL BE TERMINATED AT THE PROPOSED SIGNAL HEAD. A NEW INSTALLATION OF SIGNAL WIRE SHALL BE INSTALLED FROM THE TERMINAL BLOCK OF THE PROPOSED MAST ARM SIGNAL HEAD TO THE TERMINAL BLOCK OF THE EXISTING 3-SECT HEAD. WIRE SHALL BE PAID FOR AS ELECTRIC CABLE IN CONDUIT, SIGNAL NO. 14, 5/C

TRAFFIC SIGNAL QUANTITIES

JEFFERSON & FOURTH

QNTY	UNIT	ITEM
20.0	FOOT	ELECTRIC CABLE IN CONDUIT, SIGNAL NO. 14, 5/C
1	EACH	SIGNAL HEAD, POLYCARBONATE, LED, 1-FACE, 3-SECTION, MAST ARM MOUNTED
1	EACH	TRAFFIC SIGNAL BACKPLATE
1	EACH	MODIFY EXISTING TRAFFIC SIGNAL BACKPLATE
1	EACH	RELOCATE SIGN PANEL

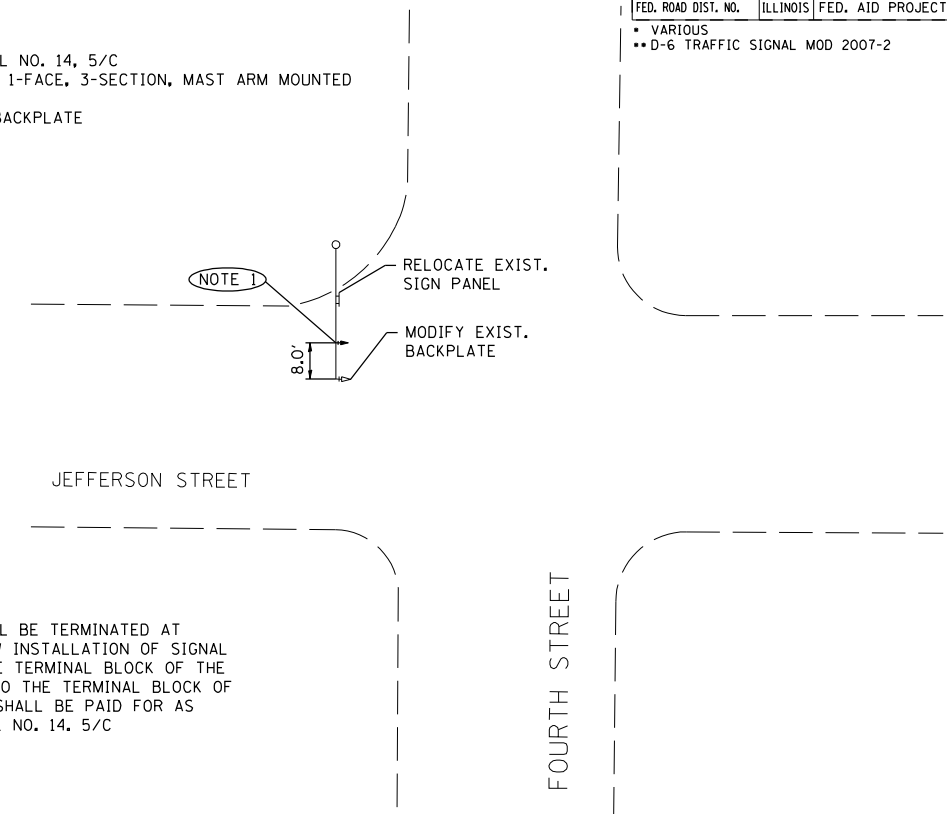

NOTE 1: EXISTING WIRING IN MAST ARM SHALL BE TERMINATED AT THE PROPOSED SIGNAL HEAD. A NEW INSTALLATION OF SIGNAL WIRE SHALL BE INSTALLED FROM THE TERMINAL BLOCK OF THE PROPOSED MAST ARM SIGNAL HEAD TO THE TERMINAL BLOCK OF THE EXISTING 3-SECT HEAD. WIRE SHALL BE PAID FOR AS ELECTRIC CABLE IN CONDUIT, SIGNAL NO. 14, 5/C

TRAFFIC SIGNAL QUANTITIES

JEFFERSON & FIRST

QNTY	UNIT	ITEM
11.0	SO FT	PORTLAND CEMENT CONCRETE SIDEWALK, 4"
17.0	SO FT	SIDEWALK REMOVAL
6.0	FOOT	CONDUIT IN TRENCH, 2", PVC
6.0	FOOT	TRENCH AND BACKFILL FOR ELECTRICAL WORK
1	EACH	MAINTENANCE OF EXISTING TRAFFIC SIGNAL INSTALLATION
61.0	FOOT	ELECTRIC CABLE IN CONDUIT, SIGNAL NO. 14, 5/C
16.0	FOOT	ELECTRIC CABLE IN CONDUIT, SIGNAL NO. 14, 7/C
16.0	FOOT	ELECTRIC CABLE IN CONDUIT, SIGNAL NO. 14, 9/C
1	EACH	STEEL MAST ARM AND POLE, 38 FT.
13.5	FOOT	CONCRETE FOUNDATION, TYPE E, 30" DIAMETER
3	EACH	SIGNAL HEAD, POLYCARBONATE, LED, 1-FACE, 3-SECTION, MAST ARM MOUNTED
3	EACH	TRAFFIC SIGNAL BACKPLATE
3	EACH	RELOCATE EXISTING SIGNAL HEAD
2	EACH	RELOCATE EXISTING PEDESTRIAN SIGNAL HEAD
2	EACH	REBUILD EXISTING PEDESTRIAN SIGNAL HEAD, L.E.D.
48.0	FOOT	REMOVE AND REINSTALL ELECTRIC CABLE FROM CONDUIT
1	EACH	REMOVE EXISTING TRAFFIC SIGNAL EQUIPMENT
1	EACH	REMOVE EXISTING CONCRETE FOUNDATION
1	EACH	MODIFY EXISTING TRAFFIC SIGNAL BACKPLATE
3	EACH	RELOCATE SIGN PANEL

ALL TRAFFIC SIGNAL MAST ARM ASSEMBLIES MUST BE DESIGNED FOR THE LOADINGS SHOWN ON THE HIGHWAY STANDARDS OR THESE SIGNAL PLANS WHICHEVER IS GREATER

RELOCATE EXIST. SIG HEAD (QNTY = 3)
RELOCATE EXIST. PED HEAD (QNTY = 2)

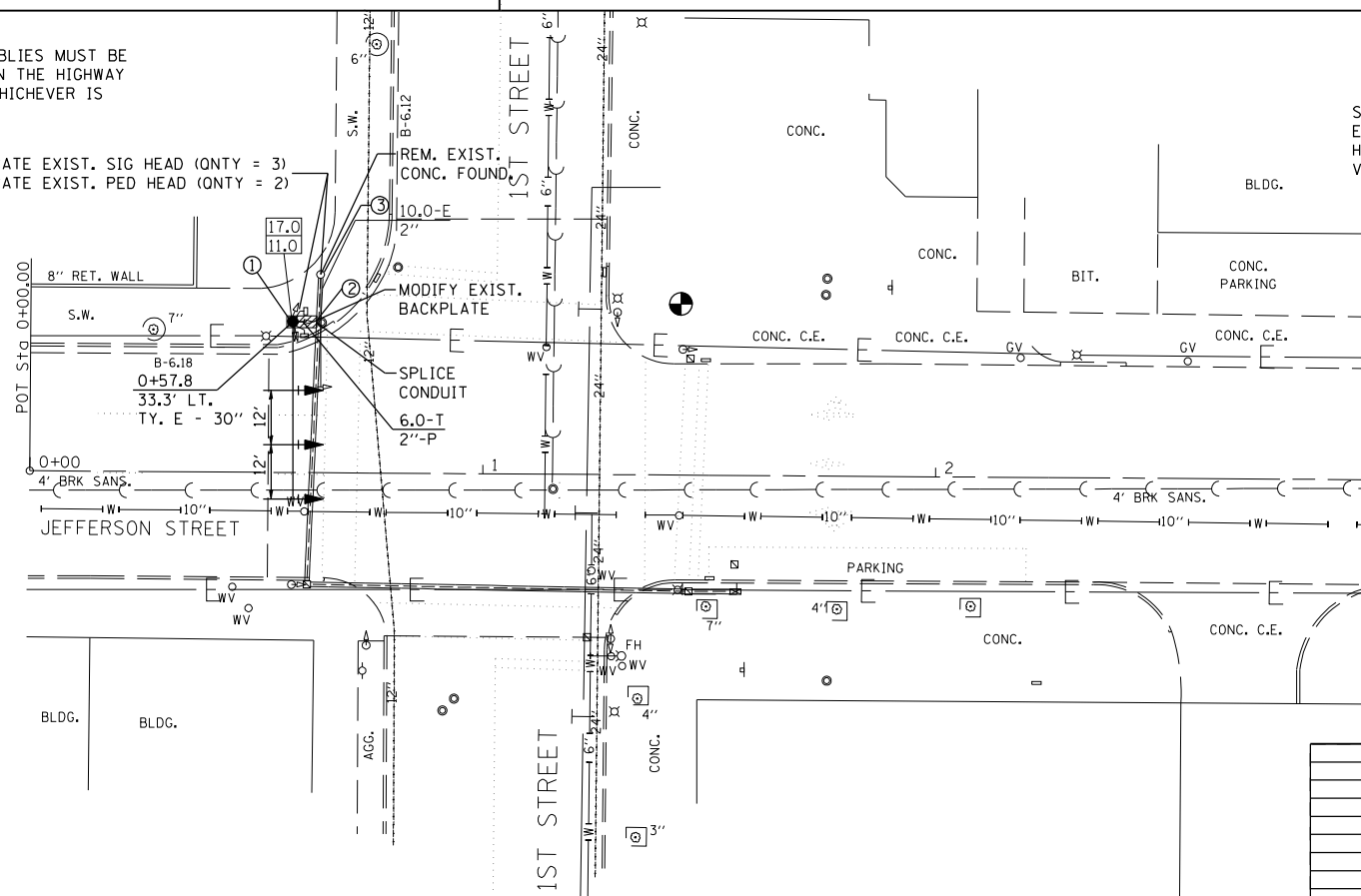

SPLICE PROPOSED CABLES TO EXISTING CABLES AT MAST ARM HANDHOLE. CONTRACTOR SHALL VERIFY EXISTING CABLE SIZES

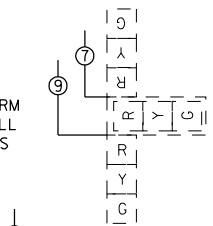

WIRING DIAGRAM

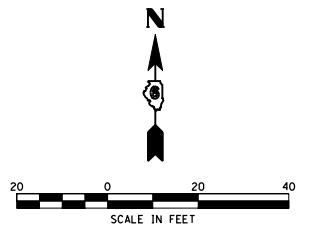

- NOTE 1: REMOVE AND REINSTALL EXISTING TRAFFIC SIGNAL CABLES FROM EXISTING MAST ARM TO PROPOSED MAST ARM HANDHOLE. SPLICE PROPOSED SIGNAL CABLES TO EXISTING CABLES AT MAST ARM HANDHOLE
- NOTE 2: CONTRACTOR SHALL FIELD VERIFY THE EXISTING CABLE AND CONDUIT SIZES FOR SPLICING PURPOSES FOR THE EXISTING MAST ARM TO BE REMOVED
- NOTE 3: RELOCATE EXISTING STREET NAME SIGN AND (2) ONE-WAY SIGNS TO PROPOSED MAST ARM.

REMOVE EXISTING TRAFFIC SIGNAL EQUIPMENT CONSISTS OF:

- 1.) MAST ARM ASSEMBLY AND POLE
- 2.) SIGNAL HEAD

ALL REMOVED EQUIPMENT SHALL BE RETURNED TO THE CITY OF SPRINGFIELD

REVISIONS	
NAME	DATE

ILLINOIS DEPARTMENT OF TRANSPORTATION
TRAFFIC SIGNAL PLAN
 FAP ROUTE 67
 (IL 29 & IL97 / MADISON ST. & JEFFERSON ST.)
 D-6 TRAFFIC SIGNAL MOD 2007-02
 SANGAMON

SCALE: VERT. NOV '06
 HORIZ. NOV '06

DRAWN BY: KDA
 CHECKED BY:

PLOT DATE = 12/12/2006
 FILE NAME = c:\p\projects\6652706\129\97\ts.sheets.dgn
 PLOT SCALE = 4.23524 / IN.
 USER NAME = laughlin-1