

F.A.I. RTE.	SECTION	COUNTY	TOTAL SHEETS	SHEET NO.
55	.	SANGAMON	26	13

STA.	TO STA.
FED. ROAD DIST. NO.	ILLINOIS FED. AID PROJECT

• D-6 CABLE MEDIAN BAR #2

EXIST. CURVE 438  
 PI STA. = 438+55.52  
 $\Delta = 7^\circ 12' 51''$  (LT)  
 $D = 0^\circ 27' 55''$   
 $R = 12,310.76'$   
 $T = 776.07'$   
 $L = 1,550.09'$   
 $E = 24.44'$   
 $e = \text{-----}$   
 $T.R. = \text{-----}$   
 $S.E. RUN = \text{-----}$   
 P.C. STA. = 430+79.45  
 P.T. STA. = 446+29.54

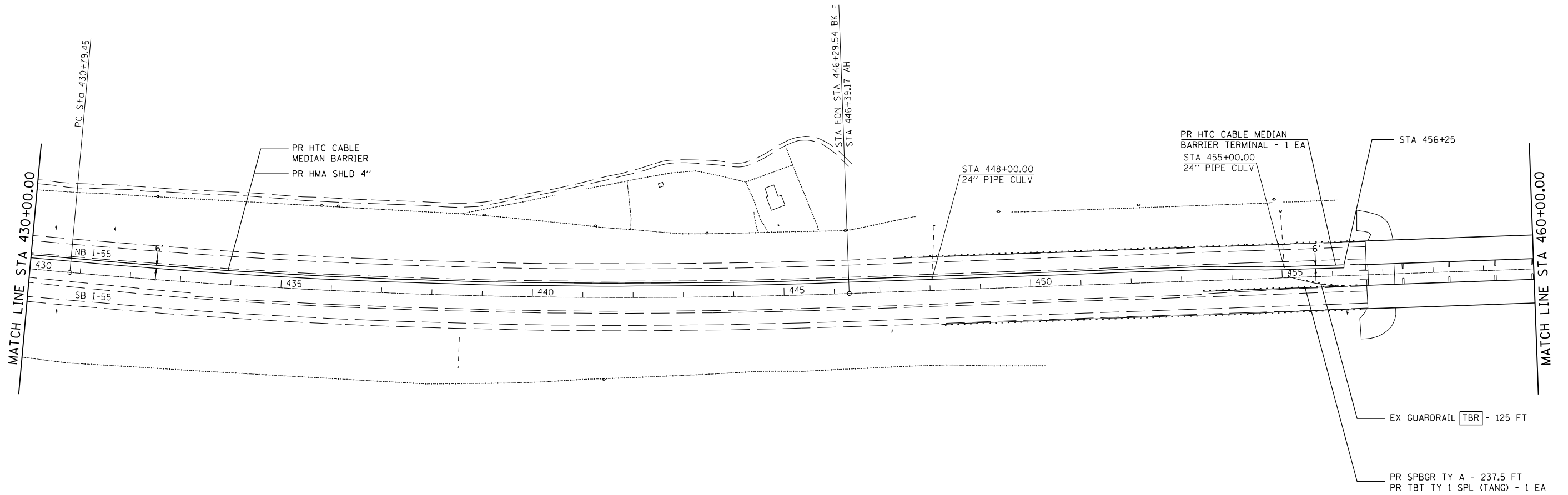

PLOT DATE = 12/13/2006  
 FILE NAME = c:\p\projects\4653806\shplan1.dgn  
 PLOT SCALE = 211.7647 / IN.  
 USER NAME = laughlin-1

REVISIONS	
NAME	DATE

ILLINOIS DEPARTMENT OF TRANSPORTATION  
 PLAN SHEET  
 FAI 55 (I-55)  
 SECTION D-6 CABLE MEDIAN BAR #2  
 SANGAMON COUNTY  
 SCALE: VERT. \_\_\_\_\_  
 HORIZ. \_\_\_\_\_  
 DATE \_\_\_\_\_ DRAWN BY \_\_\_\_\_  
 CHECKED BY \_\_\_\_\_