

F.A.I. RTE.	SECTION	COUNTY	TOTAL SHEETS	SHEET NO.
55		SANGAMON	26	1

\* - D-6 CABLE MEDIAN BAR #2

STATE OF ILLINOIS  
DEPARTMENT OF TRANSPORTATION  
DIVISION OF HIGHWAYS

# PROPOSED HIGHWAY PLANS

FAI 55 (I-55)  
SECTION D-6 CABLE MEDIAN BAR #2  
SANGAMON COUNTY  
PROJECT # HSIP-055-3(139)102  
C-96-515-07

**INDEX OF SHEETS**

- 1 COVER SHEET
- 2 GENERAL NOTES
- 3 SUMMARY OF QUANTITIES
- 4-8 TYPICAL SECTIONS
- 9-10 SCHEDULES OF QUANTITIES
- 11-22 PLAN SHEETS
- 23 DETAILS
- 24 GRADING DETAIL
- 25 CABLE GUARD MARKER DETAIL
- 26 GIBRALTAR CABLE BARRIER DETAILS

**HIGHWAY STANDARDS**

000001-04	701106-01
630001-07	701400-02
635006-02	701406-04
635011-01	702001-06
701101-01	

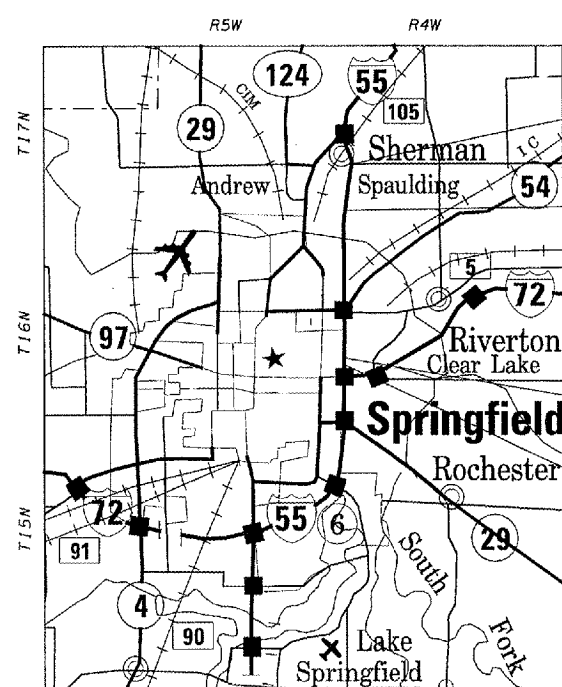

PROJECT BEGINS  
STA 374+25.00

STA EQN: STA 446+29.54 BK =  
STA 446+39.17 AH

STA EQN: STA 695+32.26 BK =  
STA 355+49.48 AH

PROJECT ENDS  
STA 347+81.00

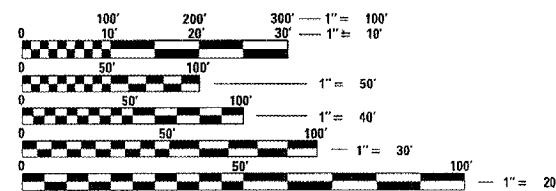

FULL SIZE PLANS HAVE BEEN PREPARED USING STANDARD ENGINEERING SCALES. REDUCED SIZED PLANS WILL NOT CONFORM TO STANDARD SCALES. IN MAKING MEASUREMENTS ON REDUCED PLANS, THE ABOVE SCALES MAY BE USED.

J.U.L.I.E.  
JOINT UTILITY LOCATION INFORMATION FOR EXCAVATION  
1-800-892-0123

ADT - 38,800

STATE OF ILLINOIS  
DEPARTMENT OF TRANSPORTATION  
DIVISION OF HIGHWAYS

SUBMITTED *Dec 14 2006*

*Chris M. Reed*  
DEPUTY DIRECTOR OF HIGHWAYS, REGION ENGINEER

*February 2, 2007*  
*Eric E. Harn*  
ENGINEER OF DESIGN AND ENVIRONMENT

*February 2, 2007*  
*Matt R. See, P.E.*  
DIRECTOR OF HIGHWAYS, CHIEF ENGINEER

**PRINTED BY THE AUTHORITY  
OF THE STATE OF ILLINOIS**

GROSS LENGTH OF PROJECT = 32,866.11 FEET = 6.22 MILES  
NET LENGTH OF PROJECT = 32,866.11 FEET = 6.22 MILES

PROJECT ENGINEER: SAL MADONIA (217) 782-4761  
SQUAD LEADER: JEFFREY P. MYERS (217) 524-7940

CONTRACT NO. 72A56

SANGAMON COUNTY

SECTION D-6 CABLE MEDIAN BAR #2

F.A.I. RTE.	SECTION	COUNTY	TOTAL SHEETS	SHEET NO.
55	*	SANGAMON	26	2
STA.		TO STA.		
FED. ROAD DIST. NO.		ILLINOIS	FED. AID PROJECT	

\* D-6 CABLE MEDIAN BAR #2

GENERAL NOTES

1. THE CONTRACTOR SHALL BE RESPONSIBLE FOR PROTECTING UTILITY PROPERTY FROM CONSTRUCTION OPERATIONS AS OUTLINED IN ARTICLE 107.31 OF THE STANDARD SPECIFICATIONS. THE JULIE NUMBER IS 800-892-0123. A MINIMUM OF FORTY-EIGHT HOURS ADVANCE NOTICE IS REQUIRED. ANY DAMAGE TO THE UNDERGROUND FACILITIES, CAUSED BY THE CONTRACTOR SHALL BE REPAIRED TO THE SATISFACTION OF THE DEPARTMENT AT THE CONTRACTOR'S EXPENSE, INCLUDING TEMPORARY REPAIRS WHICH MAY BE REQUIRED TO KEEP THE FACILITY OPERATIONAL WHILE MATERIAL IS BEING OBTAINED TO MAKE PERMANENT REPAIRS.
2. THE LOCATIONS OF THOSE BURIED AND ABOVEGROUND UTILITIES SHOWN ARE APPROXIMATE, ARE SHOWN FOR CONTRACTOR INFORMATIONAL USE ONLY, AND ARE NOT TO BE REFERENCED FOR CONSTRUCTIONS PURPOSES. THE IMPLIED PRESENCE OR ABSENCE OF UTILITIES IS NOT TO BE CONSTRUED BY THE OWNER, ENGINEER, CONTRACTOR, OR SUBCONTRACTORS TO BE AN ACCURATE AND COMPLETE REPRESENTATION OF UTILITIES THAT MAY OR MAY NOT EXIST ON THE CONSTRUCTION SITE. BURIED AND ABOVEGROUND UTILITY LOCATION, IDENTIFICATION, AND MARKING ARE THE SOLE RESPONSIBILITY OF THE CONTRACTOR. REROUTING, DISCONNECTION, PROTECTION, ETC. OF ANY UTILITIES MUST BE COORDINATED BETWEEN THE CONTRACTOR, UTILITY COMPANY, AND OWNER. SITE SAFETY, INCLUDING THE AVOIDANCE OF HAZARDS ASSOCIATED WITH BURIED AND ABOVEGROUND UTILITIES, REMAINS THE SOLE RESPONSIBILITY OF THE CONTRACTOR.
3. FOR STABILIZATION, ALL TYPE III BARRICADES SHALL REQUIRE A MINIMUM OF FOUR SANDBAGS PER BARRICADE.
4. WHERE SECTION OR SUBSECTION MONUMENTS ARE ENCOUNTERED, THE ENGINEER SHALL BE NOTIFIED BEFORE SUCH MONUMENTS ARE REMOVED. THE CONTRACTOR SHALL PROTECT AND CAREFULLY PRESERVE ALL MONUMENTS UNTIL AN AUTHORIZED SURVEYOR OR AGENT HAS WITNESSED OR OTHERWISE REFERENCED THEIR LOCATION. THE CONTRACTOR SHALL BE RESPONSIBLE FOR HAVING AN AUTHORIZED SURVEYOR RE-ESTABLISH ANY SECTION OR SUBSECTION MONUMENTS DESTROYED BY HIS OPERATIONS.
5. ANY REFERENCE TO A STANDARD IN THESE PLANS SHALL BE INTERPRETED TO MEAN THE EDITION AS INDICATED BY THE SUBNUMBER LISTED ON THE INDEX OF SHEETS OR THE COPY OF THE STANDARD INCLUDED IN THESE PLANS.
6. UNLESS NOTED OTHERWISE, STATIONS AND OFFSETS REFER TO CENTERLINE OF PROJECT.
7. IN ADDITION TO FIELD SURVEYS AND AERIAL SURVEYS, PLAN DIMENSIONS AND DETAILS RELATIVE TO THE EXISTING FACILITIES HAVE BEEN TAKEN FROM EXISTING PLANS AND ARE SUBJECT TO CONSTRUCTION VARIATIONS. IT SHALL BE THE CONTRACTOR'S RESPONSIBILITY TO VERIFY SUCH DIMENSIONS AND DETAILS IN THE FIELD. SUCH VARIATIONS SHALL NOT BE A CAUSE FOR ADDITIONAL COMPENSATION DUE TO A CHANGE IN THE SCOPE OF THE WORK. HOWEVER, THE CONTRACTOR WILL BE PAID FOR THE QUANTITY ACTUALLY FURNISHED AT THE UNIT PRICE BID FOR THE WORK.

COMMITMENTS:

THERE ARE NO COMMITMENTS ON THIS PROJECT.

MIX REQUIREMENTS TABLE	
The following mixture requirements are applicable for this project.	
MIXTURE USE (S):	HOT-MIX ASPHALT SHOULDERS
AC/PG:	PG 58-22
RAP%: (MAX)	15%
DESIGN AIR VOIDS:	2.0% @ N DESIGN = 30
MIXTURE COMPOSITION: (GRADATION MIXTURE)	BAM
FRICTION AGGREGATE:	N/A

DISTRICT SIX	
EXAMINED	<u>November 21</u> 20 <u>06</u> <i>[Signature]</i>
OPERATIONS ENGINEER	
EXAMINED	<u>Nov 27</u> 20 <u>06</u> <i>[Signature]</i>
PROGRAM IMPLEMENTATION ENGINEER	
EXAMINED	<u>DECEMBER 12</u> 20 <u>06</u> <i>[Signature]</i>
PROGRAM DEVELOPMENT ENGINEER	

REVISIONS	
NAME	DATE

ILLINOIS DEPARTMENT OF TRANSPORTATION  
 GENERAL NOTES  
 FAI 55 (I-55)  
 SECTION D-6 CABLE MEDIAN BAR #2  
 SANGAMON COUNTY  
 SCALE: VERT. \_\_\_\_\_  
 HORIZ. \_\_\_\_\_  
 DATE \_\_\_\_\_ DRAWN BY \_\_\_\_\_  
 CHECKED BY \_\_\_\_\_

ILLINOIS DEPARTMENT OF TRANSPORTATION  
SUMMARY OF QUANTITIES

CONTRACT NO. 72456				
F.A.I. RTE.	SECTION	COUNTY	TOTAL SHEETS	SHEET NO.
55	•	SANGAMON	26	3
STA.		TO STA.		
FED. ROAD DIST. NO.		ILLINOIS FED. AID PROJECT		

• - D-6 CABLE MEDIAN BAR #2

LOCATION OF WORK				URBAN I-55 90% FED./10% STATE	
SUMMARY OF QUANTITIES				CONSTRUCTION TYPE CODE	
CODE NO.	ITEM	UNIT	TOTAL QUANTITY	SEFY-2A	
20200600	EXCAVATING AND GRADING EXISTING SHOULDER	UNIT	292	292	
25001000	SEEDING, CLASS 2 (SPECIAL)	ACRE	4	4	
25100630	EROSION CONTROL BLANKET	SQ YD	19,476	19,476	
48203013	HOT-MIX ASPHALT SHOULDERS, 4"	SQ YD	18,656	18,656	
48203037	HOT-MIX ASPHALT SHOULDERS, 10"	SQ YD	648	648	
63000000	STEEL PLATE BEAM GUARD RAIL, TYPE A	FOOT	475	475	
63100167	TRAFFIC BARRIER TERMINAL TYPE 1, SPECIAL (TANGENT)	EACH	2	2	
63200310	GUARDRAIL REMOVAL	FOOT	900	900	
67100100	MOBILIZATION	L SUM	1	1	
70100700	TRAFFIC CONTROL AND PROTECTION, STANDARD 701406	L SUM	1	1	
70103815	TRAFFIC CONTROL SURVEILLANCE	CAL DA	5	5	
70106800	CHANGEABLE MESSAGE SIGN	CAL MO	4	4	
78200410	GUARDRAIL MARKERS, TYPE A	EACH	8	8	
78201000	TERMINAL MARKER - DIRECT APPLIED	EACH	2	2	
X0325231	CABLE GUARD MARKER	EACH	699	699	
X0325589	HIGH TENSION CABLE MEDIAN BARRIER	FOOT	27,764	27,764	
X0325590	HIGH TENSION CABLE MEDIAN BARRIER TERMINAL	EACH	8	8	
Z0029999	IMPACT ATTENUATOR REMOVAL	EACH	3	3	
X0325606	HIGH TENSION CABLE MEDIAN BARRIER DEMONSTRATION	EACH	2	2	

REVISIONS		ILLINOIS DEPARTMENT OF TRANSPORTATION SUMMARY OF QUANTITIES FAI 55 (I-55) SECTION D-6 CABLE MEDIAN BAR #2 SANGAMON COUNTY
NAME	DATE	
SCALE:	VERT. DATE	HORIZ. DRAWN BY CHECKED BY

REV.

PLT DATE : 12/12/2006  
FILE NAME : c:\p\projects\052006\summary.qdw  
PLOT SCALE : 1/8"=1'-0" / 3/16"  
USER NAME : teaghtl@i-

F.A.I. RTE.	SECTION	COUNTY	TOTAL SHEETS	SHEET NO.
55		SANGAMON	26	4
STA.		TO STA.		
FED. ROAD DIST. NO.	ILLINOIS	FED. AID PROJECT		

• D-6 CABLE MEDIAN BAR #2

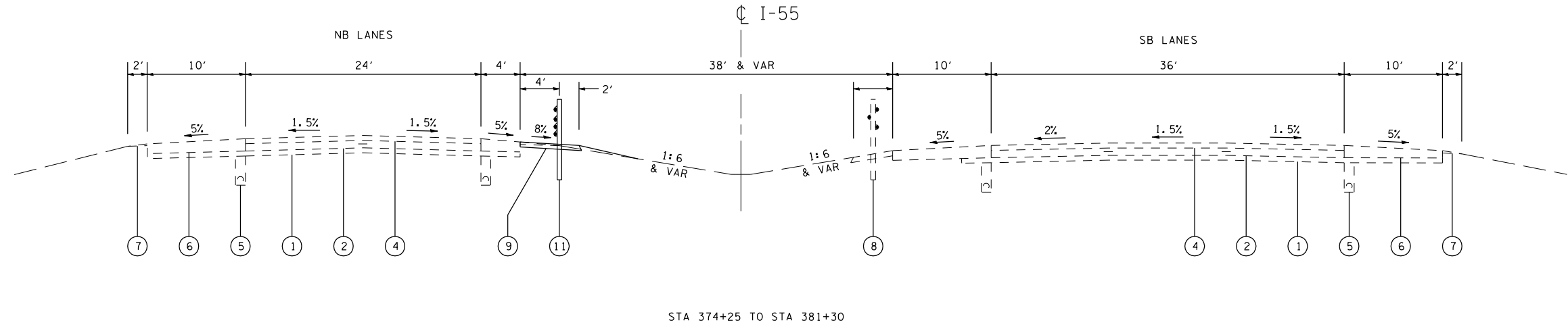

STA 374+25 TO STA 381+30

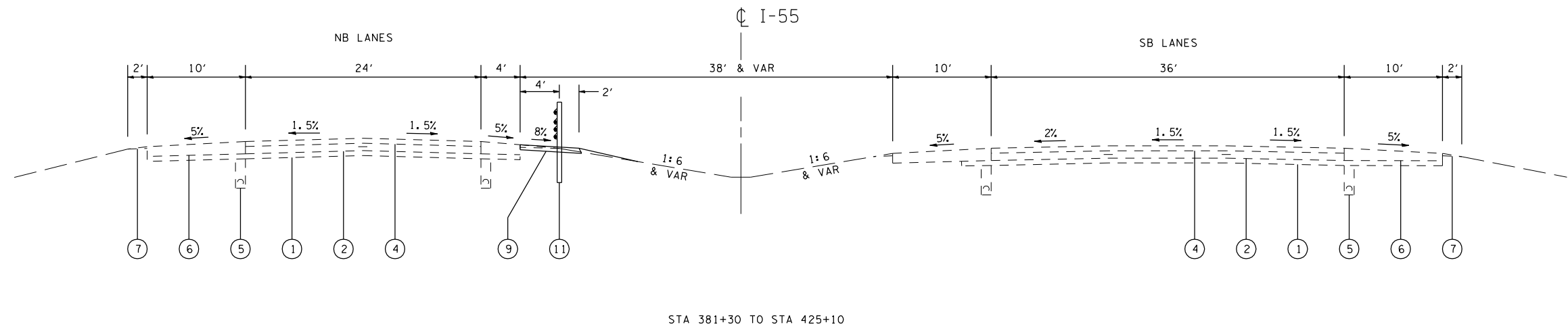

STA 381+30 TO STA 425+10

LEGEND

- ① EX SUB-BASE GRANULAR MATERIAL 6"
- ② EX 10" SRPCC PAVEMENT
- ③ EX 10" PCC PAVEMENT
- ④ EX BITUMINOUS CONCRETE 5" AND VAR
- ⑤ EX PIPE UNDERDRAIN
- ⑥ EX BITUMINOUS SHOULDERS
- ⑦ EX AGGREGATE SHOULDER
- ⑧ EX HIGH TENSION CABLE MEDIAN BARRIER
- ⑨ PR HOT-MIX ASPHALT SHOULDERS 4"
- ⑩ PR HOT-MIX ASPHALT SHOULDERS 10"
- ⑪ PR HIGH TENSION CABLE MEDIAN BARRIER

REVISIONS	
NAME	DATE

ILLINOIS DEPARTMENT OF TRANSPORTATION  
 TYPICAL SECTIONS  
 FAI 55 (I-55)  
 SECTION D-6 CABLE MEDIAN BAR #2  
 SANGAMON COUNTY

SCALE: VERT. \_\_\_\_\_  
 HORIZ. \_\_\_\_\_  
 DATE \_\_\_\_\_ DRAWN BY \_\_\_\_\_  
 CHECKED BY \_\_\_\_\_

PLOT DATE = 12/13/2006  
 FILE NAME = c:\p\projects\653806\sh\typical.dgn  
 PLOT SCALE = 1/8"=1'-0" / IN.  
 USER NAME = laughlin-1

F.A.I. RTE.	SECTION	COUNTY	TOTAL SHEETS	SHEET NO.
55	*	SANGAMON	26	5
STA.		TO STA.		
FED. ROAD DIST. NO.	ILLINOIS	FED. AID PROJECT		

\* D-6 CABLE MEDIAN BAR #2

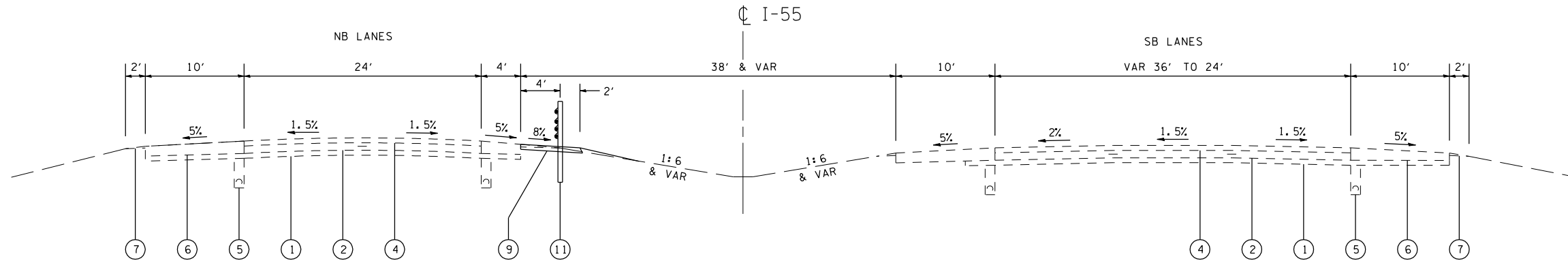

STA 425+10 TO STA 433+31

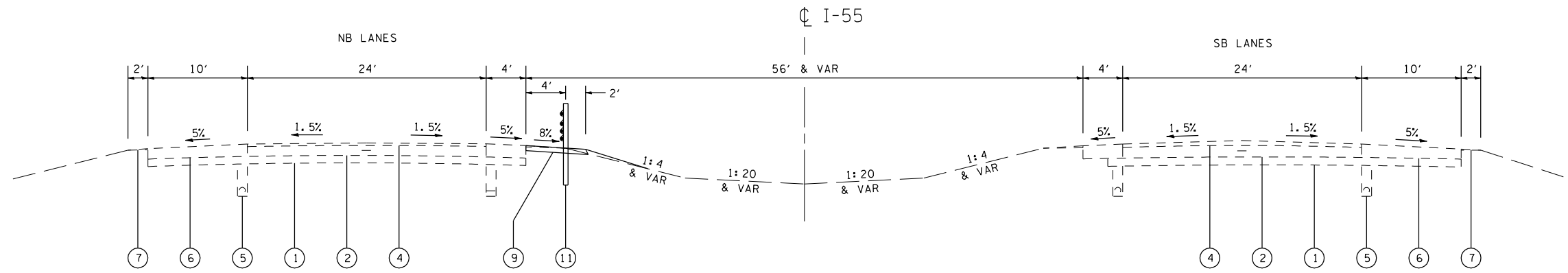

STA 433+31 TO STA 456+25  
STA 468+34 TO STA 515+58

LEGEND

- ① EX SUB-BASE GRANULAR MATERIAL 6"
- ② EX 10" SRPCC PAVEMENT
- ③ EX 10" PCC PAVEMENT
- ④ EX BITUMINOUS CONCRETE 5" AND VAR
- ⑤ EX PIPE UNDERDRAIN
- ⑥ EX BITUMINOUS SHOULDERS
- ⑦ EX AGGREGATE SHOULDER
- ⑧ EX HIGH TENSION CABLE MEDIAN BARRIER
- ⑨ PR HOT-MIX ASPHALT SHOULDERS 4"
- ⑩ PR HOT-MIX ASPHALT SHOULDERS 10"
- ⑪ PR HIGH TENSION CABLE MEDIAN BARRIER

REVISIONS	
NAME	DATE

ILLINOIS DEPARTMENT OF TRANSPORTATION  
TYPICAL SECTIONS  
FAI 55 (I-55)  
SECTION D-6 CABLE MEDIAN BAR #2  
SANGAMON COUNTY  
SCALE: VERT. / HORIZ.  
DATE / DRAWN BY / CHECKED BY

F.A.I. RTE.	SECTION	COUNTY	TOTAL SHEETS	SHEET NO.
55	*	SANGAMON	26	6
STA.		TO STA.		
FED. ROAD DIST. NO.		ILLINOIS FED. AID PROJECT		

\* D-6 CABLE MEDIAN BAR #2

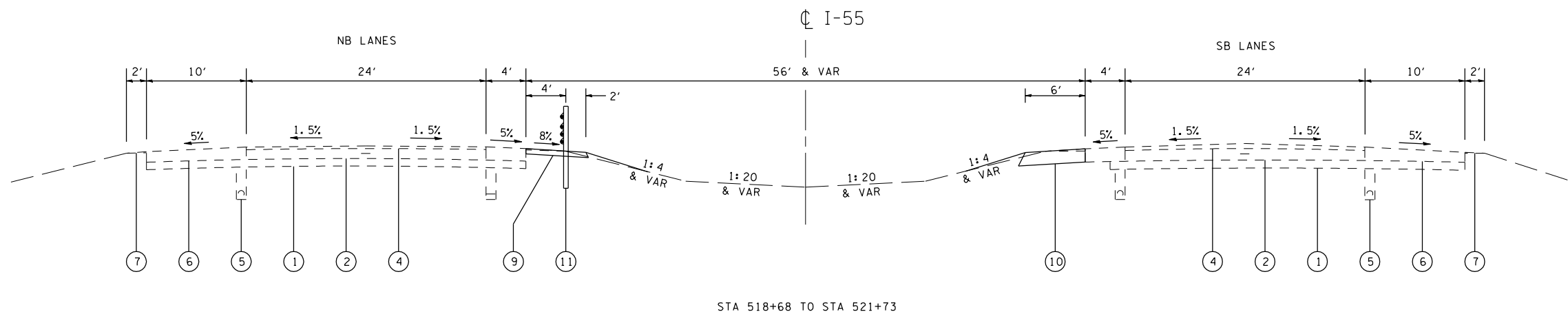
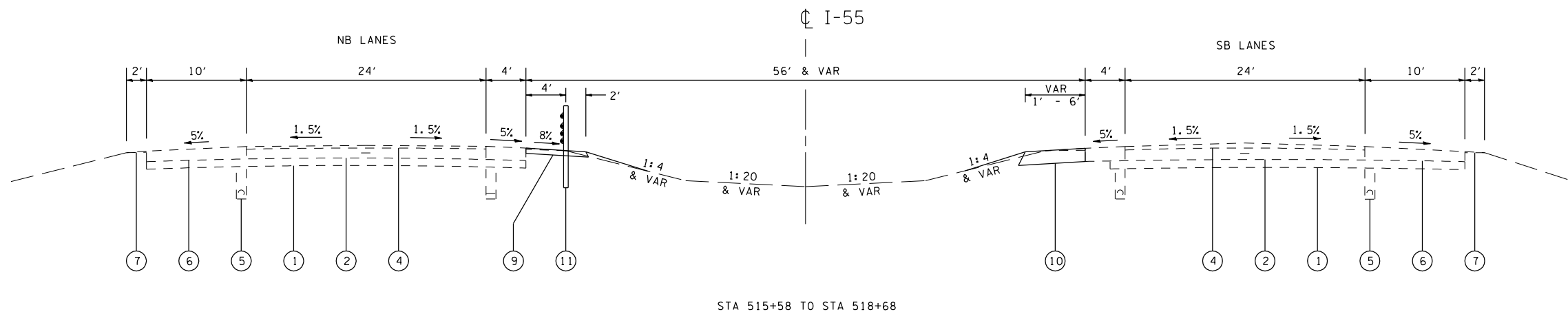

LEGEND

- ① EX SUB-BASE GRANULAR MATERIAL 6"
- ② EX 10" SRPCC PAVEMENT
- ③ EX 10" PCC PAVEMENT
- ④ EX BITUMINOUS CONCRETE 5" AND VAR
- ⑤ EX PIPE UNDERDRAIN
- ⑥ EX BITUMINOUS SHOULDERS
- ⑦ EX AGGREGATE SHOULDER
- ⑧ EX HIGH TENSION CABLE MEDIAN BARRIER
- ⑨ PR HOT-MIX ASPHALT SHOULDERS 4"
- ⑩ PR HOT-MIX ASPHALT SHOULDERS 10"
- ⑪ PR HIGH TENSION CABLE MEDIAN BARRIER

REVISIONS	
NAME	DATE

ILLINOIS DEPARTMENT OF TRANSPORTATION  
 TYPICAL SECTIONS  
 FAI 55 (I-55)  
 SECTION D-6 CABLE MEDIAN BAR #2  
 SANGAMON COUNTY

SCALE: VERT. \_\_\_\_\_  
 HORIZ. \_\_\_\_\_  
 DATE \_\_\_\_\_ DRAWN BY \_\_\_\_\_  
 CHECKED BY \_\_\_\_\_

PLOT DATE = 12/13/2006  
 FILE NAME = c:\projects\653806\shutupicel.dgn  
 PLOT SCALE = 1/8" = 1'-0" / IN.  
 USER NAME = laughlin

F.A.I. RTE.	SECTION	COUNTY	TOTAL SHEETS	SHEET NO.
55		SANGAMON	26	7
STA.		TO STA.		
FED. ROAD DIST. NO.		ILLINOIS	FED. AID PROJECT	

• D-6 CABLE MEDIAN BAR #2

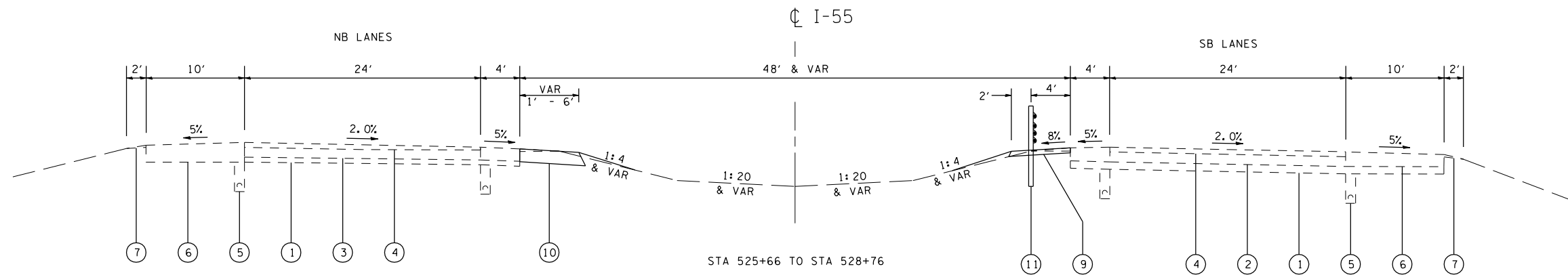
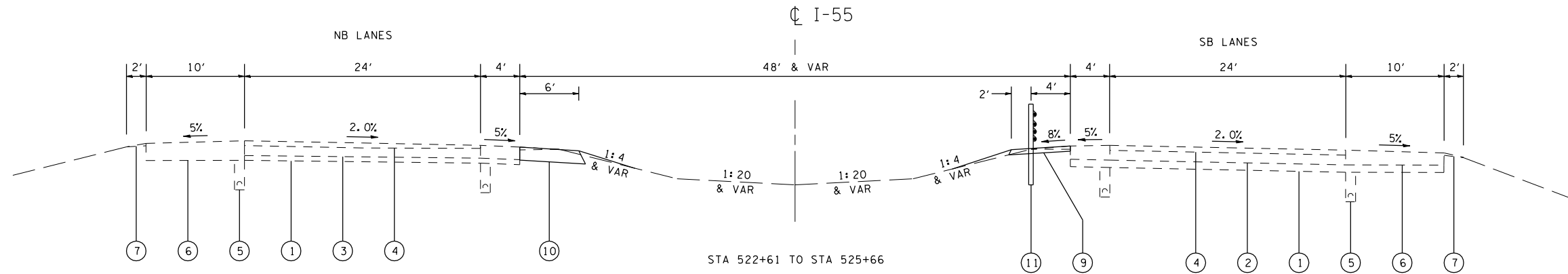

LEGEND

- ① EX SUB-BASE GRANULAR MATERIAL 6"
- ② EX 10" SRPCC PAVEMENT
- ③ EX 10" PCC PAVEMENT
- ④ EX BITUMINOUS CONCRETE 5" AND VAR
- ⑤ EX PIPE UNDERDRAIN
- ⑥ EX BITUMINOUS SHOULDERS
- ⑦ EX AGGREGATE SHOULDER
- ⑧ EX HIGH TENSION CABLE MEDIAN BARRIER
- ⑨ PR HOT-MIX ASPHALT SHOULDERS 4"
- ⑩ PR HOT-MIX ASPHALT SHOULDERS 10"
- ⑪ PR HIGH TENSION CABLE MEDIAN BARRIER

REVISIONS	
NAME	DATE

ILLINOIS DEPARTMENT OF TRANSPORTATION  
 TYPICAL SECTIONS  
 FAI 55 (I-55)  
 SECTION D-6 CABLE MEDIAN BAR #2  
 SANGAMON COUNTY

SCALE: VERT.      DRAWN BY  
 HORIZ.              CHECKED BY  
 DATE

PLOT DATE = 12/13/2006  
 FILE NAME = c:\p\projects\6553806\sh\typical.dgn  
 PLOT SCALE = 1/8" = 1' / IN.  
 USER NAME = laughlin

F.A.I. RTE.	SECTION	COUNTY	TOTAL SHEETS	SHEET NO.
55	.	SANGAMON	26	8

STA.	TO STA.
FED. ROAD DIST. NO.	ILLINOIS FED. AID PROJECT

• D-6 CABLE MEDIAN BAR #2

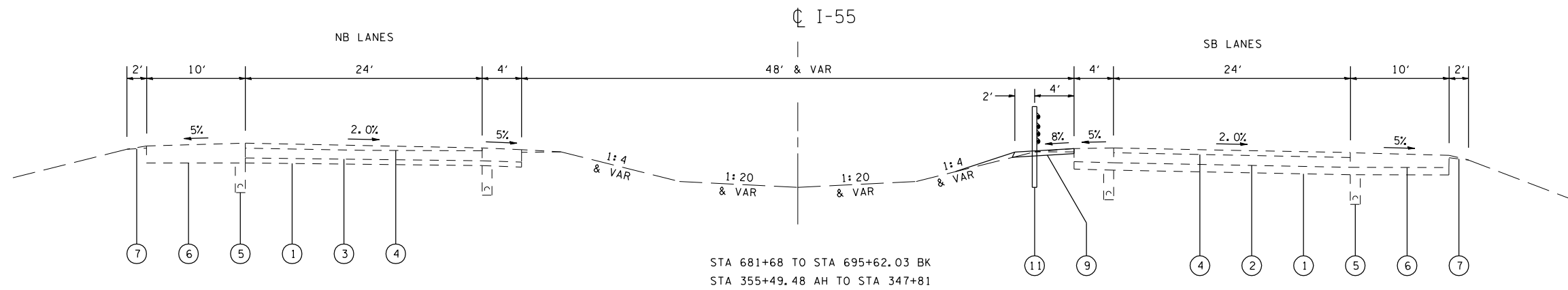
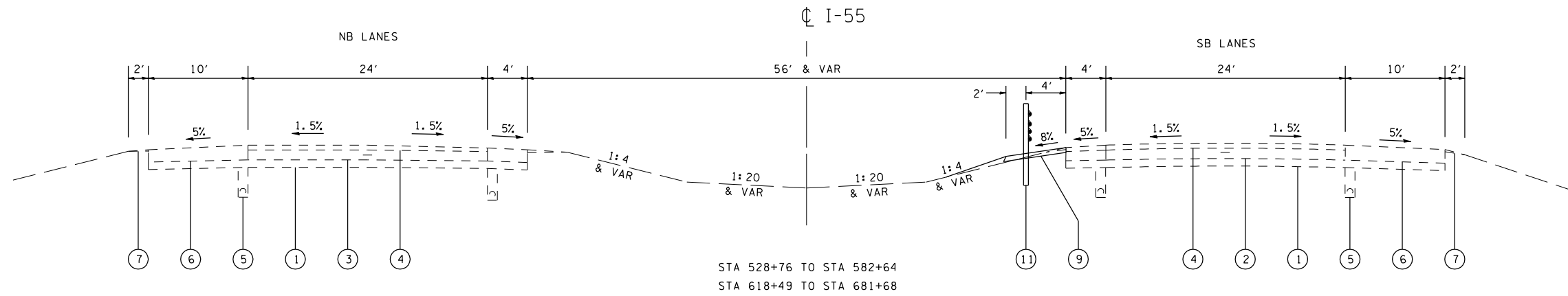

LEGEND

- ① EX SUB-BASE GRANULAR MATERIAL 6"
- ② EX 10" SRPCC PAVEMENT
- ③ EX 10" PCC PAVEMENT
- ④ EX BITUMINOUS CONCRETE 5" AND VAR
- ⑤ EX PIPE UNDERDRAIN
- ⑥ EX BITUMINOUS SHOULDERS
- ⑦ EX AGGREGATE SHOULDER
- ⑧ EX HIGH TENSION CABLE MEDIAN BARRIER
- ⑨ PR HOT-MIX ASPHALT SHOULDERS 4"
- ⑩ PR HOT-MIX ASPHALT SHOULDERS 10"
- ⑪ PR HIGH TENSION CABLE MEDIAN BARRIER

REVISIONS	
NAME	DATE

ILLINOIS DEPARTMENT OF TRANSPORTATION

TYPICAL SECTIONS

FAI 55 (I-55)

SECTION D-6 CABLE MEDIAN BAR #2

SANGAMON COUNTY

SCALE: VERT.  
HORIZ.

DRAWN BY  
CHECKED BY



F.A.I. RTE.	SECTION	COUNTY	TOTAL SHEETS	SHEET NO.
55	*	SANGAMON	26	9
STA.		TO STA.		
FED. ROAD DIST. NO.	ILLINOIS	FED. AID PROJECT		

\* D-6 CABLE MEDIAN BAR #2

GUARDRAIL REMOVAL

LOCATION	LENGTH (FOOT)
RT STA 455+11 TO STA 456+30	125
LT STA 468+20 TO STA 469+45	125
RT STA 622+41 TO STA 624+41	200
RT STA 635+58 TO STA 637+08	150
RT STA 349+71 TO STA 346+71	300
TOTAL	900

\* - TBT TY 6 TO BE LEFT IN PLACE

IMPACT ATTENUATOR REMOVAL

LOCATION	EACH
STA 374+00 (SN 084-0088 N SIDE)	1
STA 374+50 (SN 084-0088 S SIDE)	1
STA 556+50 (SN 084-0101 N SIDE)	1
TOTAL	3

STEEL PLATE BEAM GUARDRAIL, TYPE A

LOCATION	LENGTH (FOOT)
RT STA 453+93 TO STA 456+30	237.5
LT STA 468+20 TO STA 470+58	237.5
TOTAL	475.0

TRAFFIC BARRIER TERMINAL TYPE 1, SPECIAL (TANGENT)

LOCATION	QUANTITY (EACH)
RT STA 453+43 TO STA 453+93	1
LT STA 470+58 TO STA 471+08	1
TOTAL	2

TERMINAL MARKER - DIRECT APPLIED

LOCATION	QUANTITY (EACH)
RT STA 453+43	1
LT STA 471+08	1
TOTAL	2

HIGH TENSION CABLE MEDIAN BARRIER

LOCATION	LENGTH (FOOT)
LT STA 374+52.50 TO STA 446+29.54 BK	7,177
LT STA 446+39.17 AH TO STA 455+97.50	958
LT STA 468+61.50 TO STA 521+45.50	5,284
RT STA 522+88.50 TO STA 582+36.50	5,948
RT STA 618+76.50 TO STA 695+32.26 BK	7,656
RT STA 355+49.48 AH TO STA 348+08.50	741
TOTAL	27,764

HIGH TENSION CABLE MEDIAN BARRIER TERMINAL

LOCATION	EACH
LT STA 374+25.00 TO STA 374+52.50	1
LT STA 455+97.50 TO STA 456+25.00	1
LT STA 468+34.00 TO STA 468+61.50	1
LT STA 521+45.50 TO STA 521+73.00	1
RT STA 522+61.00 TO STA 522+88.50	1
RT STA 582+36.50 TO STA 582+64.00	1
RT STA 618+49.00 TO STA 618+76.50	1
RT STA 348+08.50 TO STA 347+81.00	1
TOTAL	8

HOT-MIX ASPHALT SHOULDERS, 4"

LOCATION	LENGTH (FOOT)	WIDTH (FOOT)	AREA (SQ YD)
LT STA 374+25.00 TO STA 446+29.54 BK	7,205	6.0	4,803.03
LT STA 446+39.17 AH TO STA 456+25.00	986	6.0	657.22
LT STA 468+34.00 TO STA 521+73.00	5,339	6.0	3,559.33
RT STA 522+61.00 TO STA 582+64.00	6,003	6.0	4,002.00
RT STA 618+49.00 TO STA 695+32.26 BK	7,683	6.0	5,122.17
RT STA 355+49.48 AH TO STA 347+81.00	768	6.0	512.32
TOTAL			18,656.07

HOT-MIX ASPHALT SHOULDERS, 10"

LOCATION	LENGTH (FOOT)	WIDTH (FOOT)	AREA (SQ YD)
LT STA 515+58.00 TO STA 518+68.00	310	1.0 TO 6.0	120.56
LT STA 518+68.00 TO STA 521+73.00	305	6.0	203.33
RT STA 522+61.00 TO STA 525+66.00	305	6.0	203.33
RT STA 525+66.00 TO STA 528+76.00	310	1.0 TO 6.0	120.56
TOTAL			647.78

PLOT DATE = 12/13/2006  
 FILE NAME = c:\p\projects\4653806\shs\shsched\shs.dgn  
 PLOT SCALE = 1/8"=1'-0"  
 USER NAME = laughlin-1

REVISIONS	
NAME	DATE

ILLINOIS DEPARTMENT OF TRANSPORTATION  
 SCHEDULES OF QUANTITIES  
 FAI 55 (1-55)  
 SECTION D-6 CABLE MEDIAN BAR #2  
 SANGAMON COUNTY

SCALE: VERT.      DRAWN BY  
 HORIZ.              CHECKED BY  
 DATE

F.A.I. RTE.	SECTION	COUNTY	TOTAL SHEETS	SHEET NO.
55	*	SANGAMON	26	10
STA.		TO STA.		
FED. ROAD DIST. NO.	ILLINOIS	FED. AID PROJECT		

\* D-6 CABLE MEDIAN BAR #2

CABLE GUARD MARKER

LOCATION	QUANTITY (EACH)
LT STA 374+25.00 TO STA 446+29.54 BK	180
LT STA 446+39.17 AH TO STA 456+25.00	25
LT STA 468+34.00 TO STA 521+73.00	133
RT STA 522+61.00 TO STA 582+64.00	150
RT STA 618+49.00 TO STA 695+32.26 BK	192
RT STA 355+49.48 AH TO STA 347+81.00	19
<b>TOTAL</b>	<b>699</b>

SEEDING, CLASS 2 (SPECIAL)

LOCATION	LENGTH (FOOT)	WIDTH (FOOT)	AREA (ACRES)
LT STA 374+25.00 TO STA 446+29.54 BK	7,205	6.0	0.99
LT STA 446+39.17 AH TO STA 456+25.00	986	6.0	0.14
LT STA 468+34.00 TO STA 521+73.00	5,339	6.0	0.74
LT STA 515+58.00 TO STA 521+73.00	615	6.0	0.08
RT STA 522+61.00 TO STA 582+64.00	6,003	6.0	0.83
RT STA 522+61.00 TO STA 528+76.00	615	6.0	0.08
RT STA 618+49.00 TO STA 695+32.26 BK	7,683	6.0	1.06
RT STA 355+49.48 AH TO STA 347+81.00	768	6.0	0.11
<b>TOTAL</b>			<b>4.03</b>

EXCAVATING AND GRADING EXISTING SHOULDER

LOCATION	LENGTH (FOOT)	LENGTH (UNIT)
LT STA 374+25.00 TO STA 446+29.54 BK	7,205	72.05
LT STA 446+39.17 AH TO STA 456+25.00	986	9.86
LT STA 468+34.00 TO STA 521+73.00	5,339	53.39
LT STA 515+58.00 TO STA 521+73.00	615	6.15
RT STA 522+61.00 TO STA 582+64.00	6,003	60.03
RT STA 522+61.00 TO STA 528+76.00	615	6.15
RT STA 618+49.00 TO STA 695+32.26 BK	7,683	76.83
RT STA 355+49.48 AH TO STA 347+81.00	768	7.68
<b>TOTAL</b>		<b>292.14</b>

EROSION CONTROL BLANKET

LOCATION	LENGTH (FOOT)	WIDTH (FOOT)	AREA (SQ YD)
LT STA 374+25.00 TO STA 446+29.54 BK	7,205	6.0	4,803.03
LT STA 446+39.17 AH TO STA 456+25.00	986	6.0	657.22
LT STA 468+34.00 TO STA 521+73.00	5,339	6.0	3,559.33
LT STA 515+58.00 TO STA 521+73.00	615	6.0	410.00
RT STA 522+61.00 TO STA 582+64.00	6,003	6.0	4,002.00
RT STA 522+61.00 TO STA 528+76.00	615	6.0	410.00
RT STA 618+49.00 TO STA 695+32.26 BK	7,683	6.0	5,122.17
RT STA 355+49.48 AH TO STA 347+81.00	768	6.0	512.32
<b>TOTAL</b>			<b>19,476.07</b>

PLOT DATE = 12/13/2006  
 FILE NAME = c:\p\projects\6553806\shsched\shs.dgn  
 PLOT SCALE = 1/8"=1'-0"  
 USER NAME = laughlin

REVISIONS	
NAME	DATE

ILLINOIS DEPARTMENT OF TRANSPORTATION  
 SCHEDULES OF QUANTITIES  
 FAI 55 (1-55)  
 SECTION D-6 CABLE MEDIAN BAR #2  
 SANGAMON COUNTY

SCALE: VERT.      DRAWN BY  
 HORIZ.              CHECKED BY  
 DATE

F.A.I. RTE.	SECTION	COUNTY	TOTAL SHEETS	SHEET NO.
55	.	SANGAMON	26	11

STA.	TO STA.
FED. ROAD DIST. NO.	ILLINOIS FED. AID PROJECT

\* D-6 CABLE MEDIAN BAR #2



EXIST. CURVE 375  
 PI STA. = 375+51.13  
 $\Delta = 12^\circ 32' 15''$  (LT)  
 $D = 1^\circ 15' 14''$   
 $R = 4,569.81'$   
 $T = 501.99'$   
 $L = 999.97'$   
 $E = 27.49'$   
 $e = \text{-----}$   
 $T.R. = \text{-----}$   
 $S.E. RUN = \text{-----}$   
 $P.C. STA. = 370+49.14$   
 $P.T. STA. = 380+49.11$

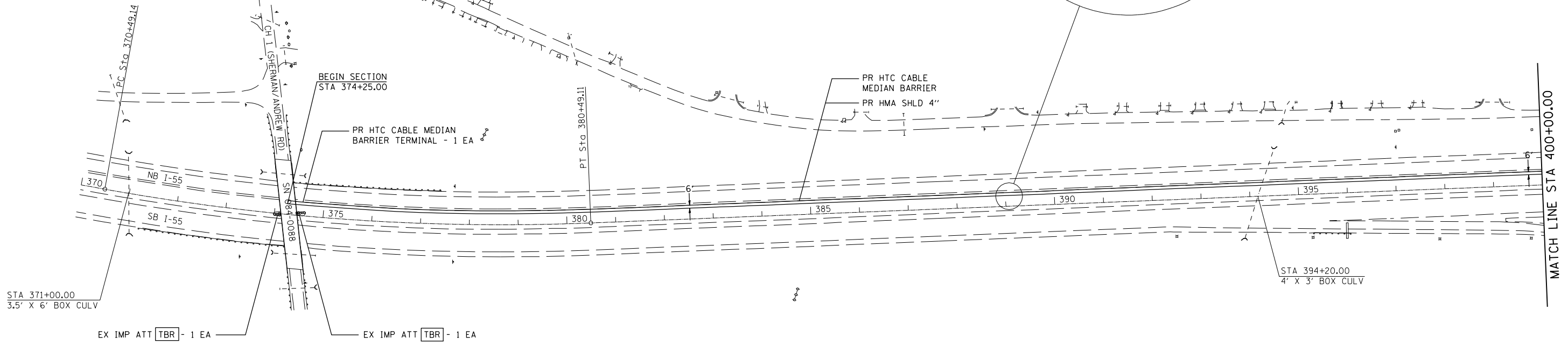
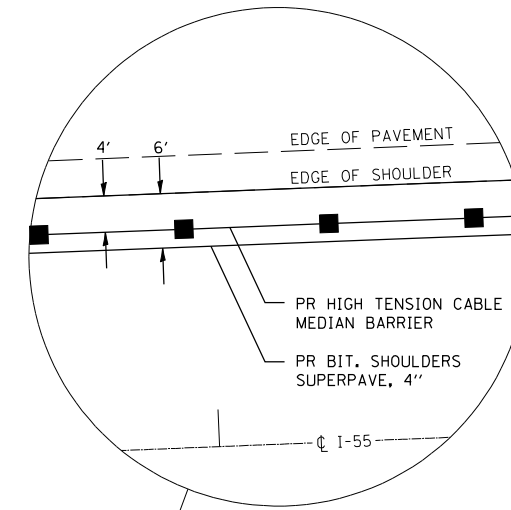

PLOT DATE = 12/13/2006  
 FILE NAME = c:\p\projects\653806\shplan1.dgn  
 PLOT SCALE = 211.7647 / IN.  
 USER NAME = laughlin-1

REVISIONS	
NAME	DATE

ILLINOIS DEPARTMENT OF TRANSPORTATION  
 PLAN SHEET  
 FAI 55 (I-55)  
 SECTION D-6 CABLE MEDIAN BAR #2  
 SANGAMON COUNTY  
 SCALE: VERT. \_\_\_\_\_  
 HORIZ. \_\_\_\_\_  
 DATE \_\_\_\_\_ DRAWN BY \_\_\_\_\_  
 CHECKED BY \_\_\_\_\_

F.A.I. RTE.	SECTION	COUNTY	TOTAL SHEETS	SHEET NO.
55	*	SANGAMON	26	12

STA.	TO STA.
FED. ROAD DIST. NO.	ILLINOIS FED. AID PROJECT

\* D-6 CABLE MEDIAN BAR #2

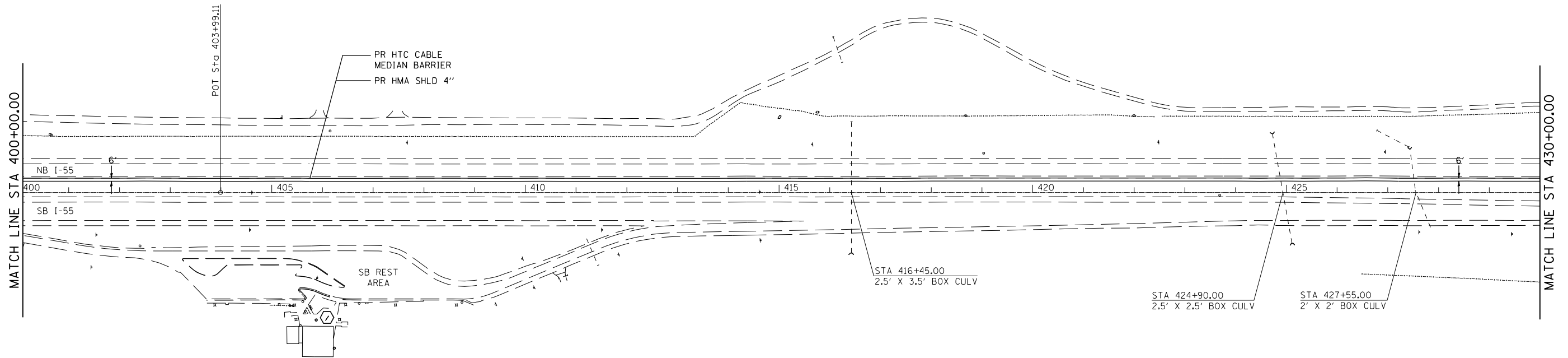

PLOT DATE = 12/13/2006  
 FILE NAME = c:\p\projects\653806\shiplan1.dgn  
 PLOT SCALE = 211.7647 / IN.  
 USER NAME = laughlin-1

REVISIONS	
NAME	DATE

ILLINOIS DEPARTMENT OF TRANSPORTATION  
 PLAN SHEET  
 FAI 55 (I-55)  
 SECTION D-6 CABLE MEDIAN BAR #2  
 SANGAMON COUNTY  
 SCALE: VERT.      DRAWN BY  
           HORIZ.      CHECKED BY  
 DATE

F.A.I. RTE.	SECTION	COUNTY	TOTAL SHEETS	SHEET NO.
55	.	SANGAMON	26	13

STA.	TO STA.
FED. ROAD DIST. NO.	ILLINOIS FED. AID PROJECT

• D-6 CABLE MEDIAN BAR #2

EXIST. CURVE 438  
 PI STA. = 438+55.52  
 $\Delta = 7^\circ 12' 51''$  (LT)  
 $D = 0^\circ 27' 55''$   
 $R = 12,310.76'$   
 $T = 776.07'$   
 $L = 1,550.09'$   
 $E = 24.44'$   
 $e = \text{-----}$   
 $T.R. = \text{-----}$   
 $S.E. RUN = \text{-----}$   
 $P.C. STA. = 430+79.45$   
 $P.T. STA. = 446+29.54$

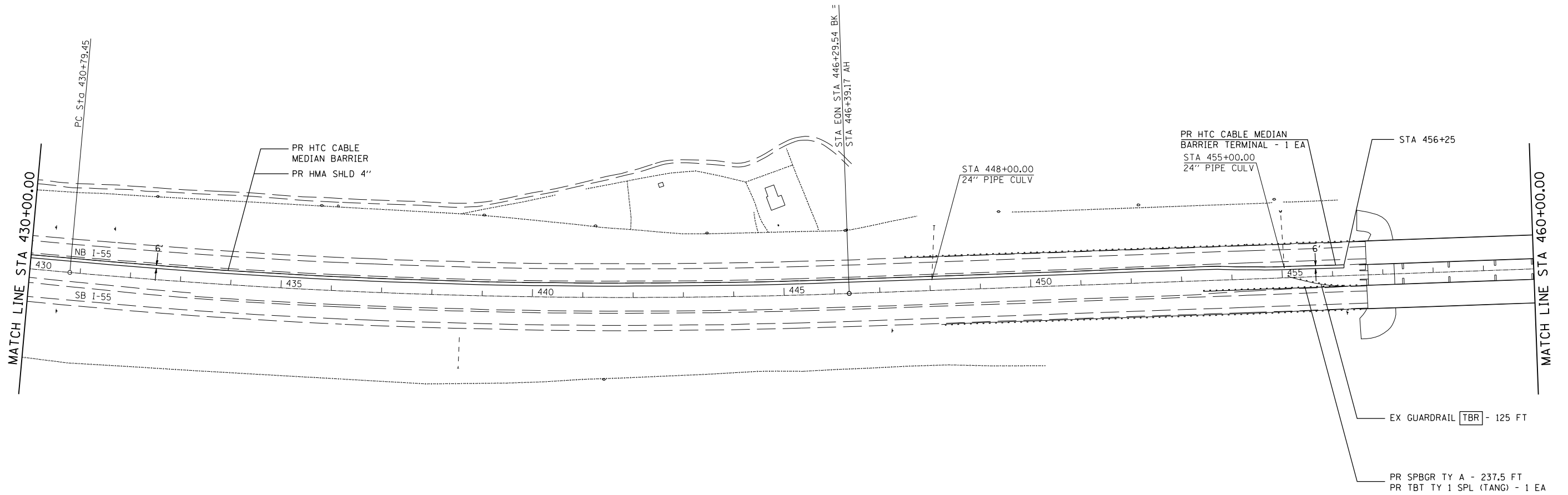

PLOT DATE = 12/13/2006  
 FILE NAME = c:\p\projects\653806\shplan1.dgn  
 PLOT SCALE = 211.7647 / IN.  
 USER NAME = laughlin-1

REVISIONS	
NAME	DATE

ILLINOIS DEPARTMENT OF TRANSPORTATION  
 PLAN SHEET  
 FAI 55 (I-55)  
 SECTION D-6 CABLE MEDIAN BAR #2  
 SANGAMON COUNTY

SCALE: VERT. \_\_\_\_\_  
 HORIZ. \_\_\_\_\_  
 DATE \_\_\_\_\_ DRAWN BY \_\_\_\_\_  
 CHECKED BY \_\_\_\_\_

F.A.I. RTE.	SECTION	COUNTY	TOTAL SHEETS	SHEET NO.
55	*	SANGAMON	26	14

STA.	TO STA.
FED. ROAD DIST. NO.	ILLINOIS FED. AID PROJECT

\* D-6 CABLE MEDIAN BAR #2

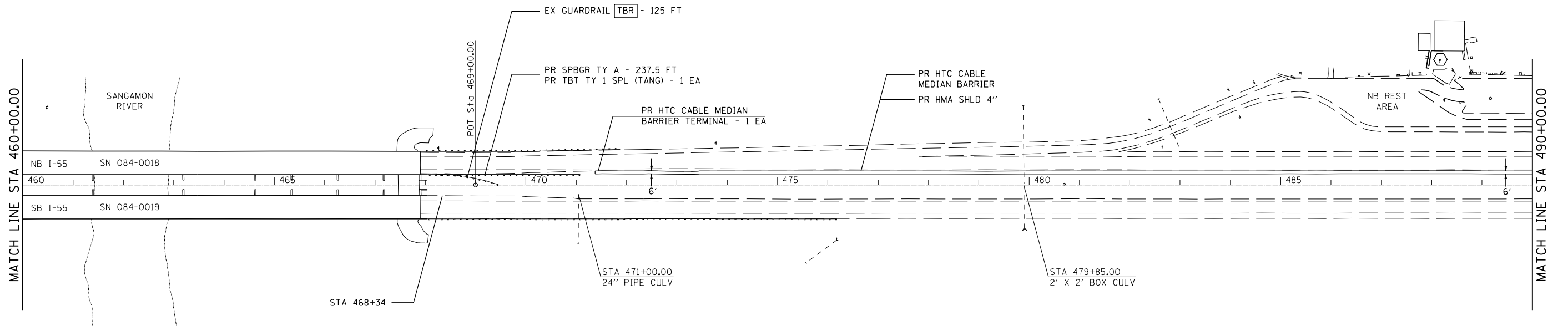

PLOT DATE = 12/13/2006  
 FILE NAME = c:\p\projects\4653806\shplan1.dgn  
 PLOT SCALE = 211.7647 / IN.  
 USER NAME = laughlin-1

REVISIONS	
NAME	DATE

ILLINOIS DEPARTMENT OF TRANSPORTATION  
 PLAN SHEET  
 FAI 55 (I-55)  
 SECTION D-6 CABLE MEDIAN BAR #2  
 SANGAMON COUNTY  
 SCALE: VERT. \_\_\_\_\_  
 HORIZ. \_\_\_\_\_  
 DATE \_\_\_\_\_ DRAWN BY \_\_\_\_\_  
 CHECKED BY \_\_\_\_\_

F.A.I. RTE.	SECTION	COUNTY	TOTAL SHEETS	SHEET NO.
55	.	SANGAMON	26	15

STA.	TO STA.
FED. ROAD DIST. NO.	ILLINOIS FED. AID PROJECT

• D-6 CABLE MEDIAN BAR #2

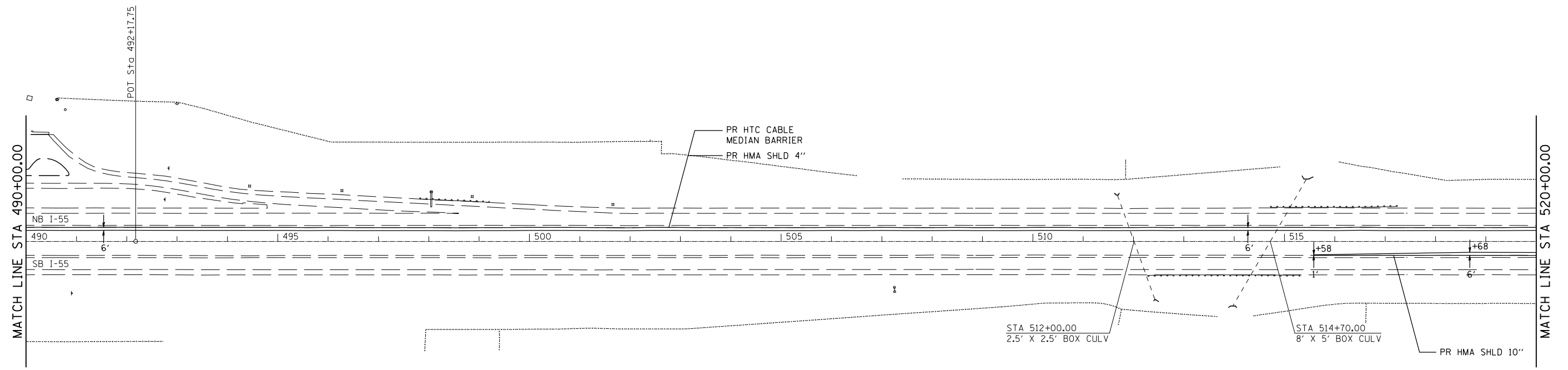

PLOT DATE = 12/13/2006  
 FILE NAME = c:\projects\653806\shplan1.dgn  
 PLOT SCALE = 211.7647 / IN.  
 USER NAME = laughlin-1

REVISIONS	
NAME	DATE

ILLINOIS DEPARTMENT OF TRANSPORTATION  
 PLAN SHEET  
 FAI 55 (I-55)  
 SECTION D-6 CABLE MEDIAN BAR #2  
 SANGAMON COUNTY  
 SCALE: VERT.      DRAWN BY  
           HORIZ.      CHECKED BY  
 DATE

F.A.I. RTE.	SECTION	COUNTY	TOTAL SHEETS	SHEET NO.
55	*	SANGAMON	26	16

STA.	TO STA.
FED. ROAD DIST. NO.	ILLINOIS FED. AID PROJECT

\* D-6 CABLE MEDIAN BAR #2

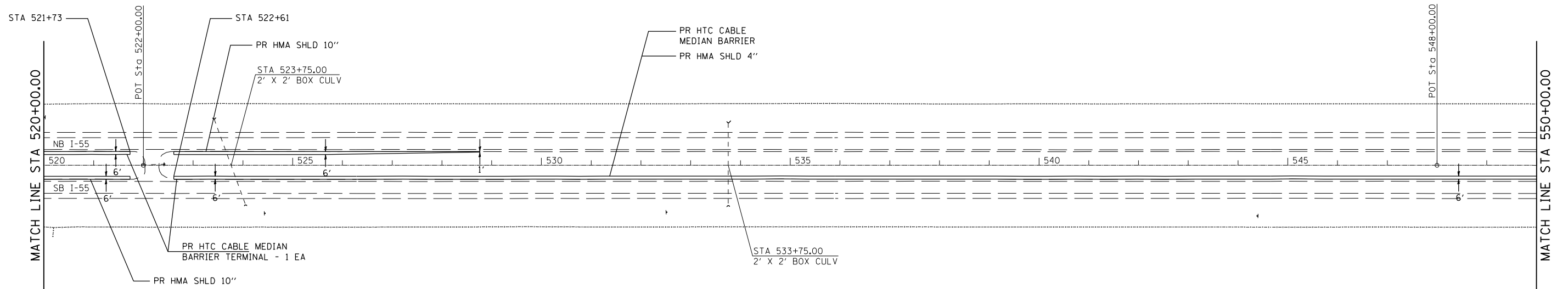

PLOT DATE = 12/13/2006  
 FILE NAME = c:\p\projects\4653806\shplan1.dgn  
 PLOT SCALE = 211.7647 / IN.  
 USER NAME = laughlin-1

REVISIONS	
NAME	DATE

ILLINOIS DEPARTMENT OF TRANSPORTATION  
 PLAN SHEET  
 FAI 55 (I-55)  
 SECTION D-6 CABLE MEDIAN BAR #2  
 SANGAMON COUNTY

SCALE: VERT. / HORIZ.  
 DATE: / /  
 DRAWN BY: /  
 CHECKED BY: /



F.A.I. RTE.	SECTION	COUNTY	TOTAL SHEETS	SHEET NO.
55	.	SANGAMON	26	17

STA.	TO STA.
FED. ROAD DIST. NO.	ILLINOIS FED. AID PROJECT

\* D-6 CABLE MEDIAN BAR #2

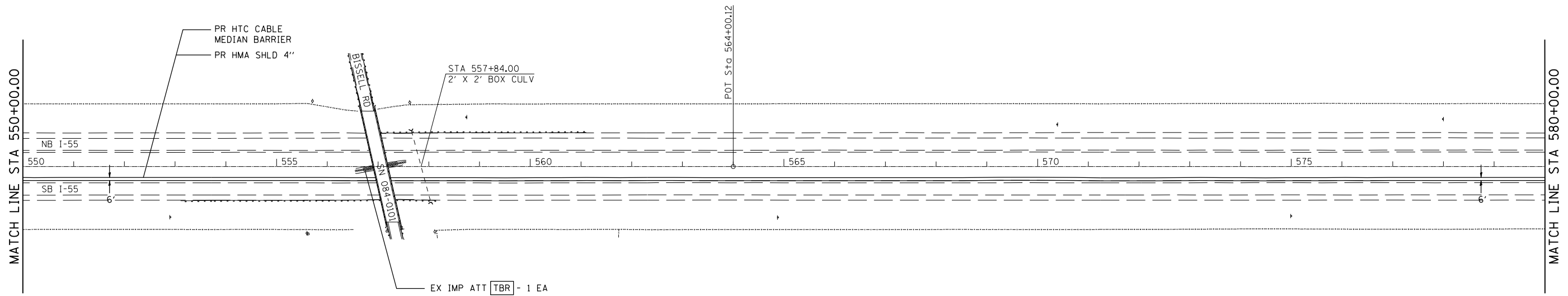

PLOT DATE = 12/13/2006  
 FILE NAME = c:\p\projects\653806\shplan1.dgn  
 PLOT SCALE = 211.7647 / IN.  
 USER NAME = laughlin-1

REVISIONS	
NAME	DATE

ILLINOIS DEPARTMENT OF TRANSPORTATION  
 PLAN SHEET  
 FAI 55 (I-55)  
 SECTION D-6 CABLE MEDIAN BAR #2  
 SANGAMON COUNTY  
 SCALE: VERT.      DRAWN BY  
           HORIZ.      CHECKED BY  
 DATE

F.A.I. RTE.	SECTION	COUNTY	TOTAL SHEETS	SHEET NO.
55	*	SANGAMON	26	18
STA.		TO STA.		
FED. ROAD DIST. NO.	ILLINOIS	FED. AID PROJECT		

\* D-6 CABLE MEDIAN BAR #2

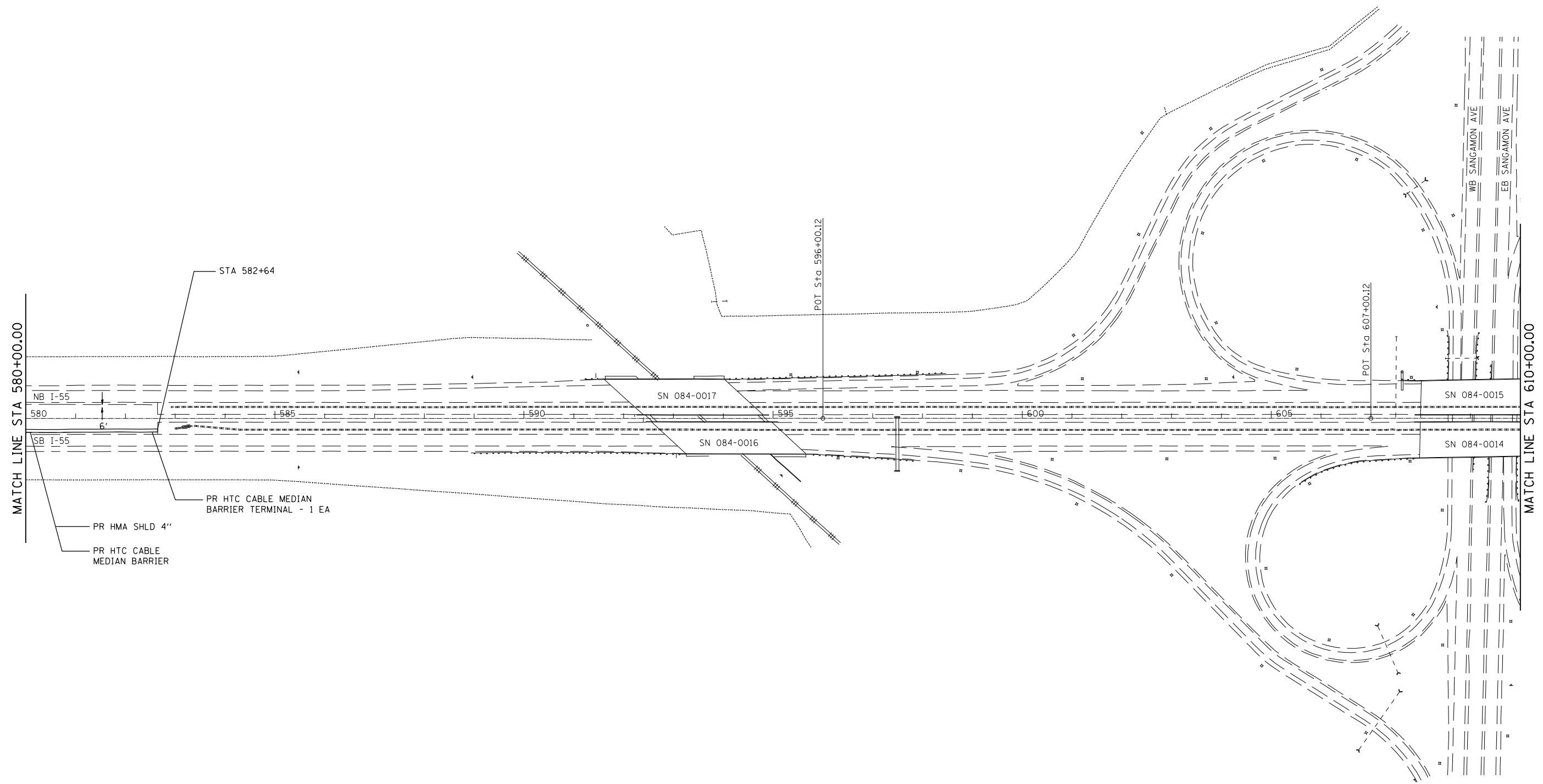

PLOT DATE = 12/13/2006  
 FILE NAME = c:\p\projects\653806\shplan1.dgn  
 PLOT SCALE = 211.7647 / IN.  
 USER NAME = laughlin-1

REVISIONS	
NAME	DATE

ILLINOIS DEPARTMENT OF TRANSPORTATION  
 PLAN SHEET  
 FAI 55 (I-55)  
 SECTION D-6 CABLE MEDIAN BAR #2  
 SANGAMON COUNTY  
 SCALE: VERT. / HORIZ.  
 DATE: / /  
 DRAWN BY: /  
 CHECKED BY: /

F.A.I. RTE.	SECTION	COUNTY	TOTAL SHEETS	SHEET NO.
55	*	SANGAMON	26	19

STA.	TO STA.
FED. ROAD DIST. NO.	ILLINOIS FED. AID PROJECT

\* D-6 CABLE MEDIAN BAR #2

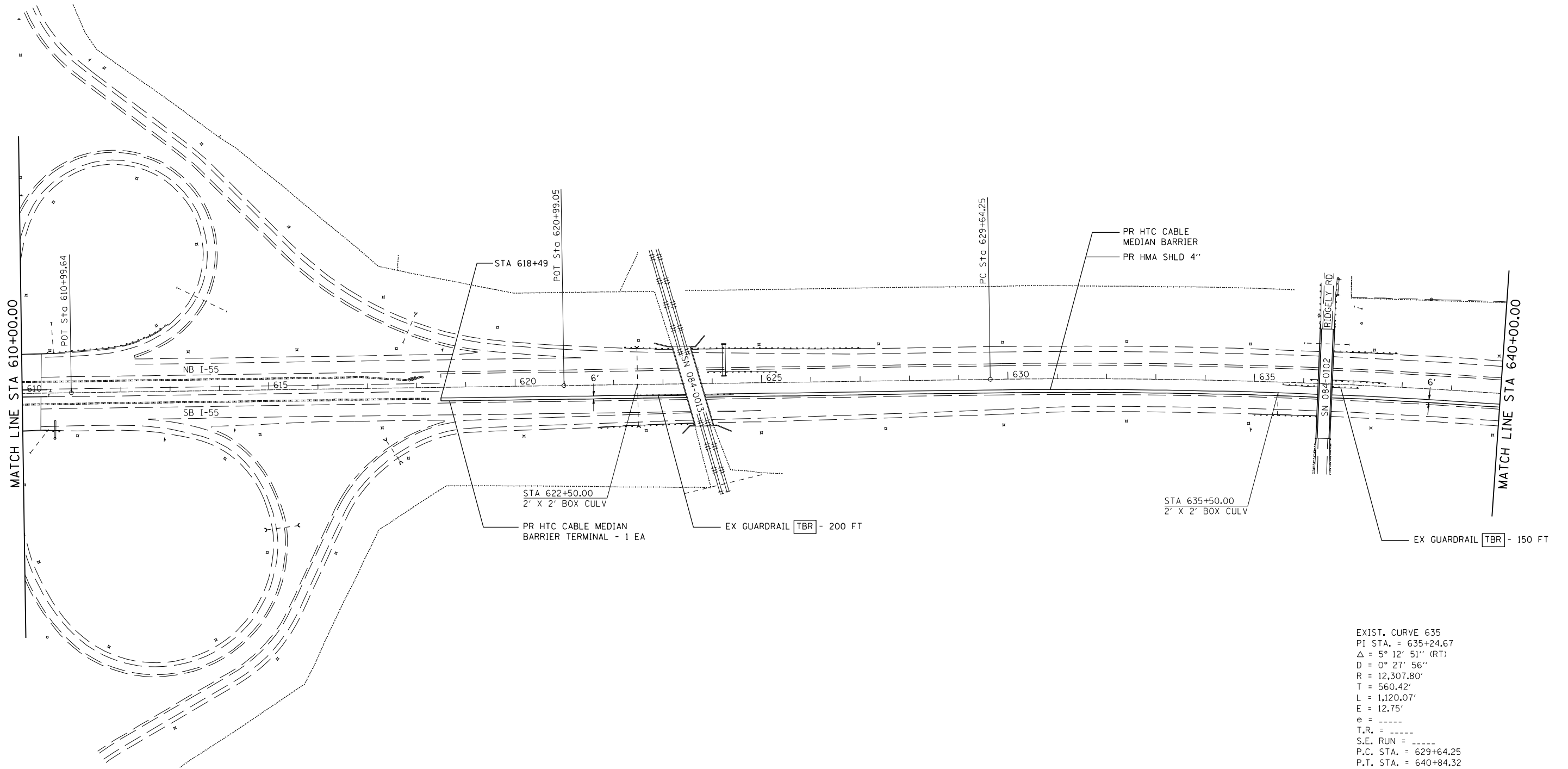

EXIST. CURVE 635  
 PI STA. = 635+24.67  
 Δ = 5° 12' 51" (RT)  
 D = 0° 27' 56"  
 R = 12,307.80'  
 T = 560.42'  
 L = 1,120.07'  
 E = 12.75'  
 e = ----  
 T.R. = ----  
 S.E. RUN = ----  
 P.C. STA. = 629+64.25  
 P.T. STA. = 640+84.32

PLOT DATE = 12/13/2006  
 FILE NAME = c:\p\projects\653806\shplan1.dgn  
 PLOT SCALE = 211.7647 / IN.  
 USER NAME = laughlin-1

REVISIONS	
NAME	DATE

ILLINOIS DEPARTMENT OF TRANSPORTATION  
 PLAN SHEET  
 FAI 55 (I-55)  
 SECTION D-6 CABLE MEDIAN BAR #2  
 SANGAMON COUNTY  
 SCALE: VERT. \_\_\_\_\_  
 HORIZ. \_\_\_\_\_  
 DATE \_\_\_\_\_ DRAWN BY \_\_\_\_\_  
 CHECKED BY \_\_\_\_\_

F.A.I. RTE.	SECTION	COUNTY	TOTAL SHEETS	SHEET NO.
55	*	SANGAMON	26	20

STA.	TO STA.
FED. ROAD DIST. NO.	ILLINOIS FED. AID PROJECT

\* D-6 CABLE MEDIAN BAR #2

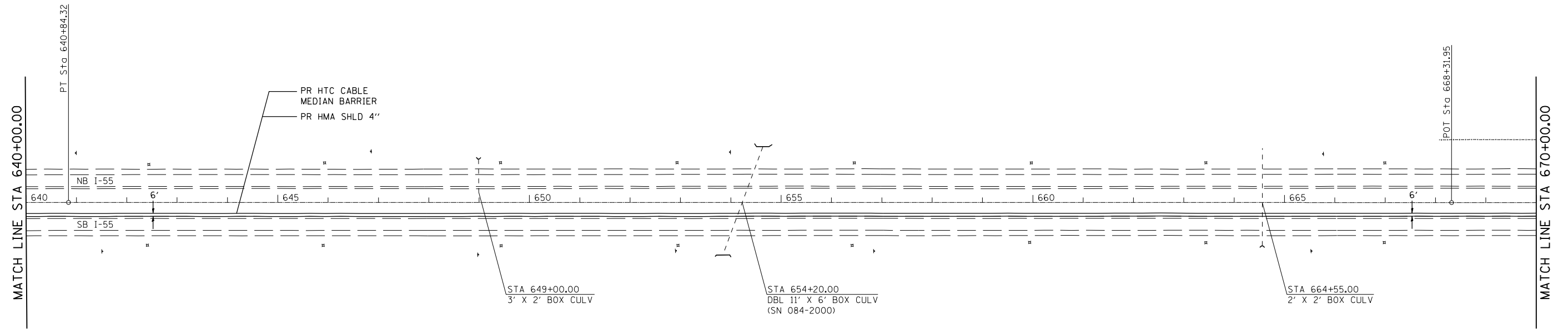

PLOT DATE = 12/13/2006  
 FILE NAME = c:\p\projects\6553806\shplan1.dgn  
 PLOT SCALE = 211.7647 / IN.  
 USER NAME = laughlin-1

REVISIONS	
NAME	DATE

ILLINOIS DEPARTMENT OF TRANSPORTATION  
 PLAN SHEET  
 FAI 55 (I-55)  
 SECTION D-6 CABLE MEDIAN BAR #2  
 SANGAMON COUNTY  
 SCALE: VERT.      DRAWN BY  
 HORIZ.              CHECKED BY  
 DATE

F.A.I. RTE.	SECTION	COUNTY	TOTAL SHEETS	SHEET NO.
55	*	SANGAMON	26	21

STA.	TO STA.
FED. ROAD DIST. NO.	ILLINOIS FED. AID PROJECT

\* D-6 CABLE MEDIAN BAR #2

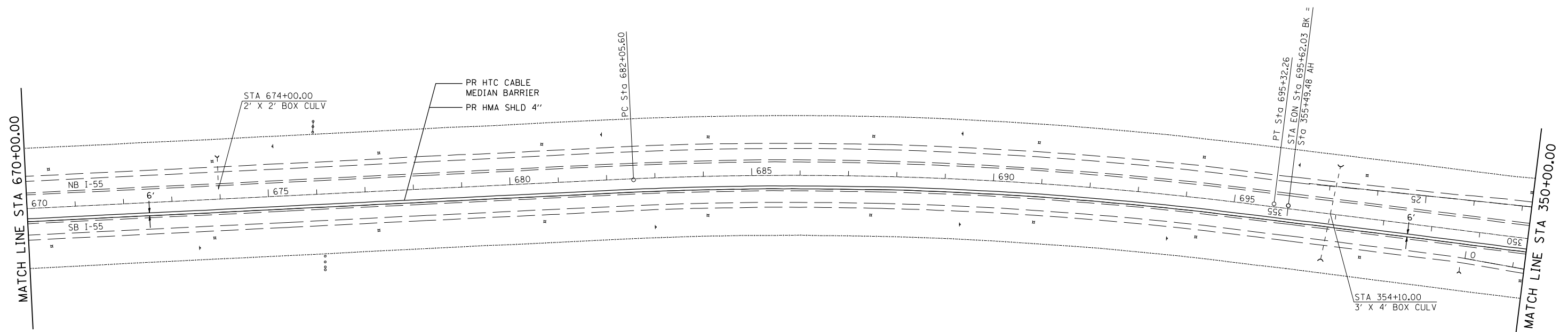

EXIST. CURVE 688  
 PI STA. = 688+70.61  
 $\Delta = 9^\circ 57' 48''$  (RT)  
 $D = 0^\circ 45' 04''$   
 $R = 7,629.11'$   
 $T = 665.01'$   
 $L = 1,326.67'$   
 $E = 28.93'$   
 $e = \text{-----}$   
 $T.R. = \text{-----}$   
 $S.E. \text{ RUN} = \text{-----}$   
 P.C. STA. = 682+05.60  
 P.T. STA. = 695+32.26

PLOT DATE = 12/13/2006  
 FILE NAME = c:\p\projects\653806\shplan1.dgn  
 PLOT SCALE = 211.7647 / IN.  
 USER NAME = laughlin-1

REVISIONS	
NAME	DATE

ILLINOIS DEPARTMENT OF TRANSPORTATION  
 PLAN SHEET  
 FAI 55 (I-55)  
 SECTION D-6 CABLE MEDIAN BAR #2  
 SANGAMON COUNTY  
 SCALE: VERT. \_\_\_\_\_  
 HORIZ. \_\_\_\_\_  
 DATE \_\_\_\_\_ DRAWN BY \_\_\_\_\_  
 CHECKED BY \_\_\_\_\_

F.A.I. RTE.	SECTION	COUNTY	TOTAL SHEETS	SHEET NO.
55	*	SANGAMON	26	22

STA.	TO STA.
FED. ROAD DIST. NO.	ILLINOIS FED. AID PROJECT

\* D-6 CABLE MEDIAN BAR #2

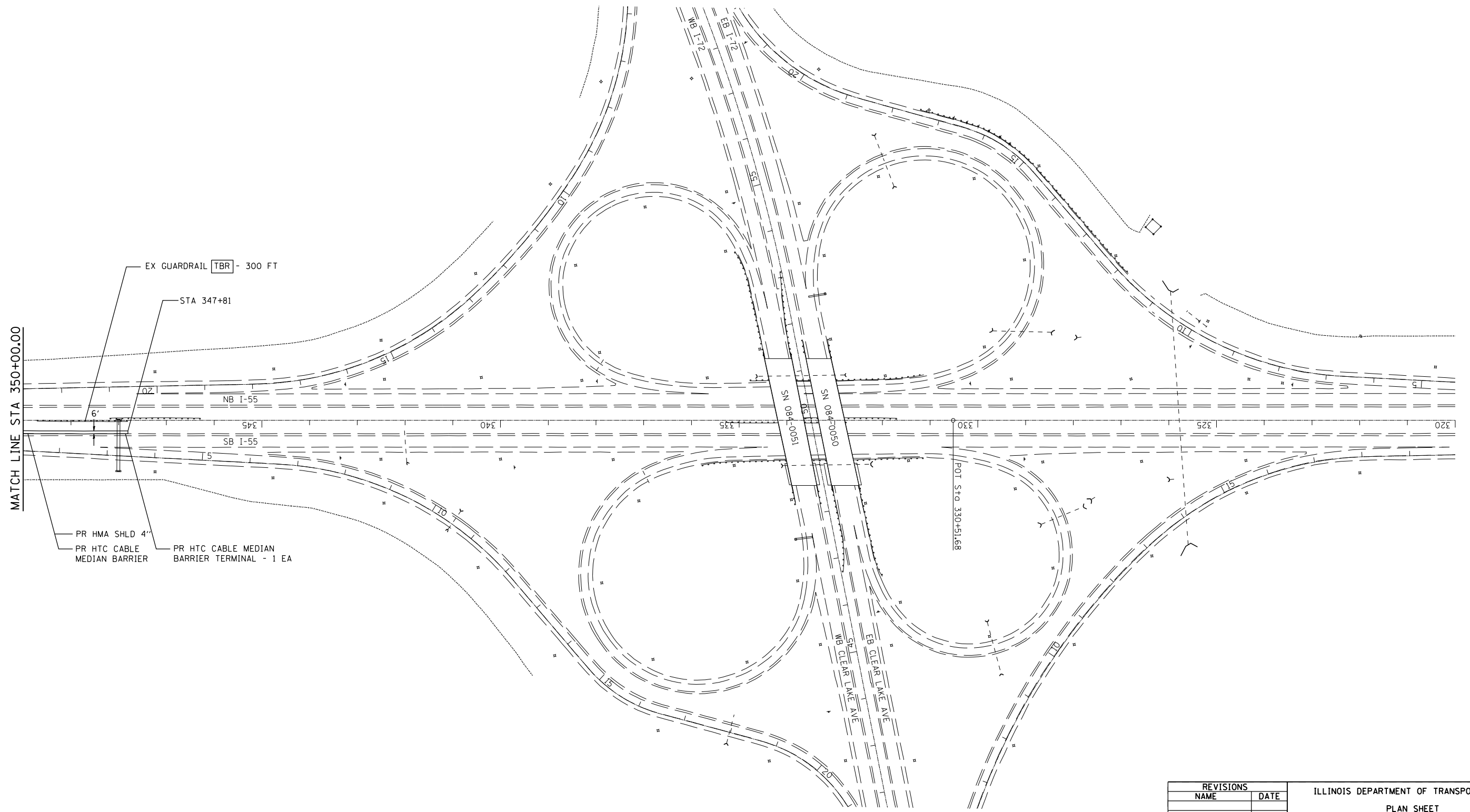

PLOT DATE = 12/13/2006  
 FILE NAME = c:\p\projects\653806\shplan1.dgn  
 PLOT SCALE = 211.7647 / IN.  
 USER NAME = laughlin-1

REVISIONS	
NAME	DATE

ILLINOIS DEPARTMENT OF TRANSPORTATION  
 PLAN SHEET  
 FAI 55 (I-55)  
 SECTION D-6 CABLE MEDIAN BAR #2  
 SANGAMON COUNTY  
 SCALE: VERT. / HORIZ.  
 DATE: / /  
 DRAWN BY: /  
 CHECKED BY: /

F.A.I. RTE.	SECTION	COUNTY	TOTAL SHEETS	SHEET NO.
55	*	SANGAMON	26	23
STA.		TO STA.		
FED. ROAD DIST. NO.	ILLINOIS	FED. AID PROJECT		

\* - D-6 CABLE MEDIAN BAR #2

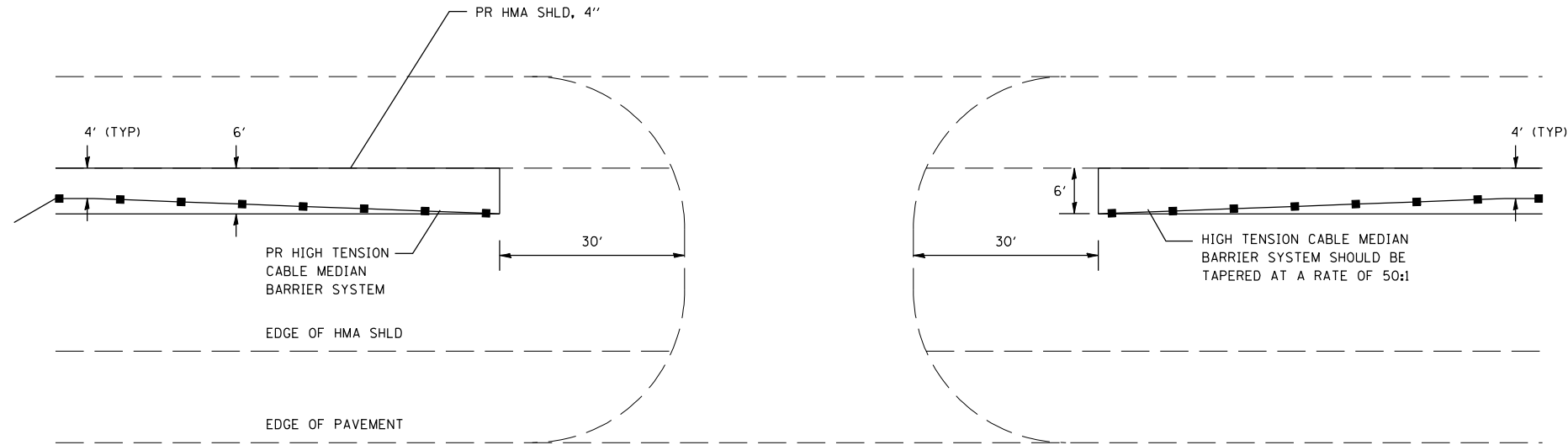

EMERGENCY MEDIAN CROSSOVER

NOT TO SCALE

NOTES:

1. POSTS SHALL BE DRIVEN, IN ACCORDANCE WITH MANUFACTURER'S SPECIFICATIONS.
2. POST SPACING MAY BE ALTERED TO AVOID DRAINAGE STRUCTURES OR OTHER OBSTACLES.

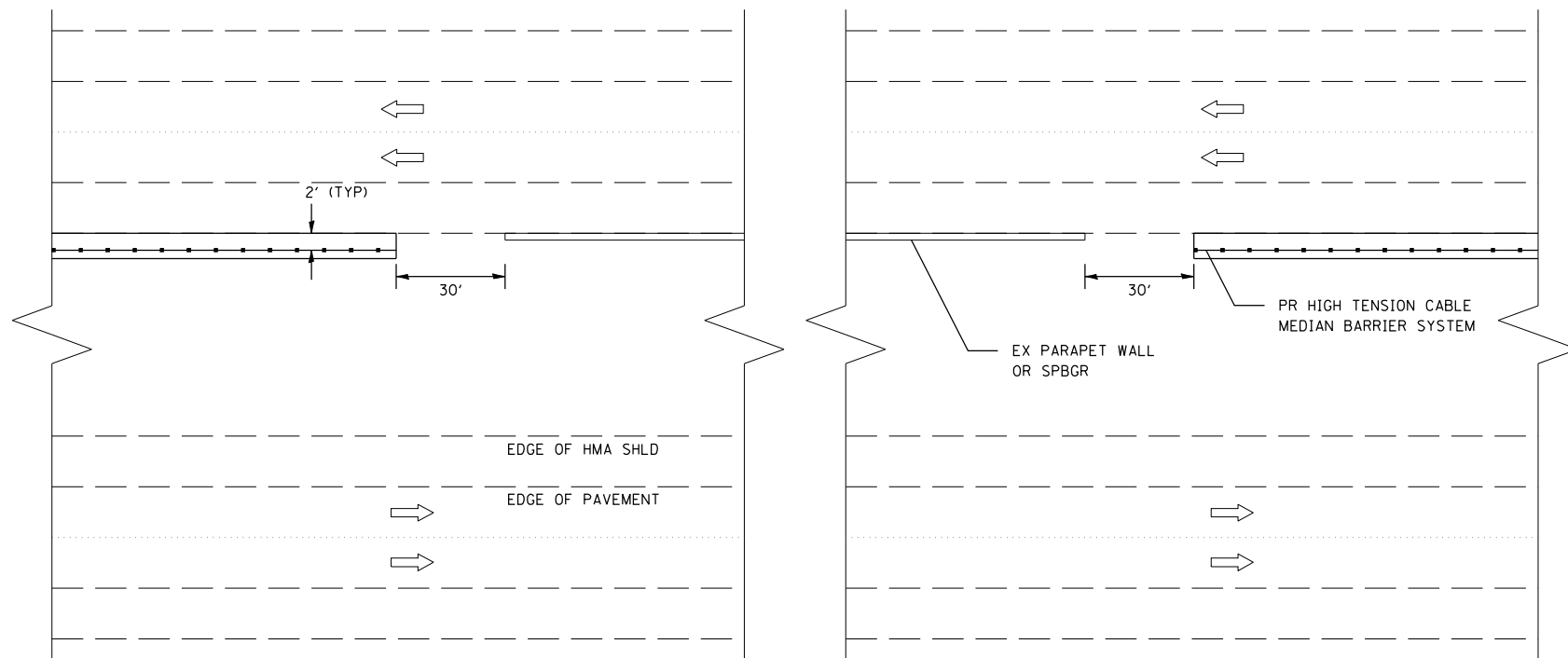

ADJACENT TO MAINLINE STRUCTURES

NOT TO SCALE

REVISIONS	
NAME	DATE

ILLINOIS DEPARTMENT OF TRANSPORTATION  
 DETAILS  
 FAI 55 (I-55)  
 SECTION D-6 CABLE MEDIAN BAR #2  
 SANGAMON COUNTY

SCALE: VERT.  
 HORIZ.  
 DATE

DRAWN BY  
 CHECKED BY

PLOT DATE = 12/13/2006  
 FILE NAME = c:\p\projects\4653806\shd\detail.dgn  
 PLOT SCALE = 211.7647 / IN.  
 USER NAME = laughlin-1

F.A.I. RTE.	SECTION	COUNTY	TOTAL SHEETS	SHEET NO.
55	*	SANGAMON	26	24

STA.	TO STA.
FED. ROAD DIST. NO.	ILLINOIS FED. AID PROJECT
* - D-6 CABLE MEDIAN BAR #2	

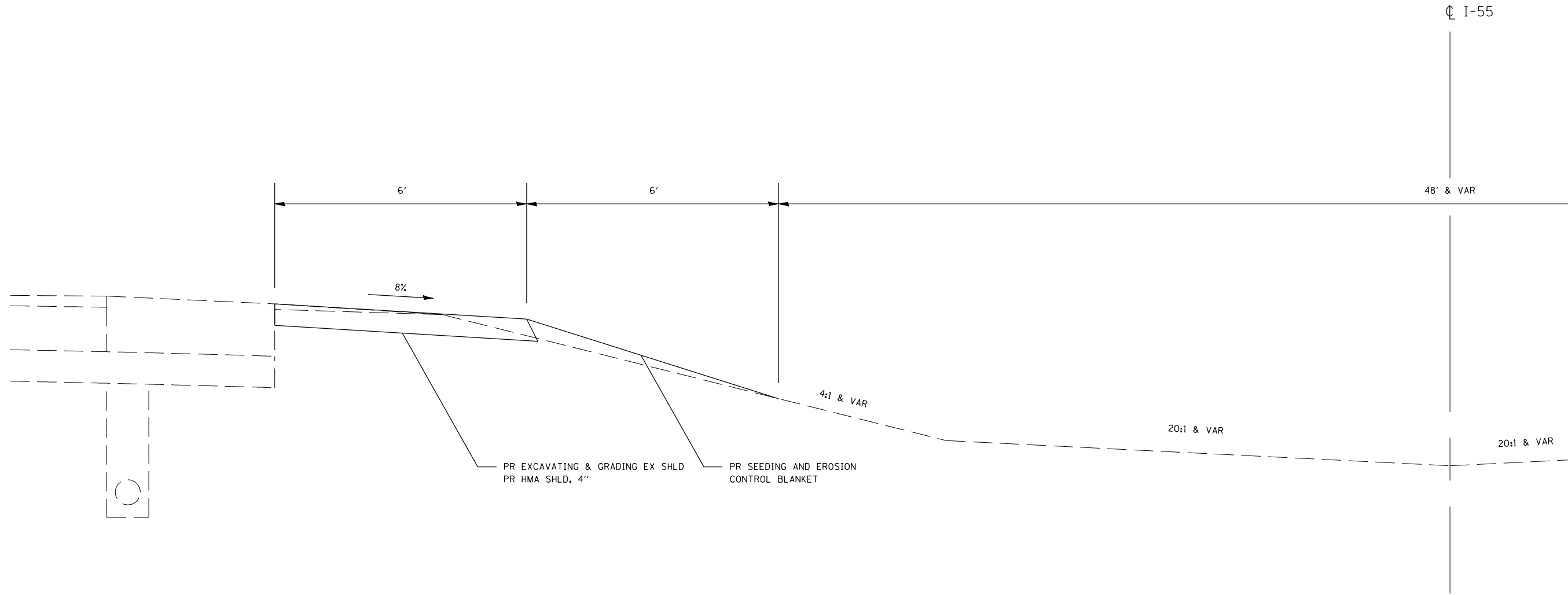

PR EXCAVATING & GRADING EX SHLD  
PR HMA SHLD, 4"

PR SEEDING AND EROSION  
CONTROL BLANKET

NOTES:

- EXCAVATION FOR THE HMA SHOULDER WILL BE MEASURED AND PAID FOR AS EXCAVATING AND GRADING EXISTING SHOULDER, WHICH SHALL INCLUDE GRADING AND COMPACTING THE FILL AREA TO THE SATISFACTION OF THE ENGINEER.
- DURING THE GRADING OPERATIONS, CARE SHALL BE TAKEN NOT TO FILL OR DISTURB EXISTING PIPE UNDERDRAIN HEADWALLS OR OTHER DRAINAGE STRUCTURES.

NOT TO SCALE

REVISIONS	
NAME	DATE

ILLINOIS DEPARTMENT OF TRANSPORTATION  
GRADING DETAIL  
FAI 55 (I-55)  
SECTION D-6 CABLE MEDIAN BAR #2  
SANGAMON COUNTY

SCALE: VERT. \_\_\_\_\_  
HORIZ. \_\_\_\_\_  
DATE \_\_\_\_\_

DRAWN BY \_\_\_\_\_  
CHECKED BY \_\_\_\_\_

PLOT DATE = 12/13/2006  
FILE NAME = c:\p\projects\4653806\shd\detail.dgn  
PLOT SCALE = 211.7647 / IN.  
USER NAME = laughlin-1



F.A.I. RTE.	SECTION	COUNTY	TOTAL SHEETS	SHEET NO.
55	*	SANGAMON	26	25
STA.		TO STA.		
FED. ROAD DIST. NO.		ILLINOIS FED. AID PROJECT		

\* - D-6 CABLE MEDIAN BAR #2

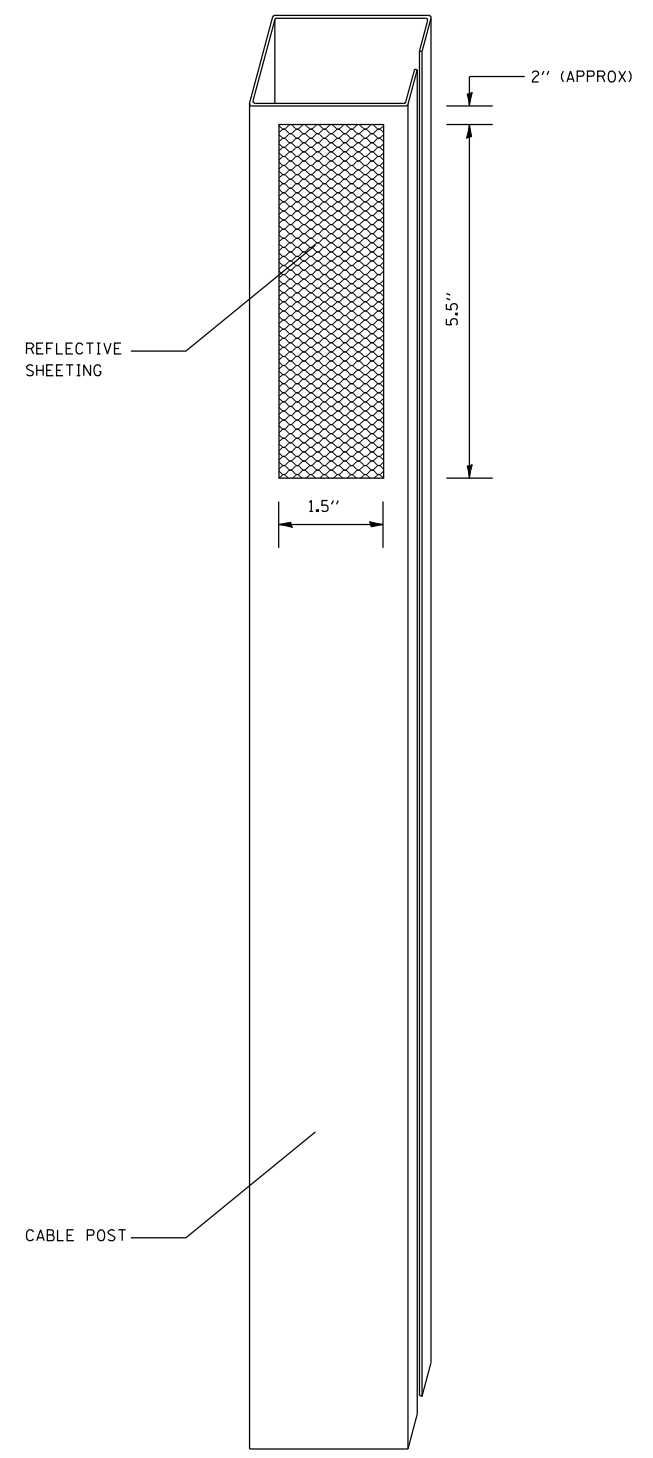

NOTES:

MATERIAL: THE MATERIAL SHALL BE IN ACCORDANCE WITH SECTION 1090 AND 1091 OF THE STANDARD SPECIFICATIONS.

CONSTRUCTION REQUIREMENTS: THE REFLECTIVE SHEETING SHALL BE INSTALLED DIRECTLY ON THE CABLE POSTS. THE REFLECTIVE SHEETING SHALL BE INSTALLED AS SHOWN IN THE PLANS, ON EVERY OTHER POST (IN ORDER TO PROVIDE A SPACING OF 40'). THE SURFACE OF THE POST SHALL BE CLEANED OF ALL CONTAMINANTS PRIOR TO THE INSTALLATION OF THE REFLECTIVE SHEETING. THE SURFACE SHALL BE CLEANED USING A 5-8 PERCENT PHOSPHORIC ACID SOLUTION AND RINSED WITH CLEAN WATER OR AS RECOMMENDED BY THE MANUFACTURER OF THE REFLECTIVE SHEETING AND AS APPROVED BY THE ENGINEER.

BASIS OF PAYMENT: THIS WORK WILL BE PAID FOR AT THE CONTRACT UNIT PRICE EACH FOR CABLE GUARD MARKER.

CABLE GUARD MARKER				QUANTITY
LOCATION				( EACH)
LT STA 374+25.00	TO	STA 446+29.54 BK		180
LT STA 446+39.17 AH	TO	STA 456+25.00		25
LT STA 468+34.00	TO	STA 521+73.00		133
RT STA 522+61.00	TO	STA 582+64.00		150
RT STA 618+49.00	TO	STA 695+32.26 BK		192
RT STA 355+49.48 AH	TO	STA 347+81.00		19
TOTAL				699

PLOT DATE = 12/13/2006  
 FILE NAME = c:\p\projects\4653806\shdetail.dgn  
 PLOT SCALE = 211.7647 / IN.  
 USER NAME = laughlin-1

REVISIONS		ILLINOIS DEPARTMENT OF TRANSPORTATION CABLE GUARD MARKER DETAIL
NAME	DATE	
		FAI 55 (I-55) SECTION D-6 CABLE MEDIAN BAR #2 SANGAMON COUNTY
SCALE: VERT.	DRAWN BY	CHECKED BY
HORIZ.		
DATE		

F.A.I. RTE.	SECTION	COUNTY	TOTAL SHEETS	SHEET NO.
55	.	SANGAMON	26	26
STA.		TO STA.		
FED. ROAD DIST. NO.		ILLINOIS FED. AID PROJECT		

\* - D-6 CABLE MEDIAN BAR #2

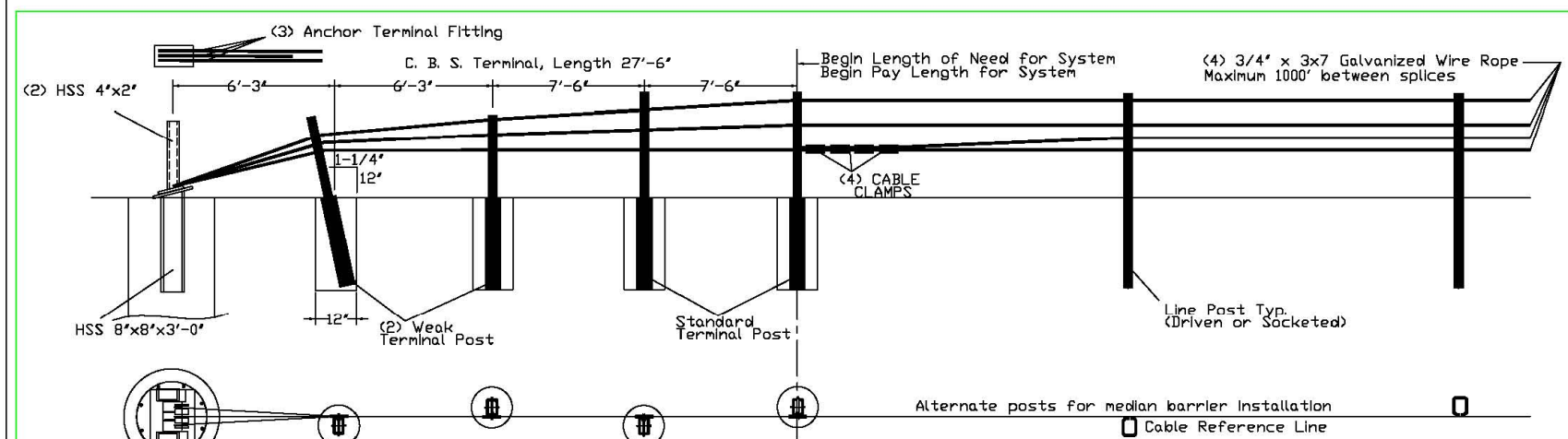

- ### GENERAL NOTES
- For additional information contact Gibraltar, Inc. at 1-800-495-8957, or see the manufacture's product manual.
  - All concrete shall be minimum 2500 PSI.
  - Alternate Post for bi-directional traffic flow. If installed for traffic in one direction install cables on traffic side of posts.
  - The Cable Barrier System shall be installed on median shoulders or on depressed medians with slopes of 6:1 or flatter.
  - The Cable Barrier System is accepted by the FHWA Test Level - 4
  - See the MUTCD for proper "Barrier" delineation
  - Rock Clause: Where solid rock is encountered:
    - For socketed post, continue digging 12" diameter, 15' deep into rock or the required plan depth whichever comes first.
    - For driven post, core drill a 4" diameter hole 18" deep into rock or the required plan depth, whichever comes first.
    - For Anchor post, continue digging 24" diameter, 30' deep into rock or the required plan depth, whichever comes first.
  - Every component to be galvanized.

Tension (lbs)	Force (kips)
-10F	8000
0	7600
10	7200
20	6800
30	6400
40	6000
50	5600
60	5200
70	4800
80	4400
90	4000
100	3600
110	3200

Allowable Deviation from Chart +/- 200 lbs/force

Deflection	Post Spacing
9'3"	30.FT
9'	28.FT
8'	20.FT
7'	12.FT
6'8"	10.FT

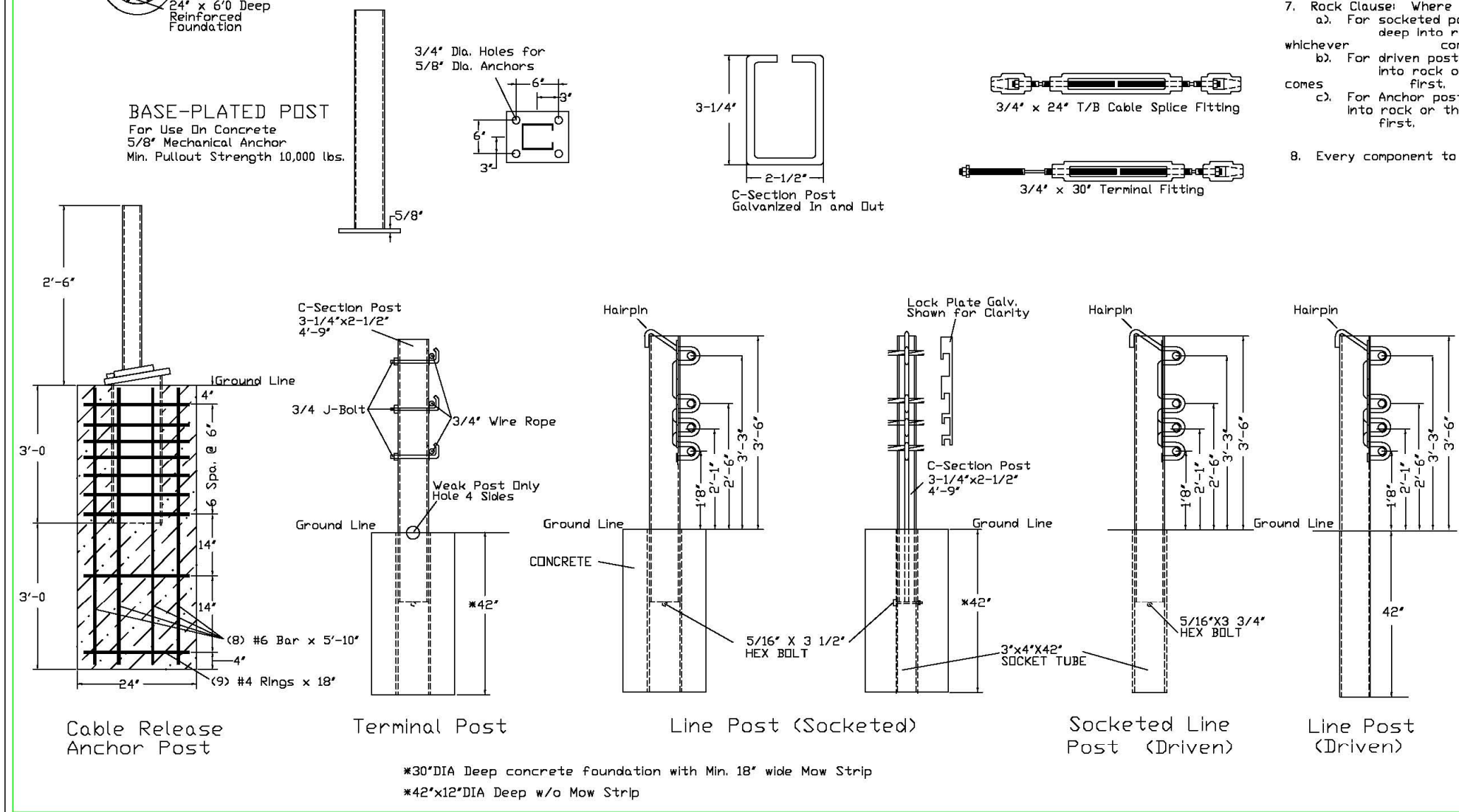

**Cable Barrier System**  
Patent Pending

**GIBRALTAR** 320 Southland Road  
Burnet, Texas 78611  
1-800-495-8957

TL-4 4 CABLE SYSTEM    DATE: 10/13/06    DRAFTER: EJ

PLOT DATE = 12/13/2006  
 FILE NAME = c:\p\projects\4653806\shideout\tdgn  
 PLOT SCALE = 211.7647 / IN.  
 USER NAME = laughlin-1

REVISIONS	
NAME	DATE

ILLINOIS DEPARTMENT OF TRANSPORTATION  
GIBRALTAR CABLE BARRIER DETAILS

FAI 55 (I-55)  
SECTION D-6 CABLE MEDIAN BAR #2  
SANGAMON COUNTY

SCALE: VERT.    DRAWN BY  
          HORIZ.         CHECKED BY  
DATE