

F.A.S. RTE.	SECTION	COUNTY	TOTAL SHEETS	SHEET NO.
1842	106BR	ST CLAIR	61	8
STA.		TO STA.		
FED. ROAD DIST. NO.		ILLINOIS FED. AID PROJECT		

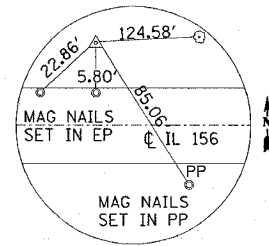

TIE POINT #1
I.P. W/IDOT CAP

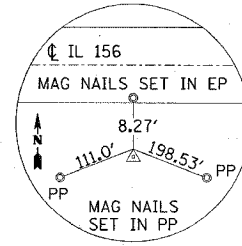

TIE POINT #2
I.P. W/IDOT CAP
IN FIELD ENTRANCE

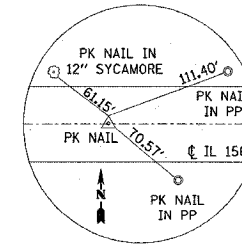

TIE POINT #3
TIES P.O.T.
STA. 660+00

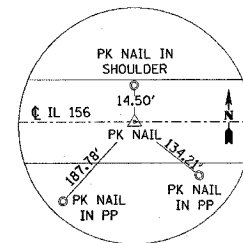

TIE POINT #5
TIES P.O.T.
EAST OF BRIDGE
STA. 679+00.

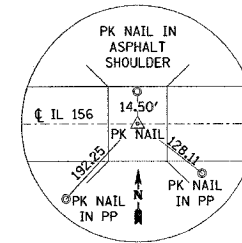

TIE POINT #4
CENTER OF BRIDGE
STA. 669+84.84

BENCHMARKS

ELEV.	DESCRIPTION
416.65	A CHISELED "□" N.W. CORNER CONCRETE SLAB FOR GAGING STATION.

NOTE: ALL TIES PULLED DIRECT

REVISIONS	
NAME	DATE

ILLINOIS DEPARTMENT OF TRANSPORTATION
TIES & BENCHMARKS
FAS ROUTE 1842
SECTION 106BR
ST CLAIR COUNTY

SCALE: VERT.
DATE

DRAWN BY
CHECKED BY