

F.A.S. RTE.	SECTION	COUNTY	TOTAL SHEETS	SHEET NO.
1842	106BR	ST CLAIR	61	15
STA. 667+00.00		TO STA. 673+00.00		
FED. ROAD DIST. NO.		ILLINOIS FED. AID PROJECT		

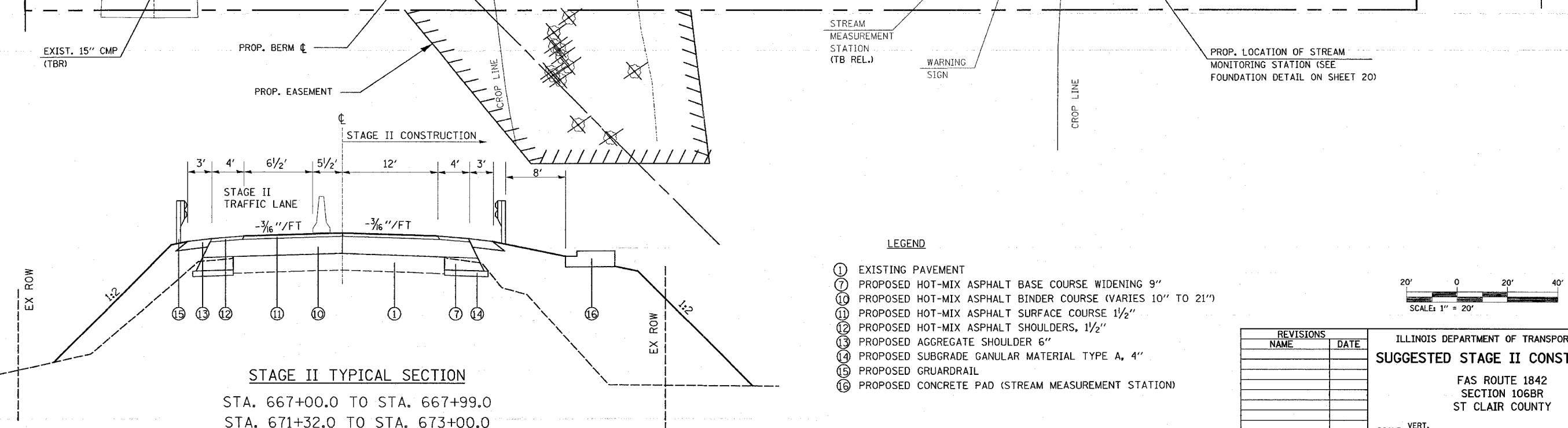

- LEGEND**
- ① EXISTING PAVEMENT
 - ⑦ PROPOSED HOT-MIX ASPHALT BASE COURSE WIDENING 9"
 - ⑩ PROPOSED HOT-MIX ASPHALT BINDER COURSE (VARIES 10" TO 21")
 - ⑪ PROPOSED HOT-MIX ASPHALT SURFACE COURSE 1 1/2"
 - ⑫ PROPOSED HOT-MIX ASPHALT SHOULDERS, 1 1/2"
 - ⑬ PROPOSED AGGREGATE SHOULDER 6"
 - ⑭ PROPOSED SUBGRADE GRANULAR MATERIAL TYPE A, 4"
 - ⑮ PROPOSED GUARDRAIL
 - ⑯ PROPOSED CONCRETE PAD (STREAM MEASUREMENT STATION)

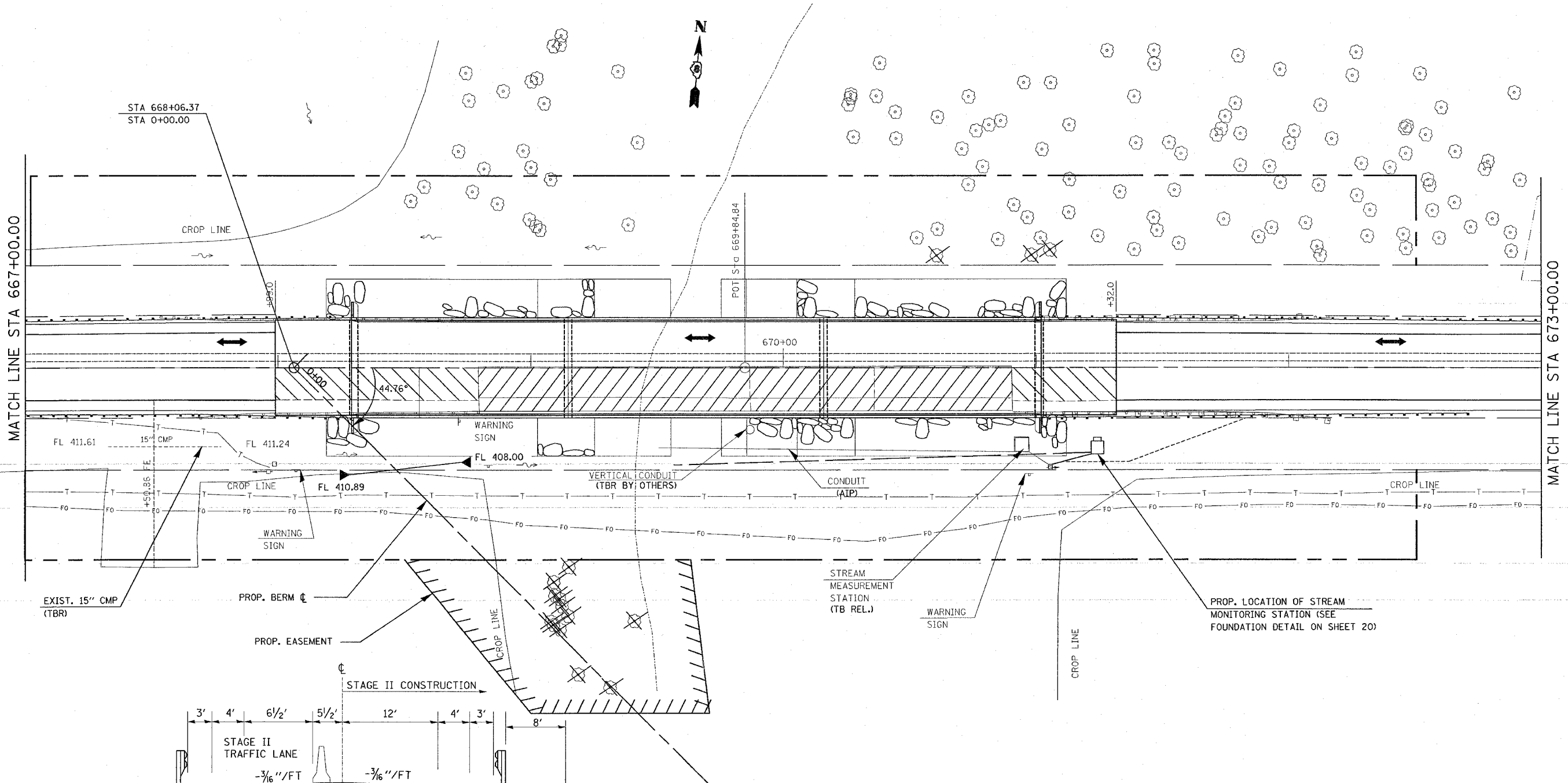
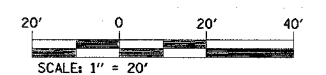

REVISIONS	
NAME	DATE

ILLINOIS DEPARTMENT OF TRANSPORTATION
SUGGESTED STAGE II CONSTRUCTION
 FAS ROUTE 1842
 SECTION 106BR
 ST CLAIR COUNTY

SCALE: VERT. _____
 HORIZ. _____
 DATE _____
 DRAWN BY _____
 CHECKED BY _____

PLOT DATE 12/11/2006
 FILE NAME c:\p\proj\sta\1842\106br\plan\p15.dwg
 PLOT SCALE 1" = 20'
 REFERENCE SHEET