





F.A.U. RTE.	SECTION	COUNTY	TOTAL SHEETS	SHEET NO.
9079	65BR	MADISON	46	15
STA. TO STA.		FED. ROAD DIST. NO. ILLINOIS FED. AID PROJECT		

**LEGEND**

-  TEMPORARY BRIDGE TRAFFIC SIGNALS
-  DRUM WITH STEADY BURNING LIGHT
-  TEMPORARY CONCRETE BARRIER
-  IMPACT ATTENUATOR
-  TYPE III BARRICADE

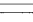

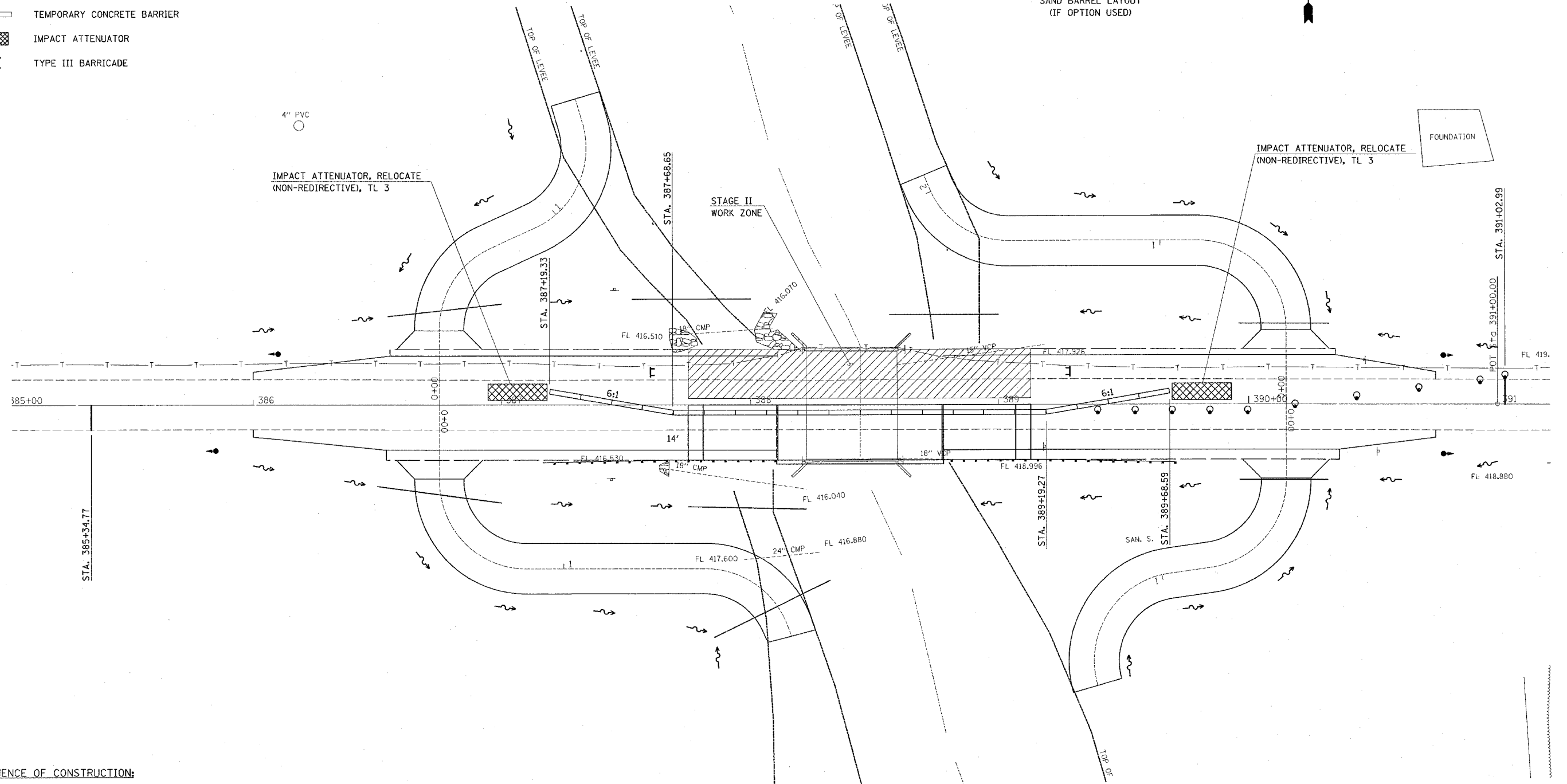
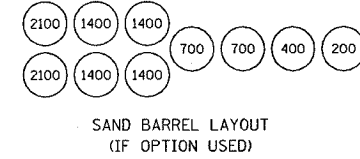
**SEQUENCE OF CONSTRUCTION:**

PLACE GUARDRAIL ALONG EASTBOUND TRAFFIC SHOWN ON THE PLANS.

RELOCATE 250 FT TEMPORARY CONCRETE BARRIER, BARRELS, AND IMPACT ATTENUATORS (2 EACH).

REMOVE TEMPORARY BRIDGE RAIL & TRAFFIC BARRIER TERMINAL, TYPE 6A (2 EACH) FROM STAGE I.

PERFORM ALL NECESSARY BRIDGE WORK IN STAGE II WORK ZONE.

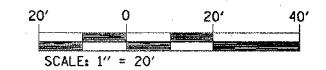

REVISIONS	
NAME	DATE

ILLINOIS DEPARTMENT OF TRANSPORTATION  
**STAGE II CONSTRUCTION**  
FAU ROUTE 9079  
SECTION 65BR  
MADISON COUNTY  
SN 060-0069 (E) 0236 (P)

PLOT DATE = 10/19/2006  
 PLOT SCALE = 20.0000' / IN.  
 REFERENCE = REF#