

F.A.I. RTE.	SECTION	COUNTY	TOTAL SHEETS	SHEET NO.
55/70		MADISON	26	14
STA. 760+00		TO STA. 790+00		
FED. ROAD DIST. NO.		ILLINOIS	FED. AID PROJECT	

*60-(7,8,9,10)I-2,60-(1,2)I-3

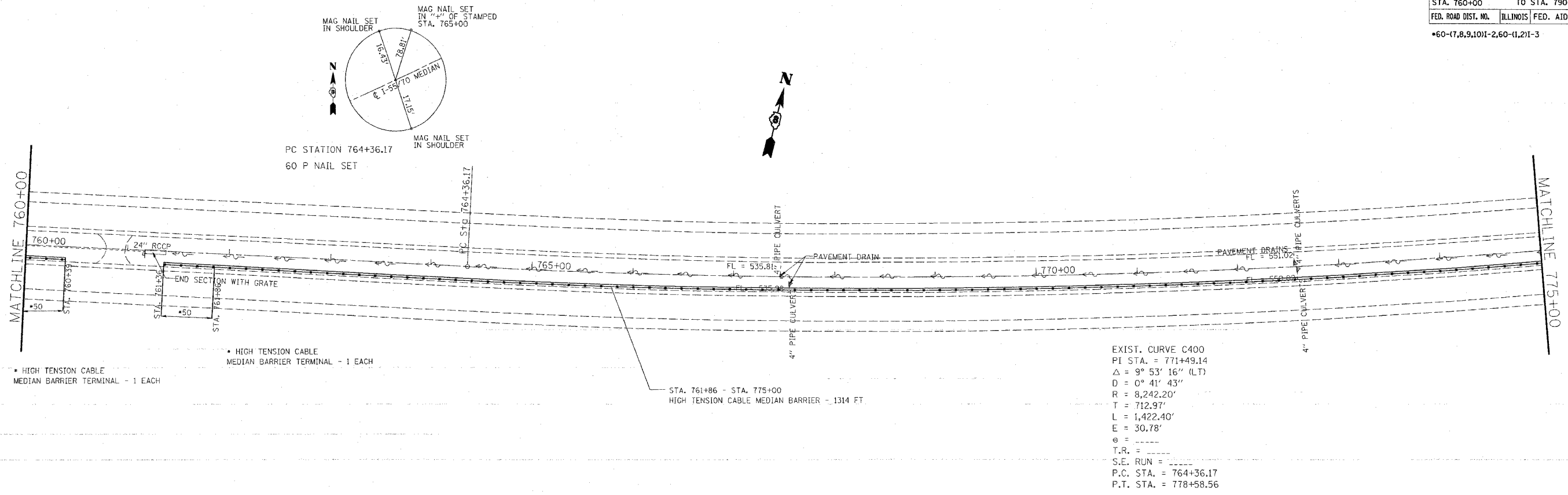

EXIST. CURVE C400
 PI STA. = 771+49.14
 $\Delta = 9^\circ 53' 16''$ (LT)
 $D = 0^\circ 41' 43''$
 $R = 8,242.20'$
 $T = 712.97'$
 $L = 1,422.40'$
 $E = 30.78'$
 $\theta =$
 $T.R. =$
 $S.E. RUN =$
 $P.C. STA. = 764+36.17$
 $P.T. STA. = 778+58.56$

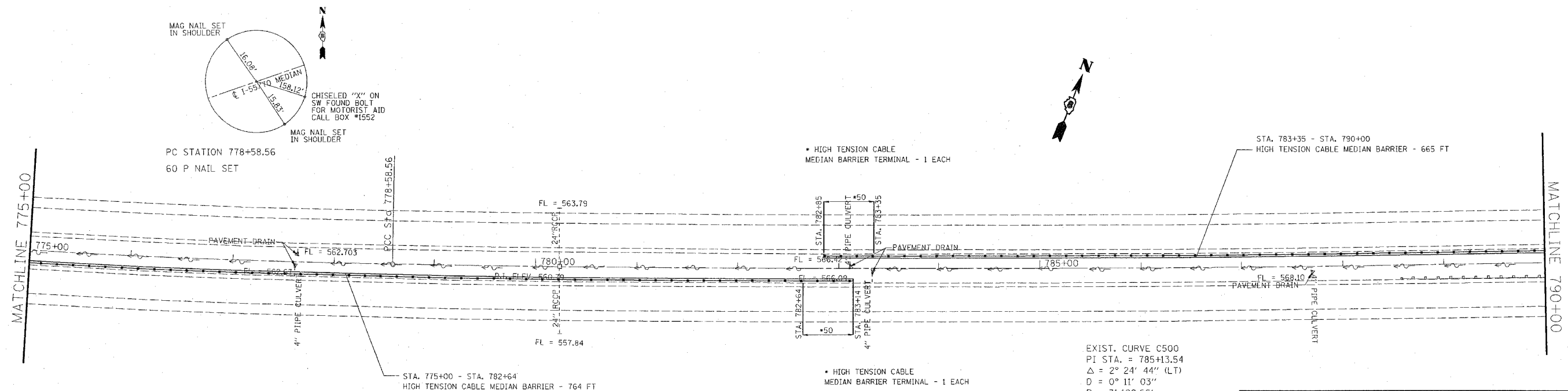

EXIST. CURVE C500
 PI STA. = 785+13.54
 $\Delta = 2^\circ 24' 44''$ (LT)
 $D = 0^\circ 11' 03''$
 $R = 31,108.66'$
 $T = 654.98'$
 $L = 1,309.76'$
 $E = 6.89'$
 $\theta =$
 $T.R. =$
 $S.E. RUN =$
 $P.C. STA. = 778+58.56$
 $P.T. STA. = 791+68.33$

REVISIONS	
NAME	DATE

ILLINOIS DEPARTMENT OF TRANSPORTATION
PLAN VIEW
 FAI RTE 55/70
 SECTION 60-(7,8,9,10)I-2,60-(1,2)I-3
 MADISON COUNTY
 SCALE: VERT. DATE: HORIZ. DATE: DRAWN BY: CHECKED BY:

PLOT DATE = 12/11/2006
 FILE NAME = c:\pvc\jcs\aed\6893\plan\p06893a.dgn
 PLOT SCALE = 80.0000 / 1" = 100'
 REFERENCE = WEP*