

F.A.I. RTE.	SECTION	COUNTY	TOTAL SHEETS	SHEET NO.
70	60-(10,11)RS	MADISON	184	37
STA.		TO STA.		
FED. ROAD DIST. NO.		ILLINOIS FED. AID PROJECT		

EXIST. CURVE RAMP G1-2	EXIST. CURVE RAMP G1-1
PI STA. = 14+32.65	PI STA. = 7+85.83
$\Delta = 56^\circ 38' 36''$ (RT)	$\Delta = 13^\circ 00' 58''$ (RT)
D = 5° 46' 33"	D = 5° 46' 33"
R = 992.00'	R = 992.00'
T = 534.62'	T = 113.17'
L = 980.70'	L = 225.36'
E = 134.89'	E = 6.43'
E = -----	E = -----
T.R. = -----	T.R. = -----
S.E. RUN = -----	S.E. RUN = -----
P.C. STA. = 8+98.03	P.C. STA. = 6+72.67
P.T. STA. = 18+78.73	P.T. STA. = 8+98.03

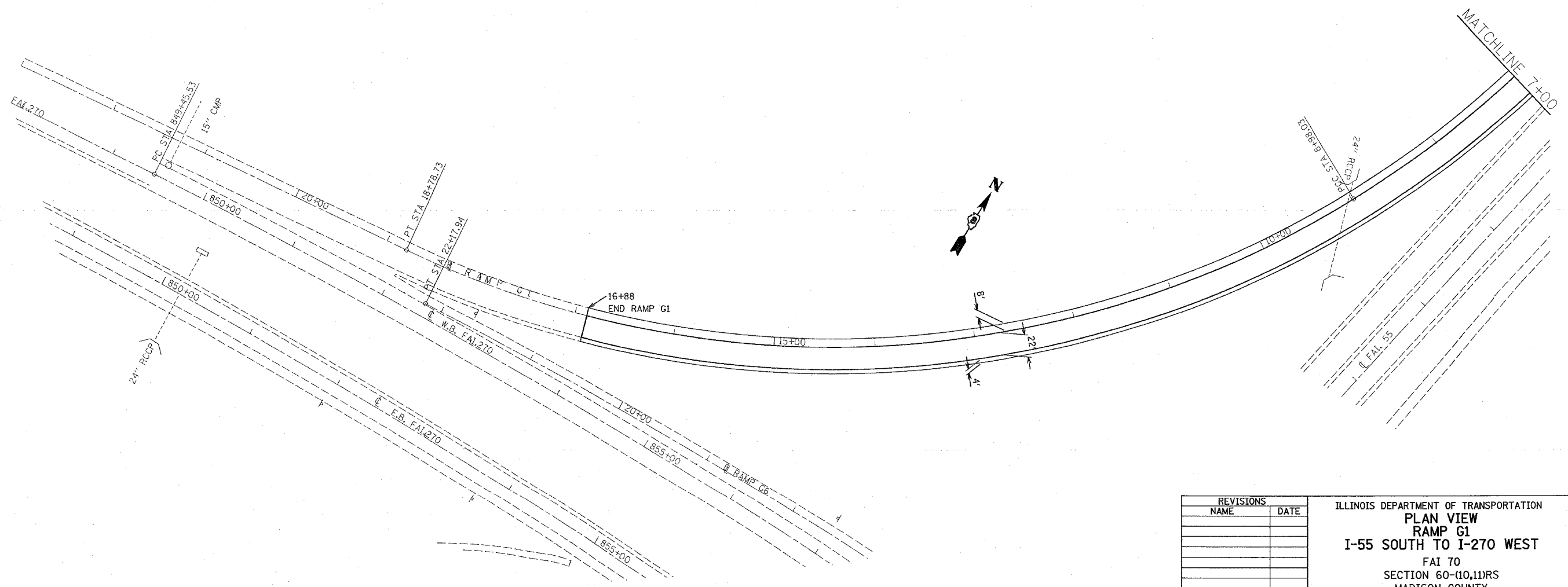

PLOT DATE = 04/25/05  
 FILE NAME = 07FILEL  
 PLOT SCALE = 1/8"=1'-0"  
 REFERENCE = #REF#

REVISIONS	
NAME	DATE

ILLINOIS DEPARTMENT OF TRANSPORTATION  
**PLAN VIEW**  
**RAMP G1**  
**I-55 SOUTH TO I-270 WEST**  
 FAI 70  
 SECTION 60-(10,11)RS  
 MADISON COUNTY  
 SCALE: VERT. \_\_\_\_\_  
 HORIZ. \_\_\_\_\_  
 DATE \_\_\_\_\_  
 DRAWN BY \_\_\_\_\_  
 CHECKED BY \_\_\_\_\_