

F.A.I. RTE.	SECTION	COUNTY	TOTAL SHEETS	SHEET NO.
70	60-(10,11)RS	MADISON	156	86
STA. _____ TO STA. _____		FED. ROAD DIST. NO. _____ ILLINOIS FED. AID PROJECT		

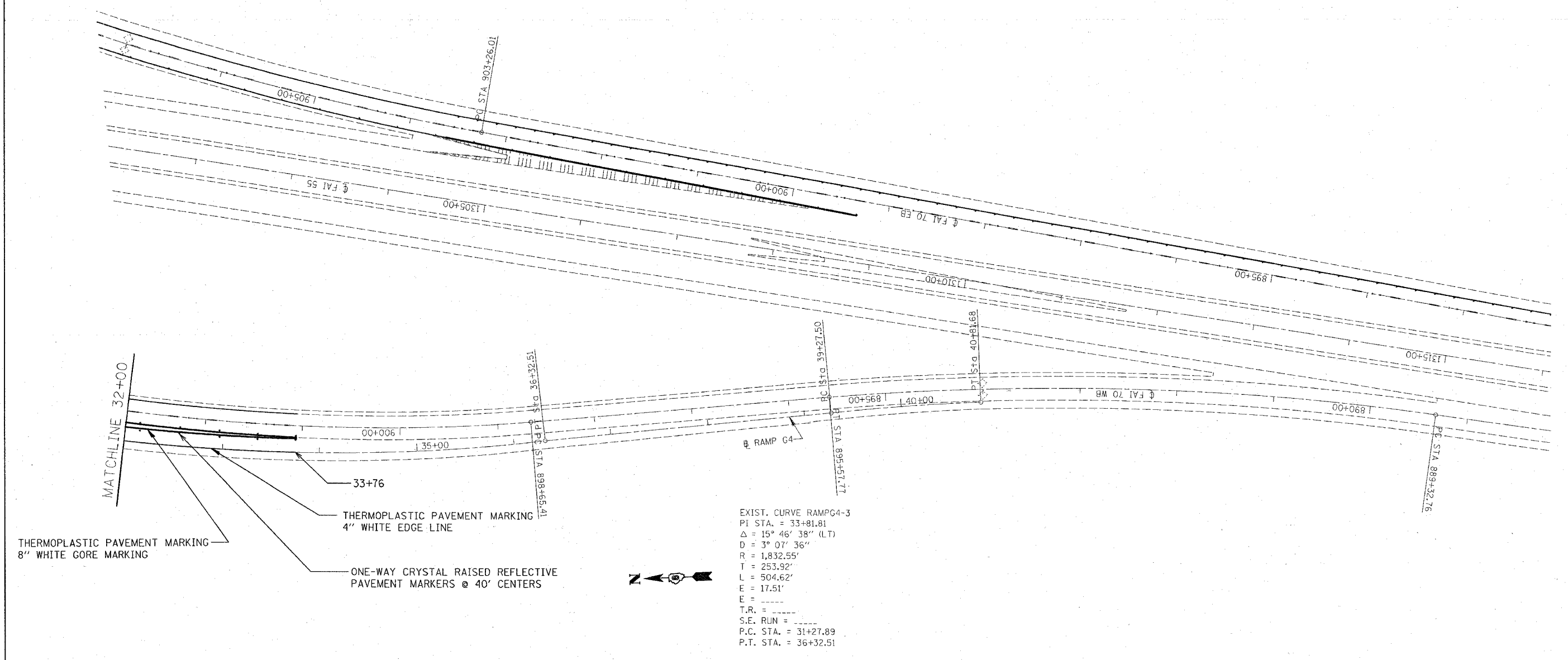

EXIST. CURVE RAMPG4-3  
 PI STA. = 33+81.81  
 $\Delta = 15^\circ 46' 38''$  (LT)  
 $D = 3^\circ 07' 36''$   
 $R = 1,832.55'$   
 $T = 253.92'$   
 $L = 504.62'$   
 $E = 17.51'$   
 $E = \dots$   
 $T.R. = \dots$   
 $S.E. RUN = \dots$   
 $P.C. STA. = 31+27.89$   
 $P.T. STA. = 36+32.51$

THERMOPLASTIC PAVEMENT MARKING  
 8" WHITE GORE MARKING

THERMOPLASTIC PAVEMENT MARKING  
 4" WHITE EDGE LINE

ONE-WAY CRYSTAL RAISED REFLECTIVE  
 PAVEMENT MARKERS @ 40' CENTERS



PLOT DATE = DATE  
 PLOT SCALE = SCALE  
 REFERENCE = REF

REVISIONS	
NAME	DATE

ILLINOIS DEPARTMENT OF TRANSPORTATION  
**PAVEMENT MARKING**  
**RAMP G4**  
 FAI 70  
 SECTION 60-(10,11)RS  
 MADISON COUNTY

SCALE: VERT. \_\_\_\_\_  
 HORIZ. \_\_\_\_\_

DATE \_\_\_\_\_ DRAWN BY \_\_\_\_\_  
 CHECKED BY \_\_\_\_\_