

EXP. DATE	SECTION	COUNTY	TOTAL SHEETS	SHEET NO.
	94-F3000-06-BT	COOK	105	15
STA. 202+00	TO STA. 248+62			
FED. ROAD DIST. NO.	ILLINOIS	83709	STPE-D001(479)	

**PROPOSED CURVE DATA**

PROP. CURVE PAUL-69 PI STA. = 303+66.64 $\Delta = 19^\circ 52' 08''$ (LT) $D = 7^\circ 09' 43''$ $R = 800.00'$ $T = 140.12'$ $L = 277.42'$ $E = 12.18'$ P.C. STA = 302+26.52 P.T. STA = 305+03.94	PROP. CURVE PAUL-70 PI STA. = 307+00.15 $\Delta = 50^\circ 36' 31''$ (LT) $D = 44^\circ 04' 25''$ $R = 130.00'$ $T = 61.46'$ $L = 114.83'$ $E = 13.80'$ P.C. STA = 306+38.69 P.T. STA = 307+53.51	PROP. CURVE PAUL-71 PI STA. = 308+97.13 $\Delta = 13^\circ 00' 52''$ (LT) $D = 6^\circ 21' 58''$ $R = 900.00'$ $T = 102.66'$ $L = 204.43'$ $E = 5.84'$ P.C. STA = 307+94.47 P.T. STA = 309+98.90	PROP. CURVE PAUL-72 PI STA. = 312+87.58 $\Delta = 12^\circ 55' 53''$ (RT) $D = 5^\circ 12' 31''$ $R = 1,100.00'$ $T = 124.66'$ $L = 248.27'$ $E = 7.04'$ P.C. STA = 311+62.92 P.T. STA = 314+11.19	PROP. CURVE PAUL-73 PI STA. = 315+96.59 $\Delta = 34^\circ 38' 28''$ (LT) $D = 14^\circ 19' 26''$ $R = 400.00'$ $T = 124.74'$ $L = 241.84'$ $E = 19.00'$ P.C. STA = 314+71.85 P.T. STA = 317+13.69	PROP. CURVE PAUL-74 PI STA. = 317+87.13 $\Delta = 16^\circ 37' 49''$ (RT) $D = 19^\circ 05' 55''$ $R = 300.00'$ $T = 43.85'$ $L = 87.08'$ $E = 3.19'$ P.C. STA = 317+43.28 P.T. STA = 318+30.36	PROP. CURVE PAUL-75 PI STA. = 324+07.33 $\Delta = 5^\circ 34' 41''$ (RT) $D = 6^\circ 21' 58''$ $R = 900.00'$ $T = 43.85'$ $L = 87.62'$ $E = 1.07'$ P.C. STA = 323+63.49 P.T. STA = 324+51.11
--	--	---	---	---	--	--

PROP. CURVE PAUL-76 PI STA. = 326+18.85 $\Delta = 6^\circ 39' 12''$ (LT) $D = 6^\circ 21' 58''$ $R = 900.00'$ $T = 52.31'$ $L = 104.51'$ $E = 1.52'$ P.C. STA = 325+66.54 P.T. STA = 326+71.05	PROP. CURVE PAUL-77 PI STA. = 328+30.63 $\Delta = 24^\circ 45' 38''$ (LT) $D = 19^\circ 05' 55''$ $R = 300.00'$ $T = 65.85'$ $L = 129.65'$ $E = 7.14'$ P.C. STA = 327+64.78 P.T. STA = 328+94.42
---	---

PROP. CURVE PAUL-78 PI STA. = 330+28.10 $\Delta = 35^\circ 05' 00''$ (RT) $D = 19^\circ 05' 55''$ $R = 300.00'$ $T = 94.83'$ $L = 183.70'$ $E = 14.63'$ P.C. STA = 329+33.27 P.T. STA = 331+16.96	PROP. CURVE PAUL-79 PI STA. = 335+35.11 $\Delta = 6^\circ 35' 56''$ (LT) $D = 19^\circ 05' 55''$ $R = 300.00'$ $T = 17.29'$ $L = 34.55'$ $E = 0.50'$ P.C. STA = 335+17.81 P.T. STA = 335+52.36	PROP. CURVE PAUL-80 PI STA. = 337+35.73 $\Delta = 4^\circ 56' 04''$ (LT) $D = 11^\circ 27' 33''$ $R = 500.00'$ $T = 21.54'$ $L = 43.06'$ $E = 0.46'$ P.C. STA = 337+14.19 P.T. STA = 337+57.25	PROP. CURVE PAUL-81 PI STA. = 340+42.76 $\Delta = 3^\circ 30' 12''$ (LT) $D = 5^\circ 43' 46''$ $R = 1,000.00'$ $T = 30.58'$ $L = 61.14'$ $E = 0.47'$ P.C. STA = 340+12.18 P.T. STA = 340+73.32	PROP. CURVE PAUL-82 PI STA. = 341+86.42 $\Delta = 1^\circ 53' 33''$ (RT) $D = 5^\circ 43' 46''$ $R = 1,000.00'$ $T = 16.52'$ $L = 33.03'$ $E = 0.14'$ P.C. STA = 341+69.91 P.T. STA = 342+02.94	PROP. CURVE PAUL-83 PI STA. = 343+36.73 $\Delta = 1^\circ 47' 59''$ (RT) $D = 2^\circ 51' 53''$ $R = 2,000.00'$ $T = 31.41'$ $L = 62.82'$ $E = 0.25'$ P.C. STA = 343+05.32 P.T. STA = 343+68.14	PROP. CURVE PAUL-84 PI STA. = 345+81.46 $\Delta = 5^\circ 41' 31''$ (RT) $D = 19^\circ 05' 55''$ $R = 300.00'$ $T = 14.91'$ $L = 29.80'$ $E = 0.37'$ P.C. STA = 345+66.55 P.T. STA = 345+96.35
--	---	---	--	--	--	---

MATCHLINE STA. 302+00

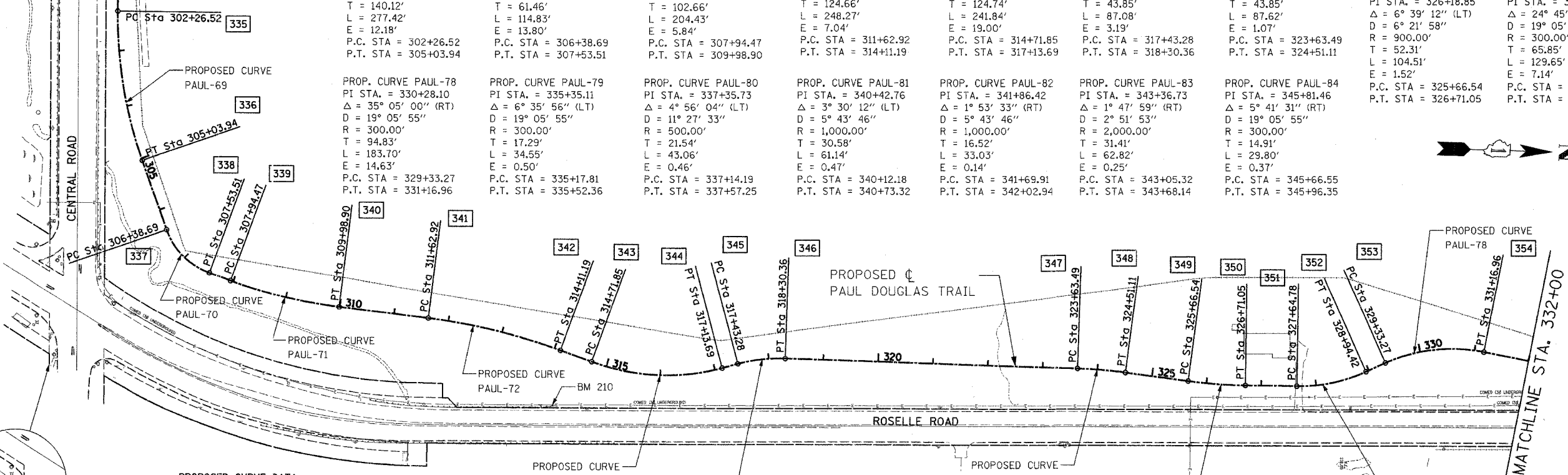

**PROPOSED CURVE DATA**

PROP. CURVE PAUL-85 PI STA. = 346+36.51 $\Delta = 5^\circ 19' 26''$ (LT) $D = 19^\circ 05' 55''$ $R = 300.00'$ $T = 13.95'$ $L = 27.88'$ $E = 0.32'$ P.C. STA = 346+22.57 P.T. STA = 346+50.44	PROP. CURVE PAUL-86 PI STA. = 347+77.39 $\Delta = 7^\circ 44' 04''$ (LT) $D = 38^\circ 11' 50''$ $R = 150.00'$ $T = 10.14'$ $L = 20.25'$ $E = 0.34'$ P.C. STA = 347+67.25 P.T. STA = 347+87.50	PROP. CURVE PAUL-87 PI STA. = 348+20.95 $\Delta = 10^\circ 28' 45''$ (RT) $D = 38^\circ 11' 50''$ $R = 150.00'$ $T = 13.76'$ $L = 27.43'$ $E = 0.63'$ P.C. STA = 348+07.19 P.T. STA = 348+34.63
---	---	--

NOTE:  
FOR CONTROL POINT AND BENCHMARK INFORMATION  
SEE SHEET 10.

**COORDINATE DATA:**

335	N 1967184.127 E 1052840.974	345	N 1968318.075 E 1053479.788
336	N 1967230.125 E 1053113.150	346	N 1968404.280 E 1053469.898
337	N 1967275.164 E 1053240.146	347	N 1968937.153 E 1053486.369
338	N 1967353.514 E 1053318.958	348	N 1969024.463 E 1053493.332
339	N 1967392.032 E 1053332.875	349	N 1969138.945 E 1053508.097
340	N 1967590.506 E 1053380.000	350	N 1969243.137 E 1053515.423
341	N 1967753.355 E 1053399.563	351	N 1969336.860 E 1053516.561
342	N 1967994.435 E 1053456.621	352	N 1969462.835 E 1053490.507
343	N 1968051.518 E 1053477.151	353	N 1969498.304 E 1053474.667
344	N 1968289.472 E 1053487.377	354	N 1969677.973 E 1053454.122

CP 5019  
NGS MON

**CONTROL POINT 5019**  
MONUMENT, SOUTHSIDE CENTRAL RD.  
EAST OF ROSELLE RD.

**COORDINATE DATA:**

355	N 1970071.431 E 1053530.732
356	N 1970105.651 E 1053535.370
357	N 1970266.992 E 1053547.840

358	N 1970310.015 E 1053549.306
359	N 1970564.935 E 1053547.014
360	N 1970626.021 E 1053544.596
361	N 1970722.370 E 1053537.828

362	N 1970755.099 E 1053536.067
363	N 1970857.665 E 1053532.260
364	N 1970920.467 E 1053530.916
365	N 1971118.873 E 1053529.787

366	N 1971148.635 E 1053531.097
367	N 1971174.733 E 1053533.548
368	N 1971202.568 E 1053534.863
369	N 1971319.380 E 1053534.948

370	N 1971339.568 E 1053533.598
371	N 1971359.081 E 1053530.963
372	N 1971386.452 E 1053529.790
373	N 1971488.641 E 1053534.764

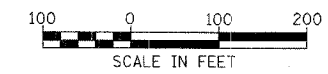

ILLINOIS DEPARTMENT OF TRANSPORTATION  
DISTRICT NO. 1 SCHAUMBURG  
**ALIGNMENT, BENCHMARKS,  
AND TIES**

SCALE AS NOTED  
DATE MARCH 28, 2006  
DRAWN BY RTA  
CHECKED BY SMH