

FAP NO.	SECTION	COUNTY	TOTAL SHEETS	SHEET NO.
	94-F3000-06-ET	COOK	105	82
STA.	TO STA.			
FED. ROAD DIST. NO.	ILLINOIS	83709	STPE-D001(479)	

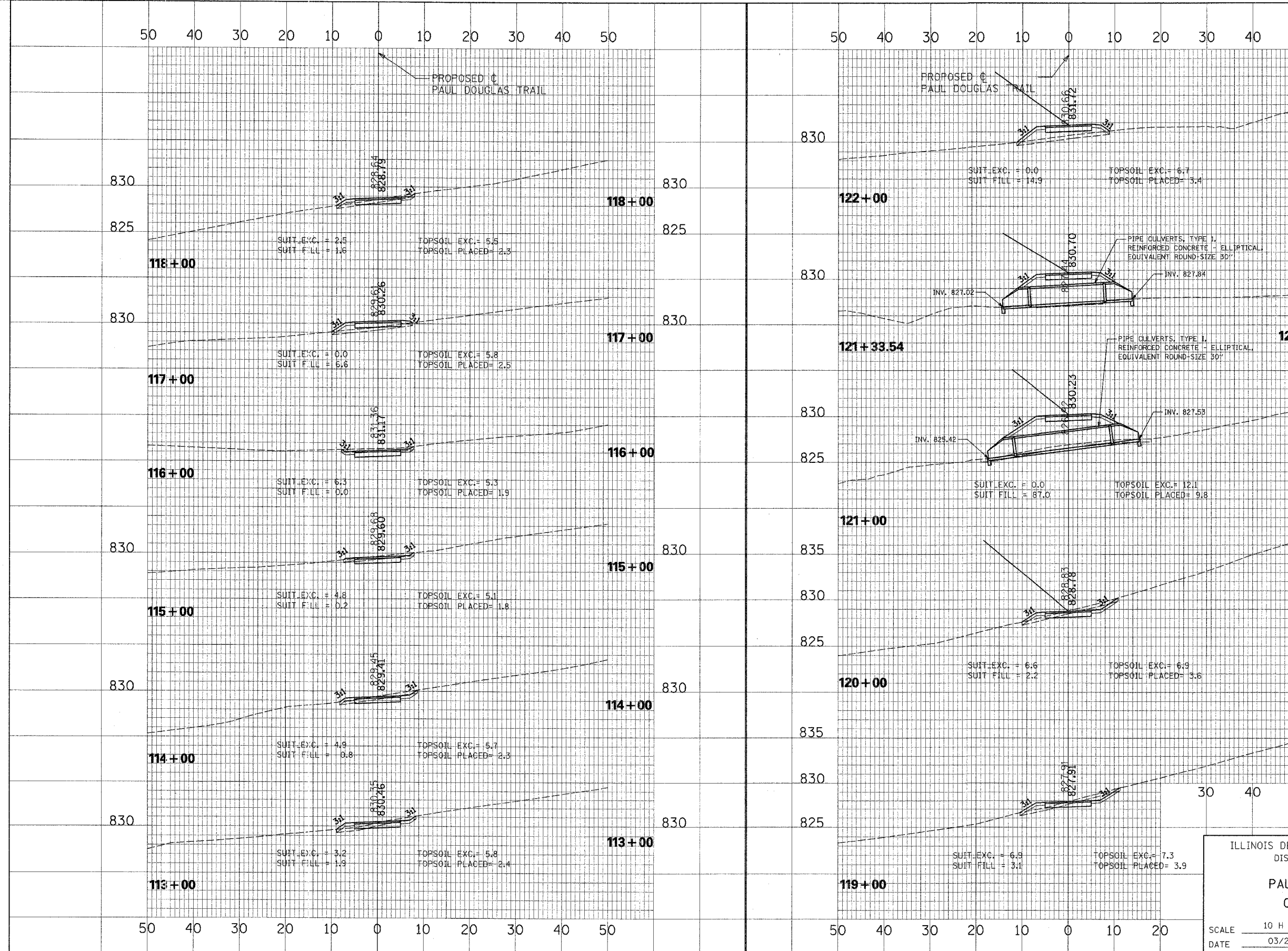

CROSS SECTION NO. \_\_\_\_\_  
 SURVEYED BY \_\_\_\_\_ DATE \_\_\_\_\_  
 GRADES CHECKED \_\_\_\_\_  
 ALIGNMENT CHECKED \_\_\_\_\_  
 NOTE BOOK NO. \_\_\_\_\_  
 DUD. FILE NAME \_\_\_\_\_

CROSS SECTION NO. \_\_\_\_\_  
 SURVEYED BY \_\_\_\_\_ DATE \_\_\_\_\_  
 GRADES CHECKED \_\_\_\_\_  
 ALIGNMENT CHECKED \_\_\_\_\_  
 NOTE BOOK NO. \_\_\_\_\_  
 DUD. FILE NAME \_\_\_\_\_

ILLINOIS DEPARTMENT OF TRANSPORTATION  
 DISTRICT NO. 1 SCHAUMBURG  
**PAUL DOUGLAS TRAIL  
 CROSS SECTIONS**  
 SCALE 10 H : 5 V  
 DATE 03/29/06  
 DRAWN BY RTA  
 CHECKED BY SMH